

545D6102

545D0102



WiFer



LED	1-130 VA	▲RC
	1-30 VA	▲RL
	1-250 W	▲R
	1-70 VA	▲L (*)

	1-230 W	▲R
	1-200 VA	▲C

(*) Der må kun anvendes transformere, der er beregnet til at blive brugt med en lysdæmper.

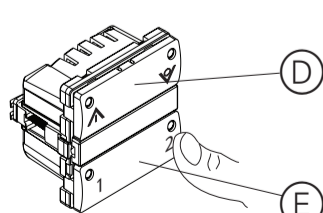
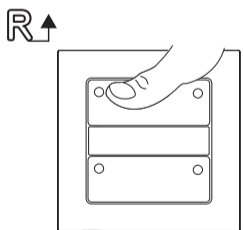
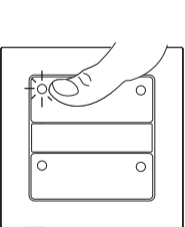
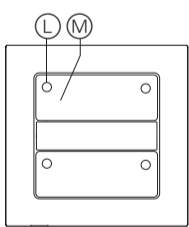
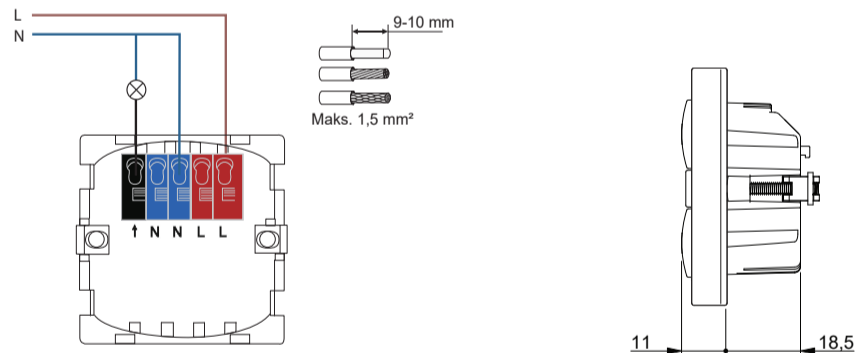
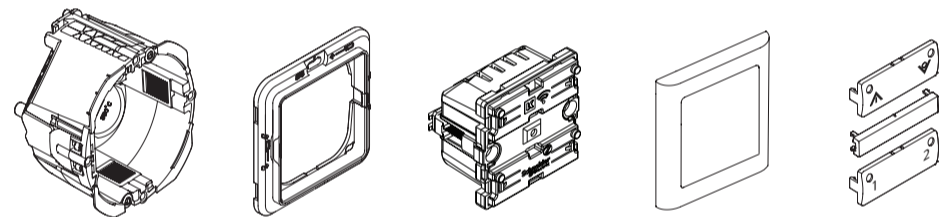
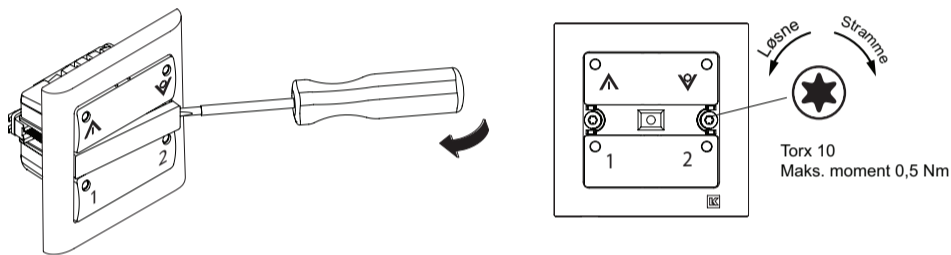
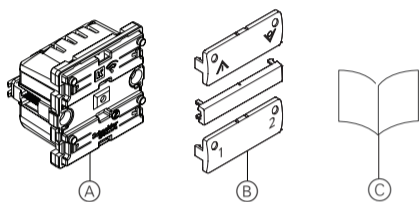

1 = S1 (Default:)

2 = S2 (Default:)

Nødvendig tilbehør

- En komplet installation kræver
- Designramme og evt. teknisk ramme.
- Tangenter og midterbjælke hvis 545D0102

Forudsætninger

Download **Wiser app'en** til din smartphone / tablet, og installer **Wiser Gateway** for at konfigurere og styre dine Wiser enheder.

Yderligere information

Detaljeret produktinformation er tilgængelig online i **systemvejledningen**: Scan QR-koden eller følg linket.

<https://www.1.lk.dk/wiser>
For din sikkerhed**▲ ▲ FARE****FARE FOR ELEKTRISK STØD, EKSPLOSION ELLER LYSBUE**

Sikker elektrisk installation må kun udføres af kvalificerede fagfolk. Dygtige fagfolk skal have dybtgående viden på følgende områder:

- Tilslutning til fast installation
- Tilslutning af flere elektriske enheder
- Lægning af elektriske kabler
- Sikkerhedsstandarder, lokale regler og forskrifter

Manglende overholdelse af disse instruktioner kan resultere i død eller alvorlig personskade.

▲ ▲ FARE**RISIKO FOR FATAL SKADE FRA ELEKTRISK STØD**

Udgangen kan have elektrisk strøm, selv når belastningen er slukket.

- Frakobl enheden fra forsyningen ved hjælp af sikringen i det indkommende kredsløb, før du arbejder på enheden.

Manglende overholdelse af disse instruktioner kan resultere i død eller alvorlig personskade.

Lær produktet at kende

LK FUGA® Wiser trådløs lysdæmper (i det følgende kaldet **enheden**) er en lysdæmper som kan betjenes lokalt på det tilknyttede betjeningstryk. Lysdæmper-udgangen kan styres fra andre Wiser enheder.

Den øverste tangent bruges til ON / dæmp op (venstre side) og OFF / dæmp ned (højre side). Den nederste tangent er scenario S1 og S2. S1 er forudkonfigureret som ON og S2 som OFF. Dette kan via Wiser app'en (kræver Gateway) ændres af brugeren til at gemme lysstyrken på lysdæmperen.

i Hvis der bruges LED, vil dæmpningsresultatet afhænge af den tilsluttede LED. Nogle LED'er fungerer ikke korrekt. Dette afhænger af antallet af LED'er, kvaliteten af driveren og strømmen til det netværk, den leveres fra.

Styringsmuligheder

Boligstyring: For at styre enheden via Wiser app skal du bruge Wiser Gateway.

Rumstyring: For at styre enheden med andre Wiser enheder, kan det parres med andre Wiser enheder inden for det samme Zigbee-netværk.

Direkte betjening: Enheden kan altid styres ved betjening direkte på enheden.

Funktioner

- Skift mellem RC og RL tilstand
- Termisk beskyttelse, overbelastningsbeskyttelse, kortslutningsbeskyttelse
- Soft start

Via app:

- Indstilling af lysniveau ved tænd eller memory funktion
- Min./maks. lysniveau
- Indstilling dimmer mode til RC eller RL mode (default RC mode).
- Indstilling af en timer eller en tidsplan

Indhold i pakke

- (A) LK FUGA® Wiser trådløs lysdæmper
- (B) Tangenter og midterbjælke (ikke inkluderet for 545D0102).
- (C) Installationsvejledning

Monteringsmuligheder

Enheden skal monteres i LK FUGA® installationsdåser eller LK FUGA® underlag. Enheden fylder 1 modul.

Montering af enheden**▲ FORSIGTIG**

Enheden kan blive beskadiget!

- Brug altid produktet i overensstemmelse med de specificerede tekniske data.
- Tilslut aldrig blandede induktive / kapacitive belastninger.
- Tilslut kun dæmpbare belastninger.
- Fare for overbelastning! Dæmpning af stikkontakter er forbudt.

Manglende overholdelse af disse instruktioner kan resultere i beskadigelse af produktet.

Forbindelse af enheden**Betjeningslementer**

- (L) Status lysdiode
- (M) Setup / reset (knappen under midterbjælken har samme funktion).

Indstilling af enheden**Skift mellem RC og RL tilstand**

Skift mellem RC og RL tilstand Tryk 14 korte tryk på setup knappen (øverst til venstre). Lysdiode lyser derefter grøn for RC mode og blå for RL mode. Fabriksindstilling er RC tilstand.

Opret forbindelse til Wiser Gateway

Tryk kort (<0,5 s) på setup / reset knappen 3 gange for at oprette forbindelse til et tilgængeligt Zigbee-netværk. Status lysdiode blinker gult og bliver derefter grønt efter en vellykket forbindelse til Zigbee-netværket.

For mere information henvises til systemet brugervejledning.

Parring til andre Wiser-enheder

For at benytte enheden i rumstyringstilstand skal den parres med andre Wiser enheder inden for det samme Zigbee-netværk.

Nulstilling af enheden

Kort tryk (<0,5 s) på setup / reset knappen 3 gange, og derefter langt tryk (>10 s) på setup / reset knappen én gang for at nulstille enheden til fabriksindstilling.

Status-LED blinker rødt og lyser derefter kontinuerligt, når enheden er nulstillet.

i Når enheden er nulstillet, slettes alle programmerings- og netværksdata.

Betjening

(D) Tænd/justér op (venstre) og sluk/justér ned (højre).

(E) Scenarier. Default: 1 = tænd, 2 = sluk.

Du kan fjernbetjene enheden med Wiser app (kræver Wiser Gateway).

Betydning af status lysdiode

Se systemvejledning.

Fejlfinding

Se systemvejledning.

Teknisk data

Mærkespænding	230 V a.c. 50 Hz
Maks. belastning	
Standby	Maks. 0,4 W
Forsikring	13 A
Overbelastningsbeskyttelse	Overophedning, kortslutning
Betjening	Lokalbetjening: 4 knapper Fjernbetjening med ydre trykknapper. Zigbee 3.0
Lokal status indikering	4 lysdioder
Timer (tidsforsinkelse)	1 sekund til 24 timer
Forbindelse	230 V, 0 V, output
Terminaler	Skrueløse terminaler 2x1,5 mm ² (N) 2x1,5 mm ² (L) 1x1,5 mm ² (belastning) Ledning: 1,5 mm ² stiv, flertrådet eller mangetrådet. En leder per hul.
Driftstemperatur	-5 til +40 °C
Fugtighed	10% - 95% relativ, ikke-kondenserende
Modul størrelse	1M
Frekvensområde	2,4 Hz
Maks. radio-frekvens-effekt transmitteret	<10 mW
Kapslingsklasse	IP20
Mekanisk beskyttelsesklasse	IK04
Miljøoplysning	Reach, RoHS, WEEE, Green Premium
EU deklaration	WD20061102
Certifikater, normer	Zigbee 3.0

Bortskaf enheden separat fra husholdningsaffald på et officielt opsamlingssted. Professionel genanvendelse beskytter mennesker og miljøet mod potentielle negative effekter.

Varemærker

- Wiser™ tilhører Schneider Electric SE, dets datterselskaber og tilknyttede virksomheder.
 - Zigbee® er et registreret varemærke tilhørende Zigbee Alliance.
 - Apple® og App Store® er mærkenavne eller registrerede varemærker tilhørende Apple Inc.
 - Google Play™ Store og Android™ er mærkenavne eller registrerede varemærker tilhørende Google Inc.
- Andre mærker og registrerede varemærker tilhører deres relevante ejere.

EU-overensstemmelseserklæring

Schneider Electric Danmark A/S erklærer hermed, at dette produkt er i overensstemmelse med de væsentlige krav og andre relevante bestemmelser i RADIO EQUIPMENT DIRECTIVE 2014/53 / EU. Overensstemmelseserklæringen kan downloades på adressen se.com/docs.

Lauritz Knudsen

Schneider Electric Danmark A/S, Lautrupvang 1, 2750 Ballerup, Telefon: +45 88 30 20 00, www.lk.dk

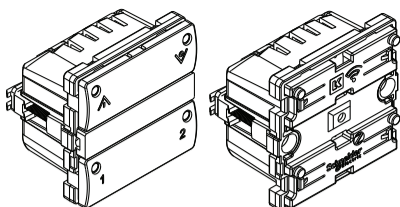

545D6102

545D0102



Wiser



LED	1-130 VA	▲RC
	1-30 VA	▲RL
	1-250 W	▲R
	1-70 VA	▲L (*)

	1-230 W	▲R
	1-200 VA	▲C

(*) Only transformer intended to be used with a dimmer shall be used.

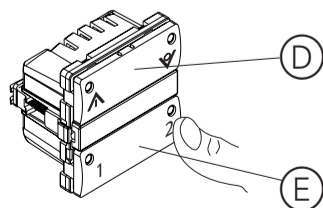
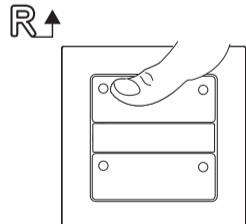
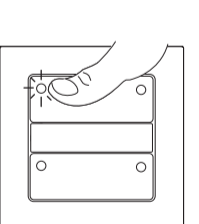
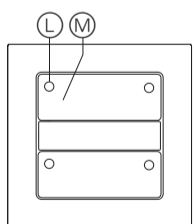
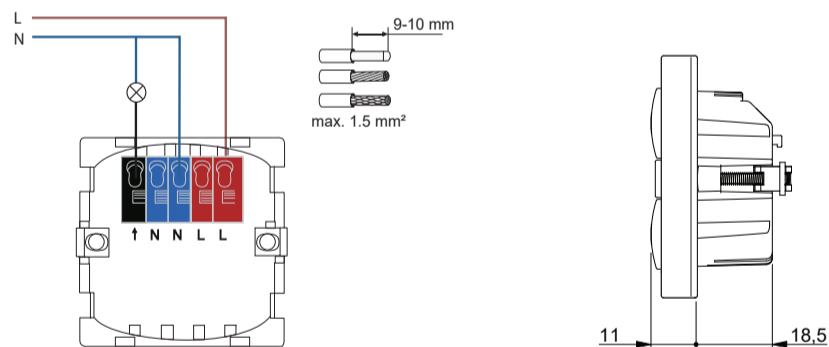
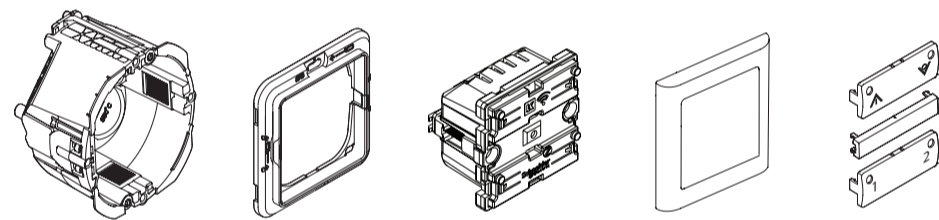
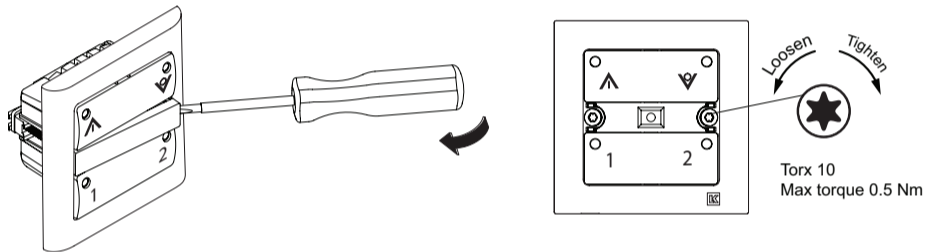
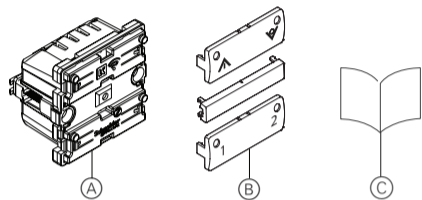

▲ = S1 (Default:)
 ▼ = S2 (Default:)

Necessary accessories

- A complete installation requires
- Design frame and possibly a technical frame.
- Rockers and center cover if 545D0102.

Prerequisites

Download the **Wiser app** to your smartphone/tablet and install the **Wiser Gateway** to configure and control Wiser devices.

Additional system information

Detailed product information is available online in the **system user guide**: Scan the QR code or follow the link.



<https://www1.lk.dk/wiser>

For your safety

▲▲ DANGER

HAZARD OF ELECTRIC SHOCK, EXPLOSION, OR ARC FLASH

Safe electrical installation must be carried out only by skilled professionals. Skilled professionals must prove profound knowledge in the following areas:

- Connecting to installation networks
- Connecting several electrical devices
- Laying electric cables
- Safety standards, local wiring rules and regulations

Failure to follow these instructions will result in death or serious injury.

▲▲ DANGER

RISK OF FATAL INJURY FROM ELECTRIC SHOCK

The output may carry electrical current even when the load is switched off.

- Disconnect the device from the supply by means of the fuse in the incoming circuit before working on the device.

Failure to follow these instructions will result in death or serious injury.

Getting to know the product

The LK FUGA® Wiser wireless dimmer (hereinafter referred to as the **device**) is a dimmer that can be operated locally at the associated operating panel. The dimmer output can be controlled from other Wiser devices.

By default, the switch panel controls the output. The upper rocker is used for ON / dim up (left side) and OFF / dim down (right side). The bottom rocker are scenarios S1 and S2. S1 is preconfigured as ON and S2 as OFF. This can be changed via the Wiser app (requires Gateway) by the user to save brightness level of the dimmer.



If LED bulb is used the dimming result will be depending on the LED connected. Some LED's will not work properly. This depends on number of LED's, the quality of the driver and the power of network it is supplied from.

Control options

- Home control:** To control the device through the Wiser app you will need the Wiser Gateway.
- Room control:** To control the device with other Wiser devices, it can be paired with other Wiser devices within the same Zigbee network.
- Direct operation:** The device can always be controlled directly on-site.

Functions

- Switch between RC and RL mode.
- Thermal protection, overload-resistant, short-circuit protection
- Soft start

Via app:

- Setting the switch-on brightness or memory function
- Dimming range: Min./max. brightness
- Setting dimmer mode to RC or RL mode (default RC mode).
- Setting a timer or a time schedule

Package contents

- (A) LK FUGA® Wiser wireless dimmer
- (B) Rockers and center cover (not included for 545D0102).
- (C) Installation guide.

Mounting options

The device must be mounted in LK FUGA® installation boxes or LK FUGA® surface installation boxes. The device size is 1 module.

Mounting the device

▲ CAUTION

The device may be damaged!

- Always operate the product in compliance with the specified technical data.
- Never connect any mixed inductive/capacitive loads.
- Only connect dimmable loads.
- Danger of overload! Dimming socket outlets is prohibited.

Failure to follow these instruction can result in equipment damage.

Connecting the device



Operating elements

- (L) Status LED
- (M) Setup/Reset (the button under the center cover bar has the same function).

Setting the device

Switch between RC and RL mode

Press 14 short-clicks on the setup button (top left). LED then lights up green for RC mode and blue for RL mode. Factory setting is RC mode.

Connecting to the Wiser Gateway

Short press (< 0,5 s) the Setup/Reset button 3 times to connect to an available Zigbee network. The status LED blinks amber and then turns green upon successful connection to the Zigbee network.

For more information refer to the system user guide.

Pairing to other Wiser devices

To control products in a room control mode, it can be paired with other Wiser devices within the same Zigbee network.

Resetting the device

Short press (< 0,5 s) the Setup/Reset button 3 times and then long press (>10 s) the Setup/Reset button once to reset the device to factory default mode.

The status LED blinks red and then turns red upon successful reset of the device.



After the device is reset all the programming and network data will be deleted.

Operating

- (D) On/adjust up (left) and off/adjust down (right).
- (E) Scenarios. Default: 1 = on, 2 = off.

You can remotely control the unit via the Wiser app (requires Wiser Gateway).

Behaviour of the status LED

Refer to the system user guide.

Troubleshooting

Refer to the system user guide.

Technical data

Rated Operational Voltage	230 V AC 50 Hz
Nominal power	
Standby Consumption	Max. 0.4 W
Associated Fuse Rating	13 A
Protection Type	Overheating Protection Short-circuit Protection
Operation	Local Control 4 pushbuttons Remote control by auxiliary push-button Zigbee 3.0
Local Signaling	4 LED
Time Delay Range	1 Second to 24 Hour
Connection	Line, Neutral, Load
Terminals	Screwless terminals 2x1.5 mm ² (N) 2x1.5 mm ² (L) 1x1.5 mm ² (Load) Wire: 1,5 mm ² solid, stranded or multi-stranded. One wire per. hole.
Operating Temperature	-5 to +40°C
Operating Humidity	10% - 95% RH, Non-condensing
Module size	1M
Operating frequency	2.4 GHz
Max. radiofrequency power transmitted	<10 mW
IP Degree of Protection	IP20
IK Degree of Protection	IK04
Environmental Disclosure	Reach, RoHS, WEEE, Green Premium
EU declaration	WD20061102
Product Certifications	Zigbee 3.0



Dispose of the device separately from household waste at an official collection point. Professional recycling protects people and the environment against potential negative effects.

Trademarks

- Wiser™ is a trademark and the property of Schneider Electric SE, its subsidiaries and affiliated companies.
 - Zigbee® is a registered trademark of the Zigbee Alliance.
 - Apple® and App Store® are brand names or registered trademarks of Apple Inc.
 - Google Play™ Store and Android™ are brand names or registered trademarks of Google Inc.
- Other brands and registered trademarks are properties of their relevant owners.

EU Declaration of conformity

Hereby, Schneider Electric Denmark A/S, declares that this product is in compliance with the essential requirements and other relevant provisions of RADIO EQUIPMENT DIRECTIVE 2014/53/EU. Declaration of conformity can be downloaded on: se.com/docs.

Lauritz Knudsen

Schneider Electric Denmark A/S, Lautrupvang 1, 2750 Ballerup, Phone: +45 88 30 20 00, www.lk.dk