

550B1011

WiFer™



	2200 W
	2000 W
	500 VA
	1000 VA

	1050 VA
C	10 A, 140 µF
	100 W
	LED 200 W

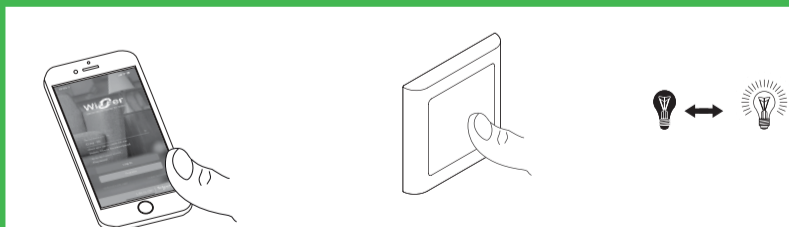
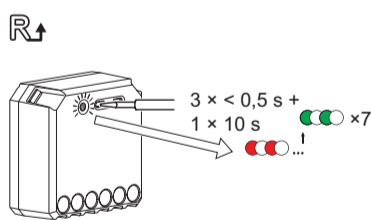
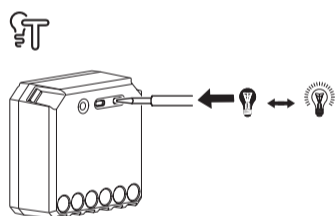
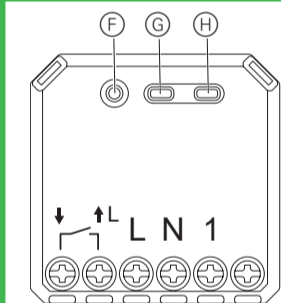
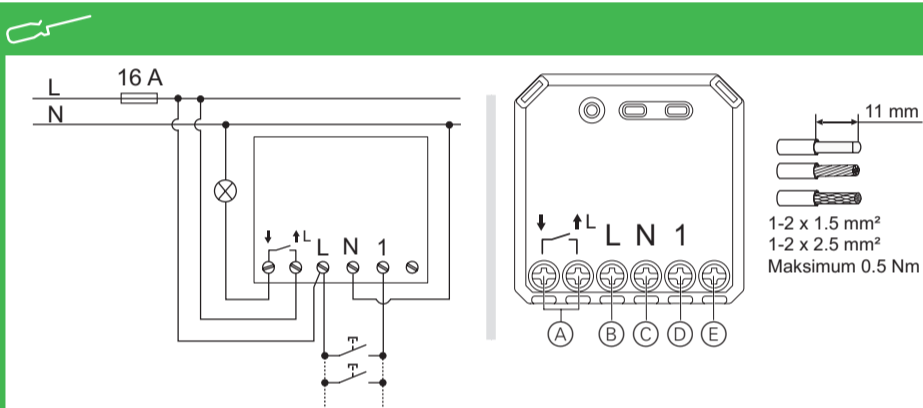
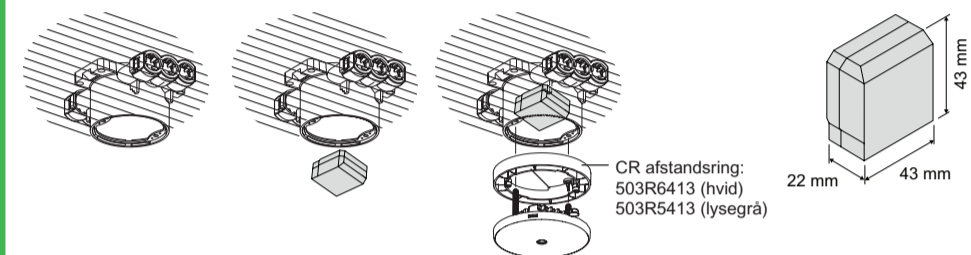
**Wiser trådløs relæ for indbygning (Puck)**

Download **Wiser app'en** til din smartphone / tablet, og installer **Wiser Gateway** for at konfigurere og styre dine Wiser enheder.

Yderligere information

Detaljeret produktinformation er tilgængelig online i **systemvejledningen**: Scan QR-koden eller følg linket.

<https://www.1.lk.dk/wiser>**For din sikkerhed****FARE****Fare for elektrisk stød, eksplosion eller lysbue**

En sikker elektrisk installation kræver viden på følgende områder:

- Tilslutning til el-installation
- Tilslutning af elektriske apparater
- Udlægning af elektriske kabler
- Sikkerhedsstandarder, lokale installationsregler og forskrifter

Manglende overholdelse af disse instruktioner vil resultere i død eller alvorlig personskade.

Lær produktet at kende

Wiser trådløs relæ for indbygning (Puck) (i det følgende benævnt **puck**) bruges til at tænde og slukke den tilsluttede belastning som kan være ohmsk, induktiv eller kapacitiv.

i Puck'en må ikke bruges til at styre sikkerhedsrelaterede applikationer.

Styringsmuligheder

Boligstyring: For at styre puck'en i dit hjem gennem Wiser app'en, skal du have en Wiser Gateway.

Rumstyring: For at styre puck'en gennem andre Wiser enheder skal enhederne parres. Wiser enhederne skal være på det samme Zigbee-netværk.

Direkte styring: Puck'en kan styres direkte på stedet med tilsluttede mekaniske betjeningstryk. Du kan maksimalt tilslutte 10 mekaniske betjeningstryk.

Funktioner:

- Tænd / sluk
- Sætte en timer eller tidsindstilling (via app)

Valg af installationslokation

Hvis du placerer puck'en bag et mekanisk betjeningstryk, skal du bruge en dyb installationsboks.

Terminaler

- | | |
|----------------------|-------------------------------|
| (A) Relæ tilslutning | (D) Tilsl. for betjeningstryk |
| (B) Fase | (E) Ikke brugt |
| (C) Nul | |

Montering af puck'en**FARE****FARE FOR ELEKTRISK STØD**

- Sørg for, at terminalerne ikke kommer i kontakt med de metalliske dele på en enhed, der er installeret på samme sted.
- Kortslut ikke udgang til nul.
- Relæet og strømførende forbindelser skal adskilles fra hinanden med 240 V a.c. isolering.

Manglende overholdelse af disse instruktioner vil resultere i død eller alvorlig personskade.

Forbindelse af puck'en**FARE****RISIKO FOR ELEKTRISK STØD, EKSPLOSION ELLER LYSBUE**

- Når du arbejder på enheden, skal du altid afbryde strømforsyningen til enheden, da udgangen kan have elektrisk strøm, selv når belastningen er slukket.
- Afbryd sikringen i det indkommende kredsløb inden installation, vedligeholdelse eller service (eller udskiftning af belastningen) påbegynde på enheden.

Manglende overholdelse af disse instruktioner vil resultere i død eller alvorlig personskade.

Betjeningselementer

- | | |
|----------------------|---------------|
| (F) Status lysdiode | (H) Test knap |
| (G) Setup/Reset knap | |

Indstilling af puck'en**ADVARSEL****FARE FOR ELEKTRISK STØD**

- Overhold reglerne for arbejde på spændende dele.
- Aktiver kun enhedsknapperne ved hjælp af isoleret hjælpedstyr, der opfylder kravene i EN 60900

Manglende overholdelse af disse instruktioner kan føre til død eller alvorlig personskade.

Test af puck'en

Før du forbinder puck'en eller tilslutter mekaniske betjeningstryk, kan du teste de grundlæggende funktioner.

Tilslutning til Wiser Gateway

Tryk 3 korte tryk (<0,5 s) på setup/reset knappen for at oprette forbindelse til et tilgængeligt Zigbee-netværk. Efter en vellykket forbindelse til Wiser Gateway lyser status lysdiode grønt.

Parring til andre Wiser enheder

For at styre produktet i en rumstyringstilstand skal det parres med andre Wiser-enheder inden for det samme Zigbee-netværk.

Yderligere oplysninger findes i systemets brugervejledning.

Reset puck'en

Tryk 3 korte tryk (<0,5 s) setup/reset-knappen, og tryk derefter lang tid på setup/reset-knappen en gang i >10 s og <15 s for at nulstille puck'en til fabriksstilstand.

Alle konfigurationsdata, brugerdata og netværksdata slettes, efter hvilket det gælder:

- Ingen forbindelse til andre enheder eller værelser
- Ingen timerindstillinger

Betjening af puck'en

Du kan fjernstyre puck'en med Wiser app'en.

Betydning af status lysdiode

Se systemvejledning.

Fejlfinding

Se systemvejledning.

Tekniske data

Mærkespænding	220-240 V a.c., 50/60 Hz
Mærkeeffekt	
Mærkestrøm	10 AX
Relæ	1, tør kontakt
Standby	Maksimalt 0,3 W
Driftstemperatur	0 °C til 35 °C
Nulleder	Påkrævet
Forbindelses terminaler	Maks. 2 x 2,5 mm ² , stiv eller flettet ledning
Eksterne tryk	Maks. 10 mekaniske betjeningstryk
Længde af alle kabler	Maks. 50 m for 3-leder NYM kabel
Forsikring	16 A
Kapslingsklasse	IP20
Frekvensområde	2,4 GHz
Maks. Transmitteret effekt	< 2,5 mW
Dimensioner (H x B x D)	43 x 43 x 22 mm
Vægdåse dimensioner	Vægdåsen skal minimum have en dybde på 26 mm.
EU deklaration	1003660-0
Certifikater	Zigbee 3.0

Bortskaf enheden separat fra husholdningsaffald på et godkendt opsamlingssted. Professionel genanvendelse beskytter mennesker og miljø mod potentielle negative effekter.

Varemærker

- Zigbee® er et registreret varemærke tilhørende Zigbee Alliance.
 - Apple® og App Store® er mærkenavne eller registrerede varemærker tilhørende Apple Inc.
 - Google Play™ Store og Android™ er mærkenavne eller registrerede varemærker tilhørende Google Inc.
- Andre mærker og registrerede varemærker tilhører deres relevante ejere.

EU-overensstemmelseserklæring

Schneider Electric Danmark A/S erklærer hermed, at dette produkt er i overensstemmelse med de væsentlige krav og andre relevante bestemmelser i RADIO EQUIPMENT DIRECTIVE 2014/53 / EU. Overensstemmelseserklæringen kan downloades på adressen se.com/docs.

Lauritz Knudsen

Schneider Electric Danmark A/S, Lautrupvang 1, 2750 Ballerup, Telefon: +45 8 30 20 00, www.lk.dk

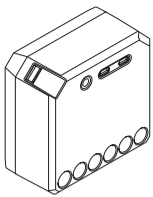

550B1011

Wiser



	2200 W
	2000 W
	500 VA
	1000 VA

	1050 VA
C	10 A, 140 µF
	100 W
	LED 200 W

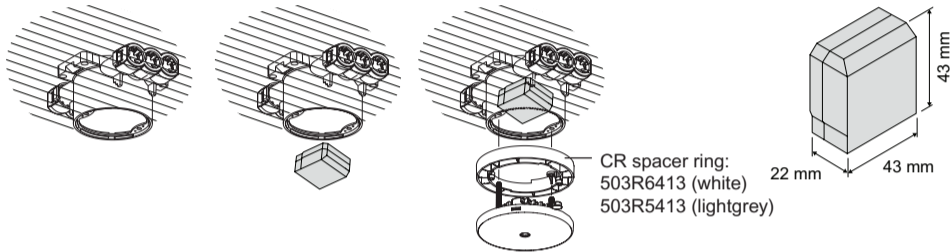

CR spacer ring:
503R6413 (white)
503R5413 (lightgrey)

22 mm 43 mm

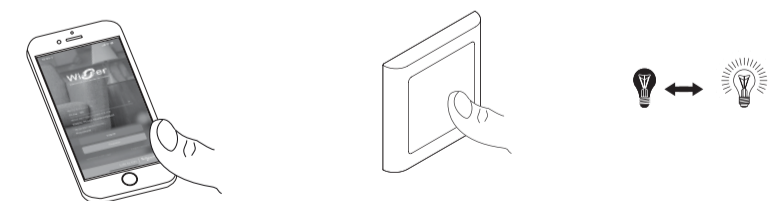
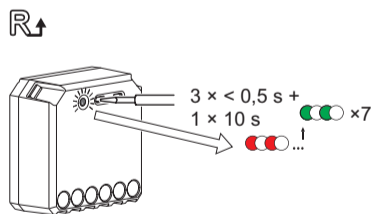
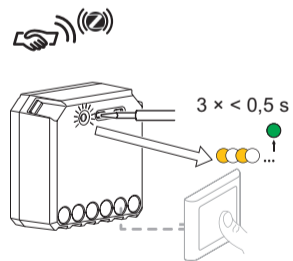
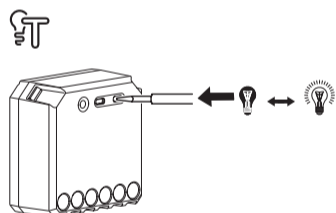
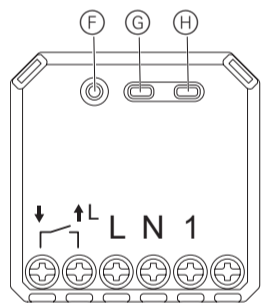
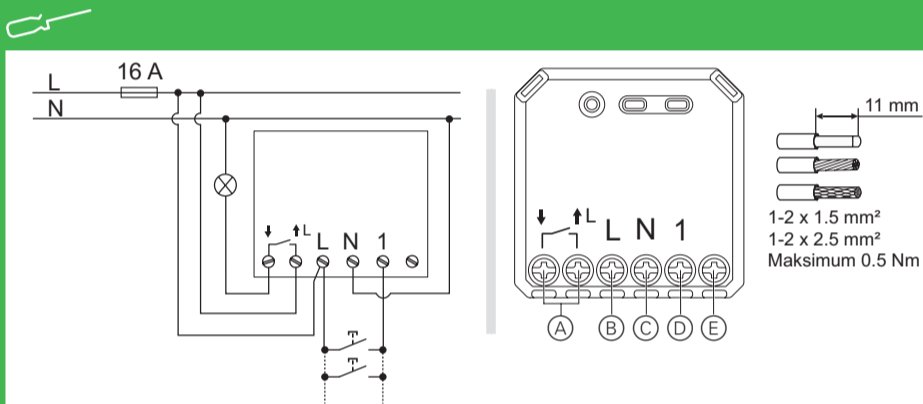

Wiser wireless relay for build in (Puck)

Prerequisites

Download the **Wiser app** to your smartphone / tablet, and install the **Wiser Gateway** to configure and control Wiser devices.

Additional system information

Detailed product information is available online in the **system user guide**: Scan the QR code or follow the link.

<https://www1.lk.dk/wiser>

For your safety

⚠️ DANGER

HAZARD OF ELECTRIC SHOCK, EXPLOSION, OR ARC FLASH

Safe electrical installation must be carried out only by skilled professionals. Skilled professionals must prove profound knowledge in the following areas:

- Connecting to installation networks
- Connecting several electrical devices
- Laying electric cables
- Safety standards, local wiring rules and regulations

Failure to follow these instructions will result in death or serious injury.

Getting to know the product

The Wiser wireless relay for build in (Puck) (hereinafter referred to as **puck**) is used to switch the ohmic, inductive or capacitive loads.

i The puck must not be used to control safety relevant applications.

Control options

Home control: To control the puck in your home through the Wiser app, you will need the Wiser Gateway.

Room control: To control the puck through other Wiser devices, it can be paired. Wiser devices has to be in the same Zigbee network.

Direct operation: The puck can always be controlled directly on-site. To do this, you can connect a maximum of 10 mechanical push-buttons.

Functions:

- Switching
- Setting a timer or a time schedule (via App)

Choosing the installation location

If you place the puck behind a mechanical push-button, use a deep installation box.

Connection elements

- | | |
|-----------------------|----------------------------|
| (A) Switch contact | (D) Extension unit input 1 |
| (B) Live conductor | (E) Unused |
| (C) Neutral conductor | |

Mounting the puck

⚠️ DANGER

HAZARD OF ELECTRIC SHOCK

- Make sure that the terminal connection area does not come in contact with the metallic parts of any device installed in the same location.
- Do not short the outputs to neutral.
- The switch contact and live conductor connection must be separated from one another by a 240 VAC basic insulation.

Failure to follow these instructions will result in death or serious injury.

Connecting the puck

⚠️ DANGER

RISK OF ELECTRIC SHOCK, EXPLOSION OR ARC FLASH

- When working on the device, always disconnect the device from the power supply, as the output may carry electrical current even when the load is switched off.
- Turn off the fuse in the incoming circuit before installation, maintenance, or service (or replacement of the load) of the device.

Failure to follow these instructions will result in death or serious injury.

Operating elements

- (F) Status LED
- (G) Setup/Reset button
- (H) Test button

Setting the puck

⚠️ WARNING

DANGER DUE TO ELECTRIC SHOCK

- Observe the regulations for working on live parts.
- Only actuate the device buttons using insulated auxiliary equipment that meets the requirements of EN 60900

Failure to observe these instructions can lead to death or serious injury.

Testing the puck

Before you couple the puck or connect mechanical push-buttons, you can test the basic functions.

Connecting to the Wiser Gateway

Short press (< 0,5 s) the Setup/Reset button 3 times to connect to the available Zigbee network. Upon successful connection to the Wiser Gateway the status LED turns green.

Pairing to other Wiser devices

To control the product in a room control mode, it can be paired with other LK Smart devices within the same Zigbee network.

For more details, refer to the system user guide.

Resetting the puck

Short press (< 0,5 s) the Setup/Reset button 3 times and then long press the Setup/Reset button once for >10 s and <15 s to reset the puck to factory default mode.

All configuration data, user data, and network data is deleted. After which:

- No connectivity to other devices or rooms
- No timer settings

Operating the puck

You can remotely control the puck through the Wiser app.

Behaviour of the status LED

Refer to the system user guide.

Troubleshooting

Refer to the system user guide.

Technical data

Nominal voltage	AC 220-240 V, 50/60 Hz
Nominal power	
Nominal current	10 AX
Switching channel	1, dry contact
Standby	Maximum 0.3 W
Operating Temperature	0 °C to 35 °C
Neutral conductor	Required
Connecting terminals	Maximum 2 × 2.5 mm ² , solid or stranded types
Extension connection	Maximum 10 mechanical push-buttons
Length of all cable	Maximum 50 m for 3-wire NYM cable
Fuse protection	16 A circuit breaker
IP rating	IP20
Operating frequency	2.4 GHz
Max. radio-frequency power transmitted	< 2.5 mW
Product dimensions (H × W × D)	43 × 43 × 22 mm
Wall box dimension	i The wall box must have a minimum depth of 26 mm.
EU declaration	1003660-0
Certification	Zigbee 3.0

Dispose of the device separately from household waste at an official collection point. Professional recycling protects people and the environment against potential negative effects.

Trademarks

- Zigbee® is a registered trademark of the Zigbee Alliance.
- Apple® and App Store® are brand names or registered trademarks of Apple Inc.
- Google Play™ Store and Android™ are brand names or registered trademarks of Google Inc.

Other brands and registered trademarks are properties of their relevant owners.

EU Declaration of conformity

Hereby, Schneider Electric Danmark A/S, declares that this product is in compliance with the essential requirements and other relevant provisions of RADIO EQUIPMENT DIRECTIVE 2014/53/EU. Declaration of conformity can be downloaded on: se.com/docs.

Lauritz Knudsen

Schneider Electric Danmark A/S, Lautrupvang 1, 2750 Ballerup, Phone.: +45 88 30 20 00, www.lk.dk