



Radio transmitters

Functional and practical for the end user

Yokis boasts a wide range of radio transmitters, in order to offer the user multiple control solutions suitable to each installation requirement.

The Yokis range includes the following types of transmitter: key chain (with 2, 4 and 8 buttons), table-top (with 1 and 4 buttons), wall-mounted (with 1, 2 and 4 buttons), flush-mounted (with 2 or 4 channels) and 50X flush-mounting box with the Simon Urmet line.

The range of transmitters is compatible with all types of Yokis radio receivers: relays, dimmers, shutter modules and gate management modules, and can generate, in addition to direct commands, centralisation commands and scenario activation.

They are easy to install and configure: through the YokisPro App for the installer, but also from the YnO App directly by the end user.



RECESSED TRANSMITTERS



E2BPP	5454413	2-channel transmitter for buttons
E2BPPX	5454414	2-channel transmitter for buttons with external antenna
E4BPP	5454427	4-channel transmitter for buttons
E4BPPX	5454428	4-channel transmitter for buttons with external antenna
ABE2BPP ON/OFF	5454815	Radio device for light remote control
ABE2BPP UP/DOWN	5454816	Radio device for shutter remote control

E2BPP: 2-channel E4BPP: 4 channels

- ▶ **Multifunctional flush-mounted transmitters:** each channel can control any Yokis radio product (lighting, roller shutters, scenarios, etc.).
- ▶ It can be wired behind any commercially available set of electrical panels and can be positioned on the bottom of the flush-mounted box.
- ▶ It can be operated by button, switch or any potential-free contact.
- ▶ Available in a version with an external antenna to divert the signal in the event of an obstacle.
- ▶ Transmitter powered by a standard CR2032 battery (average battery life > 5 years).
- ▶ Free antenna holder supplied with external antenna version.

SMART SWITCHES

- ▶ **Multifunctional 50X transmitters:** each channel can control any Yokis radio product (lighting, roller shutters, scenarios, centralisation, etc.).
- ▶ Powered transmitter (230V).
- ▶ For installation on 50X type pre-settings of the Simon Urmet NEA line.
- ▶ Equipped with two blue LEDs for identification in the dark.
- ▶ Supplied with fitted matt white and optional anthracite button cover inside the package.

WALL-MOUNTED TRANSMITTERS



TLM1T45P	5454417	WLP 1-pushbutton wall-mounted RF switch
TLM2T45P	5454419	WLP 2-pushbutton wall-mounted RF switch
TLM4T45P	5454421	WLP 4-pushbutton wall-mounted RF switch
TLM1T503	5454600	Wall-mounted 1-button radio transmitter
TLM2T503	5454601	Wall-mounted 2-button radio transmitter
TLM4T503	5454602	Wall-mounted 4-button radio transmitter

WALL-MOUNTED CONTROLS

- Based on Simon Urmet Nea Expi white plastic design, compatible with 3-module flush-mounting boxes. Ideal in the case of concealed sliding doors and for integrating the system with new control points, without the need for masonry work, as it can be fixed to a surface with two dowels or with the double-sided adhesive tape provided.
- ▶ Battery powered (CR2032) with an average life of more than 5 years.

The products are supplied complete with support for flush-mounting box 503. They can be installed on flush-mounting box 503 or on any flat surface using double-sided adhesive tape.



RADIO TRANSMITTERS

RADIO FEATURES

- ▶ Radio coverage:
 - inside a house < 100 m²
 - through a load-bearing wall or slab
 - 250 m unobstructed field of view
- ▶ Frequency: 2.4 GHz
- ▶ Transmission: Two-way with notification LED on transmitter

If the LED is not blinking this does not indicate a battery fault, but a failed radio transmission.

- ▶ Batteries: standard, CR2032 lithium type.
- ▶ Useful life of batteries: > 5 years.
- ▶ The batteries are replaced by opening the container with a flat-blade screwdriver. Data are retained.

TECHNICAL FEATURES

Max. receivers per channel	4 in direct connection or unlimited in centralisation
Operating temperature	- 10 °C + 50 °C
Protection	IP54
Relative humidity	maximum 70%
Dimensions (mm)	Antenna Cable length: 250 mm

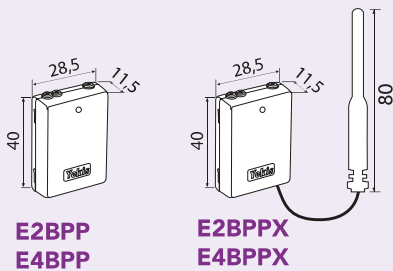

**E2BPP
E4BPP**

**E2BPPX
E4BPPX**

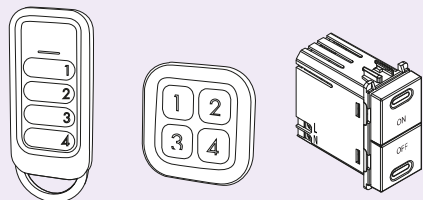

**TLC4TP
TLC1TP
TLC2TP
TLC8TP**

GALET4TP

**ABE2BPP
ON/OFF**

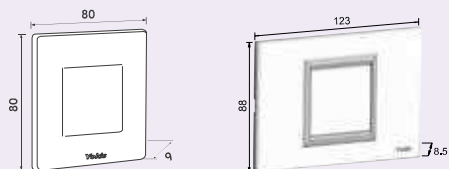

**TLM1T45P
TLM2T45P
TLM4T45P**

**TLM1T503
TLM2T503
TLM4T503**

ITEM NUMBER TABLE

Power Transmitters	Item number	Serial number	P.
2-channel flush-mounted transmitter	E2BPP	5454413	59
2-channel flush-mounted transmitter with external antenna	E2BPPX	5454414	59
4-channel flush-mounted transmitter	E4BPP	5454427	59
4-channel flush-mounted transmitter with external antenna	E4BPPX	5454428	59
1-button radio Design remote control	TLC1TP	5454430	60
2-button radio Design remote control	TLC2TP	5454431	60
4-button radio Design remote control	TLC4TP	5454432	60
8-button radio Design remote control	TLC8TP	5454434	60
4-button radio Design remote control	GALET4TP	5454433	60
Extra flat 1-channel wall-mounted transmitter	TLM1T503	5454600	59
Extra flat 2-channel wall-mounted transmitter	TLM2T503	5454601	59
Extra flat 4-channel wall-mounted transmitter	TLM4T503	5454602	59
Radio device for centralisation of the light	ABE2BPP ON/OFF	5454815	59
Radio device for shutter centralisation	ABE2BPP UP/DOWN	5454816	59

SD 033

WIRING PRINCIPLE OF A FLUSH-MOUNTED TRANSMITTER

On all transmitters, the LED only lights up when the radio transmission is successful.

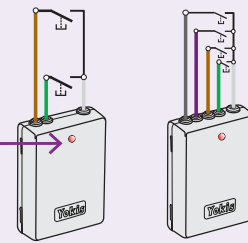

E2BPP(X)

E4BPP(X)

It is not necessary to use all channels, only one channel can be used with a single button.

Switches can be wired instead of buttons if the receivers are radio toggle relay modules.

EASY CONNECTION

Connection of transmitters with Yokis radio receivers (direct connection).

NOTE: The receiver must be powered.

Step 1: [E5]

On the transmitter, quickly touch the pushbutton you wish to connect for 5 times. The transmitter LED will start blinking quickly for 30 seconds, indicating that it is waiting for a connection.

Step 2: [R1]

While the transmitter LED is blinking, insert the tip of a pencil in the "connect" hole on the receiver (located on the back of the casing) and press lightly. If the connection is successful, the receiver LED blinks once and the transmitter LED stops blinking.

- ▶ With the MTR2000ERP(X) and the MTR2000MRP(X), the E2BPP(X) and the E4BPP(X) can be wired behind either a button or a switch (refer to diagram SD18 on page 27):



Warning! Program the transmitter in "instant" mode before connecting it to the switch.

- ▶ Each button can control up to 4 receivers in direct connection.
- ▶ In Radio Bus mode, each button can control an unlimited number of receivers, as long as the receivers are interconnected.
- ▶ It is not possible to use buttons equipped with light indicator.

STANDARDS AND CERTIFICATIONS

