



CoreLine Wall-mounted

WL140V LED20S/830 PSU MDU WH

Power supply unit - Symmetrical - 120° x 120°

CoreLine wall-mounted solutions deliver on the CoreLine promise of innovative, easy-to-install and high quality luminaires. These circular-shaped, surface-mounted luminaires are suitable for both ceiling and wall installations and are easy to apply in circulation areas such as corridors, hallways and staircases. The modern, unobtrusive design, combined with a homogeneous light distribution, ensures this luminaire will blend into the architecture of most buildings. And thanks to the push-in connectors, installation of the CoreLine WL140V is fast and straightforward. This family includes Interact ready luminaires with integrated wireless communications, ready for use with Interact gateways, sensors and software.

Product data

General information			
Beam angle of light source	120 °	Glow-wire test	Temperature 850 °C, duration 30 s
Light source color	830 warm white	Flammability mark	-
Light source replaceable	Yes	CE mark	CE mark
Number of gear units	1 unit	ENEC mark	ENEC mark
Driver/power unit/transformer	Power supply unit	Warranty period	5 years
Driver included	Yes	Constant light output	No
Optic type	Symmetrical	Number of products on MCB of 16 A type B	32
Luminaire light beam spread	120° x 120°	Photobiological risk	Photobiological risk group 0 @200mm to EN62778
Control interface	-	Photobiological risk specification	0.2 m
Connection	Push-in connector 6-pole	EU RoHS compliant	Yes
Cable	-	Unified glare rating CEN	24
Protection class IEC	Safety class II		

CoreLine Wall-mounted

Light technical	
Saturated Red (R9)	<50

Operating and electrical	
Input Voltage	220-240 V
Input Frequency	50 or 60 Hz
Initial CLO power consumption	- W
Average CLO power consumption	- W
Inrush current	14 A
Inrush time	0.007 ms
Power Factor (Min)	0.9

Controls and dimming	
Dimmable	No

Mechanical and housing	
Housing Material	Polycarbonate
Reflector material	Polycarbonate
Optic material	Polycarbonate
Optical cover/lens material	Polycarbonate
Fixation material	-
Optical cover/lens finish	Opal
Overall height	85 mm
Overall diameter	390 mm
Color	White RAL 9003
Dimensions (Height x Width x Depth)	85 x NaN x NaN mm

Approval and application	
Ingress protection code	IP65 [Dust penetration-protected, jet-proof]
Mech. impact protection code	IK10 [20 J vandal-resistant]
Sustainability rating	-

Initial performance (IEC compliant)	
Initial luminous flux (system flux)	1850 lm
Luminous flux tolerance	+/-10%
Initial LED luminaire efficacy	95 lm/W

Init. Corr. Color Temperature	3000 K
Init. Color Rendering Index	>80
Initial chromaticity	(0.4338,0.4030) SDCM <3
Initial input power	19 W
Power consumption tolerance	+/-10%

Over time performance (IEC compliant)	
Control gear failure rate at median useful life 50000 h	5 %
Lumen maintenance at median useful life* 35000 h	-
Lumen maintenance at median useful life* 50000 h	80
Lumen maintenance at median useful life* 75000 h	-
Lumen maintenance at median useful life* 100000 h	-

Application conditions	
Ambient temperature range	-20 to +40 °C
Performance ambient temperature Tq	25 °C
Maximum dim level	Not applicable
Suitable for random switching	No

Product data	
Full product code	871951452877299
Order product name	WL140V LED20S/830 PSU MDU WH
EAN/UPC - Product	8719514528772
Order code	911401847982
Numerator - Quantity Per Pack	1
Numerator - Packs per outer box	6
Material Nr. (12NC)	911401847982
Net Weight (Piece)	1.890 kg



Dimensional drawing

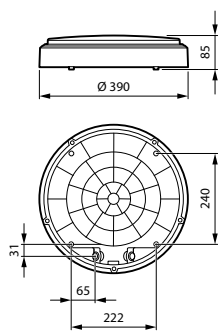

WL140V LED20S/830 PSU MDU WH

CoreLine Wall-mounted

Photometric data

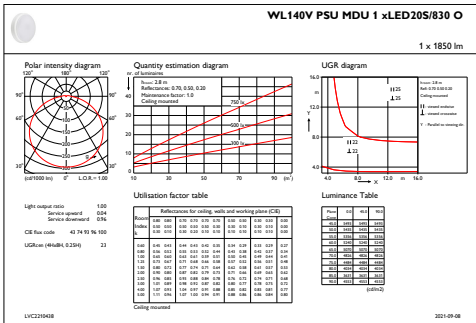

IFGU1_WL140VPSUMDU1xLED20S8300

