

ALASKA V3 IP65 NON-CORROSIVE LUMINAIRE FOR LED TUBES INSTRUCTIONS

Issue 03 on 2nd November 2020

THANK YOU for buying this product. To help ensure it gives complete satisfaction please install it according to these instructions, and then pass the instructions to the appropriate person for retention and future reference.

SAFETY This is a mains powered product. It is designed to be installed by suitably qualified personnel only and in accordance with the applicable building and electrical regulations. Before installation or maintenance the electrical supply to the product must be isolated.



INSTALLATION SUPPORT If installation advice or accessories are required, please contact us at the above address. We will do our best to help. When reporting a suspected fault or seeking installation support, the problem is likely to be resolved most quickly if you have full product details to-hand, as well as details of when and where it was purchased.

CHOICE OF LED TUBE

There are many choices of LED tubes on the market & they require various ways of internal wiring to get the Live & Neutral supplies to the correct point. These luminaires are wired as shown which should cater to most lamps available.

If this does not match how your LED tube needs to be wired, then you will need to adjust internally. This work should be carried out by a suitably qualified person.

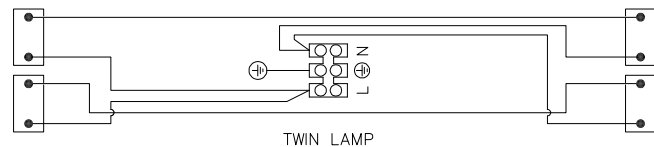
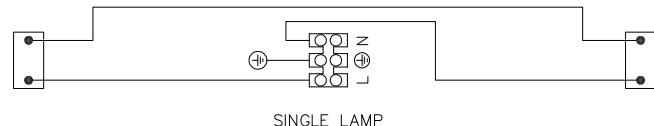

LUMINAIRE INSTALLATION

1. Separate the base from the diffuser.
2. Remove the gear tray from the base by rotating the two retaining clips 90 degrees & then disconnect from the retaining straps via the small snap hooks.
3. It may be necessary to change the internal wiring to suit your choice of LED tube - See section "CHOICE OF LED TUBE" above.
4. Fit the diffuser clips (located in accessories pack) on to the base by snapping into allocated positions. Ensure all clips are fitted.
5. The base is able to be fixed via the following methods; once chosen, prepare the ceiling/mounting points ensuring the fixing surface/mechanism is sufficient to support the luminaire weight & its application –

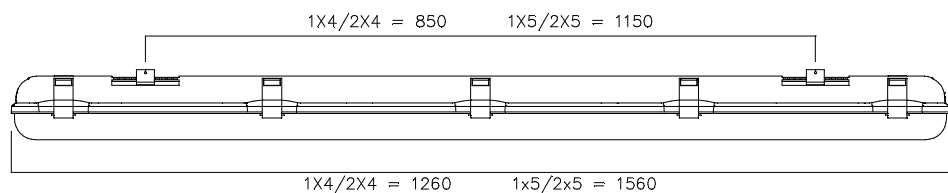
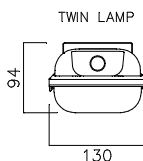
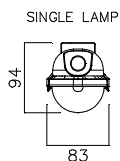

Surface fixing: Mount the two stainless steel, surface mount fixing clips provided to the ceiling at the specified fixing centres (see diagram). Offer the base up to the clips & push to snap fit.

Chain or Wire suspension: Mount the two stainless steel surface mount fixing clips to the base. Then add a V hook (provided in the accessory pack) to each of the surface mount clips. This will provide connection points for chain or wire suspension at the specified fixing centres (see diagram).

6. Route the mains supply cable into the base through one end. Firstly, remove the bung fitted to the pre-drilled hole & fit one of the IP65 cable glands provided in the accessory pack. If through wiring, then repeat at opposite end.
 7. Refit the gear tray on to the retaining straps via the snap hooks.
 8. Route the mains supply cable to the terminal block & terminate, ensuring correct polarity is observed.
- NOTE! THIS LUMINAIRE MUST BE EARTHED.**
9. Fully locate the gear tray into the base by aligning the slots with the clips in the base & rotate the two retaining clips 90 degrees to secure.
 10. Fit lamp(s) by locating into the lampholders at both ends & rotating 90 degrees to secure.
 11. Fit the diffuser by locating onto the base & secure using the snap-fit clips.
 12. Reconnect power supply & check for correct operation.

MAINTENANCE

1. Cleaning should be carried out at regular intervals so as not impair photometric performance or thermal safety of the luminaire.