

Reserve dele/Måltegninger

F1105, F1106, F1107, F1108, F1109, F1111, F1112
Efter August 2003

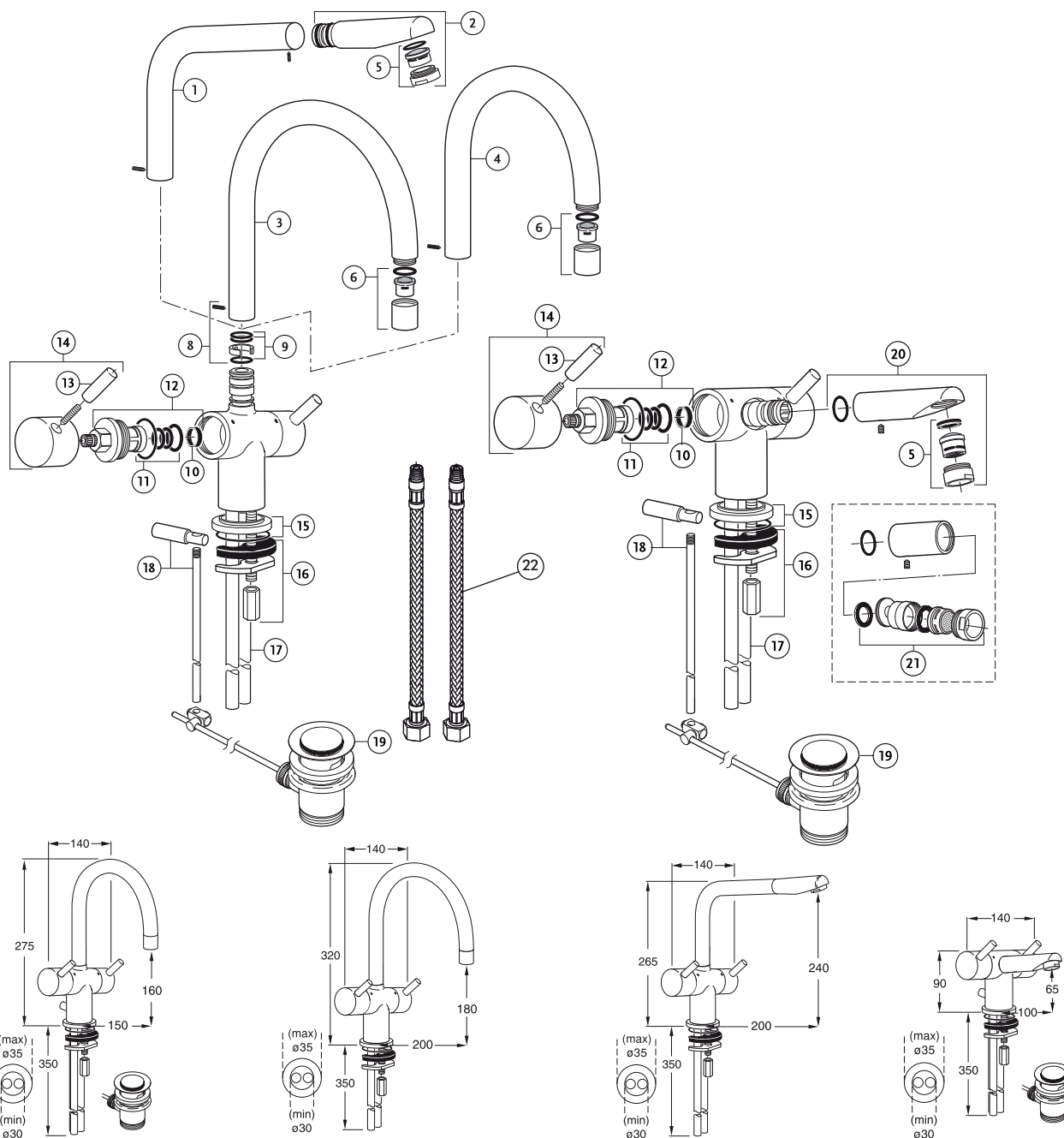

Nr.	Beskrivelse	Varenr.	WS nr.	Nr.	Beskrivelse	Varenr.	WS nr.
1	L-tud med spids 1109 Do. Stainless	F960511AA F960511XJ	745116040 745116047	14	Håndhjul med Børma kold Do. Stainless	F960193AA F960193XJ	745111590 745111597
2	Udløbsspid til 1109 Do. Stainless	F960440AA F960440XJ	745116050 745116057	14	Håndhjul varm Do. Stainless	F960194AA F960194XJ	745111000 745111007
3	C-tud til 1106 Do. Stainless	F960219AA F960219XJ	745116010 745116017	15	Bordring + O-ring Do. Stainless	F960523AA	745111900
4	C-tud til 1112 Do. Stainless	F960220AA F960220XJ	745116000 745116007	16	Bespændingssæt M8	A960304NU	745111900
5	Luftblander 24 mm Do. Stainless	A960321AA F960231AA	745117426 745116750	17	Kobberrør L=386 mm Do. Rå	F960211AA F960211NU	745111390 745111391
6	Luftblander 18 mm Do. Stainless	F960231AA F960231XJ	745116750 745116757	18	Træk-op stang, komplet Do. Stainless	F960191AA F960191XJ	745116920 745116927
8	Reparationssæt t.tud	F960023NU	745115559	19	Bundventil Do. Stainless	H3699AA H3699XJ	747316110 747316117
9	O-ringe	F960183NU	745116310	20	Udløbsspid 1105		
10	Bundpakning	F960016NU	745111621	21	Kugle-luftblander	F960182AA	745115084
11	Rep. sæt 571	F960030NU	745111666	22	Flex slange M10x1-G3/8"	A963305NU	
12	Ventiloverdel varm Ventiloverdel kold	F960035NU F960034NU	745111184 745111185				
13	Pind 25 mm Do. Stainless	F960108AA F960107XJ	745116620 745116647				