



# Lyric™ W1 Wi-Fi Water Leak and Freeze Detector

## INSTALLATION INSTRUCTIONS



Download the Lyric app

To setup and use your new water leak and freeze detector, search for Honeywell Lyric in the App Store or Google Play.



Lyric



### Before you begin

Read these instructions carefully. Failure to follow these instructions can damage the product.

## Need help?

If you need help any point during the installation and setup of the W1 Wi-Fi Water Leak and Freeze Detector, please contact Customer Care:

**Web:** [getconnected.honeywell.com](http://getconnected.honeywell.com)

# Contents

## **Welcome • 1**

## **Parts of your detector • 2**

## **Placement • 3**

- Preparing for installation • 4
- Download and install the app • 4
- Power up the detector • 5
- Pair and name your detector • 6
- Connect to Wi-Fi • 7
- Placement • 8
- Optional cable sensor • 8

## **Configure the detector • 10**

- Select alert recipients • 11

## **App dashboard • 12**

- Temperature/Humidity trend • 12
- Leak detected • 13

## **Using the Lyric app • 15**

- Rename a detector • 15
- Remove a detector • 16

Change alert settings • 17

Add alert recipients • 18

Remove alert recipients • 19

Reset • 20

Status LED • 20

**Maintenance • 21**

**Frequently Asked Questions • 22**

**Regulations • 25**

**Guarantee • 25**

**Specifications • 26**

# Welcome

Congratulations on your purchase of Honeywell's Lyric™ Wi-Fi Water Leak and Freeze Detector. This sensor keeps an eye on your home or business, alerting you at the first sign of water leaks or large changes in temperature or humidity, which can help stop a leak before it becomes a flood, or alert you to conditions that can result in frozen pipes.

## What's in the box?

You should find:

- Honeywell Lyric™ W1 Wi-Fi Water Leak and Freeze Detector
- Three AA alkaline batteries
- Optional cable sensor
- Optional mounting screw

## Download the app

To setup and use your new detector, search for Honeywell Lyric in the App Store or Google Play.



Lyric



After downloading, follow the instructions in the app and skip the install step.

# Parts of your detector



LED indicator

Cable sensor

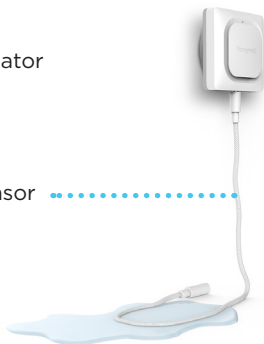

Mounting keyhole (to hang on wall)

Water sensors

Cable sensor jack

Sensor jack plug

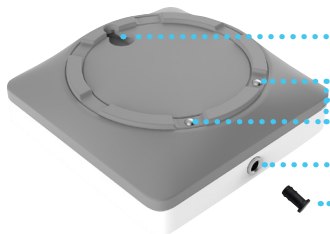

# Placement

The detector and (if used) the optional cable sensor should be placed where leaks are likely to occur. For the most part, this will be on the bottom level of your home or business, near water sources, or anywhere you think leaks are possible.

Locations to consider:

- Floor drain
- Water heater
- Sump pump
- Washing machine
- Kitchen
- Sink
- Toilet



## Preparing for installation

To install this product, you will need:

- The Lyric app
- Bluetooth connectivity turned on for your Android or Apple mobile device
- Your Wi-Fi® password

## Download and install the app

- 1 Go to the App Store or Google Play and search for Honeywell Lyric.** Follow instructions to download and install the free Lyric app.

- 2** After downloading, launch the app, register (if necessary), go to **Menu**, and then go to **Add New Device**.

**Note:** Make sure Bluetooth is enabled on your mobile device.



### Honeywell Lyric app

Download and login to complete the setup.

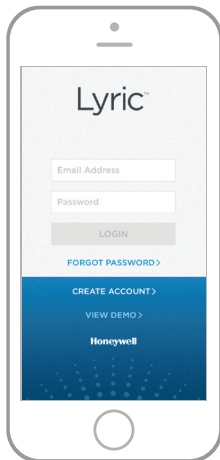



## Power up the detector

It is important to install the app before you install the batteries.

After the batteries are installed, the detector will begin attempting to pair with the app immediately.

If you are installing multiple detectors, the easiest way to do it is to install the batteries in one leak detector at a time.

If you have more than one leak detector attempting to pair with the app, you will see multiple MAC IDs listed in the app. Remove the battery cover and the batteries to see the detector's MAC ID label.

The detector is powered by 3 AA batteries (included). Open the battery cover on the detector and install the batteries.

- 1** Remove the battery cover from the detector.
- 2** Install the 3 AA alkaline batteries (included).
- 3** Replace the battery cover. Press firmly around the edges to ensure a snug fit.

**Note:** The cable sensor jack is NOT for plugging in a power adaptor. Plugging in a power adaptor could damage the detector.

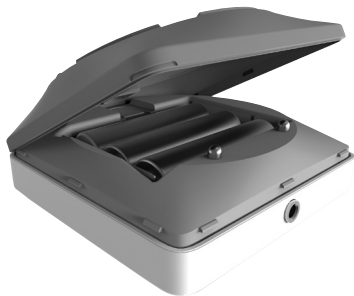

## Pair and name your detector

- 1 Under Add New Device, select **Lyric Water Leak and Freeze Detector**.

**Note:** Make sure Bluetooth is enabled on your mobile device.

- 2 Provide a location for your detector. Press **NEXT**.

- 3 The detector will now pair with the app.

**Note:** If you have more than one detector, you will need to connect each detector individually.

- 4 An audible alert will sound and your detector's LED will turn solid blue to indicate your detector is paired. Press **NEXT**.

- 5 Create a custom name for the detector or select one from the list. Press **NEXT**.

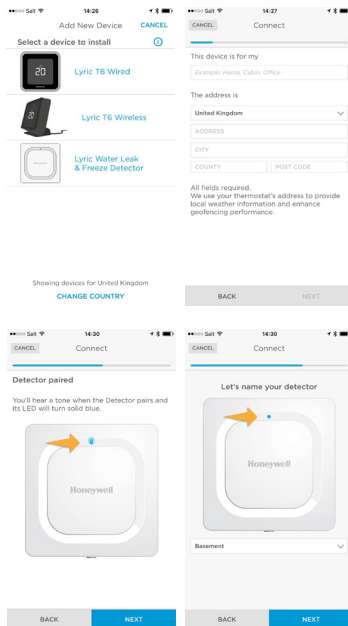

## Connect to Wi-Fi

- 1 Choose your network from the list. Press **NEXT**.
- 2 Enter your Wi-Fi password, if necessary. Press **NEXT**.
- 3 When connected to Wi-Fi, the LED will turn solid green for 5 minutes, **then turn off** to preserve battery life.

**Note:** After you connect the detector to your Wi-Fi network the first time, if you remove and replace the detector's batteries, it will reconnect to your Wi-Fi network automatically.

## Configure

Continue to follow instructions in the app to configure your detector. Set the high and low levels for humidity and temperature warnings, and identify the people you want notified in case of an alarm. These settings can be updated at any time using the app.

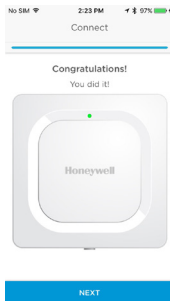
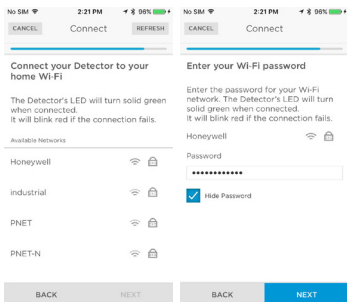

## Placement

The detector can simply be placed on a flat surface or used with the optional cable sensor to hang from a wall or be arranged on the ground. For wall mounting, use the included screw and hang the detector on the mounting keyhole.



If the detector is placed on the floor, be sure the sensors have good contact with the floor. If you expect a large flooding in the area where you install your Lyric W1 water leak detector that could submerge the unit, consider hanging it on the wall (with provided screw and wall plug), and using the included 1.2 m cable sensor for water detection. To cover an even larger area, purchase additional cable sensors to extend your coverage.

## Optional cable sensor

To install the optional cable sensor, remove the sensor jack plug and insert the cable sensor. Insert the sensor jack plug at the end the cable sensor.

Additional cable sensors (sold separately) can be connected to extend the cable and increase water sensing area.

The entire length of cable is an extended sensor. You can hang the detector from the wall or place both the detector and cable sensor on the floor.

**Note:** The cable sensor jack is NOT for plugging in a power adaptor. Plugging in a power adaptor could damage the detector.

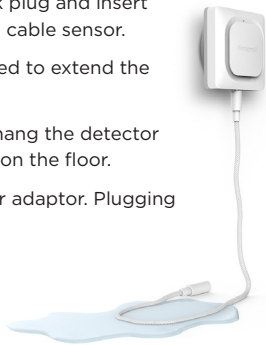

## The detector is connected.

The detector is designed to “sleep” most of the time, only “waking up” when it senses water or indoor temperature or humidity that could be harmful to the building.

Follow instructions in the app to configure your detector. You can set the high and low levels for humidity and temperature warnings, and identify the people you want notified in case of an alarm.

If you remove and replace the detector batteries, the detector will reconnect to your Wi-Fi network automatically when you install new batteries.

## In case of an alert

To preserve battery life, it can **take up to 1 minute for the detector to sense a leak**.

You can mute the detector by pressing the Mute button in the app or removing the batteries or cable sensor from the detector. The mute command may take up to 1 minute to reach the detector.

After you've addressed the cause of the alert, wipe dry the detector and cable sensor and put them back in place. Replace batteries if they were removed.

# Configure the detector

Selections you make here will determine how often the detector will send temperature and humidity readings to the app. They will also determine when and how you receive notifications for temperature or humidity alerts.

No matter what settings you select, you will always be notified of temperature/humidity conditions and water leaks if they occur.

- 1 Select how often you want the detector to send updates to the app. More communications per day reduces battery life.
- 2 Select Fahrenheit or Celsius for temperature displays.
- 3 Select the alert levels you want for temperature or keep the default settings. The detector will notify you of temperatures below the low temperature setting or above the high temperature setting.
- 4 Select the alert levels you want for humidity the same way you selected them for temperature.
- 5 When you are done, press **NEXT**.

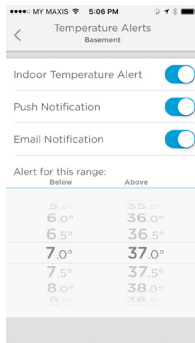
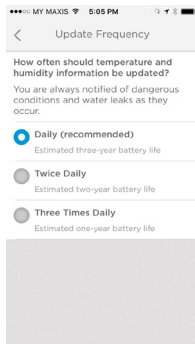
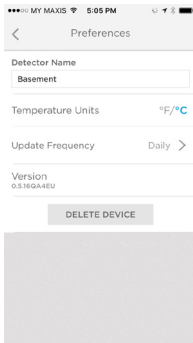
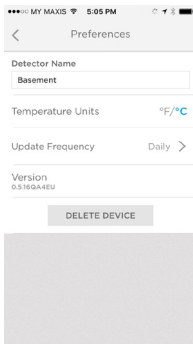

## Select alert recipients

Choose the people you want notified when there is an alert condition. You can choose e-mail, text message, or both.

- 1 Press the text box to add a contact.
- 2 Select the contact from your address book.
- 3 If you want other people to receive alerts, press the **Who else should receive emails?** text box.
- 4 Select the contact from your address book.
- 5 Continue to add contacts until you are done.
- 6 If you want to remove contacts, press the  next to their name.
- 7 Press **Finish**.

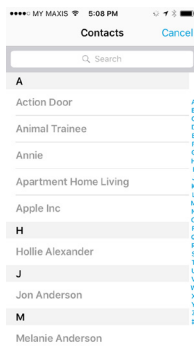
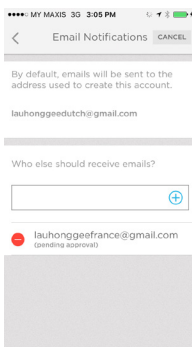
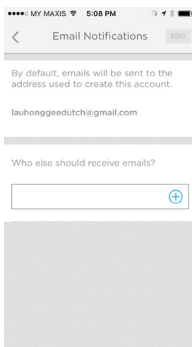

# App dashboard

The app dashboard displays historical information about temperature and humidity readings taken at the detector locations. It displays an alarm screen when a leak is detected.

## Temperature/Humidity trend

Here is an example of the dashboard showing the 30-day trend of temperature and humidity settings. Press **Temperature** or **Humidity** to change from one to the other.

The remaining battery life of the detector is displayed in the bottom-left corner of the screen.

The next scheduled update between the detector and the app is displayed in the bottom-right corner of the screen. To change the schedule see page 10.

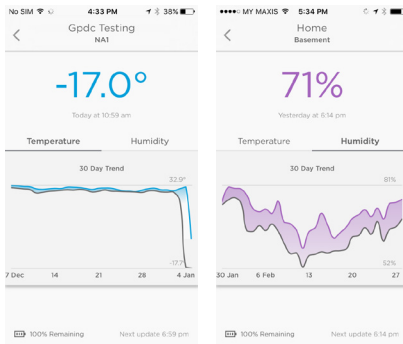



## Leak detected

If a leak is detected, the detector will sound a loud alarm.

### **IMPORTANT**

*It can take up to one minute for the alarm to sound after water is detected.*

You can silence the alarm from the app by pressing the **Mute** button, then start the alarm again by pressing **Unmute**.

### **IMPORTANT**

*It can take up to one minute for Mute or Unmute commands to take effect.*

After you've addressed the cause of the alert, wipe dry the detector and cable sensor and put them back in place.

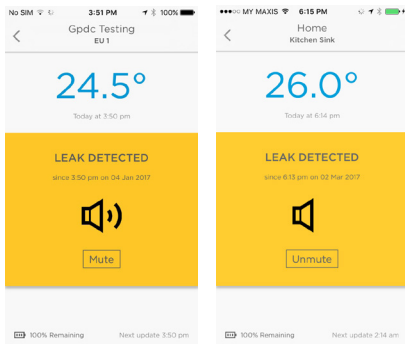

## Other alerts

The app will alert you if temperatures drop below freezing or are otherwise above or below your settings; if humidity is above or below your settings, or if the detector loses internet connection.

Use the app to find out more information about these warnings.

To restore internet connection, use the app or push one end of a paperclip into the detector's reset hole. See "Reset" on page 20.

*Humidity outside of desired range*

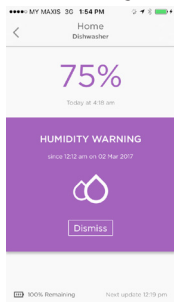

*Low temperature detected by device*

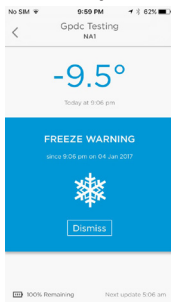

*WiFi connection failure*

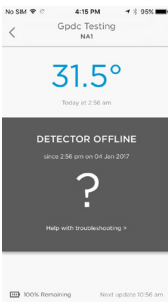

*Alerts and Activity notification center*

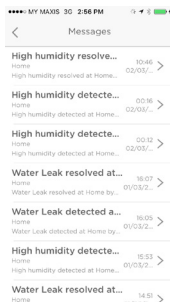

# Using the Lyric app

Using the Lyric app, you have remote connection to your detector.

To see a snapshot of alerts and activity, press the message icon.

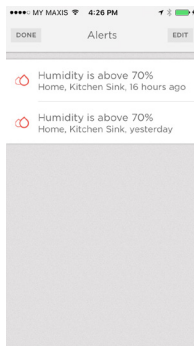
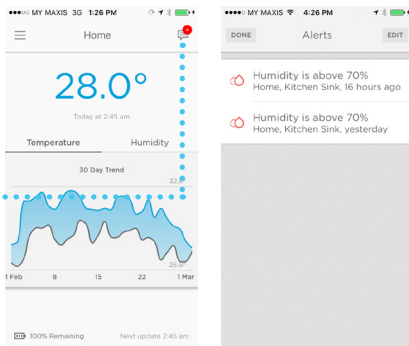

## Rename a detector

You might want to rename your detector if you add other detectors to your network or if you move an detector to a different location. This is simple to do using the app.

- 1 Press the side menu button.
- 2 Press **Leak Detector**.
- 3 Press the current detector name you want to change, type the new name, then press the Back arrow.

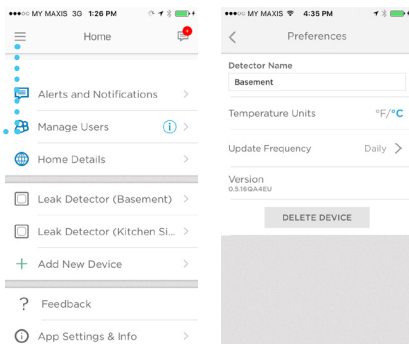

## Remove a detector

If you need to remove a detector from your account, it is easy to do using the app.

- 1 Press the side menu button.
- 2 Press **Leak Detector**.
- 3 Press **DELETE DEVICE**.
- 4 Press **YES** to confirm the deletion or **NO** to cancel it.

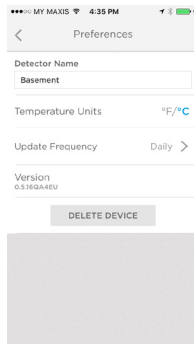
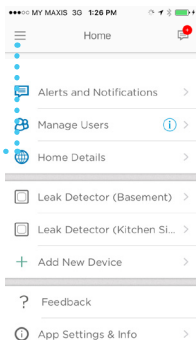

## Change alert settings

You can change how the detector and app handle alerts at any time.

- 1 Press the side menu button.
- 2 Press **Alerts and Notifications**.
- 3 Press **High/Low Temperature** to change temperature alert settings.
- 4 Press **High/Low Humidity** to change humidity alert settings.
- 5 Use the app to set the following:

- Alert - turns temperature or humidity alerts on or off.
- Push Notifications - sends messages from the detector to your mobile device's notification screen.
- Email Notification - determines if an alert will send out an email notification to your recipients.
- Allowable temperature or humidity levels (anything outside this range causes an alert).

- 6 When you are done, press the Back arrow.

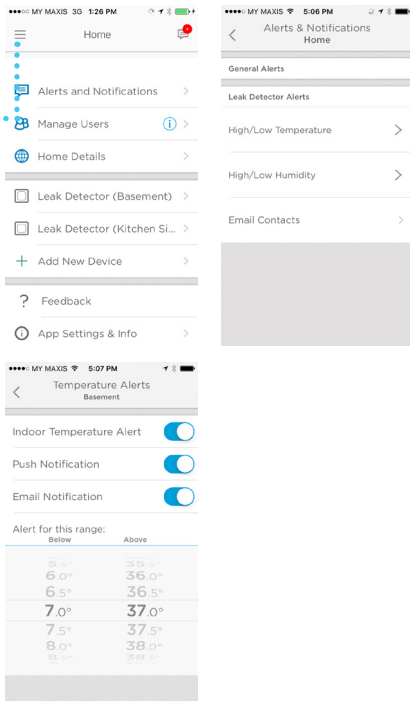

## Add alert recipients

You can change the detector's alert recipients at any time.

- 1 Press the side menu button.
- 2 Press **Alerts and Notifications**.
- 3 Press **Email Contacts**.
- 4 To add recipients, press the text box and add an email address, or press the  button to open your Contacts list and select a recipient.
- 5 When you are done, press the Back arrow.

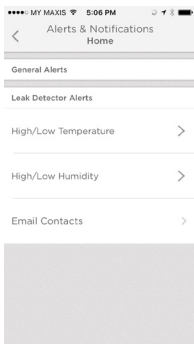
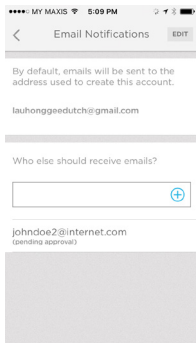
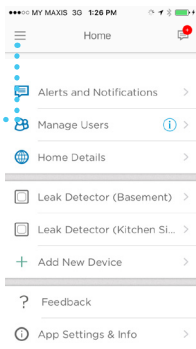

## Remove alert recipients

You can change the detector's alert recipients at any time.

- 1 Press the side menu button.
- 2 Press **Alerts and Notifications**.
- 3 Press **Email Contacts**.
- 4 Press **EDIT**.
- 5 Press the **+** button next to the recipient you want to remove.
- 6 Press **Delete** to confirm.
- 7 If you decide not to delete the recipient, press **CANCEL**.
- 8 When you are done, press the Back arrow.

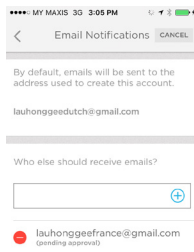
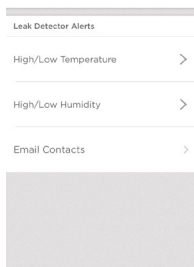
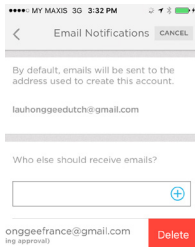
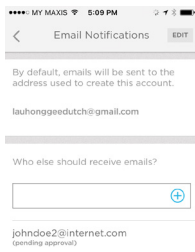
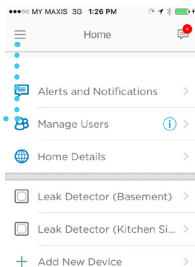

## Reset

Use one end of a paperclip to press and hold into the reset hole for 5 seconds to reset Wi-Fi, detector settings, and to re-start Bluetooth pairing. The LED will blink blue.

Press and hold the paperclip into the reset hole for 15 seconds to restore factory defaults. The LED will blink blue.

## Status LED

The detector has an LED that gives device status.

LED	Detector state
-----	----------------

<b>During installation</b>	
Blinking blue	Powering up and connecting to Bluetooth.
Solid blue	Paired with Bluetooth.
Blinking green	Connecting to Wi-Fi network.
Solid green	Has power, Wi-Fi connection, and is operating normally.
<b>Note:</b> LED turns off after 5 minutes to preserve battery life.	
Solid red	Failed to connect to Wi-Fi.
<b>During operation</b>	
Blinking red	Detected a leak.



## Maintenance

Your detector requires no maintenance and the battery life should be approximately three years if using the correct batteries. Battery life might be shorter due to a number of factors (e.g., extreme cold or heat, multiple cable sensors, alert activity, frequency of status updates).

If you have problems with your detector, consult “Frequently Asked Questions” on page 22.

In case of an alert, address the cause of the alert, then wipe dry the detector and cable sensor and put them back in place. Replace batteries if they were removed to silence the alert.

# Frequently Asked Questions

## **Is there a preferred install height?**

The detector can be on the floor or hang at any height. The length of the supplied cable sensor is 1.2 meters. You can attach additional cable sensors for additional coverage – up to 125 Cable Sensors connected for 150 meters. Water can touch any part of the cable for the alarm to sound.

## **How do I locate the MAC ID on the detector?**

MAC IDs are printed in the detector's battery compartment. Repeat the installation steps for each detector individually.

## **Why can't I see my Home Wi-Fi in the Lyric apps?**

Make sure the 2.4 GHz band of your n/ac type Wifi Router is switched ON.

## **I just poured some water on the cable sensor, but I don't hear the detector buzzing right away. Is something wrong with my detector?**

It can take up to one minute for the alarm to sound after water is detected.

## **OK, I waited one minute and nothing happened. Is something wrong with my detector?**

Make sure the batteries are inserted correctly. If that does not correct the issue then put in new batteries. If the issue is not corrected contact the Honeywell helpline number that is available at [getconnected.honeywell.com](http://getconnected.honeywell.com).

## **Is the entire length of the cable sensor able to detect water?**

Yes, the entire 1.2 meter cable sensor detects water. Additional cable sensors can be added for a maximum sensing distance of up to 150 meters. The cable sensors need to be connected to each other, please make sure that each cable is installed correctly. You may test each cable sensor section by inserting each cable sensor section into the water leak detector separately and by pouring water on the applicable cable sensor section to test. If the cable sensor does not trigger the buzzer alarm after pouring water on the cable sensor, please contact the Honeywell helpline number that is available at [getconnected.honeywell.com](http://getconnected.honeywell.com).

**What type of alerts and notifications can I receive? (Note that you will only receive alerts and notifications that you've set up and enabled.)**

1. Water: When the water leak detector or cable sensor detects water
  - A. 100dB A buzzer alarm will sound at device
  - B. Red LED flashes at device
  - C. Push notification is sent to your mobile device
  - D. Email notification is sent to the email address connected to your Lyric app
  - E. Email notification is sent to other email recipients set up in your Lyric app
2. Temp and Humidity: When your temperature and humidity is outside the default or custom settings in your Lyric app
  - A. Push notification is sent to your mobile device
  - B. Email notification is sent to the email address connected to your Lyric app
  - C. Email notification is sent to other email recipients setup in your Lyric app
3. When the device goes offline:
  - A. Push notification is sent to your mobile device
  - B. Email notification is sent to the email address connected to your Lyric app
  - C. Email notification is sent to other email recipients set up in your Lyric app
4. Low Battery Level:
  - A. Push notification is sent to your mobile device
  - B. Email notification is sent to the email address connected to your Lyric app that your battery is running low
  - C. Email notification is sent to other email recipients set up in your Lyric app that your battery is running low
  - D. The detector starts beeping once every minute after reaching roughly 5% levels to remind you to replace batteries.
5. When any of the above alerts (water leak, temperature, humidity, battery levels, offline) are resolved:
  - A. Push notification is sent to your mobile device that the issue is resolved
  - B. Email notification is sent to the email address connected to your Lyric app that the issue is resolved
  - C. Email notification is sent to other email recipients set up in your Lyric app that the issue is resolved

**How will I know when the batteries need to be replaced?**

You should receive in-app, push and/or email notifications, depending on your settings, when the battery level reaches approximate values of 25% remaining (just a warning), 10% remaining (urgent), and 5% (critical), you will receive an in-app, push and/or email notification, depending on your settings. The detector starts beeping once every minute after reaching roughly 5% levels to remind you to replace batteries.

**How does the detector sense freeze conditions and send notifications?**

The detector has a built-in temperature sensor that senses temperature every hour. If the temperature goes below the set thresholds, you should be notified through in-app, push and/or email notifications, depending on your settings.

**What are the temperature and humidity defaults? Can I change them?**

The default thresholds for temperature are pre-set at 45° F or 7° C and at 100° F or 38° C and you may change the settings in the Lyric app. The default thresholds for humidity are pre-set at 20% and at 70% and you may change the settings in the Lyric app.

**How would I know if my detector is offline?**

If the detector misses a particular update, you will receive a notification that the detector is offline.

**Can each detector have a different list of email members?**

No. Added email accounts will receive notifications from all devices connected to the account.

**How far can the detector be from the router?**

The range of distance of the Wi-Fi signal is determined by your router. Check your router's manual for additional information.

### **Will the detector work without Wi-Fi?**

Yes, the detector will sound a 100dB alarm when the detector senses water (through the built-in sensors or through the cable sensor). However, you will not receive in-app, push, and/or email notifications without a Wi-Fi connection.

If you need further assistance, please contact customer care for help:

**Web:** [getconnected.honeywell.com](http://getconnected.honeywell.com)

## **Regulations**

### **Disposal and recycling**

The product is classified by the Waste Electrical or Electronic Equipment (WEEE) directive. Batteries (if used) and waste electrical products should not be disposed of with other household or commercial waste. At the end of its useful life, the packaging and the product should be disposed of via a suitable recycling centre. For information on available facilities, please contact your local authority or retailer from where the product was purchased.

### **EC declaration of conformity**

Novar ED&S hereby declares that the product is in compliance with the essential requirements and other relevant provisions of the Radio Equipment Directive (RED) 2014/53/EU

## **Guarantee**

Novar ED&S undertakes to replace or repair at its discretion goods, should they become defective within 2 years solely as a result of faulty materials and workmanship. Understandably, if the product has not been installed, operated or maintained in accordance with the instructions, if the product has not been used appropriately or if any attempt has been made to rectify, dismantle or alter the product in any way, the guarantee will be invalidated. The guarantee states Novar ED&S entire liability. The guarantee does not extend to cover consequential loss or damage or installation costs arising from the defective product. The guarantee does not in any way affect the statutory or other rights of a consumer and applies to products installed within the EU only. If an item develops a fault, the product must be returned to the point of sale with: 1. Proof of purchase. 2. Full description of the fault. 3. All relevant batteries (disconnected).

# Specifications

**Battery:** 3 AA Alkaline (included)

**Dimensions:** 78 mm square x 32 mm thick

**Weight:** 0.33 lbs (150g)

**Ingress Protection Rating:** IP44

**Buzzer Alarm:** 100 dBA

**Water Sensing Rate:** 1 time per minute

**Temperature/Humidity Sensing Rate:** 1 time per hour

**Temperature Sensing:** 0-60° C

**Humidity Sensing:** 0-100% RH

**Temperature Alert Detection:** below 7° C or above 38° C are default settings; can be changed by user

**Humidity Alert Detection:** below 20% RH or above 70% RH are default settings; can be changed by user

**Optional Cable Sensor Length:** 1.2 m

**Wi-Fi Router Requirement:** IEEE 802.11 b/g capable routers, 2.4 GHz

**Regulatory:** CE marked

# Important Safety Information

- 1 No naked flame sources, such as lighted candles, should be placed on the product.
- 2 The product should not be covered by table cloths, curtains, etc.
- 3 The product shall not be exposed to dripping or splashing and that no objects filled with liquids, such as vases, shall be placed on the product.
- 4 The MAINS plug being used to disconnect the product, ensure that the product shall remain readily accessible (mains product only).

**CAUTION:** Risk of Electric Shock - Do Not Open - No User serviceable parts inside.

- 5 Product shall not be exposed to excessive heat such as sunshine, fire or the like.
- 6 Batteries shall not be exposed to excessive heat such as sunshine, fire or the like (Push and Battery product only).

**CAUTION:** Danger of explosion if battery is incorrectly replaced. Replace only with same or equivalent battery.

- 7 For Battery disposal see instructions in Manual.

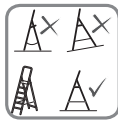
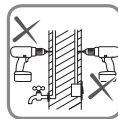

# Honeywell

## Lyric™ W1 Wi-Fi Water Leak and Freeze Detector

*Wi-Fi® is a registered trademark of Wi-Fi Alliance®*

### **Honeywell Novar ED&S**

The Arnold Centre,  
Paycocke Road,  
Basildon, Essex, SS14 3EA  
United Kingdom

[getconnected.honeywell.com](http://getconnected.honeywell.com)



© Honeywell 2017  
32325587—001 Rev.A