

**cometo**

WIRE AND CABLE EQUIPMENT

**ALIMENTATORE**

**FEEDER  
VORSCHUBEINHEIT**



**AL**



MAGGIO 2019





**AL6/AL12 PNEUMATICO**  
**AL6/AL12 PNEUMATIC**  
**AL6/AL12 PNEUMATISCH**

**AL6/AL12 IDRAULICO**  
**AL6/AL12 HYDRAULIC**  
**AL6/AL12 HYDRAULISCH**



**AL6/AL12 VITE**  
**AL6/AL12 SCREW**  
**AL6/AL12 SCHRAUBE**



**AL6/AL12 ECCENTRICO**  
**AL6/AL12 CAM**  
**AL6/AL12 ÜBER NOCKER**



Pressione ad eccentrico codice -E-  
 Cam pressure code -E-  
 Anpressdruck Ueber Nocken Kode -E-

Pressione pneumatica codice -PN-  
 Pressione idraulica codice -H-  
 Pneumatic pressure code -PN-  
 Hydraulic pressure code -H-  
 Anpressdruck Pneumatisch Kode -PN-  
 Anpressdruck Hydraulisch -H-

Pressione a vite codice -V-  
 Screw pressure code -V-  
 Anpressdruck Ueber Schraube Kode -V-

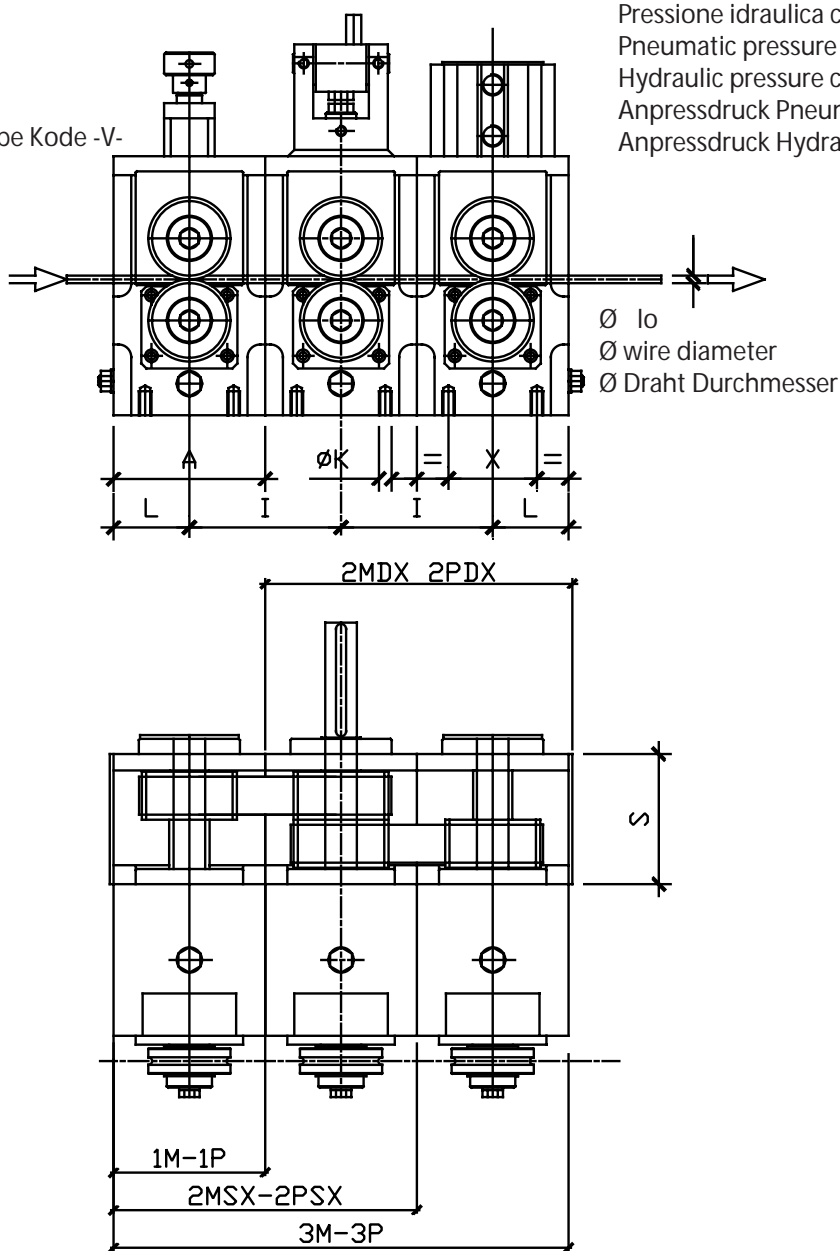

TIPO/TYP/TYPE	A	B	C	Ø D	Ø D2	E	E1	F
AL6	120	120	73	25	25	60	80	30
AL12	170	170	104	40	35	85	115,5	48,5

TIPO/TYP/TYPE	G	H	H1	H2	I	L	M
AL6	21	107,5	75	205	120	60	50
AL12	34	180	119	349	170	85	80

TIPO/TYP/TYPE	N	P	Q	Ø R	R1	S	T
AL6	M8	50	37	65	24	103	(85)
AL12	M10	85	70	122	38	130	(190)

TIPO/TYP/TYPE	V	X	Y	Ø K	Ø filo
AL6	(85)	70	100	M10	1 ÷ 7
AL12	(190)	100	130	M14	6 ÷ 15

# 1 P

1 MODULO CON PREDISPOSIZIONE PULEGGIA  
1 MODULE SUITABLE FOR PULLEY ASSEMBLY  
1 MODUL AUSGESTATTET MIT ANTRIEBSSCHEIBE

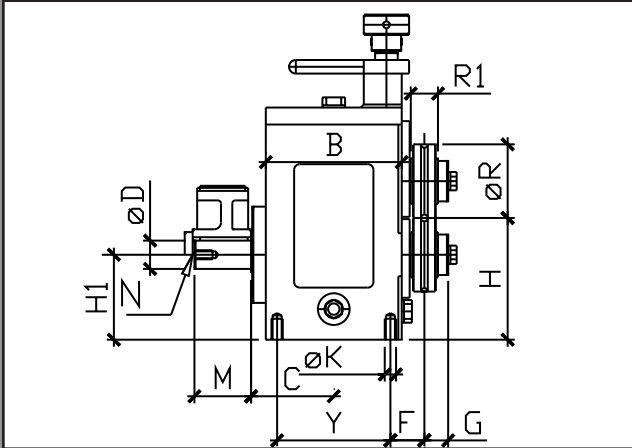

# 1 M

1 MODULO CON PREDISPOSIZIONE RIDUTTORE (A o W)  
1 MODULE SUITABLE FOR REDUCTION-GEAR (A or W)  
1 MODUL AUSGESTATTET MIT VERMINDERER (A oder W)

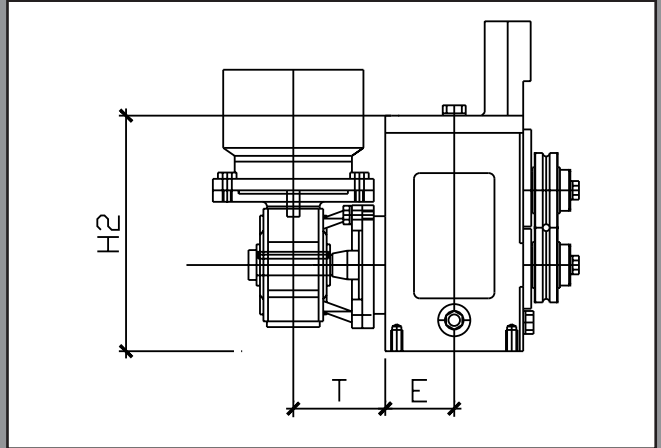

# 2 P

2 MODULI CON PREDISPOSIZIONE PULEGGIA  
2 MODULES SUITABLE FOR PULLEY ASSEMBLY  
2 MODULE AUSGESTATTET MIT ANTRIEBSSCHEIBE

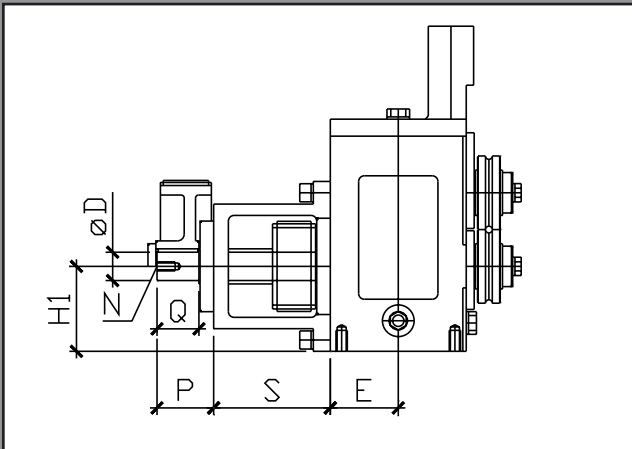

# 2 M

2 MODULI CON PREDISPOSIZIONE RIDUTTORE (A o W)  
2 MODULES SUITABLE FOR REDUCTION-GEAR (A or W)  
2 MODULE AUSGESTATTET MIT VERMINDERER (a oder W)

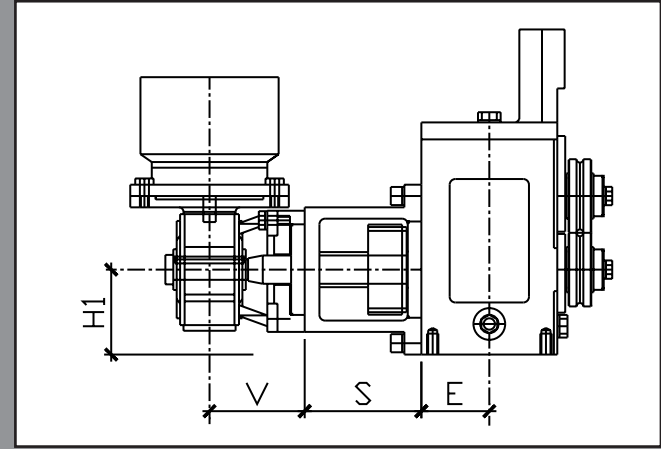

# 3 P

3 MODULI CON PREDISPOSIZIONE PULEGGIA  
3 MODULES SUITABLE FOR PULLEY ASSEMBLY  
3 MODULE AUSGESTATTET MIT ANTRIEBSSCHEIBE

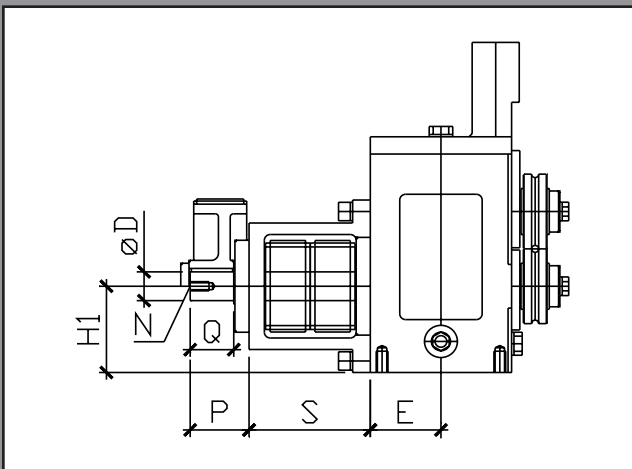

# 3 M

3 MODULI CON PREDISPOSIZIONE RIDUTTORE (A o W)  
3 MODULES SUITABLE FOR REDUCTION-GEAR (A or W)  
3 MODULE AUSGESTATTET MIT VERMINDERER (A oder W)

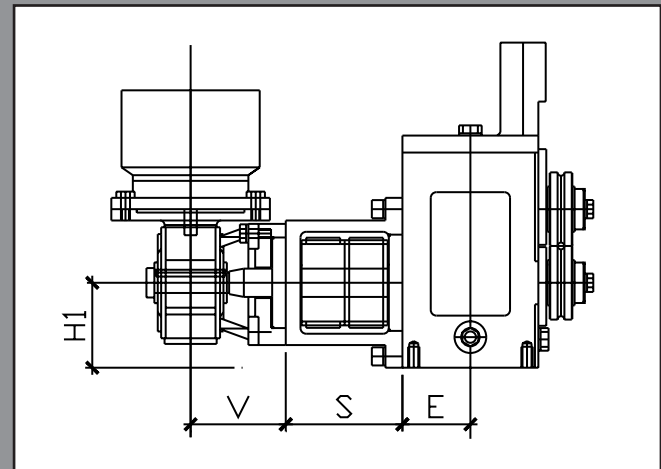



## ALIMENTATORE AL6/AL12

L'alimentatore Cometo modello AL6/AL12 è adatto sia a filo tondo che a piattine e materiali con qualsiasi altra forma.

Studiato per coprire un'ampia gamma di diametri fino a 20mm, l'alimentatore è prodotto in due grandezze, AL6 con rulli diametro 65mm, e AL12 con rulli diametro 122mm.

La costruzione modulare lo rende disponibile con 2, 4 o 6 rulli.

Il sistema di spinta del rullo superiore mobile è invece disponibile in versione a vite, eccentrico, pneumatico e oleodinamico.

## AL6/AL12 FEEDER

Cometo feeder suitable for both round or profiled wire and metal strip.

Available for wire diameter from 1 to 20 mm, and with various power options to suit (screw, cam, hydraulic, pneumatic); these units will satisfy the most demanding customer requirements.

AL6 model with rollers diameter 65mm and AL12 with 122mm rollers diameter.

This feeder have been specifically designed to require the minimum space for assembling, giving the maximum versatility.

## VORSCHUBEINHEIT AL6/AL12

Gerät zum reibschlüssiger Bewegen von Drähten, Bändern, Profilen, Rohren, Stangen und anderen strangförmigen Gütern durch zwei angetriebene Transportrollen.

Der Antrieb der Transportrollen erfolgt entweder durch Riementrieb von einer kooperierenden Basismaschine aus oder durch einen separaten Antrieb.

Der Abmessungsbereich der Produkte liegt zwischen 1 und 200mm.

Das Anpressen der Transportrollen erfolgt entweder manuell mittels Gewindespindel oder mittels Exzenternocken oder aber durch pneumatik-oder Hydraulikzylinder.

ESEMPIO COMPOSIZIONE ORDINE  
ORDER COMPOSITION EXAMPLE  
BESTELLUNGSZUSAMMENSETZUNGSBEISPIEL

MODEL	MODULES N.	ENGINE CONFIGURATION	PRESSURE ON ROLLERS
AL 6	1	M	E
	2	(A or W to be indicated) DX or SX	H
AL 12	3		PN PNT

MAGGIO 2019

M: riduttore / reduction-gear / verminderer

(scegliere modello A o W / choose model A or W / wählen Sie Modell A oder W)

P: puleggia / pulley / antriebsscheibe

E: eccentrico / cam / ueber nocken

H: idraulico / hydraulic / hydraulisch

PN: pneumatico / pneumatic / pneumatisch

PNT: pneumatico tandem / pneumaic tandem / pneumatisch tandem