

A DENOTES RAD R 0.50  
B DENOTES RAD R 0.50  
C DENOTES RAD R 1.00  
D DENOTES RAD R 1.50

A4 ORIGINAL

4

5

6

Remove Watermark Now

## H42

### PROPERTIES

EST AREA  
**3429.4 mm<sup>2</sup>**  
EST WEIGHT  
**9.259 kg/M**  
EXT PERIPHERY  
**1565.9 mm**  
TOT PERIPHERY  
**1565.9 mm**

### FINISH

MILL   
P/COAT   
ANODISED   
OTHER - SPECIFY

### MECHANICAL

I VALUES  
I<sub>xx</sub>  
**6.138x10<sup>5</sup> mm<sup>4</sup>**  
I<sub>yy</sub>  
**8.4145x10<sup>6</sup> mm<sup>4</sup>**



CENTROID  
X AXIS  
(A) 75.00 mm  
(B) 75.00 mm  
Y AXIS  
(C) 17.10 mm  
(D) 30.90 mm

TOLERANCES  
SHALL BE TO  
BS1474 : 1987  
UNLESS SPECIFIED  
OTHERWISE

ALLOY TEMPER  
6060 T5

SCALE  
2:1, 1:1  
DATE  
24.06.04  
REFERENCE  
H42  
REV  
B

A4

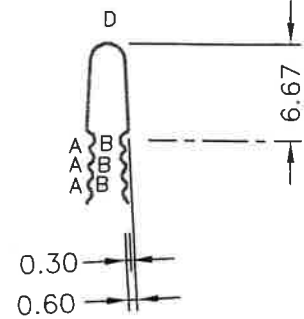
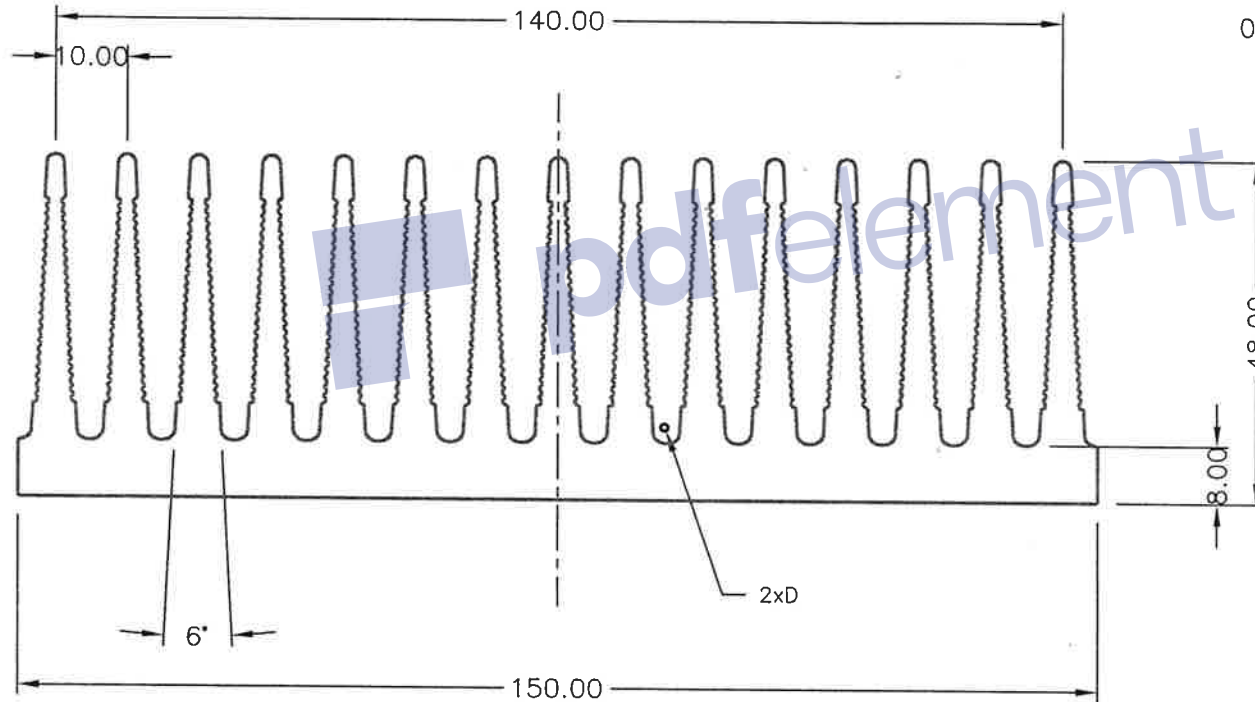

A APPROVED FOR MANUFACTURE

MRR 02.08.04

CUSTOMER

B MOD TO FINS

MRR 28.08.04

FASTRON TECHNOLOGIES

REV DESCRIPTION

DRAWN DATE

APPLICATION

ALL DIMENSIONS IN mm  
VISIBLE SURFACES DENOTED

UNSPECIFIED WALL mm  
INTERNAL RADII mm  
EXTERNAL RADII 0.30 mm

HEATSINK

0.9 Deg C per Watt @75mm

DRAWN MRR

SCALE 2:1, 1:1

DATE 24.06.04

REFERENCE H42

REV B