

SKKD 81, SKKE 81



SEMIPACK[®] 1

| V_{RSM} V | V_{RRM} V | $I_{FRMS} = 140$ A (maximum value for continuous operation) $I_{FAV} = 80$ A (sin. 180; $T_c = 87$ °C) | |
|----------------|----------------|---|--------------|
| 500 | 400 | SKKE 81/04 | SKKD 81/04 |
| 700 | 600 | SKKE 81/06 | SKKD 81/06 |
| 900 | 800 | SKKE 81/08 | SKKD 81/08 |
| 1300 | 1200 | SKKE 81/12 | SKKD 81/12 |
| 1500 | 1400 | SKKE 81/14 | SKKD 81/14 |
| 1700 | 1600 | SKKE 81/16 | SKKD 81/16 |
| 1900 | 1800 | SKKE 81/18 | SKKD 81/18 |
| 2100 | 2000 | SKKE 81/20H4 | SKKD 81/20H4 |
| 2300 | 2200 | SKKE 81/22H4 | SKKD 81/22H4 |

Rectifier Diode Modules

SKKD 81

SKKE 81

Features

- Heat transfer through aluminium oxide ceramic isolated metal baseplate
- Hard soldered joints for high reliability
- UL recognized, file no. E 63 532

Typical Applications

- Non-controllable rectifiers for AC/AC converters
- Line rectifiers for transistorized AC motor controllers
- Field supply for DC motors
- Free-wheeling diodes

1) SKKD types only

| Symbol | Conditions | Values | Units |
|---------------|--|----------------|------------------|
| I_{FAV} | sin. 180; $T_c = 85$ (100) °C | 82 (57) | A |
| I_D | P3/120; $T_a = 45$ °C; B2 / B6 | 63 / 70 | A |
| | P3/180F; $T_a = 35$ °C; B2 / B6 | 135 / 175 | A |
| I_{FSM} | $T_{vj} = 25$ °C; 10 ms | 2000 | A |
| | $T_{vj} = 125$ °C; 10 ms | 1750 | A |
| i^2t | $T_{vj} = 25$ °C; 8,3 ... 10 ms | 20000 | A ² s |
| | $T_{vj} = 125$ °C; 8,3 ... 10 ms | 15000 | A ² s |
| V_F | $T_{vj} = 25$ °C; $I_F = 300$ A | max. 1,55 | V |
| $V_{(TO)}$ | $T_{vj} = 125$ °C | max. 0,85 | V |
| r_T | $T_{vj} = 125$ °C | max. 1,8 | mΩ |
| I_{RD} | $T_{vj} = 125$ °C; $V_{RD} = V_{RRM}$ | max. 4,5 | mA |
| $R_{th(j-c)}$ | per diode / per module ¹⁾ | 0,4 / 0,2 | K/W |
| $R_{th(c-s)}$ | per diode / per module ¹⁾ | 0,2 / 0,1 | K/W |
| T_{vj} | | - 40 ... + 125 | °C |
| T_{stg} | | - 40 ... + 125 | °C |
| V_{isol} | a. c. 50 Hz; r.m.s.; 1 s / 1 min. | 3600 / 3000 | V~ |
| V_{isol} | a. c. 50 Hz; r.m.s.; 1 s / 1 min. for SKK...H4 | 4800 / 4000 | V~ |
| M_s | to heatsink | 5 ± 15 % | Nm |
| M_t | to terminals | 3 ± 15 % | Nm |
| a | | 5 * 9,81 | m/s ² |
| m | approx. | 95 | g |
| Case | SKKD | A 10 | |
| | SKKE | A 12 | |

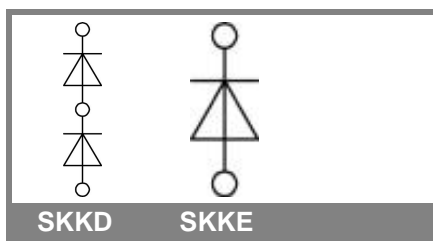

SKKD 81, SKKE 81

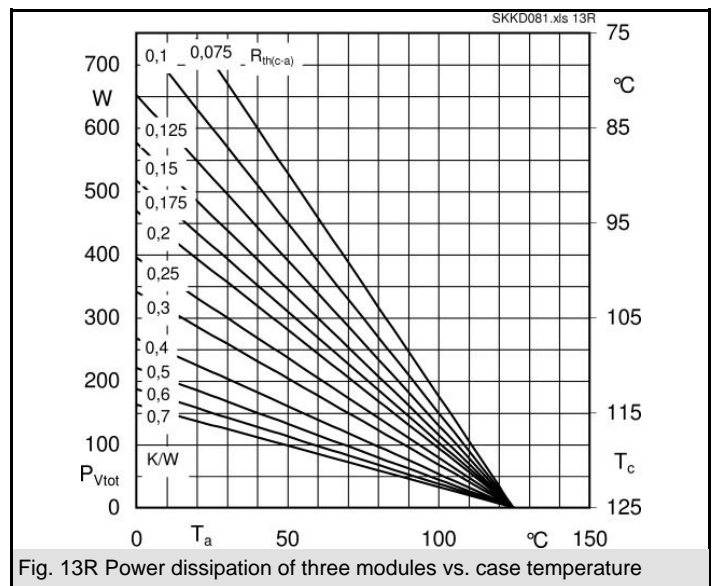
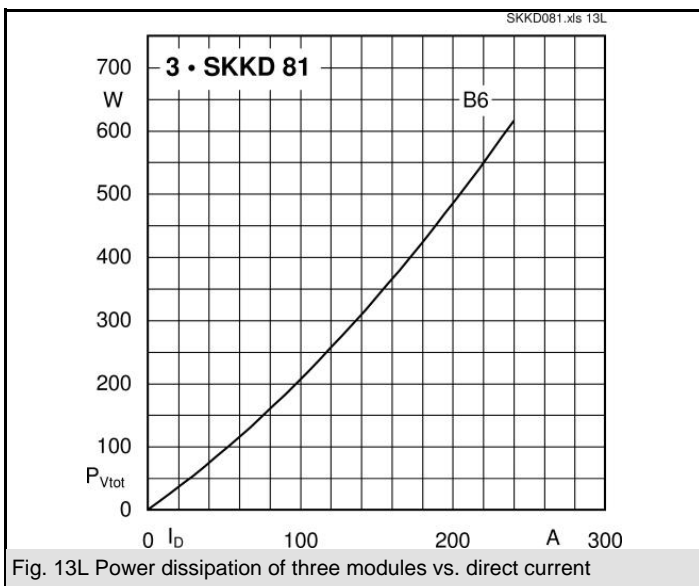
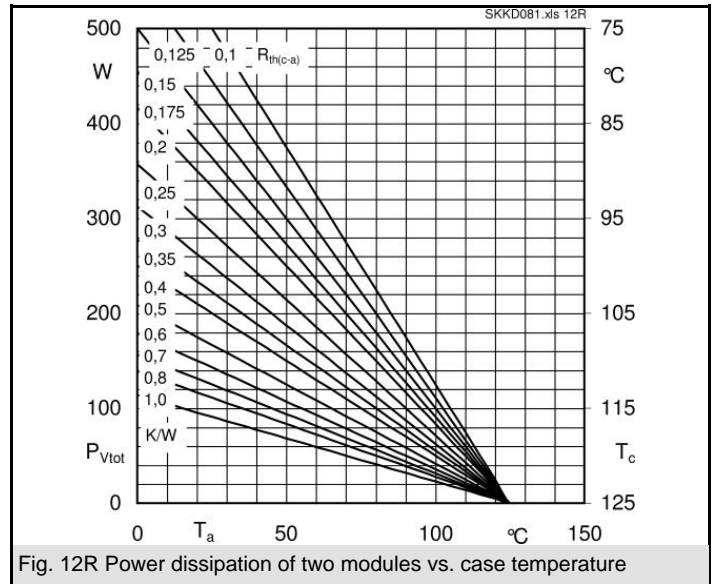
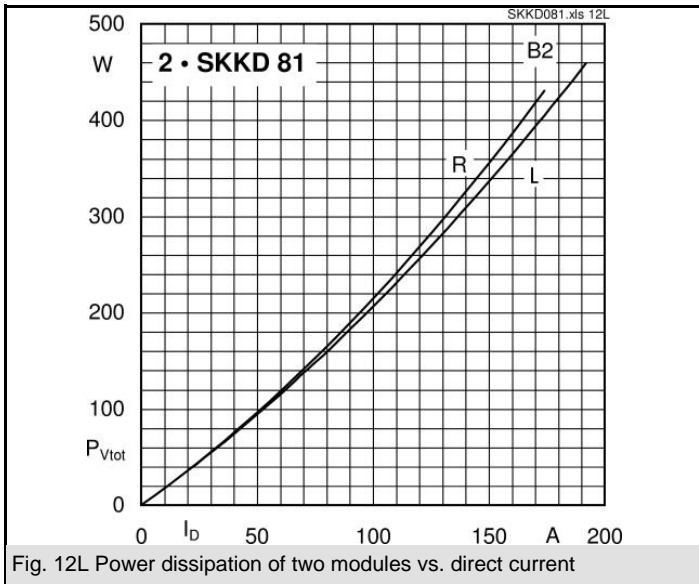
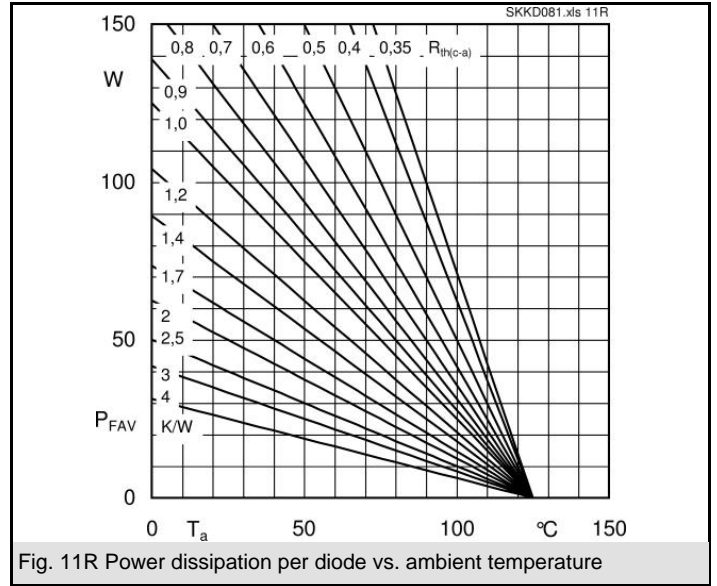
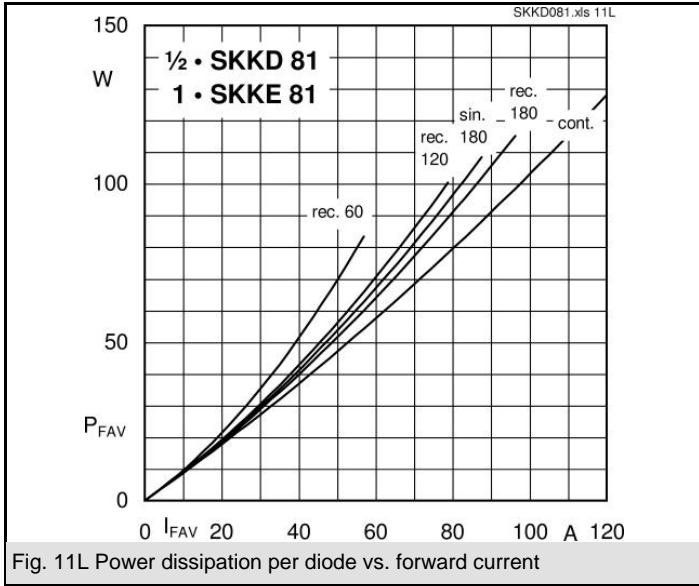

SKKD 81, SKKE 81

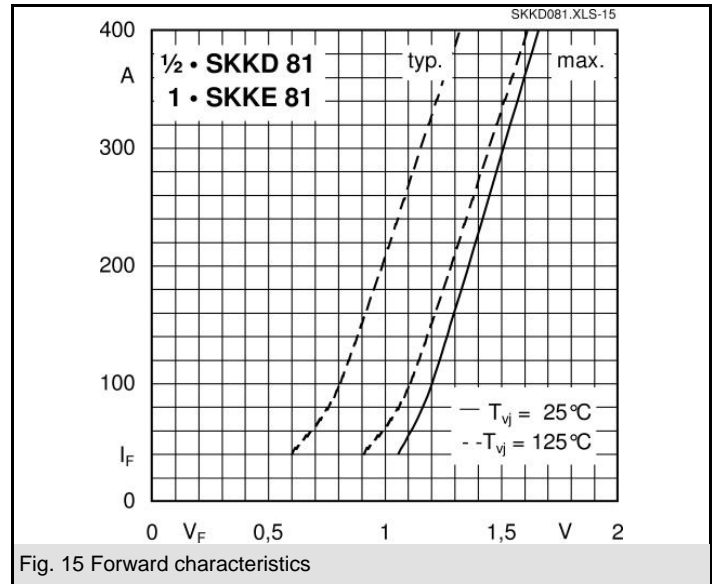

SKKD 81, SKKE 81

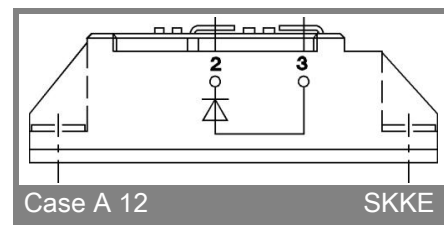
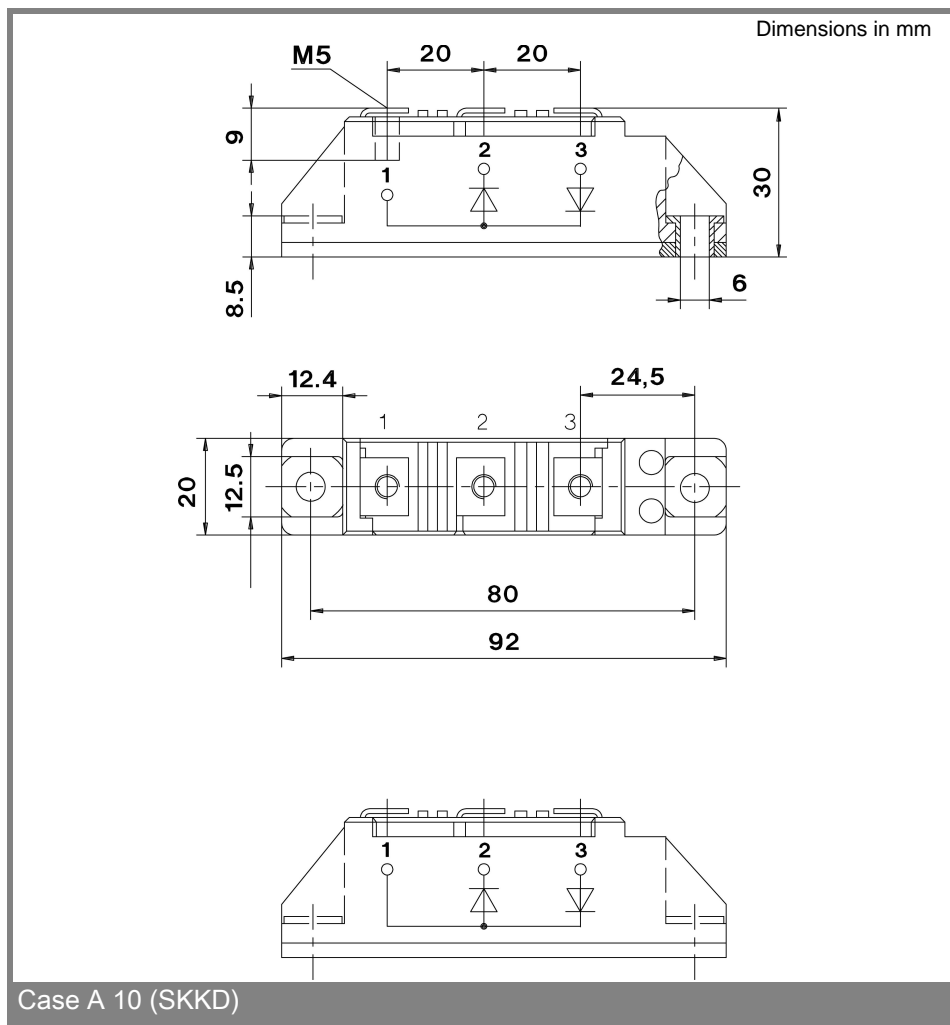

This technical information specifies semiconductor devices but promises no characteristics. No warranty or guarantee expressed or implied is made regarding delivery, performance or suitability.