

● AC Single Phase Series Filters

Diagrams

EFA301 Series

- High security and reliability, high performance filters
- Good performance of suppressing common mode and differential mode interference at frequency range 10KHz~30MHz
- Highly cost-effective, various connection ways
- Suitable for switching power supply, UPS, ATM, bill counter, embroidery machine, fuel dispenser, engraving machine, controller, industrial computer, scientific analytical instruments and other power electronic equipments as well as inverter equipments
- Safety approval: 



ROHS

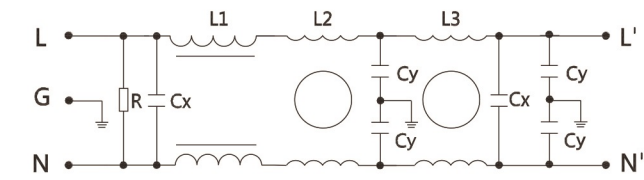
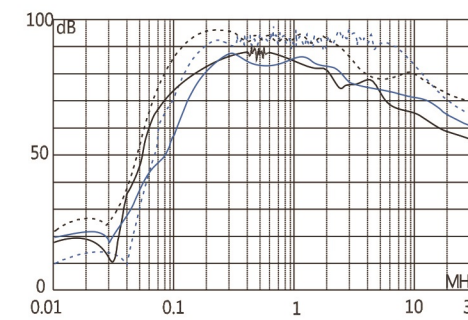
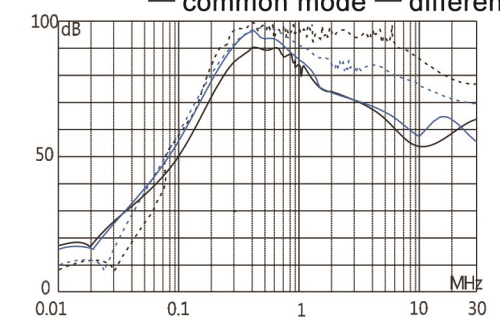

Fig.1

Insertion loss(dB)



EFA301-1-W EFA301-3-F



EFA301-6-M EFA301-10-M

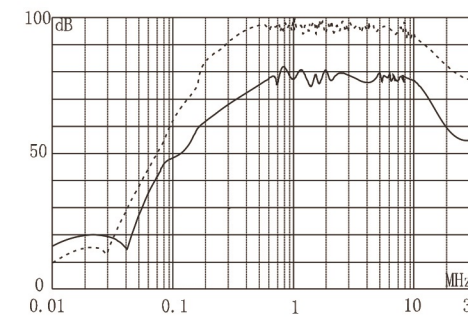

EFA301-20-M

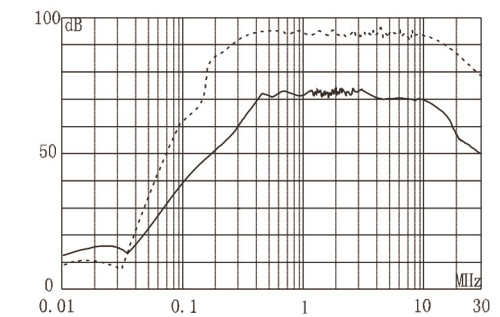



EFA301-50-M

Technical data

Rated Voltage	110/250VAC		Rated Current@40°C	0.5A~630A
Test Voltage	line-line	1760VDC	Climatic Category	25/085/21
	line-ground	2000VAC	Operating Frequency	50/60Hz

Filter Selection Table

Part No.	Rated current @40°C	Leakage current 250VAC/50Hz @20°C	Dimension	Electrical schematics	Termination		
							
EFA301-1-W	1A	<1.5mA	Fig.1	Fig.1	---	---	○
EFA301-3-F	3A	<1.5mA	Fig.2	Fig.1	---	○	---
EFA301-6-M	6A	<1.5mA	Fig.3	Fig.1	M4	---	---
EFA301-10-M	10A	<2.5mA	Fig.3	Fig.1	M4	---	---
EFA301-20-M	20A	<2.5mA	Fig.3	Fig.1	M4	---	---
EFA301-50-M	50A	<2.5mA	Fig.4	Fig.1	M6	---	---

Dimensions(mm)

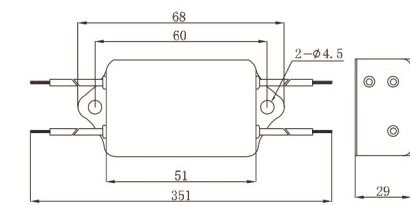

Fig.1

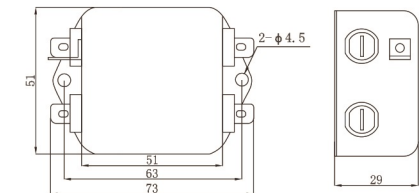

Fig.2

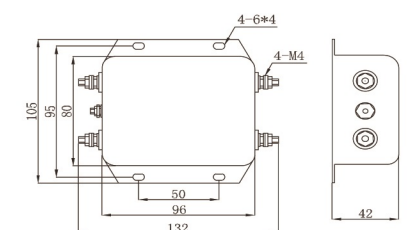

Fig.3

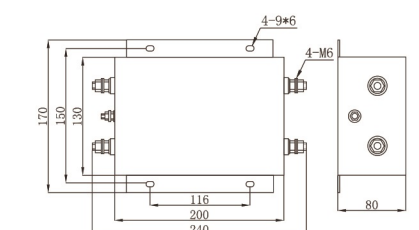

Fig.4