

SPD Component Tester ProSCT



Location of Use: Portable SPD Component Tester
 Housing: Portable Design with or without suitcase
 Compliance: EN 61326-1:2021
 IEC 61010-1:2010+A1:2019

Technical Data

ProSCT

IEC Electrical

Test Current (MOV, TVS)	I_{tc}	0.1 mA; 0.5 mA; 1 mA
Test Voltage DC (max)		1500V
Voltage Ramp (GDT)	t_A	100V/s; 1000V/s
Power Supply		Integrated rechargeable battery
		Lifetime: up to two years
MOV Measurement Error		1.5% +/- 2 digit counts
GDT Measurement Error		3.5% +/- 2 digit counts (1 kV/s)
		1.6% +/- 2 digit counts (100V/s)
Component Connection		Auto-detect
Number of Ports		1

Mechanical & Environmental

Operating Temperature Range	T_a	+14 °F to +122 °F [-10 °C to +50 °C]
Degree of Protection		IP 20 (built-in)
Housing Material		Thermoplastic: Extinguishing Degree UL-94-HB ABS
Operating State/Display		320 x 240 pixel TFT Color with Touch Screen Interface
		MOV, GDT, TVS Measurement, LOG Mode, Auto Detect, Date of Event

Order Information

Order Code	
ProSCT	130 571
ProSCT (with Suitcase and Adapter)	130 572

Dimensions & Packaging

inches [mm]

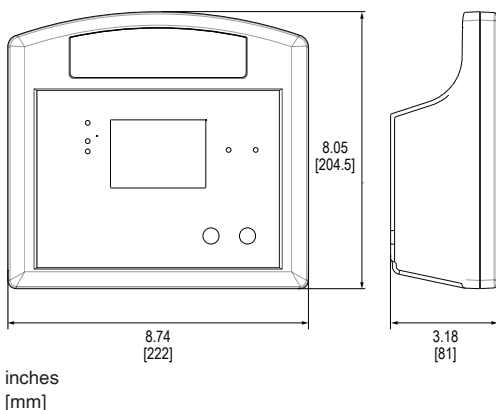

inches
[mm]

Complete Unit

ProSCT

Weight	pounds [grams]	2.43 [1100]
Packaging Dimensions (H x W x L)	Suitcase: 4.5 x 10.1 x 14.3"	[115 x 256 x 363 mm]
Standard Order Quantity		1 Unit

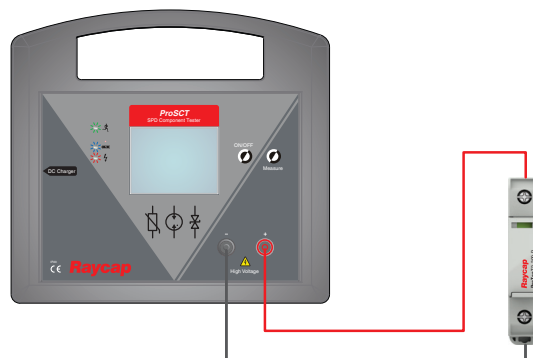

Typical Installation

Information contained in this document is subject to change at any time without notice.



SPD Adapter for ProSCT Tester



Technical Data

SPD Adapter

Connections towards SPD Tester	Banana Jack
Connections towards SPD Modules	Old SPD flat contacts, NPE bullet contact, 2 New SPD spring contacts (for 1TE and 2TE modules)
Operating Temperatures	+14 °F to +122 °F [-10 °C to +50 °C]
Enclosure Dimension (L x W x D)	2.3 x 4.3 x 2" [60 x 108 x 52 mm]
Weight	pounds [grams] .38 [175]

Order Information

Order Code	
SPD adapter	130 573

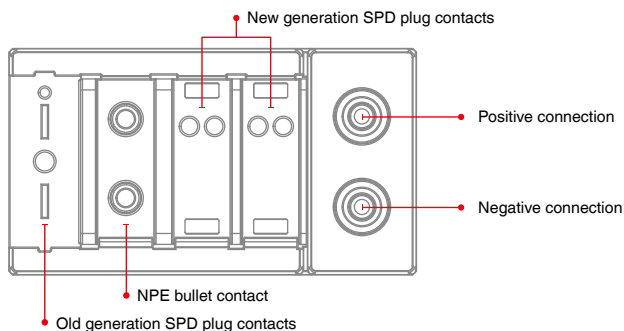

inches
[mm]

Information contained in this document is subject to change at any time without notice.

