

## Type 2 AC SPD

FRS4-C40-480

### Features

- Standard IEC61643-11
- SPD type 2-surge arrester, MOV
- Pluggable module, visual fault signalling
- Easy to use DIN mount



×4pcs remote conac

### The working principle of SPD

The working principle of surge protective device (SPD) is based on limiting voltage and diverting current. When the voltage exceeds a safe threshold, nonlinear components (such as metal oxide varistors MOV, gas discharge tubes GDT, diodes, etc.) quickly reduce resistance to guide excess energy to the ground, thus protecting equipment.

Surge protection devices contain at least one non-linear component (a varistor or spark gap), its electrical resistance varying in the function of the voltage which is applied to it. Their function is to divert the discharge or impulse current and to limit the overvoltage at the downstream equipment.

### Dimension(mm.)

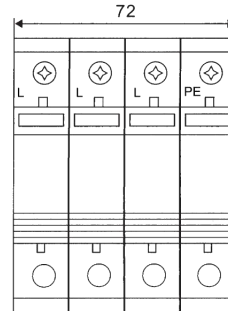
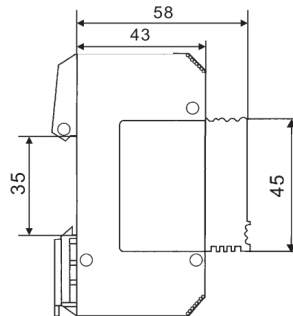

Parameter/Type	FRS4-C40/480
Nominal voltage AC (50/60 Hz) $U_n$	480 V AC
Maximum operating voltage $U_c$	L-L: 960 V AC; L-PE:880VAC
Nominal discharge current (8/20 $\mu$ s) $I_n$	20 kA
Maximum discharge current (8/20 $\mu$ s) $I_m$	40 kA
Voltage protection level $U_p$	L-L: $\leq 3.8$ kV; L-PE: $\leq 5.1$ kV
Response time $t_a$	< 25ns
Cross-section of connected conductors solid (min/max)	16 mm <sup>2</sup> / 35 mm <sup>2</sup>
Cross-section of connected conductors stranded (min/max)	16 mm <sup>2</sup> / 35 mm <sup>2</sup>
Fault indication	red indication field
*Remote contact	can be option
Remote indication contacts	250 V / 0,5 A AC, 250 V / 0,1 A DC
Cross-section of remote indication conductors	1,5 mm <sup>2</sup>
Degree of protection	IP20
Range of operating temperatures (min/max)	-40°C~+85°C
Humidity range	5%~95%
Mounting	DIN rail 35 mm
According to standard	EN 61643-11:2012, IEC 61643-11:2011 / T2