

# Load Mounts for Planar Beam Load Cells

## Product Description

2 Types are available:

- Type A Load Mount for Type ZLB/ZLS Load Cell
- Type B Load Mount for Type PB/PBW Load Cell

Material: Natural rubber with steel, zinc plated.

### Type A Load Mount for Type ZLB/ZLS Load Cell

ZLB	ØD	H	G	L
20 kg	30	15	M8	15
50 kg	30	15	M8	20
100 kg	30	15	M8	20
200 kg	30	15	M8	27

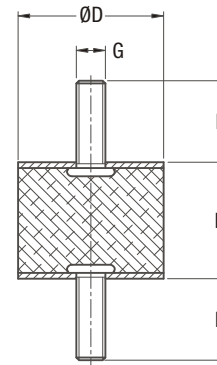

### Type B Load Mount for Type PB/PBW Load Cell

PB	PBW	ØD	H	G	L	T
3.75 kg		10	15	M4	10	> 4
7.5 kg	12.5/18.75 lb	10	15	M4	10	> 4
	25 lb	15	15	M4	13	> 4.2
15 kg	37.5 lb	20	15	M6	15	> 4.5
37.5 kg	50 lb	20	15	M6	15	> 4.5
	100 lb	25	15	M6	18	> 4.5
75 kg	240 lb	30	15	M8	20	8
150 kg		40	15	M8	23	8.5
375 kg		40	15	M8	23	8.5

