

DESB beam load cell

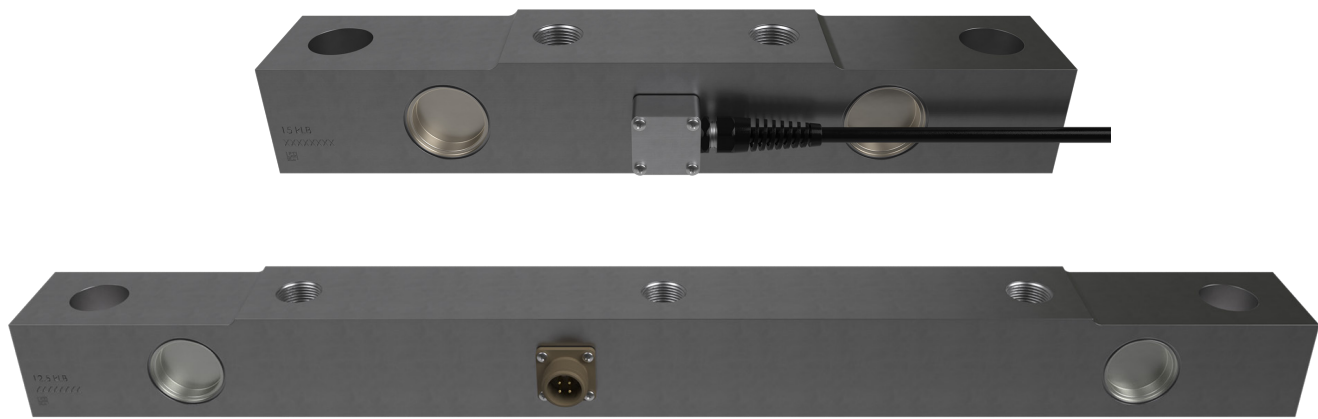

product description

The DESB load cell is a high-performance, double-ended shear beam designed for demanding weighing applications in the industrial and agricultural vehicle sector, particularly in North America.

Ideal for use in logging, fertilizer spreaders, waste vehicles, and soil stabilization equipment, this load cell is available in both 15" and 26" models. It delivers precise weight measurements, enhancing safety, reducing liability, and extending the lifespan of trucks and trailers. Constructed from high-strength stainless steel and hermetically sealed to IP68 standards, the DESB load cell ensures reliable and lasting performance even in the most challenging environments.

applications

Logging trucks, forestry equipment, industrial weighing and agricultural vehicles.

Model	Purpose
15 inch	Suitable for various applications across the US, including under-body mounts for waste trucks, fertilizer spreaders, and soil stabilization equipment. Its design, featuring a flying lead and extra strain relief, accommodates flexible installation locations on trucks.
26 inch	Specifically designed for West Coast logging configurations in the US, where it is mounted under the bolsters/bunks of log trailers. This model does not require a flying lead cable.

key features

- Capacities of 15klbs (15" model) and 12.5 klbs (26" model)
- High accuracy of 0.5% at full scale
- Corrosion resistant, high-strength stainless steel (17-4 PH)
- Hermetically sealed to IP68
- Easy to install into existing truck and trailer size envelopes
- Compatible with various trucks and trailers
- Extra strain relief for the attached cable on the 15" model

accessories

- Compatible range of hardware
- Compatible range of electronics



specifications

DESB model	-	15 Inch	26 Inch
Maximum capacity (E_{\max})	klb	15	12.5
Accuracy class	-	General purpose (GP)	
Combined error	%	± 0.5	
Rated output (RO) (Nominal)	mV/V	0.9	0.75
Excitation voltage	V	5-10	
Input resistance	Ω	350-400	
Output resistance	Ω	350 ± 2	
Insulation resistance (100 V DC)	M Ω	≥ 5000	
Safe load limit	% E_{\max}	300	
Ultimate load	% E_{\max}	400	
Safe side load	% E_{\max}	100	
Operating temperature range	$^{\circ}\text{C}$	-30 to +70	
Load cell material	-	Stainless steel 17-4 PH	
Sealing	-	Complete hermetic sealing	
Protection according EN 60 529	-	IP68 (up to 2m water depth)	
Packet weight	kg	7.8	15

Specifications and dimensions are subject to change without notice

wiring

Feature a 4-pin M12 male connector, Amphenol 3102A-14S-2P or equivalent

15-inch model: Supplied with a 1-meter cable attached, including strain relief.

26-inch model: Connector is directly mounted on the load cell body, without an attached cable.

pin	function
A	+ Excitation
B	+ Signal
C	- Excitation
D	- Signal

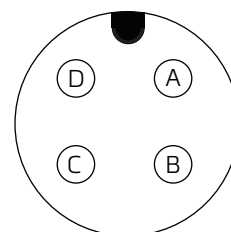

DESB 15inch dimensions (mm)

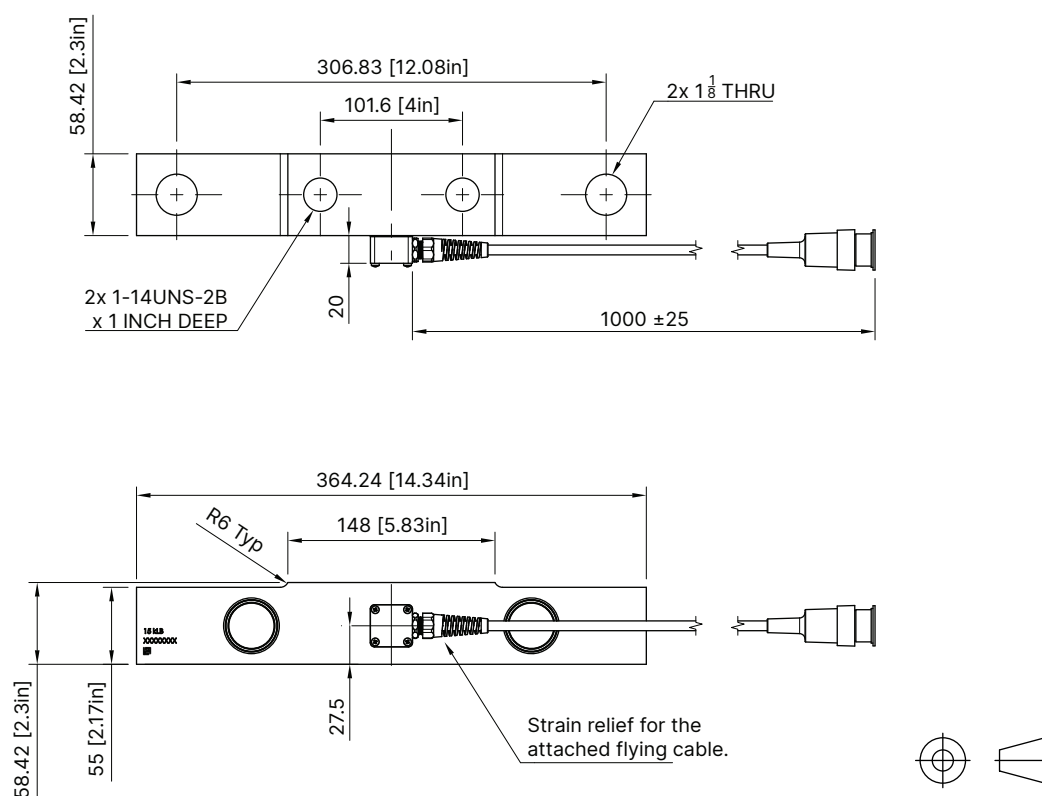

DESB 26inch dimensions (mm)

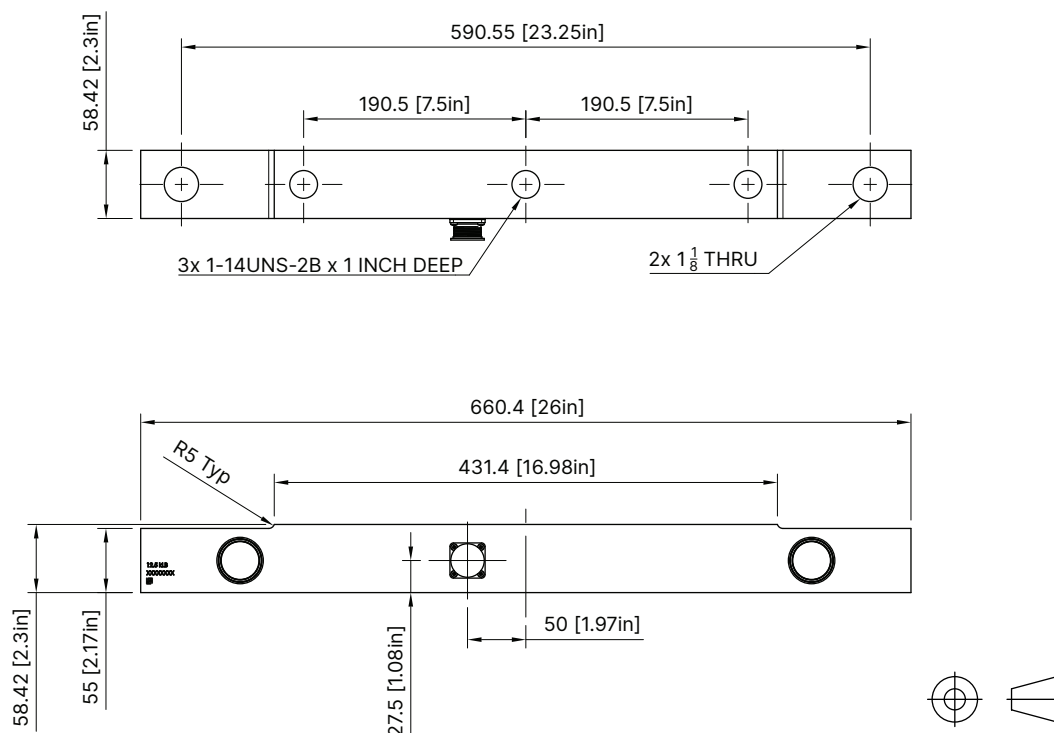

Specifications and dimensions are subject to change without notice.