

## Safety Guide for Gaslight Gas Cylinders



**FLO** **GAS**

## RECOMMENDATIONS ON THE SAFE USE OF FLOGAS BOTTLED GAS

Gaslight Cylinders should be treated with care and correctly used to ensure maximum safety. These suggestions if followed will help you to use bottled gas safely and efficiently.



### 1 Treat your gas cylinder with care

Flogas cylinders are designed and manufactured to the latest standards; however we ask you to take care of the cylinder by avoiding damage through dropping or impact. When the cylinder is not in use, keep the valve cap firmly on the valve.

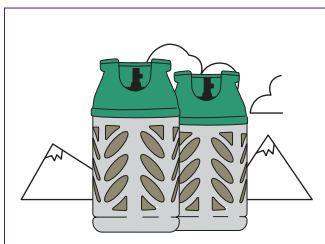

### 2 Correct cylinder storage

Cylinders should be kept standing upright, on firm level ground, with the valve upwards at all times, whether the cylinders are full or empty.

Cylinders should not be stored under stairways, in cellars or below ground level. They should also be protected from excess heat.

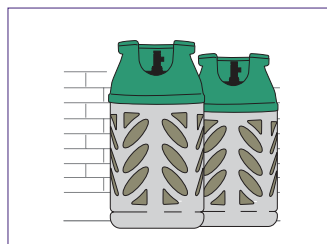

### 3 If you smell gas

Turn the gas off at the cylinder(s). Turn off all naked flames and eliminate all sources of ignition BUT do not turn electrical switches on or off. If leak is indoors, open all windows and doors to disperse gas. If cylinder is indoors, disconnect it and move it outdoors to an open area. If the leak cannot be stopped or a significant leak has occurred, evacuate the premises. Contact your installer or gas supplier. In the event of fire, contact the emergency services.



### 4 Check hoses regularly

Ensure that all hoses are properly secured with hose clips. Check them regularly and if damaged or showing signs of deterioration or wear, replace them. These items are covered by gas standards and replacements must be of the correct quality. Hoses should never be stretched across the back of a cooker or left resting on a heater.



### 5 Checking for leaks

After connecting up the cylinder open the valve and check that it is not leaking. A leak will smell, and you may hear it hiss. Brush the joint with washing up liquid. Bubbles will show a leak. Never check for a leak with a naked flame.

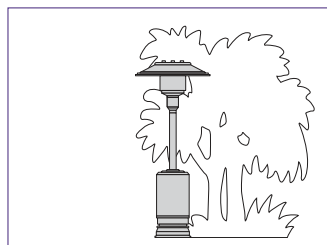

### 6 Outdoor use only

Never operate a patio heater indoors, even for testing, it is for outside use in the open air only, and may be hazardous or lethal in indoor conditions (heaters for use indoors have different protection systems to ensure their safe use).

## CHANGING OR CONNECTING FLOGAS GAS LIGHT CYLINDERS

**Before using the gas appliance, you should understand the position of the regulator lever control when in the OFF and in the ON position.**

**NOTE:** The regulator is so designed as to prevent it from being connected to the valve, unless the regulator lever is in the OFF position; therefore, never attempt to connect or to disconnect it, when the lever is not in that position.

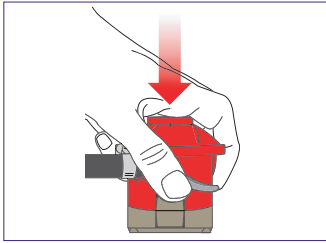

### 1 Connecting the cylinder

Ensure that all appliance gas taps are in the OFF position. Ensure that the connecting hose is correctly fitted. Ensure that the regulator lever is in the OFF position. Remove cylinder seal if fitted on cylinder. Place regulator on valve and push down firmly and vertically. You should hear a 'CLICK' sound which means that the regulator is securely connected.

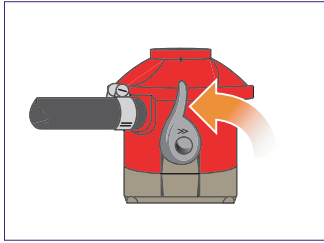

### 2 Operation

Once the regulator is correctly connected on the valve, gas supply is possible by turning the regulator lever upwards (counterclockwise).

**CAUTION:** If you are unable to turn the regulator lever to the 'ON' position, this means that your regulator is not correctly connected to the valve. Do not force the lever to open, and restart the operations described under figure no 1.

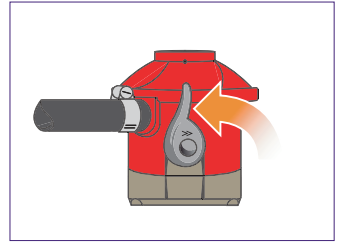

### 3 Switching off

To shut off the gas supply, turn the regulator lever to the OFF position. An arrow engraved on the lever indicates the closing direction.

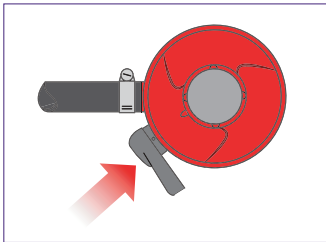

### 4 Replacement of a cylinder

Ensure that all taps on the gas appliances are in the OFF position. The regulator lever is in the OFF position.

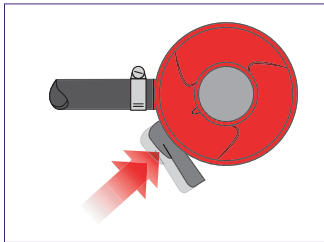

### 5 Disconnecting

To disconnect the regulator, first press in horizontally on the lever...

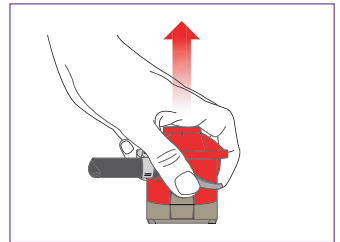

**6** Pull upwards at the same time as pressing in the lever horizontally.

# REQUIREMENTS FOR SUITABLE CYLINDER LOCATIONS

Propane cylinders should never be kept or used indoors or below ground level, they must be in the open air in a well ventilated location. The only exception is where they are supplying portable or mobile equipment in non-domestic premises, where they can be used indoors provided their use is supervised and the cylinders are moved outdoors to a suitable location at the end of the day. If the cylinders are in an enclosed yard, it must be well ventilated.

Cylinders must not be located where they may be subject to temperatures above 40C, therefore keep all inflammables including rubbish and fires 1.5m from the cylinders. Keep the area around the cylinders clear.

Do not allow cylinders obstruct passageways or fire exits and do not allow them under stairways. Prevent propane cylinders from falling over, such as by chaining the collars to a wall or fitting a cylinder cage. Use a cage if the cylinders are likely to be interfered with or where they may be struck by a vehicle.

Make sure outdoor cylinders are separated from hazards as follows:

MINIMUM SEPARATION DISTANCE IN METRES	HAZARD OR FEATURE
1.0m	Windows; doors; air vents; balanced flue outlets; drains with a water trap
1.5m	Parked vehicles; fixed sources of ignition; non-flameproof electrical equipment; flammable or combustible material
3.0m	Drain without water trap; oil tanks and their bund walls; openings to cellars or basements; corrosive, toxic or oxidising material
6.0 m	Mechanical air intakes
Chimneys/air intakes to be 1m above top of cylinder, other openings 0.3m above.	

## GENERAL PRECAUTIONS FOR ALL OUR GAS CYLINDERS

Where applicable ensure that all gas taps are OFF before turning the regulator lever to the ON position. Avoid connecting or disconnecting cylinders near to an open fire or naked flame. See that the cylinder valve and black rubber seal are not damaged before connecting the pressure regulator. Make sure the pressure regulator is fitted correctly to the cylinder neck valve. Replace the valve cap on the 'empty' cylinder.

For further information please contact:

### DUBLIN

Building 2, 3rd & 4th Floor, The Green, Dublin Airport Central, Dublin Airport, Swords, Co. Dublin, K67 E2H3.

T: 041 983 1041 E: [info@flogas.ie](mailto:info@flogas.ie) [www.flogas.ie](http://www.flogas.ie)

### CORK

Tivoli Industrial Estate, Tivoli, Co. Cork.

T: 021 450 6688 E: [info@flogas.ie](mailto:info@flogas.ie) [www.flogas.ie](http://www.flogas.ie)



[facebook.com/flogasireland](https://facebook.com/flogasireland)



[@FlogasIreland](https://twitter.com/FlogasIreland)

