

FLOORING ACCESSORIES

- **Trims and Molding**



Wall Base

Give your room a dramatic finishing touch with borders at the base of your wall. It may also be used under cabinets as a cover for toe kicks.

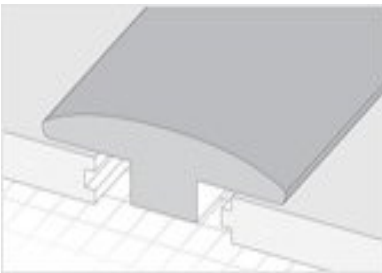

T-Molding

This molding is used as a transition piece from one flooring surface to another of equal height or to join hardwood floors between two rooms, such as in doorways. T-molding can also be used to cover joints left for expansion and contraction.

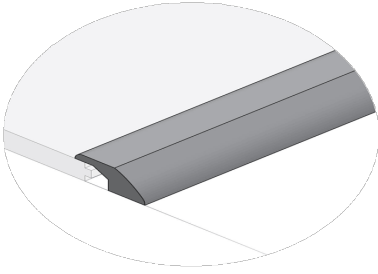

Reducer

The reducer is molding that is sloped on one side to transition between floors of different heights. This molding slopes at the end creating a continuous transition from floor to floor. It is also used as finishing touch around fireplaces, doorways, and other vertical surfaces, and as a room divider.

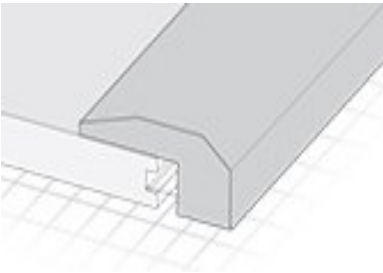

End Cap/ Threshold

Give your room a dramatic finishing touch with your wall. An end cap molding has several uses, such as transitioning from laminate to carpet, fireplaces, and exterior doors. It conceals seams against sliding door tracks, fireplaces, carpet, and tile, and provides a smooth transition between floors of different heights. With one raised side, it covers the flooring allowing protection from debris and damage.



Quarter Round/ Base Shoe

Quarter round moldings are a versatile perimeter molding style that adds a finishing touch, while covering the expansion gap. It is used as an addition to a wall base, around cabinets and at the base of steps.

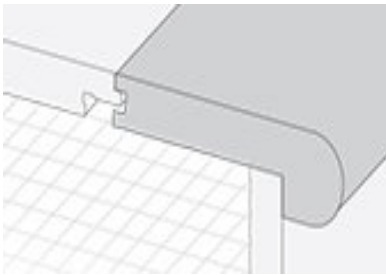

Flush Stair Nose

A molding that is used on stair steps, stair landings and elevated floor perimeters. A stair nose molding perfectly caps the edge of the stairs for a decorative and functional look creating a smooth surface between the new flooring and stair edges. Unlike overlap stair nose, flush stair connects on the same level as the flooring surface for a smooth, finished appearance.

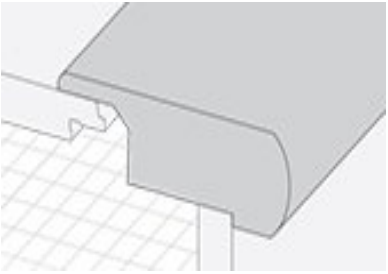

Overlap Stair Nose/Step Nose

Used where the flooring meets a step down or landing to protect the edges and provided a finished professional look. Different from flush stair nose, overlap step nose has a slightly raised profile that overlaps the flat flooring surface.



Stair Tread

A step tread is the flat, horizontal surface that your foot makes contact with when ascending or descending.



Stair Riser

A stair riser is the vertical distance between the walking surface of two stair treads (treads are what you step on) is the stair riser or riser height.

- Flooring Underlayment

An underlayment is any piece of material that is placed between the bare floor and the floor covering. The underlayment conceals the bare floor from the harsh external environmental elements. It also precludes and protects the feet from getting into direct contact with bare floors. It can be made of many different materials, chosen depending on the needs of the floor covering. Plywood, hardboard, cork, and cement board are common choices, but sometimes the underlayment is simply a thin foam padding.



QuietWalk Plus QW100PLUS Underlayment for Hardwood, Laminate and Vinyl Plank Flooring with Moisture/Vapor Barrier and Sound Absorption (Nail, Glue & Float Applications), Blue. GREENGUARD Gold Certified.

Dimensions

Coverage (1 Coat)	1-Roll = 100 SF
Square Feet / Box	100 Square Feet
Thickness or Height	0.13"
Thickness	Moisture Barrier - 1.5mm Total - 3.175mm
Length	(33' 3") 400.08"
Width	36"



Eco-Silencer HD™ FOF Acoustical Underlayment with Moisture Barrier

Eco Ultimate Silencer Underlayment is made with recycled granulated rubber tires and high-density polyurethane foam using rapidly renewable resources (soybean polyols and vegetable oils). It reduces floor noise by providing excellent sound absorption.

Available in 3' x 33.34' (100 sq. ft.) rolls.

- Exceeds Air Quality and Flammability standards

- 100% recyclable and environmentally friendly
- Contains Ultra-Fresh®, anti-microbial treatment
- Quick and easy installation (no additional seaming tape needed)
- Eliminates minor subfloor imperfections
- Adds thermal value and suitable for use with radiant heat flooring
- Crushpruf™ technology that resists indentation
- GREENGUARD Gold Certified
- Suitable for floating, glue down, and nail down laminate, solid hardwood, engineered wood, and bamboo flooring.



AcoustiCORK R60

Agglomerated 6mm Thick Cork Underlayment for Impact Noise Attenuation of All Types of Hard Surface Flooring Materials. Highly Effective IIC Noise Reduction with Minimum Thickness, Versatile, Low Cost, & Easy to Install with Long Term Durability 100% Natural & Sustainable Cork, Non-Toxic & Hypo-Allergenic.

Available in 48" x 100' x 6mm (400 sq. ft.) rolls