



THE GRIFFIN

SINGH®

25000 WOODWARD AVE., ROYAL OAK, MI 48067
MIXED-USE DEVELOPMENT



SINGH MANAGEMENT COMPANY, LLC

7125 ORCHARD LAKE ROAD, SUITE 200, WEST BLOOMFIELD, MI 48322

JOSH JACOBS | TEL: (248) 865-1610 | CELL: (248) 910-6738 | EMAIL: JOSH.JACOBS@SINGHMAIL.COM

THE GRIFFIN SINGH®

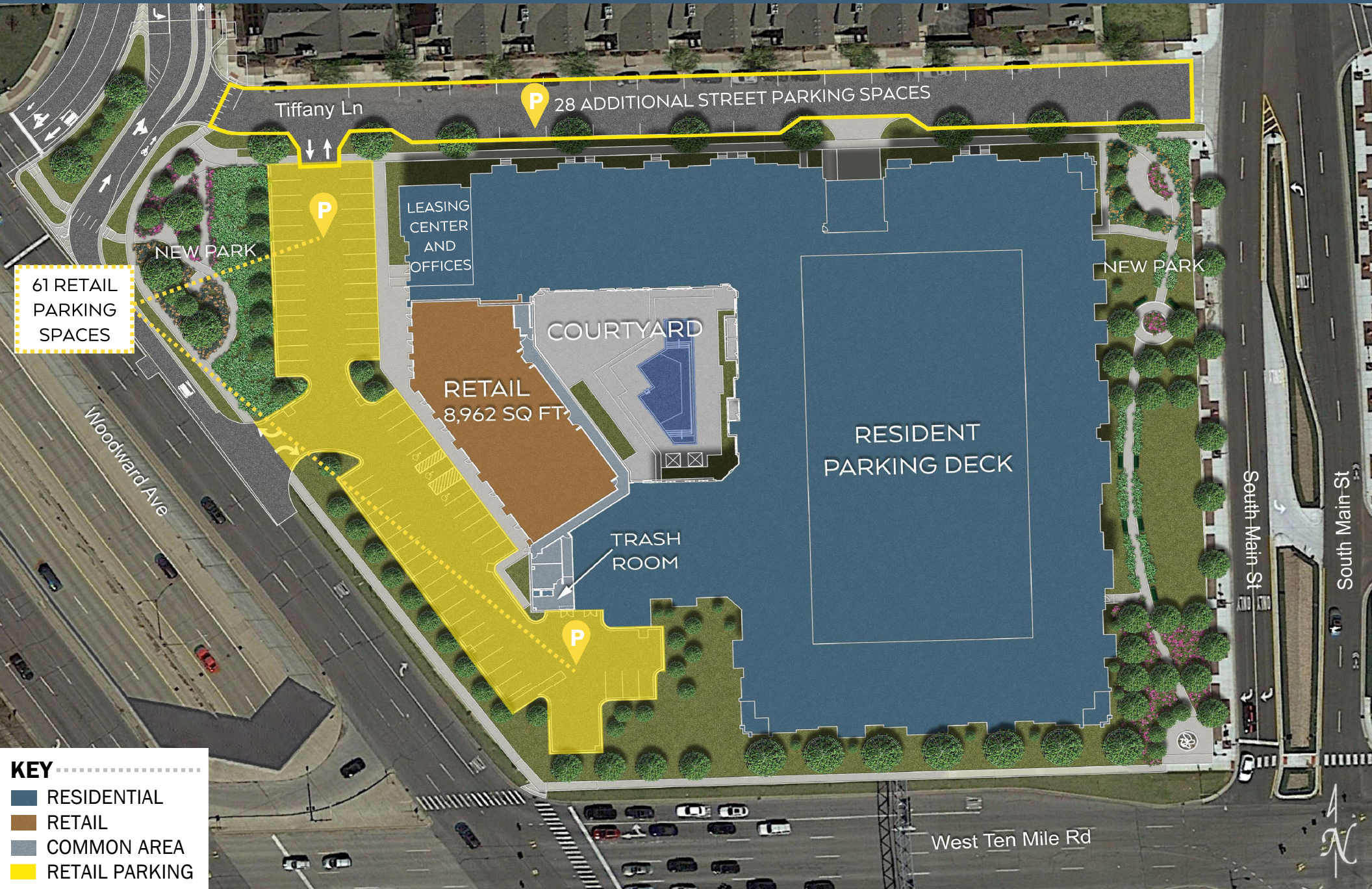

Tiffany Ln

P 28 ADDITIONAL STREET PARKING SPACES

NEW PARK

61 RETAIL PARKING SPACES

LEASING CENTER AND OFFICES

COURTYARD

RETAIL
8,962 SQ FT

TRASH ROOM

RESIDENT PARKING DECK

NEW PARK

South Main St

South Main St

West Ten Mile Rd



KEY

- RESIDENTIAL
- RETAIL
- COMMON AREA
- RETAIL PARKING

PROPERTY HIGHLIGHTS



**MIXED-USE
DEVELOPMENT**



8,962 SQ FT
OF LEASABLE COMMERCIAL SPACE



245
RESIDENTIAL UNITS



2
ON-SITE COMMUNITY PARKS



61

FREE SURFACE SPACES
AVAILABLE - 6.80/1,000 SQ FT



28

PARKING SPACES ON
TIFFANY LANE



2

PARKING LOT
ENTRANCES



99,000+ CARS

PASS I- 696 &
WOODWARD AVE DAILY



54,217 CARS

PASS WOODWARD AVE &
10 MILE RD DAILY

LOCAL HIGHLIGHTS

15,215

POPULATION
1 mi radius

40.40

MEDIAN AGE
1 mi radius

2.10

AVERAGE HH SIZE
1 mi radius

\$115,319

AVERAGE HH INCOME
1 mile radius

\$274,659

MEDIAN HOME VALUE
1 mile radius

98.63%

CIVILIANS EMPLOYED
1 mi radius

148,053

POPULATION
3 mi radius

39.20

MEDIAN AGE
3 mi radius

2.30

AVERAGE HH SIZE
3 mi radius

\$84,180

AVERAGE HH INCOME
3 mile radius

\$170,485

MEDIAN HOME VALUE
3 mile radius

97.67%

CIVILIANS EMPLOYED
3 mi radius

OVERALL RETAIL FLOOR PLAN

NOT TO SCALE

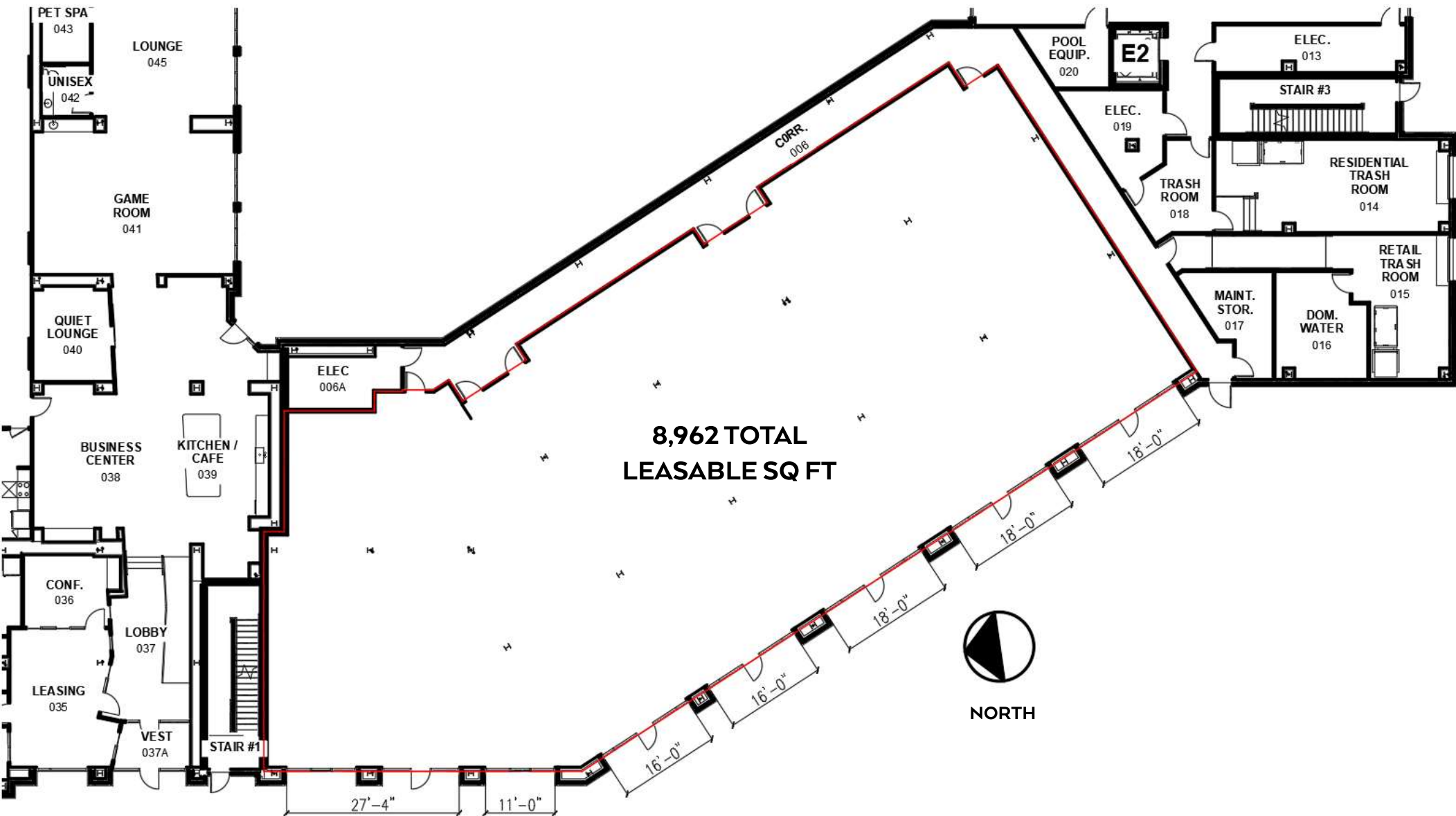

RETAIL FLOOR PLANS

NOT TO SCALE

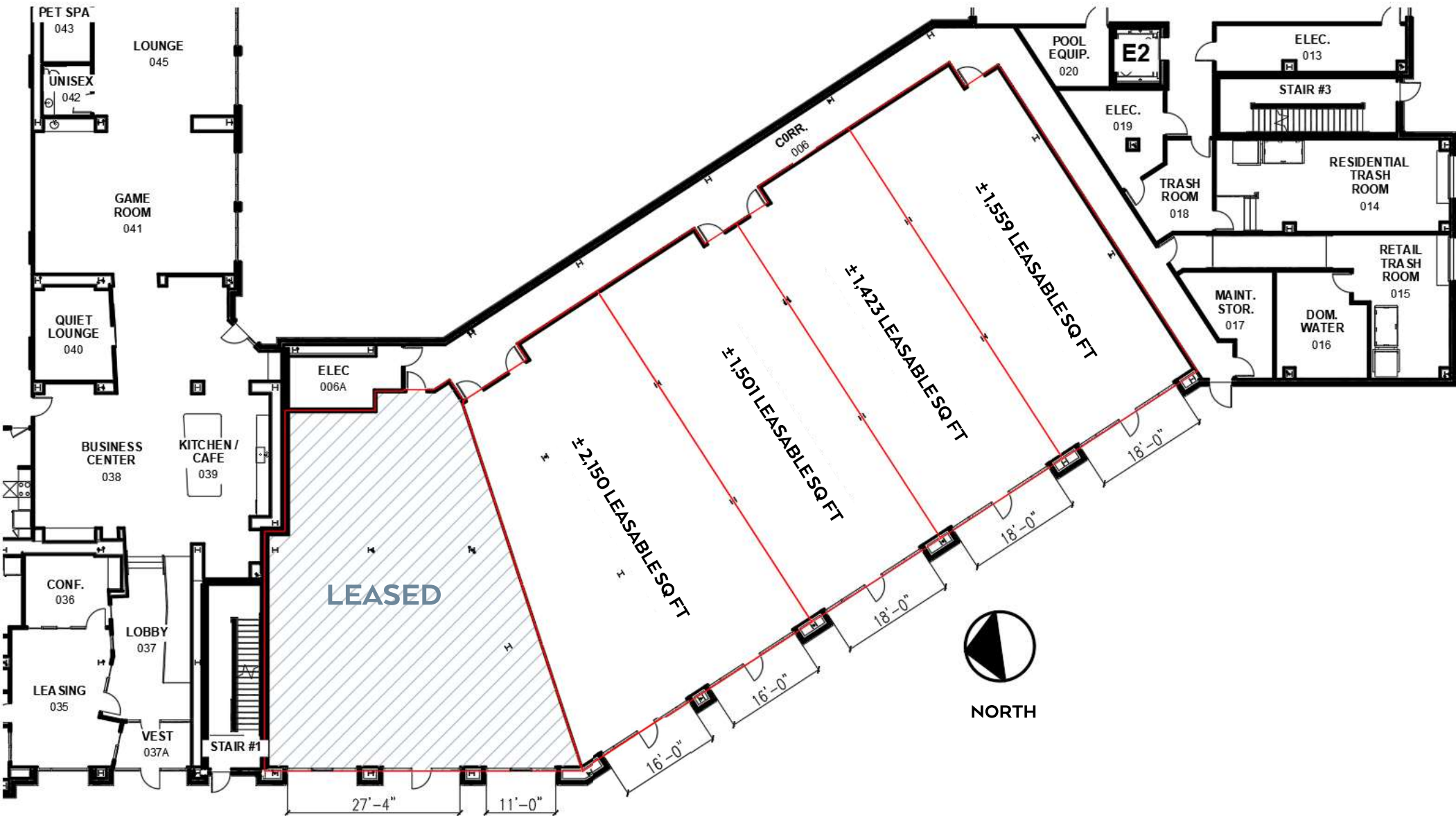

STOREFRONT SIGNAGE PLACEMENT



VIEW OF STOREFRONTS FROM WOODWARD AVENUE



RESIDENTIAL COURTYARD



LOCATION MAP

