

REV	DESCRIPTION	DATE
-----	-------------	------

△ RDK-97163
 △ RDCM-102196

張馨尹 2008/09/04
 謝婉如 2013/11/28

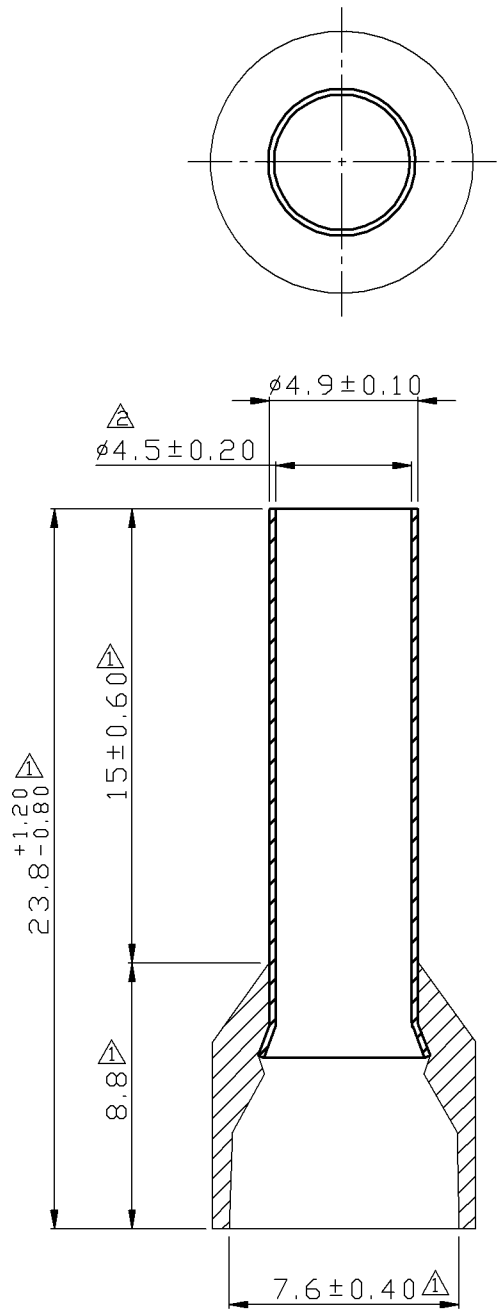

NOTE :

1. MAXIMUM ELECTRIC CURRENT :

A.W.G.	8
AMP.	70
2. MAXIMUM ELECTRICAL RATING : 105°C 600 VOLTS MAX.
3. INSULATION MATERIAL : NYLON
4. INSULATION COLOR :
 FRENCH COLOR : BROWN
 GERMAN COLOR : IVORY
 DIN COLOR : RED
5. CONNECTOR MATERIAL : COPPER TUBE.
6. WIRE RANGE : 8 A.W.G. (10 mm²)
7. CONNECTOR SURFACE TREATMENT : TIN PLATED

Tolerance Unless Otherwise Specified	
0 >	mm ± 0.50 ANGLE
>	mm ± 0° REF ±
>	mm ± ° ±
>	mm ± ° ±

NAME	NYLON-INSULATED CORD END TERMINALS (E SERIES)			UNIT	mm	
PART NO.	E10-15	MATERIAL	-----	APPROVE		
NUMBER	KA-95443-C	SCALE	SHEET PAGE	CHECKED		
DATE	2006/05/11	4/1	1-2 10F1	DRAWN	張馨尹	

KST. K.S. TERMINALS INC.