

REV	DESCRIPTION	DATE
-----	-------------	------

△ RDK-97163 張馨尹 2008/08/28

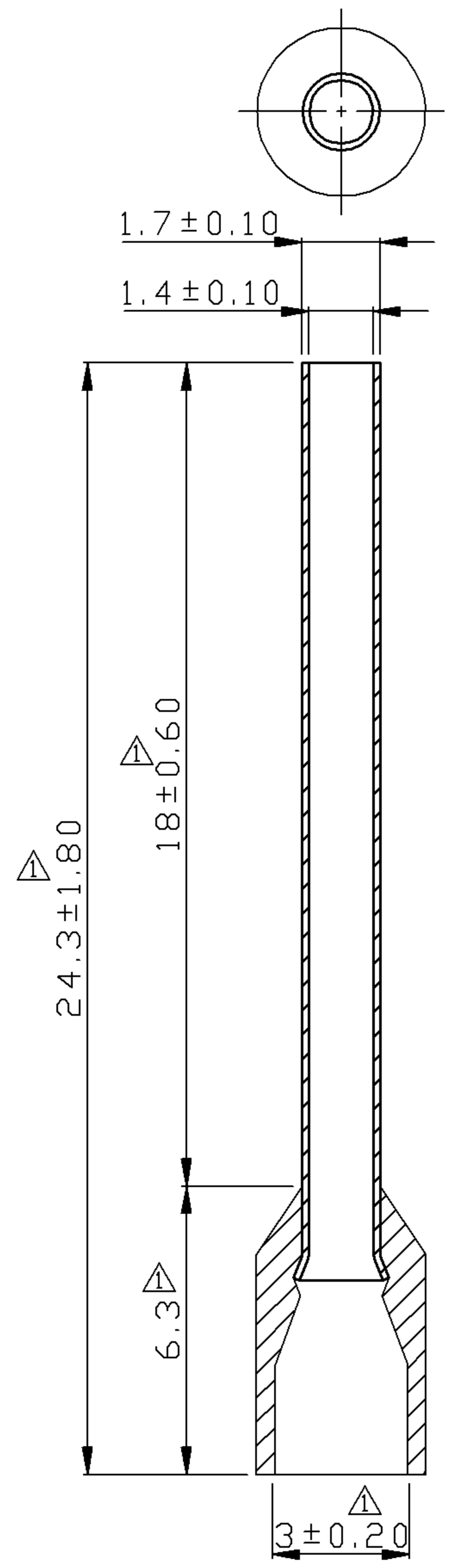

NOTE:

1. MAXIMUM ELECTRIC CURRENT :

A.W.G.	18
AMP.	17
2. MAXIMUM ELECTRICAL RATING : 105°C 600 VOLTS MAX.
3. INSULATION MATERIAL : NYLON
4. INSULATION COLOR :
 FRENCH COLOR : RED
 GERMAN COLOR : YELLOW
 DIN COLOR : RED
5. CONNECTOR MATERIAL : COPPER TUBE.
6. WIRE RANGE : 18 A.W.G.(1.0 mm²)
7. CONNECTOR SURFACE TREATMENT : TIN PLATED

Tolerance Unless Otherwise Specified	
0 >	mm ± 0.50 ANGLE
>	mm ± 0° ° REF ±
>	mm ± ° ° ±
>	mm ± ° ° ±

NAME	NYLON-INSULATED CORD END TERMINALS (E SERIES)			UNIT	
PART NO.	E1018	MATERIAL	-----	APPROVE	
NUMBER	KA-95422-C	SCALE	SHEET	PAGE	CHECKED
DATE	2006/05/10	5/1	1-1	10F1	DRAWN 張馨尹

KST. K.S. TERMINALS INC.