

REV	DESCRIPTION	DATE
△	RDK-97163	張馨尹 2008/09/08
△	RDCM-105070	林淑慎 2016/06/06

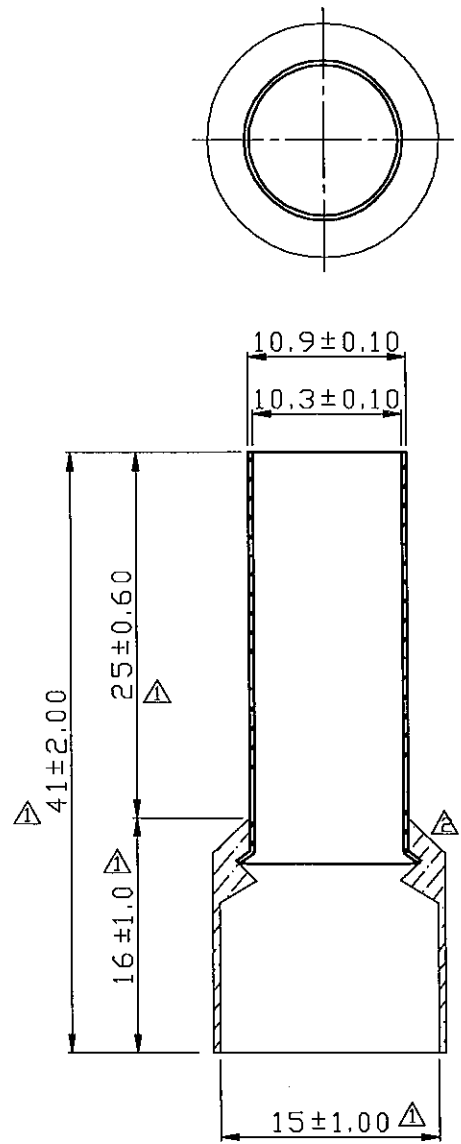

- NOTE:
1. MAXIMUM ELECTRIC CURRENT : $\frac{\text{A.W.G.} | 1/0}{\text{AMP.} | 230}$
 2. MAXIMUM ELECTRICAL RATING : 105°C 600 VOLTS MAX.
 3. INSULATION MATERIAL : NYLON
 4. INSULATION COLOR :
FRENCH COLOR : BLUE
GERMAN COLOR : OLIVE
DIN COLOR : BLUE
 5. CONNECTOR MATERIAL : COPPER TUBE.
 6. WIRE RANGE : 1/0 A.W.G. < 50 mm²
 7. CONNECTOR SURFACE TREATMENT : TIN PLATED

Tolerance Unless Otherwise Specified	
0 >	mm ± 0.50 ANGLE
>	mm ± 0° ° REF ±
>	mm ± ° ° ±
>	mm ± ° ° ±

NAME	NYLON-INSULATED CORD END TERMINALS (E SERIES)			UNIT	mm	
PART NO.	E50-25	MATERIAL	-----	APPROVE		
NUMBER	KA-95463-C	SCALE	SHEET	PAGE	CHECKED	
DATE	2006/05/10	2/1	1-2	10F1	DRAWN	張馨尹

KST. K.S. TERMINALS INC.