

REV	DESCRIPTION	DATE
-----	-------------	------

△	RDK-97163	張馨尹 2008/08/28
△	RDCM-102196	謝婉如 2013/11/26

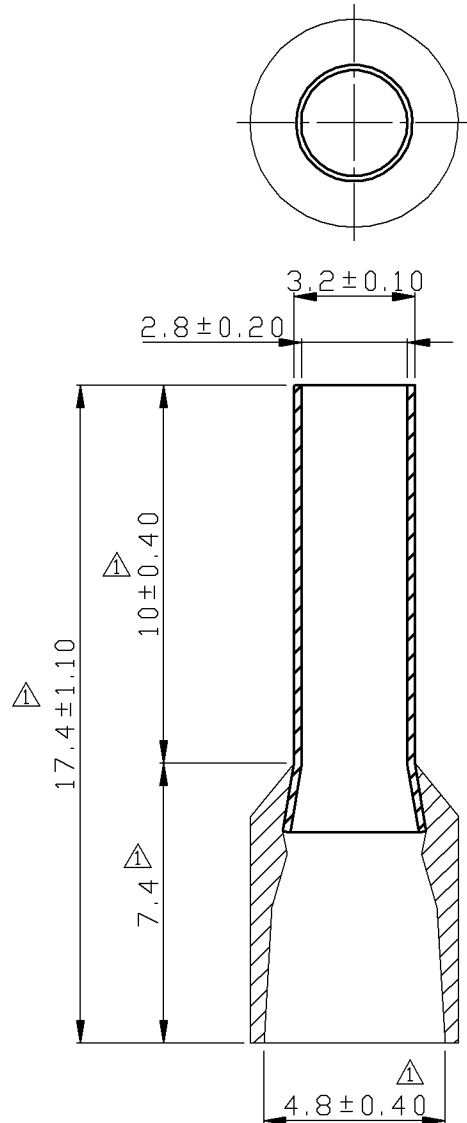

- NOTE:
1. MAXIMUM ELECTRIC CURRENT :

A.W.G.	12
AMP.	35
 2. MAXIMUM ELECTRICAL RATING : 105°C 600 VOLTS MAX.
 3. INSULATION MATERIAL : NYLON
 4. INSULATION COLOR :
 FRENCH COLOR : ORANGE
 GERMAN COLOR : GREY
 DIN COLOR : GREY
 5. CONNECTOR MATERIAL : COPPER TUBE.
 6. WIRE RANGE : 12 A.W.G. (4.0 mm²)
 7. CONNECTOR SURFACE TREATMENT : TIN PLATED

Tolerance Unless Otherwise Specified	
0 >	mm ± 0.50 ANGLE
>	mm ± 0° REF ±
>	mm ± ° ±
>	mm ± ° ±

NAME	NYLON-INSULATED CORD END TERMINALS (E SERIES)			UNIT	mm	
PART NO.	E 4010	MATERIAL	-----	APPROVE		
NUMBER	KA-95436-C	SCALE	SHEET	PAGE	CHECKED	
DATE	2006/05/10	5/1	1-2	10F2	DRAWN	張馨尹

KST. K.S. TERMINALS INC.