

REV	DESCRIPTION	DATE
△	RDK-97163	張馨尹 2008/09/08
△	RDCM-105070	林淑慎 2016/06/06

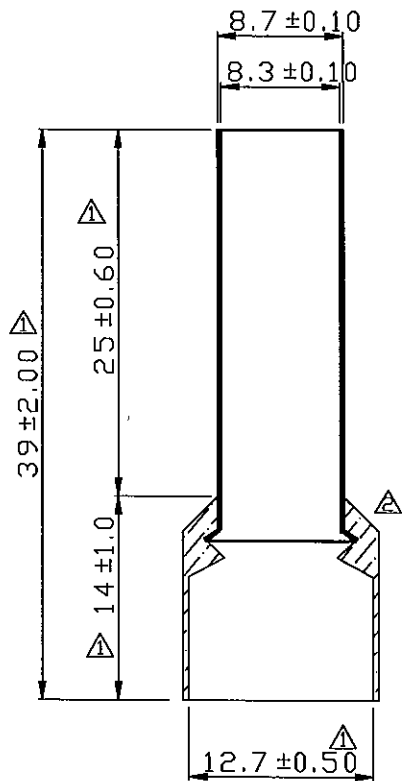
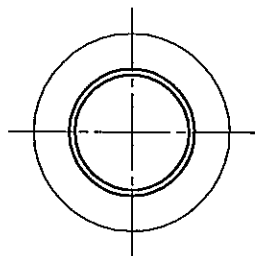

NOTE:

- MAXIMUM ELECTRIC CURRENT : $\frac{\text{A.W.G.} \mid 2}{\text{AMP.} \mid 170}$
- MAXIMUM ELECTRICAL RATING : 105°C 600 VOLTS MAX.
- INSULATION MATERIAL : NYLON
- INSULATION COLOR :
FRENCH COLOR : RED
GERMAN COLOR : BEIGE
DIN COLOR : RED
- CONNECTOR MATERIAL : COPPER TUBE.
- WIRE RANGE : 2 A.W.G.(35 mm²)
- CONNECTOR SURFACE TREATMENT : TIN PLATED

Tolerance Unless Otherwise Specified	
0 >	mm ± 0.50 ANGLE
>	mm ± 0° REF ±
>	mm ± ° ±
>	mm ± ° ±

NAME	NYLON-INSULATED CORD END TERMINALS (E SERIES)			UNIT	mm	
PART NO.	E35-25	MATERIAL	-----	APPROVE		
NUMBER	KA-95458-C	SCALE	SHEET	PAGE	CHECKED	
DATE	2006/06/11	2/1	1-2	10F1	DRAWN	張馨尹

KST. K.S. TERMINALS INC.