

REV	DESCRIPTION	DATE
△	RDK-97163	張馨尹 2008/08/25
△	RDCM-102196	謝婉如 2013/11/26
△	RDCM-103141	黃智宏 2014/08/18

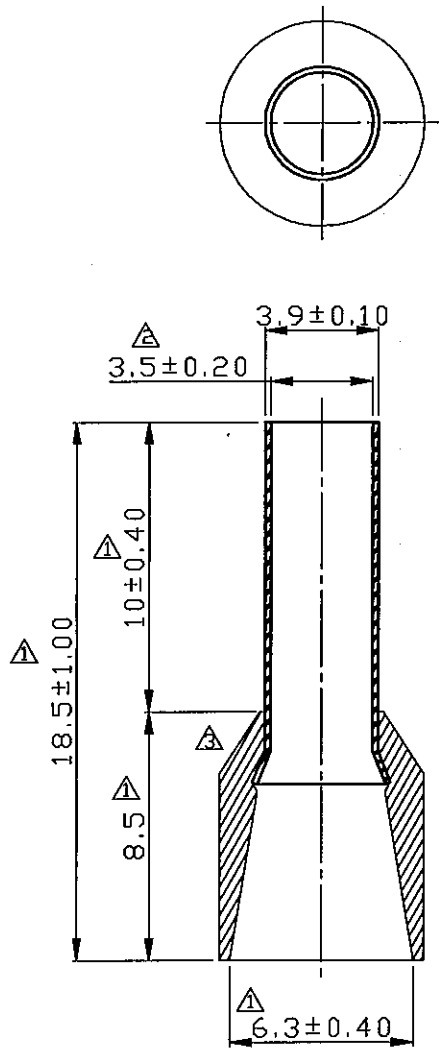

- NOTE :
1. MAXIMUM ELECTRIC CURRENT :

A.W.G.	10
AMP.	50
 2. MAXIMUM ELECTRICAL RATING : 105°C 600 VOLTS MAX.
 3. INSULATION MATERIAL : NYLON
 4. INSULATION COLOR :
FRENCH COLOR : GREEN
GERMAN COLOR : BLACK
DIN COLOR : YELLOW
 5. CONNECTOR MATERIAL : COPPER TUBE.
 6. WIRE RANGE : 10 A.W.G. (6.0 mm²)
 7. CONNECTOR SURFACE TREATMENT : TIN PLATED

Tolerance Unless Otherwise Specified	
0 >	mm ± 0.50 ANGLE
>	mm ± 0° > ° REF ±
>	mm ± ° > ° ±
>	mm ± ° > ° ±

NAME	NYLON-INSULATED CORD END TERMINALS (F SERIES)				UNIT	mm	
PART NO.	E6010	MATERIAL	-----	APPROVE			
NUMBER	KA-95439-C	SCALE	SHEET	PAGE	CHECKED		
DATE	2006/05/11	4/1	1-3	10F1	DRAWN	張馨尹	

KST. K.S. TERMINALS INC.