

REV	DESCRIPTION	DATE
-----	-------------	------

△ RDK-97163
 △ RDCM-102196

張馨尹 2008/09/04
 謝婉如 2013/11/28

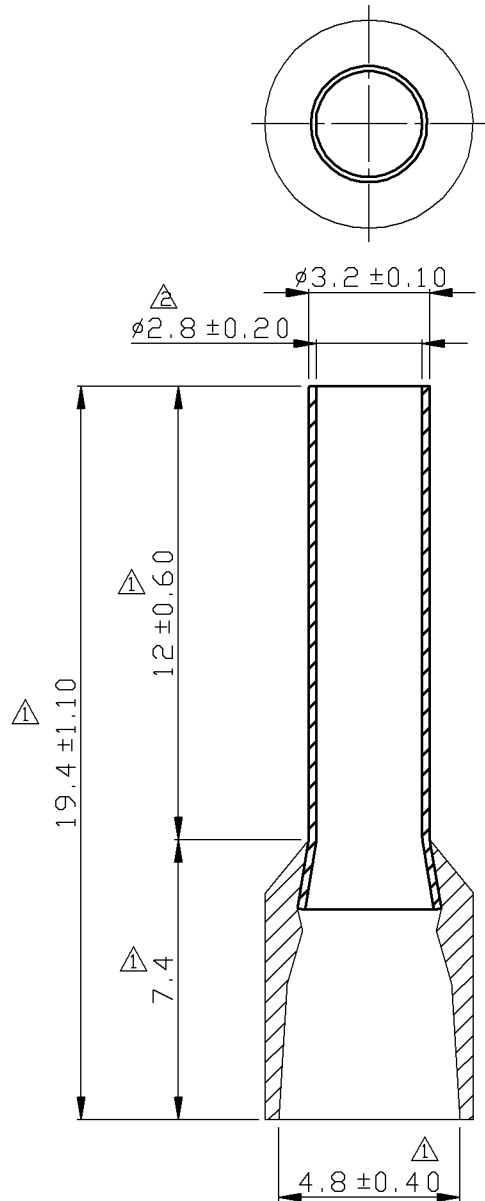

NOTE :

- MAXIMUM ELECTRIC CURRENT :

A.W.G.	12
AMP.	35
- MAXIMUM ELECTRICAL RATING : 105°C 600 VOLTS MAX.
- INSULATION MATERIAL : NYLON
- INSULATION COLOR :
 FRENCH COLOR : ORANGE
 GERMAN COLOR : GREY
 DIN COLOR : GREY
- CONNECTOR MATERIAL : COPPER TUBE.
- WIRE RANGE : 12 A.W.G. (4.0 mm²)
- CONNECTOR SURFACE TREATMENT : TIN PLATED

Tolerance Unless	
Otherwise Specified	
0 >	mm ± 0.50 ANGLE
>	mm ± 0° ° REF ±
>	mm ± ° ° ±
>	mm ± ° ° ±

NAME	NYLON-INSULATED CORD END TERMINALS (E SERIES)				UNIT	mm	
PART NO.	E 4012	MATERIAL	-----	APPROVE			
NUMBER	KA-95437-C	SCALE	SHEET	PAGE	CHECKED		
DATE	2006/05/10	5/1	1-2	10F1	DRAWN	張馨尹	

KST. K.S. TERMINALS INC.