

Modulares Schnellwechselsystem
Modular quick change system

BENZ CAPTO™

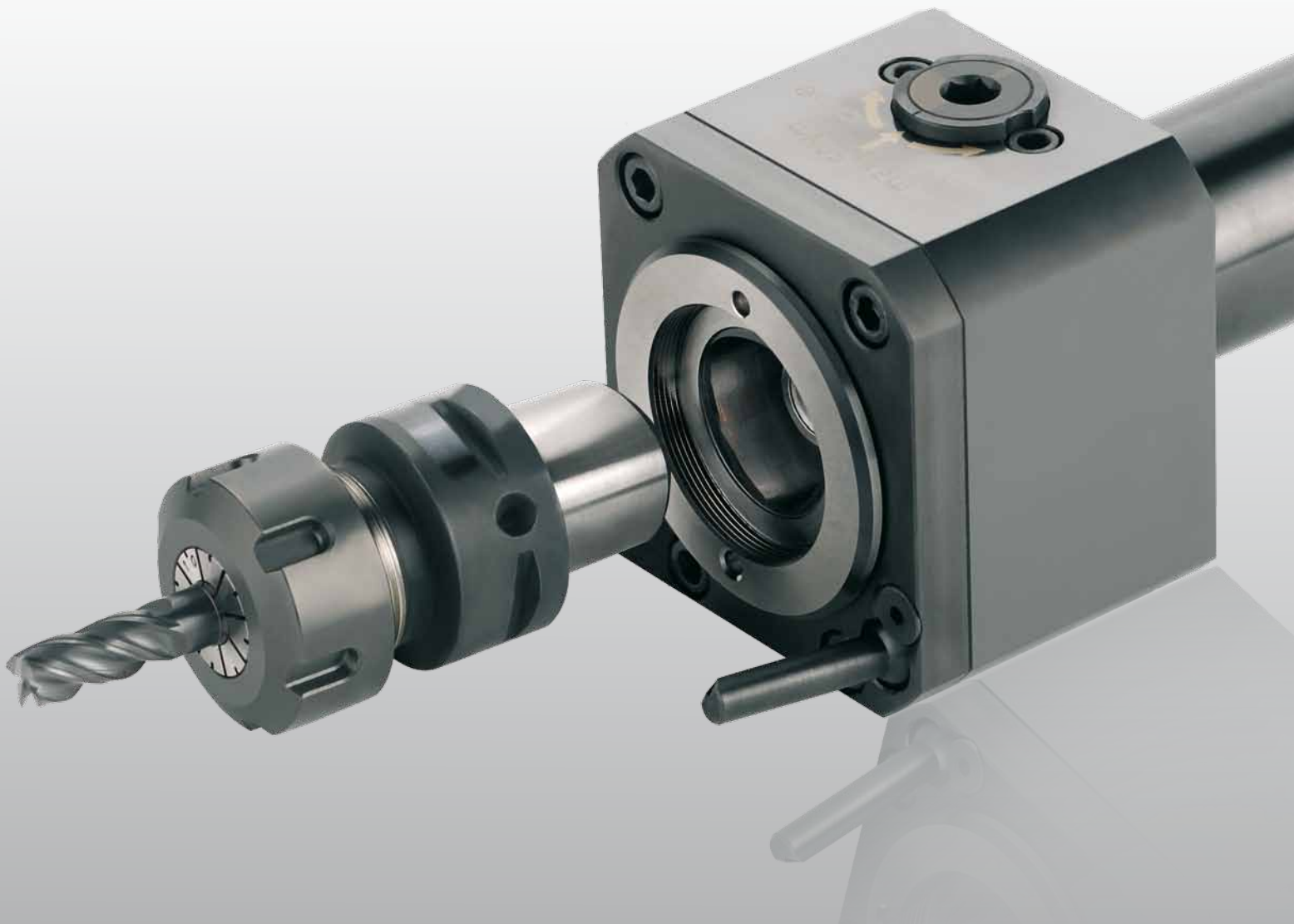

Modulares Schnellwechselsystem BENZ CAPTO™

Modular quick change system BENZ CAPTO™

Effizienz und Qualität steigern:

- Zum Drehen, Fräsen und Bohren mit bis zu 100 bar Kühlmitteldruck
- Stabilität und Steifigkeit bei zugleich hoher Flexibilität
- Kurze Auskraglänge garantiert hohe Schnittgeschwindigkeiten und Oberflächengüte
- Schneller Werkzeugwechsel mit zusätzlichem Rastmechanismus
- Ideal für schwere Zerspanung

Increase efficiency and Quality:

- *For milling, routing and drilling up to 100 bar coolant pressure*
- *Stability and rigidity with high flexibility at the same time*
- *Compact shape guarantees high cutting speeds and surface quality*
- *Fast tool change with additional locking mechanism (ratcheted)*
- *Ideal for heavy milling*



Vorteile und Funktionsweise von BENZ CAPTO™

Advantages and functionality of BENZ CAPTO™

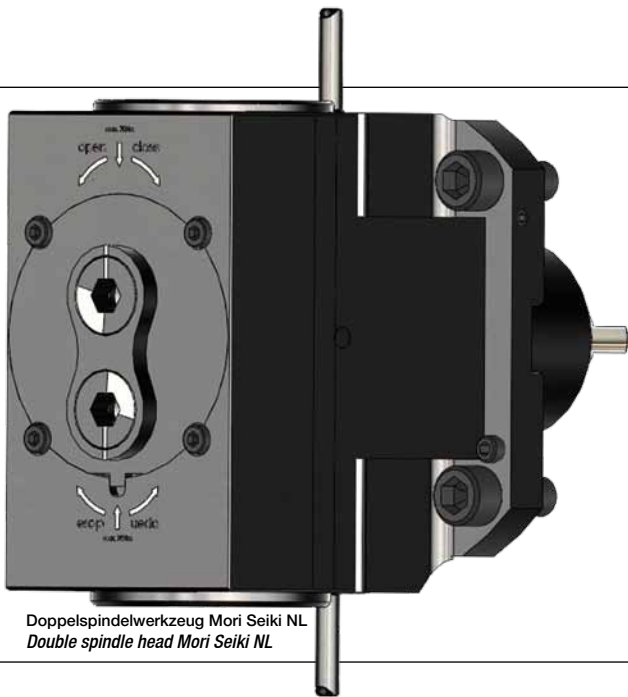

Doppelspindelwerkzeug Mori Seiki NL
Double spindle head Mori Seiki NL



Radialwerkzeug Sauter VDI
Radial live tool Sauter VDI

Kompakte Bauform

Längenmaße z.B. axiale Bauform

| BENZ CAPTO™ | D | L ₁ |
|-------------|-------|----------------|
| C3 | VDI30 | 55 |
| C4 | VDI40 | 60 |
| C5 | VDI50 | 75 |

Spannsystem auch in vergleichbaren axialen und radialen BMT-Schaftwerkzeugen realisierbar.

Einfaches Handling

- Optisch ersichtlicher Selbsthemmbereich mit 100°
- Spannstellung ab 75°
- Betätigungsdrehmoment: 50 Nm (C4)
- Prozesssicherheit durch Rastfunktion

Technik auf höchstem Niveau

- BENZ CAPTO™ Spannsystem nach ISO-Norm 26623
- Höhere Spannkräfte als in der ISO-Norm 26623 gefordert. Z.B. bei C4 = 22 kN

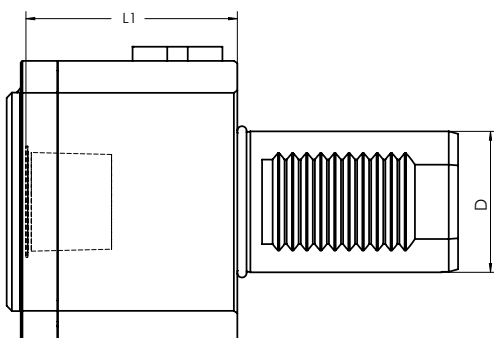

Compact design

Dimensions e.g. axial design

| BENZ CAPTO™ | D | L ₁ |
|-------------|-------|----------------|
| C3 | VDI30 | 55 |
| C4 | VDI40 | 60 |
| C5 | VDI50 | 75 |

Clamping system also for comparable axial and radial BMT tools possible.

Easy handling

- Optically visible clamping position 100°
- Clamp position from 75°
- Starting torque: 50 Nm (C4)
- Process reliability due to lock function

Technology at its highest level

- BENZ CAPTO™ clamping system as per ISO-Norm 26623
- Higher clamping force as in the requirements per ISO-Norm 26623. E.g.: C4 = 22 kN

Lösestellung
Release position

Selbsthemmbereich
Clamping position

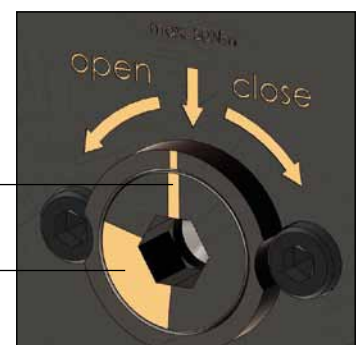

Mori Seiki NL / NT



NL 1000 NL 2500
 NL 1500 NL 3000
 NL 2000 NT 4250

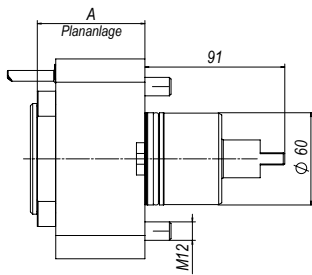

1

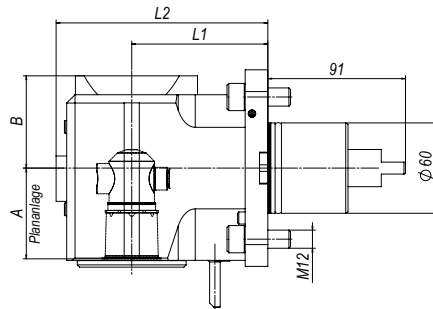

2

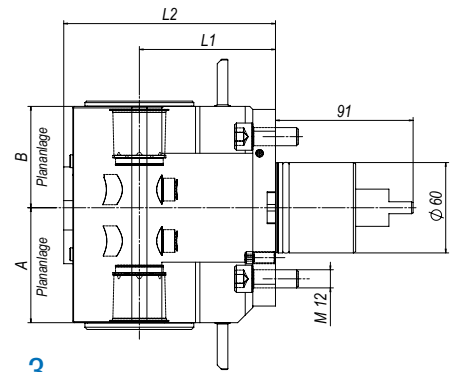

3

Angetriebene Werkzeuge | Driven tools

| Bestell-Nr. Order No. | Ausführung Tool style | Bild Figure | Aufnahme Tool holder | n [min ⁻¹] | i | T [Nm] | EK EC | IK IC | p _{max} [bar] | Maße Dimensions | | | |
|--------------------------|--------------------------|----------------|-------------------------|---------------------------|-----|-----------|----------|----------|---------------------------|-------------------|------|----------------|----------------|
| | | | | | | | | | | A | B | L ₁ | L ₂ |
| 115DA03500L5B | axial | 1 | C5 | 6.000 | 1:1 | 100 | ✓ | - | - | 69 | - | - | - |
| 115EA03500L5B | axial | 1 | C5 | 6.000 | 1:1 | 100 | ✓ | ✓ | 50 | 84 | - | - | - |
| 115FAX03559L5BD | radial | 2 | C5 | 6.000 | 1:1 | 150 | ✓ | - | - | 60 | 61 | 90 | 140 |
| 115GAX03559L5BD | radial | 2 | C5 | 6.000 | 1:1 | 150 | ✓ | ✓ | 100 | 60 | 67,5 | 90 | 140 |
| 115FAX03500L5BD2 | radial | 3 | C5 | 6.000 | 1:1 | 150 | ✓ | - | - | 75 | 65 | 90 | 140 |

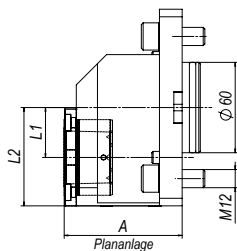

4

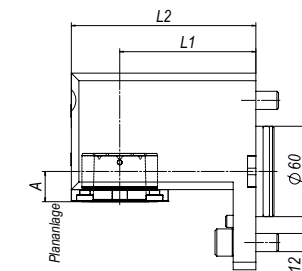

5

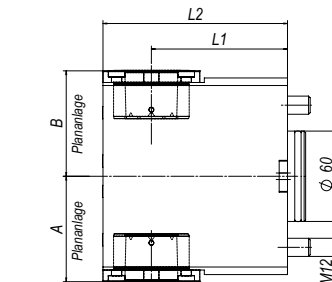

6

Statische Halter | Static tool holders

| Bestell-Nr. Order No. | Ausführung Tool style | Bild Figure | Aufnahme Tool holder | EK EC | IK IC | p _{max} [bar] | Maße Dimensions | | | |
|--------------------------|--------------------------------|----------------|-------------------------|----------|----------|---------------------------|-------------------|----|----------------|----------------|
| | | | | | | | A | B | L ₁ | L ₂ |
| 115AV035L5BDU-78 | axial versetzt axial offset | 4 | C5 | - | ✓ | 100 | 78 | - | 33 | 65 |
| 115AR035L5BDU-90 | radial | 5 | C5 | - | ✓ | 100 | 30 | - | 90 | 122 |
| 115AR035L5BD2U-90 | radial | 6 | C5 | - | ✓ | 100 | 70 | 70 | 90 | 122 |

EK: externe Kühlung, IK: interne Kühlung
 Zubehör ist nicht im Lieferumfang enthalten
 Technische Änderungen vorbehalten

EC: external coolant, IC: internal coolant
 Accessories are not included in delivery
 We reserve the right to modify technical contents

Mori Seiki NZ

NZ 1500
NZ 2000

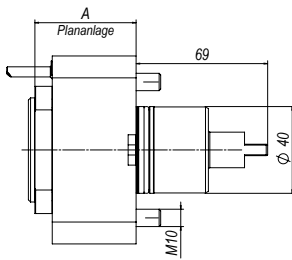

1

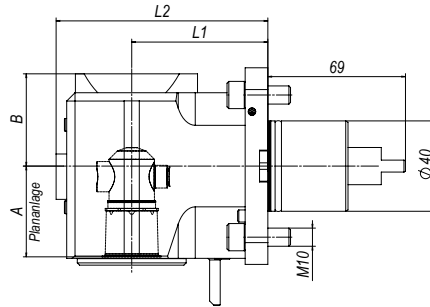

2

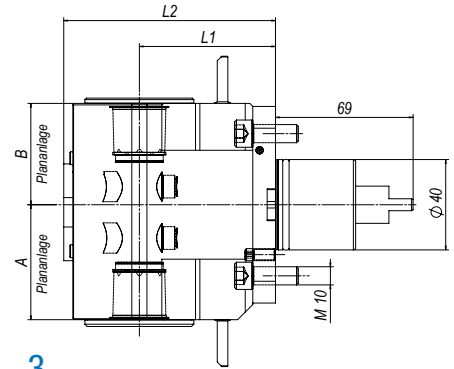

3

Angetriebene Werkzeuge | Driven tools

| Bestell-Nr. Order No. | Ausführung Tool style | Bild Figure | Aufnahme Tool holder | n [min ⁻¹] | i | T [Nm] | EK EC | IK IC | p _{max} [bar] | Maße Dimensions | | | |
|--------------------------|--------------------------|----------------|-------------------------|---------------------------|-----|-----------|----------|----------|---------------------------|-------------------|------|----------------|----------------|
| | | | | | | | | | | A | B | L ₁ | L ₂ |
| 113DA05300L3B | axial | 1 | C3 | 8.000 | 1:1 | 30 | ✓ | - | - | 50 | - | - | - |
| 113EA05300L3B | axial | 1 | C3 | 8.000 | 1:1 | 30 | ✓ | ✓ | 50 | 61 | - | - | - |
| 113FAX05339L3BD | radial | 2 | C3 | 8.000 | 1:1 | 30 | ✓ | - | - | 42 | 44 | 85 | 123,5 |
| 113GAX05339L3BD | radial | 2 | C3 | 8.000 | 1:1 | 30 | ✓ | ✓ | 100 | 42 | 67,5 | 85 | 123,5 |
| 113FAX05300L3BD2 | radial | 3 | C3 | 8.000 | 1:1 | 30 | ✓ | - | - | 52 | 44,5 | 85 | 123,5 |

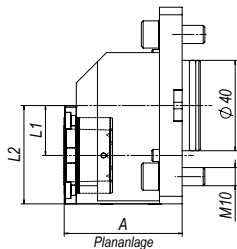

4

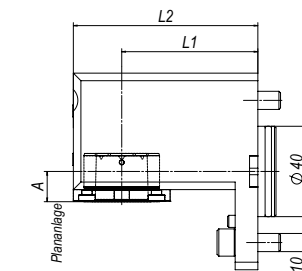

5

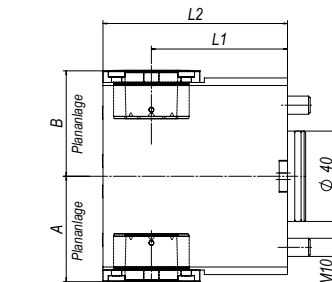

6

Statische Halter | Static tool holders

| Bestell-Nr. Order No. | Ausführung Tool style | Bild Figure | Aufnahme Tool holder | EK EC | IK IC | p _{max} [bar] | Maße Dimensions | | | |
|--------------------------|--------------------------------|----------------|-------------------------|----------|----------|---------------------------|-------------------|------|----------------|----------------|
| | | | | | | | A | B | L ₁ | L ₂ |
| 113AV053L4BDU-60 | axial versetzt axial offset | 4 | C4 | - | ✓ | 100 | 65 | - | 41 | 65 |
| 113AR053L4BDU-85 | radial | 5 | C4 | - | ✓ | 100 | 30 | - | 85 | 109 |
| 113AR053L4BD2U-85 | radial | 6 | C4 | - | ✓ | 100 | 57,5 | 57,5 | 85 | 109 |

EK: externe Kühlung, IK: interne Kühlung
Zubehör ist nicht im Lieferumfang enthalten
Technische Änderungen vorbehalten

EC: external coolant, IC: internal coolant
Accessories are not included in delivery
We reserve the right to modify technical contents

Sauter VDI 30 DIN 5480

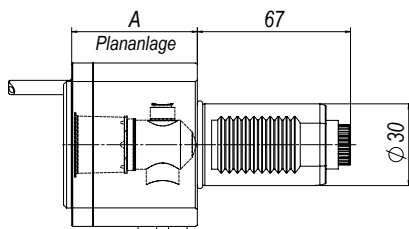
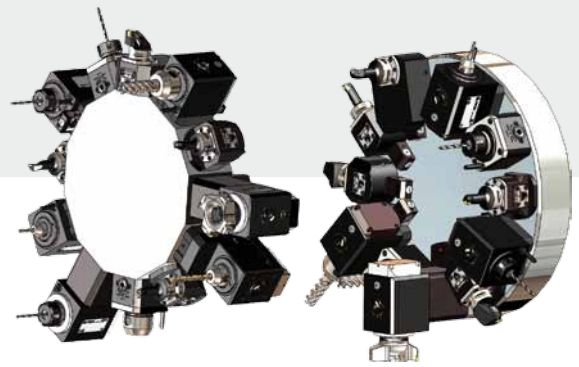

1

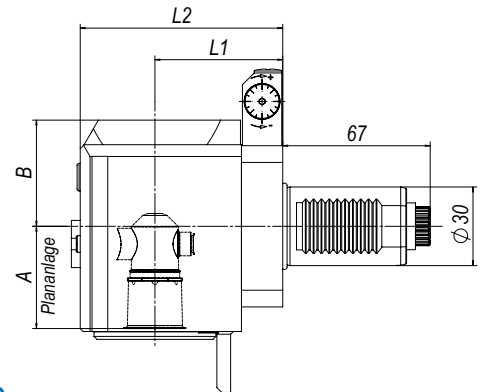

2

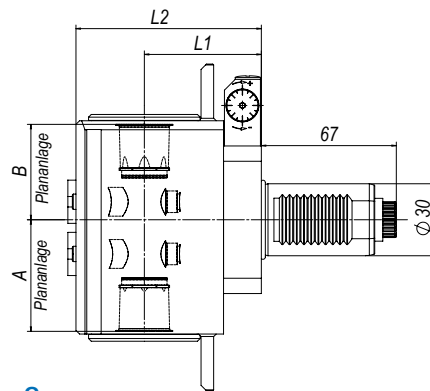

3

Rechtsausführung dargestellt
Right-handed version pictured

Angetriebene Werkzeuge | Driven tools

| Bestell-Nr. Order No. | Ausführung Tool style | Bild Figure | Aufnahme Tool holder | n [min ⁻¹] | i | T [Nm] | EK EC | IK IC | p_{max} [bar] | Maße Dimensions | | | |
|--------------------------|--------------------------|----------------|-------------------------|-----------------------------|-----|-----------|----------|----------|--------------------|-------------------|------|---------|-------|
| | | | | | | | | | | A | B | L_1^* | L_2 |
| 113DA01231L3BR | axial | 1 | C3 | 8.000 | 1:1 | 30 | ✓ | - | - | 55 | - | - | - |
| 113EA01231L3BR | axial | 1 | C3 | 8.000 | 1:1 | 30 | ✓ | ✓ | 50 | 78 | - | - | - |
| 113FAX01239L3BR | radial | 2 | C3 | 8.000 | 1:1 | 30 | ✓ | - | - | 42 | 44 | 55 | 93,5 |
| 113FAX01239L3BL | radial | 2 | C3 | 8.000 | 1:1 | 30 | ✓ | - | - | 42 | 44 | 55 | 93,5 |
| 113GAX01239L3BR | radial | 2 | C3 | 8.000 | 1:1 | 30 | ✓ | ✓ | 100 | 42 | 67,5 | 55 | 93,5 |
| 113GAX01239L3BL | radial | 2 | C3 | 8.000 | 1:1 | 30 | ✓ | ✓ | 100 | 42 | 67,5 | 55 | 93,5 |
| 113FAX01239L3BD | radial | 2 | C3 | 8.000 | 1:1 | 30 | ✓ | - | - | 42 | 44 | 55 | 93,5 |
| 113GAX01239L3BD | radial | 2 | C3 | 8.000 | 1:1 | 30 | ✓ | ✓ | 100 | 42 | 44 | 55 | 93,5 |
| 113FAX01239L3BR2-57 | radial | 3 | C3 | 8.000 | 1:1 | 30 | ✓ | - | - | 52 | 44,5 | 57 | 95,5 |

*Alle Radialwerkzeuge auch in den Längen L_1 85 mm und 100 mm erhältlich.

*All radial tools are also available with 85 mm and 100 mm length L_1 .

EK: externe Kühlung, IK: interne Kühlung
Zubehör ist nicht im Lieferumfang enthalten
Technische Änderungen vorbehalten

EC: external coolant, IC: internal coolant
Accessories are not included in delivery
We reserve the right to modify technical contents

Sauter VDI 30 DIN 5480

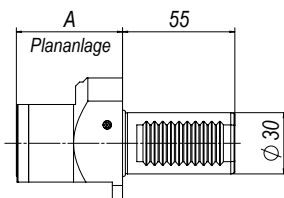
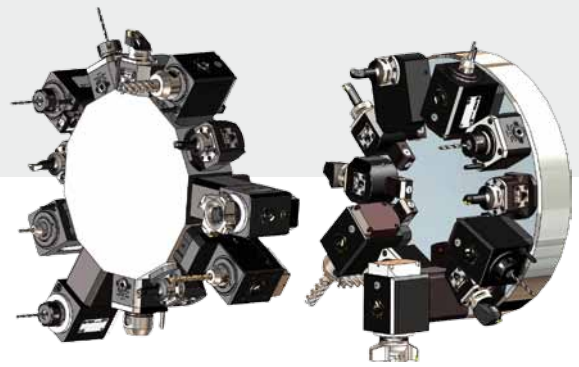

4

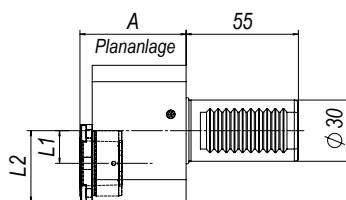

6

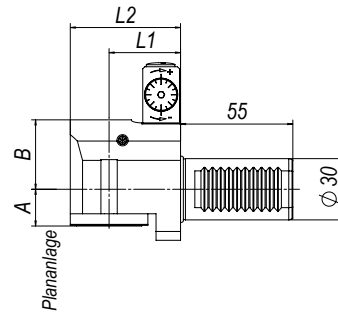

5

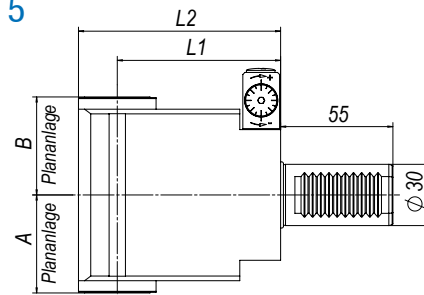

7

Rechtsausführung dargestellt
Right-handed version pictured

Statische Halter | Static tool holders

| Bestell-Nr. Order No. | Ausführung Tool style | Bild Figure | Aufnahme Tool holder | EK EC | IK IC | p _{max} [bar] | Maße Dimensions | | | |
|--------------------------|--------------------------------|----------------|-------------------------|----------|----------|------------------------|-------------------|---|------------------|----------------|
| | | | | | | | A | B | L ₁ * | L ₂ |
| 113AA100L3BRU-52 | axial | 4 | C3 | - | ✓ | 100 | 52 | - | - | - |
| 113AA100L3BLU-52 | axial | 4 | C3 | - | ✓ | 100 | 52 | - | - | - |
| 113AR100L3BRU-35 | radial | 5 | C3 | - | ✓ | 100 | 30 | - | 35 | 54 |
| 113AR100L3BLU-35 | radial | 5 | C3 | - | ✓ | 100 | 30 | - | 35 | 54 |
| 113AV100L3BRU-52 | axial versetzt axial offset | 6 | C3 | - | ✓ | 100 | 52 | - | 36 | 55 |
| 113AV100L3BLU-52 | axial versetzt axial offset | 6 | C3 | - | ✓ | 100 | 52 | - | 36 | 55 |
| 113AR012L3BRU-85 | radial | 5 | C3 | - | ✓ | 100 | 25 | - | 85 | 104 |
| 113AR012L3BLU-85 | radial | 5 | C3 | - | ✓ | 100 | 25 | - | 85 | 104 |
| 113AR012L3BR2U-85 | radial | 7 | C3 | - | ✓ | 100 | 48 | - | 85 | 104 |

*Alle Radialwerkzeuge auch in den Längen L₁ 100 mm erhältlich.

*All radial tools are also available with 100 mm length L₁.

EK: externe Kühlung, IK: interne Kühlung
Zubehör ist nicht im Lieferumfang enthalten
Technische Änderungen vorbehalten

EC: external coolant, IC: internal coolant
Accessories are not included in delivery
We reserve the right to modify technical contents

Sauter VDI 40 DIN 5480

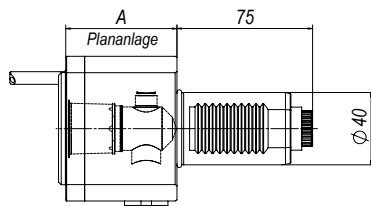
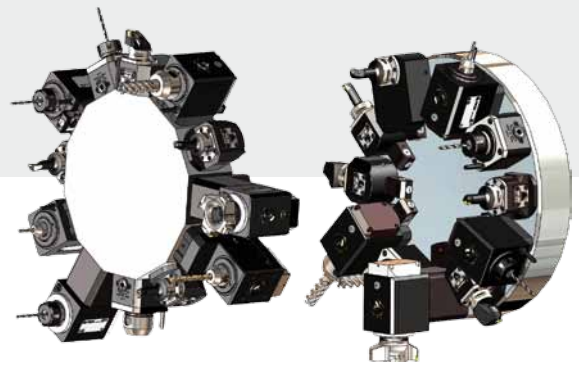

1

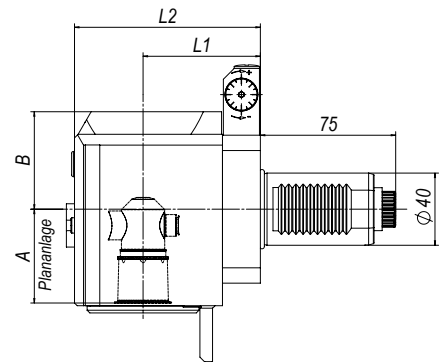

2

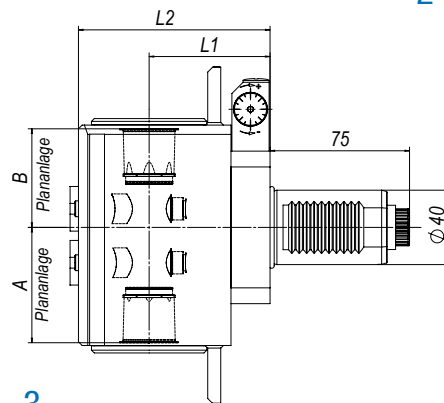

3

Rechtsausführung dargestellt
Right-handed version pictured

Angetriebene Werkzeuge | Driven tools

| Bestell-Nr. Order No. | Ausführung Tool style | Bild Figure | Aufnahme Tool holder | n [min ⁻¹] | i | T [Nm] | EK EC | IK IC | p _{max} [bar] | Maße Dimensions | | | |
|--------------------------|--------------------------|----------------|-------------------------|---------------------------|-----|-----------|----------|----------|---------------------------|-------------------|------|------------------|----------------|
| | | | | | | | | | | A | B | L ₁ * | L ₂ |
| 114DA03541L4BR | axial | 1 | C4 | 6.000 | 1:1 | 50 | ✓ | - | - | 60 | - | - | - |
| 114EA03541L4BR | axial | 1 | C4 | 6.000 | 1:1 | 50 | ✓ | ✓ | 50 | 75 | - | - | - |
| 114FAX03549L4BR | radial | 2 | C4 | 6.000 | 1:1 | 70 | ✓ | - | - | 52 | 54 | 65 | 107,5 |
| 114FAX03549L4BL | radial | 2 | C4 | 6.000 | 1:1 | 70 | ✓ | - | - | 52 | 54 | 65 | 107,5 |
| 114GAX03549L4BR | radial | 2 | C4 | 6.000 | 1:1 | 70 | ✓ | ✓ | 100 | 52 | 60,5 | 65 | 107,5 |
| 114GAX03549L4BL | radial | 2 | C4 | 6.000 | 1:1 | 70 | ✓ | ✓ | 100 | 52 | 60,5 | 65 | 107,5 |
| 114FAX03549L4BD | radial | 2 | C4 | 6.000 | 1:1 | 70 | ✓ | - | - | 52 | 54 | 65 | 107,5 |
| 114GAX03549L4BD | radial | 2 | C4 | 6.000 | 1:1 | 70 | ✓ | ✓ | 100 | 52 | 60,5 | 65 | 107,5 |
| 114FAX03549L4BR2 | radial | 3 | C4 | 6.000 | 1:1 | 70 | ✓ | - | - | 62 | 53 | 65 | 107,5 |

*Alle Radialwerkzeuge auch in den Längen L₁ 100 mm und 120 mm erhältlich.

*All radial tools are also available with 100 mm and 120 mm length L₁.

EK: externe Kühlung, IK: interne Kühlung
Zubehör ist nicht im Lieferumfang enthalten
Technische Änderungen vorbehalten

EC: external coolant, IC: internal coolant
Accessories are not included in delivery
We reserve the right to modify technical contents

Sauter VDI 40 DIN 5480

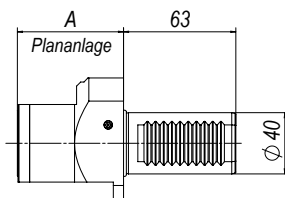
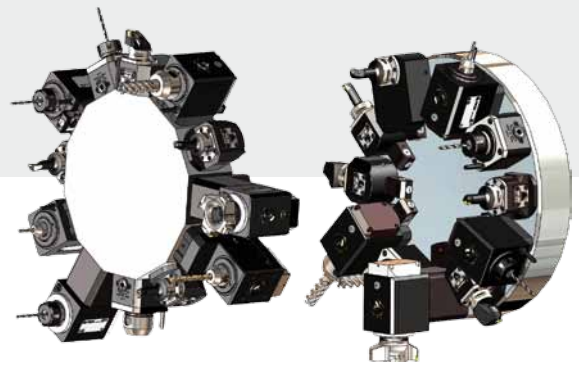

4

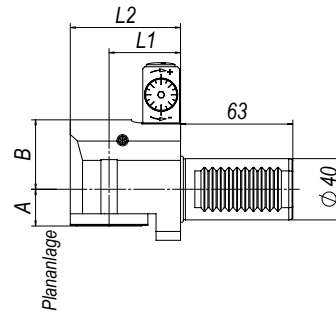

5

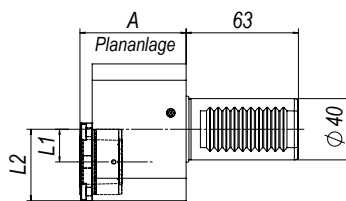

6

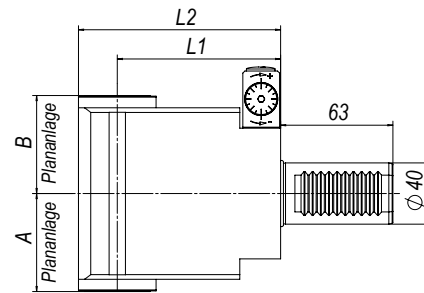

7

Rechtsausführung dargestellt
Right-handed version pictured

Statische Halter | Static tool holders

| Bestell-Nr. Order No. | Ausführung Tool style | Bild Figure | Aufnahme Tool holder | EK EC | IK IC | p _{max} [bar] | Maße Dimensions | | | |
|--------------------------|--------------------------------|----------------|-------------------------|----------|----------|------------------------|-------------------|------|------------------|----------------|
| | | | | | | | A | B | L ₁ * | L ₂ |
| 114AA100L4BRU-60 | axial | 4 | C4 | - | ✓ | 100 | 60 | - | - | - |
| 114AA100L4BLU-60 | axial | 4 | C4 | - | ✓ | 100 | 60 | - | - | - |
| 114AR100L4BRU-35 | radial | 5 | C4 | - | ✓ | 100 | 40 | - | 35 | 59 |
| 114AR100L4BLU-35 | radial | 5 | C4 | - | ✓ | 100 | 40 | - | 35 | 59 |
| 114AV100L4BRU-60 | axial versetzt axial offset | 6 | C4 | - | ✓ | 100 | 60 | - | 39 | 63 |
| 114AV100L4BLU-60 | axial versetzt axial offset | 6 | C4 | - | ✓ | 100 | 60 | - | 39 | 63 |
| 114AR035L4BRU-100 | radial | 5 | C4 | - | ✓ | 100 | 30 | - | 100 | 124 |
| 114AR035L4BLU-100 | radial | 5 | C4 | - | ✓ | 100 | 30 | - | 100 | 124 |
| 114AR035L4BR2U-100 | radial | 7 | C4 | - | ✓ | 100 | 57,5 | 57,5 | 100 | 124 |
| 114AR035L4BL2U-100 | radial | 7 | C4 | - | ✓ | 100 | 57,5 | 57,5 | 100 | 124 |

*Alle Radialwerkzeuge auch in den Längen L₁ 120 mm erhältlich.

*All radial tools are also available with 120 mm length L₁.

EK: externe Kühlung, IK: interne Kühlung
Zubehör ist nicht im Lieferumfang enthalten
Technische Änderungen vorbehalten

EC: external coolant, IC: internal coolant
Accessories are not included in delivery
We reserve the right to modify technical contents

Sauter VDI 50 DIN 5480

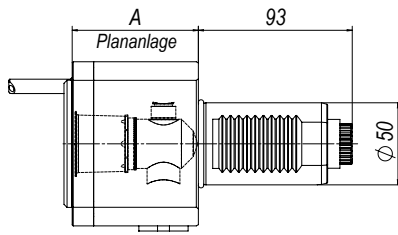
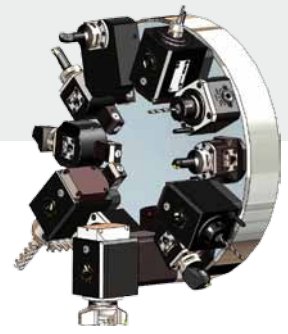

1

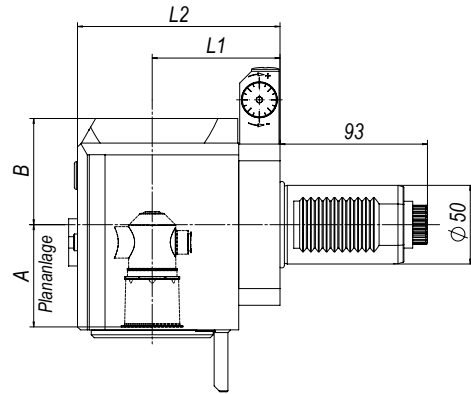

2

Rechtsausführung dargestellt
Right-handed version pictured

Angetriebene Werkzeuge | Driven tools

| Bestell-Nr. Order No. | Ausführung Tool style | Bild Figure | Aufnahme Tool holder | n [min ⁻¹] | i | T [Nm] | EK EC | IK IC | p_{max} [bar] | Maße Dimensions | | | |
|--------------------------|--------------------------|----------------|-------------------------|-----------------------------|-----|-----------|----------|----------|--------------------|-------------------|------|----------------|----------------|
| | | | | | | | | | | A | B | L ₁ | L ₂ |
| 115DA03251L5BR | axial | 1 | C5 | 6.000 | 1:1 | 100 | ✓ | - | - | 75 | - | - | - |
| 115EA03251L5BR | axial | 1 | C5 | 6.000 | 1:1 | 100 | ✓ | ✓ | 50 | 87 | - | - | - |
| 115FAX03259L5BR | radial | 2 | C5 | 6.000 | 1:1 | 150 | ✓ | - | - | 60 | 61 | 75 | 125 |
| 115FAX03259L5BL | radial | 2 | C5 | 6.000 | 1:1 | 150 | ✓ | - | - | 60 | 61 | 75 | 125 |
| 115GAX03259L5BR | radial | 2 | C5 | 6.000 | 1:1 | 150 | ✓ | ✓ | 100 | 60 | 67,5 | 75 | 125 |
| 115GAX03259L5BL | radial | 2 | C5 | 6.000 | 1:1 | 150 | ✓ | ✓ | 100 | 60 | 67,5 | 75 | 125 |

EK: externe Kühlung, IK: interne Kühlung
Zubehör ist nicht im Lieferumfang enthalten
Technische Änderungen vorbehalten

EC: external coolant, IC: internal coolant
Accessories are not included in delivery
We reserve the right to modify technical contents

Sauter VDI 50 DIN 5480

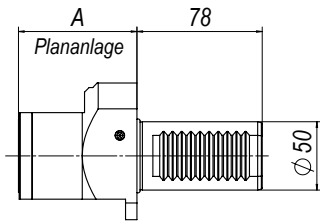
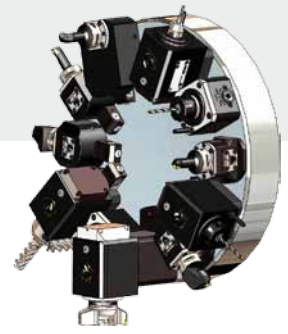

3

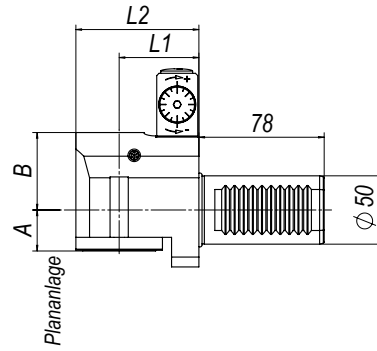

4

Rechtsausführung dargestellt
Right-handed version pictured

Statische Halter | Static tool holders

| Bestell-Nr. Order No. | Ausführung Tool style | Bild Figure | Aufnahme Tool holder | EK EC | IK IC | p _{max} [bar] | Maße Dimensions | | | |
|--------------------------|--------------------------|----------------|-------------------------|----------|----------|------------------------|-------------------|---|----------------|----------------|
| | | | | | | | A | B | L ₁ | L ₂ |
| 115AA100L5BRU-73 | axial | 3 | C5 | - | ✓ | 100 | 73 | - | - | - |
| 115AA100L5BLU-73 | axial | 3 | C5 | - | ✓ | 100 | 73 | - | - | - |
| 115AR100L5BRU-45 | radial | 4 | C5 | - | ✓ | 100 | 40 | - | 45 | 77 |
| 115AR100L5BLU-45 | radial | 4 | C5 | - | ✓ | 100 | 40 | - | 45 | 77 |

EK: externe Kühlung, IK: interne Kühlung
Zubehör ist nicht im Lieferumfang enthalten
Technische Änderungen vorbehalten

EC: external coolant, IC: internal coolant
Accessories are not included in delivery
We reserve the right to modify technical contents

Nakamura BMT Ø55



Nakamura BMT Ø55

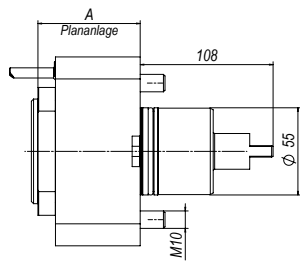

1

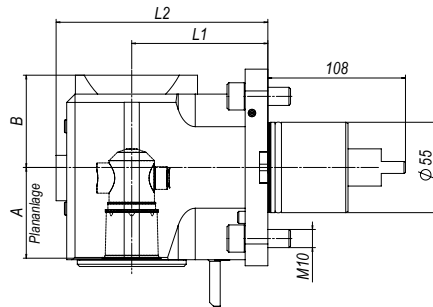

2

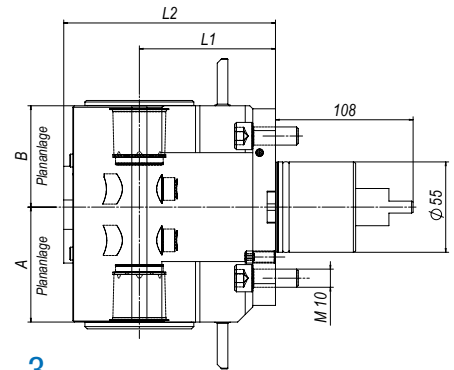

3

Angetriebene Werkzeuge | Driven tools

| Bestell-Nr. Order No. | Ausführung Tool style | Bild Figure | Aufnahme Tool holder | n [min ⁻¹] | i | T [Nm] | EK EC | IK IC | p _{max} [bar] | Maße Dimensions | | | |
|--------------------------|--------------------------|----------------|-------------------------|---------------------------|-----|-----------|----------|----------|---------------------------|-------------------|------|----------------|----------------|
| | | | | | | | | | | A | B | L ₁ | L ₂ |
| 113DA01500L3B | axial | 1 | C3 | 8.000 | 1:1 | 30 | ✓ | - | - | 48 | - | - | - |
| 113EA01500L3B | axial | 1 | C3 | 8.000 | 1:1 | 30 | ✓ | ✓ | 50 | 60 | - | - | - |
| 113FAX01539L3BD | radial | 2 | C3 | 8.000 | 1:1 | 30 | ✓ | - | - | 42 | 44 | 75 | 113,5 |
| 113GAX01539L3BD | radial | 2 | C3 | 8.000 | 1:1 | 30 | ✓ | ✓ | 100 | 42 | 67,5 | 75 | 113,5 |
| 113FAX01500L3BD2 | radial | 3 | C3 | 8.000 | 1:1 | 30 | ✓ | - | - | 52 | 44,5 | 75 | 113,5 |

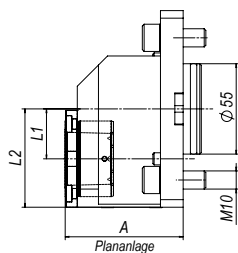

4

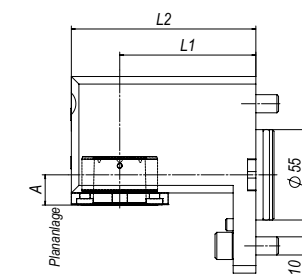

5

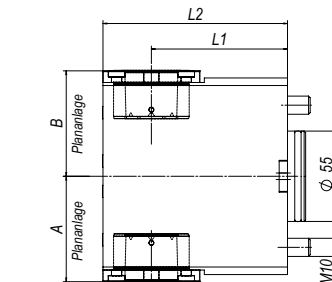

6

Statische Halter | Static tool holders

| Bestell-Nr. Order No. | Ausführung Tool style | Bild Figure | Aufnahme Tool holder | EK EC | IK IC | p _{max} [bar] | Maße Dimensions | | | |
|--------------------------|--------------------------------|----------------|-------------------------|----------|----------|---------------------------|-------------------|----|----------------|----------------|
| | | | | | | | A | B | L ₁ | L ₂ |
| 113AV015L3BDU-51 | axial versetzt axial offset | 4 | C3 | - | ✓ | 100 | 51 | - | 21 | 40 |
| 113AR015L3BDU-75 | radial | 5 | C3 | - | ✓ | 100 | 11 | - | 75 | 94 |
| 113AR015L3BD2U-75 | radial | 6 | C3 | - | ✓ | 100 | 48 | 48 | 75 | 94 |

EK: externe Kühlung, IK: interne Kühlung
Zubehör ist nicht im Lieferumfang enthalten
Technische Änderungen vorbehalten

EC: external coolant, IC: internal coolant
Accessories are not included in delivery
We reserve the right to modify technical contents

Nakamura BMT Ø65



Nakamura BMT Ø65

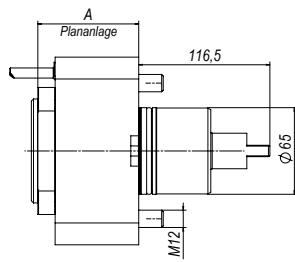

1

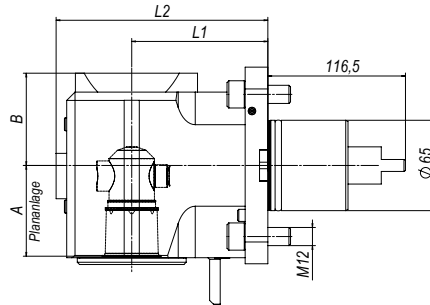

2

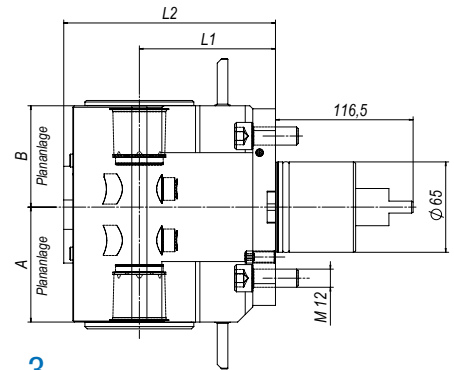

3

Angetriebene Werkzeuge | Driven tools

| Bestell-Nr. Order No. | Ausführung Tool style | Bild Figure | Aufnahme Tool holder | n [min ⁻¹] | i | T [Nm] | EK EC | IK IC | p _{max} [bar] | Maße Dimensions | | | |
|--------------------------|--------------------------|----------------|-------------------------|---------------------------|-----|-----------|----------|----------|---------------------------|-------------------|------|----------------|----------------|
| | | | | | | | | | | A | B | L ₁ | L ₂ |
| 114DA05100L4B | axial | 1 | C4 | 6.000 | 1:1 | 50 | ✓ | - | - | 59 | - | - | - |
| 114EA05100L4B | axial | 1 | C4 | 6.000 | 1:1 | 50 | ✓ | ✓ | 50 | 72 | - | - | - |
| 114FAX05149L4BD | radial | 2 | C4 | 6.000 | 1:1 | 70 | ✓ | - | - | 52 | 54 | 65 | 107,5 |
| 114GAX05149L4BD | radial | 2 | C4 | 6.000 | 1:1 | 70 | ✓ | ✓ | 100 | 52 | 60,5 | 65 | 107,5 |
| 114FAX05100L4BD2 | radial | 3 | C4 | 6.000 | 1:1 | 70 | ✓ | - | - | 60 | 55 | 65 | 107,5 |

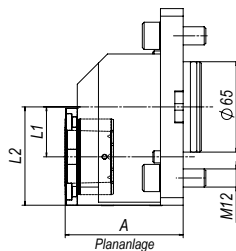

4

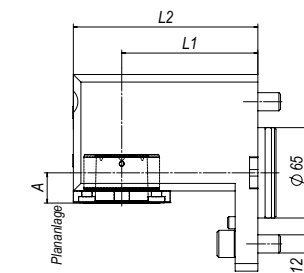

5

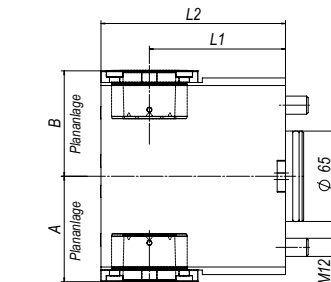

6

Statische Halter | Static tool holders

| Bestell-Nr. Order No. | Ausführung Tool style | Bild Figure | Aufnahme Tool holder | EK EC | IK IC | p _{max} [bar] | Maße Dimensions | | | |
|--------------------------|--------------------------------|----------------|-------------------------|----------|----------|---------------------------|-------------------|------|----------------|----------------|
| | | | | | | | A | B | L ₁ | L ₂ |
| 114AV051L4BDU-60 | axial versetzt axial offset | 4 | C4 | - | ✓ | 100 | 60 | - | 26 | 50 |
| 114AR051L4BDU-65 | radial | 5 | C4 | - | ✓ | 100 | 20 | - | 65 | 84 |
| 114AR051L4BD2U-65 | radial | 6 | C4 | - | ✓ | 100 | 57,5 | 57,5 | 65 | 89 |

EK: externe Kühlung, IK: interne Kühlung
Zubehör ist nicht im Lieferumfang enthalten
Technische Änderungen vorbehalten

EC: external coolant, IC: internal coolant
Accessories are not included in delivery
We reserve the right to modify technical contents

BENZ CAPTO™ Adapter C3, C4, C5

Ohne Greiferrille!
Without gripper groove!

Weldon DIN 1835 B
Weldon DIN 1835 B

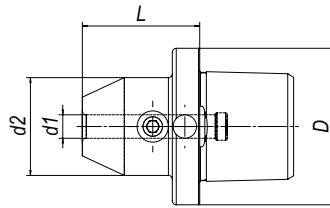

Weldon **C3**

| Bestell-Nr. Order No. | d1 | d2 | D | L |
|--------------------------|----|----|----|----|
| 550.1400633 | 6 | 25 | 32 | 33 |
| 550.1400833 | 8 | 28 | 32 | 33 |
| 550.1401037 | 10 | 35 | 32 | 37 |
| 550.1401242 | 12 | 42 | 32 | 42 |
| 550.1401443 | 14 | 44 | 32 | 43 |
| 550.1401651 | 16 | 48 | 32 | 51 |

Weldon **C4**

| Bestell-Nr. Order No. | d1 | d2 | D | L |
|--------------------------|----|----|----|----|
| 551.1400630 | 6 | 25 | 40 | 30 |
| 551.1400830 | 8 | 28 | 40 | 30 |
| 551.1401034 | 10 | 35 | 40 | 34 |
| 551.1401239 | 12 | 42 | 40 | 39 |
| 551.1401439 | 14 | 44 | 40 | 39 |
| 551.1401643 | 16 | 48 | 40 | 43 |
| 551.1401843 | 18 | 50 | 40 | 43 |
| 551.1402045 | 20 | 52 | 40 | 45 |

Weldon **C5**

| Bestell-Nr. Order No. | d1 | d2 | D | L |
|--------------------------|----|----|----|----|
| 552.1400629 | 6 | 25 | 50 | 29 |
| 552.1400829 | 8 | 28 | 50 | 29 |
| 552.1401033 | 10 | 35 | 50 | 33 |
| 552.1401238 | 12 | 42 | 50 | 38 |
| 552.1401438 | 14 | 44 | 50 | 38 |
| 552.1401641 | 16 | 48 | 50 | 41 |
| 552.1401842 | 18 | 50 | 50 | 42 |
| 552.1402044 | 20 | 52 | 50 | 44 |
| 552.1402552 | 25 | 65 | 50 | 52 |

Spannzangenfutter 8° Typ ER
Collet chucks 8° type ER

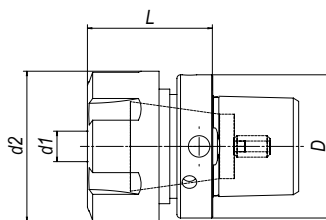

Spannzange | Collet chuck **C3**

| Bestell-Nr. Order No. | d1 | d2 | D | L |
|--------------------------|------|----|----|----|
| 550.130E330 | ER16 | 28 | 32 | 30 |
| 550.130E435 | ER20 | 34 | 32 | 35 |
| 550.130E544 | ER25 | 42 | 32 | 44 |

Spannzange | Collet chuck **C4**

| Bestell-Nr. Order No. | d1 | d2 | D | L |
|--------------------------|------|----|----|----|
| 551.130E432 | ER20 | 34 | 40 | 32 |
| 551.130E535 | ER25 | 42 | 40 | 35 |
| 551.130E652 | ER32 | 50 | 40 | 52 |

Spannzange | Collet chuck **C5**

| Bestell-Nr. Order No. | d1 | d2 | D | L |
|--------------------------|------|----|----|----|
| 552.130E534 | ER25 | 42 | 50 | 34 |
| 552.130E641 | ER32 | 50 | 50 | 41 |
| 552.130E758 | ER40 | 63 | 50 | 58 |

Aufsteckfräsdorne
Milling machine arbors

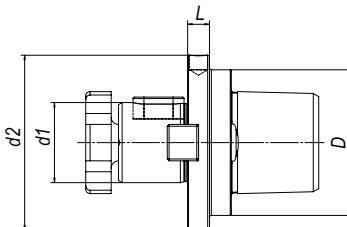

Fräsdorn | Milling arbor **C3**

| Bestell-Nr. Order No. | d1 | d2 | D | L |
|--------------------------|----|----|----|----|
| 550.2311613 | 16 | 34 | 32 | 13 |
| 550.2312217 | 22 | 48 | 32 | 17 |

Fräsdorn | Milling arbor **C4**

| Bestell-Nr. Order No. | d1 | d2 | D | L |
|--------------------------|----|----|----|----|
| 551.2312216 | 22 | 48 | 40 | 16 |
| 551.2312719 | 27 | 51 | 40 | 19 |

Fräsdorn | Milling arbor **C5**

| Bestell-Nr. Order No. | d1 | d2 | D | L |
|--------------------------|----|----|----|----|
| 552.2312711 | 27 | 55 | 50 | 11 |
| 552.2313222 | 32 | 62 | 50 | 22 |

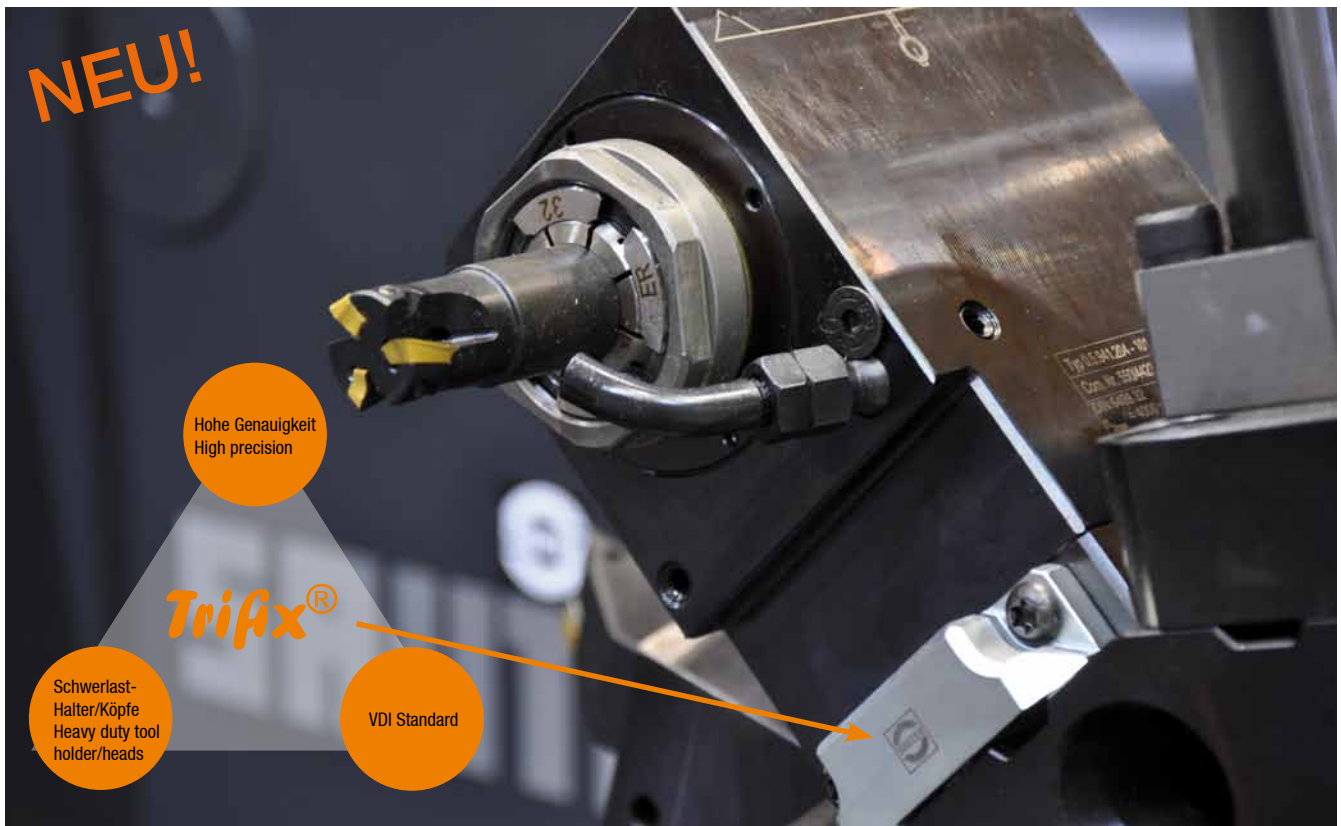

Nur für Gildemeister **Trifix®** Revolver | Only for Gildemeister **Trifix®** turret

GILDEMEISTER

BENZ, lizenzierter Systempartner von DMG

- Hohe Positioniergenauigkeit ohne Ausrichtaufwand
- Stabile Anbindung durch eine zusätzliche Ausrichtleiste
- Für Schwerzerspannung sehr gut geeignet
- Vorausgerichtet auf jedem Revolverplatz sofort einsetzbar
- Ausführungen auf Anfrage

BENZ, licensed system partner of DMG

- *High positioning accuracy without alignment effort*
- *Rigid connection ensured by additional alignment rail*
- *Excellently applicable for heavy duty machining*
- *Preset units can be used immediately at any turret place*
- *Additional designs on request*



BENZ GmbH Werkzeugsysteme
Im Mühlegrün 12
77716 Haslach
Deutschland | Germany
Fon +49.7832.704 - 8400
Fax +49.7832.704 - 21
www.benz-tools.de
metal@benz-tools.de

EIN UNTERNEHMEN DER | MEMBER OF

