



**Commercial Opportunities**

For lease  
Broadway and Birch







Possession Q1 - 2026

Potential Unit Sizes | All sizes are in SQ FT

CRU 1	2,418 SF	Retail
CRU 2	1,669 SF	Retail
CRU 3	1,223 SF	Retail
CRU 4	806 SF	Retail
CRU 5	1,027 SF	Retail
CRU 6	992 SF	Retail
CRU 7	274 SF	Retail
Second Floor		
CRU 10	16,108 SF	Office/Retail

Additional Rent (2023 est.)  
\$ 23.00 PSF



Location

Located in the City of Vancouver at the corner of Broadway & Birch, the location has 2 levels of commercial opportunities and 25 stories of residential with 258 units. The ground floor units have high ceilings with ample frontage to West Broadway. The 2nd floor opportunity has a private entrance for a single retail or office user. Already under construction, possession is slated for Q1 2026.



5 minute walk to new South Granville skytrain station opening 2026



Private entrance off Broadway for 2nd floor opportunity



Street Parking and designated underground commercial stalls



High visibility along West Broadway



Vancouver  
British Columbia



Site Details



**Civic Address**  
2538 Birch Street, Vancouver, BC



**Site Area**  
258 residential units, 25 stories and 2 commercial levels



**Zoning**  
CD-1



**Parking**  
30 commercial parking stalls



**Completion**  
Q1 2026

Property Highlights



9 Min to Downtown



Fronting the West  
Broadway corridor

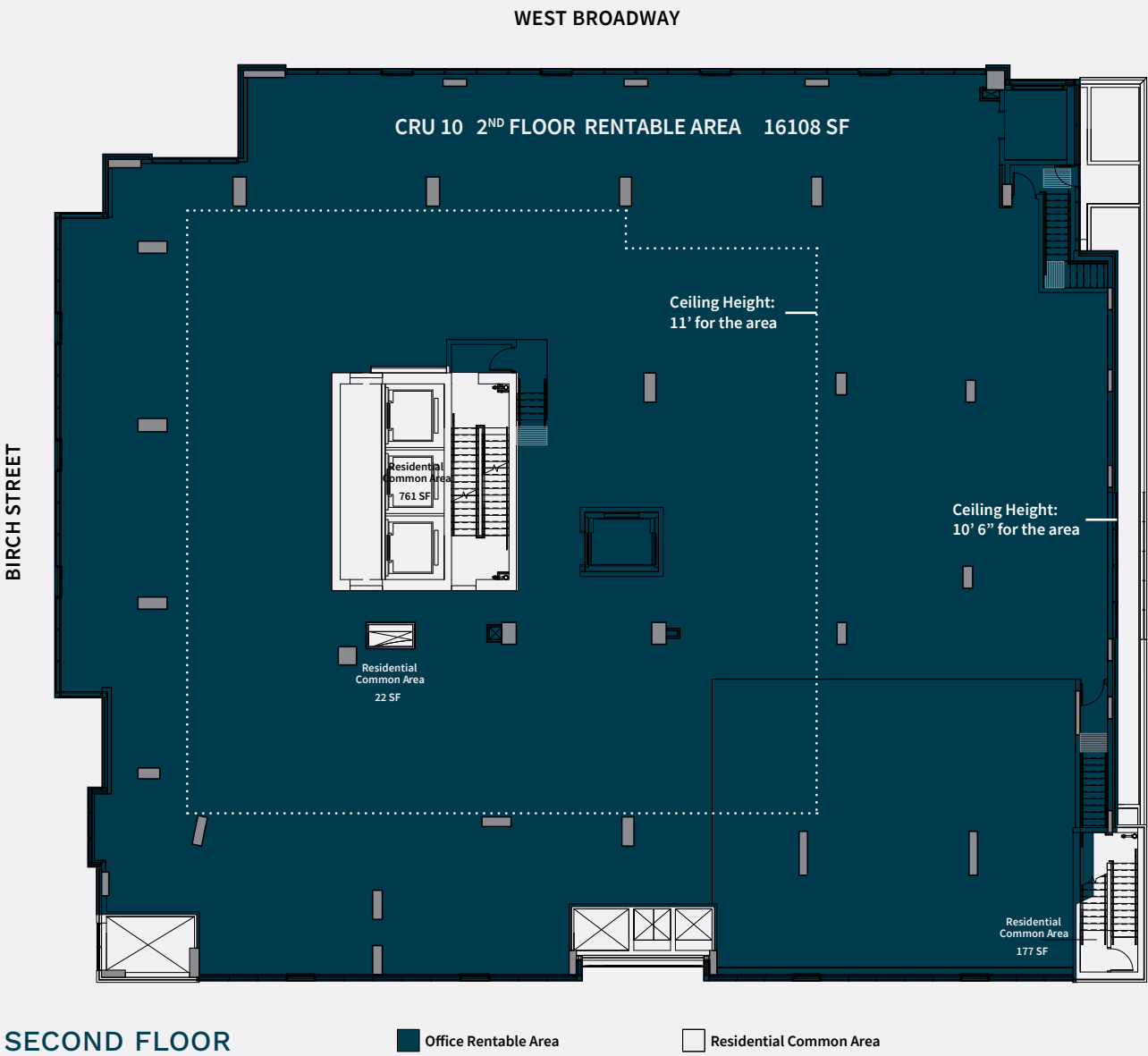





## Demographics

	1 km	3 km	5 km
 <b>Population</b>	29,693	246,022	426,853
 <b>Households</b>	17,027	132,523	208,614
 <b>Avg. Household Income</b>	\$127,828	\$129,389	\$130,585
 <b>Total Expenditure</b> <small>Avg. Household Income</small>	\$117,761	\$123,545	\$129,235

Source: Statistics Canada, 2024

**Connor O'Keeffe\***  
Vice President  
+1 604 628 4339  
connor.okeeffe@jll.com



**jll.ca**  
510 West Georgia Street, Suite 2150  
Vancouver, BC V6B 0M3  
Jones Lang LaSalle Real Estate Services, Inc.

© 2024 Jones Lang LaSalle Real Estate Services, Inc. All rights reserved. Information set out herein (the "Information") has not been verified by Jones Lang LaSalle Real Estate Services, Inc., Brokerage and any and all of its real estate agents/staff, and to all other divisions of the company (collectively "JLL"). JLL does not represent, warrant or guarantee the accuracy, correctness and completeness of the Information. Given the limitations of the investigations, inquiries and verification that JLL have undertaken, the reliability of this Information must be treated with a suitable degree of caution and neither JLL or any of their affiliates accept any liability or responsibility for the accuracy or completeness of the information contained herein and no reliance should be placed on the information contained in this document. JLL does not accept or assume any responsibility or liability, direct or consequential, for the Information or the recipient's reliance upon the Information. The recipient of the Information should take such steps as the recipient may deem necessary to verify the Information prior to placing any reliance upon the Information. The Information may change and any property described in the Information may be withdrawn from the market at any time without notice or obligation to the recipient from JLL. \*Personal Real Estate Corporation