

**FOR SUBLEASE**

**10,977 SF**

**IN THE HEART OF DOWNTOWN MONTREAL**

**FULLY FURNISHED, VERSATILE CLASSROOM SPACE**

**1265**

BERRI STREET





# 1265 BERRI

Located in the dynamic Ville-Marie borough, in the heart of downtown Montreal, 1265 rue Berri is in a neighborhood known for its mix of historic charm, urban life and cultural diversity. Close to cafés, restaurants and art galleries, it is served by Montreal's orange, green and yellow lines (Berri-UQAM stations) and is also accessible by major arteries such as Boulevard De Maisonneuve and rue Sainte-Catherine Est.



## HIGHLIGHTS



**PRIME LOCATION FOR  
ACADEMIC INSTITUTION**



**IMMEDIATE OCCUPANCY  
FULLY FURNISHED**



**HIGHLY ACCESSIBLE  
1-MIN WALK TO METRO**



**SINGLE TENANT OCCUPANCY  
FOR THE ENTIRE 3RD FLOOR**







## SPACE OVERVIEW

Floor:	3rd Floor - 10,977 SF
Sublease Term:	May 31 <sup>st</sup> , 2027
Availability:	30 days
Net Rent:	Contact Broker
Additional Rent:	\$12.28 PSF Electricity & Daily cleaning included









## 3RD FLOOR

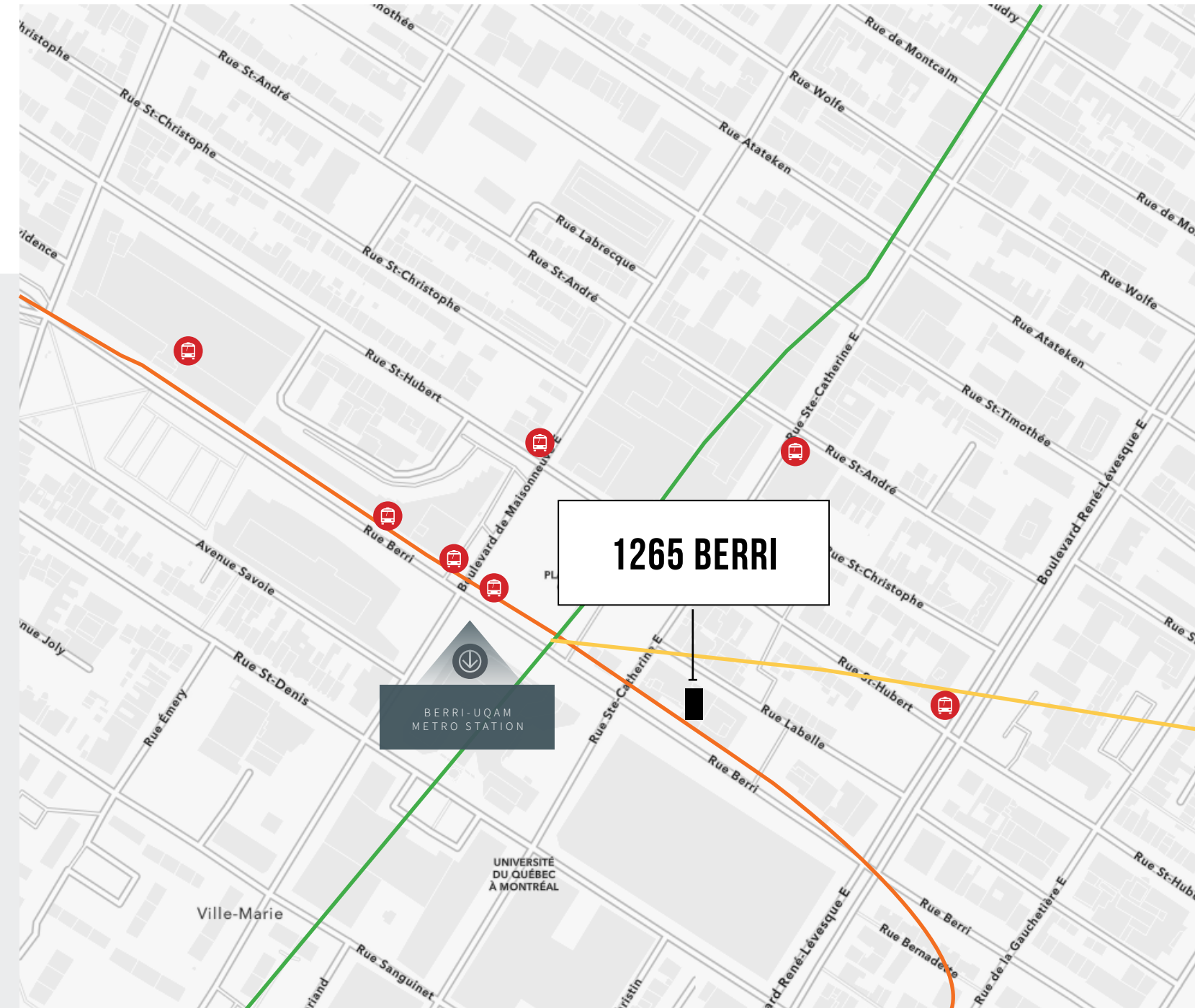
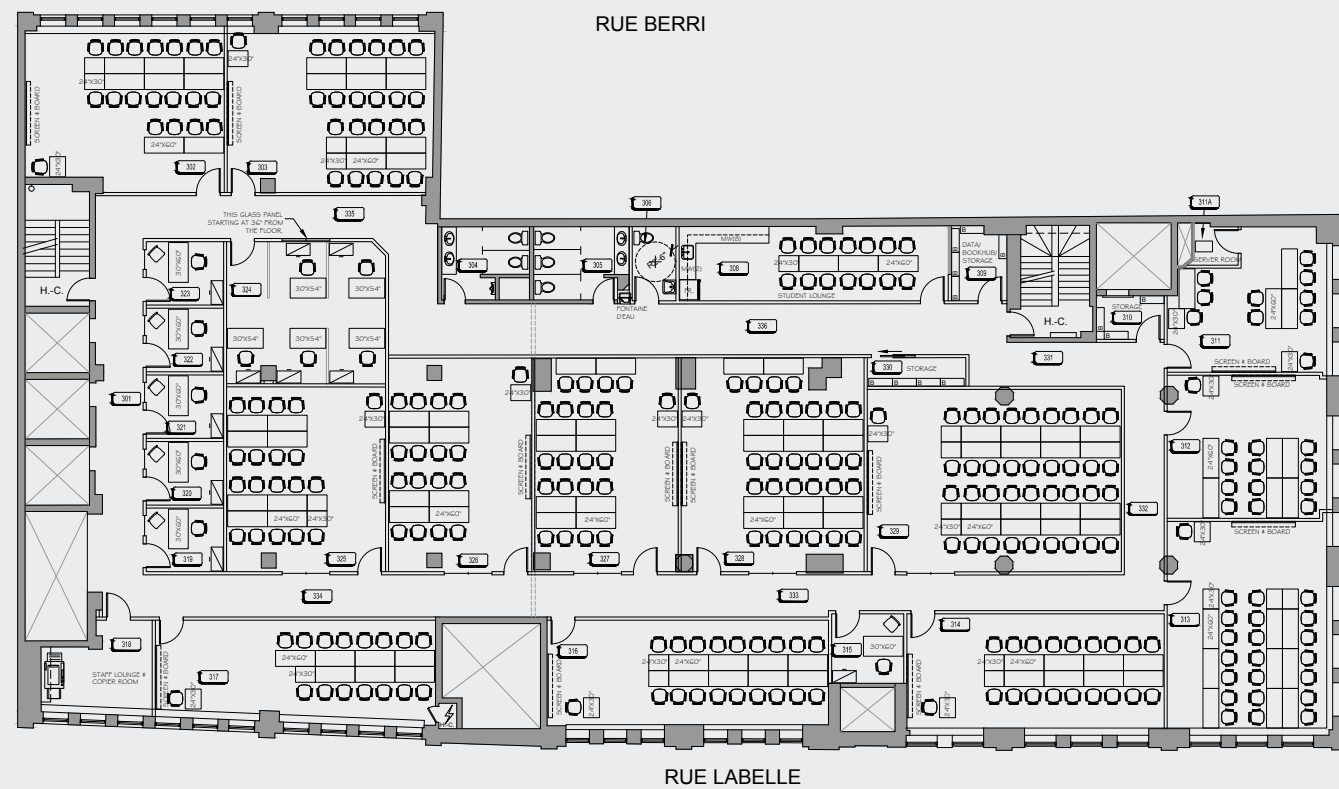

# AREA ACCESSIBILITY

**METRO**

   1 minute walk: Berri-UQAM Metro Station

## BUS

 747, 361, 30, 358, 15, 715, 14, 350, 355, 445

## FOR MORE INFORMATION, PLEASE CONTACT:

### **Michel (Michael) Belina\***

Executive Vice President

Real Estate Broker

Jones Lang Lasalle Real Estate Services, Inc. (Real Estate Agency)

+1 514 886 3010

michael.belina@jll.com

\*Real Estate Broker acting with the business corporation Services  
Immobiliers Michel Belina Inc.

### **Erika Ricupero**

Associate

Real Estate Broker

Jones Lang Lasalle Real Estate Services, Inc. (Real Estate Agency)

+1 514 838 8710

erika.ricupero@jll.com

Copyright © Jones Lang LaSalle IP, Inc. 2025

This publication is the sole property of Jones Lang LaSalle and must not be copied, reproduced or transmitted in any form or by any means, either in whole or in part, without the prior written consent of Jones Lang LaSalle. The information contained in this publication has been obtained from sources generally regarded to be reliable. However, no representation is made, or warranty given, in respect of the accuracy of this information. We would like to be informed of any inaccuracies so that we may correct them. Jones Lang LaSalle does not accept any liability in negligence or otherwise for any loss or damage suffered by any party resulting from reliance on this publication. Jones Lang LaSalle Americas, Inc., license # 5674-7835-01.

Any opinion or estimate of value of any asset in this presentation is based upon the high-level preliminary review by JLL. It is not the same as the opinion of value in an appraisal developed by a licensed appraiser under the Uniform Standards of Professional Appraisal Practice. JLL expressly disclaims any liability for any reliance on any opinion or estimate of value in this presentation by any party.

