

For sale or lease

58,738 square feet on 2.55 acres
5310 - 1st Street SW, Calgary

- Central market space
- Dock and drive-in loading
- Multiple demising scenarios
- Layout can be reconfigured
- Close proximity to downtown and central southeast roadways



District	Manchester	
Zoning	I-G (Industrial General)	
Site Size	2.55 acres	
Building Size	Office:	6,990 SF
	Warehouse:	36,341 SF
	Production:	11,827 SF
	Mezzanine:	3,580 SF
	Total:	58,738 SF
	<i>Multiple demising scenarios available for lease</i>	
Ceiling Height	24' clear	

Sale Price	Market
Property Tax	\$162,623.08 (2025)
Lease Rate	Market
Op. Costs	\$4.75 PSF (2024)
Heating	Forced air
Loading	9 dock doors 1 drive-in door <i>Potential for additional 2 dock doors</i>
Power	600 amps, 600 volts
Parking	72 surface stalls

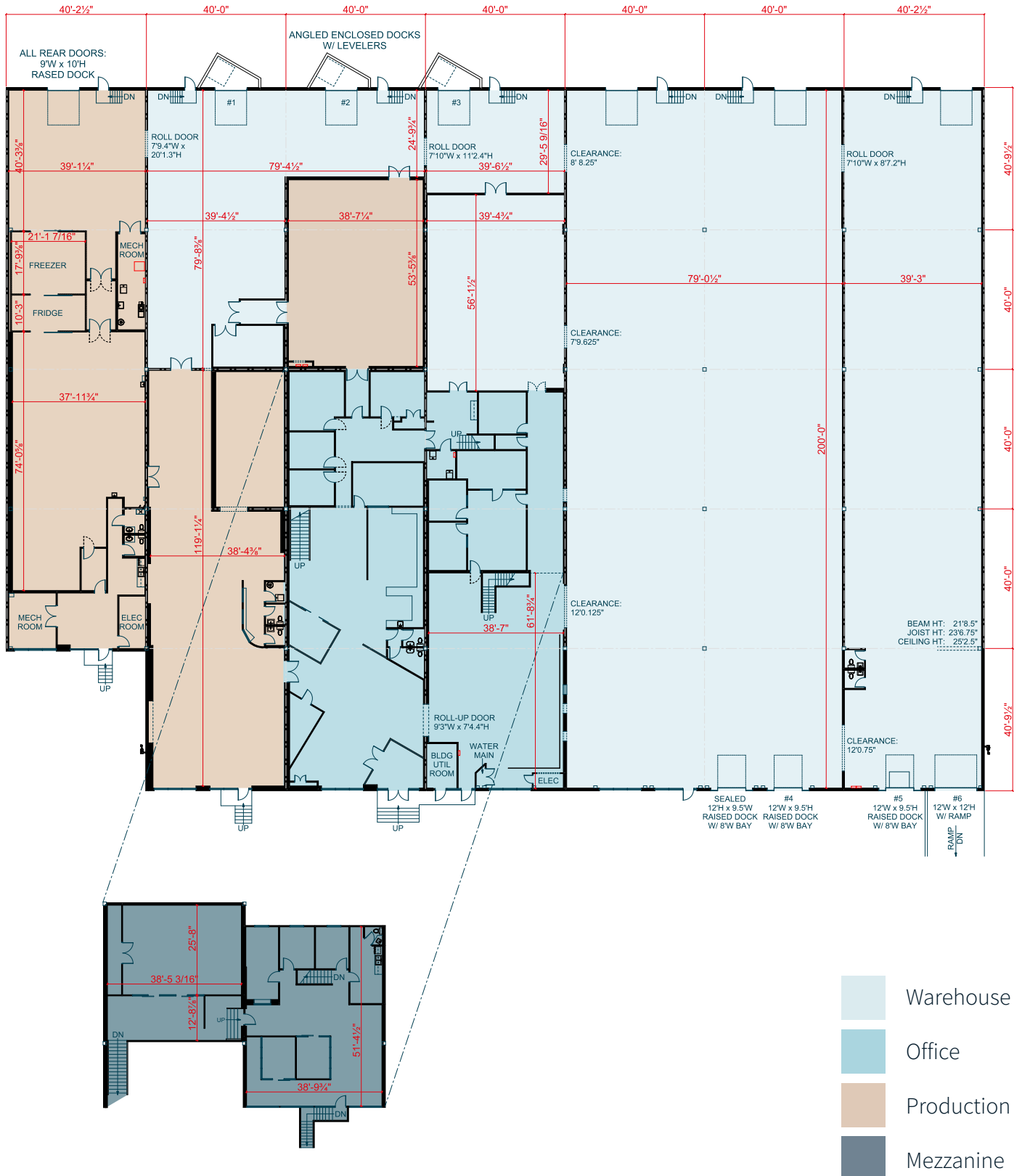



Approximate Drive Times

Transportation Routes

- Glenmore Trail **5 min**
- Deerfoot Trail **9 min**
- Trans-Canada Hwy **15 min**

Destination Places

- Chinook Centre **7 min**
- Downtown Calgary **11 min**
- Calgary Int'l Airport **36 min**

jll.ca

Contact us for more information

jll.ca

Ryan Haney

Lead Broker

Executive Vice President

+1 403 456 2221

ryan.haney@jll.com

Austin Smith

Lead Broker

Vice President

+1 403 456 2197

austin.smith@jll.com

Troy Robinson

Lead Broker

Associate

+1 403 670 7353

troy.robinson@jll.com

Marshall Toner

EVP, National Industrial

+1 403 456 2214

marshall.toner@jll.com

Chris Saunders

Executive Vice President

+1 403 456 2218

chris.saunders@jll.com

Carey Koroluk

Vice President

+1 403 456 2346

carey.koroluk@jll.com