

LAST REMAINING BAY



For Lease

## 41 Flex Bays

9527 41 Avenue | Edmonton, AB

Bays starting at  $\pm 11,200$  SF

- Functional dock loading warehouse
- Four access points into site with ample customer parking
- Demising options and office build-outs available

For more information contact:

**Kent Simpson**

Vice President

780 203 0425

[Kent.Simpson@jll.com](mailto:Kent.Simpson@jll.com)

**Bronwyn Scrivens**

Vice President, SIOR

780 807 4564

[Bronwyn.Scrivens@jll.com](mailto:Bronwyn.Scrivens@jll.com)

**Mackenzie York**

Associate Vice President

780 920 8463

[Mackenzie.York@jll.com](mailto:Mackenzie.York@jll.com)





## Property Details

<b>Municipal Address</b>	9527-37 41 Avenue
<b>Available Area</b>	± 11,200 SF
<b>Zoning</b>	BE - Business Employment
<b>Power</b>	100 & 150 Amp, 120/208 volt, 3 phase
<b>Ceiling Height</b>	20'
<b>Heating</b>	RTU in Office, ceiling mounted forced air unit heaters in warehouse
<b>Lighting</b>	Upgraded to LED throughout
<b>Loading</b>	9527/31- Dock doors
<b>Parking</b>	Unassigned - first come, first served
<b>Lease Rate (PSF)</b>	\$9.75
<b>Op. Costs (PSF)</b>	\$5.10 - Includes Water
<b>Property Taxes (PSF)</b>	\$3.20
<b>Occupancy</b>	Immediate

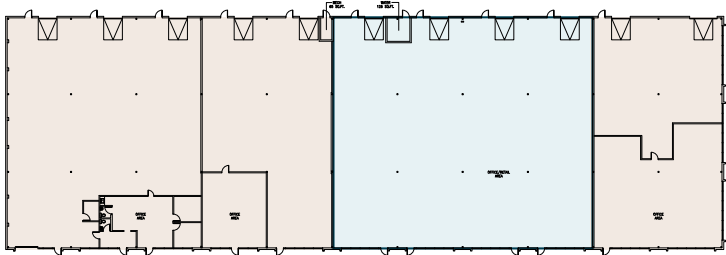

9527/31 41 Avenue

± 11,200 SF | (4) Dock doors

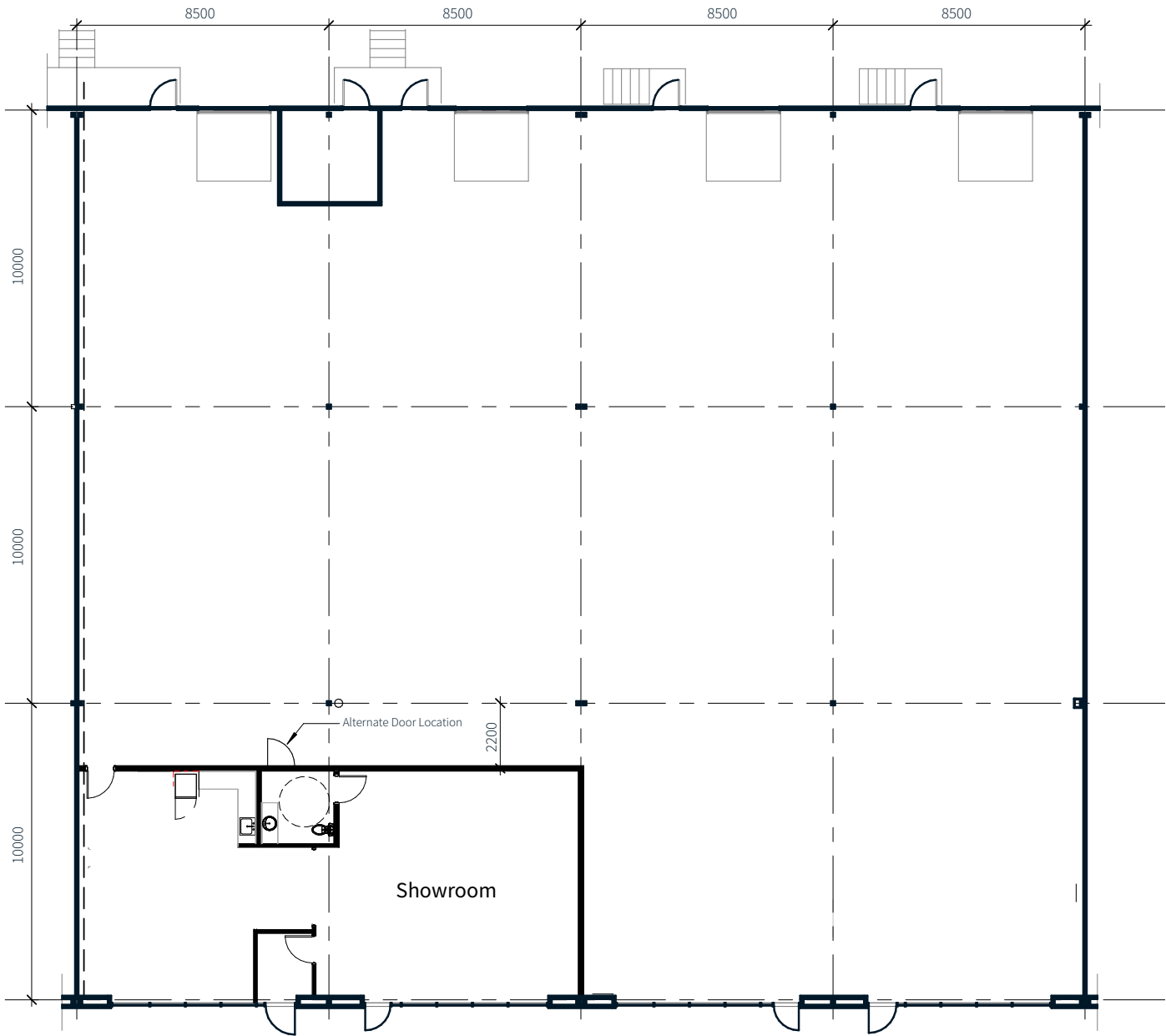

\*Build-out in progress



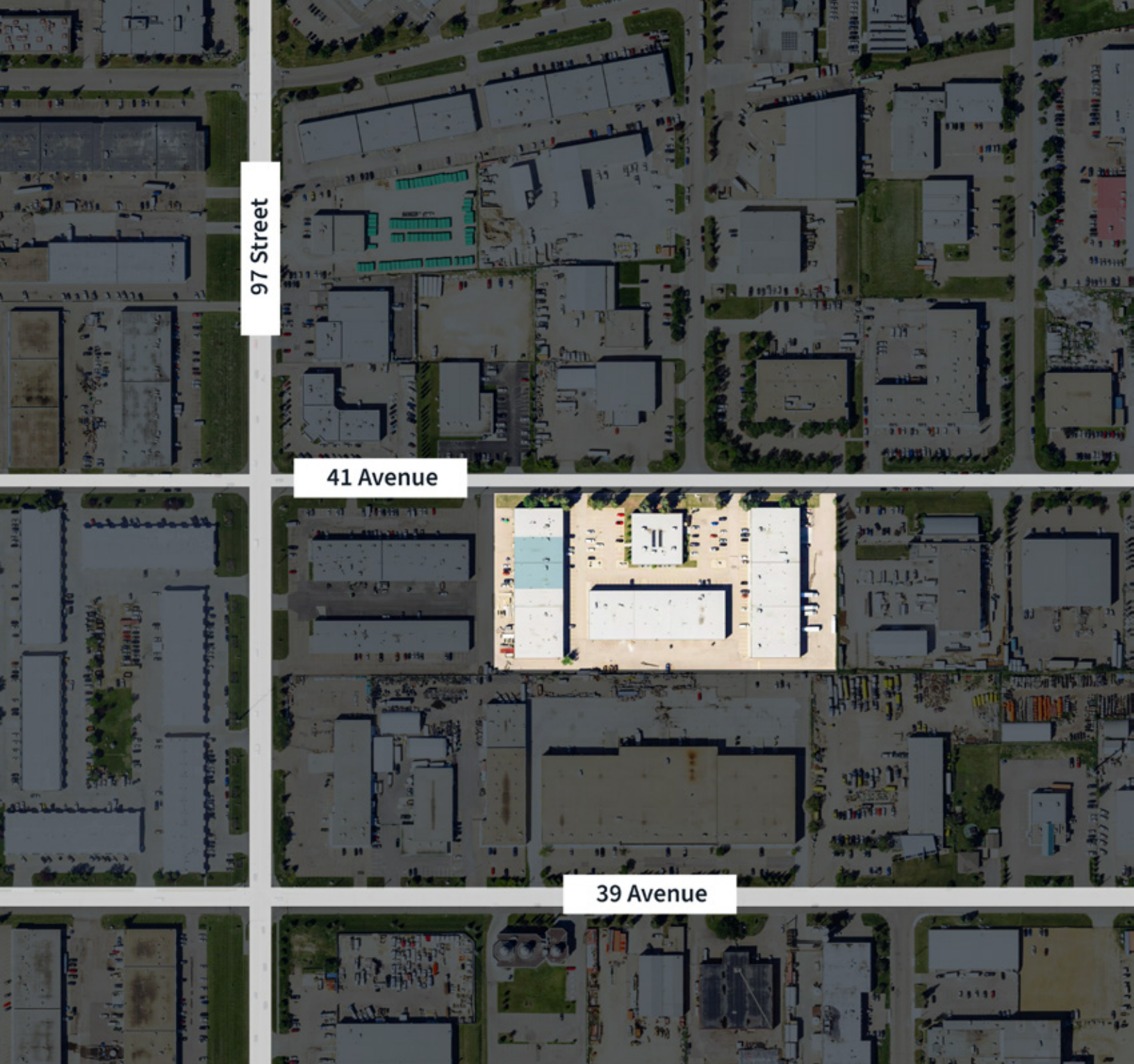

Four building business park with flexible Business Employment zoning and a diverse, existing tenant mix

South Central location with close proximity to Whitemud Drive, 99 Street, and 91 Street and large southeast residential communities







Whitemud Dr.

97 Street

91 Street

39 Avenue

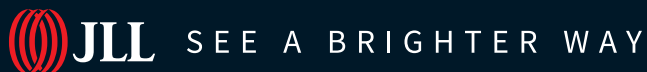

**Darryl McGavigan**  
Executive Vice President  
780 328 0064  
Darryl.McGavigan@jll.com

**Kent Simpson**  
Vice President  
780 203 0425  
Kent.Simpson@jll.com

**Adam Butler**  
Executive Vice President  
780 328 0065  
Adam.Butler@jll.com

**Mackenzie York**  
Associate Vice President  
780 920 8463  
Mackenzie.York@jll.com

**Bronwyn Scrivens**  
Vice President, SIOR  
780 807 4564  
Bronwyn.Scrivens@jll.com

**Kailee Campbell**  
Senior Transaction Analyst  
780 328 0069  
Kailee.Campbell@jll.com

**JLL Edmonton Industrial** | Suite 2101, 10088 102 Avenue NW Edmonton, Alberta T5J 2Z1

DISCLAIMER: ©2025 Jones Lang LaSalle IP, Inc. All rights reserved. All information contained herein is from sources deemed reliable; however, no representation or warranty is made to the accuracy thereof. The Property may be withdrawn without notice. Neither Owner nor JLL accepts any liability for any loss or damage suffered by any party resulting from reliance on this information. Jones Lang LaSalle Real Estate Services, Inc.