

**FOR SALE**

**TROVE™**

**13880 Wireless Way  
Richmond, B.C.**



**LAST UNIT AVAILABLE!**  
**Ground Floor Showroom & Warehouse**





# PROPERTY HIGHLIGHTS

Vancouver's first automotive and luxury lifestyle commercial development blended with first class industrial showroom and warehousing spaces.

Trove is more than a place to store vehicles, it is a community of like-minded Individuals with a passion for cars and a luxurious way to savor the benefits of owning a super car. Not only will you have the opportunity to connect with other car enthusiasts, there will be complementing businesses at Trove including moving coffee, element acoustics, r2, and missing chopsticks.

[WWW.THETROVECLUB.COM](http://WWW.THETROVECLUB.COM)

PLAY VIDEO ▶

- Gas, sanitary, and water roughed into each unit
- Provisions to accommodate AC units by owner
- Mezzanine steel construction with concrete floor and 8' clearance
- Unit specific – clerestory glazing
- Each unit individually metered for utilities
- Each unit features independent fresh air and exhaust ventilation
- Additional guest parking on site
- Industrial Business Park (IB1) zoning







VANCOUVER

7A

7

BURNABY

1A

Boundary Rd

Oak St

SW Marine Dr

Knight St

YVR AIRPORT

TROVE™

91

RICHMOND

99

17

91

## TRANSIT NETWORK

- Millenium Line
- Canada Line
- Expo Line

## LOCATION OVERVIEW

Immediate access to major highways and excellent transit service

With a base of operations at TROVE, you are at the intersection of several key transportation routes, and just across the river from the City of Vancouver. This gives your team, suppliers and customers an incredible range of options. Few business parks offer ownership in such a central location. Easy access will save you time, money and efficiency over the long term.



YVR AIRPORT

15 MIN



DOWNTOWN RICHMOND

10 MIN



DOWNTOWN VANCOUVER

30 MIN



US BORDER

20 MIN

- Immediate access to Knight Street and Highway 91
- Quick connections to Highway 99, Westminster Highway and Cambie Road
- Minutes away from the shops and services of Bridgeport Road
- Excellent transit service with bus stop right at the site
- By bus you are just 16 minutes from Lansdowne Canada Line Station and 13 minutes from the Knight Street Transit hub
- YVR Airport is less than 20 minutes away



SOLD

# UNIT 122/124

PRICE: \$2,403,700 (\$650/SF)

SIZE:  
3,698 SF  
(INCLUDING 1,033 SF OF MEZZANINE)

## FEATURES

- Two 10' wide automated glass grade loading doors
- Concrete slab-on-grade designed for approximately 150 psf load
- 19' height (18' clear, est.) ceiling
- Gas, sanitary, and water roughed-in to each unit
- Minimum 100amp electrical service
- NFPA 13 sprinkler system
- Gas fired unit heater
- Provisions to accommodate AC units by owner
- Mezzanine steel construction with concrete floor and 8' clearance
- Unit specific – clerestory glazing
- Each unit individually metered for utilities
- Each unit featuring independent fresh air and exhaust ventilation
- Additional guest parking on site
- Easy access to Highway 99 and 91, YVR Airport, and Downtown Vancouver
- Industrial Business Park (IB1) zoning
- Concrete construction building designed for the West Coast climate

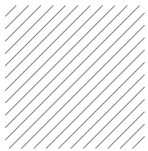
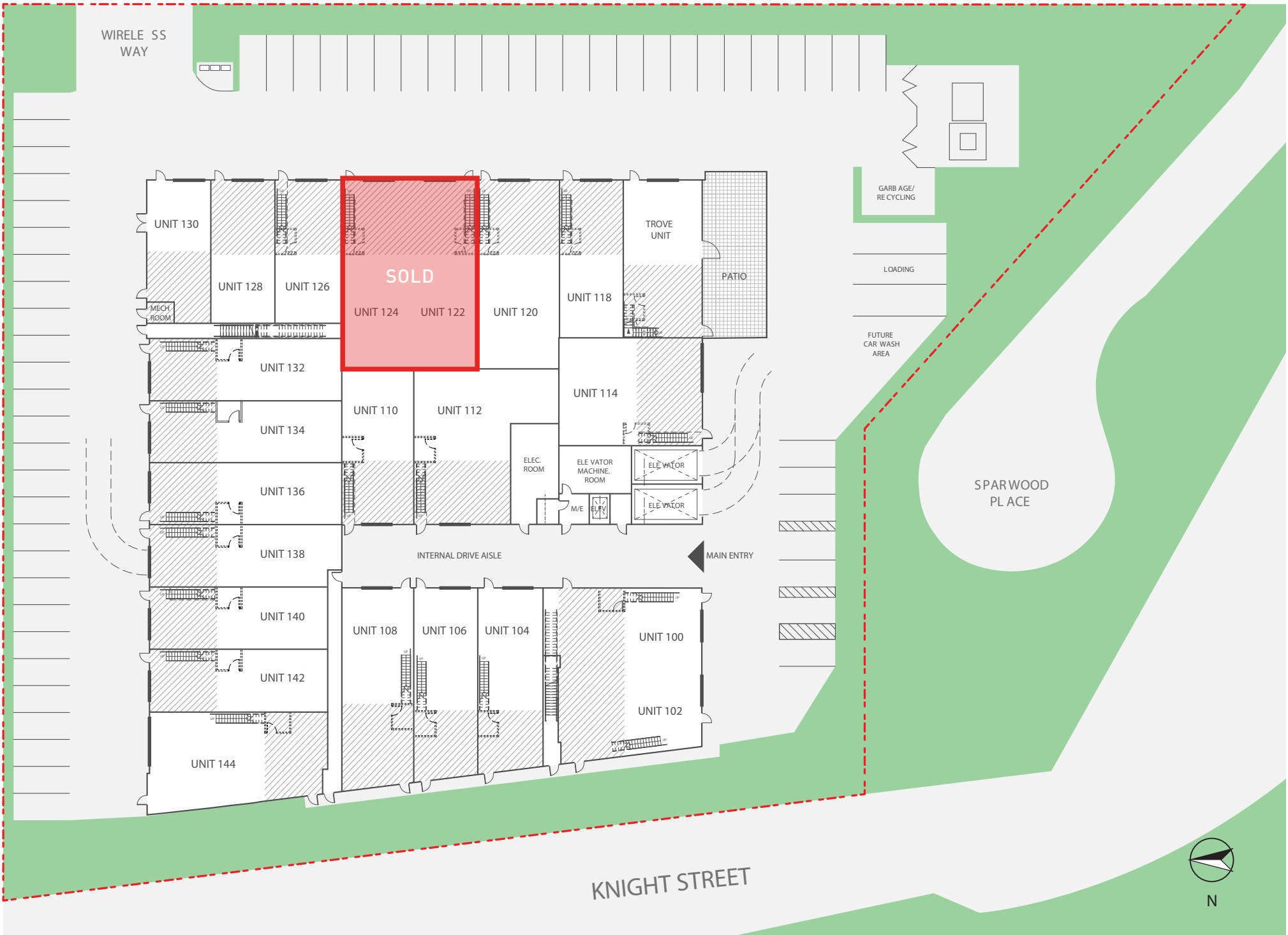

MEZZANINE

AVAILABLE IMMEDIATELY

UNIT 228-230

PRICE: \$1,850,000 (\$510/SF)

SIZE:	STRATA FEES:
UNIT 228: 1,766 SF	UNIT 228: \$742.58
UNIT 230: 1,957 SF	UNIT 230: \$824.07
TOTAL: 3,723 SF	TOTAL: \$1,566.65

FEATURES

- Two oversized freight elevators for convenient access to second floor
- Two 10’ wide automated glass grade loading doors
- Concrete slab-on-grade designed for approximately 150 psf load
- 19’ height (18’ clear, est.) ceiling
- Gas, sanitary, and water roughed-in to each unit
- Minimum 100amp electrical service
- NFPA 13 sprinkler system
- Gas fired unit heater
- Provisions to accommodate AC units by owner
- Mezzanine steel construction with concrete floor and 8’ clearance
- Unit specific – clerestory glazing
- Each unit individually metered for utilities
- Each unit featuring independent fresh air and exhaust ventilation
- Additional guest parking on site
- Easy access to Highway 99 and 91, YVR Airport, and Downtown Vancouver
- Industrial Business Park (IB1) zoning
- Concrete construction building designed for the West Coast climate

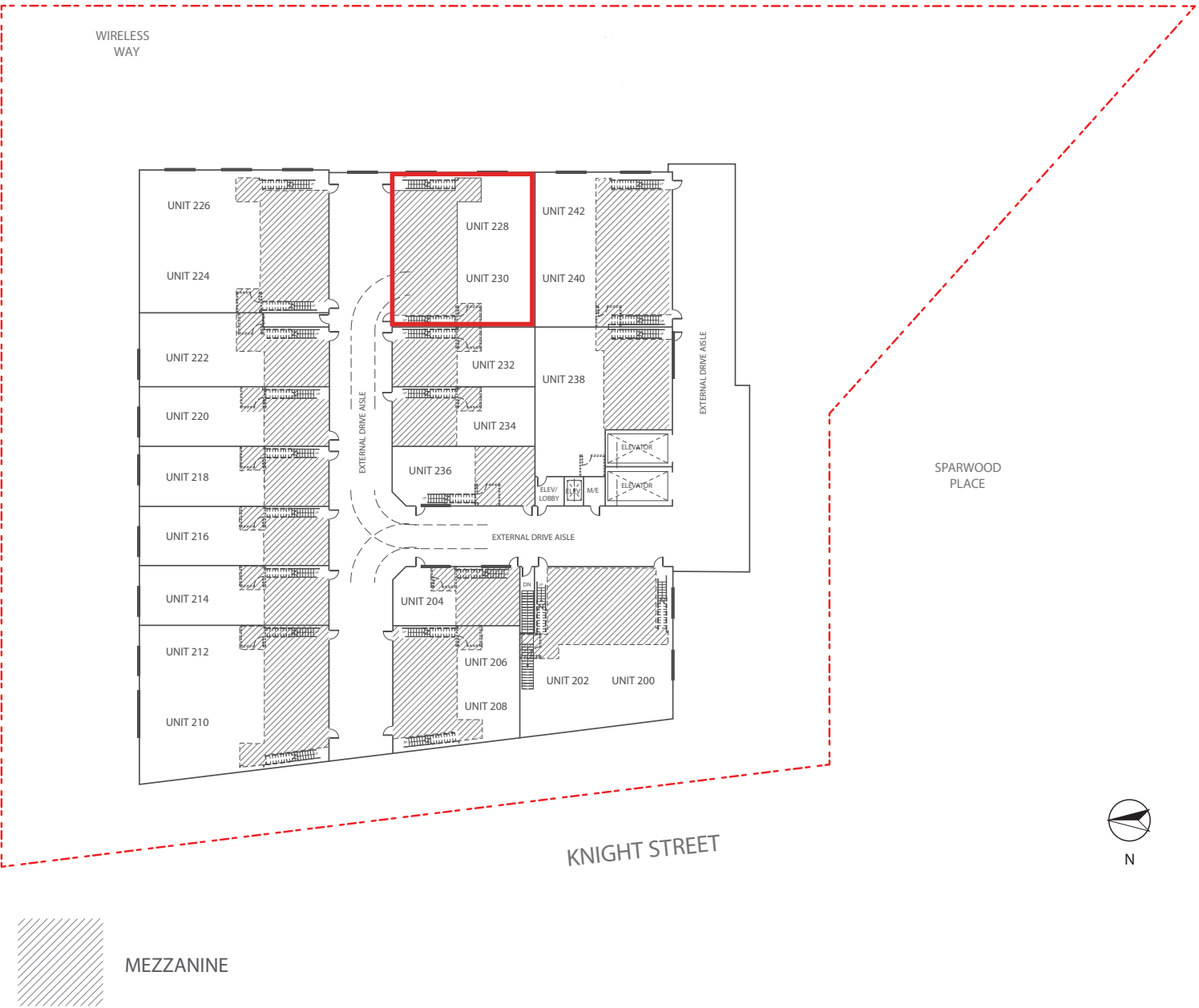







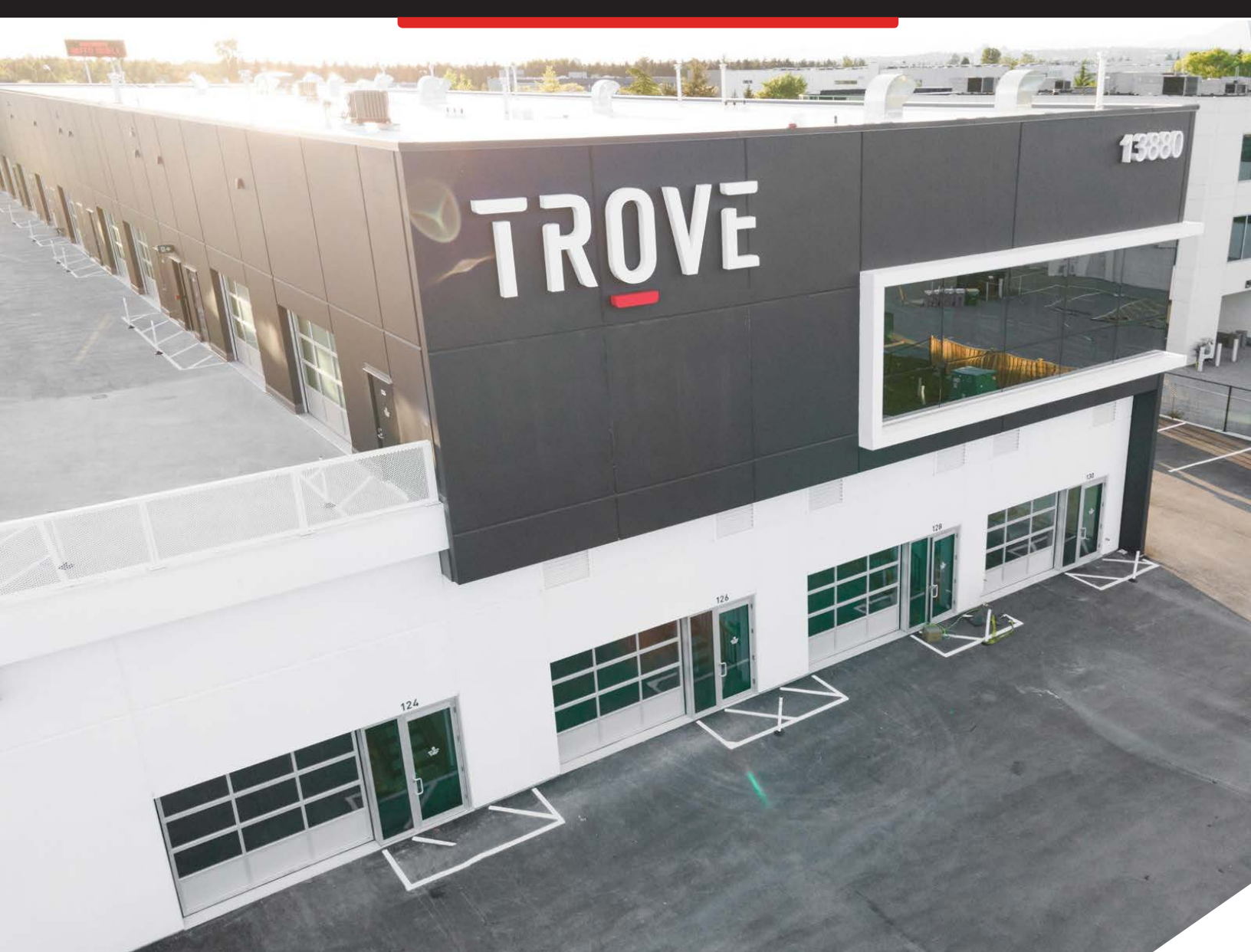

For more information, please contact:

**Stefan Morissette\***

Senior Vice President

+1 604 657 0801

[stefan.morissette@jll.com](mailto:stefan.morissette@jll.com)

**Jonathan Jassebi\***

Vice President

+1 778 883 8667

[jonathan.jassebi@jll.com](mailto:jonathan.jassebi@jll.com)

Although information has been obtained from sources deemed reliable, Owner, Jones Lang LaSalle, and/or their representatives, brokers or agents make no guarantees as to the accuracy of the information contained herein, and offer the Property without express or implied warranties of any kind. The Property may be withdrawn without notice. The developer reserves the right to modify the information contained herein without prior notice. If the recipient of this information has signed a confidentiality agreement regarding this matter, this information is subject to the terms of that agreement. The developer reserves the right to modify the information contained herein without prior notice. E.&O.E. ©2025. Jones Lang LaSalle. All rights reserved. [www.jll.ca](http://www.jll.ca)

\*Personal Real Estate Corporation

