

Puerta Polanco

Oficinas en Renta



Bldv. Manuel Ávila Camacho **No. 261**
Polanco 1 Secc., Miguel Hidalgo, CDMX

CARACTERÍSTICAS



Certificación

Leed
Premium



Seguridad integral

- CCTV
- Accesos con tarjetas de proximidad
- Vigilancia 24/7



Sistema contra incendios

- Hidrantes
- Detectores de humo
- Alarma
- Rociadores



1 Cajón

por cada 30 m²
rentables



Amenidades Exclusivas

- Salas de Juntas
- Roof Garden

M2

Disponibilidad

NIVEL	RENTABLE	TIPO	CONDICIÓN	ENTREGA
1	416 m ²	Oficina Corporativa	Obra Gris	Inmediata
PB 1	968.62 m ²	Local Comercial	Semi Acondicionado	
PB 2	111.32 m ²	Local Comercial	Obra Gris	
PB 3	133.00 m ²	Local Comercial	Obra Gris	
TOTAL	1,628.94 m²			

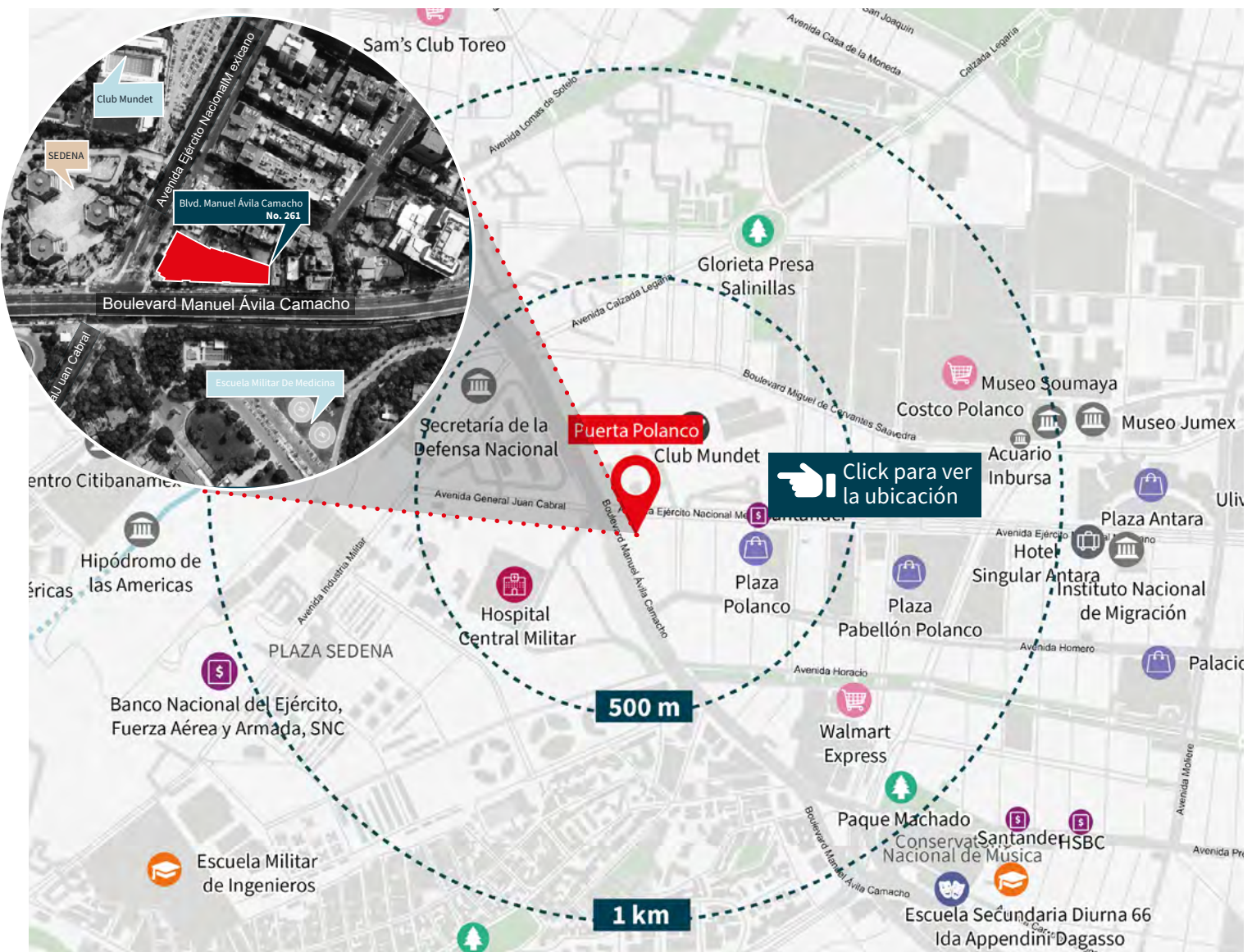

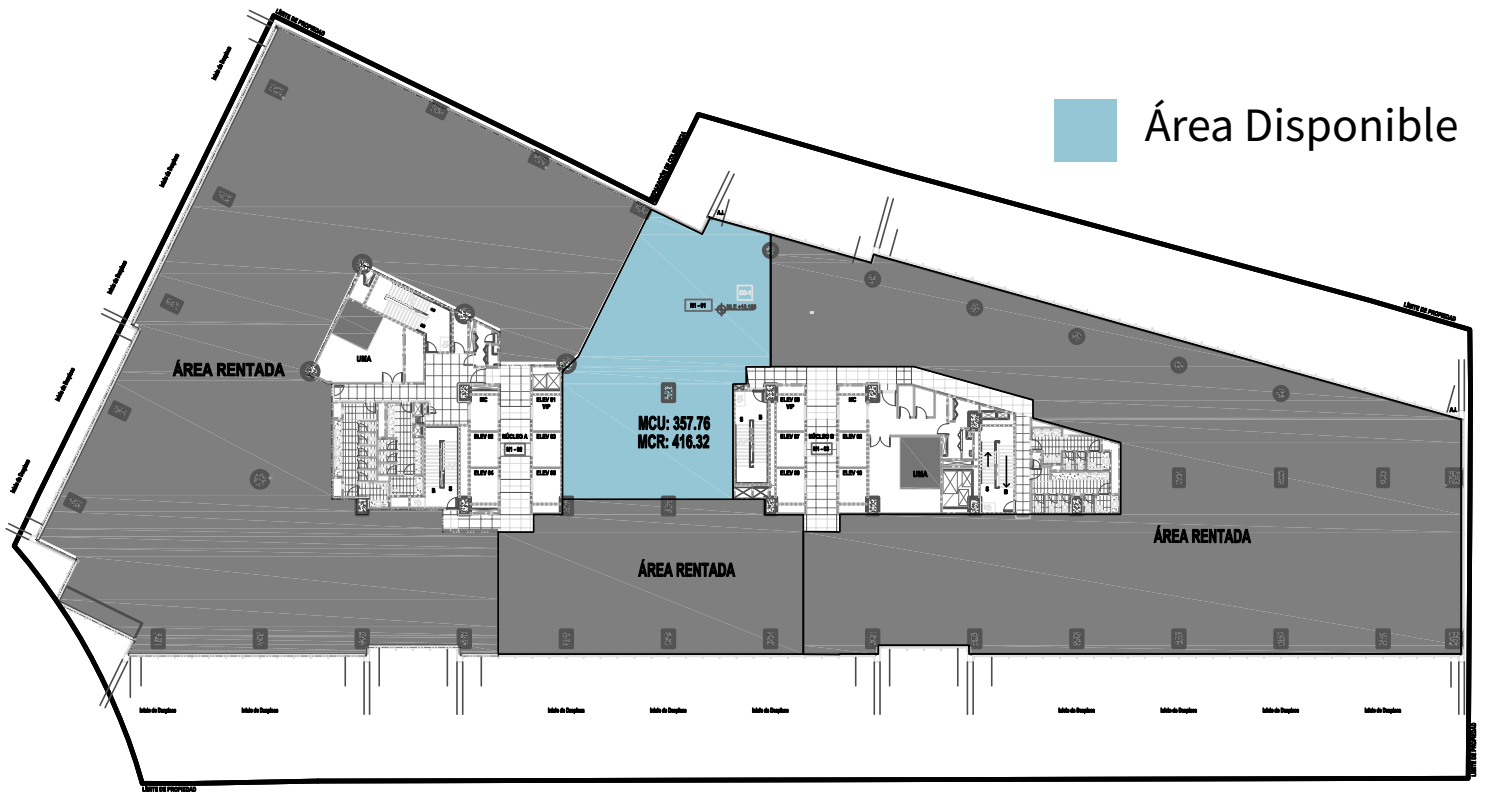



SEE A BRIGHTER WAY

CONTACTO

Alejandra Santa Cruz
alejandra.santacruz@jll.com
55 80 35 73 57

jll.com | @jll

© 2026 Jones Lang LaSalle IP, Inc. All rights reserved. The information contained in this document is proprietary to JLL and shall be used solely for the purposes of evaluating this project. All such documentation and information remains the property of JLL and shall be kept confidential. Reproduction of any part of this document is authorized only to the extent necessary for its evaluation. It is not to be shown to any third party without the prior written authorization of JLL. All information contained herein is from sources deemed reliable; however, no representation or warranty is made as to the accuracy thereof.