

SENTINEL FILTERS

The Sentinel filter range offers protection against hazardous gas, vapour and particulates within a wide variety of industries. Fully compatible with the Sentinel Full Face and Half Mask, the ergonomic filters offer incredibly low breathing resistance with optimised volume when fitted.

FEATURES & BENEFITS

- ✓ Gas filters are snowstorm filled to optimise space and volume, resulting in a smaller light weight casing that limits obstruction of view when fitted
- ✓ Particulate P3S & P3H contain pleated filter media, providing more surface area for reduced breathing resistance
- ✓ Sentinel filters are fitted with a simple connection which easily click into position
- ✓ Less than 115g, all filter combinations are light weight and can be used on both Full Face and Half Mask
- ✓ The P3P Filter is tested to 'R', allowing the use for more than one shift



Filter: ABEK1



Filter: A1



Filter: A2



Filter: P3 H



Filter: P3 S



MADE IN THE UK

FILTER SELECTION

FILTER TYPE	COLOUR DESIGNATION	MAIN AREA OF APPLICATION
P3 R	White	Particle "R" marking means that the particle filters are suitable for reuse against aerosols (Several Work Shifts)
A	Brown	Organic gases and vapours with boiling point >65°C
B	Grey	Inorganic gases and vapours
E	Yellow	Sulphur Dioxide and other acidic gases and vapours
K	Green	Ammonia and organic Ammonia derivatives

DURATION OF USE

The duration of use of a filter depends on its load, e.g. type and concentration of contaminant, the wearer's breathing rate and other factors. A greater load will reduce the duration of use.

GAS FILTERS

The presence of odour, taste and/or irritation indicates that the gas filter no longer works and must be replaced (no later than 6 months after the original packaging has been opened).

PARTICULATE FILTERS

Particulate and combined filters must be replaced at the latest when the breathing resistance becomes too high.

CERTIFICATION

**EN 143:2000 + A1:2006
& EN 14387:2021**



ORDERING INFORMATION

P3S:	ASRAS0003BF	A1:	ASRAS0005BZ
P3H:	ASRAS0003BH	A2:	ASRAS0006BZ
P3P:	ASRAS0004BZ	ABEK1:	ASRAS0007BZ

MATERIAL

PARTICULATE FILTER (P3S, P3H):	FIBREGLASS
PARTICULATE FILTER CASE (P3S, P3H):	ABS
P3 P FILTER:	POLYPROPYLENE
GAS FILTER:	ACTIVATED CARBON
GAS FILTER CASE:	ABS

FITTING INSTRUCTIONS

Attaching filters to mask

1. Check the integrity of the mask connector (seal on the full face mask or mask surface on the, half mask); if worn away or damaged, replace the seal/mask as appropriate.
2. Push the filter onto the mask connector, with the tabs on the filter connector aligning with the respective tabs on the filter body [See Diagram 1].
3. Rotate the filter clockwise until the filter clicks into place [See Diagram 2].
4. Make sure the filter is correctly seated [see Diagram 3 and 4].

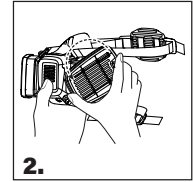
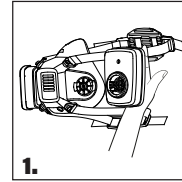

Combination filters

1. To assemble combination gas, vapour and particulate filters, insert the particulate P3-P filter into the filter retaining cover as shown, marking should be visible once fitted to the filter. [See Diagram 5].
2. Push the gas filter body into the retaining cover, ensuring a correct fit. Ensure all retaining cover clips are firmly in place on the gas filter. [See Diagram 6].
3. Assemble the filter body onto the mask as described in these instructions as normal [See Diagram 7].

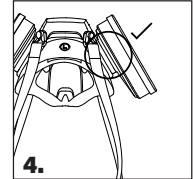
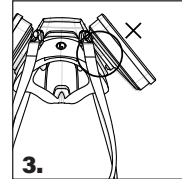

Removing the filters from the mask

1. Rotate the filter anticlockwise until loose
2. Lift the filter away from the mask

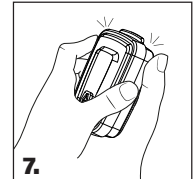
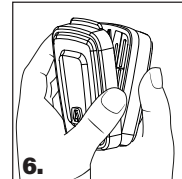
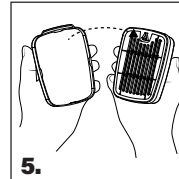

SUITABLE APPLICATIONS

FILTER	TYPE OF FILTER	STANDARD	APF**	HAZARD	INDUSTRY	
ASRAS0003BF	P3 Filters - Standard Size	EN 143:2000 + A1 2006 P3 R	20xWEL* HALF MASK 40xWEL* FULL FACE MASK	Protects from non-toxic dusts and oil/water based particulates	Agriculture Laboratory and Disease Control Pharmaceutical Industry Welding work Woodworking Underground Civil Engineering	Mining Manufacture of Batteries (Ni-Cad) Disposal of Toxic Waste Cutting and Casting of Metals Craft Work Construction
ASRAS0003BH	P3 Filters - High Capacity	EN 143:2000 + A1 2006 P3 R	20xWEL* HALF MASK 40xWEL* FULL FACE MASK			
ASRAS0005BZ	A1 Filters	EN 14387:2021	10xWEL* HALF MASK 20xWEL* FULL FACE MASK	Protects from organic vapours	Paint and Varnish Manufacture Welding Agriculture Transportation	Automotive Ink & Dye Manufacture Aerospace Petrochemical refining
ASRAS0006BZ	A2 Filters	EN 14387:2021	10xWEL* HALF MASK 20xWEL* FULL FACE MASK			
ASRAS0007BZ	ABEK1 Filters	EN 14387:2021	10xWEL* HALF MASK 20xWEL* FULL FACE MASK	Protects from organic vapours, Inorganic, acid gases, ammonia & ammoniacal derivatives	All of the above plus: Electrolytic processes	Acid Cleaning Refrigeration
ASRAS0004BZ	P3P Filters	EN 14387:2021	Combine with any gas & vapor filter - see above for assigned protection			

*WEL - Workplace Exposure Limit, **Assigned Protection Factor (HSG53 HSE Guide) (HSE EH40 Workplace Exposure Limits)

CERTIFICATION

Authorised Representative [EU]: Globus EMEA Ltd., 51 Dawson Street, Dublin, D02 AN25, Ireland. Product conforms to the requirement of: UK Regulation 2016/425 on PPE, brought into UK Law and amended & Regulation (EU) 2016/425 of the European Parliament and of the Council as Personal Protective Equipment (PPE).

Type-Examination, (Module B), Certificates issued by: UK - CCQS UK Ltd., Level 2, 5 Harbour Exchange Square, London, E14 9GE, UK. [A.B. No. 1105]. EU - CCQS Certification Services Ltd., Block 1 Blanchardstown Corporate Park, Ballycoolin Road, Blanchardstown, Dublin D155 AKK1, Ireland. [N.B. No. 2834].

PPE is subject to the conformity assessment procedure, conformity to type based on Quality Assurance of the production process, (Module D), under the surveillance of the Approved/Notified Body(-ies): UK - SGS UK Ltd., Rossmore Business Park, Ellesmere Port, Cheshire, CH65 3EN, UK. [A.B. No. 0120]. EU - SGS Fimko Oy, Takomtie 8, FI-00380, Helsinki, Finland. [N.B. No. 0598].