

800-810

N GREAT SOUTHWEST PARKWAY

Arlington, Texas 76011

FOR SALE

3,000 SF
CONDO
UNITS

AVAILABLE
IMMEDIATELY

GREAT
SOUTHWEST
SUBMARKET



Owned by:



Leasing Information:

Riley Maxwell
214.676.3235
riley.maxwell@transwestern.com

Jack Brewer
214.292.6459
jack.brewer@transwestern.com



TRANSWESTERN

REAL ESTATE
SERVICES

The information provided herein was obtained from sources believed to be reliable; however, Transwestern makes no guarantees, warranties or representations as to the completeness or accuracy thereof. The presentation of this property is submitted subject to errors, omissions, change of price or conditions, prior sale or lease, or withdrawal without notice. Copyright © 2020 Transwestern.

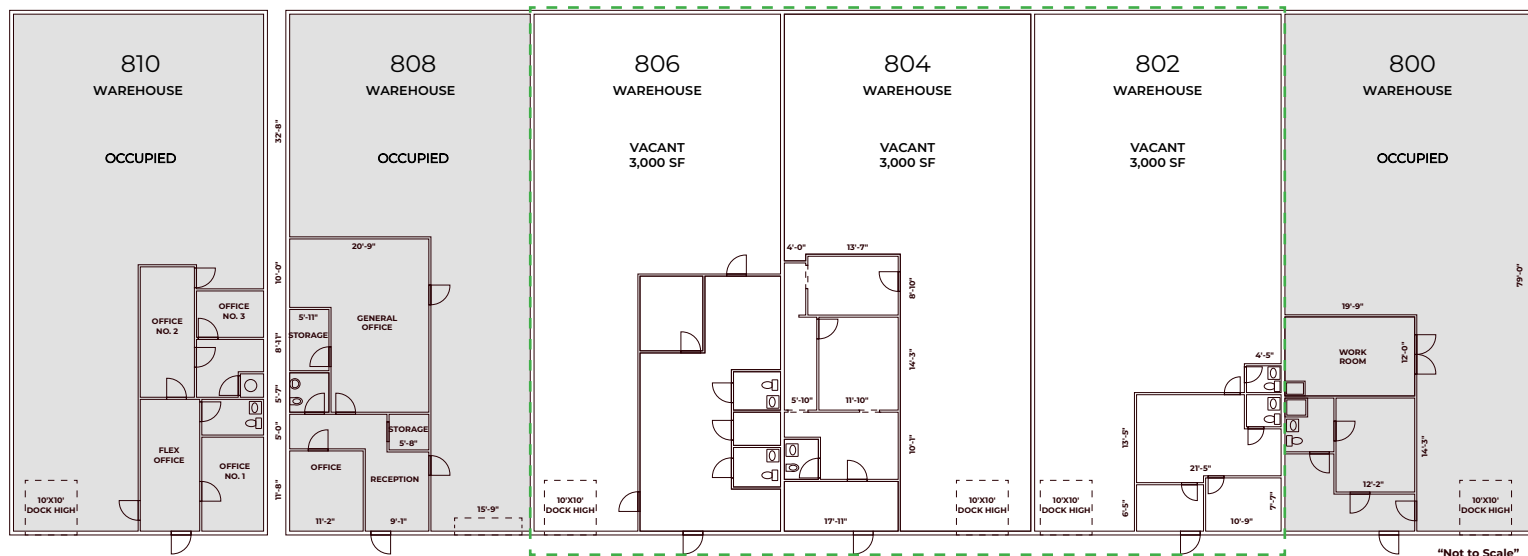

PROPERTY FEATURES

- Excellent Owner/User Opportunity to purchase 3,000 - 9,000 SF
- Three 3,000-SF Condo units available immediately
- One Dock High Door per unit
- 16' Clear Height
- Front Load/Front Park
- Immediate access to Hwy 161 & Hwy 360
- New LED Lighting
- Fully Renovated Office Space



DRIVE TIMES

14 miles
DALLAS CBD

4 minutes
I-35W

14 miles
DFW AIRPORT

5 minutes
TX-360

16 miles
DALLAS LOVEFIELD AIRPORT

10 minutes
I-20

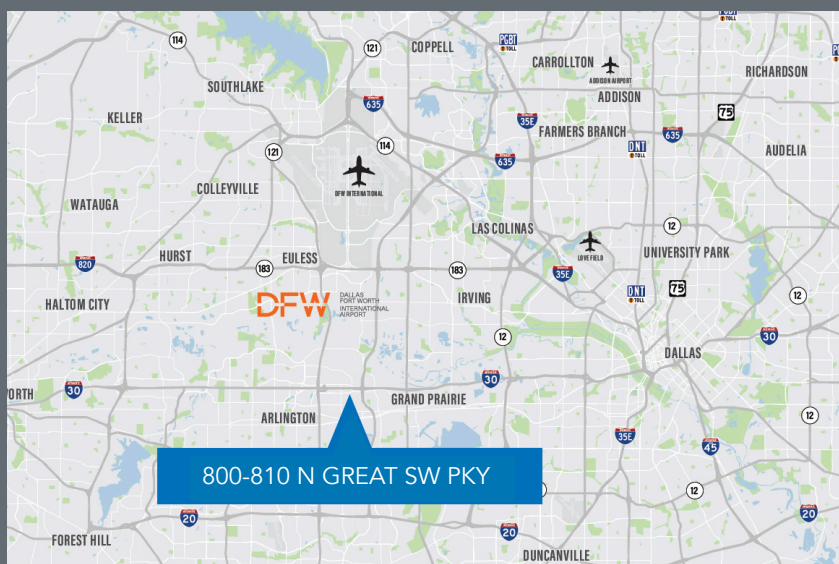

Owned by:



Leasing Information:

Riley Maxwell
214.676.3235
riley.maxwell@transwestern.com

Jack Brewer
214.292.6459
jack.brewer@transwestern.com



TRANSWESTERN

REAL ESTATE
SERVICES

The information provided herein was obtained from sources believed to be reliable; however, Transwestern makes no guarantees, warranties or representations as to the completeness or accuracy thereof. The presentation of this property is submitted subject to errors, omissions, change of price or conditions, prior sale or lease, or withdrawal without notice. Copyright © 2020 Transwestern.