

Plug-In Socket with Meter Quick Installation Guide

Scan for a more detailed Installation Guide.



Overview

The SolarEdge Smart Energy Management solutions allow increasing the self-consumption of a site. One method used for this purpose is controlling the usage (consumption) of loads using Device Control products.

The SolarEdge Device Control units divert power to an appliance (load) according to pre-configured schedules.

You can configure the Device Control products locally through the SolarEdge inverter or remotely, via the SolarEdge monitoring portal.

The SolarEdge Plug-in socket (referred to as "the device") is a ZigBee wireless AC switch with a built-in energy and power-consumption meter that provides power measurements up to 2.5kW. Based on these measurements and on the system configuration it switches the loads on and off.

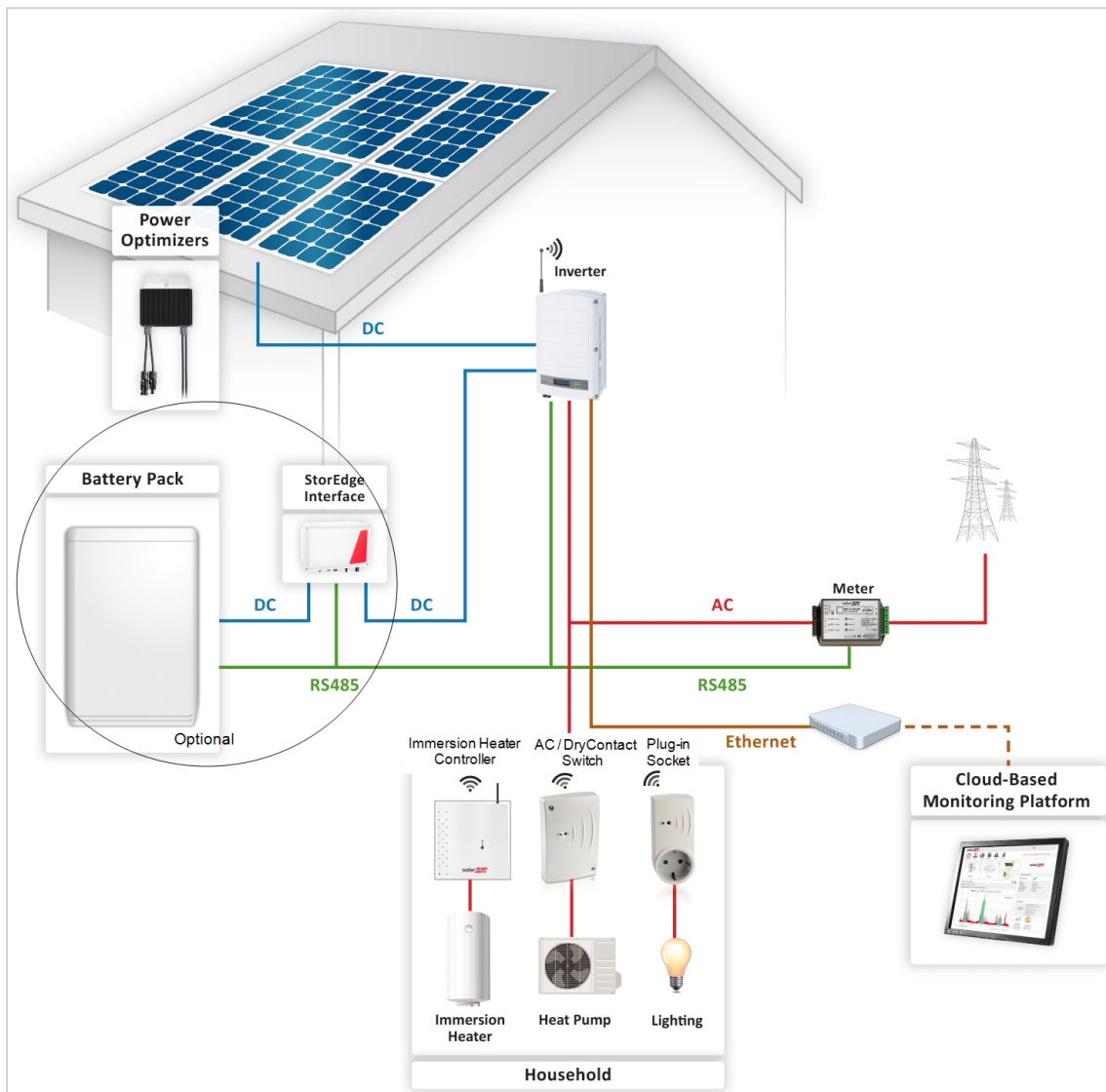

Figure 1: SolarEdge system with Device Control products

To enable the Plug-in socket functionality, the following supporting devices must be installed:

- Device Control ZigBee Module, installed inside the inverter. For physical installation refer to <http://www.solaredge.com/sites/default/files/se-device-control-zigbee-module-installation-guide.pdf>.
- SolarEdge Modbus Meter. Refer to <http://www.solaredge.com/files/pdfs/solaredge-meter-installation-guide.pdf>

Installation

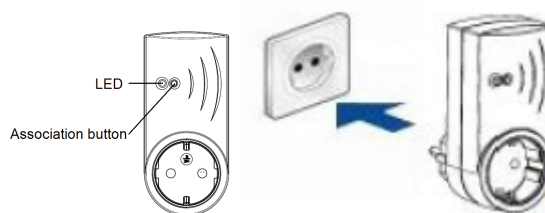

Figure 2: The Plug-in Socket

CAUTION!

- This product must be operated under the specified operating specifications, as described in the latest technical specification datasheet.
- Configure the product so that the load connected is not switched on or off more frequently than specified by the load manufacturer.
- Do not connect loads that require a continuous current supply (e.g. fridge, freezer).
- Do not use the product if it is damaged or malfunctioning.
- Never connect loads that can cause injuries or fire if they are switched on unintentionally (e.g. an iron).
- Do not let the product come into contact with water or other liquids.
- The enclosed documentation is an integral part of this product. Keep the documentation in a convenient place for future reference and observe all instructions contained therein.

1. Plug the device into a wall socket, at a maximum distance of 50 m from the inverter.
2. For configuration and troubleshooting, refer to <http://www.solaredge.com/sites/default/files/se-device-control-plugin-socket-installation-guide.pdf>.

Specifications

ELECTRICAL SERVICE		SEHAZB-SCKT-MTR-XX ¹	
Operating Voltage Range - Line to Neutral		90 - 250	Vac
AC Frequency		50/60	Hz
Maximum Active Power Measurement		3	kW
Maximum Load Current		13	A
COMMUNICATION			
Supported Communication Protocol		ZigBee Home Automation	
Nominal Transmit Power		3	dBm
Operating Frequency Range		2.4 - 2.5	GHz
Outdoor (LOS) Range		100	m
Indoor Range ²		50	m
STANDARD COMPLIANCE			
Radio		ETSI EN 300 328 V 1.8.1, ETSI EN 301 489-1, ETSI EN 301 489-17	
Safety		EN 60335-1, EN 60335-2-30, EN 50371	
Immunity		EN 55014-2	
Emissions		EN 55014-1, EN 61000-3-2, EN 61000-3-3	
INSTALLATION SPECIFICATIONS			
Operating Temperature Range		0 to +50	°C
Protection Rating		IP30	
Dimensions (H x W x D)		110 x 50 x 40	mm

¹Multiple plug types for various sockets: XX = GB, DE, FR, IT

²Approximate values. May differ depending on specific installation conditions.