



Havwoods International
Carnforth Business Park
Oakwood Way, Carnforth
Lancashire LA5 9FD
United Kingdom
T. +44 (0)1524 737000
F. +44 (0)1524 737001
info@havwoods.com



HAWWOODS
INTERNATIONAL

Installation Instructions

Below is the relevant information required to achieve a successful installation of Havwoods Pureplank O6 flooring products. Please read these instructions carefully to ensure your flooring is installed correctly and fully warranted.

- Pureplank O6 Installation Kit (Profiled tapping block, Expansion spacers, Pull bar)
- Suitable underlay of sufficient quality. Havwoods recommend Undatech Silver/Gold foil backed underlay
- Hammer
- Underlay foil jointing tape
- D3 Wood Adhesive (if radiator pipes present)
- Pencil
- Saw
- Knife
- Tape Measure

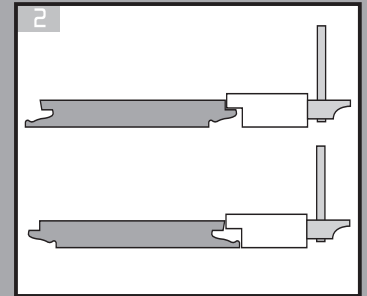
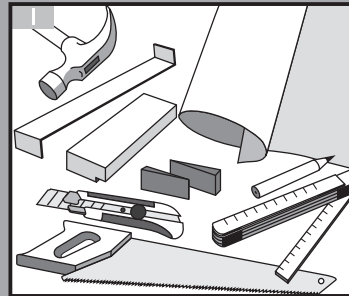

Pureplank O6 floors are designed for a floated installation. Do not use adhesive to bond the flooring to the subfloor or fix the flooring to the subfloor with nails or screws at any point. Never strike the boards directly with a hammer, always use the tapping block.

Underfloor Heating

Pureplank O6 floors are suitable for use with underfloor heating systems. Measures must be taken to ensure that the surface temperature of the flooring never exceeds 27°C (80°F). Heating elements must never be in direct contact with the underside of the flooring.

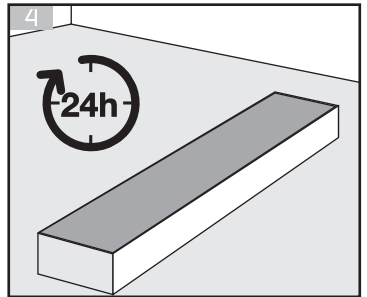
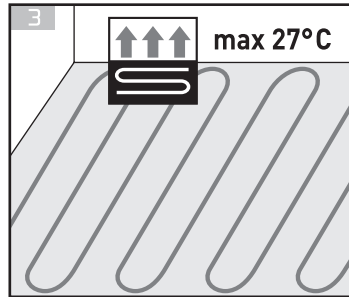

Storage

Store materials in the area in which they are to be installed. The material should be delivered 24 hours prior to installation and remain in its original unopened packaging until the point of fitting. The environment in the room needs to have a temperature of between 16-21°C (61-70°F) and an ambient RH of 40-60%. Store materials so that they are not in direct contact with the floor or walls.

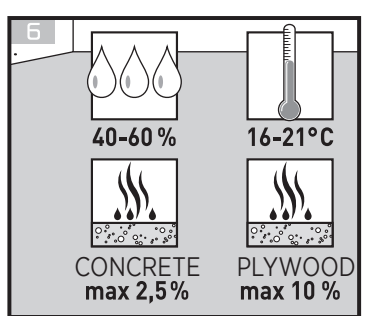
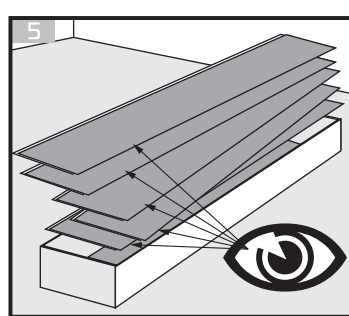

Preparation

Check each board before installation for any potential damage or defect, an installed board is an accepted one. The subfloor must be flat, level, dry and free from contamination:

Subfloors should be sound with no loose particles.

The maximum level variance for a subfloor to receive Pureplank O6 is 4mm (10/64") over 2 metres (6'9/16").

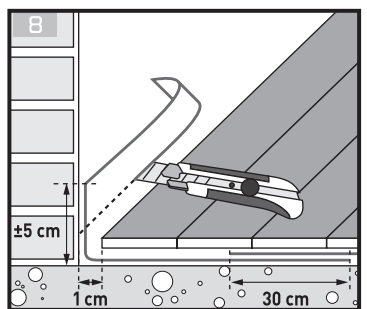
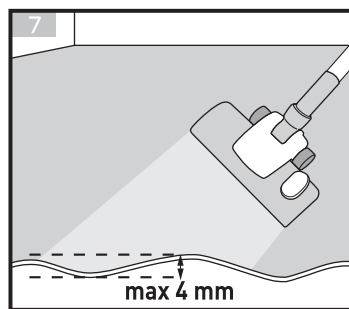

Concrete subfloors must have a moisture content of less than 2.5% (CM method) or 75%RH. Where underfloor heating is present, this requirement becomes 2% and 65%RH.

Anhydrite screeds must have a moisture content of <0.5% (CM method).

Plywood or other timber substrates should have a moisture content of <10%.

The ambient conditions of 16-21°C (61-70°F) 40-60%RH should be maintained before during and after installation to ensure best performance of your floor.

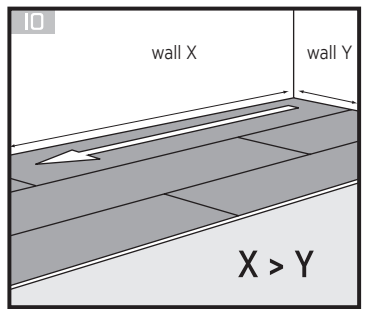
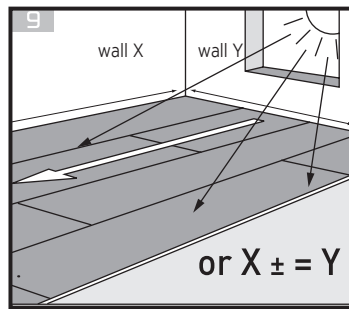

Underlay

Pureplank O6 has an incorporated cork layer which performs the cushioning and sound-dampening functioning of an underlay. Where installing to a concrete or anhydrite screeded substrate, install Pureplank O6 over 250 micron polythene sheeting which should be laid at a 300mm overlaps and taped at joints with foil jointing tape. The polythene can continue 50mm on walls to ensure moisture venting from the substrate does not damage flooring.

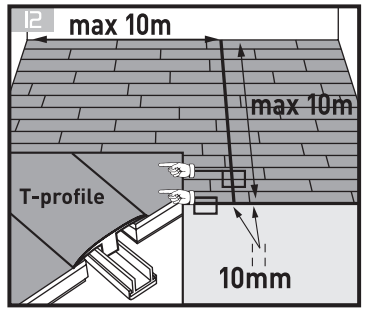
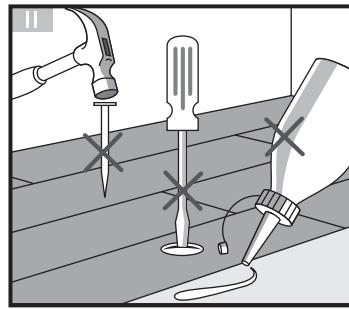

Layout

It is generally recommended to install planks longitudinally towards the greatest light source and in the direction of the longest wall in a room.

N.B Some wood species are more sensitive to light than others and will develop their colour under exposure to UV light. This is a natural phenomenon and any timber floor should be expected to exhibit some lightening or darkening under UV light exposure.

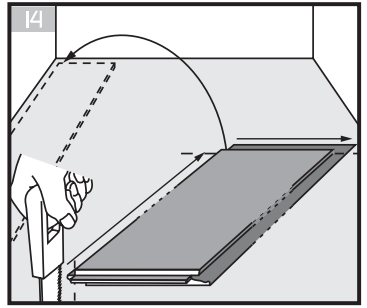
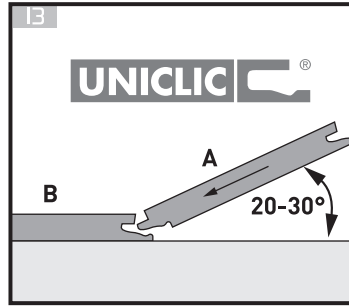

Installation

1. General

Pureplank O6 products use a Uniclicsystem to allow a floating installation. Boards are held together through a click Tongue an Groove system. This allows a quick and accurate installation.

To fit planks together, first engage the joint at the long edge of the planks at a 20-30° angle and then use a the tapping block and hammer to fully engage the joint until the board sits flat to the substrate. Gently tap along the plank every 30cm (12") until the boards are clicked together. Do not use excessive force as this may damage the planks.

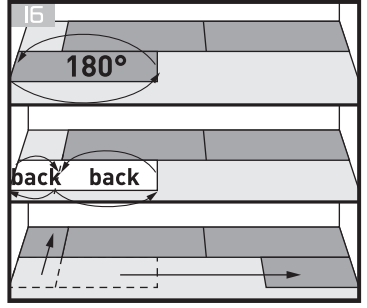
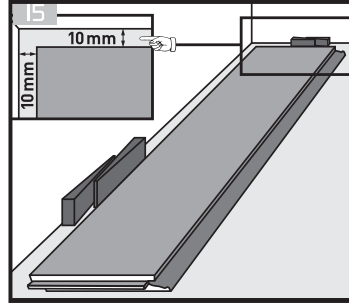

Ensure an expansion gap is left at the perimeter of the flooring and at the junction with any fixed obstacle (such as radiator piped and door frames). The minimum expansion is 10mm (3/8") or 1mm (3/64") per linear metre (3'3") of floor span. Perimeter expansion gaps should be covered with skirting details which must only be fixed to the wall and not the floor so as not to obstruct expansion. Floors with a span greater than 10m (33') must be sectioned using a T-profile.

For the most straight-forward installation, install the tongue (A) into groove (B) as shown in image 13.

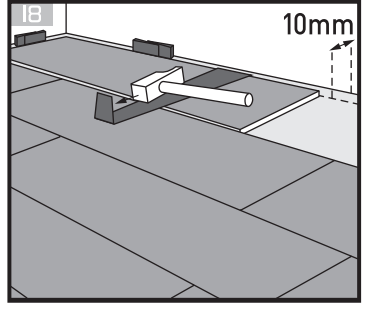
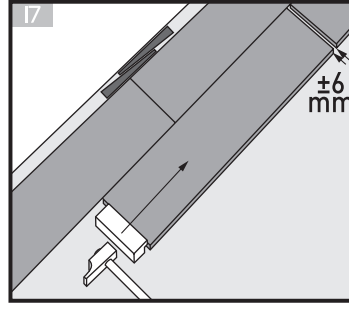

2. First Row

First measure your room to ensure that your last row will be at least 1/3 of a plank width before starting with a full board. If the last row will be narrower than 1/3 of a plank then cut the first row of planks along the length to adjust the layout so that the cuts to both walls will be of even size.

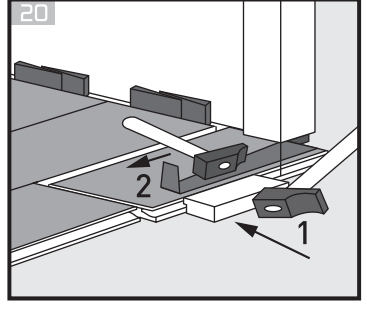
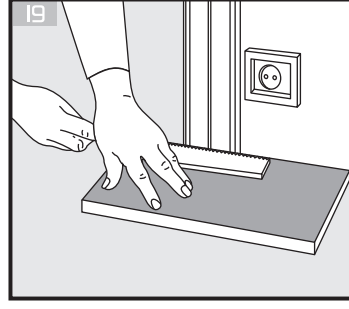

If starting with a full board, remove the tongue element from the first plank on the long and short edge and place into the corner of the room (image 14). Remove the tongue elements from the long edge of all remaining planks in the first row.

Use the spacers from the installation kit to maintain a 10mm perimeter expansion to all walls and fixed objects (Image15).

For the last plank of the first row, first measure the plank before adjusting the length. Do not remove the tongue on the long edge before the board length has been cut so that the remainder of the board can be used to start the second row (Image 16). If the cut from the last row is less than 20cm (8") in length, then a new plank will be required to start the second row. Ensure to stagger the short-end joints between adjacent planks by a distance at least twice the width of the plank.

Continue the second row by tapping the long edge of the plank into the adjacent board with a distance of 6mm (1/4") to the previous board (Image 17). Use the profiled tapping block to gently knock this board into the previous plank. Do not attempt to do this in one hit as it will damage the board.

Continue installing in this method until the last row.

3. Last Row

Be sure to leave an expansion gap of 10mm to the wall. Cut the boards along their length to fit the space and use the pull-bar from the installation kit to engage the long edge joint (Image 18).

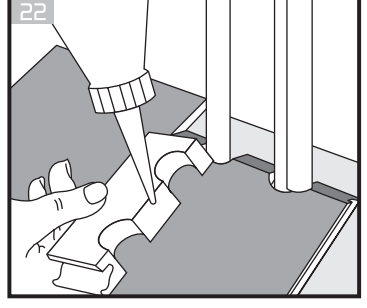
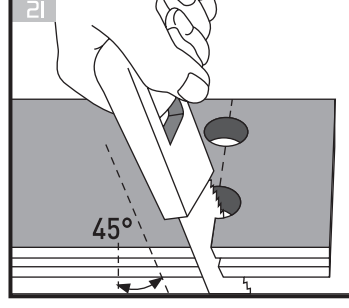

4. Doorframes

If the flooring does not fit beneath the frame, use a cut piece of flooring and a saw to adjust the frame height so that the floor can be installed underneath (Image 19). Ensure that there is a 10mm expansion gap to the fixed element of the frame/wall. If it is not possible to click the planks together using the tapping block, use the pull-bar to engage the joint between planks (Image 20).

5. Radiator Pipes

Carefully mark the location of Radiator pipes and drill the board with a diameter 20mm in excess of the pipe measurement to maintain the required expansion of 10mm. Cut across the board at 45° through the centre of the drilled hole(s) as shown in Image 21. Bond the cut piece to the plank using D3 adhesive as shown in Image 22.

6. To Finish the Installation

The floor can be walked on immediately after installation. Remove perimeter spacers and install skirtings (never fix skirtings to the floor). A suitable mastic can be used to seal the perimeter from the potential ingress of moisture if necessary.

Maintenance and Protection

In order to properly protect your floor, be sure to follow these three steps prior to use:

- Place felt feet under chairs and furniture
- Use soft wheel designed for parquet/wood flooring on all castor chairs
- Ensure a suitable door-mat is in place where entering the floor from external doors

