



Waste bin systems - Pull-out units

SALICE

Waste bin systems

Available in a range of sizes, the waste bin systems provide an aesthetically attractive and extremely effective solution to an essential kitchen function - the efficient handling of waste.

Both the Lineabox drawer and the waste bins are supplied in preassembled kits.

Their assembly is easy, rapid and intuitive.

This operation is tool free. The sliding movement of the drawer is fluid and progressive, thanks to Shelf full-extension runners, premounted on a specially-designed frame.



Single packing

STORAGE UNIT WIDTH	PART NUMBER	BOX
Storage unit width 305 mm (12")	AKWBAX_05000305	1 single kit
Storage unit width 381 mm (15")	AKWBAX_05000381	1 single kit
Storage unit width 457 mm (18")	AKWBAX_05000457	1 single kit
Storage unit width 533 mm (21")	AKWBAX_05000533	1 single kit

Part number composition (example):

AKWBAX105000305

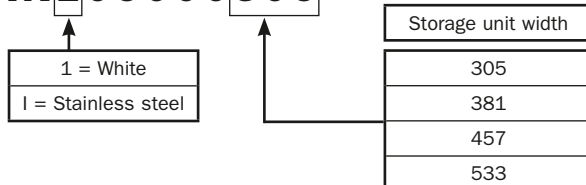

Waste bin systems - Storage unit 305 mm (12")



Kit consists of:

- 2 Shelf runners 65559, 500 mm length, premounted on a steel support
- Screws for wooden frontal \varnothing 4 x 35 mm
- Fully assembled Lineabox drawer
- Steel bin-holder frame
- 1 plastic waste bins - capacity 33 litres (35 qt.)

Technical features:

- Depth adjustment with the runner fixing clips
- Sideways, vertical and tilt adjustment on the runners support

Finishes:

- Bin-holder frame: Titanium
- Waste bins: Grey
- Runners support: Grey
- Lineabox sides: White, Stainless steel

Dimensions with Shelf full-extension runners

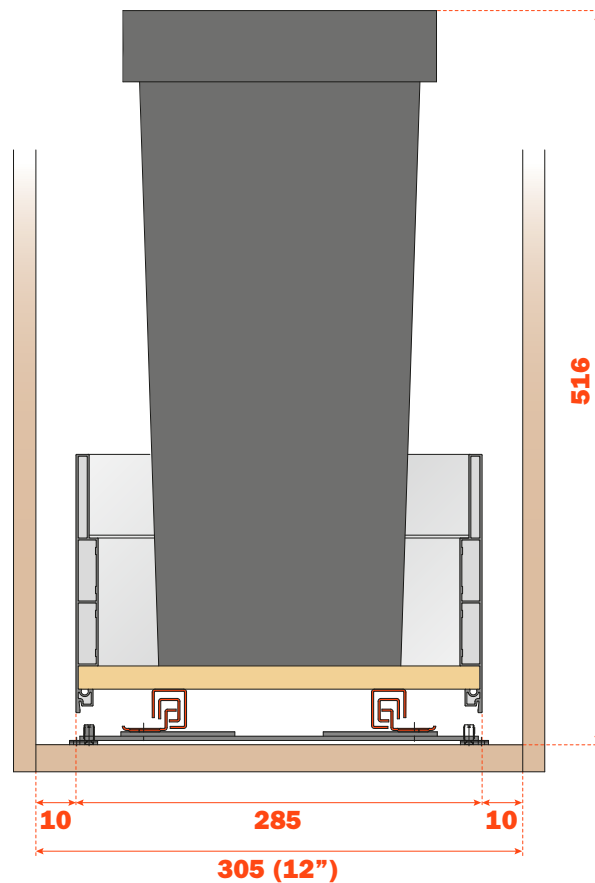

Waste bin systems - Storage unit 381 mm (15")



Kit consists of:

- 2 Shelf runners 65559, 500 mm length, premounted on a steel support
- Screws for wooden frontal \varnothing 4 x 35 mm
- Fully assembled Lineabox drawer
- Steel bin-holder frame
- 2 plastic waste bins - capacity 30 litres (32 qt.)

Technical features:

- Depth adjustment with the runner fixing clips
- Sideways, vertical and tilt adjustment on the runners support

Finishes:

- Bin-holder frame: Titanium
- Waste bins: Grey
- Runners support: Grey
- Lineabox sides: White, Stainless steel

Dimensions with Shelf full-extension runners

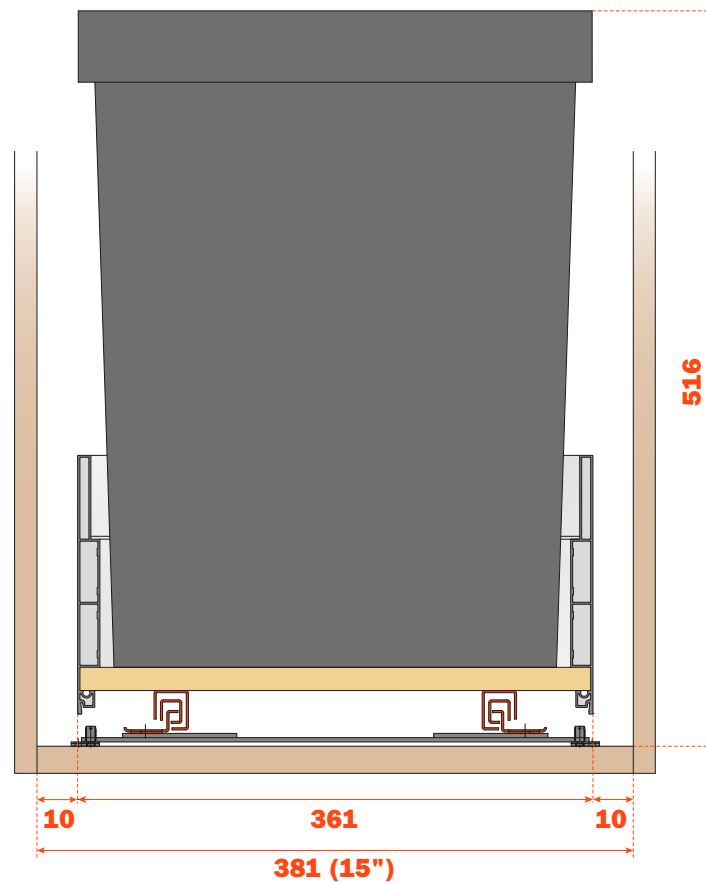

Waste bin systems - Storage unit 457 mm (18")



Kit consists of:

- 2 Shelf runners 65559, 500 mm length, premounted on a steel support
- Screws for wooden frontal \varnothing 4 x 35 mm
- Fully assembled Lineabox drawer
- Steel bin-holder frame
- 2 plastic waste bins - capacity 30 litres (32 qt.)

Technical features:

- Depth adjustment with the runner fixing clips
- Sideways, vertical and tilt adjustment on the runners support

Finishes:

- Bin-holder frame: Titanium
- Waste bins: Grey
- Runners support: Grey
- Lineabox sides: White, Stainless steel

Dimensions with Shelf full-extension runners

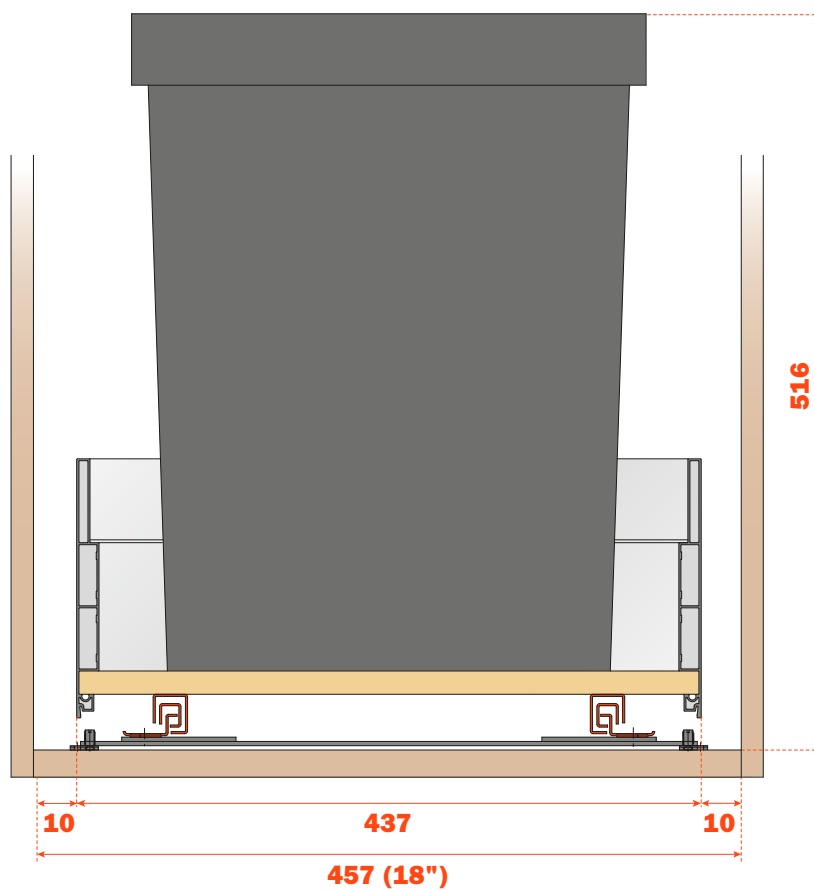

Waste bin systems - Storage unit 533 mm (21")



Kit consists of:

- 3 Shelf runners 65559, 500 mm length, premounted on a steel support
- Screws for wooden frontal \varnothing 4 x 35 mm
- Fully assembled Lineabox drawer
- Steel bin-holder frame
- 2 plastic waste bins - capacity 33 litres (35 qt.)

Technical features:

- Depth adjustment with the runner fixing clips
- Sideways, vertical and tilt adjustment on the runners support

Finishes:

- Bin-holder frame: Titanium
- Waste bins: Grey
- Runners support: Grey
- Lineabox sides: White, Stainless steel

Dimensions with Shelf full-extension runners

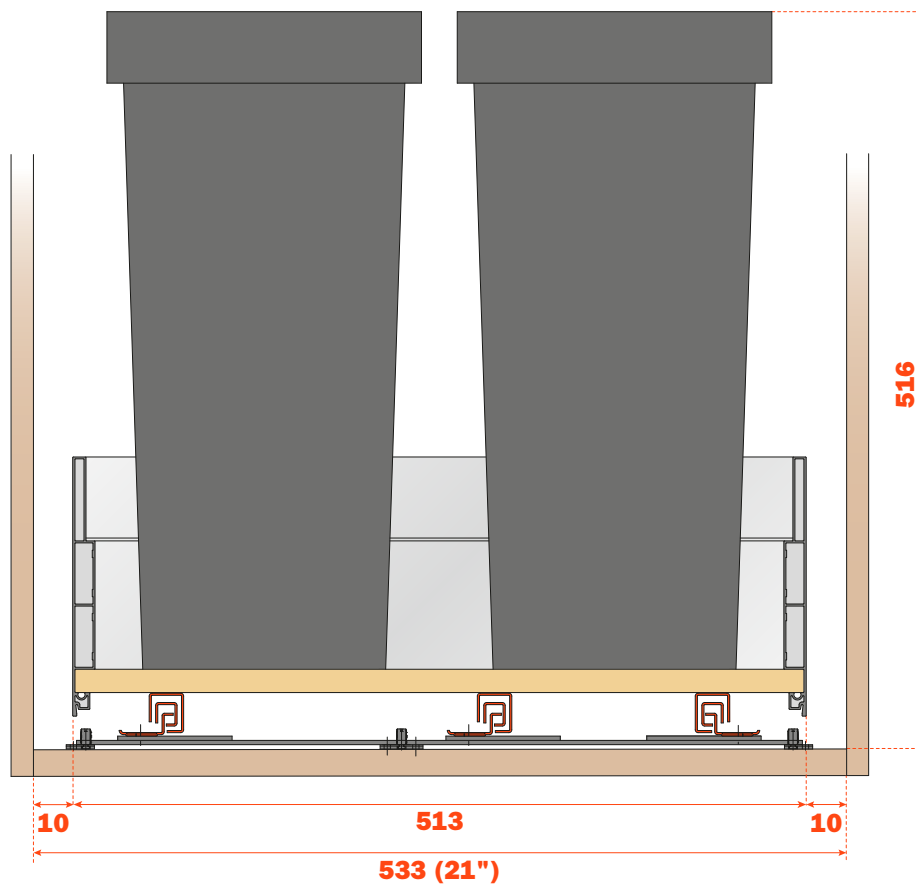

Waste bin systems - Assembly features

Place the runner support on the bottom of the cabinet.



Position the runner support at the centre of the cabinet, using the front reference. The front feet, aligned with the base panel of the cabinet, can be used as a reference for the depth positioning.



Screw-fix the feet with the screws provided (\varnothing 4 x 18 mm).



Pre-drill the drawer frontal using the template provided. For the correct positioning use as reference the middle of the front panel and its overlay (**D**) on the base panel of the cabinet.

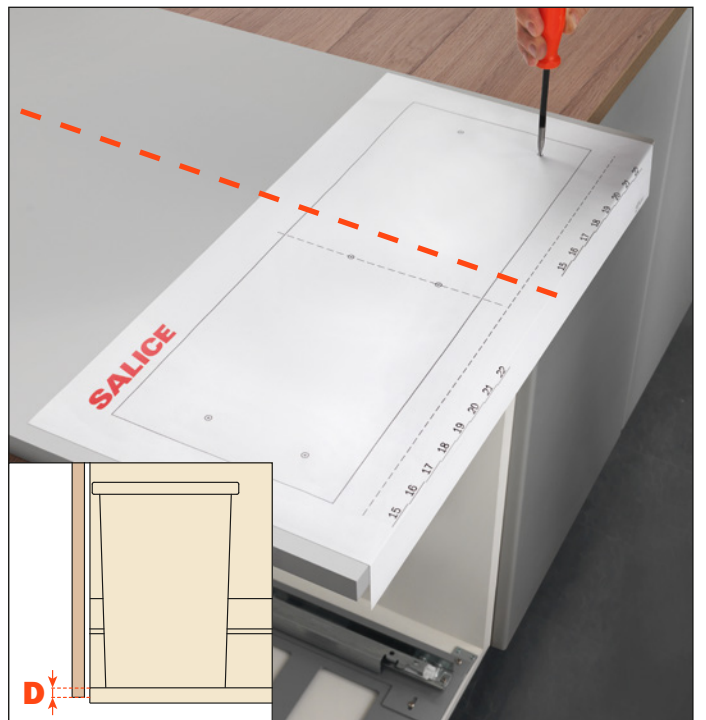

Using the pre-drilled holes, fix the drawer to the drawer frontal using the screws provided (\varnothing 4 x 35 mm).



Slide the drawer onto the runners until the clips engage.

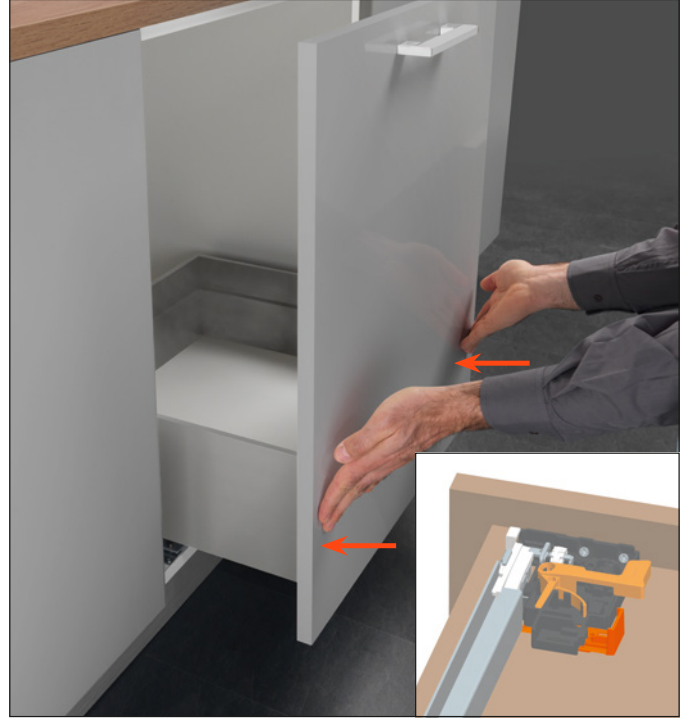

Insert the bin-holder frame.



Insert the waste bins.



Waste bin systems - Adjustments

A technologically advanced and comprehensive adjustment system enables the drawer frontal to be aligned precisely in all directions.

The amount of adjustment far exceeds what is available elsewhere.

All operations can be carried out with a drawer already installed.

Sideways tilt adjustment (+8 mm)

Operate on the adjusters on the right or on the left for the sideways tilt adjustment of the front panel.

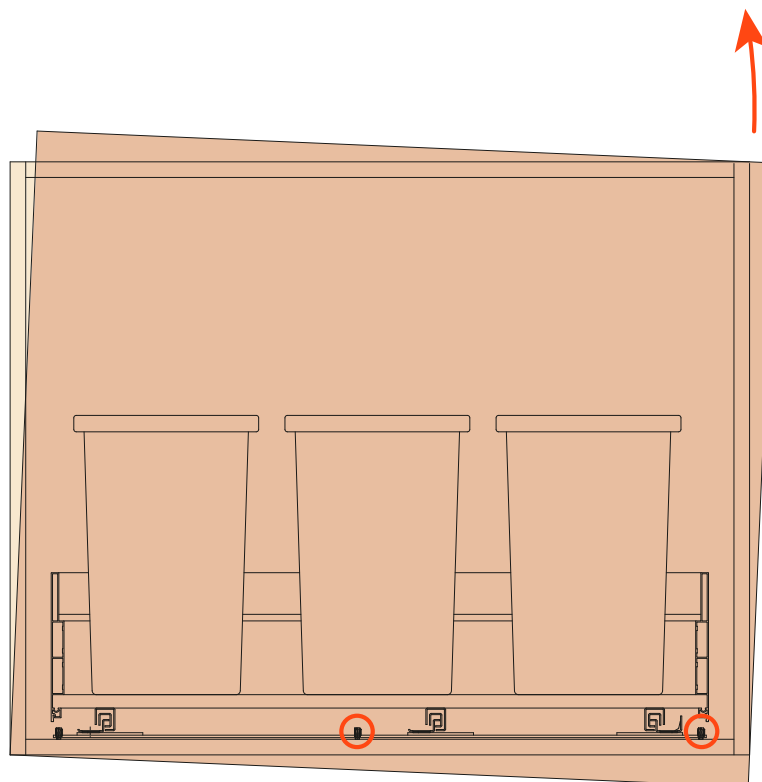
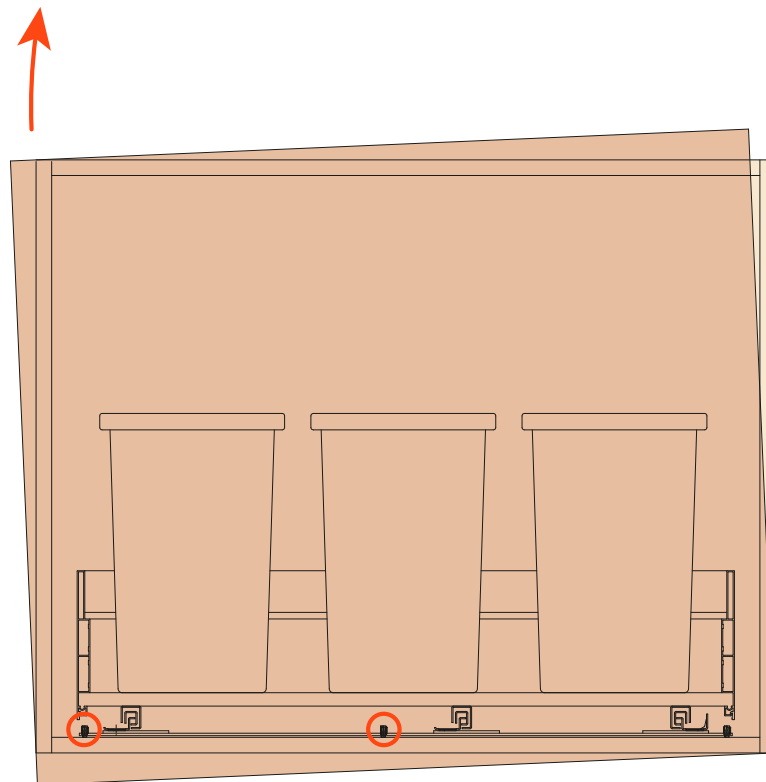

Vertical adjustment (+8 mm)

Operate on all adjusters for the vertical adjustment of the front panel.

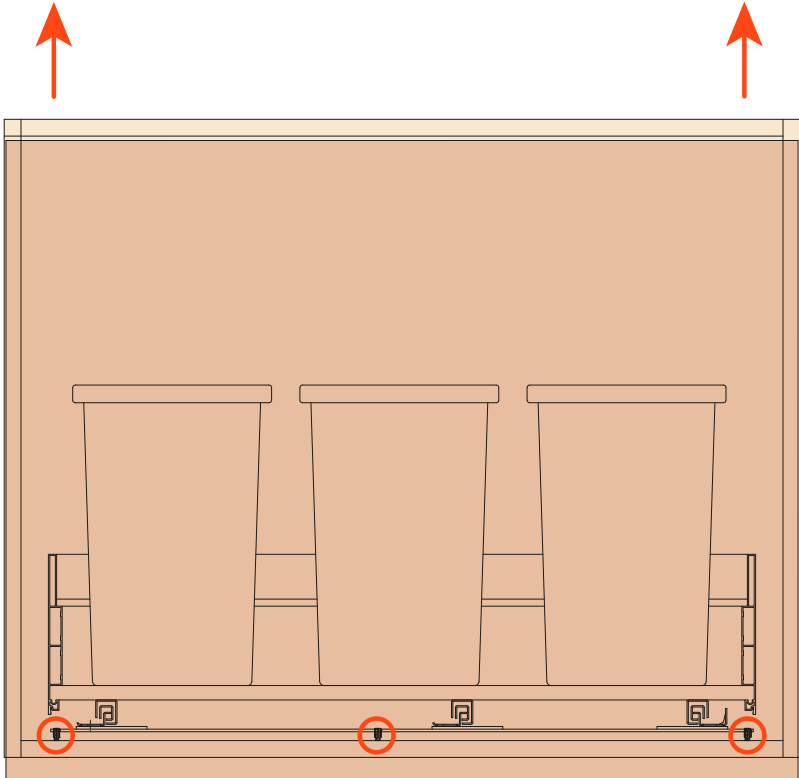

Waste bin systems - Adjustments

Depth tilt adjustment ($\pm 2^\circ$)

Operate on the front or the rear adjusters for the depth tilt adjustment of the front panel.

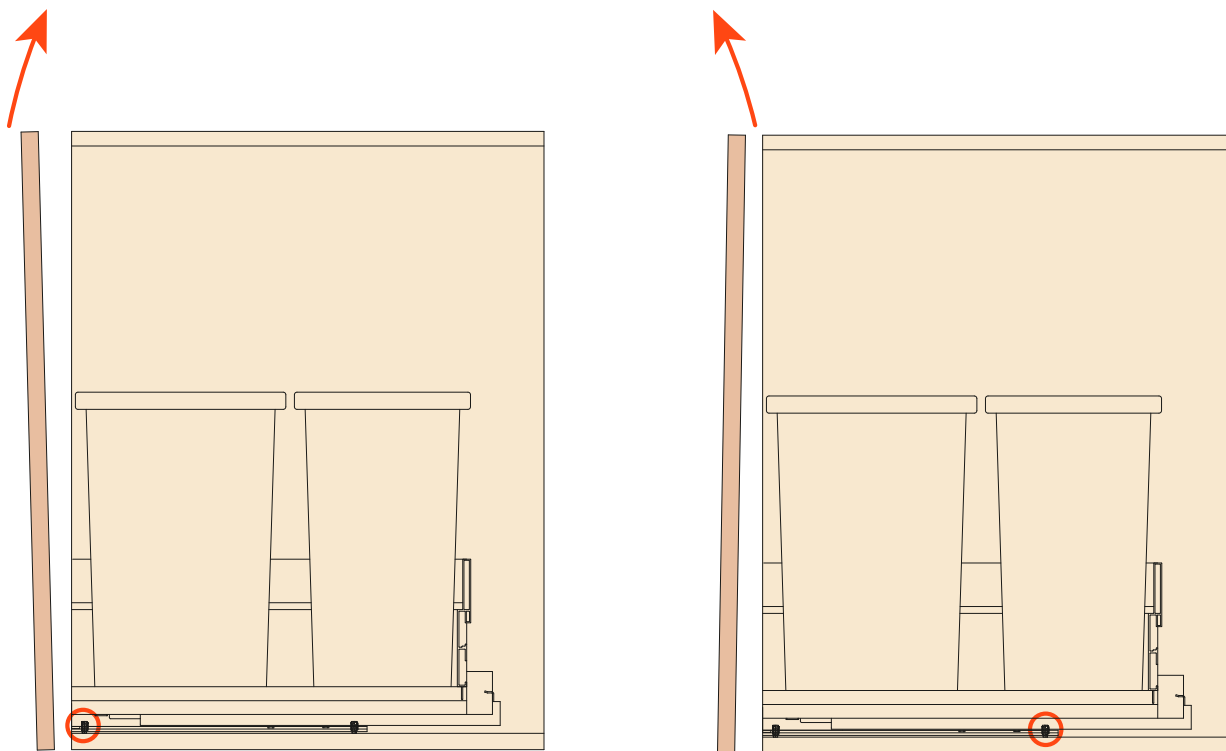

Depth adjustment - 3 way adjustable clip (± 2 mm)

Rotate the black wheel towards the inside or the outside of the drawer to increase or to reduce the gap between the front and the side.

The clip shows the position 0.

This operation is tool free.

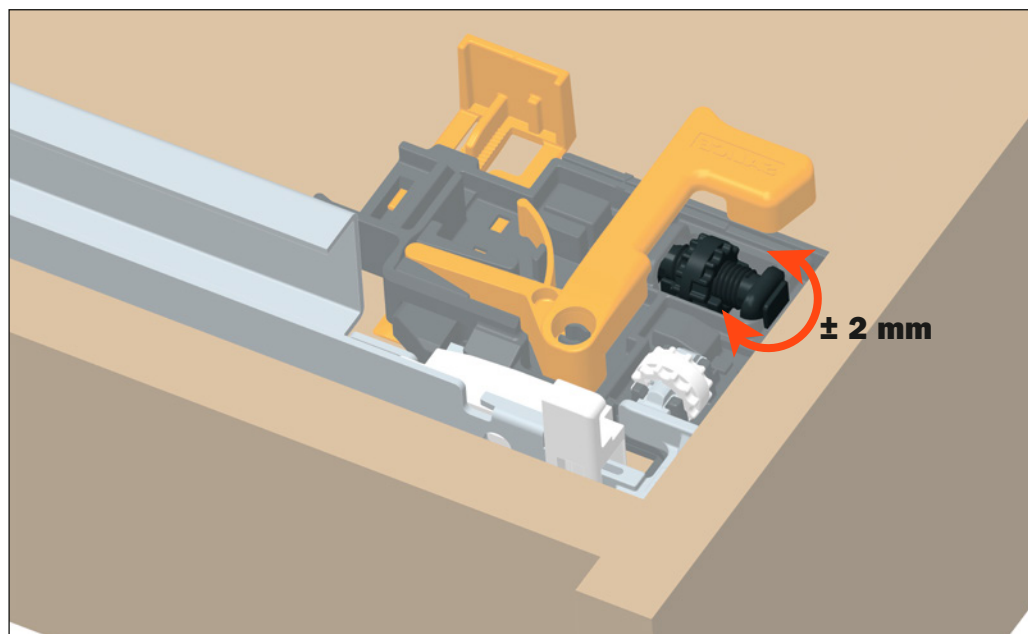
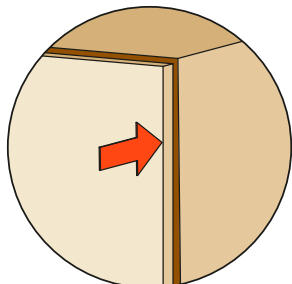
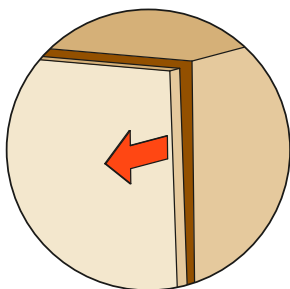

Sideways adjustment (± 6 mm)

Loosen the indicated screws for the sideways adjustment of the front panel.
Finally the fixing screws must be retightened.

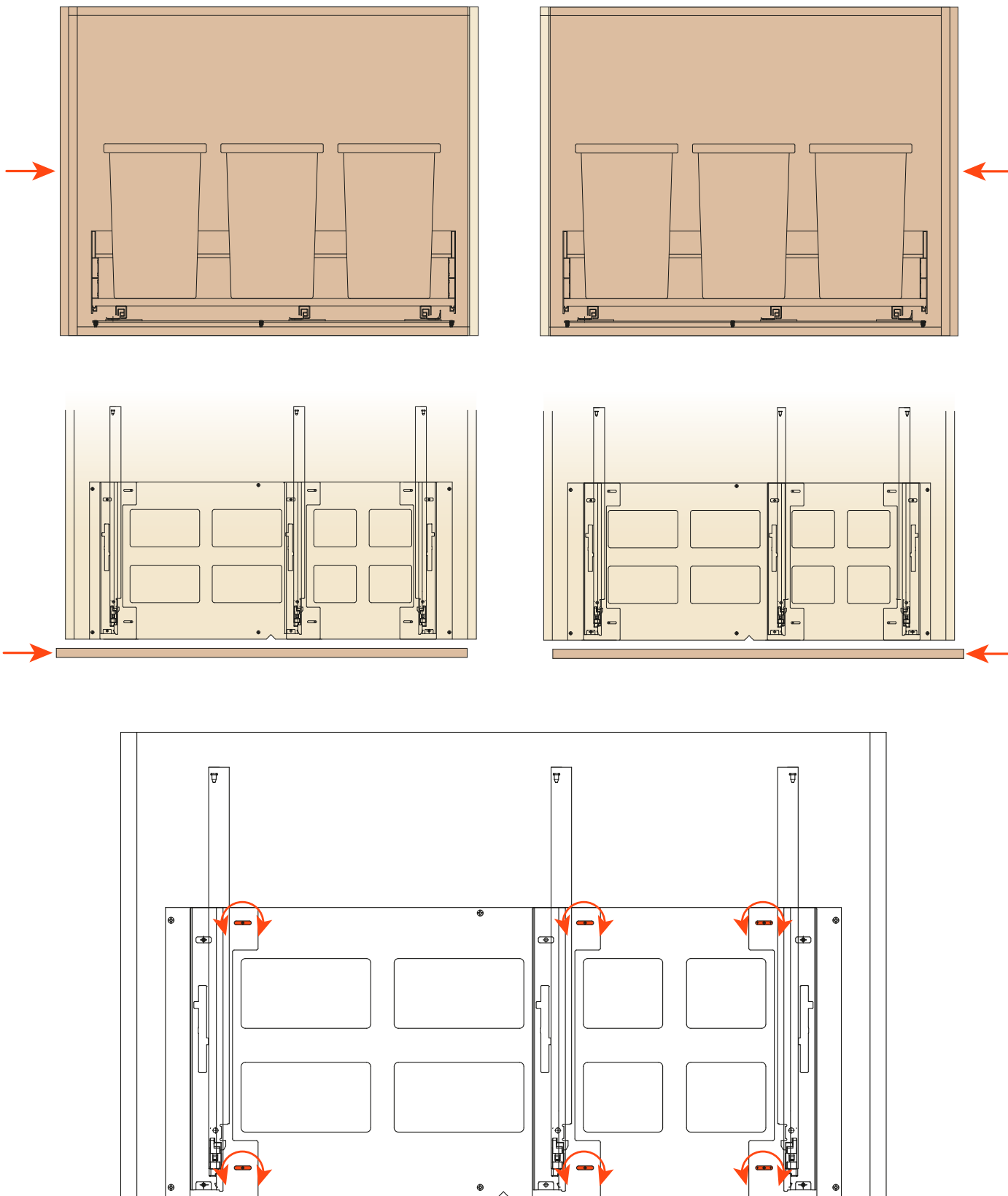

Waste bin systems - Accessories

SCCX83H9

Cover cap with embossed logo



SCXX83H9

Cover cap with silk-screen printed logo



AMSRX33

Reinforcing supports for the bottom of the drawer

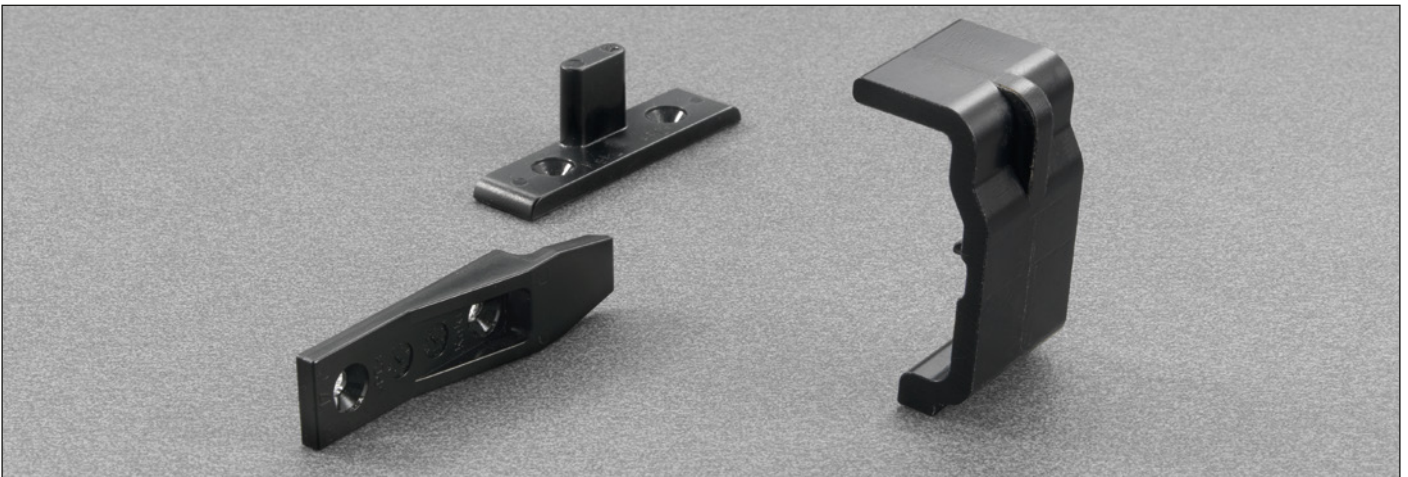

Waste bin systems - Lineabox finishes

White

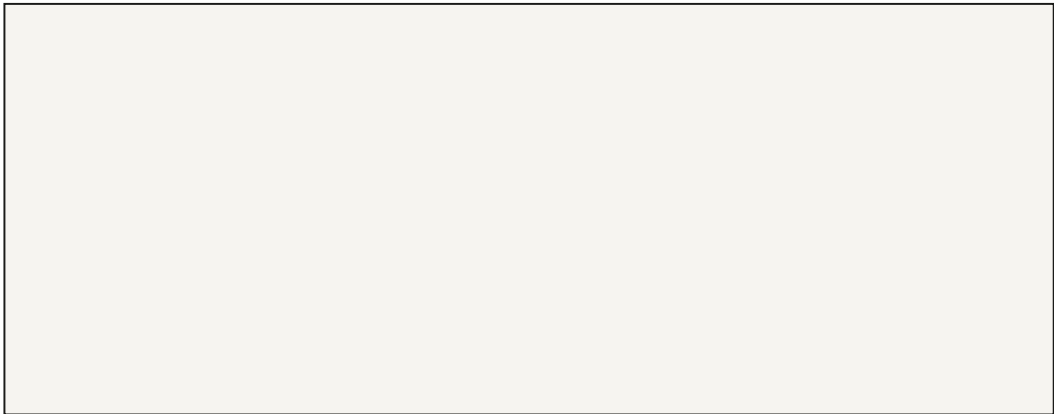

Stainless steel





Pull-out units

Pull-out units for the internal organization of kitchen storage units.

Completely preassembled, easy and intuitive to mount, they transform even the smallest spaces into useful containers for bottles and spice jars.



Single packing

MIN CABINET OPENING	PART NUMBER	BOX
115 mm (4-1/2")	AKEEDX_05000115	1 single kit (runners on right side)
153 mm (6")	AKEEDX_05000153	1 single kit (runners on right side)
305 (12")	AKESX_05000305	1 single kit (runners on left side)

Part number composition (example):

AKEEDX105000115

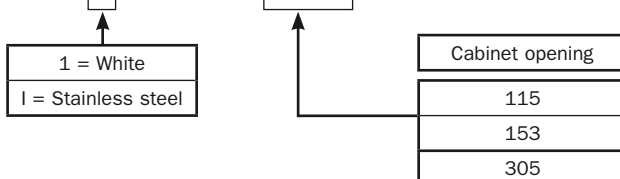

Pull-out units - Storage unit 115 mm (4-1/2") and 153 mm (6")



Kit consists of:

- 2 Futura runners 6555, full-extension, 500 mm length, to be fixed to the right side of the cabinet
- Screws for wooden frontal $\varnothing 4 \times 35$ mm
- 2 fully assembled Lineabox drawers, premounted on a frame

Technical features:

- Depth, vertical and sideways adjustment with the runner fixing clips
- For cabinets with side thickness min. 16 mm (5/8") max. 19 mm (3/4")

Accessories:

- Central drawer, 350 mm length

Finishes:

- Lineabox sides: White, Stainless steel

Dimensions with Futura full-extension runners

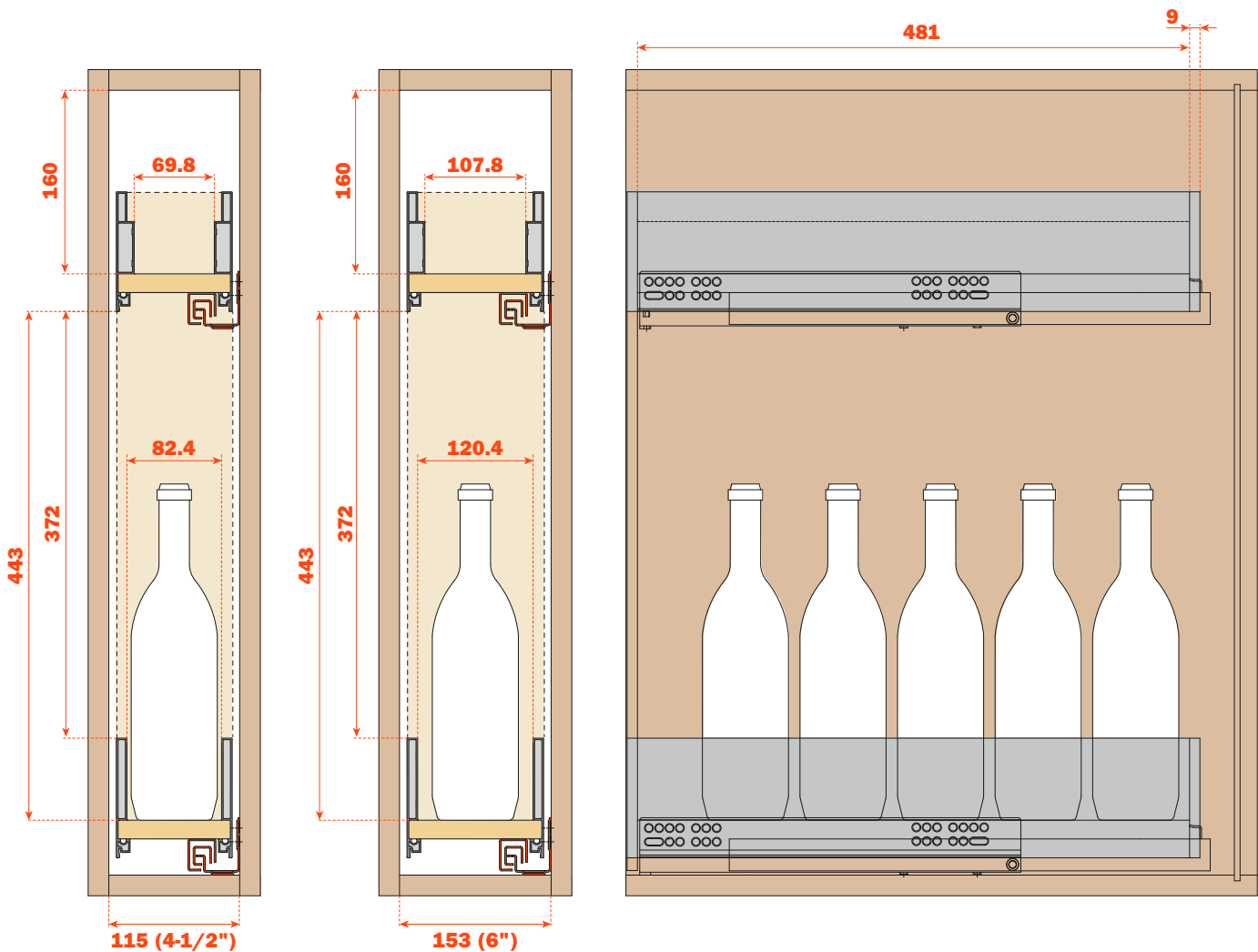

Pull-out units - Storage unit 305 mm (12")



Kit consists of:

- 2 Futura runners 6555, full-extension, 500 mm length, to be fixed to the left side of the cabinet
- 1 Shelf runner 65559, 500 mm length, to be fixed to the bottom of the cabinet
- Screws for wooden frontal $\varnothing 4 \times 35$ mm
- 2 fully assembled Lineabox drawers, premounted on a frame

Technical features:

- Depth, vertical and sideways adjustment with the runner fixing clips
- For cabinets with side thickness min. 16 mm (5/8") max. 19 mm (3/4")

Finishes:

- Lineabox sides: White, Stainless steel

Dimensions with Futura and Shelf full-extension runners

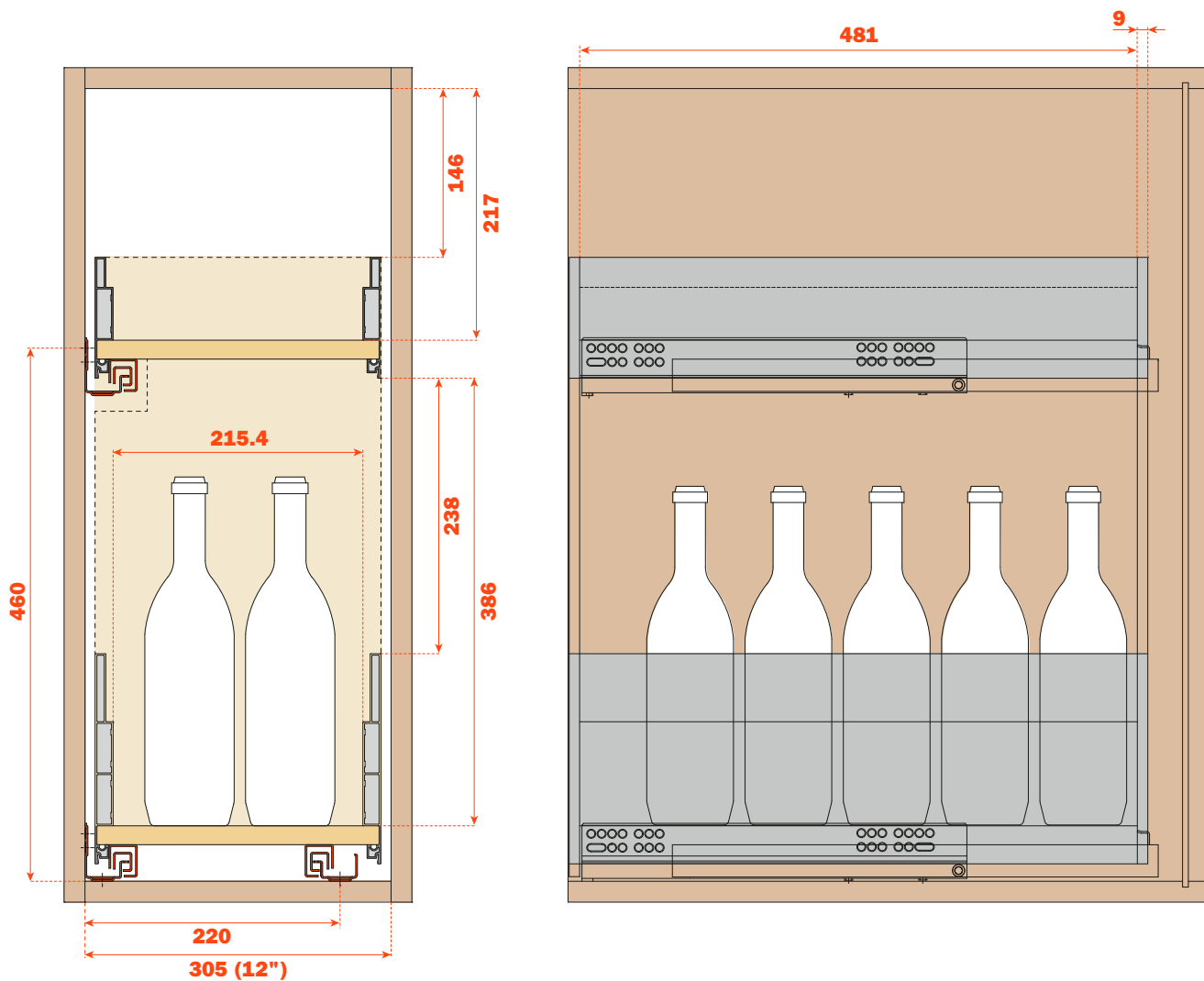

Pull-out units - Storage unit 115 mm (4-1/2") and 153 mm (6") - Accessories

AKCCMT_03000150

Central drawer

To be fixed to the front panel, using the pre-drilling, by frontal fixings and screw provided (\varnothing 3.5 x 20 mm).

Finishes: Lineabox sides: White, Stainless steel.

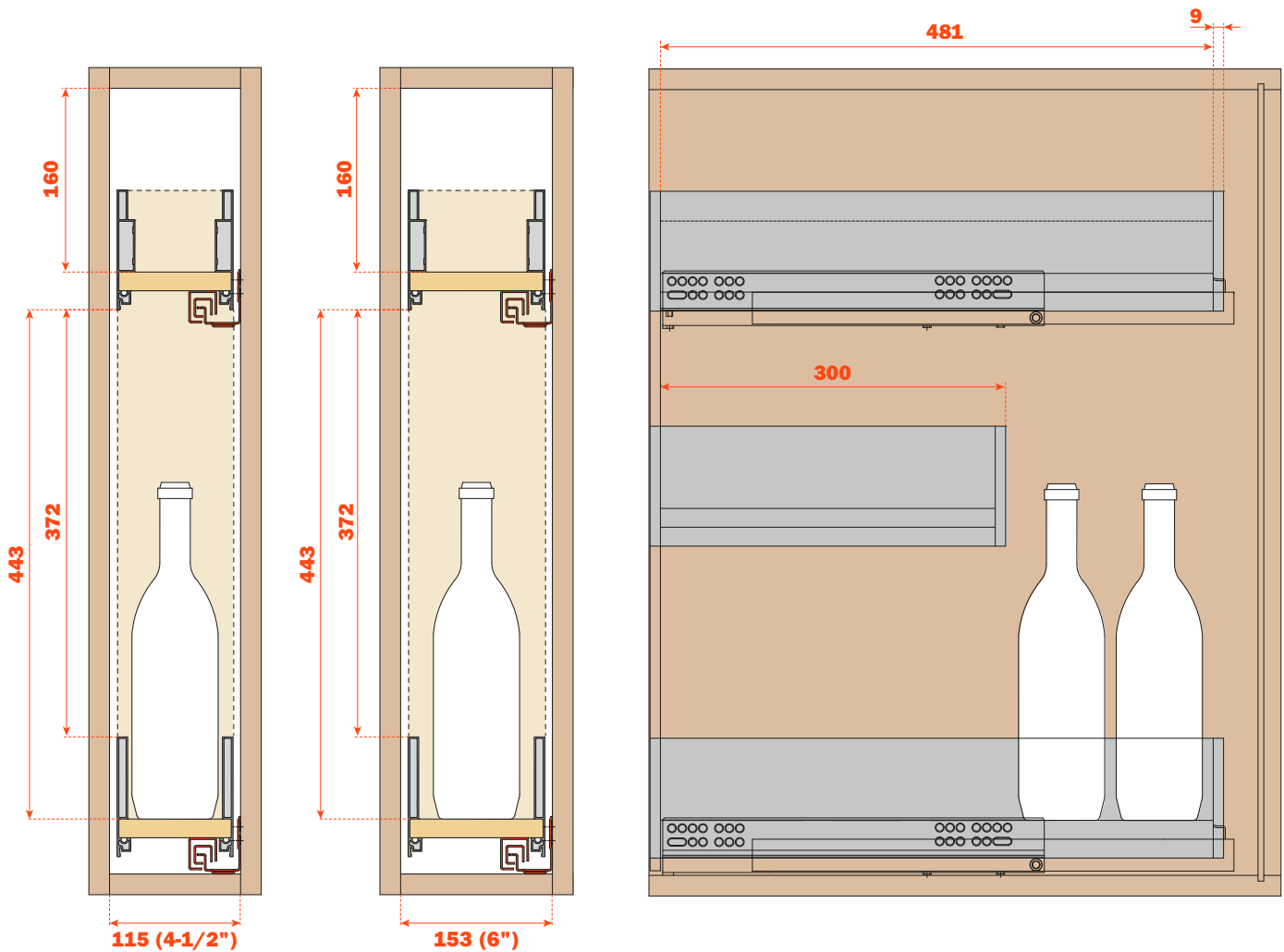
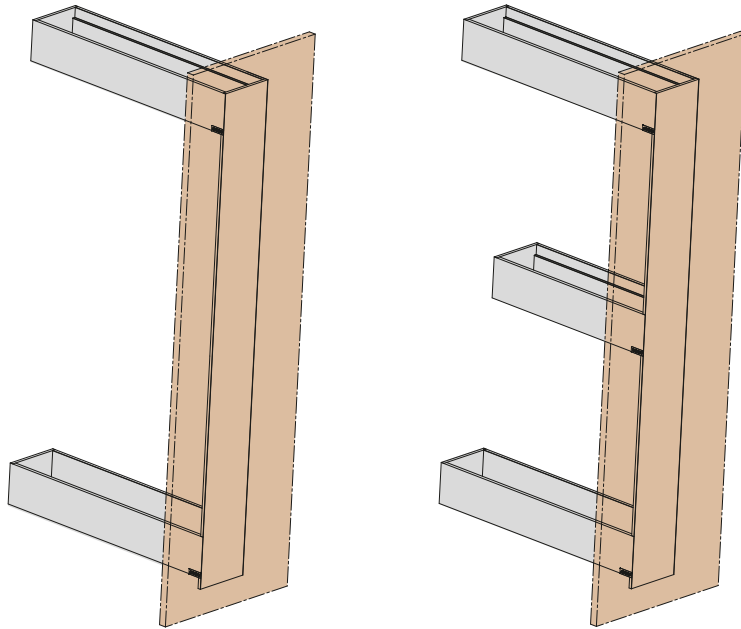

Pull-out units - Accessories

SCCX83H9

Cover cap with embossed logo



SCXX83H9

Cover cap with silk-screen printed logo



Pull-out units - Lineabox finishes

White



Stainless steel

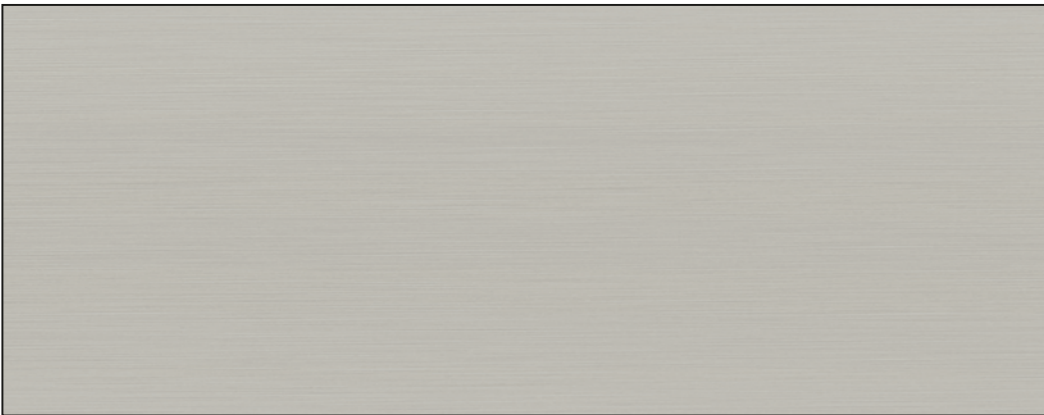

Proudly Supplied By



1-855-650-3265 | www.rugbyabp.com