



## ADJUSTABLE & FIXED STEEL DOOR FRAMES

21300 West 8 Mile  
Southfield, MI 48075  
248-352-0044  
Fax: 248-352-4222  
[www.idpincorporated.com](http://www.idpincorporated.com)

**ENTRY-FIT™**  
**K2A Series & F Series Steel Frames**

# Why IDP for Light Commercial Frames?

Commercial trends today require the strength and durability of commercial products but the warmth and comfort of residential styling. Our blended inventory reflects these trends and allows us to respond quickly. Sourcing light commercial products can be complicated, time consuming and very frustrating. Our program is designed to simplify that process.

It is driven by:

- Simplicity – Make it easy for you, your customer and IDP
- Speed – Light Commercial Products delivered at residential speeds
- Convenience – Residential and light commercial products from one, single source
- Prefinishing – Yes, we provide residential or light commercial frames painted in 7 popular paint colors

## Frames & Components – Easy installation

Both the K2A and F Series Frames are extremely durable and easy to install. Please refer to each of the frame's specific installation instructions for more information. Below are two cross sections breaking down the important components of each frame.

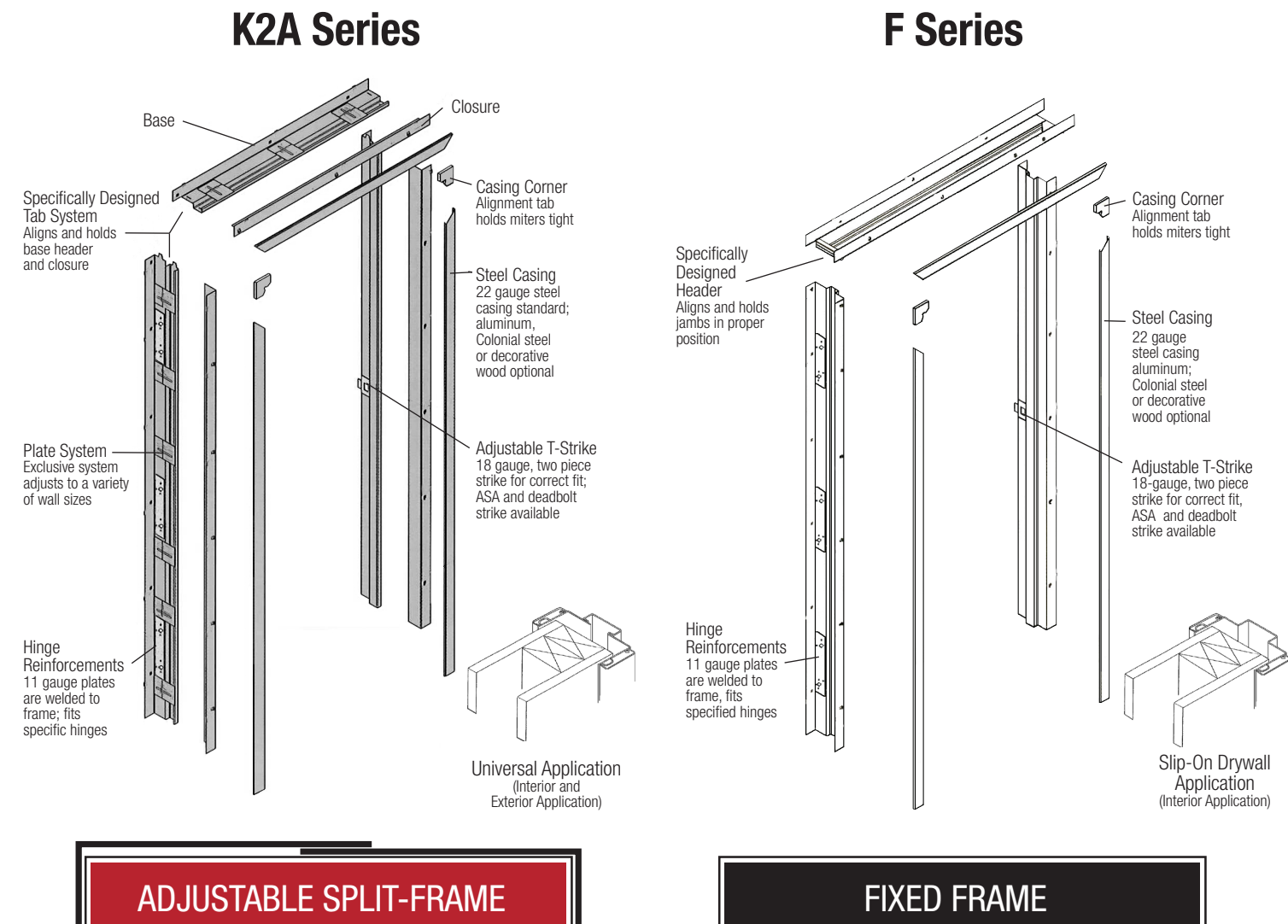

# F Series Steel Frame Installation Instructions

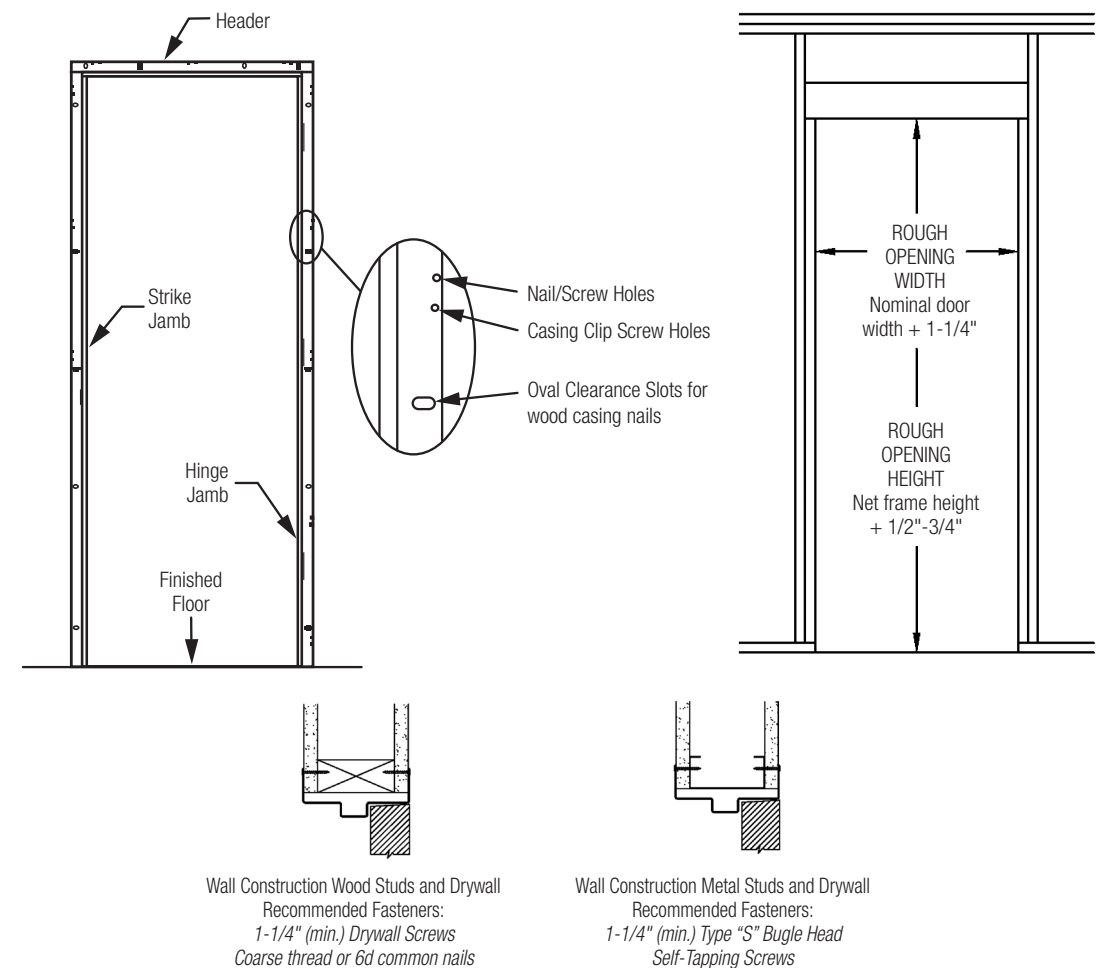
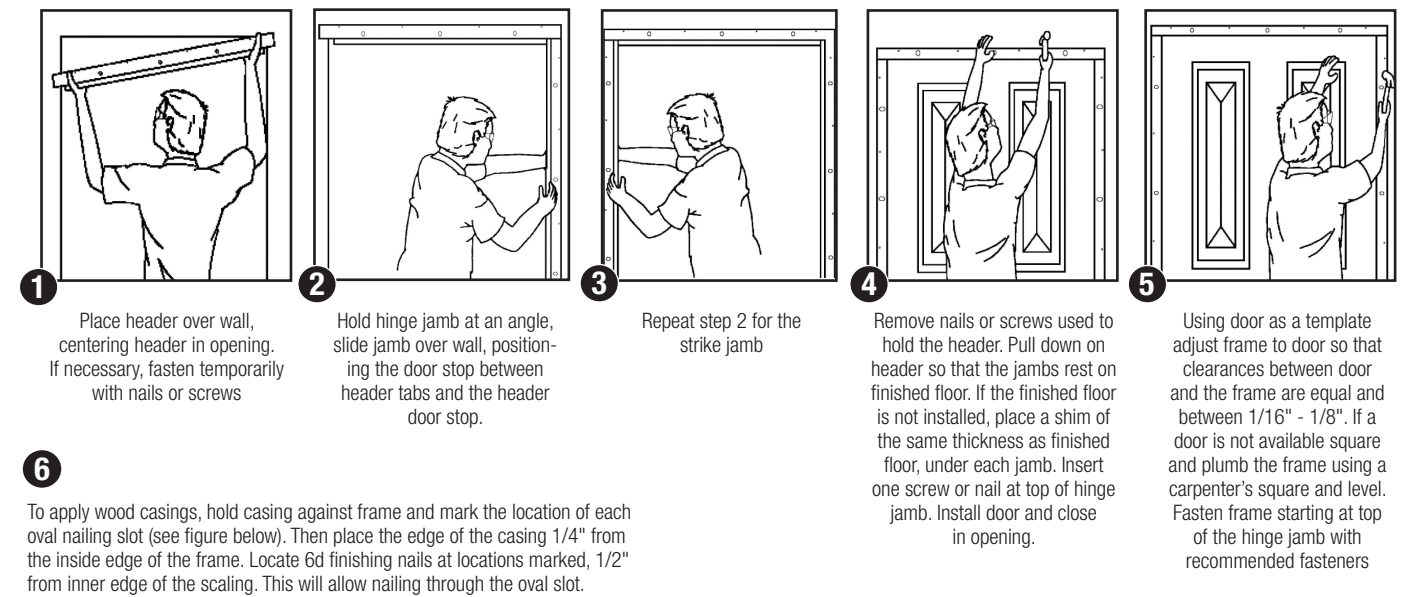





**1** Place bottom of door unit in bottom of opening. Lean top of door away from wall. Have helper caulk bottom of sill. Stand door upright, centered in opening and against wall.



**2** Use a level to plumb hinge jamb. Secure near top corner with a drywall screw.



**3** Install screws in the hinge jamb, start at top, checking for plumb as you work to bottom.



**4** Remove prehang clip and open door. Square header to hinge jamb. Install drywall screw in center of header.



**5** Close door and secure strike jamb using a 1/8" spacer for a consistent gap thru bottom - Install remaining screws in header.



**6** On the other side of door, slide the jamb closure trims into the jambs, starting from bottom.



**7** Slide header closure trim into header. Adjust vertical and header closure trims for a good fit in top corners.



**8** Secure the header closure trim and jamb closure trim near the top corners. Then install the remaining screws.

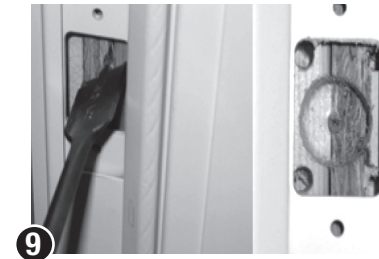

**9** Prepare stud for deadbolt clearance. Bore a 7/8"-1" hole to a depth of 1" from face of frame. Drill a 3/8" diameter hole at corners - 1" from face of frame.

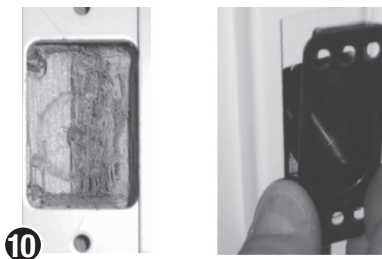

**10** Clear out remaining wood with chisel. Test depth and clearance with the plastic deadbolt strike box.



**11** Pull weatherstrip out of the kerf near sill to allow room for caulking. Install sill extender if required.

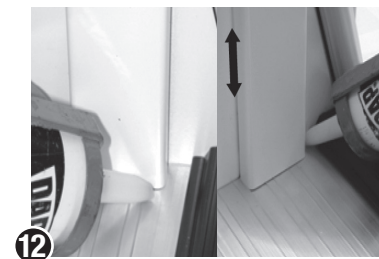

**12** Allow caulk to set before reinserting weatherstrip. Caulk outside sill and closure trim to floor. For exterior, caulk frame to closure trim at jambs & header (as arrow indicates).



**13** Install lockset and deadbolt per manufacturer's instructions. Install strike plate supplied with lockset. Install deadbolt strike plate and plastic dust box or blank plate with two #8-32 x 3/8" flat head screws - and you're ready to go.

**WARNING: The 90 minute fire rating is VOID unless this frame is installed with the closure kit.**

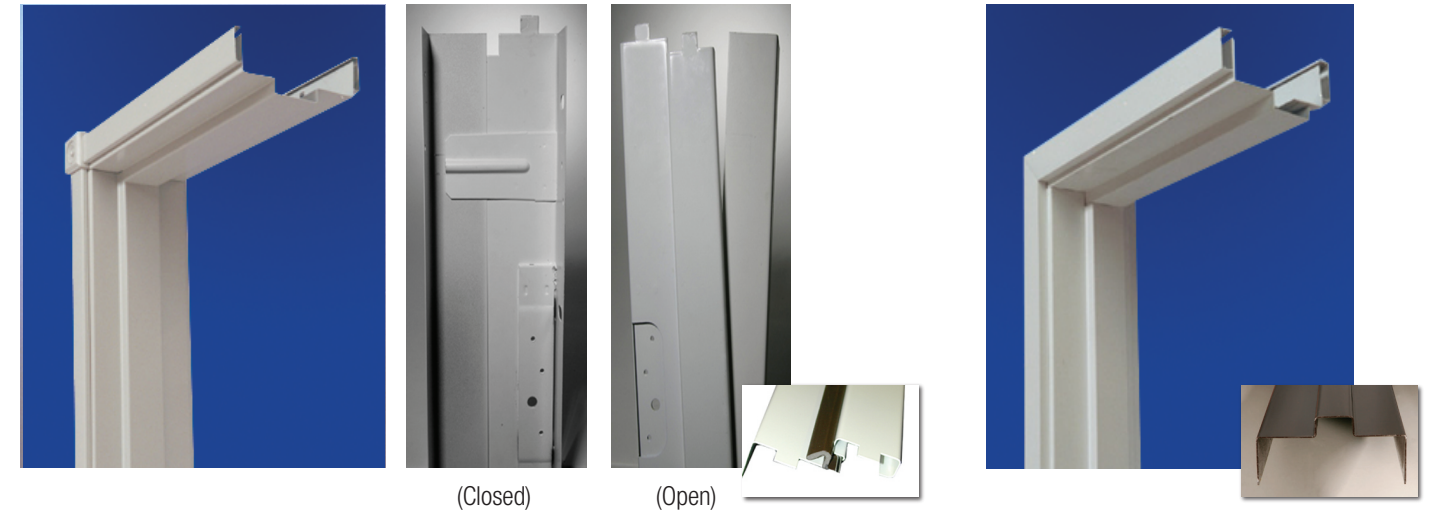

## K2A Series

### 18 Gauge Steel\* Adjustable Split Frame

Our K2A door frame is an adjustable steel frame with a kerf for weatherstripping designed for prehung applications for residential or light commercial, new or remodeling construction. The K2A door frame is also a solution for 90 minute applications for house to garage as well as light commercial and multi-family projects where prehung door units save time and money on installation. Other specs include:

- Warnock Hersey **90 MIN** neutral and positive pressure fire rated label, wood or steel studs
- Constructed of 18 gauge galvanized A60 steel
- Can be prehung with adjustable or ADA compliant sill
- 3 adjustable frame sizes available:  

4-1/2"-5-1/2"	5-1/2"-6-1/2"	6-1/2"-7-1/2"
---------------	---------------	---------------

 (1" adjustments, special/custom sizes are available)
- 1-3/4" doors only
- 5/8" stop height
- Removal without damage to the existing wall
- Includes anchoring holes and nail clearance slots for wood casing
- Hinge Prep for 4"
- 2-3/4" deadbolt prep and 2-3/4" adjustable T-strike prep



#### Options

- Special hinge or strike locations
- 4-7/8" ASA strike prep
- 2-1/4" Full lip strike prep
- Standard threshold prep
- Aluminum or Steel Casing

\* Main frames are 18 gauge and closure trim is 22 gauge for walls up to 7-1/2" walls over 7-1/2" is 18 gauge

## F Series

### 18 Gauge Steel Fixed Frame

Our F Series door frame is a fixed throat prefinished standard and kerf steel door frame designed for interior applications in new construction and light commercial projects such as assisted living, hotel/motel, office and residential. Other specs include:

- Warnock Hersey **90 MIN** neutral and positive pressure fire rated label, wood or steel studs
- Constructed of 18 gauge galvanized A60 steel
- 2 Fixed frame sizes available:  

4-5/8"	4-7/8"
--------	--------

 (10 other sizes varying from 4" to 7-3/8" are available as well as special/custom sizes)
- Available for both 1-3/8" and 1-3/4" doors
- 5/8" stop height
- Removable without damage to existing wall
- Hinge preps: 4" and 4-1/2"
- 2-3/4" adjustable T-strike prep
- Prefinished steel casing to match frame (1-1/2" width)

#### Options

- Special hinge or strike locations
- Non-standard wall size
- 4-7/8" ASA strike prep
- 2-1/4" Full lip strike prep
- 2-3/4" deadbolt prep
- Kerf fixed throat frame option
- Standard threshold prep
- Prefinished aluminum casing to match frame (1-1/2" width)
- Prefinished colonial casing to match frame (1-3/4" width)

**K2A Series Frame** (Adjustable Split-Frame)

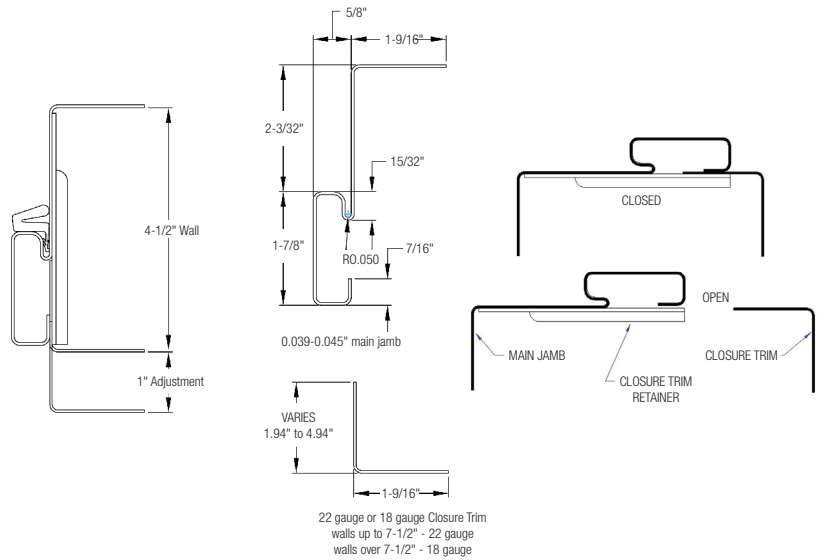

**F Series Frame** (Fixed Frame)

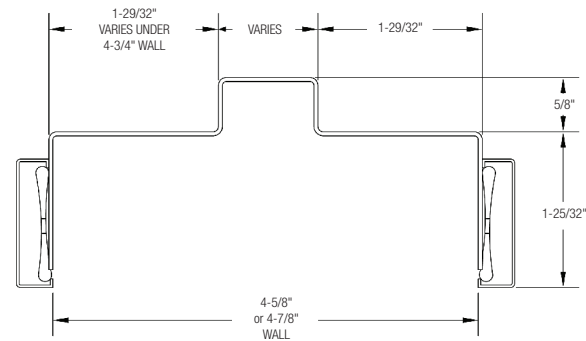

IDP was one of the first to offer prefinishing services and has perfected the process through the years. We offer 7 paint choices for commercial steel frames. IDP's affordable, convenient and premium quality paints will save you time, money and frustration.

Please note: *Paint samples may vary from the actual finish. Steel frames painted a dark color with prolonged exposure to direct sunlight are excluded from warranty.*



**Opening Sizes & Commercial Door Handings**

**Commercial Door Handings**  
(Viewed from Keyed Side of Door)

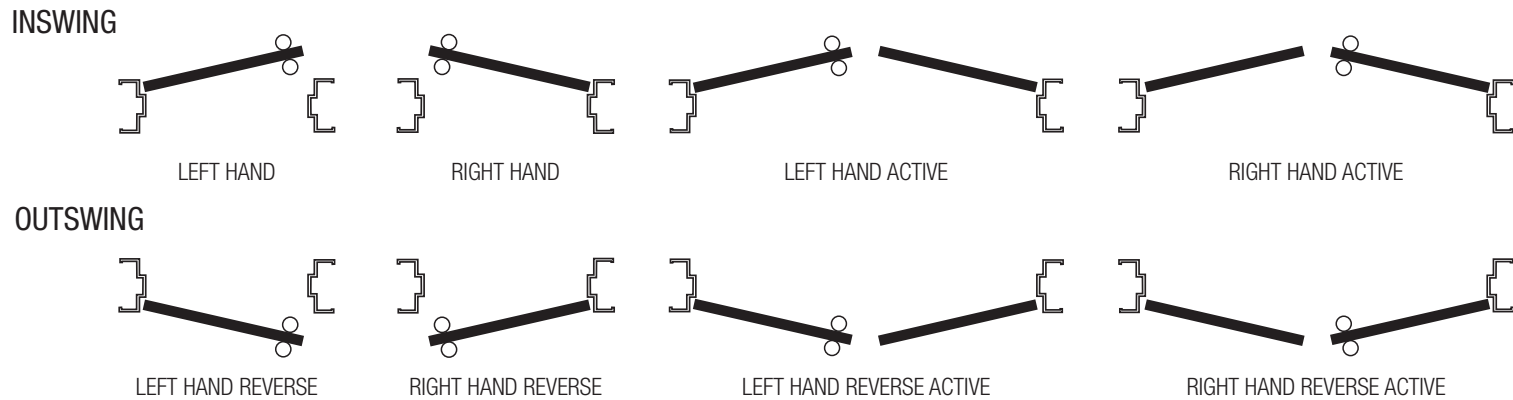

**Opening Sizes for Steel Frames**

**K2A Series Frame**

Door Size	ROUGH OPENING	
	Width	Height (Standard Sill)
2/8 x 6/8	33"	81-1/8"
3/0 x 6/8	37"	81-1/8"
3/0 x 7/0	37"	85-1/8"

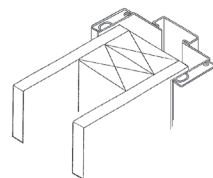

UNIVERSAL APPLICATION  
(Interior and Exterior Application)

**F Series Frame**

Door Size	ROUGH OPENING	
	Width	Height
2/8 x 6/8	33-1/4"	81"
3/0 x 6/8	37-1/4"	81"
3/0 x 7/0	37-1/4"	85"
6/0 x 6/8	73-1/4"	81"
6/0 x 7/0	73-1/4"	85"

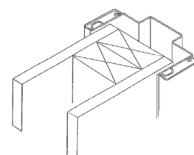

SLIP-ON DRYWALL  
(Interior Application)

**IDP Commercial Steel Frame Warranty**

The Warranty for IDP Entry-Fit™ Steel Frames manufactured by IDP, Inc. is to the original consumer purchaser to be free from defects in material and workmanship for a period of one (1) years from the date of purchase. All warranties for commercial use are limited to (1) years from the date of purchase.

This warranty is applicable only when the product(s) covered by it have been installed in accordance with the recommended written installation instructions of IDP, Inc. and with established building practices, have been accorded treatment which is considered good practice in the building industry regarding handling, storage and maintenance, and have been subject to only normal use. Because IDP, Inc. cannot control the manner in which its products are handled after leaving its premises. This warranty does not apply to the finish or accessories of any product whatsoever. We exclude from this warranty any lock mechanisms or closer hardware, or other miscellaneous hardware, or any other door attachments, or doors which we do not manufacture or furnish. The warranty covers normal usage and excludes a product: with scratches or abrasions; that has been altered, improperly installed, abused or misused; that has been damaged by acts of nature; or that has undergone normal wear and tear.

ANY AND ALL IMPLIED WARRANTIES HERETO ARE LIMITED TO ONE (1) YEAR FROM THE DATE OF PURCHASE.

Some states do not allow limitations on how long an implied warranty lasts, so the above limitations may not apply to you.

In the event the original consumer purchaser of any IDP Entry-Fit™ Steel Frames product believes that the frame or any parts thereof covered by this warranty are defective, a letter outlining the alleged defect should be sent postage prepaid to the following address:

International Door Products Inc.  
21300 W. 8 Mile Road  
Southfield, MI 48075  
Direct questions about this warranty to: [info@idpincorporated.com](mailto:info@idpincorporated.com)

Any IDP Entry-Fit™ Steel Frames, or any parts thereof covered by this warranty which, upon inspection by an authorized representative of IDP, Inc, are found by said representative to be defective will be repaired, replaced or, at the option of IDP, Inc, the purchase price of the frame or part will be refunded and does not include labor, installation costs, finishing costs, or indirect or consequential damages of any nature. Some states do not allow the exclusion or limitation of incidental or consequential damages, so the above limitation or exclusion may not apply to you. This warranty gives you specific legal rights, and you may also have other rights which vary from state to state.

Proudly Supplied By

