

BEST OF IBS
AWARDS 2022

WINNER
BEST WINDOW &
DOOR PRODUCT



POWERED BY
ENDURA

DOOR COMPONENTS MADE IN THE USA



PANOLOCK[®]+
MULTI-POINT LOCK

PanoLock[®] + is the first and only multi-point lock that works with a wide variety of off-the-shelf hardware, including electronic deadbolts! That's affordable security and performance for every entry door.



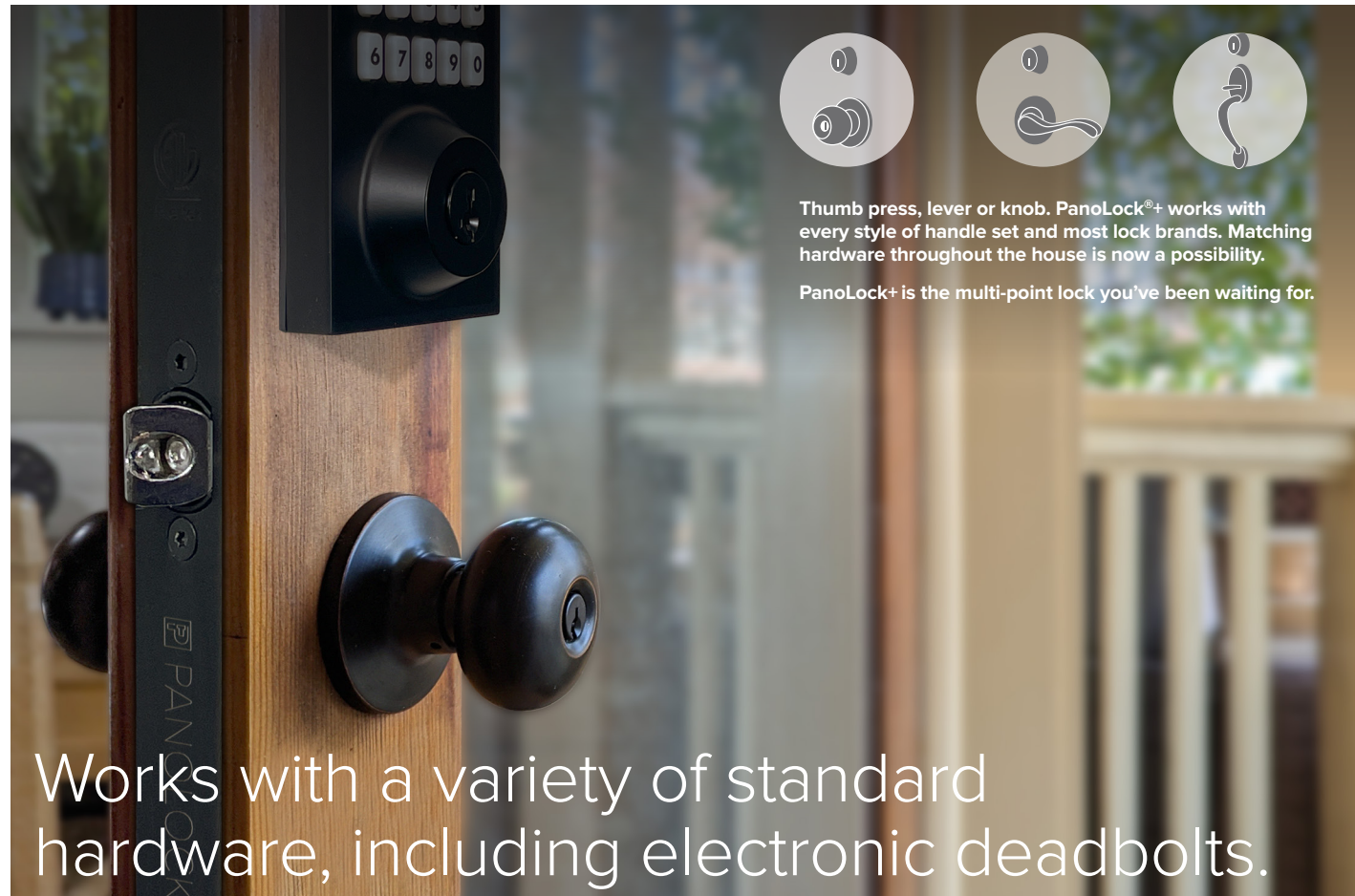

Works with a variety of standard hardware, including electronic deadbolts.



Security. Performance. Standard.

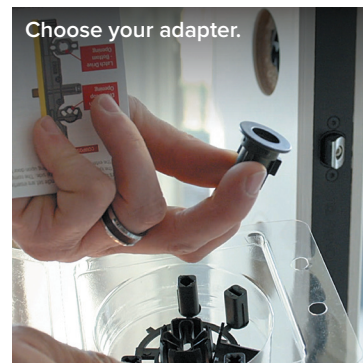

Use of multi-point locks has been limited, primarily due to high cost, difficult installation and operation, and the limitations of dedicated handset hardware that are required for each manufacturer's lock offering.

PanoLock+ Square Adapter.

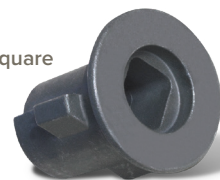

PanoLock®+ works with off-the-shelf hardware. Schlage, Kwikset, Emtek, Gatehouse, Baldwin, Brinks, and Defiant.* And more.

PanoLock+ integrates with almost every brand and type of handset through an innovative system of adapters.

* Please refer to our website to verify that your preferred locksets have been tested for compatibility with PanoLock+. <https://www.enduraproducts.com/panolockplus/>

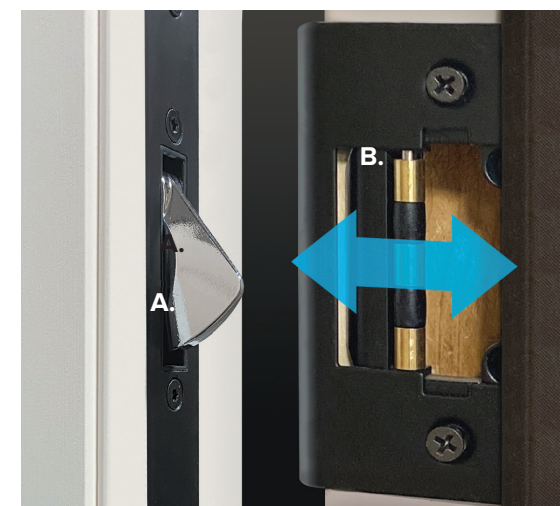
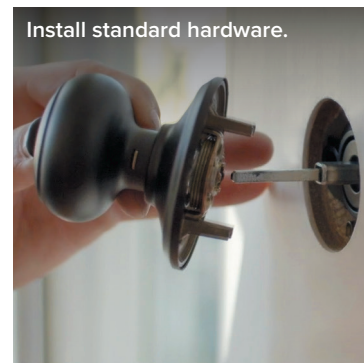

A. Tapered bolt. Unlike other locks that tend to catch, PanoLock+'s tapered bolts engage easily, even when the door is out of alignment.

B. Adjustable roller strike. Rollers lower operating force and allow the tapered bolt to gently snug the door panel against the weatherstrip.

Easy to live with.

A simple turn of the deadbolt operates both tapered bolts smoothly and the handle-set operates the handle-set latch. Three points of secure contact. PanoLock+ is easy to live with, even after years of use.

Secure performance.

PanoLock+ delivers the strength of three locking points for uncompromised protection. No weak hooks or catches. Just tested, proven strength.

Handleset Latch

Tapered Bolt





Easy to work with.

PanoLock+ is flexible. Handling and swing can be set in the shop, reducing the number of SKUs.

- No dedicated hardware required.
- No need for dedicated panels.
- No difficult installation.
- No expensive templates.

It's easy to say yes to PanoLock+.

Faceplate Finishes Sizes



Bronze
Anodized



Brushed
Clear
Anodized

6/8
8/0

Adjustable Strike Plate Finishes



Victorian
Bronze



Satin
Nickel



Bright
Brass



Black



Stainless
Steel

Tested and proven.

PanoLock+ has been extensively tested and proven to perform, even in severe conditions. During structural testing, PanoLock+ withstood winds up to 200 mph. Additional testing included:

- Operating torque/force tested as low as 2 in/lbs with select handle sets.
- Durability Cycle Testing Passed 100,000 cycles.
- Air infiltration and exfiltration Tested to A2.
- Water Infiltration and Exfiltration Tested DP60 with Z-Articulating Cap sill.
- Impact/Forced Entry Resistance Tested Grade 40.



Proudly Supplied By



1-615-885-0355 | www.warrenbros.com

INNOVATION POWERED BY ENDURA.

Endura is built on innovation and a commitment to performance. Our products are problem solvers, born directly from insight we've learned from our customers about real-world challenges. We're always pushing ourselves to face an ever-present challenge: How can we make your door system work better?

Innovation protected under patents and patents pending in U.S. and Canada.
See www.endurapatents.com.

Form # PanoLock+ 23 Effective 2.23 © Endura Products



DOOR COMPONENTS MADE IN THE USA

8817 W. Market St., Colfax, NC 27235
1.800.334.2006 www.enduraproducts.com