



## Architectural Aluminum Trim

**Make a statement with style.**

Product Catalog 8th Edition

**TAMLYN**<sup>®</sup>  
FAMILY. VALUE. SERVICE.





## Innovation from A Trusted Source

TAMLYN® was established in May 1971 by Ron Tamlyn, Sr. with \$800 borrowed money and help from his wife, Jean, in a small shack in the back yard of their modest home in Bellaire, Texas. We remain family-owned and operated to this day. Our history is one of quality, innovation, and proven performance. We are proud to represent the manufacturing end of the building products industry.

TAMLYN can provide ALUMINUM TRIM for both interior & exterior. As a division of TAMLYN®, XtremeInterior™ Aluminum Solutions is excited to provide the newest interior product line of aluminum trim available in the architectural supply industry.

TAMLYN's line of exterior aluminum trim - XtremeTrim® - has thousands of design and color options, allowing architects and users to dramatically improve their building aesthetics and create modern architectural lines. For more information about our exterior architectural profiles, visit our website at [www.tamlyn.com](http://www.tamlyn.com) and look for XtremeTrim®.

TAMLYN has you covered, both inside and out, for all your aluminum trim needs.

**FAMILY. VALUE. SERVICE.**







## Simple but Significant

A team of our architects led the process of selecting and designing each profile for the desired aesthetic effect and specific application. We offer quality products, competitive prices and fast service. While we recognize we are in a global economy, we remain committed to making products by choice in the USA where possible, giving customers a quality domestic option.



## Moving Forward

As the push for more contemporary design reaches into every architectural sector, XtremeInterior™ by Tamlyn is here with experienced technical assistance and custom profile development.





ORDER HERE

ORDER HERE

ORDER HERE

ORDER HERE

JUICY  
BURGER



# TABLE OF CONTENTS

## REVEALS

RV	Reveal	10	8
RVBD	Reveal Bead	11	
RVDF	Reveal Double Flange	12	
RPS	Reveal Projecting Square	13	
RVRD	Reveal Round	14	
RVRS	Reveal Square	15	
RVSA	Reveal Square Angled	16	
RVST	Reveal Square Tapered	17	
RVV	Reveal V	18	
RVVF	Reveal V Flange	19	

## BASES

BCT	Base Cove Transition	22	20
BF	Base Flush	23	
BFF	Base Flush Flat	24	
BLF	Base Ledge Flange	25	
BPR	Base Projecting Round	26	
BPRR	Base Projecting Round Reveal	27	
BPS	Base Projecting Square	28	
BPSR	Base Projecting Square Reveal	29	
BRDF	Base Reveal Double Flange	30	
BRF	Base Reveal Flange	31	
BRL	Base Reveal Ledge	32	
BSL	Base Shadow Line	33	

## CORNERS

CAC	Corner Arc	38	36
CALP	Corner Arrow Low Profile	39	
CBD	Corner Bead	40	
CBV	Corner Bevel	41	
CEL	Corner Elliptical	42	
CRA	Corner Radiused	43	
CRD	Corner Round	44	
CRR	Corner Rectangular Radiused	45	
CRS	Corner Rectangular Square	46	
CRT	Corner Rectangular Tapered	47	
CSQ	Corner Square	48	
CWO	Corner W	49	
CXF	Corner X	50	
ICAC	Inside Corner Arc	51	
ICBV	Inside Corner Bevel	52	
ICEL	Inside Corner Elliptical	53	
ICRA	Inside Corner Radiused	54	
ICRD	Inside Corner Round	55	
ICRF	Inside Corner Flange	56	
ICSQ	Inside Corner Square	57	

## 2-PIECE SYSTEMS

CHFS	Channel Flush Square	62	60
CHRS	Channel Rectangular Square	63	
CHSA	Channel Square Angled	64	
CHST	Channel Square Tapered	65	
IBRR	Insert Blade Rectangular Round	66	
IBRS	Insert Blade Rectangular Square	67	
IBRT	Insert Blade Rectangular Tapered	68	
IPRS	Insert Projecting Radiused Square	69	
IRSQ	Insert Rectangular Square	70	

## MOLDINGS & MILLWORK

MCK	Corner Key	74	72
MCS	Corner Square Mold	75	
MCR	C Mold	76	
MEC	End Cap	77	
MECS	End Cap Step	78	
MFC	Corner Flush Mold	79	
MFF	Flush Flat Mold	80	
MFR	F Mold	81	
MGT	Glass Track	82	
MHC	H Mold Curve	83	
MHF	H Mold Flat	84	
MJR	J Mold	85	
MKE	Knife Edge	86	
MLR	L Mold	87	
MLU	Universal L Mold	88	
MPH	Panel H Mold	89	
MPJ	Panel J Mold	90	
MPOC	Panel Outside Corner Mold	91	
MPS	Projecting Square Mold	92	
MRV	Reveal Mold	93	
MTR	T Mold	94	
MWR	W Mold	95	
MZR	Z Mold	96	

## ACOUSTICAL

PACT	Classic Perimeter Trim	100	98
PACT-KE5	Knife Edge Perimeter Trim	101	

## Reveals

Accessorize your interiors with a variety of beautiful reveal profiles that can be installed vertically, horizontally and diagonally.



# RV

## Reveal

Creates a minimalist shadow line with simple reveal space that allows installation vertically, horizontally or diagonally. Can be used in conjunction with 5/8" drywall, panel installation and wrapped surface finishes such as fabric or vinyl wall coverings. Ridged faces for tape & float and pre-punched holes for easy install (hole placement may vary).

Available in 10' length. 6063 T5 aluminum with standard clear anodized or primed finish. Anodized color and powder coating finishes available with custom color matching.

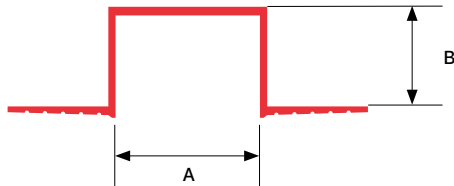

ITEM ID	A	B
RV-14	1/4"	1/4"
RV5-12	1/2"	1/2"
RV5-100	1"	1/2"
RV5-200	2"	1/2"

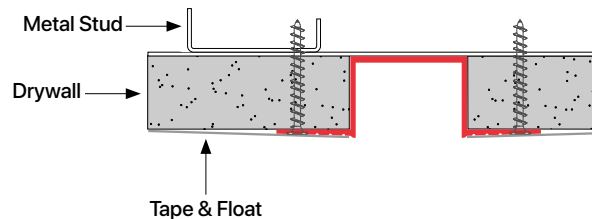
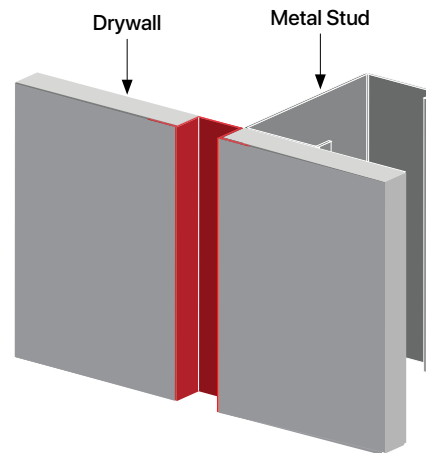
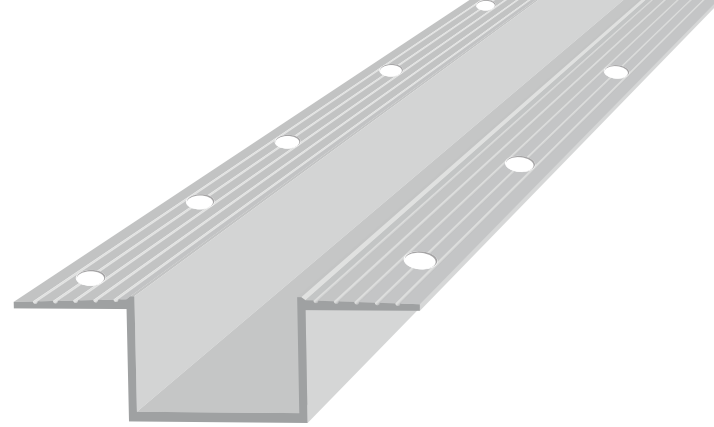

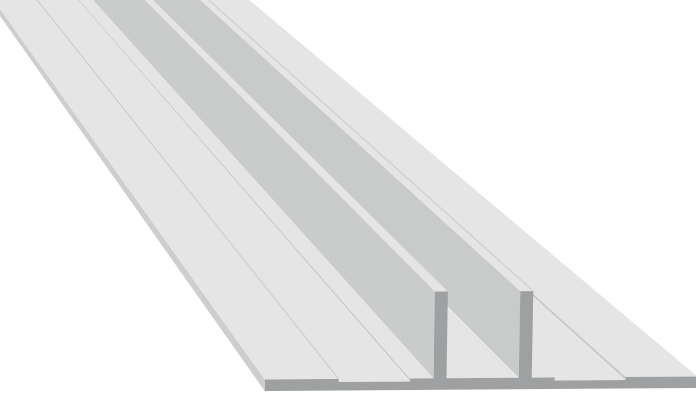

# RVBD

## Reveal Bead

Serves as an aesthetic expansion joint between panels. A better, more appealing and secure solution to the "open wall" vertical joint look popular in many areas. Designs can be installed vertically, horizontally or diagonally. Used in conjunction with panel installation and wrapped surface finishes such as fabric or vinyl wall coverings.

Available in 10' length. 6063 T5 aluminum with standard clear anodized or primed finish. Anodized color and powder coating finishes available with custom color matching.

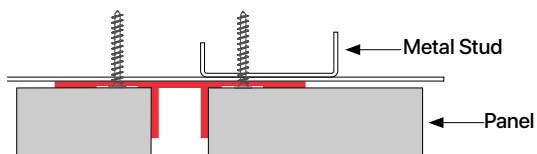
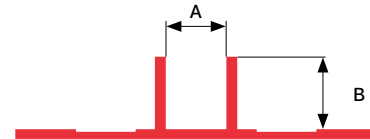
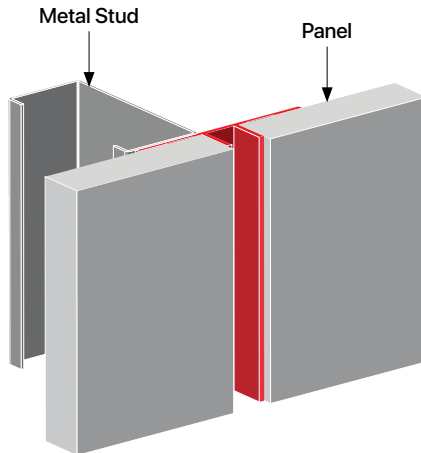

ITEM ID	A	B
RVBD-516-14	1/4"	5/16"
RVBD-516-12	1/2"	5/16"
RVBD-112	1/2"	1"
RVBD-34	3/4"	3/4"

# RVDF

## Reveal Double Flange

Creates a sleek shadow line with simple reveal space and double flange arms. Can be installed vertically, horizontally or diagonally. Used in conjunction with 5/8" drywall, panel installation and wrapped surface finishes such as fabric or vinyl wall coverings. Ridged faces for tape & float.

Available in 10' length. 6063 T5 aluminum with standard clear anodized or primed finish. Anodized color and powder coating finishes available with custom color matching.

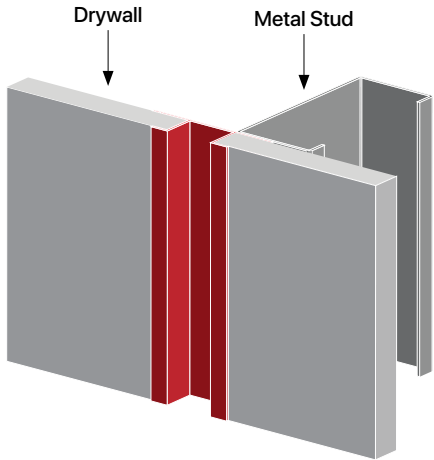
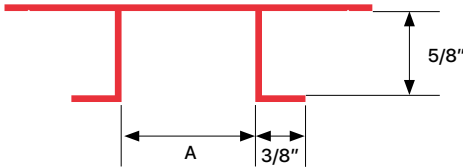
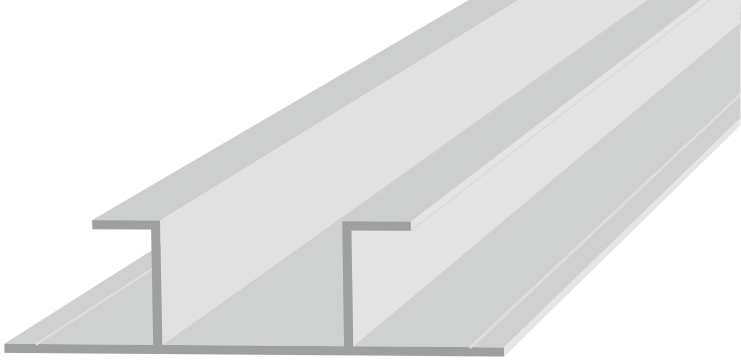

ITEM ID	A
RVDF-12	1/2"
RVDF-100	1"
RVDF-200	2"

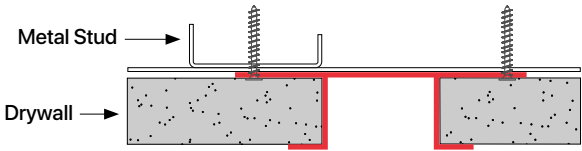

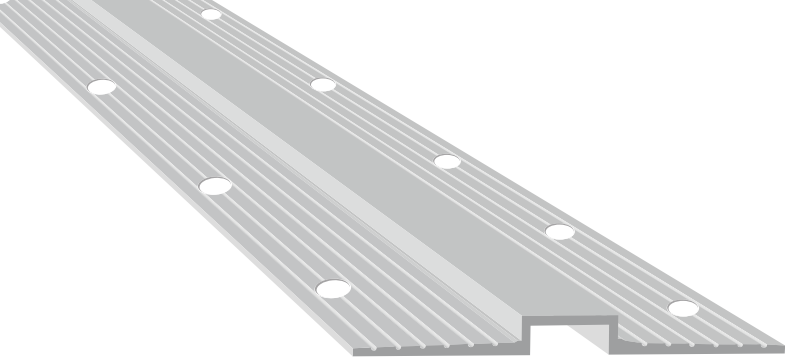

# RPS

## Reveal Projecting Square

Creates an appealing design with projecting square detail that allows installation vertically, horizontally or diagonally. Can be used in conjunction with drywall or behind panel installation and wrapped surface finishes such as fabric or vinyl wall coverings. Ridged faces for tape and float and pre-punched holes for easy install (hole placement may vary).

Available in 10' length. 6063 T5 aluminum with standard clear anodized or primed finish. Anodized color and powder coating finishes available with custom color matching.

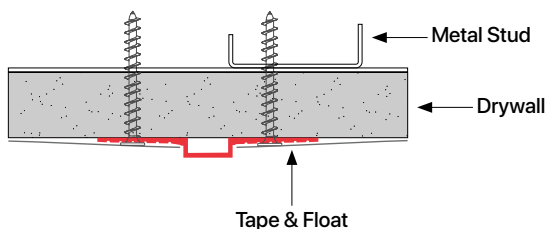
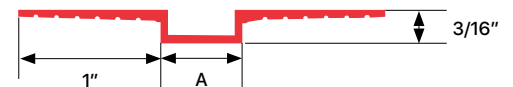
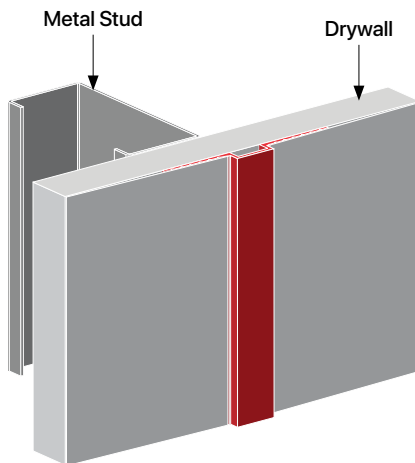

ITEM ID	A
RPS-14	1/4"
RPS-12	1/2"
RPS-100	1"

# RVRD

## Reveal Round

Creates an appealing recess with projecting details that allows installation vertically, horizontally or diagonally. Can be used in conjunction with 5/8" drywall, panel installation and wrapped surface finishes such as fabric or vinyl wall coverings.

Available in 10' length. 6063 T5 aluminum with standard clear anodized or primed finish. Anodized color and powder coating finishes available with custom color matching.

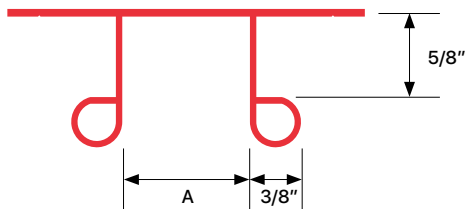

ITEM ID	A
RVRD-12	1/2"
RVRD-100	1"
RVRD-200	2"

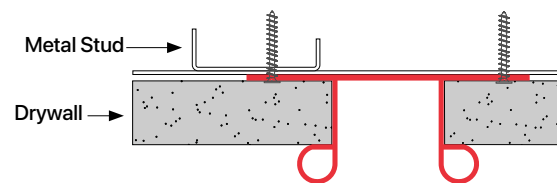
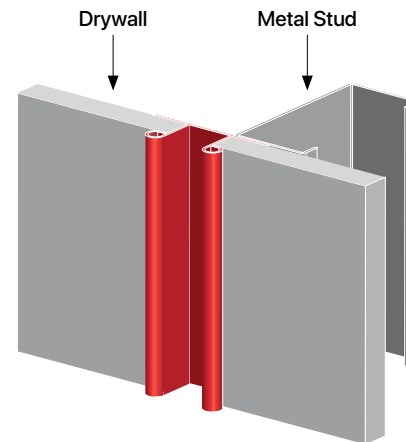

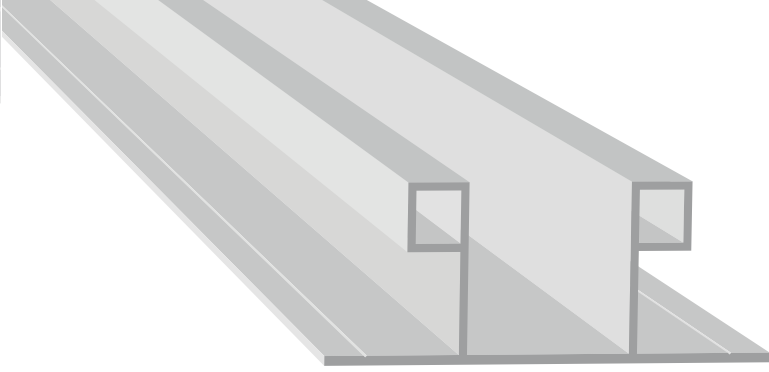

# RVRS

## Reveal Square

Creates an appealing recess with projecting square details that allows installation vertically, horizontally or diagonally. Can be used in conjunction with 5/8" drywall, panel installation and wrapped surface finishes such as fabric or vinyl wall coverings.

Available in 10' length. 6063 T5 aluminum with standard clear anodized or primed finish. Anodized color and powder coating finishes available with custom color matching.

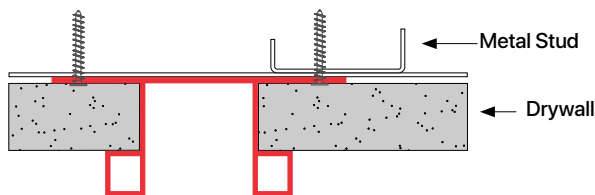
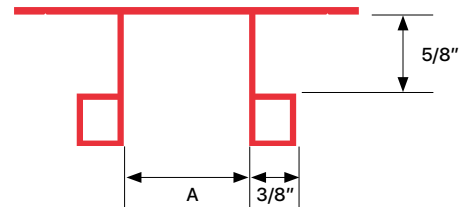
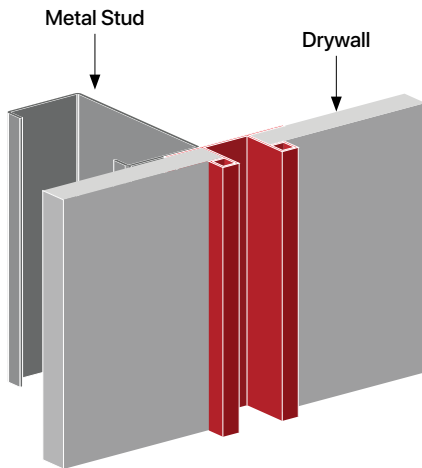

ITEM ID	A
RVRS-12	1/2"
RVRS-100	1"
RVRS-200	2"

# RVSA

## Reveal Square Angled

Creates an appealing recess with projecting angled details that allows installation vertically, horizontally or diagonally. Can be used in conjunction with 5/8" drywall, panel installation and wrapped surface finishes such as fabric or vinyl wall coverings.

Available in 10' length. 6063 T5 aluminum with standard clear anodized or primed finish. Anodized color and powder coating finishes available with custom color matching.

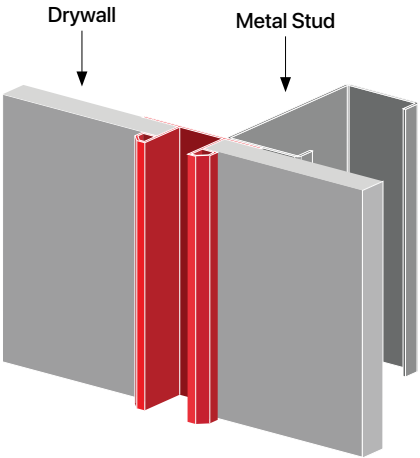
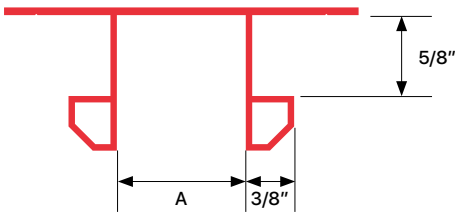
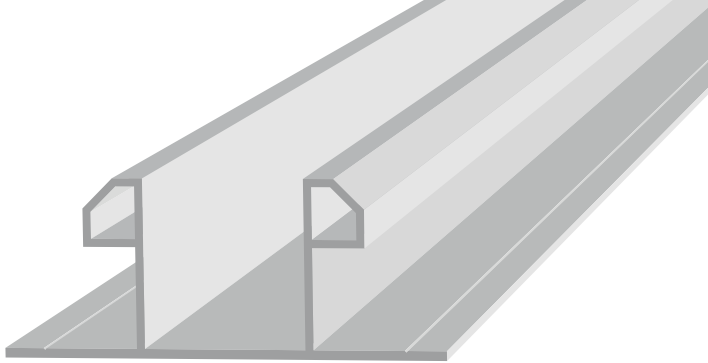

ITEM ID	A
RVSA-12	1/2"
RVSA-100	1"
RVSA-200	2"

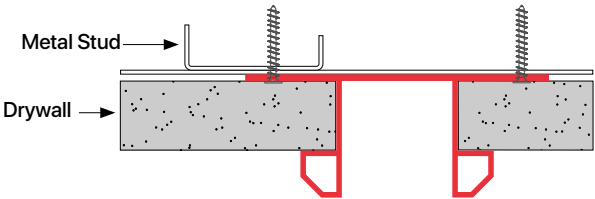

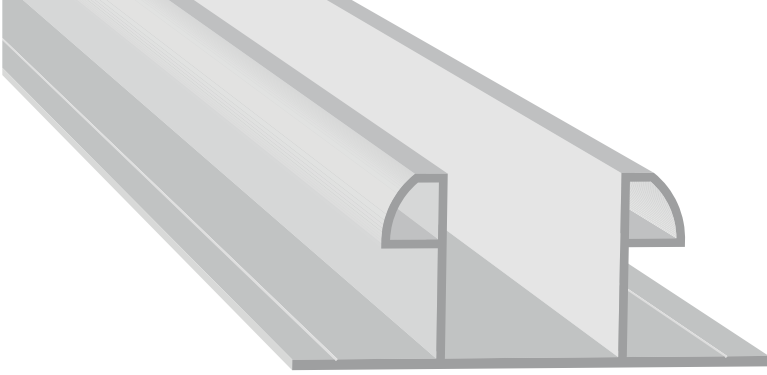

# RVST

## Reveal Square Tapered

Creates an appealing recess with projecting tapered details that allows installation vertically, horizontally or diagonally. Can be used in conjunction with 5/8" drywall, panel installation and wrapped surface finishes such as fabric or vinyl wall coverings.

Available in 10' length. 6063 T5 aluminum with standard clear anodized or primed finish. Anodized color and powder coating finishes available with custom color matching.

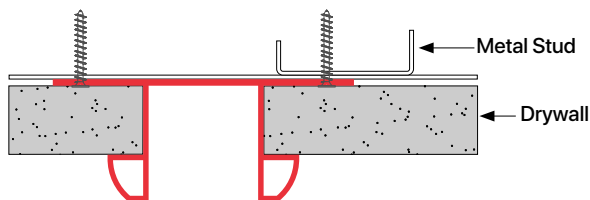
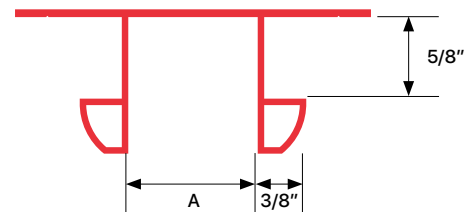
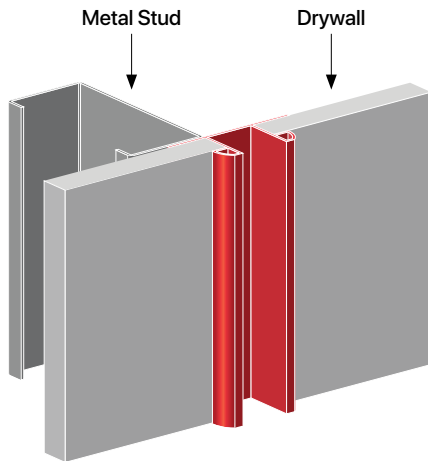

ITEM ID	A
RVST-12	1/2"
RVST-100	1"
RVST-200	2"

# RVV

## Reveal V

Creates a unique shadow line with V-shaped reveal space that allows installation vertically, horizontally or diagonally. Can be used in conjunction with 5/8" drywall, panel installation and wrapped surface finishes such as fabric or vinyl wall coverings. Ridged faces for tape & float and prepunched holes for easy install (hole placement may vary).

Available in 10' length. 6063 T5 aluminum with standard clear anodized or primed finish. Anodized color and powder coating finishes available with custom color matching.

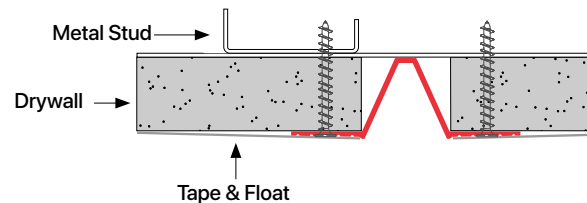
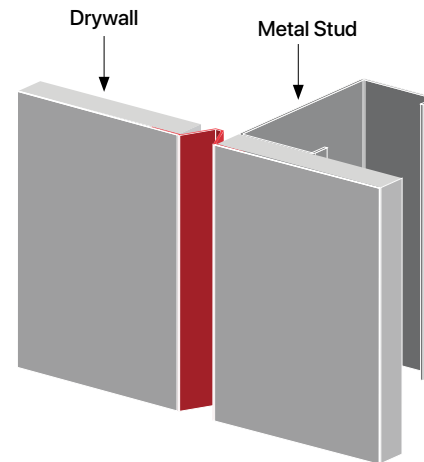
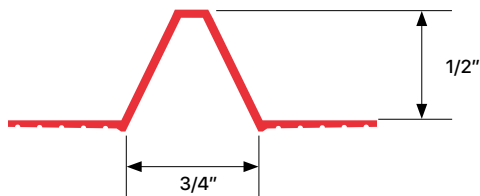
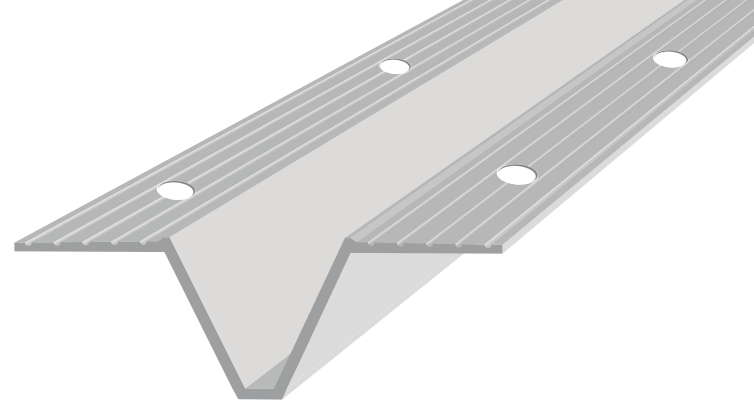

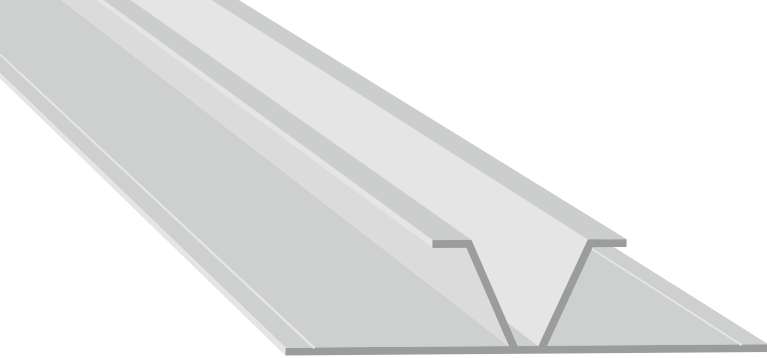

# RVVF

## Reveal V Flange

Creates beautiful shadow line with V-shaped reveal space and double flanges. Can be installed vertically, horizontally or diagonally. Used in conjunction with 5/8" drywall, panel installation and wrapped surface finishes such as fabric or vinyl wall coverings.

Available in 10' length. 6063 T5 aluminum with standard clear anodized or primed finish. Anodized color and powder coating finishes available with custom color matching.

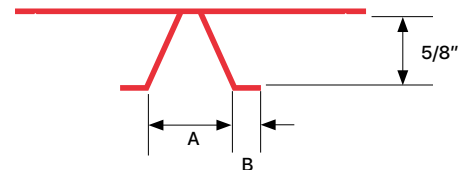
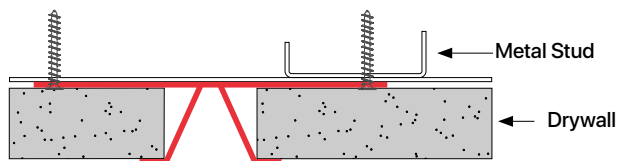
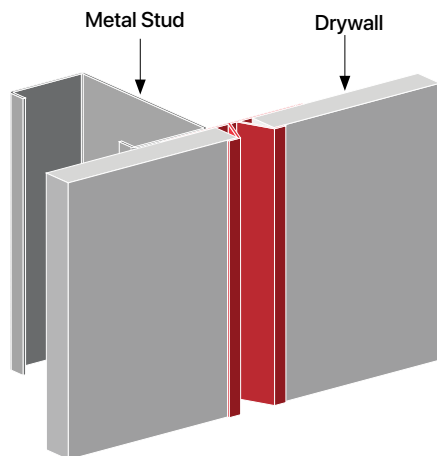

ITEM ID	A	B
RVVF-14	3/4"	1/4"
RVVF-38	3/4"	3/8"

## Bases

Less is more. Change the way your walls transition to the floor with shadow lines, sleek reveals and clean transitions.



# BCT

## Base Cove Transition

Versatile transition piece perfect for finishing the joint between walls and countertops or walls and floors. Ridged face provided for tape & float.

Available in 10' length. 6063 T5 aluminum with standard clear anodized or primed finish. Anodized color and powder coating finishes available with custom color matching.

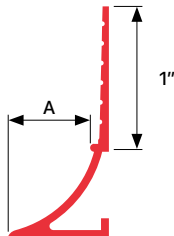

ITEM ID	A
BCT-12	1/2"
BCT-34	3/4"

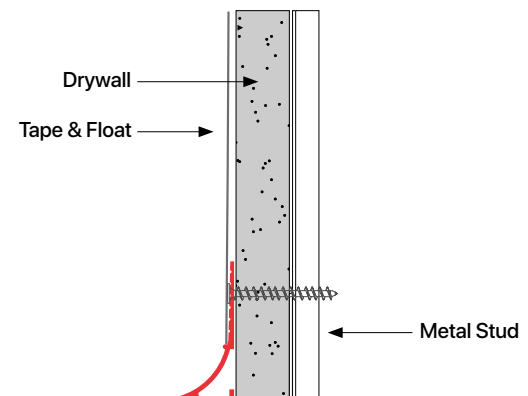
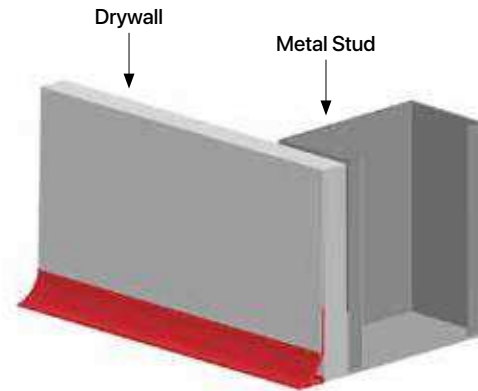

# BF

## Base Flush

Contemporary profile creates a clean shadow line and provides wall protection. Can be used in conjunction with wrapped surface finishes such as fabric or vinyl wall coverings. Ridged face provided for tape & float.

Available in 10' length. 6063 T5 aluminum with standard clear anodized or primed finish. Anodized color and powder coating finishes available with custom color matching.

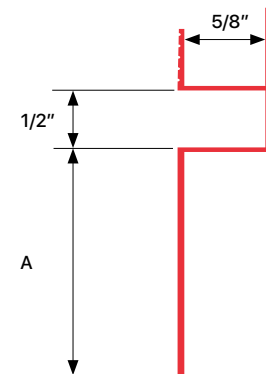
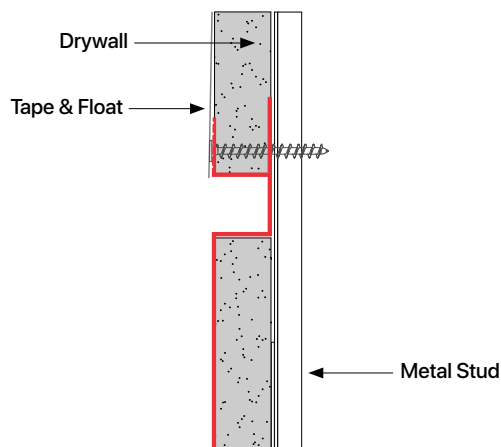
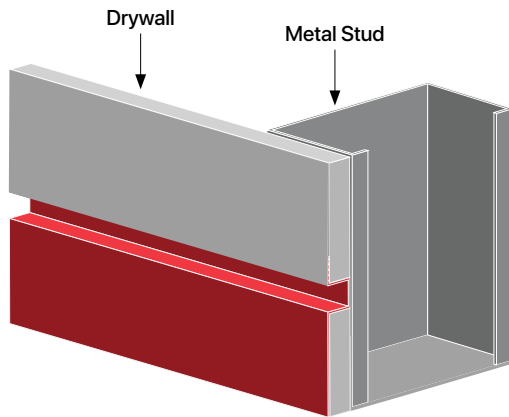

ITEM ID	A
BF-250	2-1/2"
BF-350	3-1/2"

# BFF

## Base Flush Flat

Flush finish design with less material allows for easy install without compromising the modern design. Ideal for transitioning between drywall and other materials or drywall and floors as a base profile. Ridged face provided for tape and float and pre-punched holes for easy install (hole placement may vary), adhesive is recommended for secure installation. Can be used in conjunction with drywall, panel installation and wrapped surface finishes such as fabric or vinyl wall coverings.

Available in 10' length. 6063 T5 aluminum with standard clear anodized or primed finish. Anodized color and powder coating finishes available with custom color matching.



ITEM ID	A
BFF-250	2-1/2"
BFF-300	3"
BFF-350	3-1/2"
BFF-400	4"

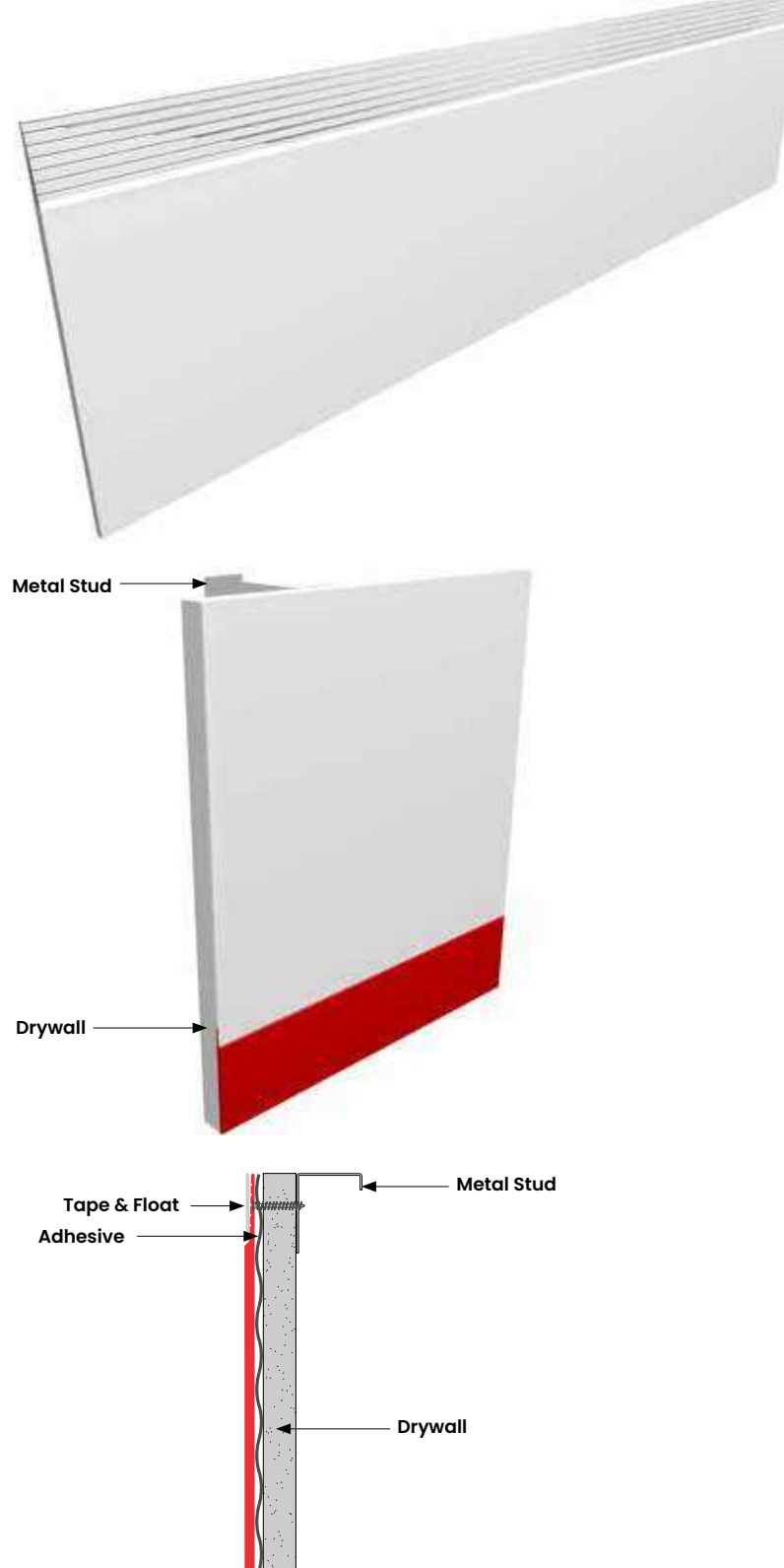

# BLF

## Base Ledge Flange

Uniquely designed profile that creates a recessed base at the bottom of a wall adding a decorative flange as well as a reveal. Can be used with virtually any wall material including panels and wrapped surface finishes such as fabric or vinyl wall coverings.

Available in 10' length. 6063 T5 aluminum with standard clear anodized or primed finish. Anodized color and powder coating finishes available with custom color matching.

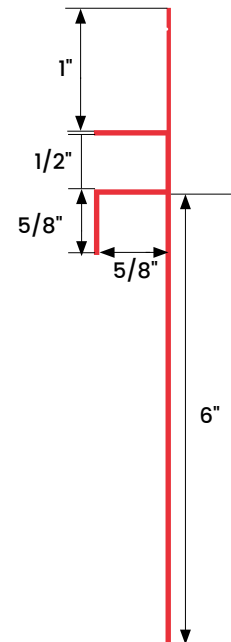
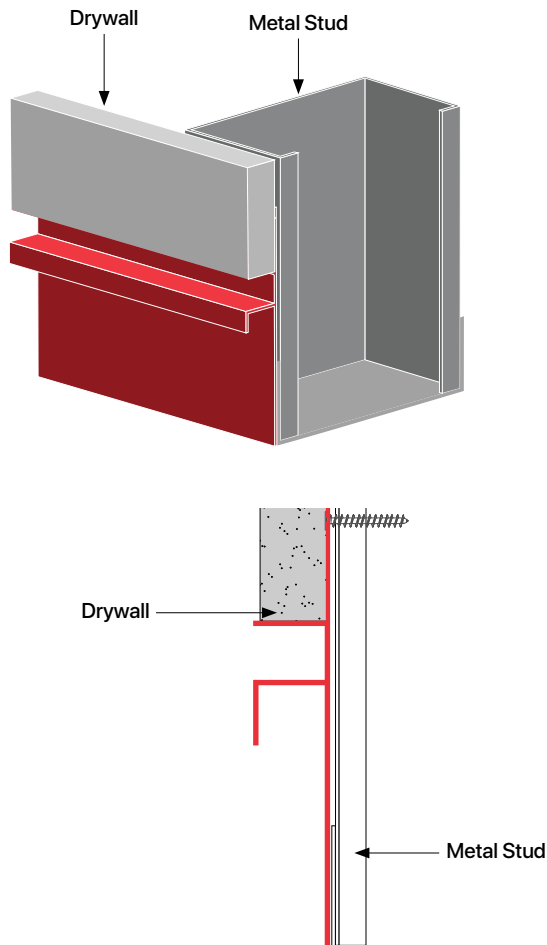

# BPR

## Base Projecting Round

PATENTED

Stunning profile that creates a recessed base at the bottom of a wall just above floor surface or at the top of a wall just below the ceiling surface. Projecting round edge adds beautiful detail to any space. Ridged face provided for tape & float. Can be used in conjunction with wrapped surface finishes such as fabric or vinyl wall coverings.

Available in 10' length. 6063 T5 aluminum with standard clear anodized or primed finish. Anodized color and powder coating finishes available with custom color matching.

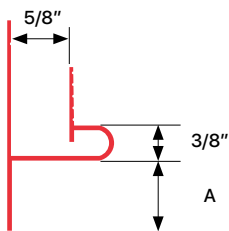

ITEM ID	A
BPR-34	3/4"
BPR-150	1-1/2"
BPR-200	2"
BPR-250	2-1/2"

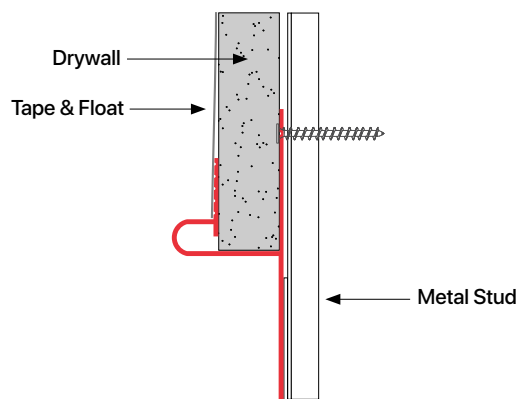
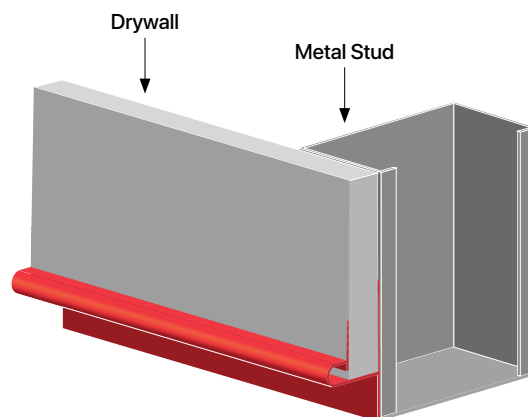
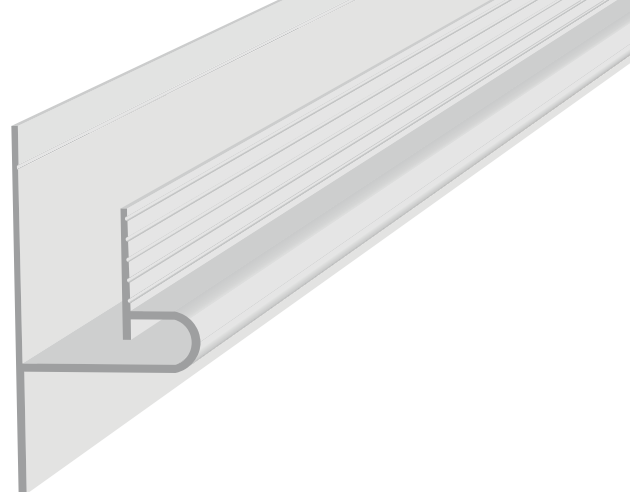

# BPRR

## Base Projecting Round Reveal

PATENTED

Unique profile that creates a combination reveal and projecting detail line at the bottom of a wall just above floor surface or at the top of a wall just below the ceiling surface. Projecting round edge adds classic and refined detail. Ridged face provided for tape & float. Can be used in conjunction with wrapped surface finishes such as fabric or vinyl wall coverings.

Available in 10' length. 6063 T5 aluminum with standard clear anodized or primed finish. Anodized color and powder coating finishes available with custom color matching.

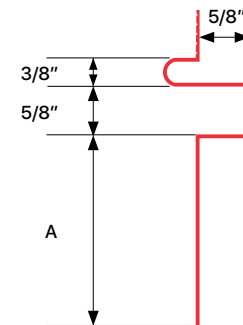
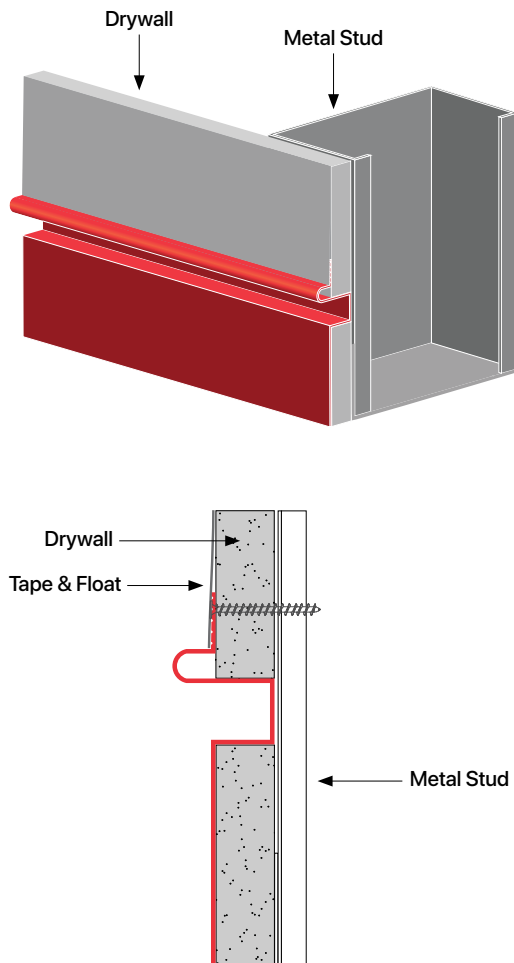

ITEM ID	A
BPRR-250	2-1/2"
BPRR-300	3"

# BPS

## Base Projecting Square

PATENTED

Sleek profile that creates a recessed base at the bottom of a wall just above floor surface or at the top of a wall just below the ceiling surface. Projecting square edge adds classic and refined detail. Ridged face provided for tape & float. Can be used in conjunction with wrapped surface finishes such as fabric or vinyl wall coverings.

Available in 10' length. 6063 T5 aluminum with standard clear anodized or primed finish. Anodized color and powder coating finishes available with custom color matching.

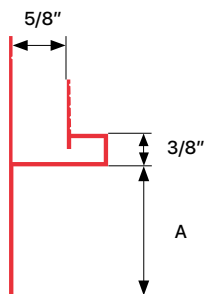

ITEM ID	A
BPS-34	3/4"
BPS-150	1-1/2"
BPS-200	2"
BPS-250	2-1/2"

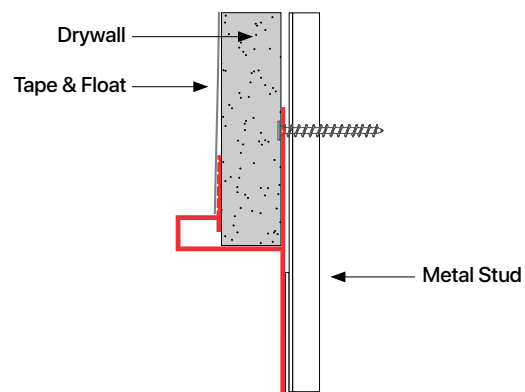
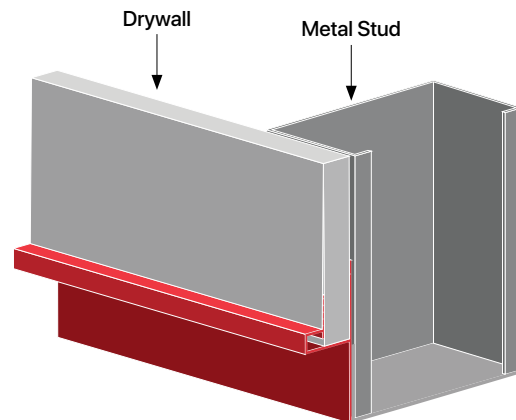
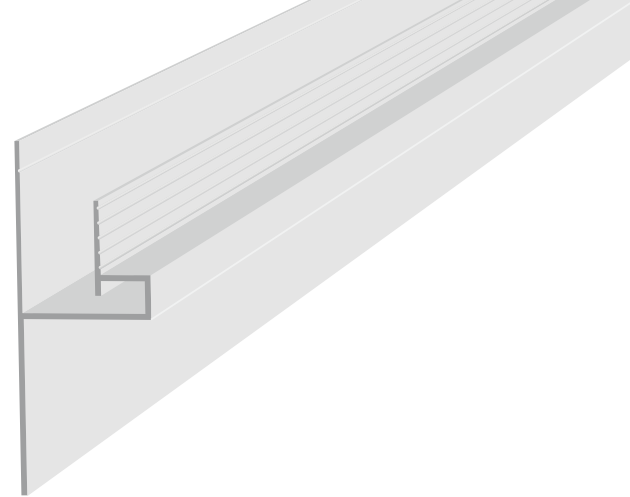

# BPSR

## Base Projecting Square Reveal

PATENTED

Unique profile that creates a combination reveal and projecting detail line at the bottom of a wall just above floor surface or at the top of a wall just below the ceiling surface. Projecting square edge adds classic and refined detail. Ridged face provided for tape & float. Can be used in conjunction with wrapped surface finishes such as fabric or vinyl wall coverings.

Available in 10' length. 6063 T5 aluminum with standard clear anodized or primed finish. Anodized color and powder coating finishes available with custom color matching.

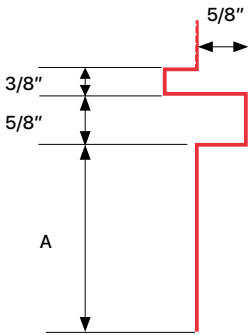
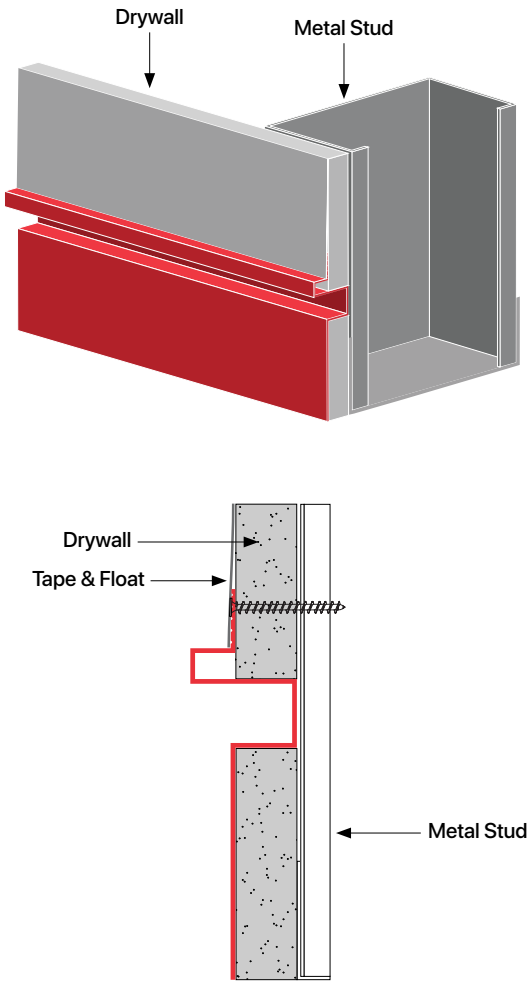

ITEM ID	A
BPSR-250	2-1/2"
BPSR-300	3"

# BRDF

## Base Reveal Double Flange

Striking profile that creates a recessed base at the bottom of a wall just above floor surface or at the top of a wall just below the ceiling surface. Double flange creates a reveal for visual impact as well as protecting the bottom of wall material and creating a lower recess. Can be used in conjunction with wrapped surface finishes such as fabric or vinyl wall coverings.

Available in 10' length. 6063 T5 aluminum with standard clear anodized or primed finish. Anodized color and powder coating finishes available with custom color matching.

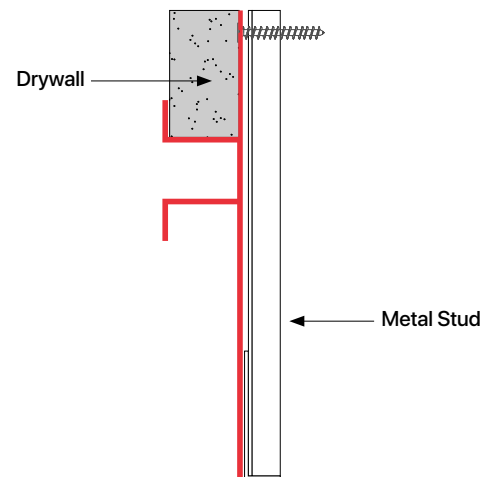
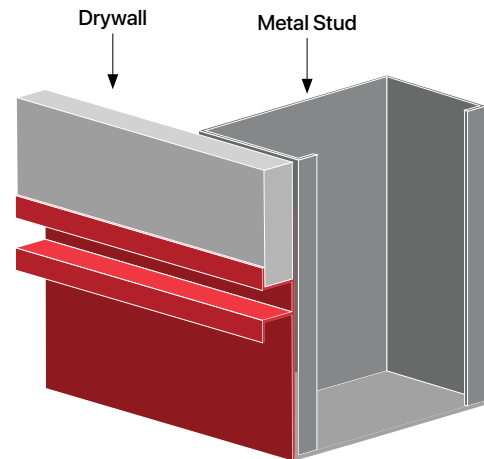
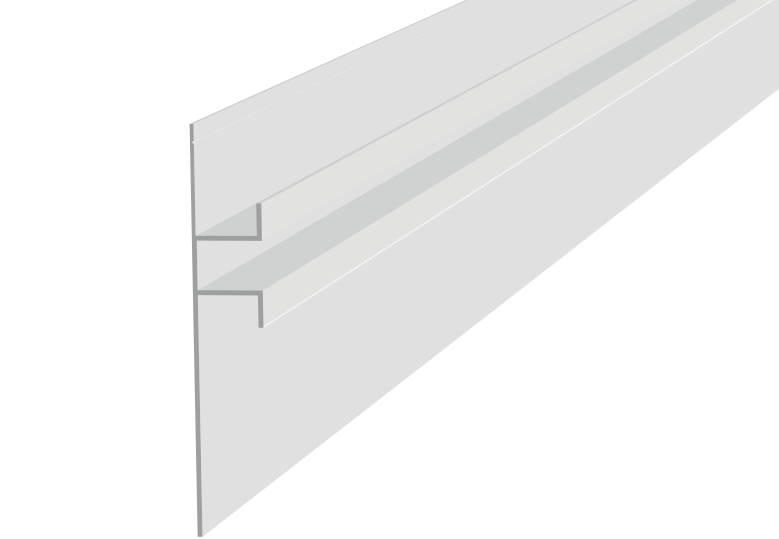
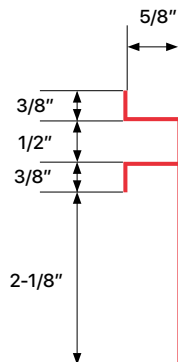

# BRF

## Base Reveal Flange

Uniquely detailed profile that creates a recessed base at the bottom of a wall adding a decorative flange as well as a reveal. Ideal placement just above floor surface or at the top of a wall just below the ceiling surface. Ridged face provided for tape & float. Can be used in conjunction with wrapped surface finishes such as fabric or vinyl wall coverings.

Available in 10' length. 6063 T5 aluminum with standard clear anodized or primed finish. Anodized color and powder coating finishes available with custom color matching.

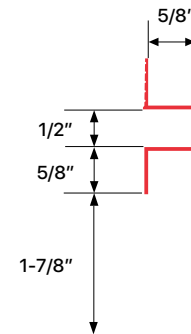
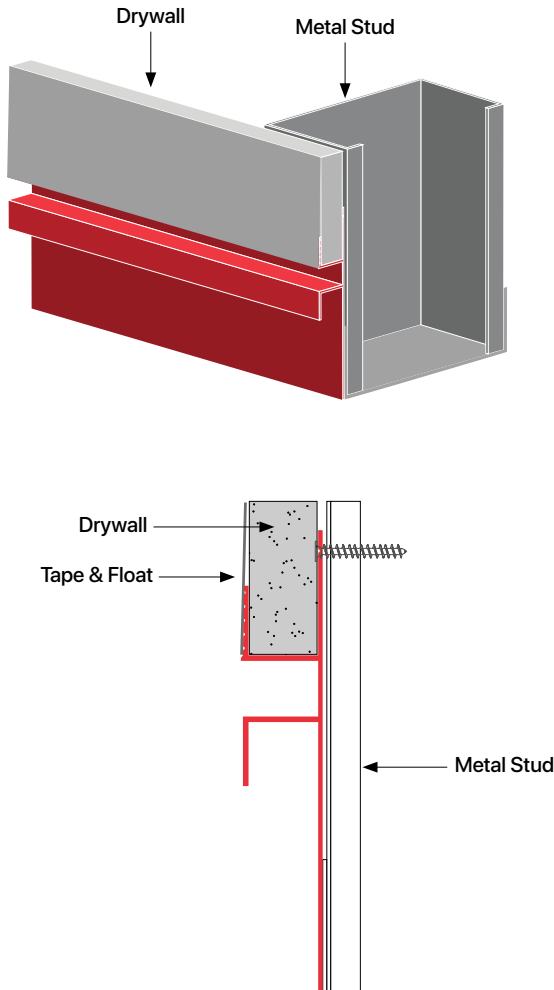

# BRL

## Base Reveal Ledge

Classic profile that creates a recessed base at the bottom of a wall just above floor surface or at the top of a wall just below the ceiling surface with additional reveal space created by a projecting edge. Projecting linear edge adds streamlined detail to any room. Ridged face provided for tape & float. Can be used in conjunction with wrapped surface finishes such as fabric or vinyl wall coverings.

Available in 10' length. 6063 T5 aluminum with standard clear anodized or primed finish. Anodized color and powder coating finishes available with custom color matching.

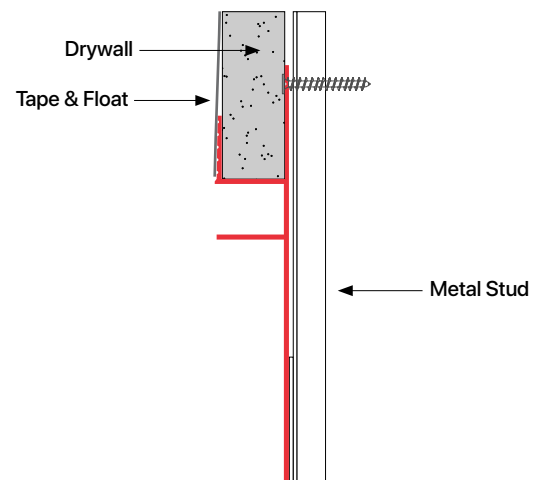
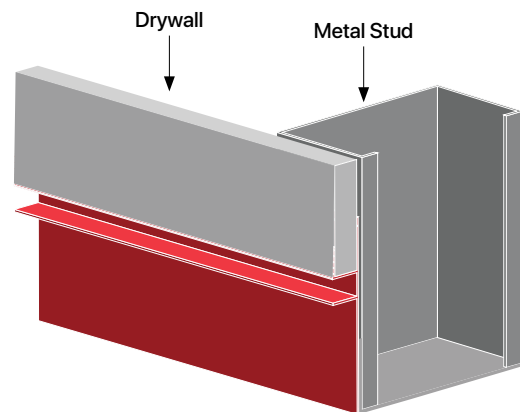
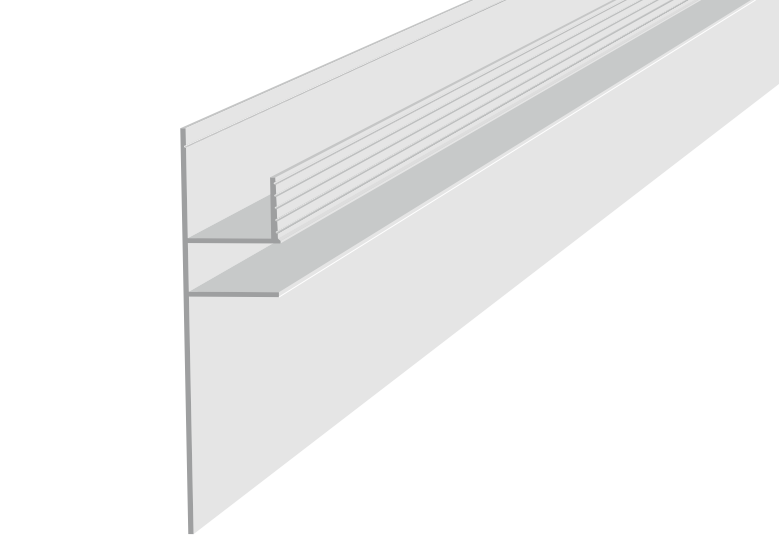
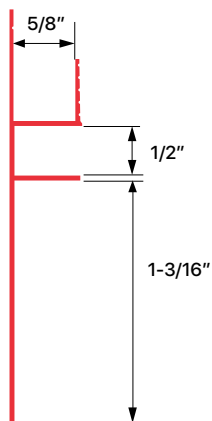

# BSL

## Base Shadow Line

Create visually stunning shadow lines with a minimalist base trim that allows the wall to appear to float just above the floor surface and allows for the same effect at the top of the wall just below the ceiling surface. Can be used vertically or horizontally. Ridged face provided for tape & float. Can be used in conjunction with wrapped surface finishes such as fabric or vinyl wall coverings.

Available in 10' length. 6063 T5 aluminum with standard clear anodized or primed finish. Anodized color and powder coating finishes available with custom color matching.

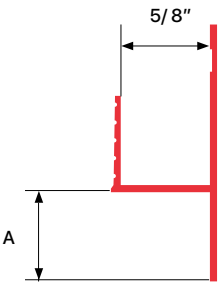
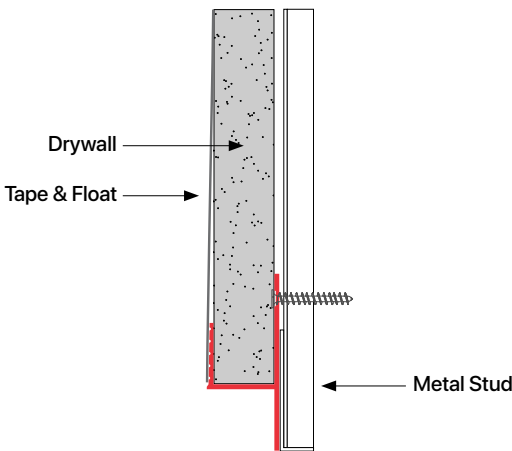
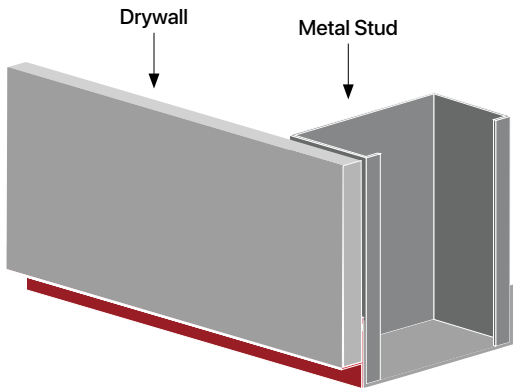

ITEM ID	A
BSL-516	5/16"
BSL-58	5/8"
BSL-150	1-1/2"
BSL-250	2-1/2"
BSL-400	4"

\*BSL-400 also available for 1/2" drywall





## Corners

Protection and beauty in one! Our line of unique corner profiles offers innovative solutions for any project.



# CAC

## Corner Arc

Simple but stunning corner profile. Provides corner protection and simple design for vertical and horizontal drywall or panel corners. Can be used in conjunction with wrapped surface finishes such as fabric or vinyl wall coverings.

Available in 10' length. 6063 T5 aluminum with standard clear anodized or primed finish. Anodized color and powder coating finishes available with custom color matching.

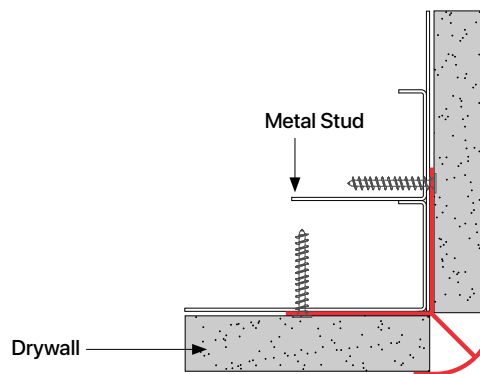
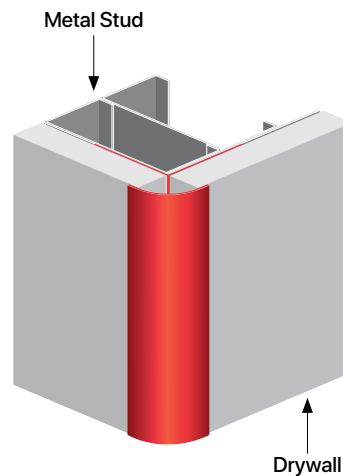
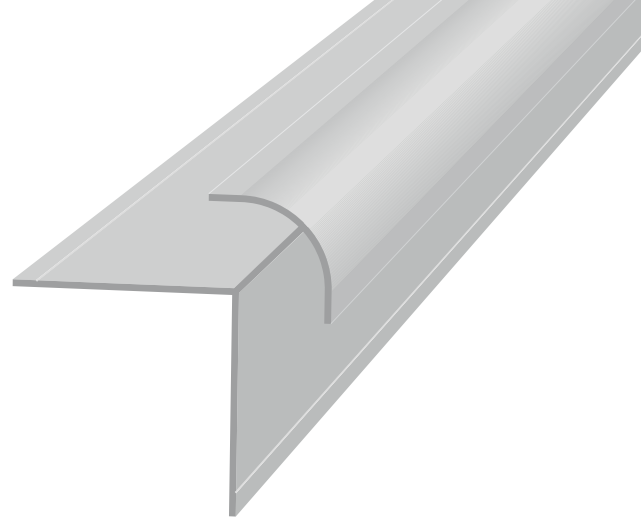
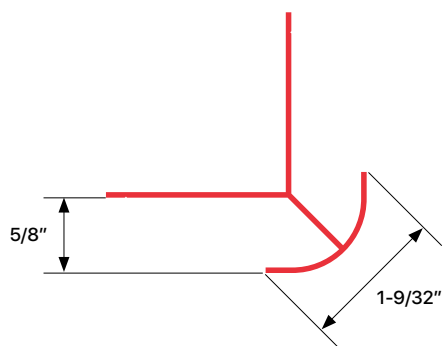

# CALP

## Corner Arrow Low Profile

Very popular face sizes which offer a clean outside corner for drywalls. Works well with all vertical options. Can be used in conjunction with drywall, panel installation and wrapped surface finishes such as fabric or vinyl wall coverings.

Available in 10' length. 6063 T5 aluminum with standard clear anodized or primed finish. Anodized color and powder coating finishes available with custom color matching.

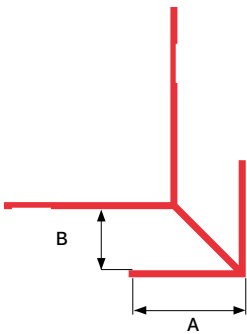
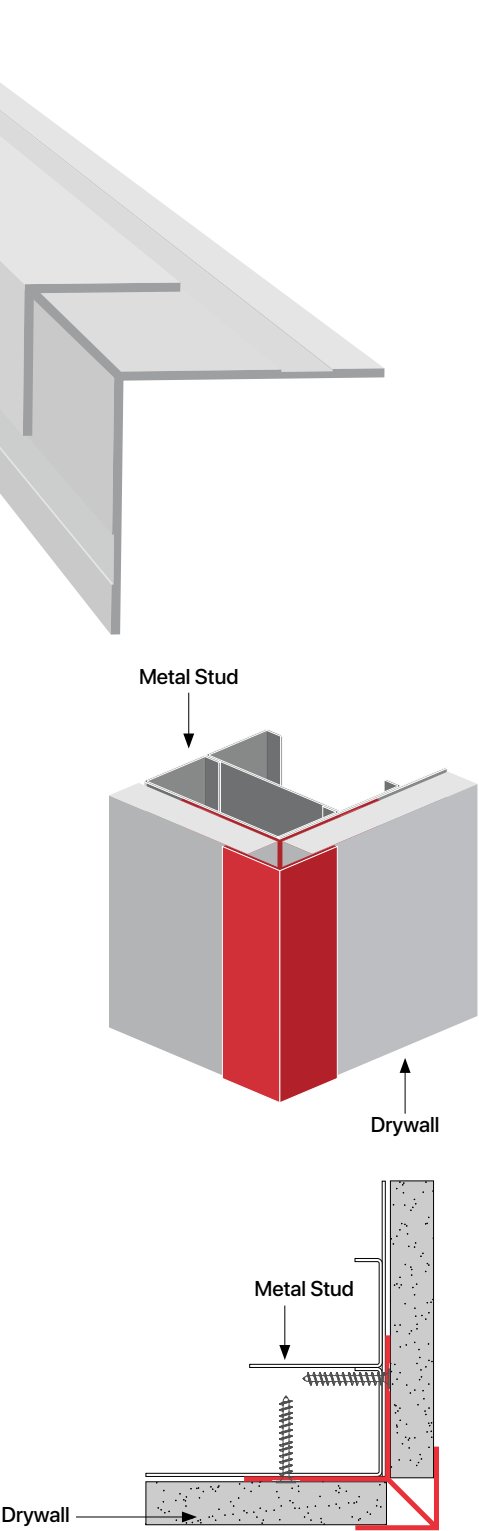

ITEM ID	A	B
CALP-716	1"	7/16"
CALP-58	1-1/8"	5/8"

# CBD

## Corner Bead

Minimalistic bead line corner profile. Provides corner protection and sleek design for vertical drywall corners. Can be used in conjunction with wrapped surface finishes such as fabric or vinyl wall coverings. Ridged faces for tape & float and pre-punched holes for easy install (hole placement may vary).

Available in 10' length. 6063 T5 aluminum with standard clear anodized or primed finish. Anodized color and powder coating finishes available with custom color matching.

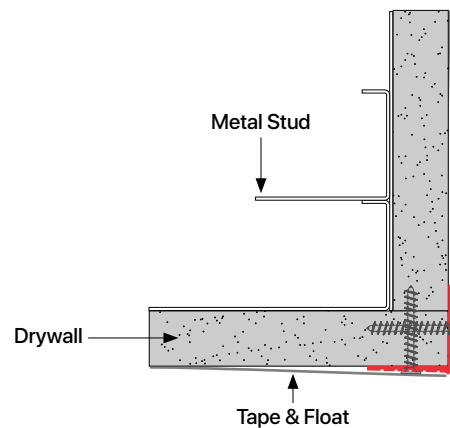
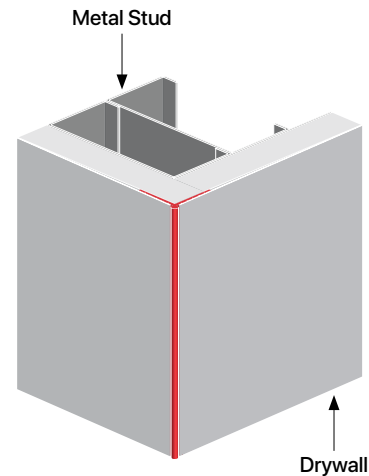
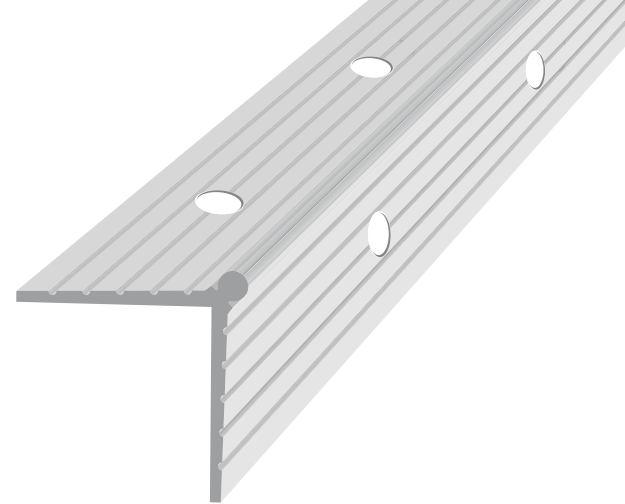
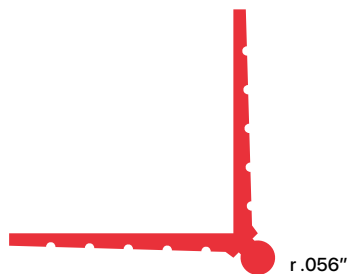

XtremeInterior™ profiles are subject to alterations with or without notice.

# CBV

## Corner Bevel

Modern and modest beveled corner profile. Provides corner protection and streamlined design for vertical or horizontal drywall corners. Can be used in conjunction with wrapped surface finishes such as fabric or vinyl wall coverings. Ridged faces for tape & float and pre-punched holes for easy install (hole placement may vary).

Available in 10' length. 6063 T5 aluminum with standard clear anodized or primed finish. Anodized color and powder coating finishes available with custom color matching.

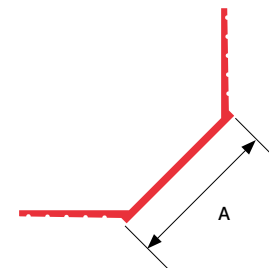
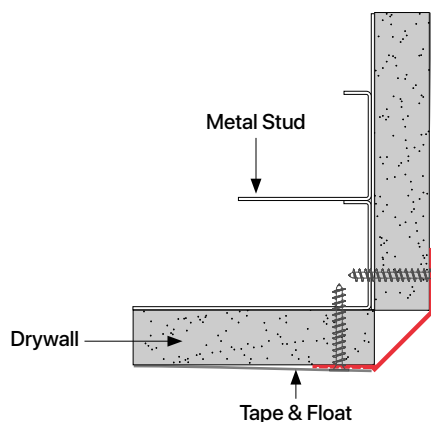
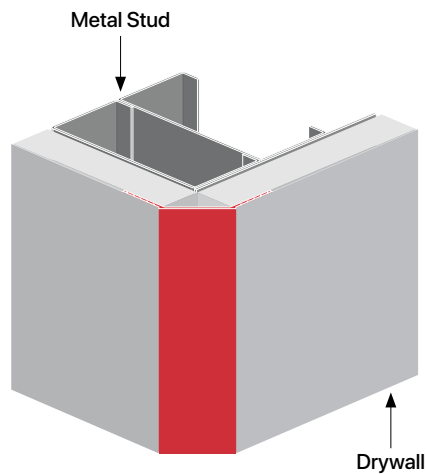
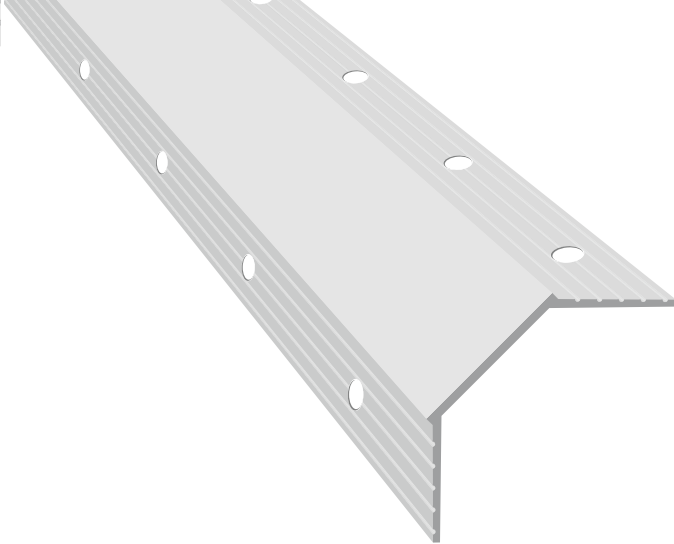

ITEM ID	A
CBV-100	1"
CBV-200	2"
CBV-300	3"

# CEL

## Corner Elliptical

PATENTED

Design feature with elliptical corner for vertical and horizontal (for fur down applications) drywall corners. Can be used in conjunction with wrapped surface finishes such as fabric or vinyl wall coverings. Unique design with stunning visual results. Provides corner protection and reveal creates the illusion of a floating corner. Ridged faces provided for tape & float.

Available in 10' length. 6063 T5 aluminum with standard clear anodized or primed finish. Anodized color and powder coating finishes available with custom color matching.

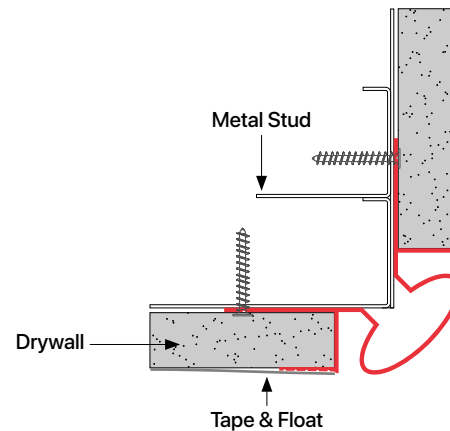
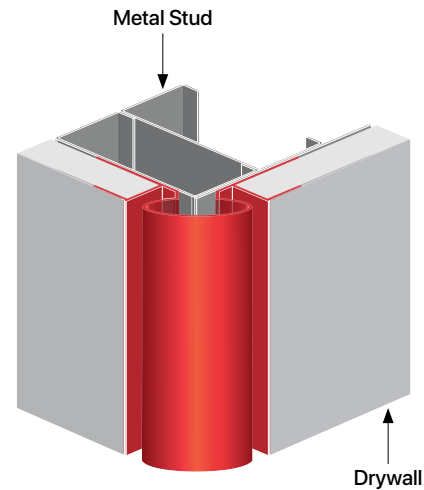
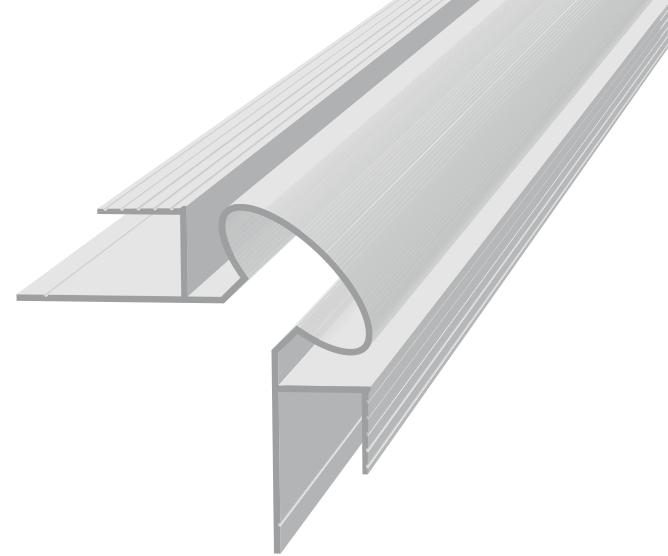
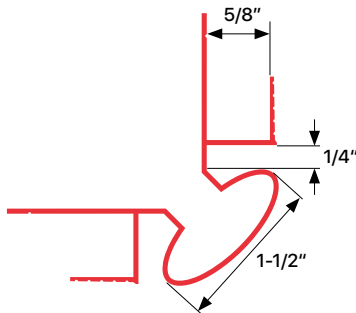

# CRA

## Corner Radiused

PATENTED

Design feature with rounded edge for vertical and horizontal (for fur-down applications) drywall or panel corners. Can be used in conjunction with wrapped surface finishes such as fabric or vinyl wall coverings. Provides corner protection and reveal creates the illusion of a floating corner. Ridged faces provided for taping and floating.

Available in 10' length. 6063 T5 aluminum with standard standard clear anodized or primed finish. Anodized color and powder coating finishes available with custom color matching.

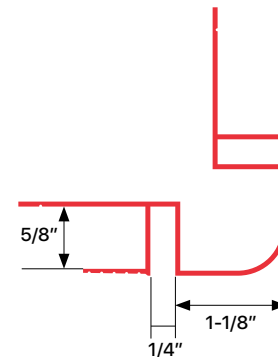
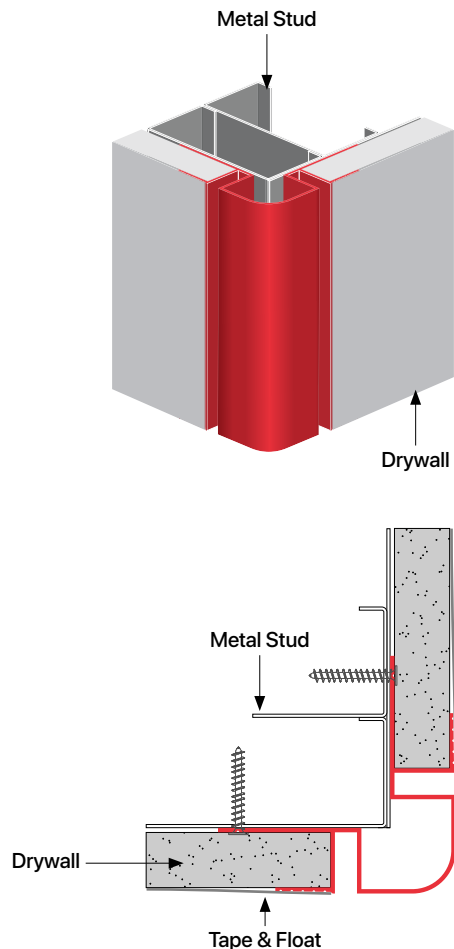

# CRD

## Corner Round

PATENTED

Design feature with circular corner for vertical and horizontal (for fur down applications) drywall or panel corners. Can be used in conjunction with wrapped surface finishes such as fabric or vinyl wall coverings. Provides corner protection and creates the illusion of a floating corner. Ridged faces provided for tape & float.

Available in 10' length. 6063 T5 aluminum with standard clear anodized or primed finish. Anodized color and powder coating finishes available with custom color matching.

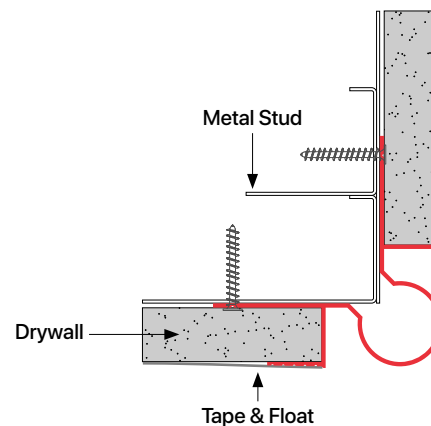
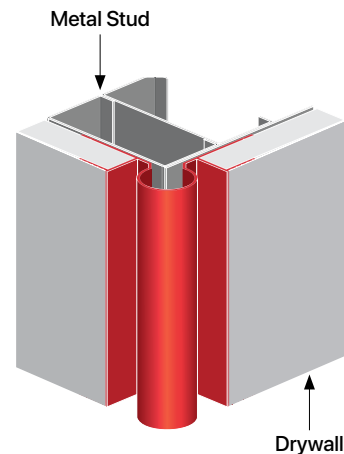
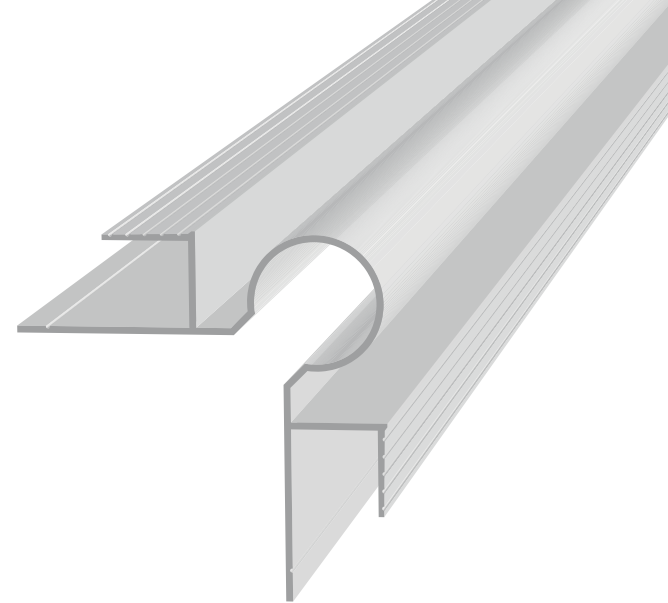
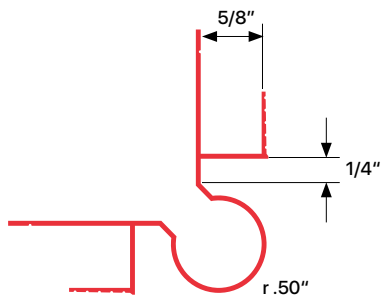

# CRR

## Corner Rectangular Radiused

PATENTED

Design feature with rounded asymmetrical corner for vertical and horizontal (for fur down applications) drywall corners. Can be used in conjunction with wrapped surface finishes such as fabric or vinyl wall coverings. Provides corner protection and creates the illusion of a floating corner. Ridged faces provided for tape & float.

Available in 10' length. 6063 T5 aluminum with standard clear anodized or primed finish. Anodized color and powder coating finishes available with custom color matching.

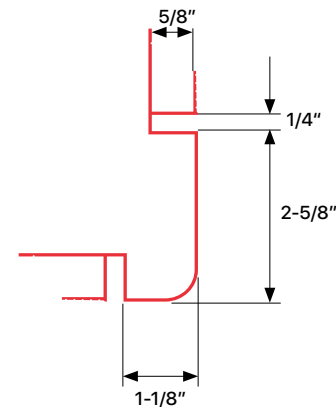
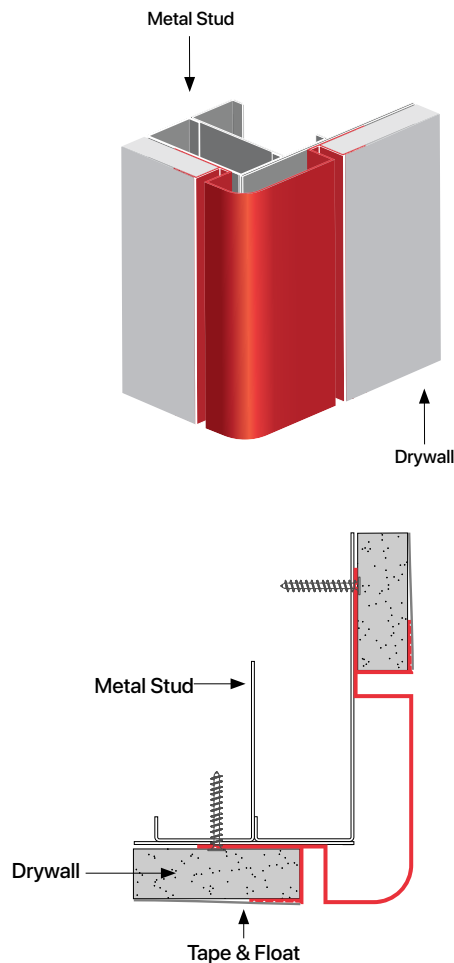

# CRS

## Corner Rectangular Square

PATENTED

Design feature with asymmetrical corner for vertical and horizontal (for fur down applications) drywall corners. Can be used in conjunction with wrapped surface finishes such as fabric or vinyl wall coverings. Provides corner protection and creates the illusion of a floating corner. Ridged faces provided for tape & float.

Available in 10' length. 6063 T5 aluminum with standard clear anodized or primed finish. Anodized color and powder coating finishes available with custom color matching.

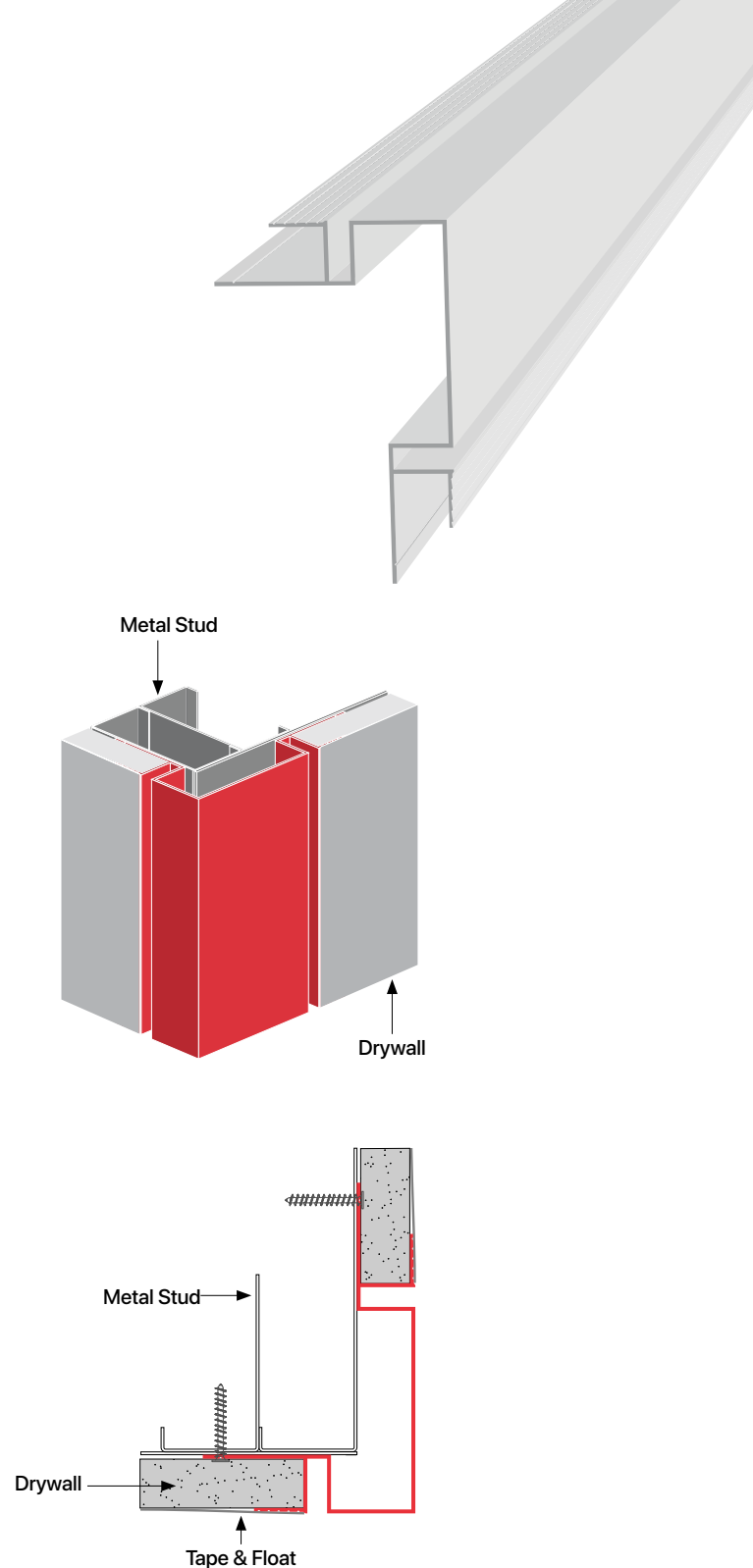
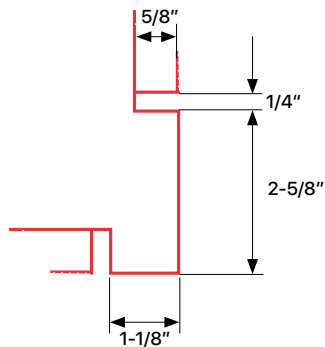

# CRT

## Corner Rectangular Tapered

Design feature with tapering asymmetrical corner for vertical and horizontal (for fur down applications) drywall corners. Can be used in conjunction with wrapped surface finishes such as fabric or vinyl wall coverings. Provides corner protection and creates the illusion of a floating corner. Ridged faces provided for tape & float.

Available in 10' length. 6063 T5 aluminum with standard clear anodized or primed finish. Anodized color and powder coating finishes available with custom color matching.

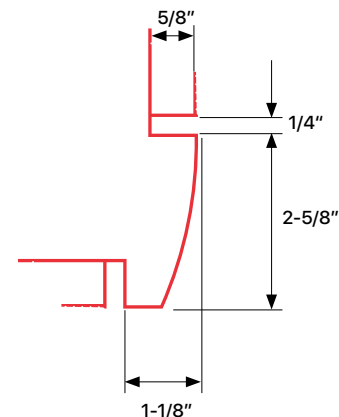
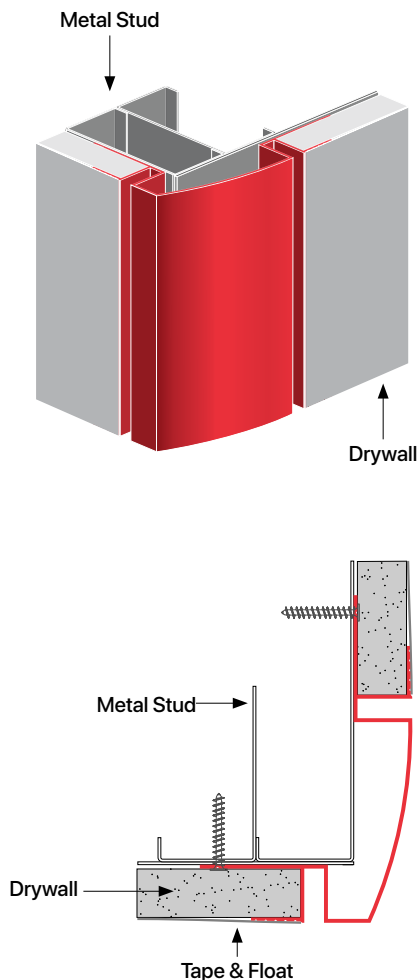

# CSQ

## Corner Square

PATENTED

Design feature and finished edge for vertical and horizontal (for fur down applications) drywall corners. Can be used in conjunction with wrapped surface finishes such as fabric or vinyl wall coverings. Provides corner protection and creates the illusion of a floating corner. Ridged faces provided for tape & float.

Available in 10' length. 6063 T5 aluminum with standard clear anodized or primed finish. Anodized color and powder coating finishes available with custom color matching.

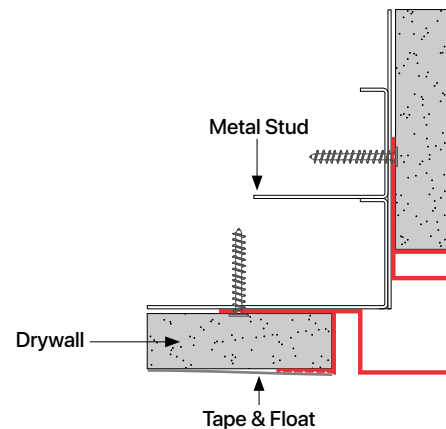
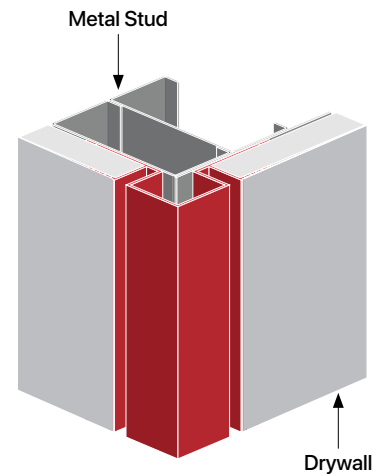
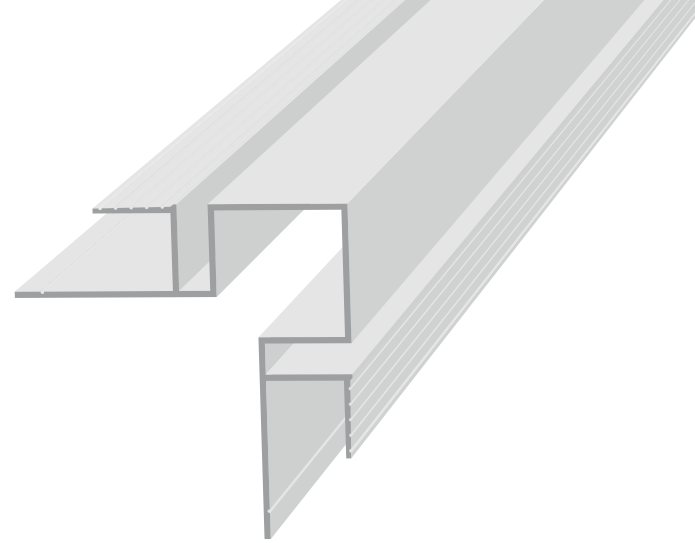
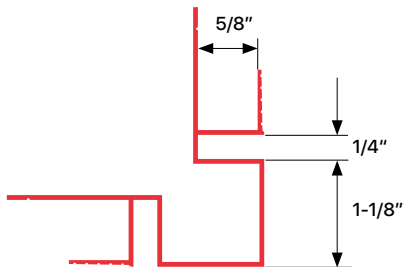

# CWO

## Corner W

Design feature with tapering asymmetrical corner for vertical and horizontal (for fur down applications) drywall corners. Can be used in conjunction with wrapped surface finishes such as fabric or vinyl wall coverings. Provides corner protection and creates the illusion of a floating corner. Ridged faces provided for tape & float.

Available in 10' length. 6063 T5 aluminum with standard clear anodized or primed finish. Anodized color and powder coating finishes available with custom color matching.

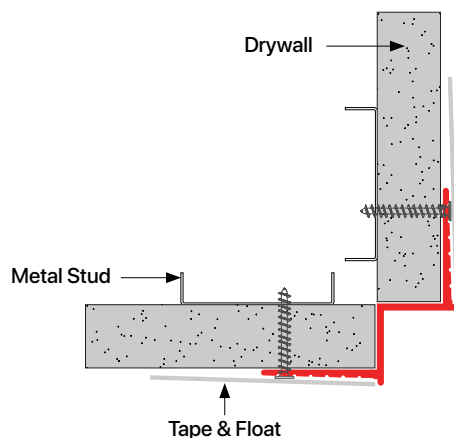
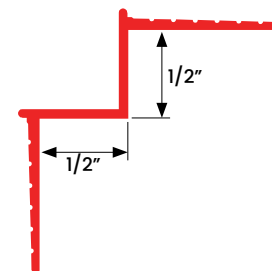
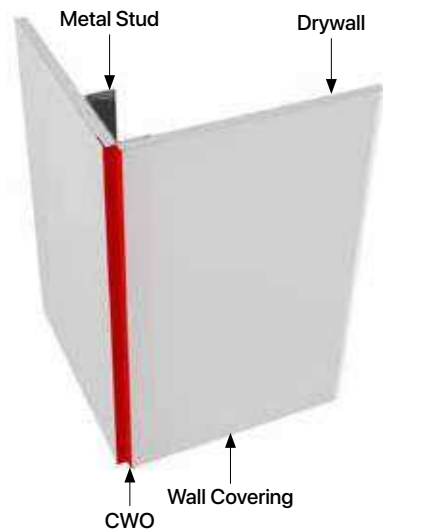

# CXF

## Corner X

Classic and clean corner profile with flange arms. Provides corner protection and beautiful design for vertical and horizontal drywall or panel corners. Can be used in conjunction with wrapped surface finishes such as fabric or vinyl wall coverings.

Available in 10' length. 6063 T5 aluminum with standard clear anodized or primed finish. Anodized color and powder coating finishes available with custom color matching.

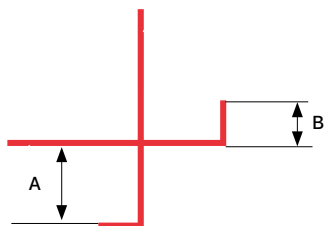

ITEM ID	A	B
CXF-14	5/8"	1/4"
CXF-38	5/8"	3/8"
CXF-58	5/8"	5/8"
CXF-100	1"	3/8"
CXF-34-18	3/4"	1/8"
CXF-34-58	3/4"	5/8"
CXF-716-18	7/16"	1/8"

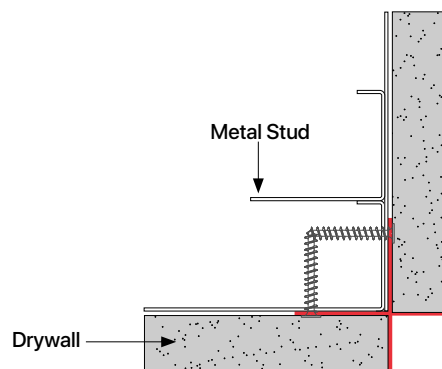
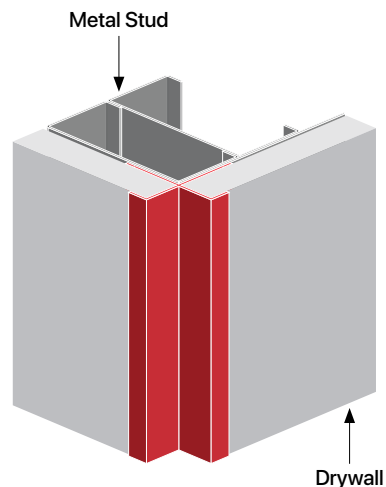
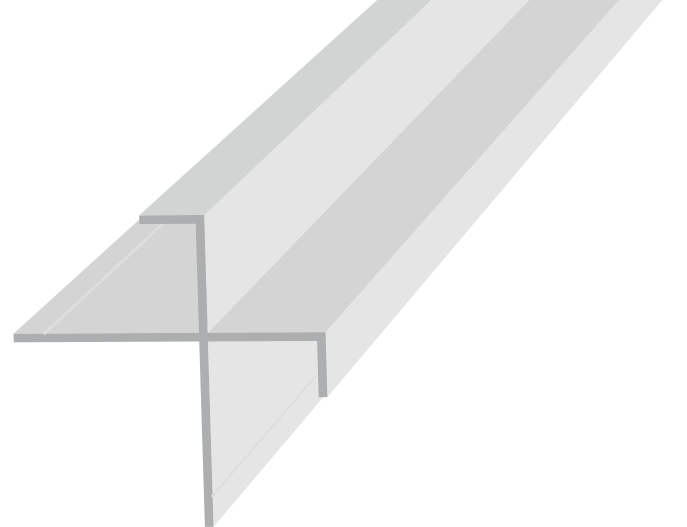

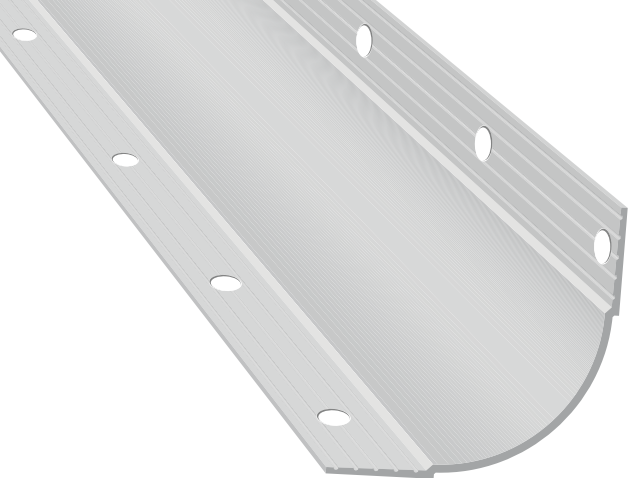

# ICAC

## Inside Corner Arc

Coordinating inside corner for the CAC profile (page 38). Can be used vertically and horizontally in conjunction with drywall, panels, and wrapped surface finishes. Ridged faces for tape & float and pre-punched holes for easy install (hole placement may vary).

Available in 10' length. 6063 T5 aluminum with standard clear anodized or primed finish. Anodized color and powder coating finishes available with custom color matching.

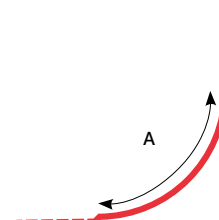
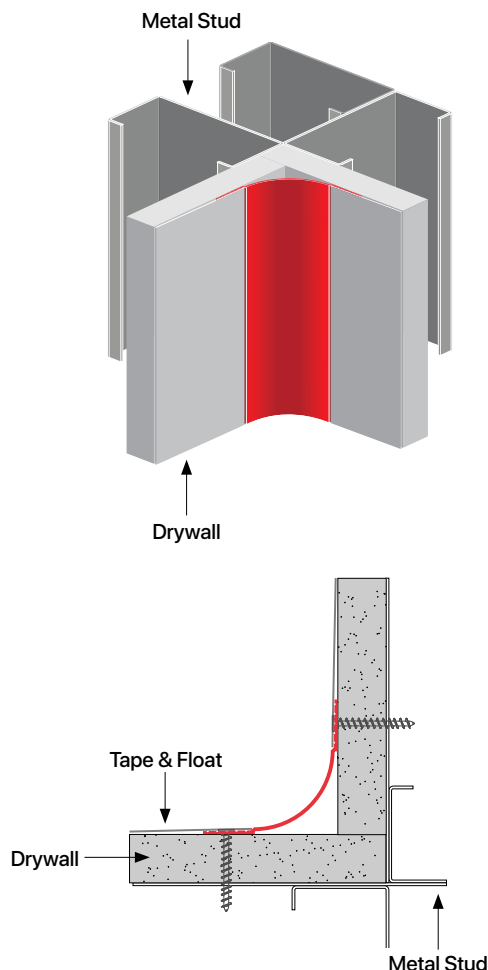

ITEM ID	A
ICAC-100	1"
ICAC-200	2"
ICAC-300	3"

# ICBV

## Inside Corner Bevel

Coordinating inside corner for the CBV profile (page41). Can be used vertically and horizontally in conjunction with drywall, panels, and wrapped surface finishes. Ridged faces for tape & float and pre-punched holes for easy install (hole placement may vary).

Available in 10' length. 6063 T5 aluminum with standard clear anodized or primed finish. Anodized color and powder coating finishes available with custom color matching.

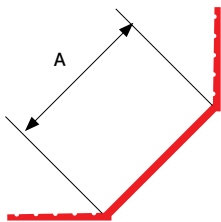

ITEM ID	A
ICBV-100	1"
ICBV-200	2"

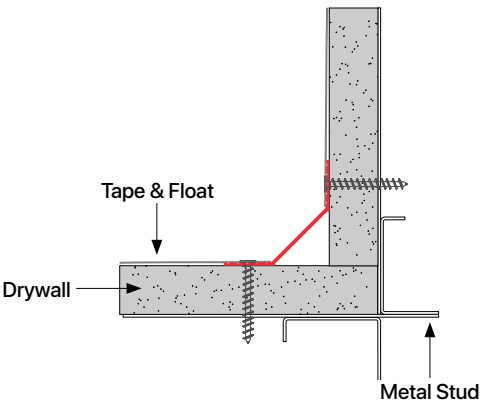
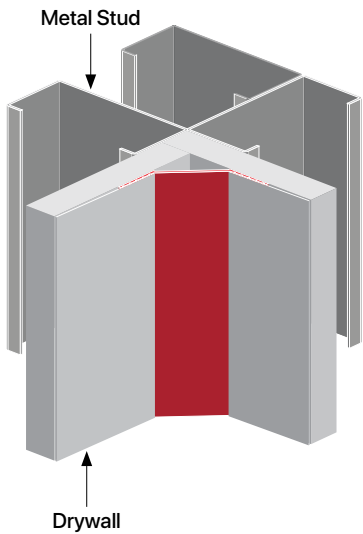
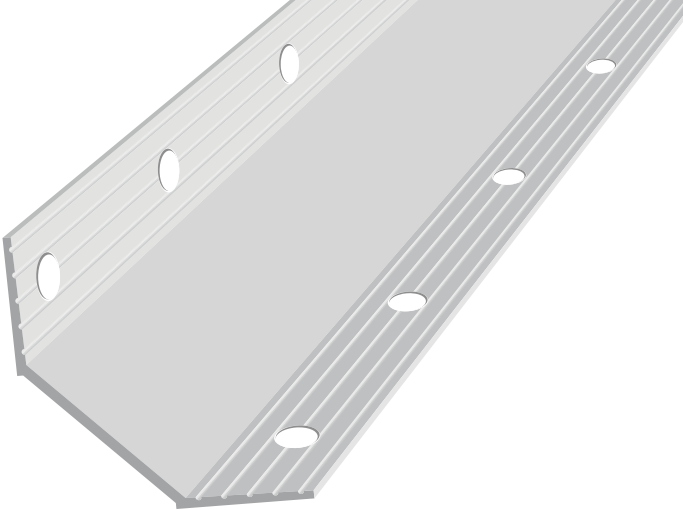

# ICEL

## Inside Corner Elliptical

PATENTED

Coordinating inside corner for the CEL profile (page 42). Can be used vertically and horizontally in conjunction with drywall, panels, and wrapped surface finishes. Ridged faces allow for tape & float.

Available in 10' length. 6063 T5 aluminum with standard clear anodized or primed finish. Anodized color and powder coating finishes available with custom color matching.

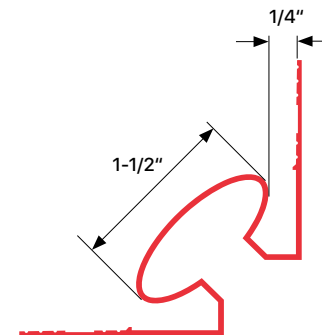
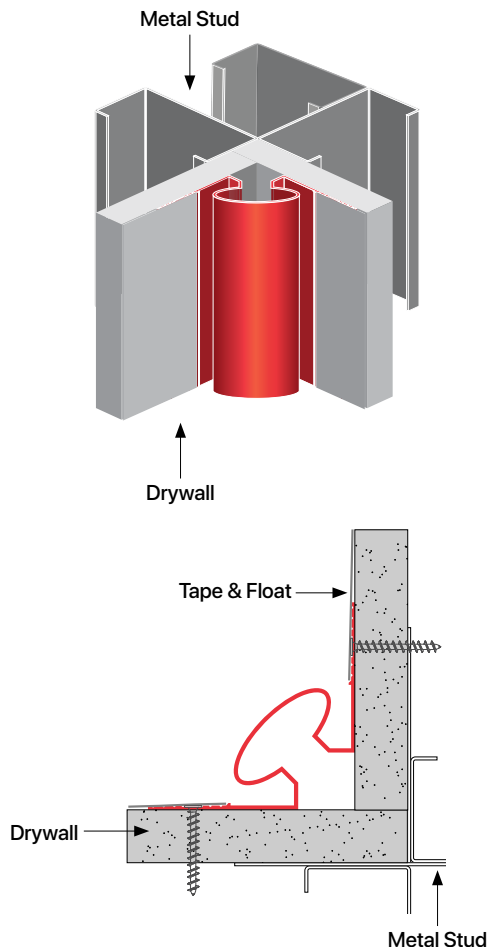

# ICRA

## Inside Corner Radiused

PATENTED

Coordinating inside corner for the CRA profile (page 43). Can be used vertically and horizontally in conjunction with drywall, panels, and wrapped surface finishes. Ridged faces allow for tape & float.

Available in 10' length. 6063 T5 aluminum with standard clear anodized or primed finish. Anodized color and powder coating finishes available with custom color matching.

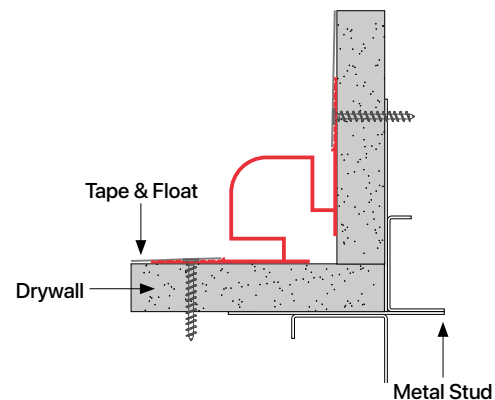
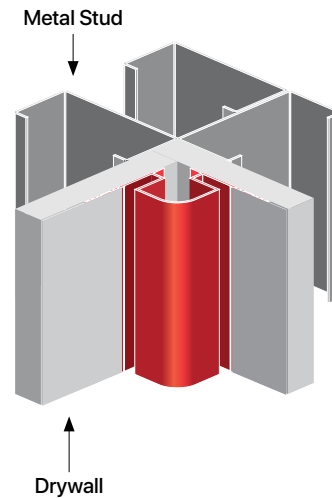
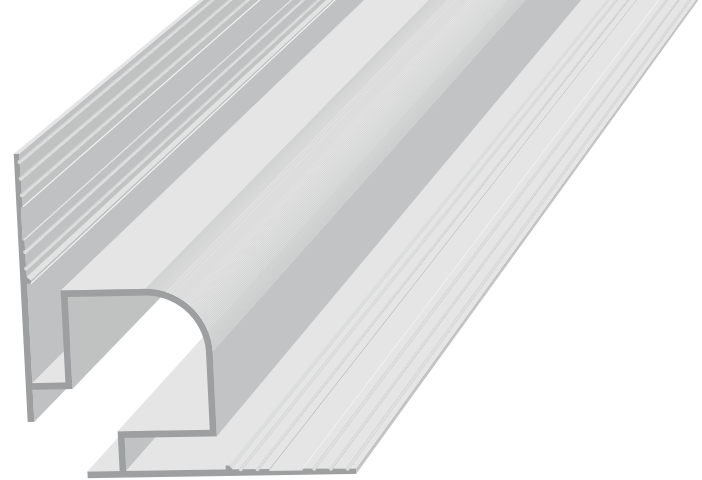
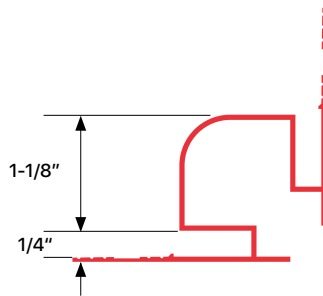

# ICRD

## Inside Corner Round

PATENTED

Coordinating inside corner for the CRD profile (page 44). Can be used vertically and horizontally in conjunction with drywall, panels, and wrapped surface finishes. Ridged faces allow for tape & float.

Available in 10' length. 6063 T5 aluminum with standard clear anodized or primed finish. Anodized color and powder coating finishes available with custom color matching.

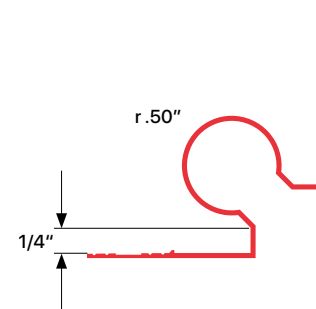
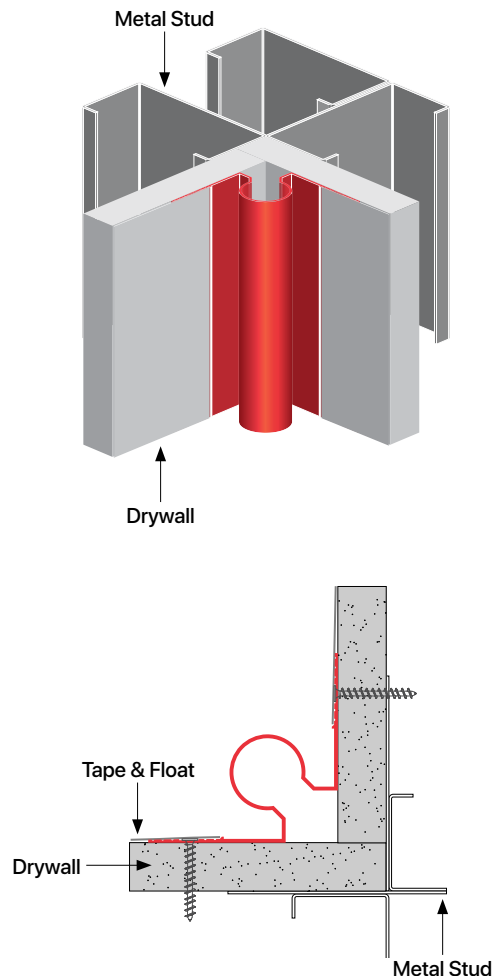

# ICRF

## Inside Corner Flange

Coordinating inside corner for the CXF profile (page 50). Can be used vertically and horizontally in conjunction with drywall, panels, and wrapped surface finishes.

Available in 10' length. 6063 T5 aluminum with standard clear anodized or primed finish. Anodized color and powder coating finishes available with custom color matching.

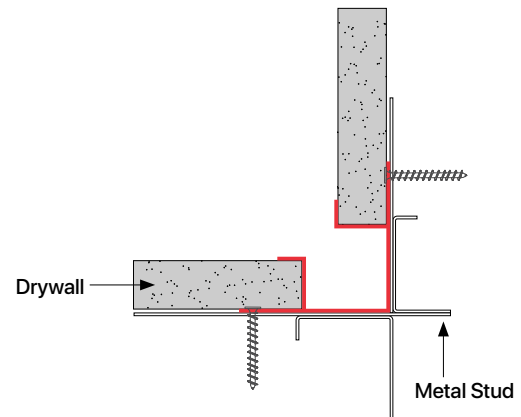
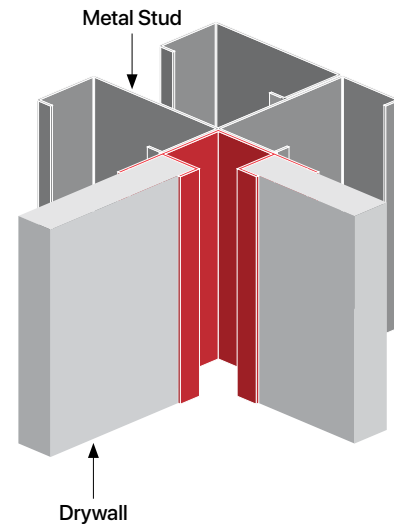
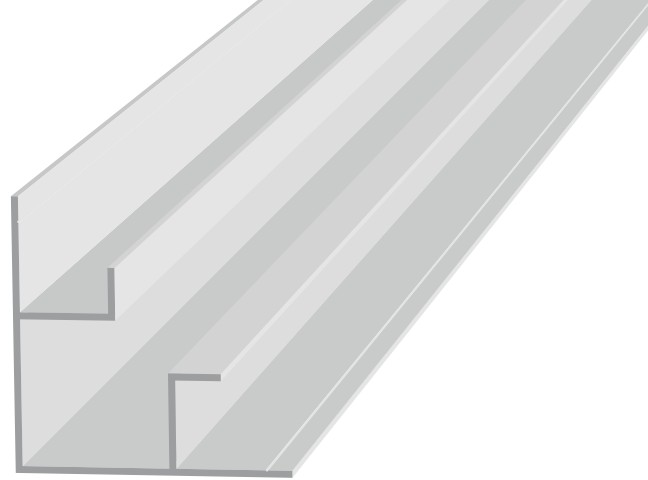
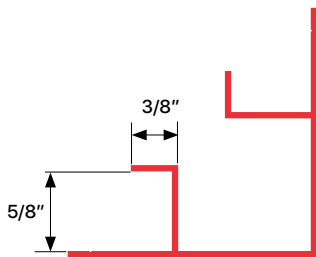

# ICSQ

## Inside Corner Square

PATENTED

Coordinating inside corner for the CSQ profile (page 48). Can be used vertically and horizontally in conjunction with drywall, panels, and wrapped surface finishes. Ridged faces allow for tape & float.

Available in 10' length. 6063 T5 aluminum with standard clear anodized or primed finish. Anodized color and powder coating finishes available with custom color matching.

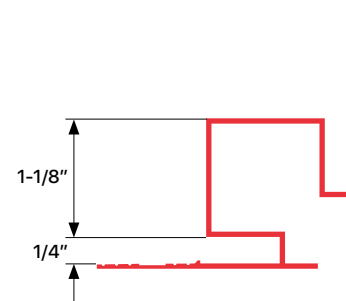
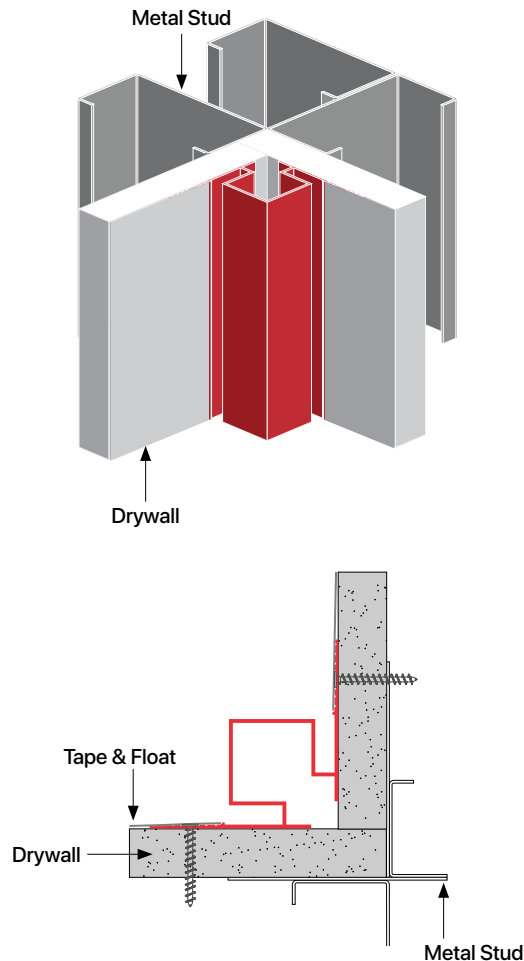





## 2-Piece Systems

Exclusive line of channels and inserts that work together to give the visual impact your feature wall needs.



# CHFS

## Channel Flush Square

PATENTED

Anchor channel for two-piece system. Ridged faces provided for taping and floating and allow insert piece to appear to stand alone. Can be used in conjunction with 5/8" drywall or panel installation and with wrapped surface finishes such as fabric or vinyl wall coverings. Used vertically or diagonally and in approved conditions, horizontally.

Available in 10' length. 6063 T5 aluminum with standard clear anodized or primed finish. Anodized color and powder coating finishes available with custom color matching.

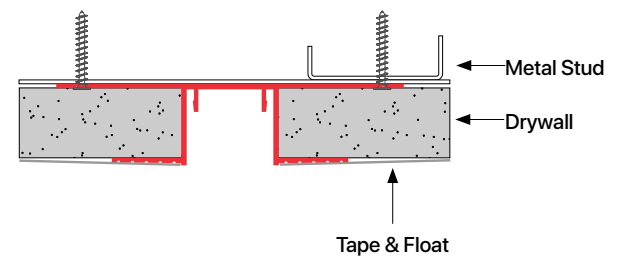
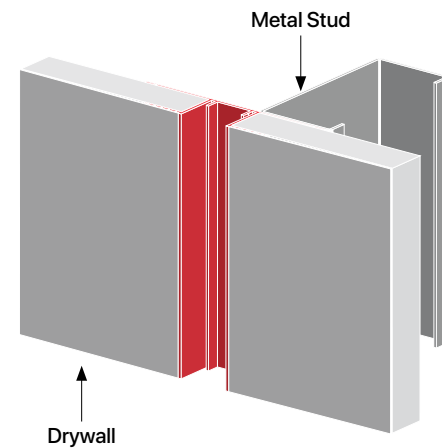
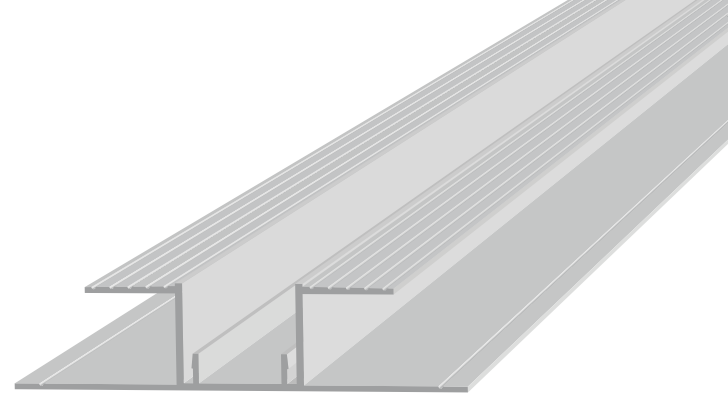

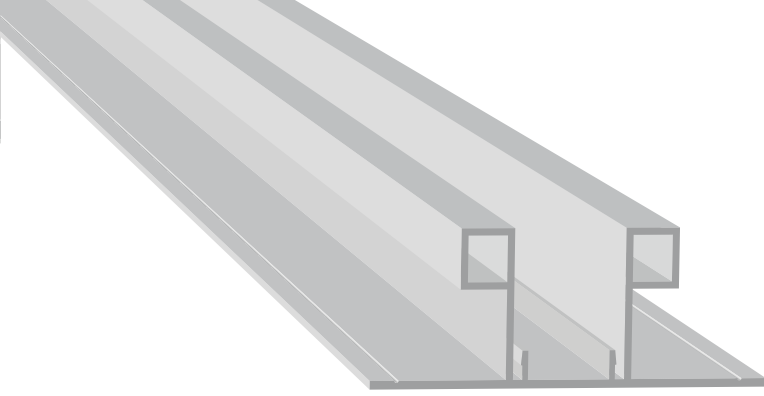

# CHRS

## Channel Rectangular Square

PATENTED

Anchor channel for two-piece system. Classic square projections add visual impact when paired with an insert piece. Can be used in conjunction with 5/8" drywall, panel installation and with wrapped surface finishes such as fabric or vinyl wall coverings. Used vertically or diagonally and in approved conditions, horizontally.

Available in 10' length. 6063 T5 aluminum with standard clear anodized or primed finish. Anodized color and powder coating finishes available with custom color matching.

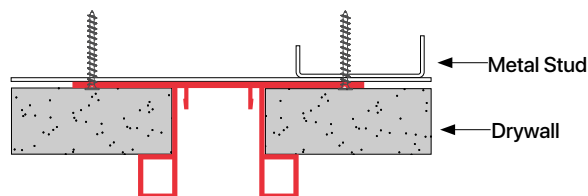
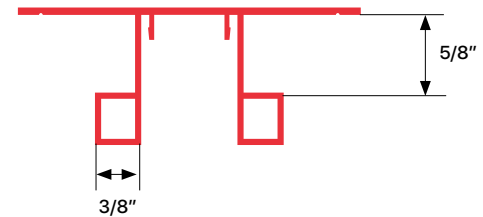
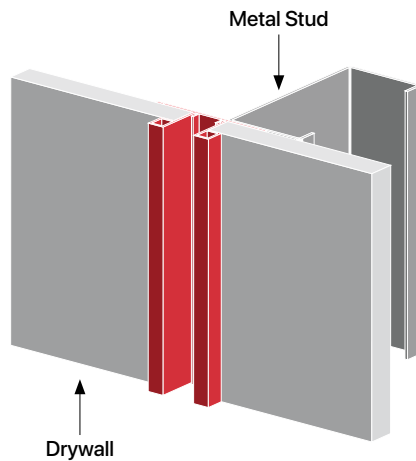

# CHSA

## Channel Square Angled

PATENTED

Anchor channel for two-piece system. Angled detail adds a unique touch to a classic look. Can be used in conjunction with 5/8" drywall, panel installation and with wrapped surface finishes such as fabric or vinyl wall coverings. Used vertically or diagonally and in approved conditions, horizontally.

Available in 10' length. 6063 T5 aluminum with standard clear anodized or primed finish. Anodized color and powder coating finishes available with custom color matching.

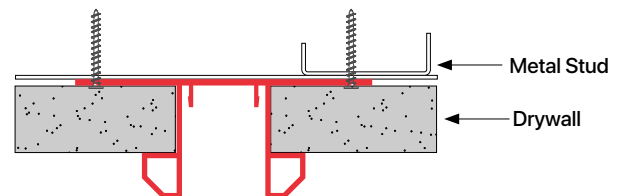
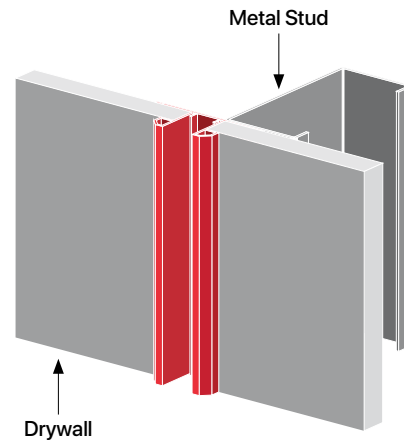
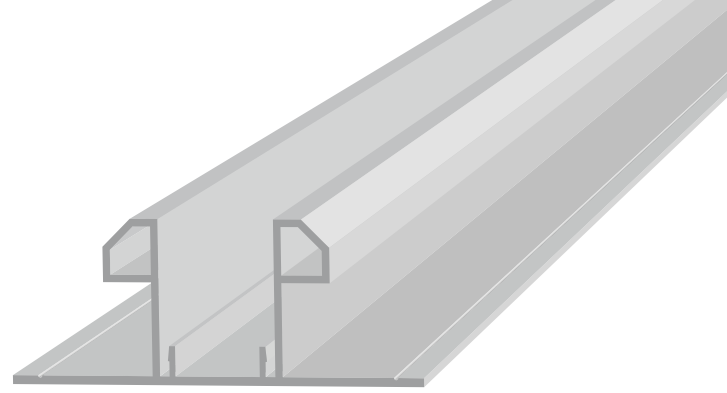
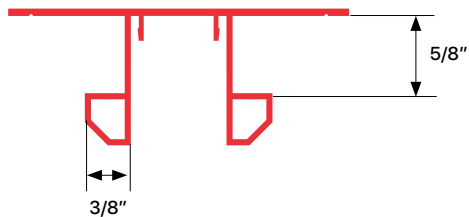

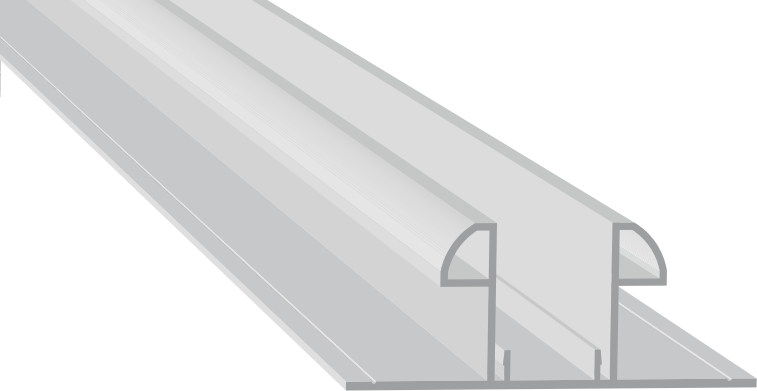

# CHST

## Channel Square Tapered

PATENTED

Anchor channel for two-piece system. Ridged faces provided for taping and floating and unique tapered square edges create a dynamic look when paired with an insert piece. Can be used in conjunction with 5/8" drywall, panel installation and with wrapped surface finishes such as fabric or vinyl wall coverings. Used vertically or diagonally and in approved conditions, horizontally.

Available in 10' length. 6063 T5 aluminum with standard clear anodized or primed finish. Anodized color and powder coating finishes available with custom color matching.

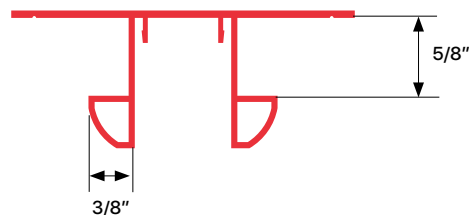
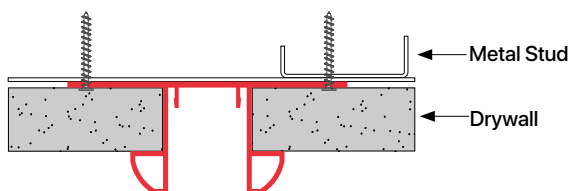
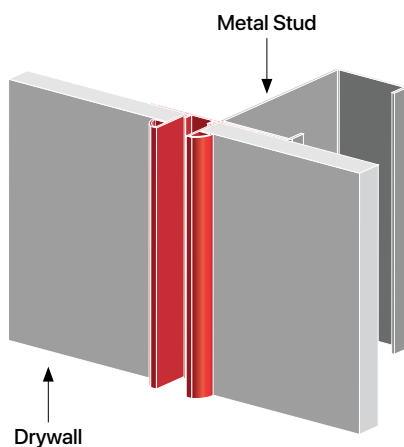

# IBRR

## Insert Blade Rectangular Round

PATENTED

Paired with a Channel Reveal, this unique blade projection creates an attractive look in any space. Ridged faces provided for taping and floating with drywall installation. Can also be used in conjunction with panels and wrapped surface finishes such as fabric or vinyl wall coverings. Used vertically or diagonally.

Available in 10' length. 6063 T5 aluminum with standard clear anodized or primed finish. Anodized color and powder coating finishes available with custom color matching.

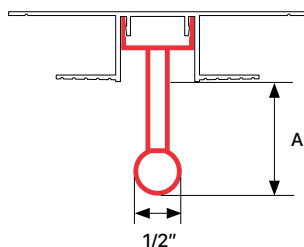

ITEM ID	A
IBRR-100	1"
IBRR-200	2"
IBRR-300	3"

Can be used with other channels.

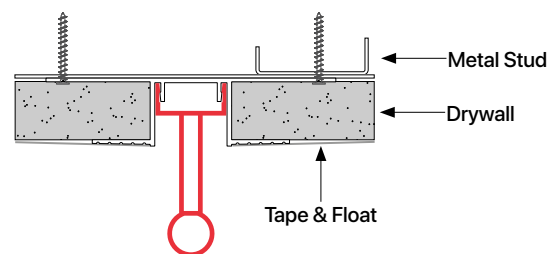
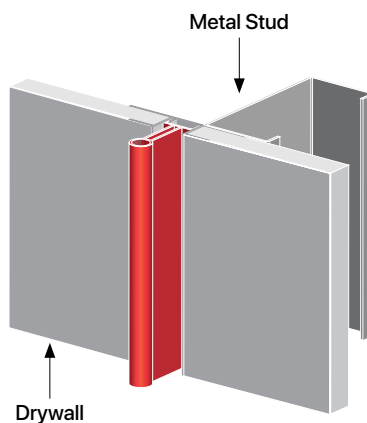
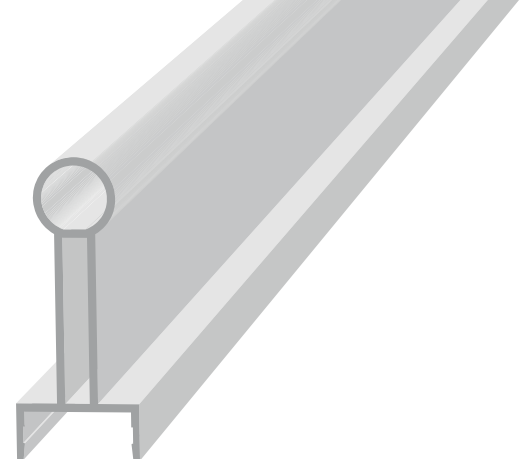

# IBRS

## Insert Blade Rectangular Square

PATENTED

Paired with a Channel Reveal, this blade projection with reveals adds refinement and class. Ridged faces provided for taping and floating with drywall installation. Can also be used in conjunction with panels and wrapped surface finishes such as fabric or vinyl wall coverings. Used vertically or diagonally.

Available in 10' length. 6063 T5 aluminum with standard clear anodized or primed finish. Anodized color and powder coating finishes available with custom color matching.

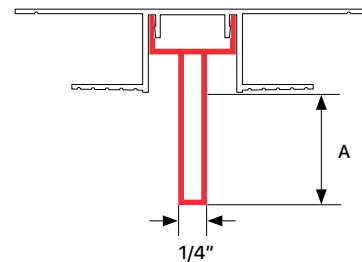
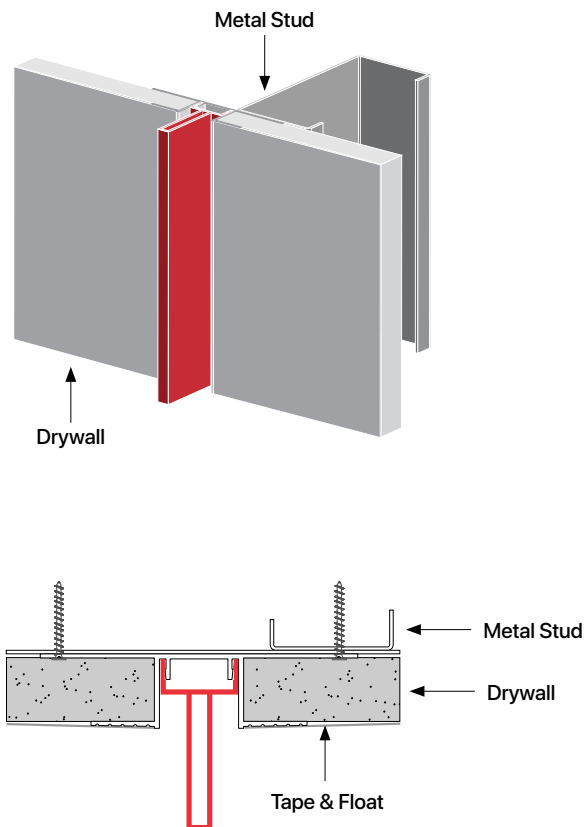

ITEM ID	A
IBRS-100	1"
IBRS-200	2"
IBRS-300	3"

Can be used with other channels.

# IBRT

## Insert Blade Rectangular Tapered

PATENTED

Paired with a Channel Reveal, this exclusive projection creates an impressive look with a detailed notch blade. Ridged faces provided for taping and floating with drywall installation. Can also be used in conjunction with panels and wrapped surface finishes such as fabric or vinyl wall coverings. Used vertically or diagonally.

Available in 10' length. 6063 T5 aluminum with standard clear anodized or primed finish. Anodized color and powder coating finishes available with custom color matching.

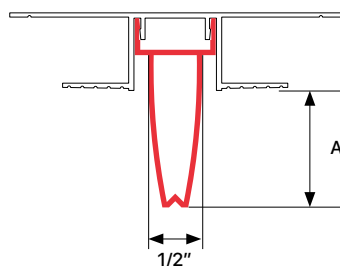

ITEM ID	A
IBRT-100	1"
IBRT-200	2"
IBRT-300	3"

Can be used with other channels.

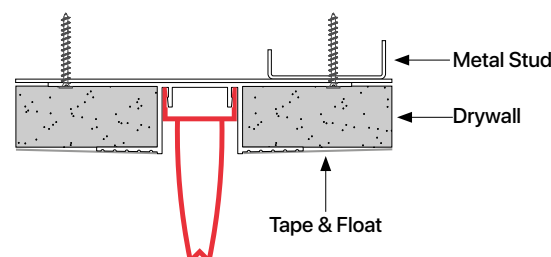
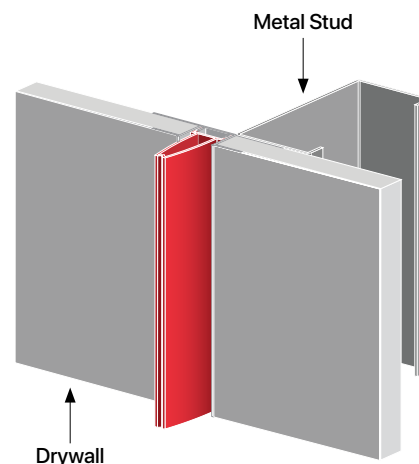
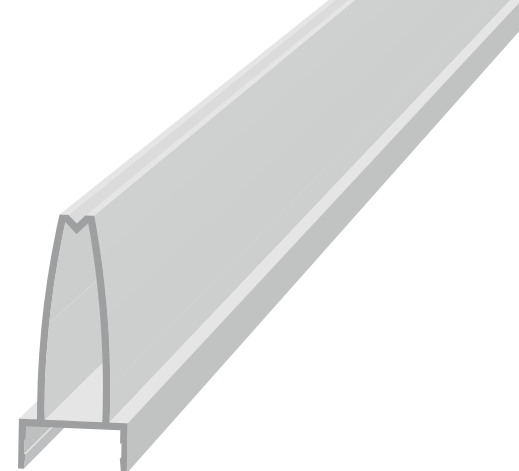

# IPRS

## Insert Projecting Radiused Square

Paired with a Channel Reveal, this subtle projection creates a classic look in drywall or panel installation. Can also be used in conjunction with wrapped surface finishes such as fabric or vinyl wall coverings. Ridged faces provided for tape & float. Used vertically or diagonally.

Available in 10' length. 6063 T5 aluminum with standard clear anodized or primed finish. Anodized color and powder coating finishes available with custom color matching.

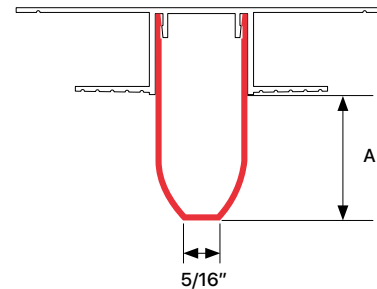
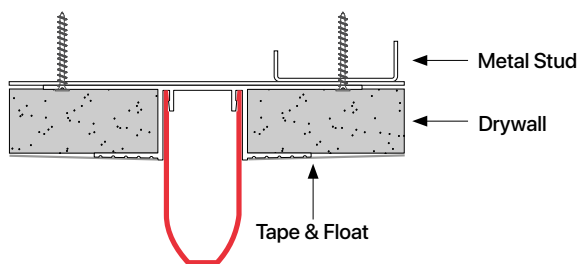
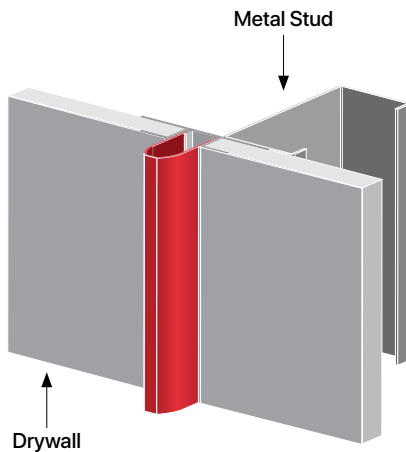

ITEM ID	A
IPRS-0	0"
IPRS-100	1"
IPRS-200	2"
IPRS-300	3"

Can be used with other channels.

# IRSQ

## Insert Rectangular Square

Paired with a Channel Reveal, this classic projection creates a modern look in drywall or panel installation. Can also be used in conjunction with wrapped surface finishes such as fabric or vinyl wall coverings. Ridged faces provided for tape & float. Used vertically or diagonally.

Available in 10' length. 6063 T5 aluminum with standard clear anodized or primed finish. Anodized color and powder coating finishes available with custom color matching.

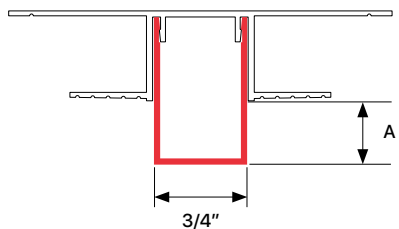

ITEM ID	A
IRSQ-0	0"
IRSQ-100	1"
IRSQ-200	2"
IRSQ-300	3"

Can be used with other channels.

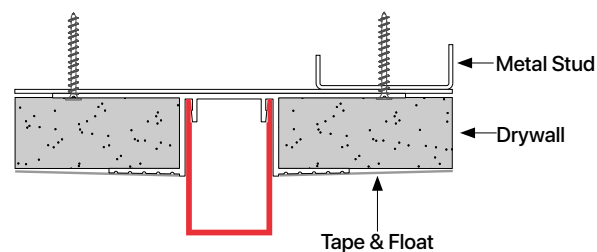
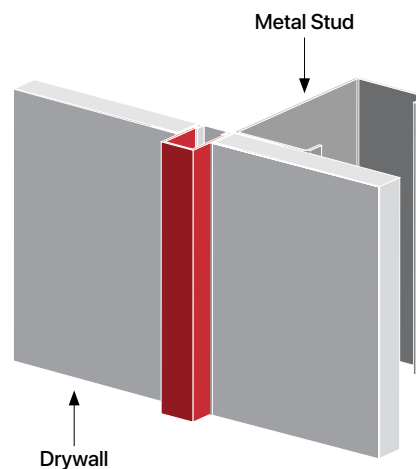
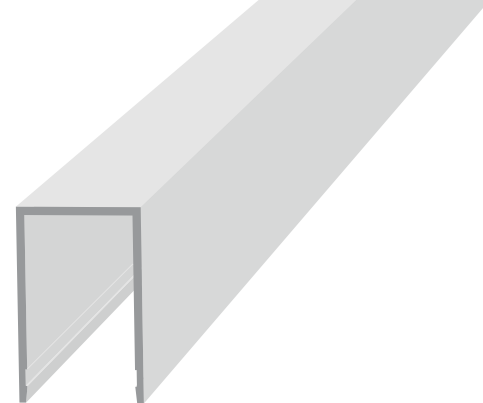



## Moldings & Millwork

Contemporary and versatile designs for any application.



# MCK

## Corner Key

Simple and minimalist corner profile designed to be used with millwork and panel applications. Provides corner protection and simple design for vertical and horizontal drywall or panel corners. Can be used in conjunction with wrapped surface finishes such as fabric or vinyl wall coverings.

Available in 10' length. 6063 T5 aluminum with standard clear anodized or primed finish. Anodized color and powder coating finishes available with custom color matching.

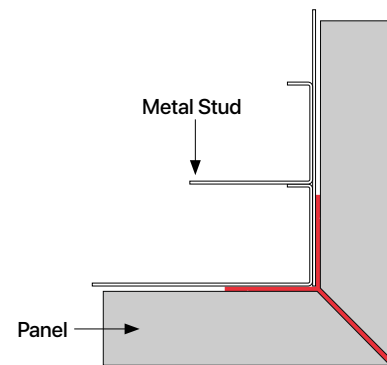
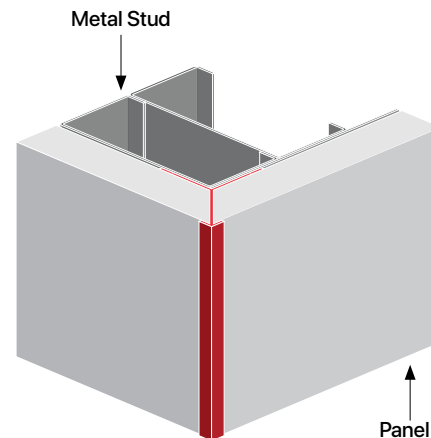
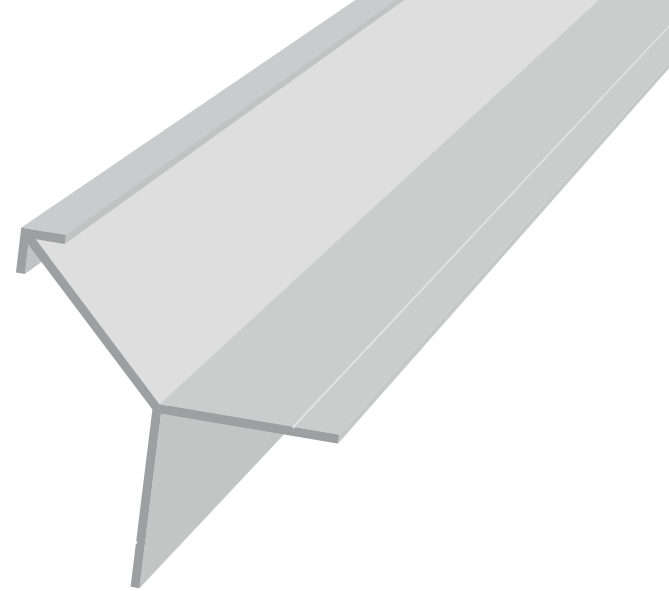
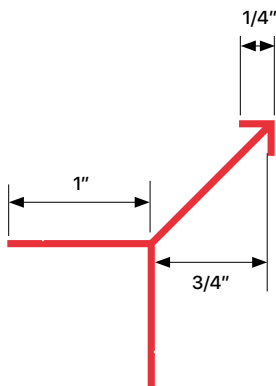

# MCS

## Corner Square Mold

Minimalistic linear corner profile. Provides corner protection and sleek design for millwork or panel corners. Can be used in conjunction with wrapped surface finishes such as fabric or vinyl wall coverings.

Available in 10' length. 6063 T5 aluminum with standard clear anodized or primed finish. Anodized color and powder coating finishes available with custom color matching.

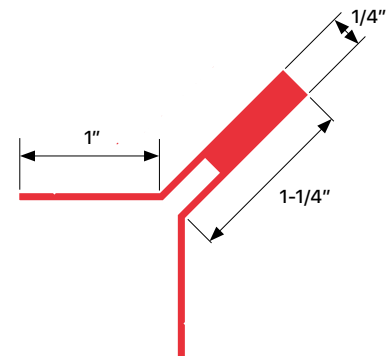
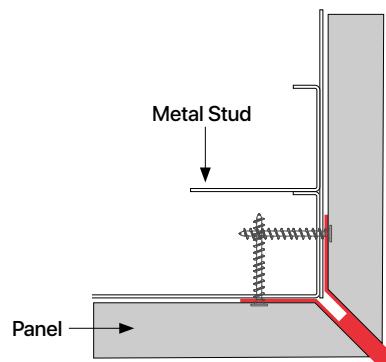
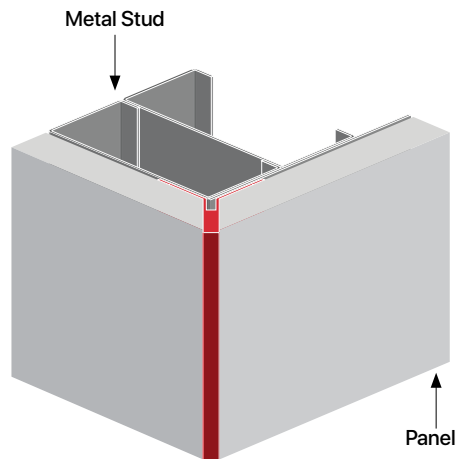

# MCR

## C Mold

Clean finish design with reveal detail for drywall terminations at ceilings, windows, doors and other material transitions. Can be installed horizontally or vertically. Can be used in conjunction with 5/8" drywall, panel installation and with wrapped surface finishes such as fabric or vinyl wall coverings. Ridged faces for tape & float and pre-punched holes for easy install (hole placement may vary).

Available in 10' length. 6063 T5 aluminum with standard clear anodized or primed finish. Anodized color and powder coating finishes available with custom color matching.

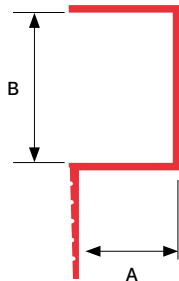

ITEM ID	A	B
MCR5-14	1/2"	1/4"
MCR5-12	1/2"	1/2"
MCR5-100	1/2"	1"
MCR5-200	1/2"	2"
MCR-12	5/8"	1/2"
MCR-58	5/8"	5/8"

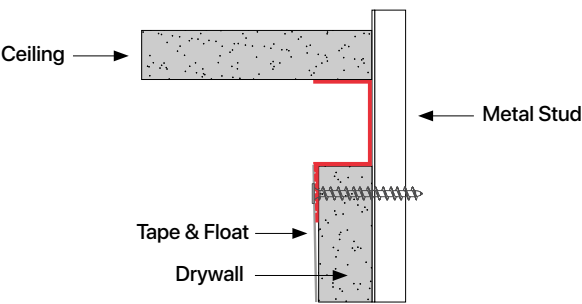
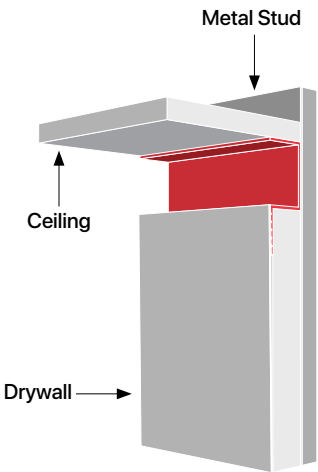
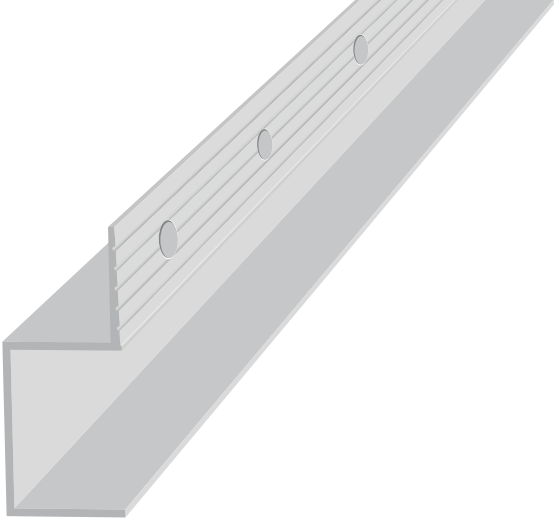

# MEC

## End Cap

Classic termination profile that provides a clean end for a wall, partition or cased opening. Ridged faces for tape & float and pre-punched holes for easy install (hole placement may vary). Can be used in conjunction with drywall, panel installation and wrapped surface finishes such as fabric or vinyl wall coverings.

Available in 10' length. 6063 T5 aluminum with standard clear anodized or primed finish. Anodized color and powder coating finishes available with custom color matching.

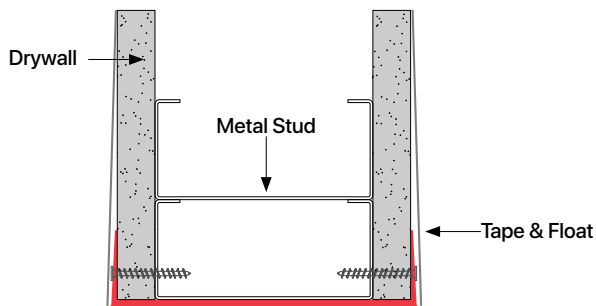
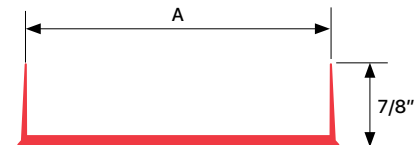
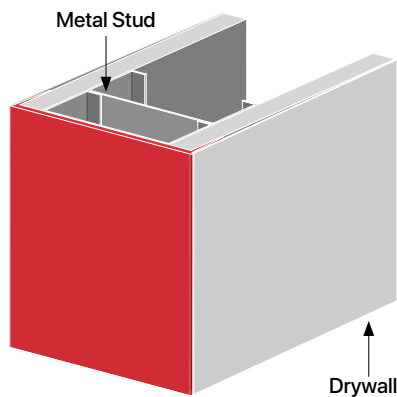

ITEM ID	A
MEC-334	3-3/4"
MEC-478	4-7/8"

# MECS

## End Cap Step

Stepped-termination profile that provides clean but distinct end for a wall, partition or cased opening. Ridged faces for tape & float and pre-punched holes for easy install (hole placement may vary). Can be used in conjunction with drywall, panel installation and wrapped surface finishes such as fabric or vinyl wall coverings.

Available in 10' length. 6063 T5 aluminum with standard clear anodized or primed finish. Anodized color and powder coating finishes available with custom color matching.

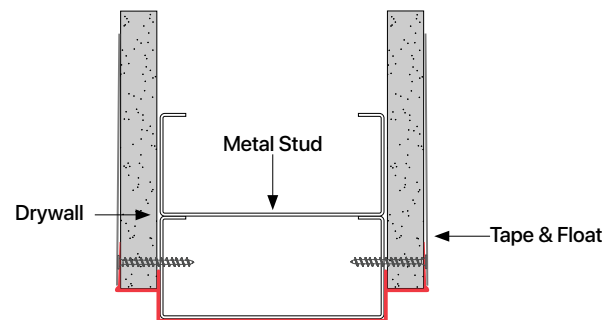
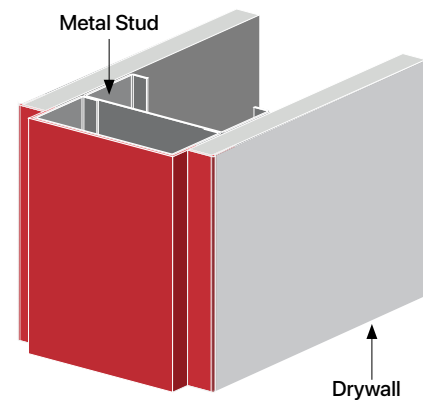
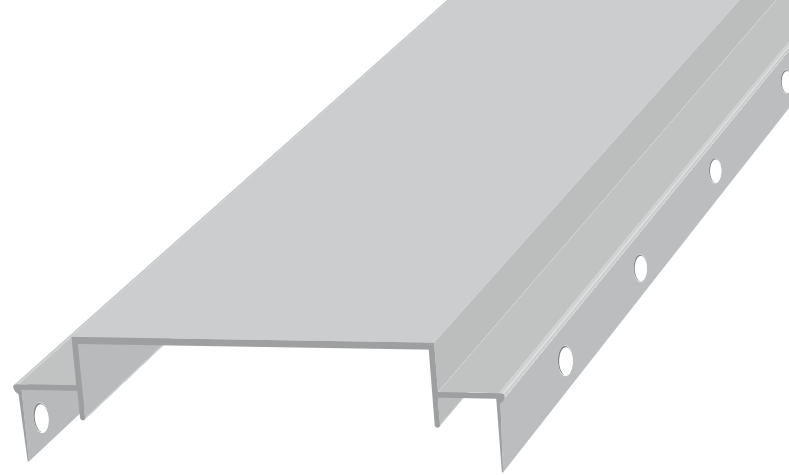
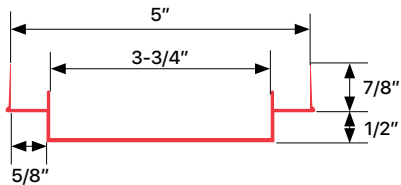

# MFC

## Corner Flush Mold

Simple and minimalist corner profile designed to be used with drywall. Provides corner protection and simple design for vertical and horizontal drywall or panel corners. Ridged face provided for tape and float and pre-punched holes for easy install (hole placement may vary). Can be used in conjunction with wrapped surface finishes such as fabric or vinyl wall coverings.

Available in 10' length. 6063 T5 aluminum with standard clear anodized or primed finish. Anodized color and powder coating finishes available with custom color matching.

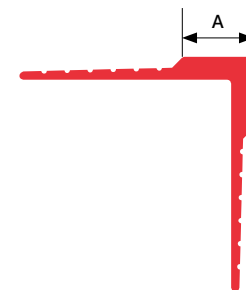
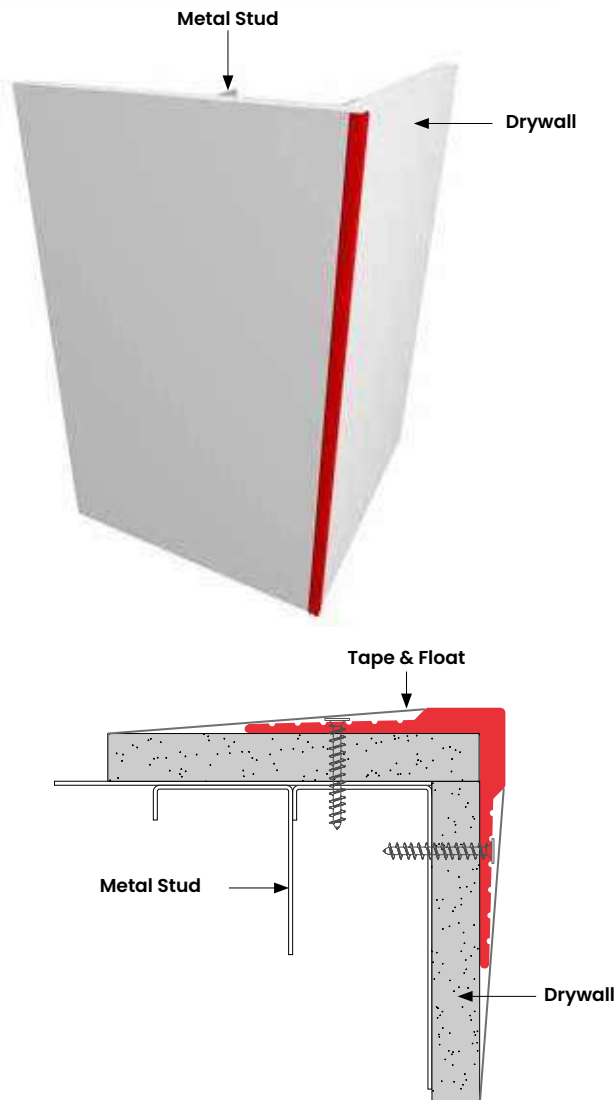

ITEM ID	A
MFC	3/8"

# MFF

## Flush Flat Mold

Versatile line piece to provide detail and style to your project. Ideal for detailing drywall and creating patterns or feature walls. Ridged face provided for tape and float and pre-punched holes for easy install (hole placement may vary). Can be used in conjunction with drywall, panel installation and wrapped surface finishes such as fabric or vinyl wall coverings.

Available in 10' length. 6063 T5 aluminum with standard clear anodized or primed finish. Anodized color and powder coating finishes available with custom color matching.

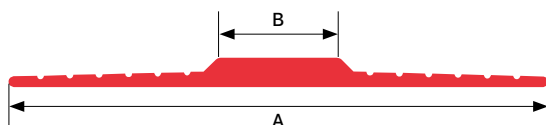

ITEM ID	A	B
MFF-12	1/2"	2-4/5"
MFF-100	1"	2-4/5"

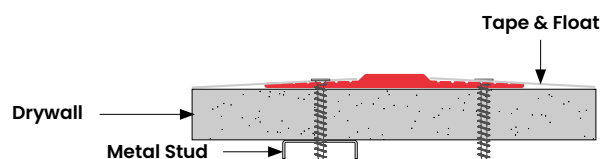
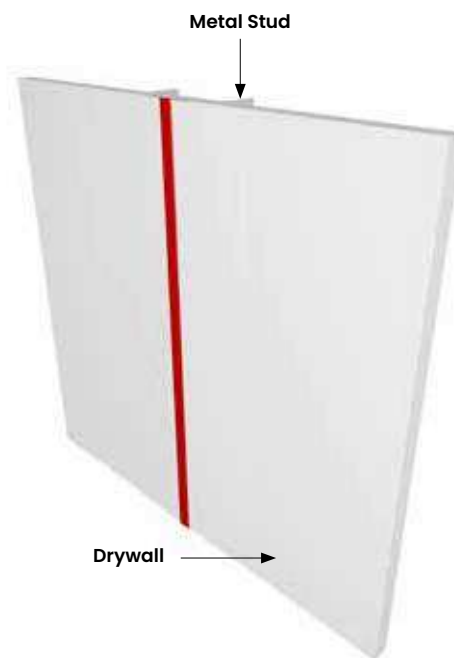

# MFR

## F Mold

Clean finish design with reveal detail for drywall terminations at ceilings, windows, doors and other material transitions. Can be installed horizontally or vertically. Can be used in conjunction with 5/8" drywall, panel installation and with wrapped surface finishes such as fabric or vinyl wall coverings.

Available in 10' length. 6063 T5 aluminum with standard clear anodized or primed finish. Anodized color and powder coating finishes available with custom color matching.

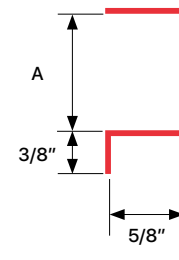
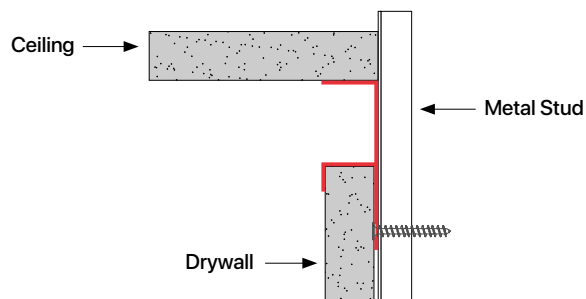
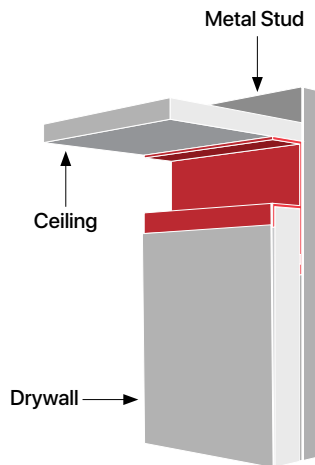

ITEM ID	A
MFR-12	1/2"
MFR-100	1"
MFR-200	2"

# MGT

## Glass Track

Transition profile for intersections of drywall and glass. Ridged face provided for tape and float. Can be used in conjunction with drywall, panel installation and wrapped surface finishes such as fabric or vinyl wall coverings.

Available in 10' length. 6063 T5 aluminum with standard clear anodized or primed finish. Anodized color and powder coating finishes available with custom color matching.

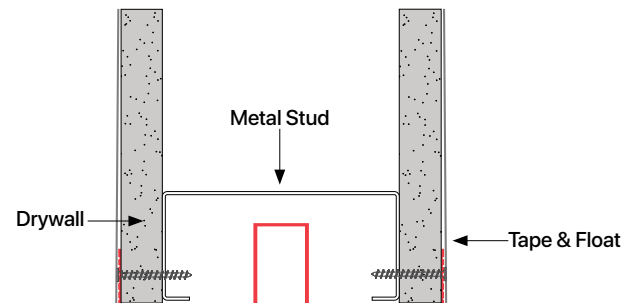
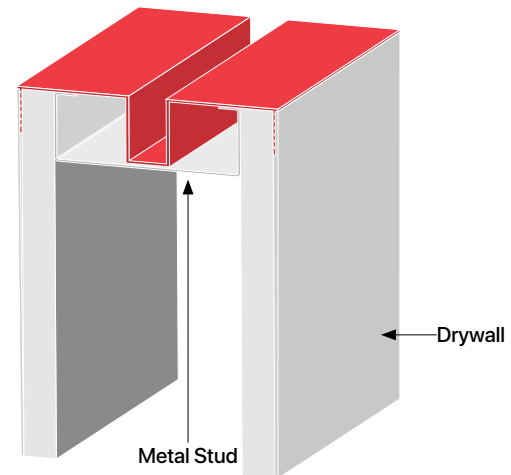
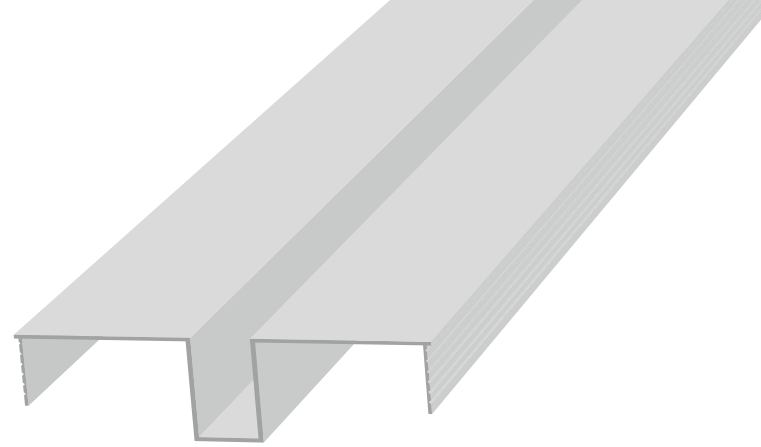
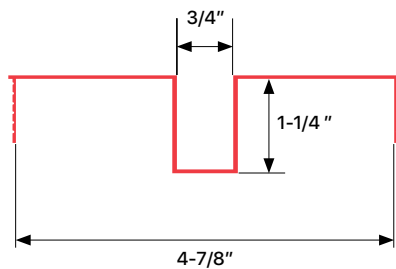

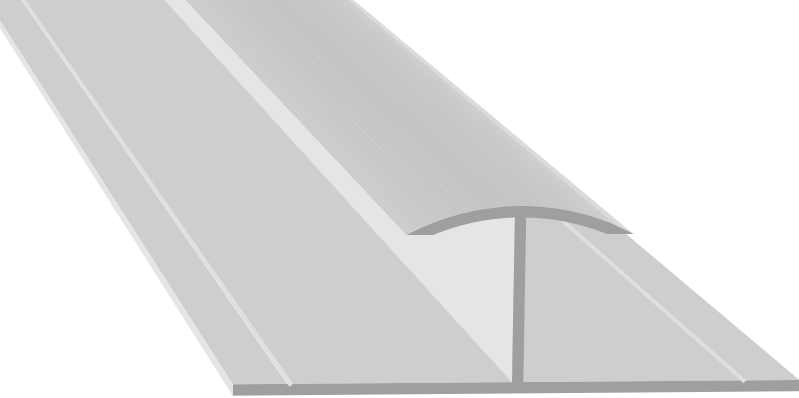

# MHC

## H Mold Curve

Create a curved seam line on any wall! Can be used in conjunction with drywall, panel installation and wrapped surface finishes such as fabric or vinyl wall coverings.

Available in 10' length. 6063 T5 aluminum with standard clear anodized or primed finish. Anodized color and powder coating finishes available with custom color matching.

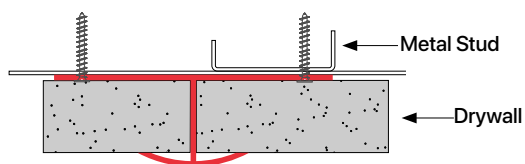
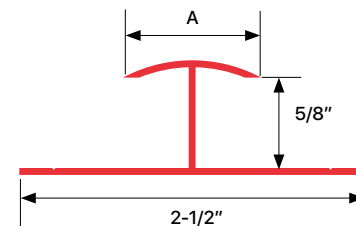
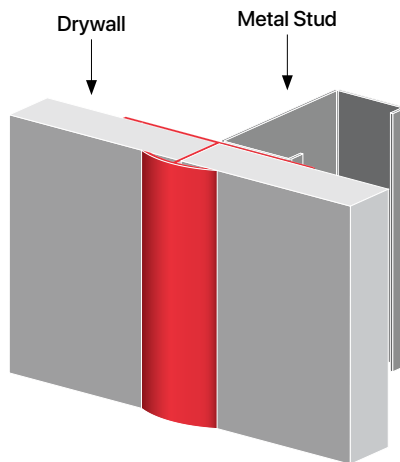

ITEM ID	A
MHC-12	1/2"
MHC-100	1"

# MHF

## H Mold Flat

Add a modern seam line to any wall. Can be used in conjunction with drywall, panel installation and wrapped surface finishes such as fabric or vinyl wall coverings.

Available in 10' length. 6063 T5 aluminum with standard clear anodized or primed finish. Anodized color and powder coating finishes available with custom color matching.

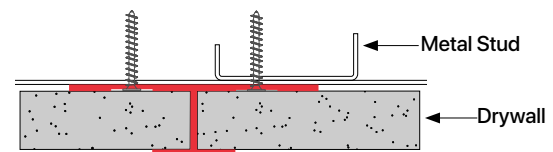
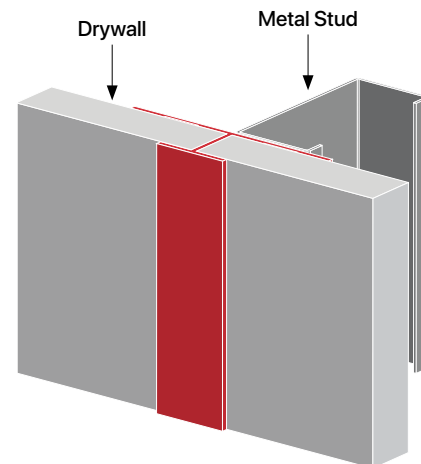
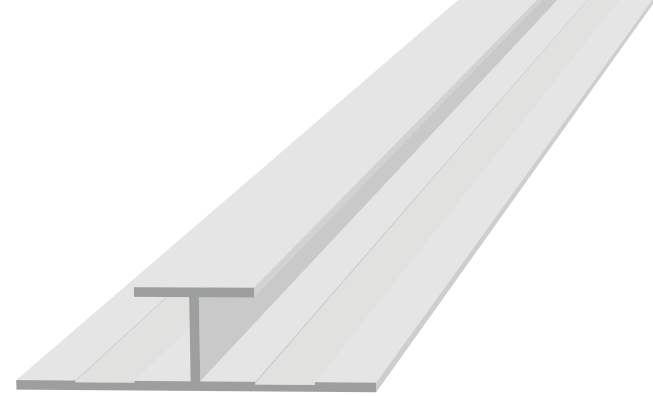
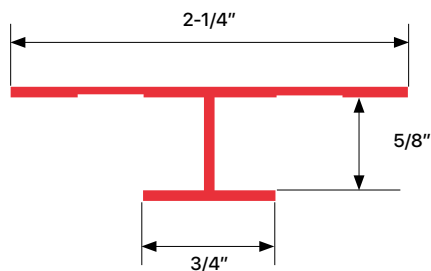

# MJR

## J Mold

Classic and clean design provides smooth finish at edges of drywall or at material transitions. Can be installed horizontally or vertically. Can be used in conjunction with 5/8" drywall, panel installation and with wrapped surface finishes such as fabric or vinyl wall coverings.

Available in 10' length. 6063 T5 aluminum with standard clear anodized or primed finish. Anodized color and powder coating finishes available with custom color matching.

\*Custom sizes available

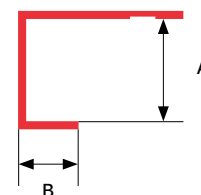
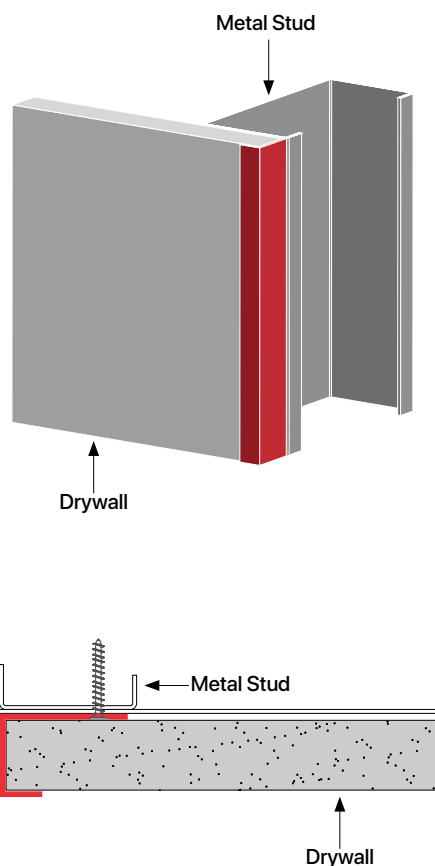

ITEM ID	A	B
MJR-14	5/8"	1/4"
MJR-38	5/8"	3/8"
MJR-12	5/8"	1/2"
MJR-716-38	7/16"	3/8"
MJR-34-58	3/4"	5/8"

# MKE

## Knife Edge

Creates a sharp knife edge at ceiling drywall terminations. Clean, crisp look creating unique ceiling design and allows for LED lighting or shadow line. Adjust fur down placement for addition of LED light strips.

Available in 10' length. 6063 T5 aluminum with standard clear anodized or primed finish. Anodized color and powder coating finishes available with custom color matching.

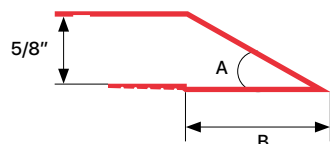

ITEM ID	A	B
MKE-30	30°	1-3/8"
MKE-45	45°	3/4"

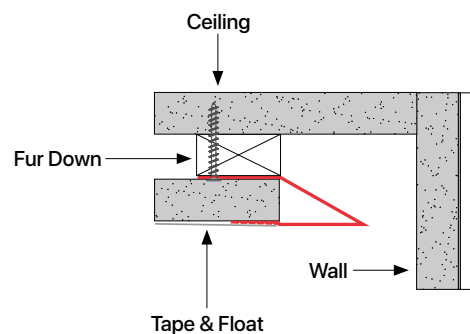
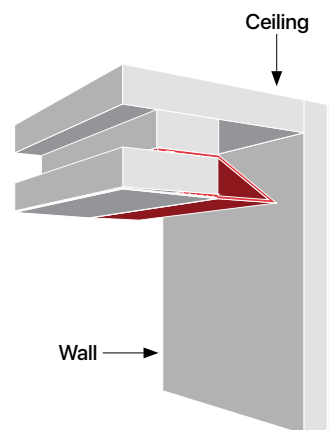

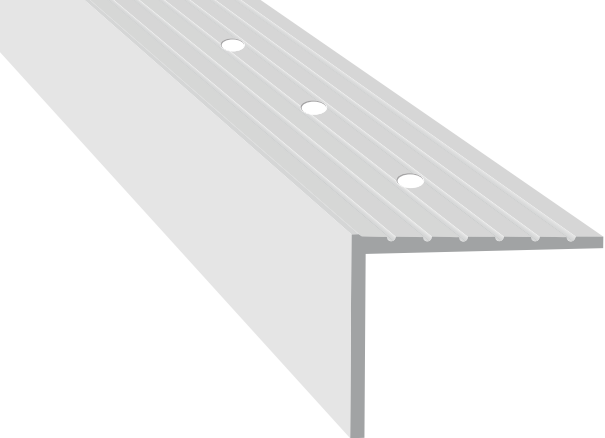

# MLR

## L Mold

Classic and versatile L profile for use at drywall edges and transitions. Can be used horizontally, vertically or diagonally. Ridged face for tape & float and pre-punched holes for easy install (hole placement may vary).

Available in 10' length. 6063 T5 aluminum with standard clear anodized or primed finish. Anodized color and powder coating finishes available with custom color matching.

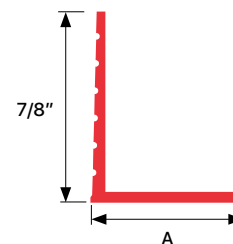
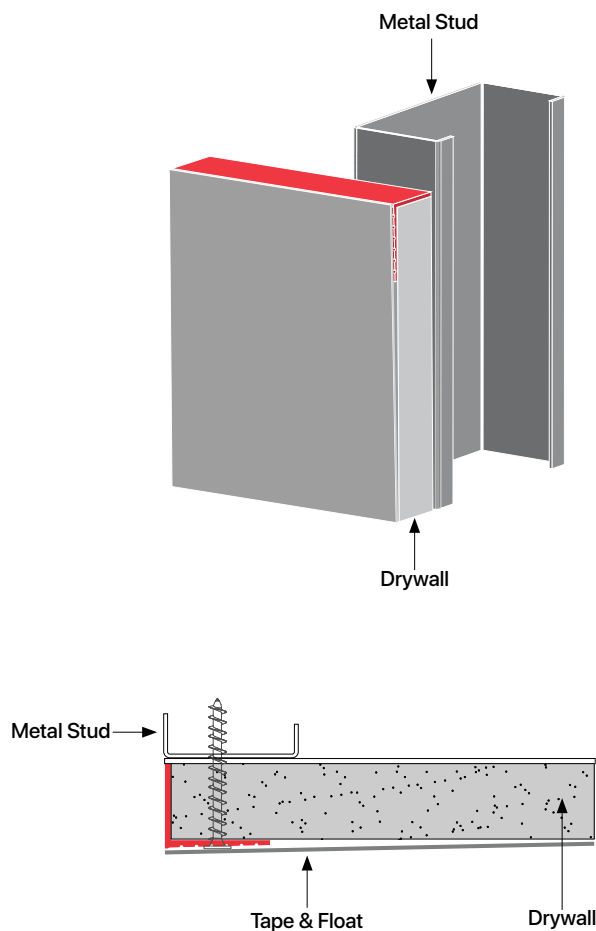

ITEM ID	A
MLR-12	1/2"
MLR-58	5/8"
MLR-100	1"
MLR-200	2"
MLR-250	2-1/2"
MLR-300	3"

# MLU

## Universal L Mold

Simple angle trim that can be adaptively used for multiple applications such as transition bar from drywall to panel/tile, between panels or in corner conditions. Can be used horizontally, vertically or diagonally.

Available in 10' length. 6063 T5 aluminum with standard clear anodized or primed finish. Anodized color and powder coating finishes available with custom color matching.

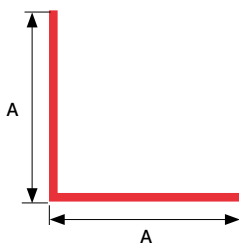

ITEM ID	A
MLU-12	1/2"
MLU-34	3/4"
MLU-100	1"

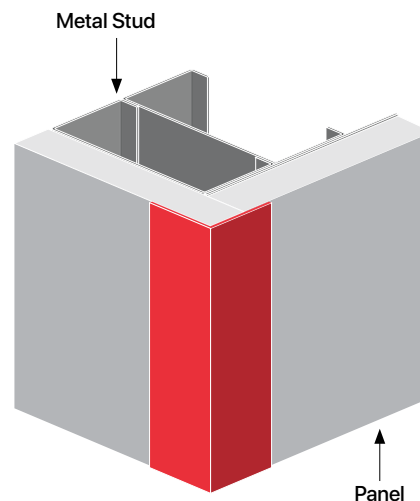
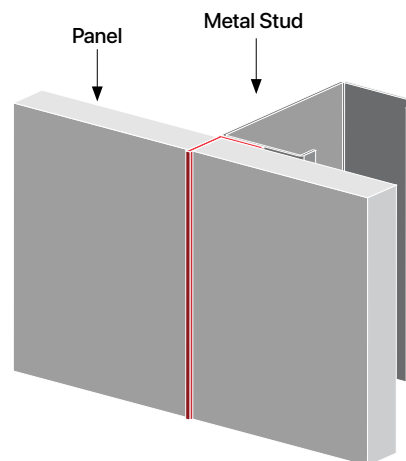
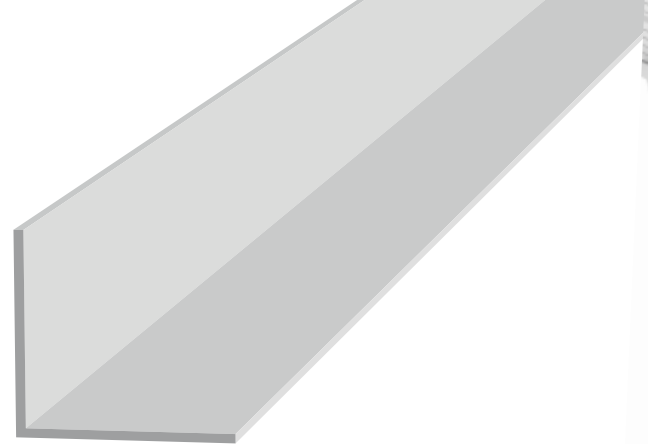



# MPH

## Panel H Mold

Create a modern seam line on any wall while providing protection for the edges of your 1/8" wall panels. Ridged face provided for tape and float and panel adhesive. Pre-punched holes for easy install (hole placement may vary). Can be used in conjunction with drywall, FRP & FRL installation and wrapped surface finishes such as fabric or vinyl wall coverings.

Available in 10' length. 6063 T5 aluminum with standard clear anodized or primed finish. Anodized color and powder coating finishes available with custom color matching.

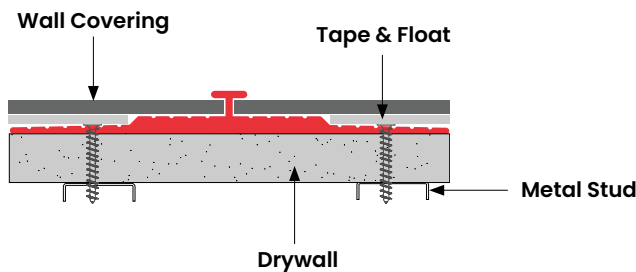
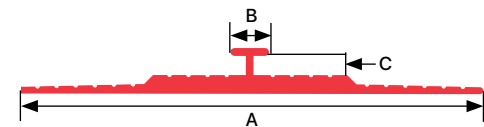
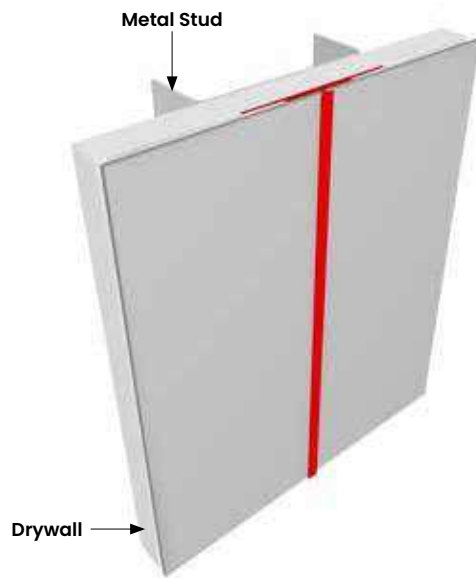

ITEM ID	A	B	C
MPH	3"	1/4"	1/8"

# MPJ

## Panel J Mold

Create a modern termination line on any wall while providing protection for the edges of your 1/8" wall panels. Ridged face provided for tape and float and panel adhesive. Pre-punched holes for easy install (hole placement may vary). Can be used in conjunction with drywall, FRP & FRL installation and wrapped surface finishes such as fabric or vinyl wall coverings.

Available in 10' length. 6063 T5 aluminum with standard clear anodized or primed finish. Anodized color and powder coating finishes available with custom color matching.

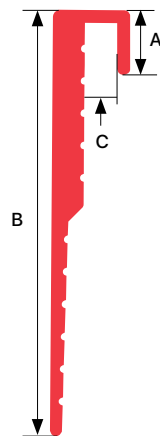

ITEM ID	A	B	C
MPJ	1/4"	1-1/2"	1/8"

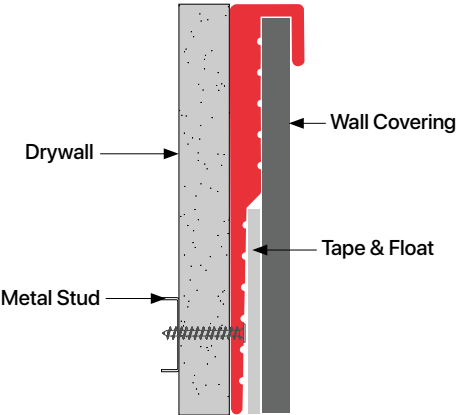
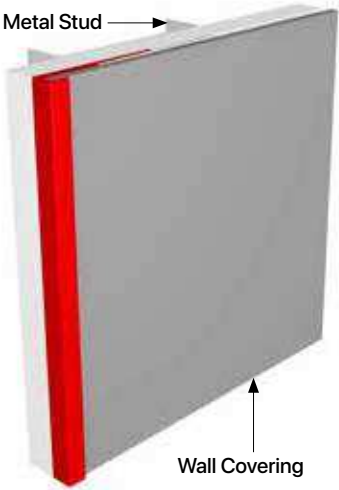

# MPOC

## Panel Outside Corner Mold

Simple and minimalist corner profile designed to provide protection for the edges of your 1/8" wall panels. Ridged face provided for tape and float and panel adhesive. Pre-punched holes for easy install (hole placement may vary). Can be used in conjunction with drywall, FRP & FRL installation and wrapped surface finishes such as fabric or vinyl wall coverings.

Available in 10' length. 6063 T5 aluminum with standard clear anodized or primed finish. Anodized color and powder coating finishes available with custom color matching.

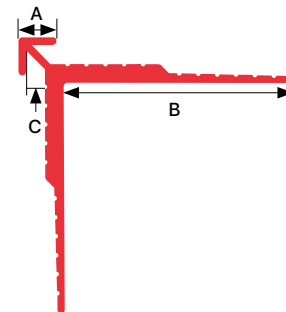
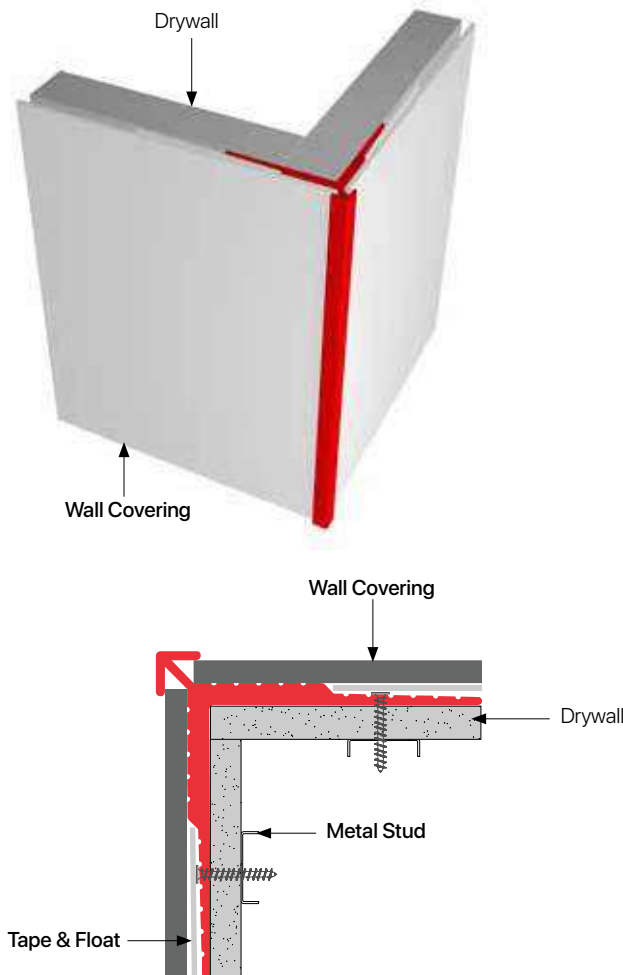

ITEM ID	A	B	C
MPOC	1/4"	1-1/2"	1/8"

# MPS

## Projecting Square Mold

Simple and classic design that serves as a bold line transition between panels. A better, more appealing and secure solution to the "open wall" vertical joint look popular in many areas. Can be installed vertically, horizontally or diagonally. Used in conjunction with 5/8" drywall, panel installation and wrapped surface finishes such as fabric or vinyl wall coverings.

Available in 10' length. 6063 T5 aluminum with standard clear anodized or primed finish. Anodized color and powder coating finishes available with custom color matching.

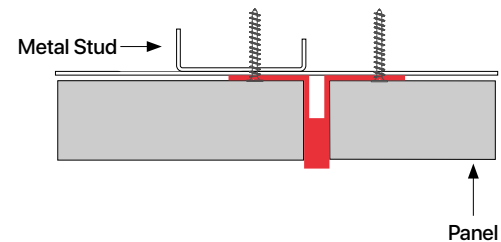
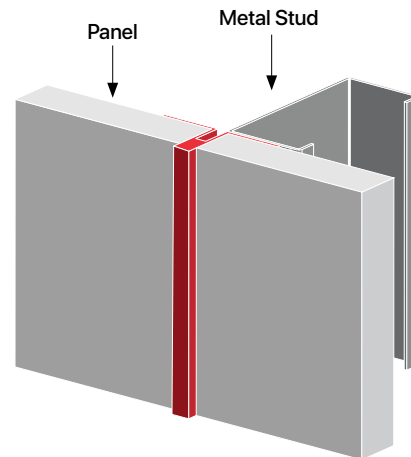
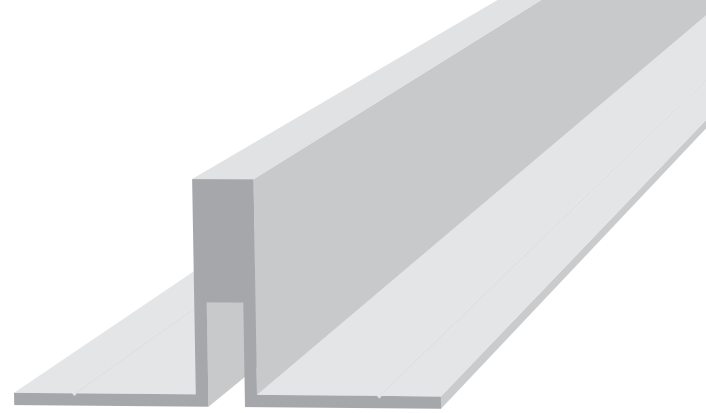
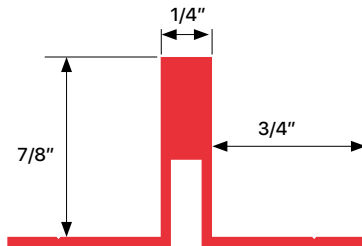

# MRV

## Reveal Mold

Classic and clean design provides smooth finish at edges of drywall or at material transitions. Can be installed horizontally or vertically. Can be used in conjunction with drywall, panel installation and wrapped surface finishes such as fabric or vinyl wall coverings.

Available in 10' length. 6063 T5 aluminum with standard clear anodized or primed finish. Anodized color and powder coating finishes available with custom color matching.

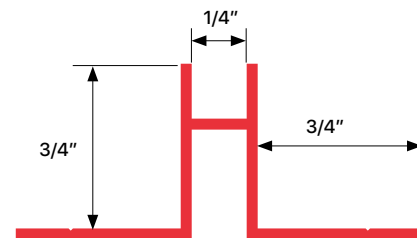
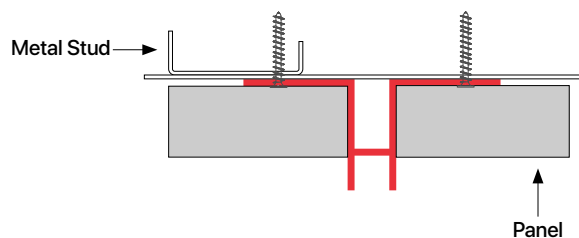
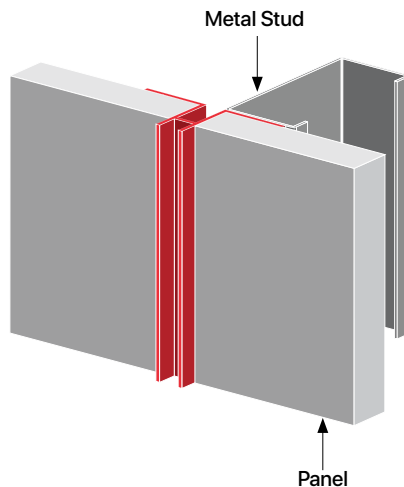

# MTR

## T Mold

T Mold serves as a minimalist joint between panels. Works with all 5/16" panel profiles/finishes.

Available in 10' length. 6063 T5 aluminum with standard clear anodized or primed finish. Anodized color and powder coating finishes available with custom color matching.

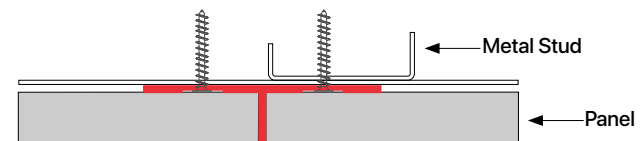
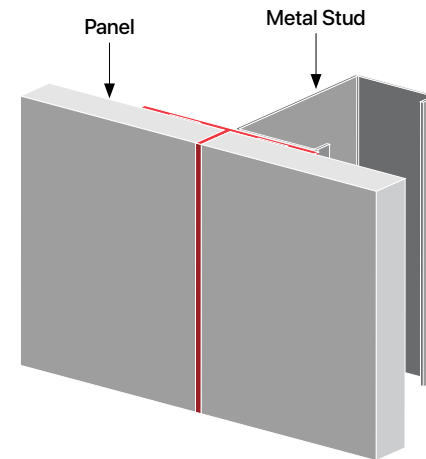
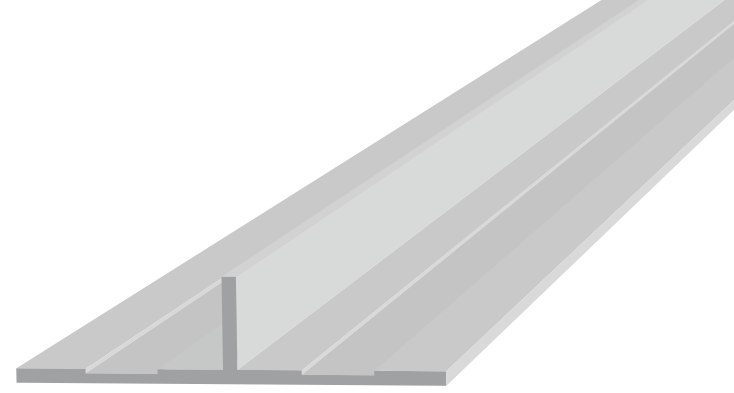
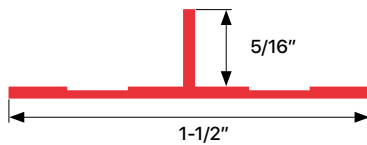

# MWR

## W Mold

Streamlined design with reveal detail for drywall terminations at ceilings and other material transitions. Can be used in conjunction with 5/8" drywall, panel installation and with wrapped surface finishes such as fabric or vinyl wall coverings.

Available in 10' length. 6063 T5 aluminum with standard clear anodized or primed finish. Anodized color and powder coating finishes available with custom color matching.

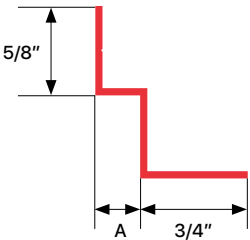
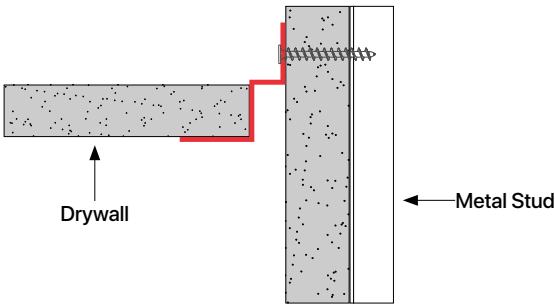
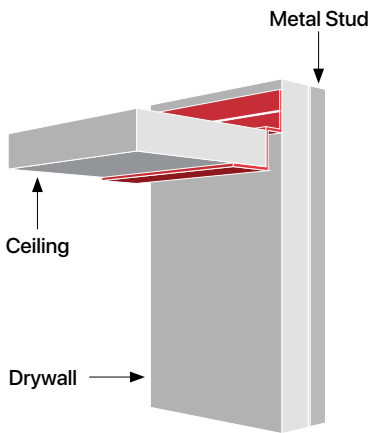

ITEM ID	A
MWR-516	5/16"
MWR-58	5/8"
MWR-150	1-1/2"

# MZR

## Z Mold

Versatile shadow line piece. Ideal for transitioning between drywall and other materials or drywall and floors. Ridged face provided for tape and float and pre-punched holes for easy install (hole placement may vary).

Available in 10' length. 6063 T5 aluminum with standard clear anodized or primed finish. Anodized color and powder coating finishes available with custom color matching.

ITEM ID	A	B
MZR14-14	1/4"	1/4"
MZR5-12	1/2"	1/2"
MZR5-100	1/2"	1"
MZR5-150	1/2"	1-1/2"
MZR5-200	1/2"	2"
MZR5-250	1/2"	2-1/2"
MZR5-300	1/2"	3"
MZR5-350	1/2"	3-1/2"
MZR5-400	1/2"	4"
MZR-14	5/8"	1/4"
MZR-516	5/8"	5/16"
MZR-12	5/8"	1/2"
MZR-58	5/8"	5/8"
MZR-100	5/8"	1"
MZR-150	5/8"	1-1/2"
MZR-200	5/8"	2"
MZR-250	5/8"	2-1/2"
MZR-300	5/8"	3"
MZR-350	5/8"	3-1/2"
MZR-400	5/8"	4"

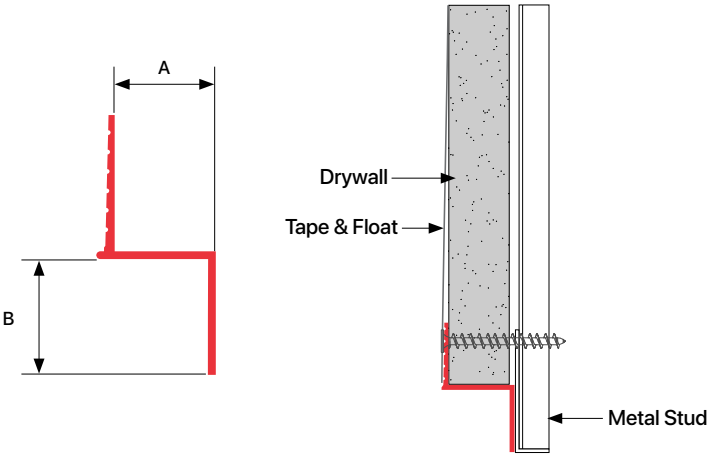
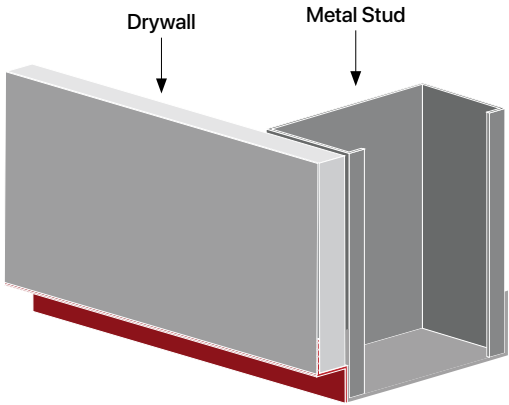
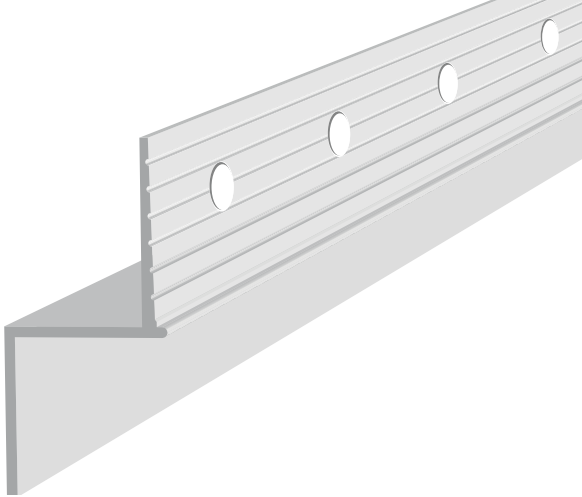



37.5665°N  
126.9780°E

MENU			
TAKO & SSAM	3 FOR \$13	\$4	SEA
DOSHI		\$14	
GALBI			
JAERYOOK	SAMGYUPSAL		
BOSSAM			
BULDALK			
SE SONGYI	BEOSEOT	V-VE	
DIY MEAL KITS			
TAKO & SSAM BOX		\$25	
BOSSAM BOX		\$28	
SEE BOARD FOR BANCHAN & SIDES			



# Acoustical

Perimeter Trims for Acoustical Ceilings



# PACT

## Classic Perimeter Trim

Ideal for suspended drywall or panel ceilings and available in six sizes. Standard in-stock finish is primed. Splice plates and clips included with trim purchase.

Available in 12' length. 6063 T5 aluminum. Anodized color and powder coating finishes available with custom color matching.

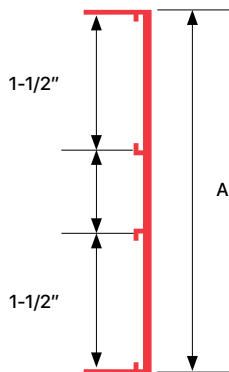

ITEM ID	A
PACT-2	2"
PACT-4	4"
PACT-6	6"
PACT-8	8"
PACT-10	10"
PACT-12	12"

XtremeInterior™ profiles are subject to alterations with or without notice.

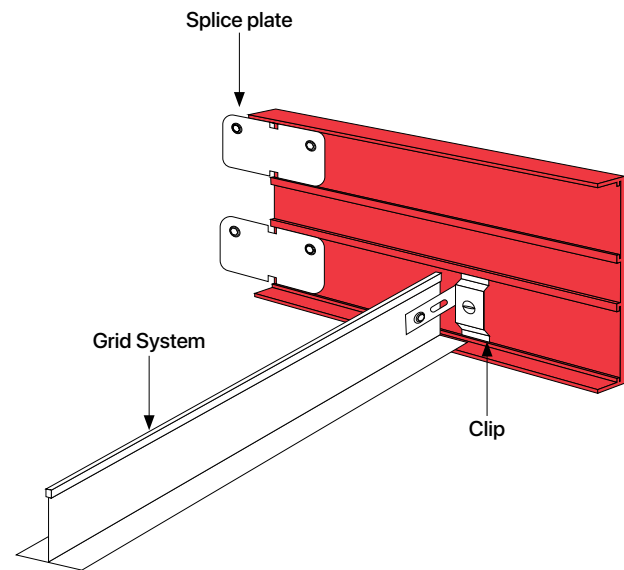
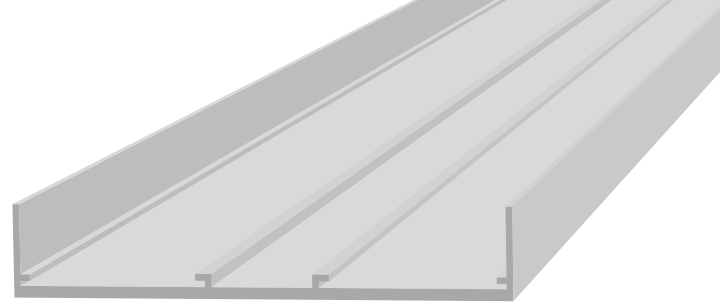

# PACT-KE5

## Knife Edge Perimeter Trim

Creates a sharp "knife edge" at suspended ceiling borders. Standard in-stock finish is primed. Can be powder coated or anodized upon request. Splice plates and clips included with trim purchase.

Available in 12' length. 6063 T5 aluminum with standard clear anodized or primed finish. Anodized color and powder coating finishes available with custom color matching.

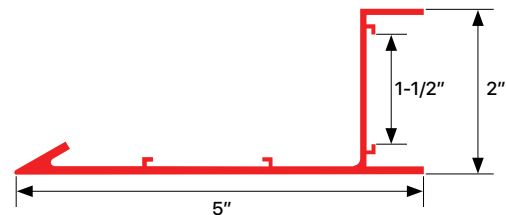
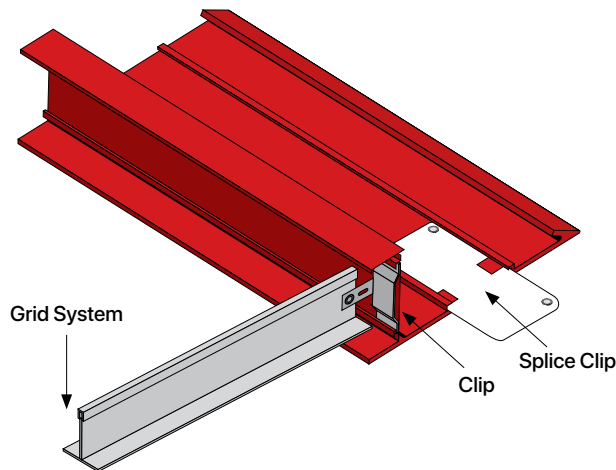



## Custom Trim Work

Tamlyn provides custom architectural extrusion solutions to designers and architects throughout the world. Though our catalog offering is diverse we understand that sometimes the need for a small change to an existing profile or a from-scratch idea would make all the difference for a project. At Tamlyn we are proud to have in-house architects, engineers and technical support available to help! We can support high volumes, short-lead times and are not distressed by custom requests. See your ideas develop from a pencil sketch, to a CAD drawing, to 3D printed samples and finally to a beautiful and functional extruded aluminum profile!

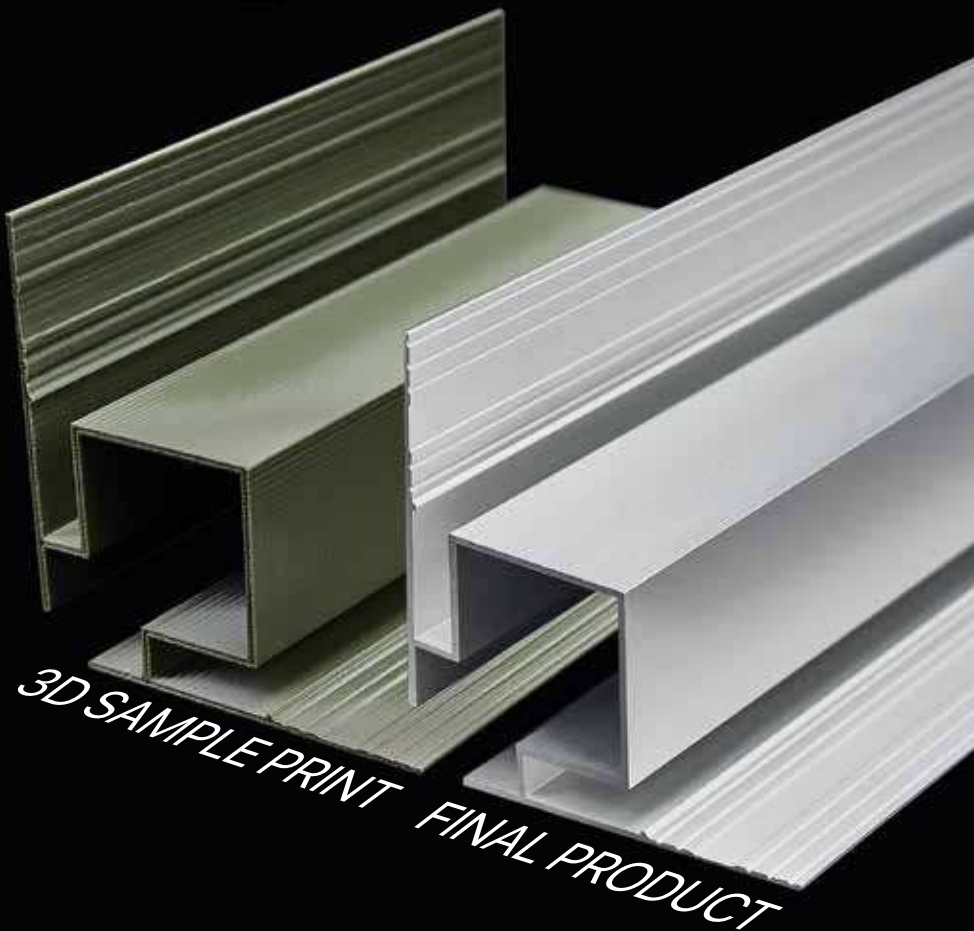
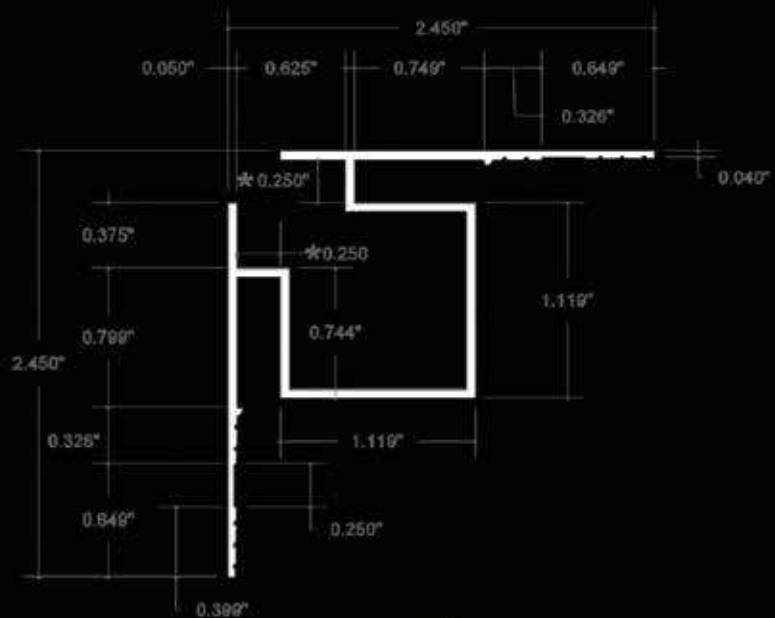

# ANODIZED FINISHES



CLEAR



CHAMPAGNE



LIGHT BRONZE



MEDIUM BRONZE



DARK BRONZE



BLACK



Colors shown are illustrated as accurately as printing methods will permit. Please utilize actual product samples for true color comparison. With all color processes there is an allowable variance tolerance that applies to painting and use of dissimilar substrate materials to which paint is applied.

XtremeInterior™ extruded profiles are provided standard with a primed finish using a proprietary primer suitable for field painting using most paint materials. Ideal application is with a direct-to-metal alkyd enamel. Consult your local paint manufacturers for best practice and proper paint selection and application. Custom color powder coating available upon request (minimum applies).

All anodized finishes are provided within an industry range of color consistency and can vary slightly from item to item. Special order anodized colors are subject to specific quantity minimums by item. Anodizing is an electrochemical conversion process that deposits an oxide film on the aluminum profile. A natural oxidation process occurs on all bare aluminum, however, producing the oxidation process artificially through anodizing creates a thicker, harder, and more durable oxide film which is an extremely durable finish resistant to most forms of airborne corrosion.

\*Metallic powdercoat available.





#### **GREEN BAY, WI**

551 Packerland Dr.

**1-920-499-2117**

Email:

woolfgb@woolfdistributing.com

Orders:

order-gb@woolfdistributing.com

#### **PEORIA, IL**

515 South Maxwell Rd.

**1-309-697-1760**

Email:

woolfpe@woolfdistributing.com

Orders:

order-pe@woolfdistributing.com

#### **WOODSTOCK, IL**

1625 West Lake Shore Dr.

woolf-ws@woolfdistributing.com

Building Materials: **1-815-477-9680**

order-ws@woolfdistributing.com

Millwork: **1-815-356-0438**

order-mw@woolfdistributing.com

Commercial: **1-815-527-9288**

commercialdoors@woolfdistributing.com