



FastenMaster[®] PRO Driven

2024 PRODUCT GUIDE



25 Years of PRO Driven Innovation



TimberLOK
1998



TrapEase
2000



LedgerLOK
2006



Cortex
2008



EVO
2023



Table of Contents

Deck & Trim Fastening

| | |
|--|----|
| Cortex® Hidden Fastening System for Decking | 7 |
| Cortex® Hidden Fastening System for Fascia | 9 |
| Cortex® Hidden Fastening System for PVC Trim | 11 |
| Tiger Claw® Hidden Fastening Systems for Grooved Decking | 13 |
| TrapEase® 3 Ultimate Deck Screw for PVC, Capstock and Composites | 15 |
| TrapEase® 3 Fascia Color Matched Fascia Fastener | 16 |
| GuardDog® Exterior Wood Deck Screw | 17 |
| EVO™ Deck Framing Connector | 19 |

Structural Fasteners

| | |
|--|----|
| TimberLOK® Structural Wood Screw. | 23 |
| HeadLOK® Structural Wood Screw | 25 |
| LedgerLOK® and LedgerLOK® Flat Head Structural Wood Screw | 27 |
| FastenMaster VersaLOK™ Structural Wood Screw | 29 |
| FlatLOK® Structural Wood Screw. | 31 |
| ThruLOK® Through-Bolt Replacement. | 33 |
| FastenMaster MVP™ Multipurpose Wood Screw | 35 |
| Lateral Tension System® Code-Compliant Lateral Deck Attachment | 37 |
| OlyLog® & LogHog® Log Home Fasteners | 39 |

Framing Systems

| | |
|---|----|
| FrameFAST™ Structural Fastening System | 43 |
| TrussBRACE™ Roof Truss Support | 45 |
| NLB Connector™ For Non-Load Bearing Wall to Truss Connections | 47 |
| PAMFast™ AutoFeed Fastening System | 49 |
| PAMFast™ AutoFeed Screws | 51 |

Products Ordering Information

| | |
|-----------|----|
| | 53 |
|-----------|----|

At FastenMaster, Everything We Do Is PRO Driven

FastenMaster is committed to supporting our professional contractors' businesses by developing innovative products and services. Our wide range of products, including those for residential decking, structural fastening, remodeling, and wood framing, offer unique benefits to remodelers, professional deck builders, residential framers, and home builders. In addition, our nationwide sales team regularly collaborates on the jobsite with PROs to gain a comprehensive understanding of their business practices and product needs. This hands-on approach enables us to develop products that save time, reduce installation cost, and build to a high level of craftsmanship.



Improving PROs' Businesses Through Craftsmanship

At FastenMaster we know that having the strongest and most secure connections isn't enough. What separates the best PRO contractors is their attention to detail and creative solutions to complex problems. Throughout our history we have brought game changing technologies to our PROs that have given them more flexibility to be creative and deliver premium solutions to their customers. Whether it's designing a dynamic outdoor living space with Cortex hidden plugs and Tiger Claw hidden clips or framing an architectural showpiece with FrameFAST, FastenMaster will always be working alongside our PROs on their most difficult and unique projects.



Photo courtesy of Elite Decks



Photo courtesy Casey Fence & Deck

Improving PROs' Businesses Through Innovation

For the last 25 years FastenMaster, a division of OMG Inc., has worked side-by-side with top PRO contractors as we've developed the most innovative structural, decking and framing fastening solutions in the industry. Our American-based engineering and manufacturing teams have enabled us to develop cutting-edge fastening solutions that reduce installed cost, increase structural integrity and reflect a pride in craftsmanship. That's why thousands of top builders have made FastenMaster their preferred product, providing them with the confidence they need to take on any project.

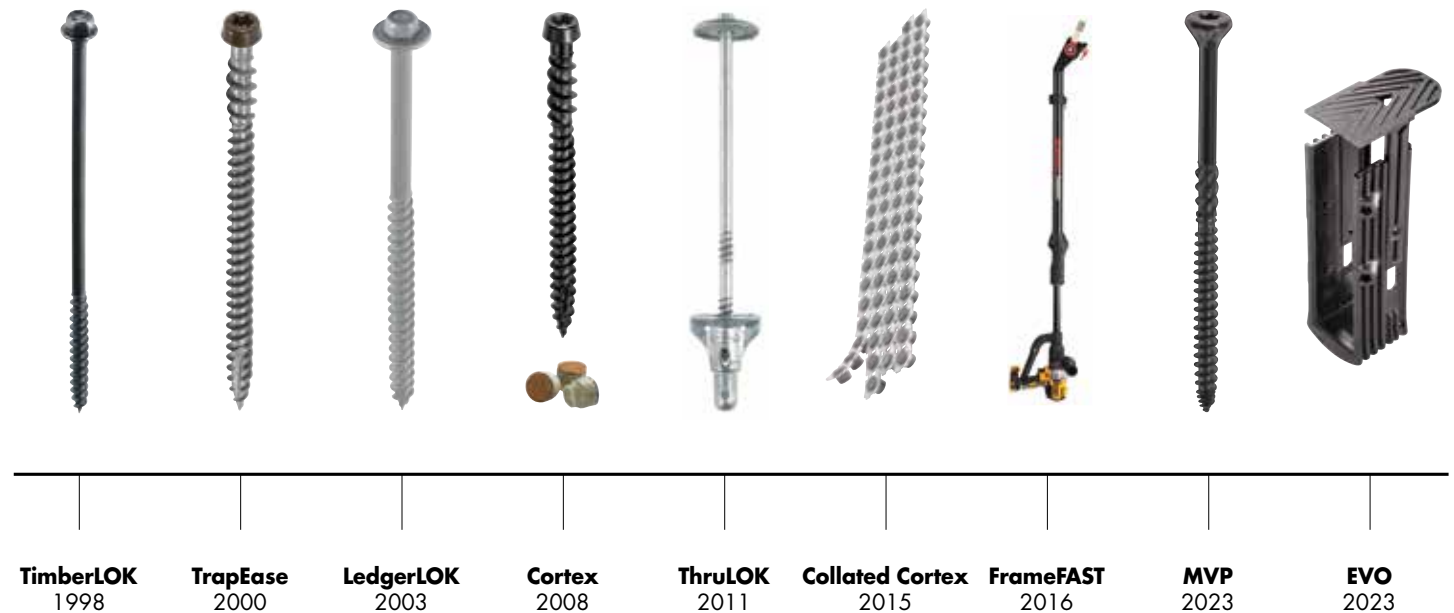

Improving PROs' Businesses Through American Manufacturing

Between our manufacturing facilities in Agawam, MA and Addison, IL, our logistics centers in Charlotte, NC and Glendale Heights, IL, and our nationwide sales organization, the entire team at FastenMaster is driven to improve our professional contractors' businesses. With over 650 team members specializing in everything from manufacturing and new product development to customer support and logistics, we have the knowledge and experience to deliver a uniquely American level of service and support. Whether you have a question for our technical team, are placing an order with our inside sales team, or training with your local sales representative, we are ready to provide the best experiences in the industry.



Deck & Trim Fastening

From strong substructures to a stunning finish, decking solutions that save time and deliver long-term results.

- 
- 2000: The newly created composite decking industry ran into problems using traditional fasteners which would “mushroom” and damage the boards. We created the first fastener designed specifically for composite decking: TrapEase
- 2004: We developed GuardDog, the first exterior wood screw designed specifically to address the newer, more aggressive chemicals in pressure treated wood.
- 2006: The Tiger Claw TC-G Hidden Deck Clip launched as the industry’s first stainless steel hidden decking clip for grooved boards, bringing long-lasting quality and a nearly invisible finish.
- 2008: We created the first “through board” hidden fastening system with the introduction of Cortex plugs and screws, a game-changing innovation that gives PROs the ability to hide screws on a variety of applications including composite decking and PVC Trim. When combined with Tiger Claw TC-G, PROs could for the first time hide all the screws on the surface of a decking project.

Elevate Your Decking Craftsmanship

FastenMaster has spent decades listening to top PRO contractors as we've developed the most comprehensive deck and trim fastening solutions in the industry. We understand that craftsmanship requires the need to deliver superior quality with a flawless finished look. That's why thousands of premiere deck builders have made FastenMaster their preferred choice for delivering strong substructures with a stunning finish.

Cortex® Hidden Fastening System for Decking and Fascia 7

- Now with pre-aligned grain plugs on collated strips
- Plugs made from deck or fascia board for perfect match
- TORX® ttap® drive system
- Decking Screw Length: 2-1/2",
- Fascia Screw Length: 1-3/4"
- Steel Framing: 1-5/8"

Cortex® Hidden Fastening System for PVC Trim 11

- Collated strips install 50% faster
- TORX® ttap® drive system
- Lengths: 2", 2-3/4"

Tiger Claw® TC-G® Hidden Fastening Systems for Grooved Decking 13

- Quick and easy installation
- Universal compatibility with grooved decking
- Stainless steel for superior durability
- Works with the Tiger Claw Pneumatic Installation Gun for even fastener installation

TrapEase® 3 Ultimate Composite Deck and Fascia Fastener 15

- Heads painted to match most popular board colors
- TORX® ttap® drive system
- Fascia fasteners engineered for fascia expansion/contraction
- Deck Screw Lengths: 2-1/2", 3"
- Fascia Screw Length: 1-3/4"

GuardDog® Exterior Wood Deck Screw 17

- Guaranteed corrosion resistance
- UV resistant to fading and chalking
- TORX® ttap® drive system
- Lengths: 1-5/8", 2", 2-1/2", 3", 3-1/2"

EVO™ Deck Framing Connector 19

- Tabs align joist to ledger in seconds, eliminating the need to tack joist in place
- Made from a reinforced engineered polymer which is stronger than steel, as well as rust, temperature & UV resistant
- Guaranteed to last for the life of the project





Close up of pre-aligned grain plug



Cortex®

Hidden Fastening System For Decking

Features:

- Collated on strips with pre-aligned grain for faster and more precise installation
- Plugs made from specific deck boards for a perfect match
- Approved for treated wood framing
- Strip-out resistant #20 TORX® tTap® drive system

Packaging Quantities (Collated):

100 LF (224 screws, 240 plugs, 2 set. tools)
300 SF (1050 screws, 1200 plugs, 6 set. tools)

Length: 2-1/2"

Description:

The Cortex Hidden Fastening System is the fastest, easiest way to hide the heads of your deck screws across the entire deck, first and last board, perimeter, and stairs. Cortex plugs are made from the same material as market-leading deck boards.

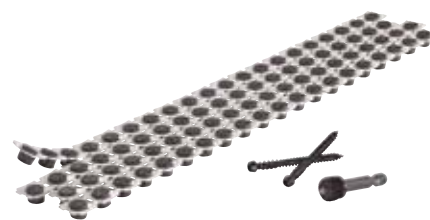

Complete Hidden Fastening System:

Combine the versatility of Cortex for first board, last board, perimeter boards and stairs with the speed and ease of the Tiger Claw TC-G Clip for the field of the deck to get a beautiful fastener-free surface.

ProjectLife™ Coating:

The performance and corrosion protection of Cortex is guaranteed for the life of the project.

| Cortex for Trex Deck Selection Guide | | | | |
|---|-----------------|--|----------|--------------------|
| Screw Material | Board Type | Packaging Quantity | Coverage | SKU |
| Carbon Steel | Trex Enhance® | 224 screws, 240 plugs, 2 setting tools | 100 LF | FMCTXCL-TX1LFEN** |
| | Trex Select® | | | FMCTXCL-TX1LFSL** |
| | Trex Transcend® | | | FMCTXCL-TX1LFTS** |
| | Trex Signature® | | | FMCTXCL-TX1LFSG** |
| | Trex Select® | 1050 screws, 1200 plugs, 6 setting tools | 300 SF | FMCTXCL-TX300SL** |
| | Trex Transcend® | | | FMCTXCL-TX300TS** |
| | Trex Signature® | | | FMCTXCL-TX300SG** |
|  316 Marine Grade Stainless Steel | Trex Select® | 224 SS screws, 240 plugs, 2 setting tools | 100 LF | FMCTXCL-TX1LSL**SS |
| | Trex Transcend® | | | FMCTXCL-TX1LTS**SS |



**Selecting SKU/Board Color

When ordering, please combine SKU column with board manufacturer color key.

Example: Cortex 300 SF for Trex Select Pebble = FMCTXCL-TX300SLPB

Colors Available

Trex Transcend®



Island Mist TSLM Lava Rock TSLR Rope Swing TSRS Spiced Rum TSSR Tiki Torch TSTT



Havana Gold TSHG Biscayne TSBC Rainier TSRN Carmel TSCM Jasper TSJP

Trex Select®



Pebble SLPB Saddle SLSD

Trex Enhance®



Foggy Wharf ENFW Toasted Sand ENTS Coastal Bluff ENCB Rocky Harbor ENRH



Beach Dune ENBD Clamshell ENCS Saddle ENSD

Trex Signature®



Ocracoke SGCK Whidbey SGWD



See replacement plug information on page 56



Scan to find
your match

FastenMaster offers perfectly matched Cortex Plugs for AZEK®, Fiberon®, Trex®, TimberTech® and other major board manufacturers. Plugs are made directly from the deck boards to ensure a perfect match every time! To view a complete list of board and color offerings, visit page 54 or scan the code above.



316 Marine Grade Stainless Steel Screws

Cortex Deck Collated Plugs are also available with 316 Marine Grade Stainless Steel screws for certain brands and boards for coastal and waterfront applications.





Cortex® FASCIA

Hidden Fastening System

Features:

- Engineered for fascia expansion/contraction
- Plugs made from fascia board
- Strip-out resistant #20 TORX® tTap® drive system
- Perfect color match

Packaging Quantities:

50 LF (100 screws, 105 plugs,
1 counterbore tool and 1 setting tool)

Length: 1-3/4"



Description:

The Cortex for Fascia Hidden Fastening System is the fastest, easiest way to hide the heads of your screws when installing fascia or stair risers. Cortex for Fascia is engineered for fascia expansion/contraction and the plugs are made from Trex fascia boards making for a perfect color match. The unique stepped counterbore tool creates a hole for movement of the fascia and a second hole for the perfect plug fit.

ProjectLife™ Coating:

The performance and corrosion protection of Cortex Fascia is guaranteed for the life of the project. Cortex Fascia is not recommended for use in saltwater applications.

| Cortex for Trex Fascia Selection Guide | | | | |
|--|-----------------|--|----------|-----------------|
| Length | Board Type | Packaging Quantity | Coverage | SKU |
| 1-3/4" | Trex Enhance® | 100 screws, 105 plugs, 1 counterbore tool, 1 setting tool | 50 LF | FMCTXF-TX50EN** |
| | Trex Select® | | | FMCTXF-TX50SL** |
| | Trex Transcend® | | | FMCTXF-TX50TS** |

**Selecting SKU/Board Color

When ordering, please combine SKU column with board manufacturer color key.

Example: Trex Transcend, 50 LF for Rope Swing = FMCTXF-TX50TSRS

Colors Available

Trex Transcend®



Trex Enhance®



Trex Select®



Cortex® Driller

Hidden Fastening System For Steel Framing

Description:

The Cortex Driller Hidden Fastening System is the easiest way to hide screw heads on deck boards used on steel deck framing.

Features:

- 410 stainless steel screws
- Compatible with 14 – 18 gauge steel framing
- Guaranteed corrosion resistance

Packaging Quantities:

100 LF (224 screws, 2 setting tools)

Length: 1-5/8" stainless steel



| Cortex Driller Product Offerings | | |
|----------------------------------|----------|----------------|
| Packaging Quantity | Coverage | SKU |
| 224 screws, 2 setting tools | 100 LF | FMCTXD-TX1LFNP |

Ordering Information:

When ordering, include your color of decking and we will add plugs at no additional cost.



Close up of pre-aligned grain plug



Cortex®

Hidden Fastening System For PVC Trim

Features:

- Installs 50% faster with collated plugs
- Strip-out resistant #20 TORX® ttap® drive system
- Dual Lead Fastener Thread installs 50% faster than traditional trim fasteners

Lengths: 2", 2-3/4"

Packaging Quantities: (Loose Plugs)

50 LF (75 screws, 100 plugs, 1 set. tool)
250 LF (375 screws, 400 plugs, 3 set. tools)
750 LF (1125 screws, 1200 plugs, 6 set. tools)

Packaging Quantities: (Collated Plugs)

250 LF (375 screws, 400 plugs, 3 set. tools)
750 LF (1125 screws, 1200 plugs, 6 set. tools)

Description:

The FastenMaster Cortex Hidden Fastening System is the fastest, easiest way to hide fastener heads when installing PVC Trim. The finished look of Cortex is virtually invisible.

ProjectLife™ Coating:

The performance and corrosion protection of Cortex Trim is guaranteed for the life of the project. Cortex Trim is not recommended for use in saltwater applications.

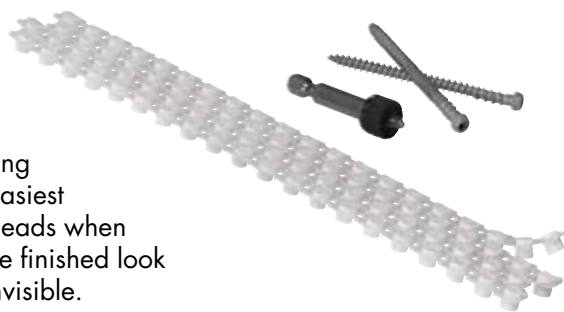

| Cortex Trim Selection Guide | | | | | | | | |
|--|----------------------------------|---|----------------|------------------|-------------------|---------------------|---|---|
| | | | 2" Fastener | | 2-3/4" Fastener | | | |
| Board | Color | Coverage | Loose Plugs | Collated Plugs | Loose Plugs | Collated Plugs | | |
| Versatex | SM = Smooth TR = Timber Ridge | 50 LF | FMCTXT-VT50** | N/A | FMCTXT234-VT50** | N/A | | |
| | | 250 LF | FMCTXT-VT250** | FMCTXTCL-VT250** | FMCTXT234-VT250** | FMCTXTCL234-VT2** | | |
| | | 750 LF | FMCTXT-VT750** | FMCTXTCL-VT750** | FMCTXT234-VT750** | FMCTXTCL234-VT7** | | |
| Royal | SM = Smooth GN = Grain | 50 LF | FMCTXT-RY50** | N/A | FMCTXT234-RY50** | N/A | | |
| | | 250 LF | FMCTXT-RY250** | FMCTXTCL-RY250** | FMCTXT234-RY250** | FMCTXTCL234-RY250** | | |
| | | 750 LF | FMCTXT-RY750** | FMCTXTCL-RY750** | FMCTXT234-RY750** | FMCTXTCL234-RY750** | | |
| Royal Select | | 250 LF | N/A | N/A | N/A | FMCTXTCL234-C2** | | |
| | | FT = Frost LT = Latte WR = Wrought Iron | | | | | CN = Chestnut NA = Oceana PB = Pine Brook | GV = Grove WL = Willow SL = Shale |
| Koma® | SM = Smooth Celuka | 50 LF | FMCTXT-KM50SM | N/A | N/A | N/A | | |
| | | 250 LF | FMCTXT-KM250SM | N/A | N/A | N/A | | |
| | | 750 LF | FMCTXT-KM750SM | N/A | N/A | N/A | | |
| Cortex #20 TORX® Itap® driver bits (2 Pack of Setting Tools) | | | | | | FMCTXSETTOOL3-2PK | | |

**Selecting SKU/Board Color

When ordering, please combine SKU column with board manufacturer color key.

Example: Cortex 250 LF fastener length 2-3/4" for Versatex Smooth = FMCTXT234-VT250SM



| Cortex Trim Replacement Plugs Selection Guide | | | |
|---|-------------|---------------------------------|-------------------|
| Board | Type | Description | SKU |
| Versatex® | Smooth | 40pc collated replacement plugs | FMCTXTQUAD-VT40SM |
| | TimberRidge | | FMCTXTQUAD-VT40TR |
| Royal | Smooth | 40pc collated replacement plugs | FMCTXTQUAD-RY40SM |
| | Grain | | FMCTXTQUAD-RY40GN |

New board colors are always being added to the Cortex product line. If the board color you are looking for is not listed on this page, consult our website for recent updates or call FastenMaster customer service.

FastenMaster offers perfectly matched Cortex Plugs for the leading Trim Manufacturers including: AZEK®, CertainTeed®, KLEER®, Modern·Mill, Royal®, Versatex®, Wolf®. Plugs are made directly from the trim boards to ensure a perfect match every time!

See replacement plug information on page 56



Tiger Claw®
Hidden Deck Fasteners

TC-G® and Installation Tools

Hidden Fastening Systems for Grooved Decking

Features:

- Automatically gaps decking
- Quick and easy installation
- Clean, fastener-free appearance
- Stainless steel for superior durability and ultimate corrosion resistance
- Strong connection between decking and joists

Packaging Quantities:

50 SF bag with hand driven screws
(90 clips per bag) plus screws

500 SF bucket for use with pneumatic gun
(900 clips per bucket)

Description:

This stainless steel hidden fastening system is designed to be universally compatible with all grooved decking boards. Delivers fast and easy installation, resulting in smooth, fastener-free outdoor living spaces.

Complete Hidden Fastening:

Combine the versatility of Cortex for first/last board, perimeter boards and stairs with Tiger Claw TC-G® for the field of the deck to get a beautiful fastener-free surface.



The performance and corrosion protection of TC-G is guaranteed for the life of the project. TC-G is not recommended for use in saltwater applications.

*Coverage based on 16" o.c. joist spacing 100 SF

The Tiger Claw Installation Gun is a semi-automatic installation tool that greatly increases the installation speed of TC-G clips. This tool can also be used with TimberTech® CONCEALoc™, Cali Bamboo®, Clubhouse™ and ConnectClip™ fasteners.

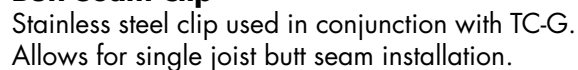
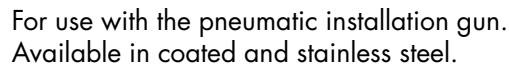

*For use with Tiger Claw Pneumatic Installation Gun





TrapEase® 3

Ultimate Deck Screw for PVC, Capstock & Composites

Features:

- For PVC, capstock and composite decking
- Strip-out resistant #20 TORX® ttap® drive system
- Head painted to match board
- Corrosion and fade resistant
- Spotter™ Installation Guide creates consistent board gapping and fastener placement (available only on 350pc bucket)

Lengths: 2-1/2", 3"

Packaging Quantities:

75pc box, 350pc bucket, 1,050pc bucket

Description:

TrapEase® 3 is the only fastener guaranteed to deliver an ultimate finished look in PVC, Capstock, and Composite decking. The TORX® ttap® drive system offers stick-fit and wobble-free installation, virtually eliminating fastener stripping during installation or removal. TrapEase 3 features a UV resistant head paint that will not fade for the life of the project – guaranteed.

ProjectLife™ Coating:

The performance and corrosion protection of TrapEase 3 is guaranteed for the life of the project. TrapEase 3 is not recommended for use in saltwater applications.



| TrapEase 3 Product Offerings | | | | |
|---|--|---------------|----------|--------------------|
| Length | Board Type | Quantity | Coverage | SKU |
| 2-1/2" | Enhance® EN Select® SL Transcend® TS | 75pc box | 20 SF | FMTR3-212-75**** |
| | | 350pc bucket | 100 SF | FMTR3-212-350**** |
| | | 1050pc bucket | 300 SF | FMTR3-212-1050**** |
| 3" only available in: MD, PB, SD, WB | | 350pc bucket | 100 SF | FMTR3-003-350**** |
| | | 1050pc bucket | 300 SF | FMTR3-003-1050**** |
| TrapEase 3 #20 TORX® Itap® Driver Bits (2 PK) | | | | FMTTAPT20BIT-2PK |



**Selecting SKU/Board Color

When ordering, combine SKU column with board mfg. color key.

Example: Trex Transcend 2-1/2", 350pc Tiki Torch = FMTR3-212-350TSTT



Scan to find
your match

FastenMaster offers color matched screws for many of the industry leading board manufacturers. See a complete listing of color offerings on page 54 or scan the code above.

TrapEase® FASCIA

Color Matched Fascia Fastener



Features:

- Engineered for fascia expansion and contraction
- Head painted to color match fascia board
- Strip-out resistant #20 TORX® tTap® drive system
- Corrosion and fade resistant

Length: 1-3/4"

Packaging Quantity:

Complete with 200 screws, 1 counterbore tool, and 1 driver bit

Description:

The strongest, fastest way to attach composite fascia. Designed to allow for Fascia board expansion and contraction, delivering beautiful finished look.



| TrapEase FASCIA Selection Guide | | | |
|---------------------------------|---|----------|-------------|
| Screw Length | Packaging Qty | Coverage | SKU |
| 1-3/4" | 200 Screws, 1 Counterbore Tool, 1 Driver Bit | 100 LF | FMTRF-1LF** |

**Selecting SKU/Board Color

When ordering, combine SKU column with board mfg. color key.

Example: Trex Transcend, Rope Swing = FMTRF-1LFRS





GuardDog®

Exterior Wood Screw

Features:

- TORX® ttap® Drive System delivers stick fit, wobble free installation
- Sharp Type 17 Point for quick installation
- UV Resistant to fading or chalking
- Guaranteed Corrosion resistance for the life of the project
- Nibs under the head deliver a clean finished look

Lengths: 1-5/8", 2", 2-1/2", 3", 3-1/2"

Packaging Quantities:

75pc box, 350pc box, 1,750pc bucket, 1,350pc bucket (3-1/2" only)

Description:

GuardDog® is a versatile exterior wood screw used for a variety of applications including pressure treated decking, railings, deck framing and more.

TORX® ttap® Drive System

The TORX® ttap® drive system offers unmatched stick-fit and wobble-free installation, eliminating fastener stripping during installation or removal.



| GuardDog Selection Guide | | | |
|--|----------------|----------|-----------------|
| Screw Length | Packaging Qty | Coverage | SKU |
| 1-5/8" | 75pc box | 20 SF | FMGD158-75 |
| | 350pc box | 100 SF | FMGD158-350 |
| | 1,750pc bucket | 500 SF | FMGD158-1750 |
| 2" | 75pc box | 20 SF | FMGD002-75 |
| | 350pc box | 100 SF | FMGD002-350 |
| | 1,750pc bucket | 500 SF | FMGD002-1750 |
| 2-1/2" | 75pc box | 20 SF | FMGD212-75 |
| | 350pc box | 100 SF | FMGD212-350 |
| | 1,750pc bucket | 500 SF | FMGD212-1750 |
| 3" | 75pc box | 20 SF | FMGD003-75 |
| | 350pc box | 100 SF | FMGD003-350 |
| | 1,750pc bucket | 500 SF | FMGD003-1750 |
| 3-1/2" | 75pc box | 20 SF | FMGD312-75 |
| | 350pc box | 100 SF | FMGD312-350 |
| | 1,350pc bucket | 350 SF | FMGD312-1350 |
| Driver bit for GuardDog w/ TORX ttap drive system (2 included) | | | FMGDDTAPT25-2PK |



Guaranteed Corrosion Resistance:

The performance and corrosion protection of GuardDog is guaranteed for the life of the project. Approved for use in exterior applications including treated wood (ACQ, MCA, MCQ, CAB) and acidic woods like cedar and redwood. GuardDog is not recommended for use in saltwater applications.

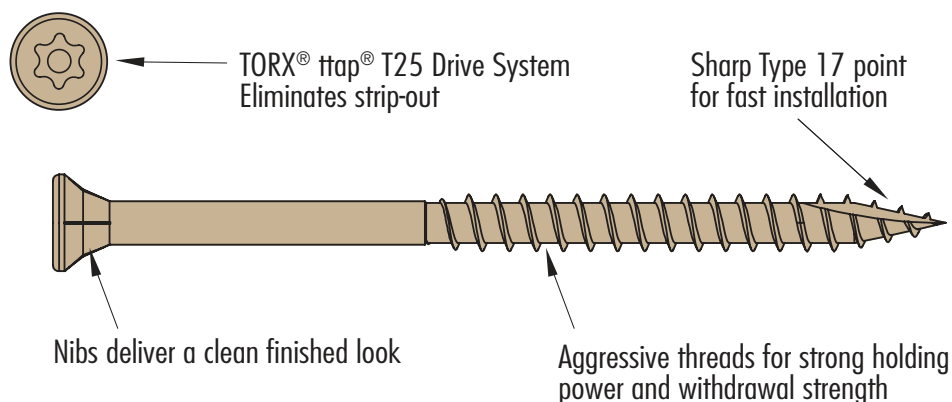



EVO[®] Joist to Ledger[™]

Deck Framing Connector



Time Saving Design

Tabs align joist to ledger in seconds.
Eliminates the need to tack joist in place.



Professional Exterior Grade

Won't rust. Temperature and UV Resistant.



Reinforced Engineered Polymer

Stronger than traditional steel connectors.
Guaranteed for life of project.



Code-Compliant

Meets IRC requirements for deck joist hangers.
Supported by ICC-ES Evaluation Report (ESR-4711).



| EVO Selection Guide | | |
|---------------------|---|------------------|
| Packaging | Contents | SKU |
| Bulk Box | (16) Connectors, (64) 5" Screws, (34) Set Screws and (1) Hex Driver Bit | FMEVODJH810-16 |
| Single Unit | (1) Connector, (4) 5" Screws and (2) Set Screws | FMEVODJH810-INDY |

The Evolution of Deck Framing:

The FastenMaster EVO Joist to Ledger Deck Framing Connector is a faster, easier, code-compliant method for attaching 2x8 or 2x10 pressure treated deck joists to a ledger board.

Stronger, More Durable Connection:

The toe-nailed structural screws and robust design combine to create a tight bond between the deck and house frame, allowing the EVO Connector to meet the highest loads and longest spans shown in the IRC for exterior decks. An ICC-ES Evaluation Report (ESR-4711) showing these loads can be found at FastenMaster.com.

ProjectLife™ Guaranteed:

The performance and corrosion resistance of EVO Deck Joist Connectors are guaranteed for the life of the project when used in accordance with the installation instructions and supporting technical literature.



**Scan to watch
an EVO video**

Installation Process:

1. Cinch the connector to the 2x8 or 2x10 joist until the connector is snug around the joist.
2. Install the provided (2) 3/4" Set Screws into the left and right holes.
3. Place the joist into position on the deck ledger. EVO automatically aligns the top of the joist to the ledger.
4. Install provided (4) Structural Screws into the four holes.



Be sure to follow all instructions and warnings when installing EVO Joist to Ledger Connectors.

Structural Fasteners

The industry-leading LOK Line replaces traditional lag screws while meeting code and lowering cost.

1998: FastenMaster created the category of structural wood-to-wood screws with the introduction of TimberLOK.

2003: FastenMaster launched LedgerLOK, the first fastener specifically designed to replace 1/2" lag screws, without predrilling, when attaching a ledger board to a rim joist of a house. It was also the very first structural screw to gain code compliance under the newly adopted ICC-ES criteria.

2004: We launched TrussLOK (later replaced by FlatLOK in 2015) the first fastener to connect multiple beams of LVL single sided up to 4 -ply.

2007: Taking the most loved elements of the best-selling TimberLOK, we created the industry's first flat headed structural fastener to meet code: HeadLOK.

2011: ThruLOK was the first fastener to replace carriage and through-bolts without predrilling. ThruLOK makes the connection 5X faster and eliminates multiple tools on the job to install.

We Invented The Structural Wood Screw. We Didn't Stop There.

In the two decades since FastenMaster created the structural wood screw category with TimberLOK, we have continued to lead the industry by providing innovative, application-specific fasteners that meet building code and help PROs finish jobs faster. It is our mission to improve our PRO contractors' businesses with code-compliant products by actively participating at their jobsites, understanding their problems, and developing products that deliver job-specific results.

| | |
|---|----|
| TimberLOK® Structural Wood Screw | 23 |
| • Replaces 3/8" lag screws · Hex head drive | |
| • Lengths: 2-7/8", 4-1/2", 6", 8", 10" | |
| HeadLOK® Structural Wood Screw | 25 |
| • Replaces 3/8" lag screws · Flat head with SpiderDrive | |
| • Standard Lengths: 2-7/8", 4-1/2", 6", 8", 10" | |
| LedgerLOK® and LedgerLOK® FlatHead Structural Wood Screw | 27 |
| • Replaces 1/2" lag screws · Hex head or TORX® ttap® drive system | |
| • Lengths: 3-5/8", 5" | |
| FastenMaster VersaLOK™ Structural Wood Screw | 29 |
| • Replaces 1/2" lag screws · TORX® ttap® drive system | |
| • Lengths: 6", 8", 10" | |
| FlatLOK® Structural Wood Screw | 31 |
| • Replaces 1/2" lag screws · TORX® ttap® drive system | |
| • Lengths: 2-7/8", 3-1/2", 4", 4-1/2", 5", 6", 6-3/4" | |
| ThruLOK® Through-Bolt Replacement | 33 |
| • Replaces 1/2" carriage or through-bolts | |
| • Lengths: 6-1/4", 7", 8", 9-1/2" | |
| FastenMaster MVP™ Multipurpose Wood Screw | 35 |
| • TORX® ttap® drive system · ProjectLife™ Coating · SureStart™ Point | |
| • Lengths: 1-1/2", 2", 2-1/2", 3", 3-1/2", 4" | |
| Lateral Tension System® Lateral Deck Attachment | 37 |
| OlyLog® & LogHog® Log Home Structural Wood Screws | 39 |





TimberLOK®

Structural Wood Screw



Features:

- No predrilling
- Faster and easier than 3/8" lag screws
- Countersinking head style
- ProjectLife Guaranteed
- Approved in treated wood
- Code-Compliant Evaluation Report ICC-ES ESR-1078

Lengths: 2-1/2", 4", 6", 8", 10"

Packaging Quantities:

Single fastener, 12pc clamshell, 50pc box, 250pc bucket, 500pc bucket (2-1/2" only)

Description:

TimberLOK is a heavy duty wood screw suitable for a wide variety of structural wood-to-wood applications such as headers, stair stringers, fences and more. TimberLOK requires no predrilling and is faster and easier than traditional lag screws.

Meet Code. Lower Cost.

TimberLOK is used by professional contractors nationwide to meet code and lower costs. *Meet Code:* Tested and proven to meet the most recent IRC/IBC requirements. *Lower Cost:* Requires no predrilling, saving time and labor.



| TimberLOK Selection Guide | | | |
|---------------------------|--|-----------------|----------------|
| Length | Typical Applications | Packaging Qty | SKU |
| 2-1/2" | Doubling/sistering up 2x header or carrying beams | Single fastener | FMTLOK212-INDY |
| | | 12pc clamshell | FMTLOK212-12 |
| | | 50pc box | FMTLOK212-50 |
| | | 500pc bucket | FMTLOK212-500 |
| 4" | Attaching 2x to 4x structures - fencing | Single fastener | FMTLOK04-INDY |
| | | 12pc clamshell | FMTLOK04-12 |
| | | 50pc box | FMTLOK04-50 |
| | | 250pc bucket | FMTLOK04-250 |
| 6" | Replacing hurricane ties on rafters or trusses. Joining multiple 4x timbers | Single fastener | FMTLOK06-INDY |
| | | 12pc clamshell | FMTLOK06-12 |
| | | 50pc box | FMTLOK06-50 |
| | | 250pc bucket | FMTLOK06-250 |
| 8" | Building up 6x landscape walls | Single fastener | FMTLOK08-INDY |
| | | 12pc clamshell | FMTLOK08-12 |
| | | 50pc box | FMTLOK08-50A |
| | | 250pc bucket | FMTLOK08-250 |
| 10" | Post and Beam construction | Single fastener | FMTLOK10-INDY |
| | | 12pc clamshell | FMTLOK10-12 |
| | | 50pc box | FMTLOK10-50A |
| | | 250pc box | FMTLOK10-250 |



Installation Procedure:

TimberLOK should be installed using an impact driver or quality grade cordless drill (18V or greater). Choose the proper length so that threads fully engage the second piece. Bring washer head flush to wood surface or countersink head flush.

ProjectLife™ Guaranteed:

The performance and corrosion protection of TimberLOK is guaranteed for the life of the project. TimberLOK is not recommended for use in saltwater applications.

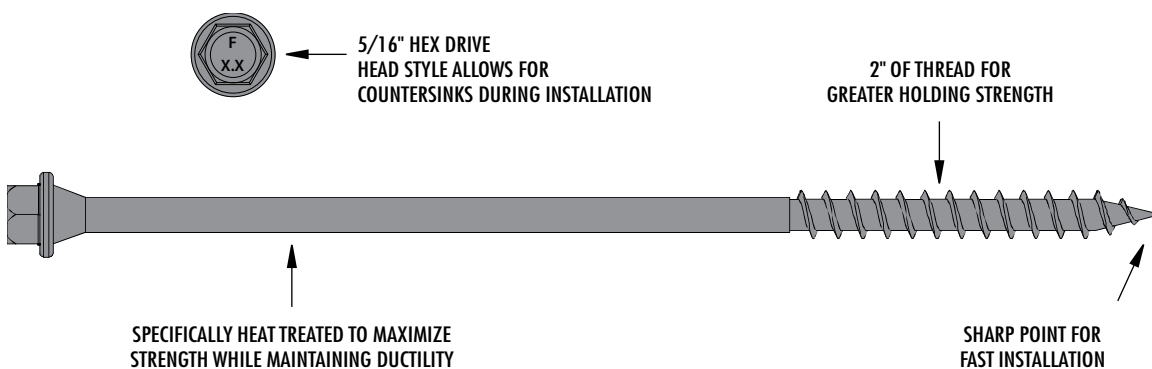



HeadLOK® Structural Wood Screw



Features

- No predrilling
- Faster, easier than 3/8" lag screws
- Non-countersinking head style
- ProjectLife Coating
- Approved for treated wood
- Code-Compliant Evaluation Report ICC-ES ESR-1078

Lengths: 2-7/8", 4-1/2", 6", 8", 10"
additional sizes also available

Packaging Quantities:

Single fastener, 12pc clamshell, 50pc box,
250pc bucket, 500pc bucket (2-7/8" only)

Description

HeadLOK is a heavy duty wood screw that does it all with an internal drive and flat head. HeadLOK offers higher design shear than 3/8" lag screws and no predrilling is needed! HeadLOK zips right in and is ideal for many wood-to-wood applications including decks, fences, SIPs, kitchen cabinets and more. The patented SpiderDrive® eliminates cam-out and improves installation speed.

Meet Code. Lower Cost.

HeadLOK is used by professional contractors nationwide to meet code and lower costs. *Meet Code:* Tested and proven to meet the most recent IRC/IBC requirements. *Lower Cost:* Requires no predrilling, saving time and labor.



| HeadLOK Standard Selection Guide | | |
|----------------------------------|-----------------|----------------|
| Length | Packaging Qty | SKU |
| 2-7/8" | Single fastener | FMHLGM278-INDY |
| | 12pc clamshell | FMHLGM278-12 |
| | 50pc box | FMHLGM278-50 |
| | 500pc bucket | FMHLGM278-500 |
| 4-1/2" | Single fastener | FMHLGM412-INDY |
| | 12pc clamshell | FMHLGM412-12 |
| | 50pc box | FMHLGM412-50 |
| | 250pc bucket | FMHLGM412-250 |
| 6" | Single fastener | FMHLGM006-INDY |
| | 12pc clamshell | FMHLGM006-12 |
| | 50pc box | FMHLGM006-50 |
| | 250pc bucket | FMHLGM006-250 |
| 8" | Single fastener | FMHLGM008-INDY |
| | 12pc clamshell | FMHLGM008-12 |
| | 50pc box | FMHLGM008-50 |
| | 250pc bucket | FMHLGM008-250 |
| 10" | Single fastener | FMHLGM010-INDY |
| | 12pc clamshell | FMHLGM010-12 |
| | 50pc box | FMHLGM010-50 |
| | 250pc bucket | FMHLGM010-250 |

| Additional Length Selection Guide | | |
|-----------------------------------|---------------|---------------|
| Length | Packaging Qty | SKU |
| 3-3/4" | 50pc bucket | FMHLGM334-50 |
| | 250pc bucket | FMHLGM334-250 |
| 5" | 250pc bucket | FMHLGM005-250 |
| 7" | 250pc bucket | FMHLGM007-250 |
| 8" | 250pc bucket | FMHLGM008-250 |
| 9" | 250pc bucket | FMHLGM009-250 |
| 10" | 250pc bucket | FMHLGM010-250 |
| 11" | 250pc bucket | FMHLGM011-250 |
| 12" | 250pc bucket | FMHLGM012-250 |
| 13" | 250pc bucket | FMHLGM013-250 |
| 14" | 250pc bucket | FMHLGM014-250 |

| HeadLOK Bits | |
|------------------------|---------------|
| 2 Spider Bits per card | FMSPIDER3-2PK |

ProjectLife™ Coating:

The performance and corrosion protection of HeadLOK is guaranteed for the life of the project. HeadLOK is not recommended for use in saltwater applications.

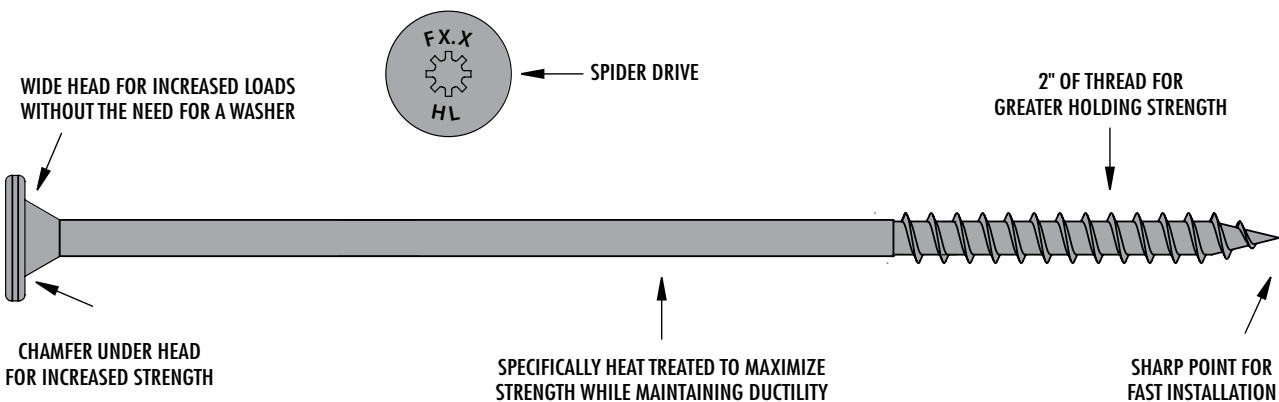



FLAT HEAD STYLE



HEX HEAD STYLE



LedgerLOK®

Structural Wood Screw

Features:

- No predrilling
- Replaces traditional 1/2" lag screws
- Hex washer head style on LedgerLOK
- TORX® ttap® Drive System on Flat Head style
- ProjectLife Coating
- Approved for treated wood
- Code-Compliant Evaluation Report ICC-ES ESR-1078

Lengths: 3-5/8", 5"

Packaging Quantities:

Single fastener, 12pc clamshell, 50pc box, 250pc bucket



Description:

LedgerLOKs are the first wood screws engineered to fasten a deck ledger board to the rim joist of a house with no predrilling. The hex-head version allows for greater bit engagement, reducing cam-out. The flat head version, with TORX® ttap® drive system, provides flush to ledger installation saving time and money.

Meet Code. Lower Cost.

LedgerLOKs are used by professional contractors nationwide to meet code and lower costs for making deck ledger connections. *Meet Code:* Tested and proven to meet the most recent IRC/IBC requirements for deck ledger to rim joist connection. *Lower Cost:* Requires no predrilling, saving time and labor.



| LedgerLOK Selection Guide | | | |
|---------------------------|-----------------|---------------|---------------|
| Length | Packaging Qty | Hex Style SKU | Flat Head SKU |
| 3-5/8" | Single Fastener | FMLL358-INDY | FMLLF358-INDY |
| | 12pc clamshell | FMLL358-12 | FMLLF358-12 |
| | 50pc box | FMLL358-50 | FMLLF358-50 |
| | 250pc bucket | FMLL358B-250 | FMLLF358B-250 |
| 5" | Single Fastener | FMLL005-INDY | FMLLF005-INDY |
| | 12pc clamshell | FMLL005-12 | FMLLF005-12 |
| | 50pc box | FMLL005-50 | FMLLF005-50 |
| | 250pc bucket | FMLL005B-250 | FMLLF005B-250 |



Installation Procedure:

LedgerLOKs should be installed using an Impact driver or a high torque 1/2" variable speed drill. Choose the proper length so that threads fully engage the main member (i.e., rim joist). Bring washer flush to side member with hex head style, do not countersink. Bring head flush with ledger using the flat head style. *Not for use in masonry or concrete.*

For detailed installation instructions, including fastening requirements, please refer to our *Deck Ledger to Rim Joist technical bulletin*. These instructions are included in all box and bucket packaging as well as being available for download from our website. When using in non-ledger applications, a design professional should be consulted for all critical connections, which include the number and location of all fasteners to meet national and local code requirements.

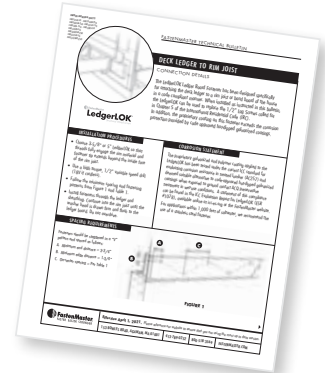

ProjectLife™ Coating:

The performance and corrosion protection of LedgerLOK is guaranteed for the life of the project. LedgerLOK is not recommended for use in saltwater applications.

Flat Head Style

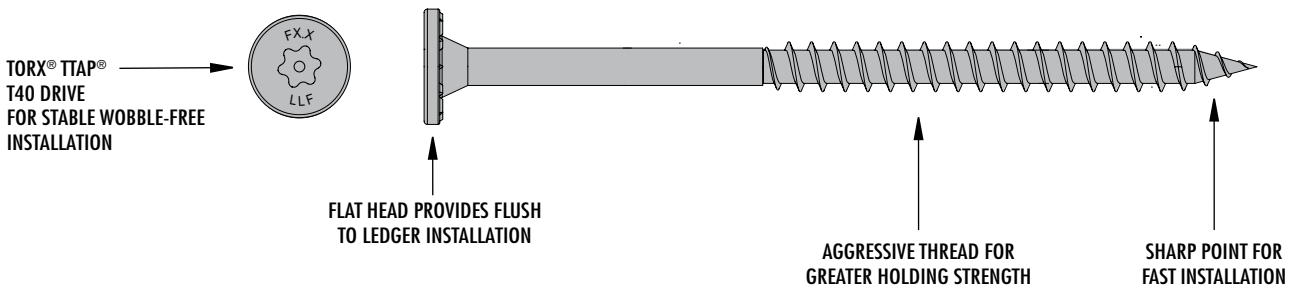

Hex Head Style

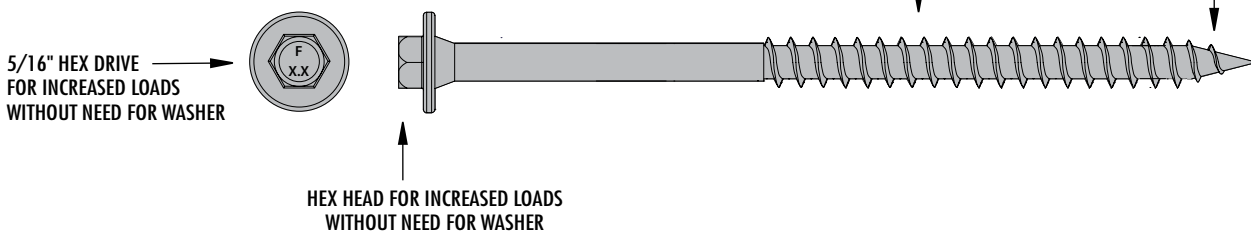



FastenMaster VersaLOK™

Structural Wood Screw



Features:

- No Predrilling
- Faster and easier than 1/2" Lags
- Attractive flush mount flat head
- ProjectLife Coating
- Approved for treated lumber
- IBC/IRC Code-Compliant ESR-1078
- TORX® ttap® drive system

Lengths: 6", 8", 10"

Packaging Quantities:

Single fastener, 50pc box

Description:

FastenMaster VersaLOK™ is a heavy-duty wood screw that can be used in a wide variety of structural applications. The performance and corrosion resistance of the VersaLOK fastener is guaranteed for the life of the project when used in accordance with the installation instructions and supporting technical literature.

Meet Code. Lower Cost.

Meet Code: VersaLOK has been tested and proven to meet the most recent IBC/IRC requirements.

Lower Cost: Requires no predrilling, saving time and labor.



| VersaLOK Screw SKU Selection Guide | | |
|------------------------------------|-----------------|--------------|
| Length | Pkg Qty | SKU |
| 6" | Single Fastener | FMVL006-INDY |
| | 50pc box | FMVL006-50 |
| 8" | Single Fastener | FMVL008-INDY |
| | 50pc box | FMVL008-50 |
| 10" | Single Fastener | FMVL010-INDY |
| | 50pc box | FMVL010-50 |



Installation Procedure:
VersaLOK should be installed using an impact driver or high torque 1/2" variable speed drill (minimum 18V if cordless). Choose the proper length fastener so that the threads fully engage the innermost member being attached. Bring the washer head flush to the surface. Not for use in concrete or masonry.

ProjectLife™ Coating:
The performance and corrosion protection of VersaLOK is guaranteed for the life of the project. VersaLOK is not recommended for use in saltwater applications.

Flat Head With TORX® Ttap® Drive:
The flat head installs flush, saving additional time and money. Plus, gain stronger bit engagement with the TORX Ttap drive system.

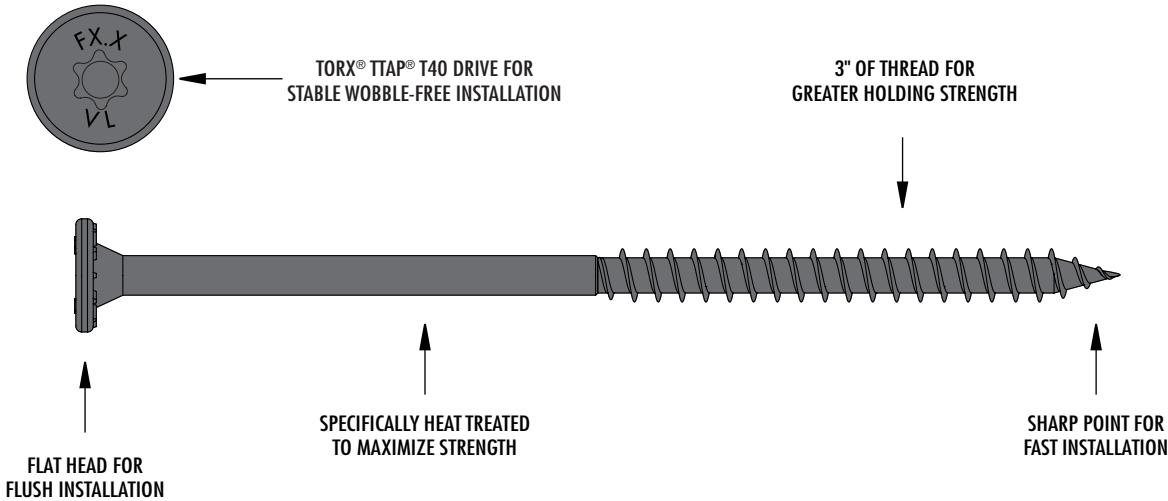



FlatLOK® Structural Wood Screw

Features

- No predrilling
- #40 TORX® ttap® drive system
- ProjectLife Coating
- Approved for single-sided installation
- Code-Compliant Evaluation Report ICC-ES AC233

Lengths: 2-7/8", 3-1/2", 4", 4-1/2", 5", 6", 6-3/4"

Packaging Quantities:

Single fastener, 50pc box, 250pc bucket, 500pc bucket (2-7/8" only), 200pc bucket (6-3/4" only)

Compliance
audited by



Description

FlatLOK is designed for various multi-ply dimensional and engineered wood connections. FlatLOK is approved for single-sided installation. Not intended for use on exterior deck ledgers; FastenMaster LedgerLOK is designed specifically for that application.

Meet Code. Lower Cost.

FlatLOK delivers strong, code-compliant connection for multi-ply LVL, girder trusses and multi-ply lumber beams.

Meet Code: Tested to meet manufacturers' requirements for single-sided installation of multi-ply LVL, LSL and PSL.

Lower Cost: Requires no predrilling, saving time and labor.



| FlatLOK Selection Guide | | | |
|-------------------------|---------------------------|-----------------|--------------|
| Length | Typical Applications | Packaging Qty | SKU |
| 2-7/8" | 2-Ply Roof Girder Trusses | 50pc box | FMFL278-50 |
| | | 500pc bucket | FMFL278B-500 |
| 3-1/2" | 2-Ply LVL Beams | Single fastener | FMFL312-INDY |
| | | 50pc box | FMFL312-50 |
| | | 250pc bucket | FMFL312B-250 |
| 4" | Interior Corridor Ledgers | 50pc box | FMFL004-50 |
| | | 250pc bucket | FMFL004B-250 |
| 4-1/2" | 3-Ply Roof Girder Trusses | 50pc box | FMFL412-50 |
| | | 250pc bucket | FMFL412B-250 |
| 5" | 3-Ply LVL Beams | Single fastener | FMFL005-INDY |
| | | 50pc box | FMFL005-50 |
| | | 250pc bucket | FMFL005B-250 |
| 6" | 4-Ply Roof Girder Trusses | 50pc box | FMFL006-50 |
| | | 250pc bucket | FMFL006B-250 |
| 6-3/4" | 4-Ply LVL Beams | Single fastener | FMFL634-INDY |
| | | 50pc box | FMFL634-50 |
| | | 200pc bucket | FMFL634B-200 |



Installation Procedure:

FlatLOK should be installed using an impact driver or high torque 1/2" variable speed drill (minimum 18V if cordless). No predrilling is required when properly installed. Bring fastener flush with wood surface, do not overdrive.

ProjectLife™ Guaranteed:

The performance and corrosion protection of FlatLOK is guaranteed for the life of the project. FlatLOK is not recommended for use in saltwater applications.

| FlatLOK Length Selection Guide | | | | | |
|--------------------------------|-----------|---------------|----------------------|----------|----------|
| A | B | C | D | E | F |
| 1 3/4" | 1 3/4" | 1 3/4" 3 1/2" | 1 3/4" 3 1/2" 1 3/4" | 3 1/2" | 1 3/4" |
| | | | | | |
| 3-1/2" | 5" | | 6-3/4" | | |

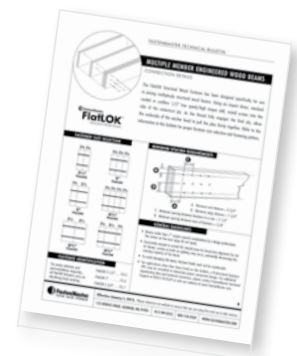

Footnotes

- Fasteners should be installed in a staggered pattern at least 1-3/4" from top or bottom edge and 3-3/4" from either end of the beam

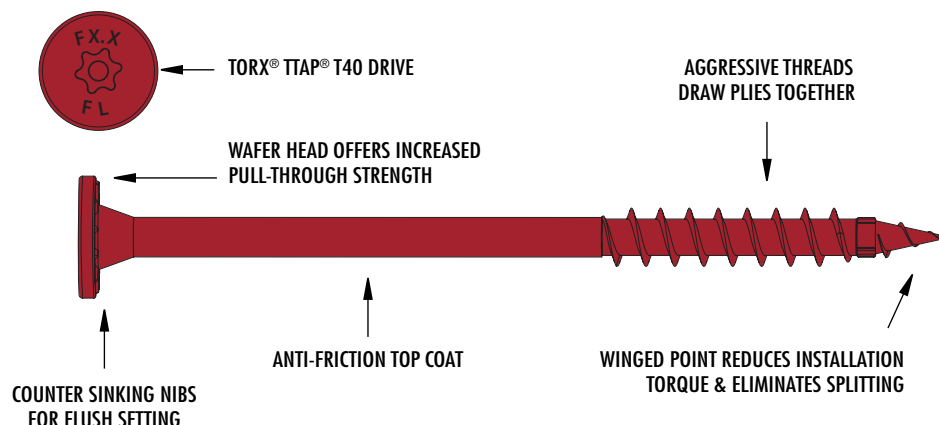



ThruLOK® Through-Bolt Replacement



Features:

- No predrilling
- Faster, easier than 1/2" through-bolts
- No drill bits or wrenches required
- Galvanized coating meets code requirements for treated wood
- Code-Compliant Evaluation Report ICC-ES ESR-1078

Lengths: 6-1/4", 7", 8", 9-1/2"

Packaging Quantities:

Single fastener, 24pc box

Description:

The ThruLOK System combines the strength of a through-bolted connection with the speed of a FastenMaster LOK fastener.

- 6-1/4": engineered to connect 4x4 posts to 2x joists
- 7": engineered to connect two 2x beams to a notched 6x6 post
- 8": engineered to connect 4x4 posts to a double rim joist or single rim joist and 2x blocking.
- 9-1/2": engineered to attach a 6x6 post two 2x beams

Meet Code. Lower Cost.

Meet Code: ThruLOK has been tested to meet the most recent IBC/IRC requirements for guard post to rim joist connections.

Lower Cost: Requires no predrilling, saving time and labor.



| ThruLOK Screw Selection Guide | | | |
|-------------------------------|------------------|-----------------|---------------|
| Length | Wood Dim Range | Pkg Qty | SKU |
| 6-1/4" | 4-1/2" to 5-1/4" | Single Fastener | FMTHR614-INDY |
| | | 24pc box | FMTHR614-24 |
| 7" | 5-1/4" to 6" | Single Fastener | FMTHR007-INDY |
| | | 24pc box | FMTHR007-24 |
| 8" | 6-1/4" to 7" | Single Fastener | FMTHR008-INDY |
| | | 24pc box | FMTHR008-24 |
| 9-1/2" | 7-3/4" to 8-1/2" | Single Fastener | FMTHR912-INDY |



Installation Procedure:

No predrilling required when properly installed. Put the ThruLOK washer on the screw with the teeth of the washer facing away from the head of the fastener. Using a 1/2" high torque variable speed drill (18V if cordless), drive the ThruLOK until washer and hex-head are just above the wood surface (approx 1/4") and point of screw protrudes out other side of connection. Thread the nut onto point of fastener. Tighten nut until flush with wood. Tighten screw with drill. **NOTE: Point of fastener must engage in nut to "MIN" line or beyond.**

For detailed installation instructions, including fastening requirements, please refer to our *ThruLOK Deck Post and Carrying Beam technical bulletins*. These instructions are included in all packaging as well as being available for download from our website. A design professional should be consulted for all other critical connections, to include the number and location of all fasteners to meet national and local code requirements.

ProjectLife™ Guaranteed:

The performance and corrosion protection of ThruLOK is guaranteed for the life of the project. ThruLOK is not recommended for use in saltwater applications.

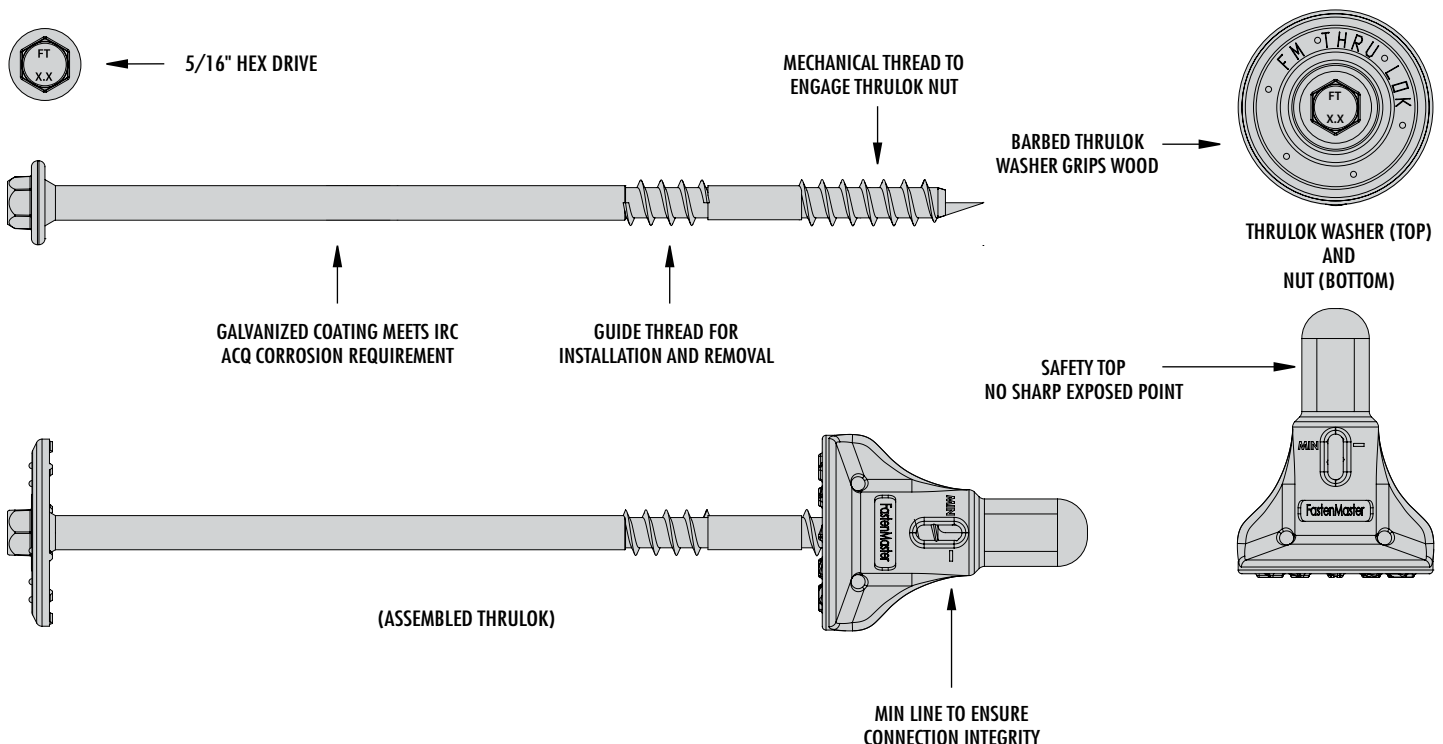
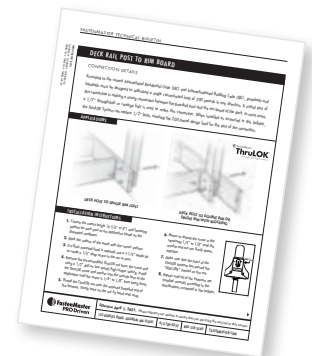



FastenMaster MVP™

Multipurpose Wood Screw



Features:

- TORX® tTap® drive system wobble-free drive
- SureStart™ Point for fast starts
- ProjectLife™ Coating with superior corrosion protection
- SureSink™ Head prevents spin-out
- For Framing, Cabinetry & More

Lengths: 1-1/2", 2", 2-1/2", 3", 3-1/2", 4"

Packaging Quantities:

100pc box, 250pc bucket, 500pc bucket, 1250pc bucket, 1600pc bucket, 2000pc bucket

Description:

The FastenMaster MVP™ Multipurpose Wood Screw has been designed for increased connection strength, durability, and corrosion resistance. The MVP fastener is IRC/IBC code-compliant and supported by an ICC-ES Evaluation Report ICC-ES ESR-5265 that can be found at FastenMaster.com.

The FastenMaster MVP delivers a best in category drive system coupled with superior corrosion protection. ProjectLife Guaranteed.



| FastenMaster MVP Selection Guide | | |
|----------------------------------|---------------|---------------|
| Length | Packaging Qty | SKU |
| 1-1/2" | 100 Pack | FMMVP112-100 |
| | 500 Pack | FMMVP112-500 |
| | 2000 Pack | FMMVP112-2000 |
| 2" | 100 Pack | FMMVP002-100 |
| | 500 Pack | FMMVP002-500 |
| | 2000 Pack | FMMVP002-2000 |
| 2-1/2" | 100 Pack | FMMVP212-100 |
| | 450 Pack | FMMVP212-450 |
| | 2000 Pack | FMMVP212-2000 |
| 3" | 100 Pack | FMMVP003-100 |
| | 350 Pack | FMMVP003-350 |
| | 1600 Pack | FMMVP003-1600 |
| 3-1/2" | 100 Pack | FMMVP312-100 |
| | 250 Pack | FMMVP312-250 |
| | 1250 Pack | FMMVP312-1250 |
| 4" | 100 Pack | FMMVP004-100 |
| | 250 Pack | FMMVP004-250 |
| | 1250 Pack | FMMVP004-1250 |



ProjectLife™ Coating:

The performance and corrosion protection of FastenMaster MVP is guaranteed for the life of the project. Approved for use in exterior applications including treated wood (ACQ, MCA, MCQ, CAB). FastenMaster MVP is not recommended for use in saltwater applications.

FastenMaster MVP Features:

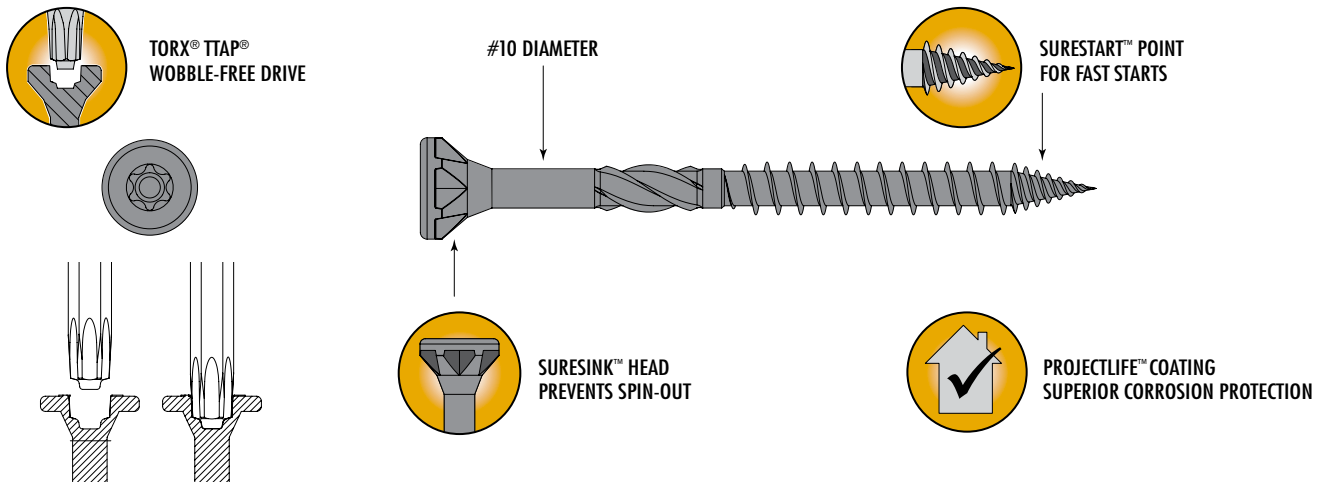



Lateral Tension System™

Code Compliant Lateral Deck Attachment

Compliance
audited by



Features:

- Meets IRC lateral load requirements for decks
- Guaranteed galvanized
- No pre-drilling required
- No interior access needed to install
- Free bits in every package

Packaging Quantities:

Each kit contains:

- (4) Lateral Tension Brackets
- (4) Transfer Screws
- (32) Bracket Mounting Screws
- (2) Driver Bits

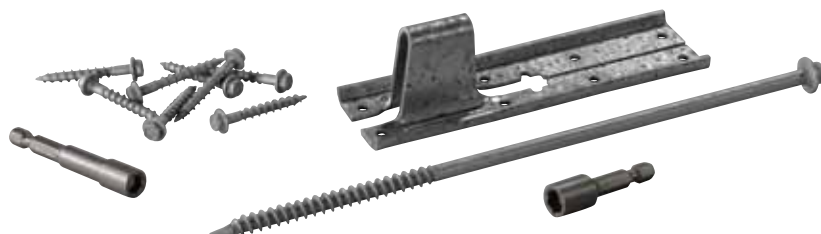

Description:

Lateral Tension System™ (LTS) is a complete kit designed to meet the newest code for transferring lateral deck loads. The International Residential Code (IRC) requires that decks be designed to withstand 750 pounds of lateral load in four locations along the ledger. LTS allows for attachment from the deck joist then directly to an interior sill plate, wall plate or stud – all from the outside.

Lateral Tension System Selection Guide

| Contents | SKU |
|---|---------|
| (4) Lateral Tension Brackets, (4) Transfer Screws, (32) Bracket Mounting Screws, (2) Driver Bits | FMLTS-4 |

Installation Procedure:

The LTS is approved for the five most common installation conditions:

Condition A: Sill Plate or Wall Plate Behind Ledger

Condition B: Sill Plate or Wall Plate Directly Below Ledger

Condition C: Sill Plate or Wall Plate 2" – 5" below Ledger

Condition D: Wall Stud in line with Deck Joist

Condition E: Wall Stud between Deck Joists

The FastenMaster LTS, is one complete kit to make all five of these code conforming connections. Each LTS bracket attaches an individual deck joist to a structural framing member of the house. With the LTS, you can install the fastener first and then add the bracket. The long fastener allows you to achieve the 3" of threading within the sill plate without having to access the interior of the house. You can achieve the code complaint connection in seconds.

ProjectLife™ Guaranteed:

The performance and corrosion protection of LTS is guaranteed for the life of the project. LTS is not recommended for use in saltwater applications.

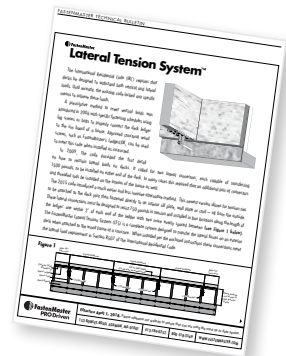

Tension Transfer Screw

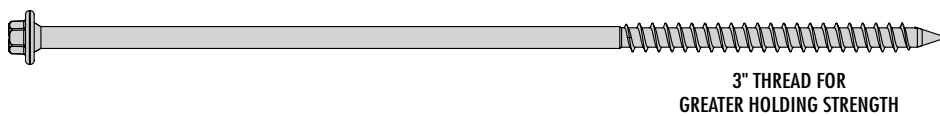

LTS Bracket Top View

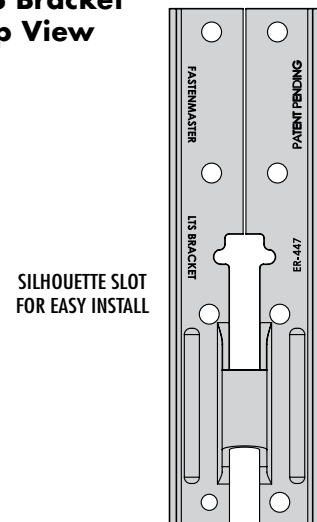

Bracket Mounting Screw

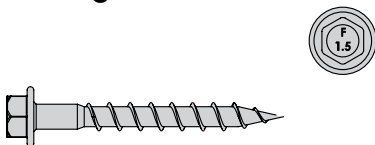

LTS Bracket Profile

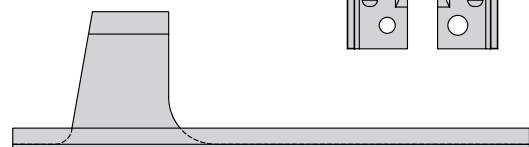



OlyLog®

Log Home Fastener

Features:

- Installs faster and easier than lags and spikes
- No predrilling
- Draws warped logs down
- Removable and reusable
- Eliminates jarring and damage caused by a sledgehammer
- ProjectLife guaranteed

Description:

OlyLog is the original threaded log home fastener that requires no predrilling.

Installation Procedure:

Use a 1/2", high torque, low RPM drill.
Install OlyLog perpendicular to the log.
Countersink minimum of 1/4".

Lengths: 2-1/2", 4", 6", 8", 9", 10", 12", 14", 16"

Packaging Quantities:

250pc box, 500pc box (2-1/2" only)



| OlyLog SKU Selection Guide | | |
|----------------------------|---------------|--------|
| Length | Packaging Qty | SKU |
| 2-1/2" | 500pc box | LOG212 |
| 4" | 250pc box | LOG004 |
| 6" | 250pc box | LOG006 |
| 8" | 250pc box | LOG008 |
| 9" | 250pc box | LOG009 |
| 10" | 250pc box | LOG010 |
| 12" | 250pc box | LOG012 |
| 14" | 250pc box | LOG014 |
| 16" | 250pc box | LOG016 |



LogHog®

Heavy Duty Log Home Fastener

Features:

- Installs much faster and easier than lags and spikes
- Countersinks into log — allows log to settle naturally
- No predrilling
- Removable and reusable
- Eliminates jarring and damage caused by sledgehammers
- ProjectLife guaranteed

Description:

LogHog is an extra heavy-duty log home fastener, engineered for specific log home construction applications. The LogHog, with its oversized head, thicker diameter and additional thread, offers increased draw-down and holding power. This fastener is corrosion resistant guaranteed.

Installation Procedure:

Use a 1/2", high torque, low RPM drill. Install LogHog perpendicular to the log. Countersink minimum of 1/4".

Lengths: 7", 9", 10", 11", 12", 13", 15"

Packaging Quantities:

150pc box (15" only), 250pc box



| LogHog SKU Selection Guide | | |
|----------------------------|---------------|---------|
| Length | Packaging Qty | SKU |
| 7" | 250pc box | LHOG007 |
| 9" | 250pc box | LHOG009 |
| 10" | 250pc box | LHOG010 |
| 11" | 250pc box | LHOG011 |
| 12" | 250pc box | LHOG012 |
| 13" | 250pc box | LHOG013 |
| 15" | 150pc box | LHOG015 |

Framing Systems

Drive productivity with tools and fasteners that make new construction more safe and efficient.



2016: FrameFAST was the first fastener and tool system specially designed to replace clips and strapping when attaching rafter tail to top plate and other critical building connections.

2019: FastenMaster created the NLB (Non-Load Bearing) Connector which was the first faster approved to replace top mounted clips when attaching non load bearing walls to resist lateral movement. NLB is the only fastener that can be installed from underneath without predrilling and comes with a unique friction-free sleeve that allows for vertical movement.

2022: TrussBRACE is the first truss bracing solution that includes both lateral and diagonal support in one connection. Set, Space and Brace in one easy step!

Frame Faster, Safer, and Easier with FastenMaster Framing Systems

For over twenty years, FastenMaster has delivered innovative structural wood-to-wood fastening solutions that increase installation speed and safety. We're driven by a relentless commitment to the professional builder. This PRO Driven focus is why FastenMaster is a trusted brand of framing contractors and structural design engineers. FastenMaster Framing Systems are designed to drive job site productivity by making new construction safer and more efficient.

| | |
|---|----|
| FrameFAST™ Structural Framing System | 43 |
| <ul style="list-style-type: none">• Installs 5x faster than traditional connectors• Available in corded and cordless power options• Increases safety by eliminating ladders | |
| TrussBRACE™ Roof Truss Support | 45 |
| <ul style="list-style-type: none">• Set, space, and brace roof trusses in one easy step• Patented design provides both lateral and diagonal support• No need to remove prior to sheathing | |
| NLB Connector™ for Non-Load Bearing Walls | 47 |
| <ul style="list-style-type: none">• Installs 8x faster than channel brackets• Accommodates up to 1-1/2" gap at the top of non-load bearing walls• No predrilling | |
| PAMFast™ AutoFeed Fastening System | 49 |
| <ul style="list-style-type: none">• 2-in-1 whole home fastening solution• Available in corded and cordless power options• Extensive offering of fastener varieties enables <i>PAMFast</i> to drive screws anywhere you do | |
| PAMFast™ AutoFeed Screws | 51 |
| <ul style="list-style-type: none">• PAMFast Fasteners: Featuring PAMDrive 6-lobe recess for improved bit life and fewer cam-outs• Drives productivity on the job site: faster installation and ergonomic, ease of use benefits• PAMMax fastener belt holds up to 40% more fasteners so workers spend more time driving screws and less time reloading | |





FrameFAST™

Structural Framing System

Features:

- **5x Faster:** Code approved connections are made in a fraction of the time verses installing a hurricane clip.
- **Easy to Install:** Featuring a TORX® ttap® drive and free alignment guide included in every package.
- **ProjectLife™ Guarantee:** Performance and corrosion protection is guaranteed for the life of the project.
- **Approved for use in exterior applications** including pressure treated wood(ACQ). Not recommended for use in saltwater applications.



The FrameFAST Fastener:

FrameFast replaces common hurricane ties and is installed without the need for compressors, nailers, and hoses. The updated FrameFAST Fastener empowers PROs with the choice of using a standard impact driver or the award winning FrameFast Tool.

Lengths: 6"

Packaging Quantities:

50pc box, 250pc bucket



| FrameFAST Fastener | | |
|---|----------------|--|
| Description | SKU | Package Contains |
| FrameFAST with TORX® ttap® 50 piece box | FMFFTT006-50 | (50) fasteners (1) alignment guide (1) TORX® ttap® driver bit - 2" |
| FrameFAST with TORX® ttap® 250 piece box | FMFFTT006B-250 | (250) fasteners (1) alignment guide (1) TORX® ttap® driver bit - 2" (1) TORX® ttap® driver bit - 6" |

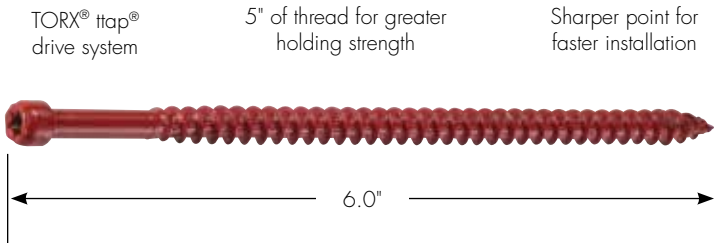

FrameFAST Tools:

- Maximize safety and productivity with the FrameFAST installation tool.
- Make code compliant connections without the use of a ladder.
- 3 interchangeable heads ensure consistent installation of the fastener in a variety of continuous load path applications.
- Fully assembled tools complete with cordless drivers by Milwaukee and DeWALT
- Scan the QR code for more information and to see FrameFAST tool in action.



**LEARN MORE
ABOUT FRAMEFAST**

| FrameFAST Installation Tools | |
|------------------------------|-------------------|
| Description | SKU |
| FF Cordless DeWALT | FMFFTOOLT2TP-DWC |
| FF Cordless Milwaukee | FMFFTOOLT2TP-MILC |
| FF Corded Milwaukee | FMFFTOOLT2TP |

| Additional Installation Heads | |
|-------------------------------|---------------|
| Description | SKU |
| Truss-to-Top-Plate Head | FMFFHEAD-T2TP |
| Stud-to-Plate Head | FMFFHEAD-S2P |
| Plate-to-Rim Head | FMFFHEAD-P2R |





TrussBRACE™

Roof Truss Support

Features:

- Set, Space, and Brace roof trusses in one easy step
- Patented design provides both lateral and diagonal support in one brace
- Enhance safety by remaining on the bottom chord of the truss during installation
- No more climbing up to the top of the truss to install bracing
- Easy to follow installation guide is provided in every box

Packaging Quantities:

Box of (30) TrussBRACEs (24-in. O.C.)



Set, Space and Brace In One Easy Step:

TrussBRACE is a revolutionary roof truss support that's changing the way framers set trusses. The innovative design provides both diagonal and lateral stability in one application. Easy web member placement keeps workers standing safely on the bottom chord of the truss. Save time by skipping the prep work of cutting wood braces, and there's nothing to remove prior to sheathing. TrussBRACE saves time before, during, and after the truss set.

| TrussBRACE Selection Guide | | |
|----------------------------|-------------------------|---------------|
| Quantity | Typical Applications | SKU |
| 30 per box | Roof Truss Installation | FMTBRACE24-30 |

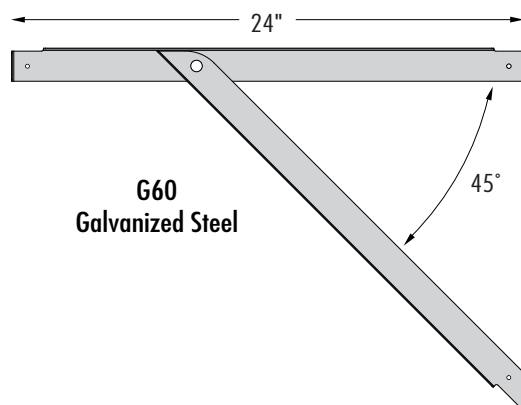

| TrussBRACE Spacing per Truss Span | |
|-----------------------------------|-------------------|
| Truss Span | Truss Spacing |
| Up to 30' | 12' on center max |
| 30' to 45' | 10' on center max |
| 45' to 60' | 8' on center max |



Scan to watch a
TrussBRACE video

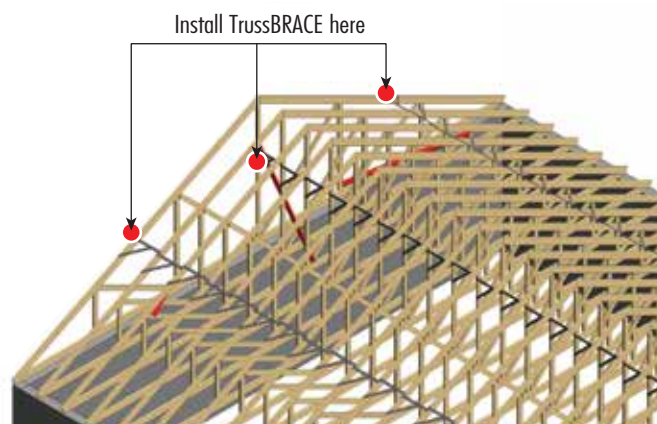
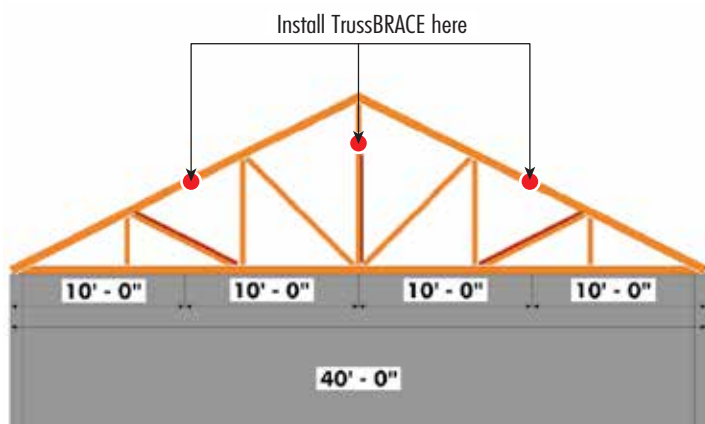

Simple Web Member Placement:

Refer to the TrussBRACE spacing chart above for general placement guidelines for temporary bracing. Remain standing on the bottom chord to maintain a safer center of gravity. When the top chord of the truss is too high to safely reach, install TrussBRACE on the web member at the desired spacing interval. Refer to the complete installation instructions by visiting FastenMaster.com.



NLB ConnectorTM

For Non-Load Bearing Wall to Truss Connections



Features:

- No predrilling
- Installs 8x faster than channel brackets
- Allows up to 1-1/2" gap between the top of non-load bearing walls and trusses / joists above
- Free drive/set tool in every package

Lengths: 6"

Packaging Quantities:

50pc box

Description:

The NLB Connector is the fastest and easiest way to secure the top of non-load bearing walls to trusses and joists above. This code-compliant connection allows for vertical deflection of the bearing members above, without transferring load into the interior partition walls below.

The NLB connector accommodates up to a 1-1/2" gap between the top of the wall and the bearing member above. This enables framers to use the same precut stud lengths as the bearing walls, and because there is no need to predrill, it's twice as fast as other non-load bearing wall connectors on the market.



| NLB Selection Guide | |
|-------------------------|-------------|
| Description | SKU |
| NLB Connector (50 pack) | FMNLB006-50 |



Installation Procedure

1. Attach the NLB Setting Tool w/Driver bit to an 18" driver bit extension pole (not included).
2. Insert the head of the NLB Connector into the magnetic driver bit.
3. Confirm connection locations based on plan drawings or refer to the Allowable Lateral Load Pounds per Connection table below.
4. Position the NLB Connector below the top plate of the wall such that it will drive through the wall plate and upward into the intersecting framing member above.
5. On the highest drill speed setting, drive directly upward through the wall plate and into the truss/joist above until the fastener automatically disengages from the driver bit.



| Allowable Lateral Load Pounds per Connection | | | | | | | |
|--|------------------|------|------|------|--------|------------------|--------|
| | Single Top Plate | | | | | Double Top Plate | |
| Max. Gap | 0" | 1/4" | 1/2" | 3/4" | 1-1/2" | 3/4" | 1-1/2" |
| Pounds | 290 | 250 | 220 | 190 | 140 | 210 | 130 |

- Loads determined through testing in accordance with ICC-ES AC13 and ASTM D-1761.
- Wood assumed to be SPF / Hem Fir or greater density.
- Applies to both F1 and F2 loading with a minimum 3-1/2" wide top plate and minimum 1-1/2" wide truss
- No increase allowed for short term load duration
- Assumes a minimum embedment of 1-1/4" into truss

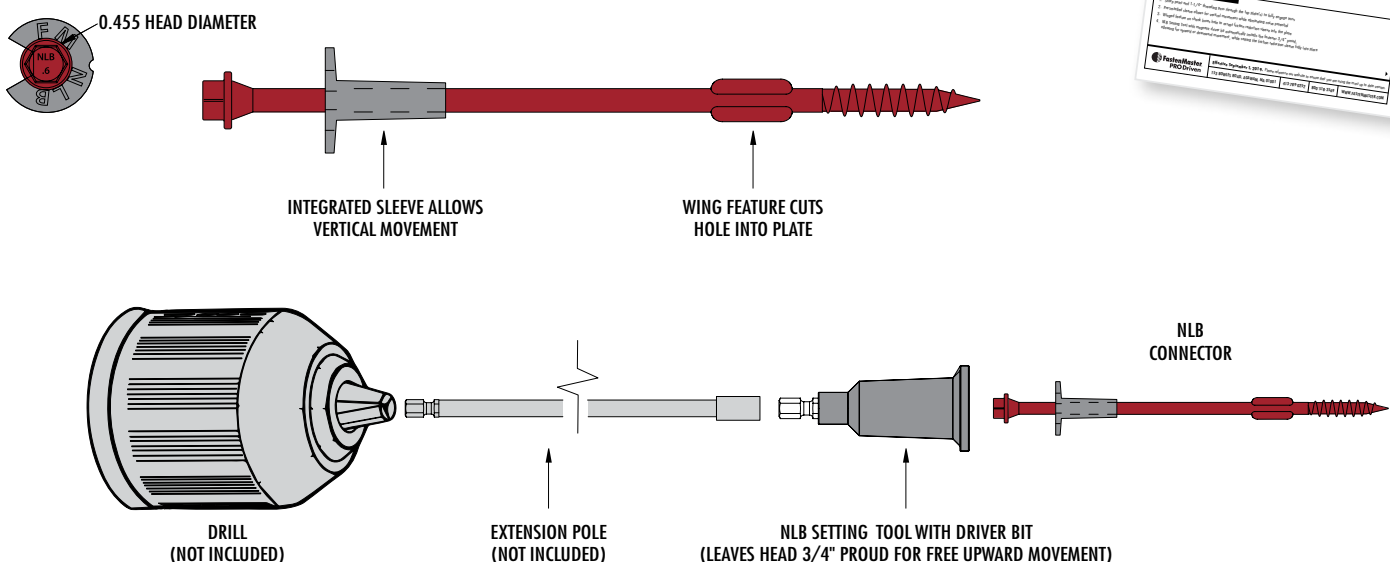
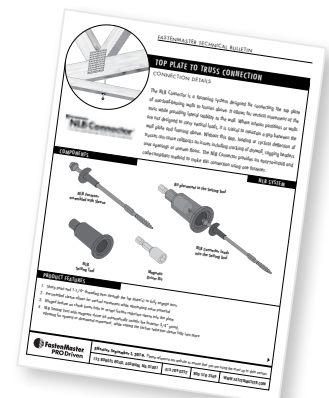



PAMFast™ Autofeet Fastening System

Features:

- 2-in-1 interchangeable length tool is a versatile whole home fastening system
- Smooth Advancement Technology delivers consistent fastening with no jams
- PAMMax fastener belt holds up to 40% more fasteners so workers spend more time driving screws and less time reloading
- Fasten subfloor and decking while standing comfortably or convert to a short tool for drywall, roof tiles, and more
- Fully assembled tools come complete with cordless screw guns by DeWALT and Makita



Description:

The smoothest, most versatile PRO grade screw delivery system is now available with cordless power. *PAMFast* tools come fully assembled with high power screw guns from DeWALT, Makita, or Milwaukee, or choose a kit that is specially engineered to fit your drill. All *PAMFast* tools include long/ short conversion pieces and are compatible with all genuine *PAMFast* collated screws.

| SKU | Compatible Motor | Power Type |
|------------------|------------------|------------|
| SD-20-DWC13KUE* | DeWALT DCF622B | Cordless |
| SD-20-MAC13KUE* | Makita XSF04Z | Cordless |
| SD-20-DW13KUE | DeWALT DW268 | Corded |
| SD-20-DWC13KIT** | DeWALT DCF622B | Cordless |
| D-20-MAC13KIT** | Makita XSF04Z | Cordless |

*Batteries/charger sold separate **Kit only (no screw gun)



The Whole Home Fastening Solution!

PAMFast is a 2-in-1 interchangeable length tool. The removable extension pole enables easy long-to-short conversion for a variety of fastening needs. Fasten subfloor and decking while standing comfortably, or convert to a short tool to fasten drywall, roof tiles, and more.



AutoFeed Gun Features:

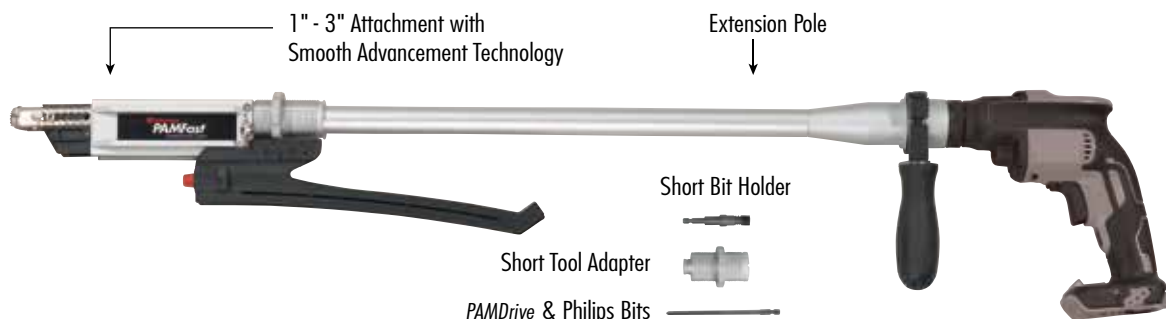



PAMFast™ Autofeed Screws

Features:

- **PAMFast Fasteners:** Featuring *PAMDrive* 6-lobe recess for improved bit life and fewer cam-outs
- **Drives productivity on the job site:** faster installation and ergonomic, ease of use benefits
- **PAMMax fastener belt** holds up to 40% more fasteners so workers spend more time driving screws and less time reloading

Packaging Quantities:

50 screws per strip, 1,000 screws per box

Interior Wood Screws

- ✦ **Wood to Wood Subfloor**
PAMDrive, ⅔ Coarse Fast Thread, Yellow Zinc, X- point



| | | |
|----------|-----------|----------|
| #8 x 1¼" | flat head | WCY8114 |
| #8 x 1½" | flat head | WCY8112 |
| #8 x 1¾" | flat head | WCY8134F |
| #8 x 2" | flat head | WCY8200F |
| #8 x 2½" | flat head | WCY8212F |
| #8 x 3" | flat head | WCY8300F |

- ✦ **High Density Wood (Advantech®) to Wood**
PAMDrive, Full Coarse Thread, Yellow Zinc, X-Point



| | | |
|----------|-----------|---------|
| #8 x 1¾" | flat head | FDY8134 |
| #8 x 2" | flat head | FDY8200 |

- ✦ **Wood to Wood Underlayment**
#2 Philips Drive, Hi-Lo Thread, Black Phosphate



| | | |
|----------|------------------------------|-----------|
| #7 x 1" | modified trim head with nibs | **MTH7100 |
| #7 x 1¼" | modified trim head with nibs | MTH7114 |

Cement Fiber Board/Siding to Wood

-  **Cement Fiberboard/Siding to Wood**
✓ACQ **PAMDrive, Coarse Thread,**
 **Copperhead External Grade Coating**



#8 x 1 3/4" modified wafer head with flutes MWMC8114
#8 x 1 5/8" modified wafer head with flutes MWMC8158

Exterior Decking Screws

-  **Pressure Treated Decking to Wood**
✓ACQ **PAMDrive, 2/3 Coarse Thread, Type 17 or X-Point,**
 **Stainless Steel or Copperhead External Grade Coating**



#8 x 1 3/4" flat head WDCH8134
#8 x 2" flat head WDCH8200
#8 x 2 1/2" flat head WDCH8212
#8 x 3" flat head WDCH8300



#8 x 2 1/2" trim head **THCH8212



#10 x 3" flat head - 316 SS **WDSS1003

-  **TrapEase 3 Collated Screws**
Composite Decking to Wood



#8 x 2 1/2" brown FMAFTR3-212-1000BR
#8 x 2 1/2" gray FMAFTR3-212-1000GY
#8 x 2 1/2" dark brown FMAFTR3-212-1000DB

Drywall to Wood Screws

-  **Drywall to Wood**
#2 Phillips Drive, Coarse Thread, Black Phosphate



#6 x 1 1/4" bugle head GCBP6114
#6 x 1 5/8" bugle head GCBP6158
#7 x 2" bugle head GCBP7200
#8 x 2 1/2" bugle head GCBP8212

Roof Tile Screws

-  **Roofing Tile to Wood**
✓ACQ **PAMDrive, 2/3 Coarse Thread, Stainless Steel or**
 **Copperhead. Miami Dade Co Certification #L 09-0720.14**



#8 x 2 1/2" flat head WTDC8212
#8 x 2 1/2" flat head (Darco Coating) WDDC8212



#8 x 2 1/2" bugle head **WDSB8212

Drywall to Steel Screws

-  **Drywall to 18-25 Gauge Steel**
#2 Phillips Drive, Fine Thread, Black Phosphate



#6 x 1 5/8" bugle head GFBP6158

-  **Drywall to 16-18 Gauge Steel**
#2 Phillips Drive, Self Drill, Clear Zinc



#6 x 1 5/8" bugle head **SDCZ6158

-  **Steel to 14-18 Gauge Steel Framing**
PAMDrive, Self Drill, Clear Zinc



#10-18 x 3/4" pan head SD101834

Wood/Steel to Steel Screws

-  **Wood/DensGlass to 18-25 Gauge Steel**
PAMDrive, Full Fine Thread, Sharp Point, Clear Zinc



#8 x 1 1/2" flat head SPCZ8112
#8 x 2" flat head **SPCZ8200

-  **Wood/DensGlass to 14-18 Gauge Steel**
PAMDrive, Fine Thread, Self Drill, Clear Zinc



#8 x 2" flat head **SDCZ8200

-  **Wood to 12-18 Gauge Steel**
Subfloor and Trailer Floor
✓ACQ **PAMDrive, Self Drill with Wings, Clear Zinc**



#10 x 1 1/2" flat head **SDW10112
#10 x 1 3/4" flat head SDW10134

-  **PAMDrive**
-  **Phillips Drive**
-  **Copperhead Screws***
- ✓ACQ **ACQ Tolerant**
-  **Miami-Dade Approved**

Check with your dealer for additional fasteners.

*Copperhead screws compatible with ACQ, CBA-A, and CA-B treated lumber

**This fastener is made to order. Lead times may vary. Consult your local dealer.



Product Offerings



Deck Color Matching Guide

| Board Collection | Board Color | Cortex Products | | TrapEase Products | | |
|---|---------------|-----------------|--------|-------------------|------|--------|
| | | Deck | Fascia | Color Match | Deck | Fascia |
| Trex Transcend® | Havana Gold | TSHG | 50TSHG | Havana Gold | TSHG | HG |
| | Island Mist | TSLM | 50TSLM | Island Mist | TSLM | LM |
| | Lava Rock | TSLR | 50TSLR | Lava Rock | TSLR | LR |
| | Rope Swing | TSRS | 50TSRS | Rope Swing | TSRS | RS |
| | Spiced Rum | TSSR | 50TSSR | Spiced Rum | TSSR | SR |
| | Tiki Torch | TSTT | 50TSTT | Tiki Torch | TSTT | TT |
| Trex Select® | Saddle | SLSD | 50SLSD | Saddle | SLSD | SD |
| | Pebble Gray | SLPB | 50SLPB | Pebble Gray | SLPB | PB |
| Trex Enhance® | Coastal Bluff | ENCB | 50ENCB | Spiced Rum | TSSR | SR |
| | Foggy Wharf | ENFW | 50ENFW | Pebble Gray | SLPB | PB |
| | Rocky Harbor | ENRH | 50ENRH | Rocky Harbor | TSGP | GP |
| | Toasted Sand | ENTS | 50ENTS | Saddle | SLSD | SD |
| | Beach Dune | ENBD | 50ENBD | Beach Dune | ENBD | BD |
| | Clam Shell | ENCS | 50ENCS | Clam Shell | ENCS | CS |
| | Saddle | ENSD | 50ENSD | Saddle | SLSD | SD |
| Trex Signature® | Ocracoke | SGCK | 50SGCK | Tiki Torch | TSTT | TT |
| | Whidbey | SGWD | 50SGWD | Clam Shell | ENCS | CS |
| Trex® Transcend Lineage™ | Island Mist | LNLM | 50LNLM | Island Mist | TSLM | LM |
| | Biscayne | TSBC | 50TSBC | Rocky Harbor | TSGP | GP |
| | Rainier | TSRN | 50TSRN | Pebble | SLPB | PB |
| | Carmel | TSCM | 50TSCM | Rope Swing | TSRS | RS |
| | Jasper | TSJP | 50TSJP | Saddle | SLSD | SD |
| TrapEase 3 Fascia also available in White | | N/A | N/A | White | N/A | WH |



Scan to find
your match

FastenMaster offers compatible products for many of the industry leading board manufacturers. To view a complete list of the most up-to-date board and color offerings visit FastenMaster.com

Deck and Trim *Product Numbers*

| Cortex for Trex Deck Selection Guide | | | | |
|---|-----------------|--|----------|--------------------|
| Screw Material | Board Type | Packaging Quantity | Coverage | SKU |
| Carbon Steel | Trex Enhance® | 224 screws, 240 plugs, 2 setting tools | 100 LF | FMCTXCL-TX1LFEN** |
| | Trex Select® | | | FMCTXCL-TX1LFSL** |
| | Trex Transcend® | | | FMCTXCL-TX1LFTS** |
| | Trex Signature® | | | FMCTXCL-TX1LFSG** |
| | Trex Select® | 1050 screws, 1200 plugs, 6 setting tools | 300 SF | FMCTXCL-TX300SL** |
| | Trex Transcend® | | | FMCTXCL-TX300TS** |
| | Trex Signature® | | | FMCTXCL-TX300SG** |
|  316 Marine Grade Stainless Steel | Trex Select® | 224 SS screws, 240 plugs, 2 setting tools | 100 LF | FMCTXCL-TX1LSL**SS |
| | Trex Transcend® | | | FMCTXCL-TX1LTS**SS |



**Selecting SKU/Board Color

When ordering, please combine SKU column with board manufacturer color key found on page 54

Example: Cortex 300 SF for Trex Select Pebble = FMCTXCL-TX300SLPB.

| Cortex for Trex Fascia Selection Guide | | | | |
|--|-----------------|--|----------|-----------------|
| Length | Board Type | Packaging Quantity | Coverage | SKU |
| 1-3/4" | Trex Enhance® | 100 screws, 105 plugs, 1 counterbore tool, 1 setting tool | 50 LF | FMCTXF-TX50EN** |
| | Trex Select® | | | FMCTXF-TX50SL** |
| | Trex Transcend® | | | FMCTXF-TX50TS** |



**Selecting SKU/Board Color

When ordering, please combine SKU column with board manufacturer color key found on page 54.

Example: Trex Transcend , 50 LF for Gravel Path = FMCTXF-TX50TSGP



| TrapEase 3 Product Offerings | | | | | |
|---|---------------|---------------|---------------------|----------|--------------------|
| Length | Board Type | Quantity | Description | Coverage | SKU |
| 2-1/2" 3" only available in: MD, PB, SD, VVB | Enhance® EN | 75pc box | 75 screws, 1 bit | 20SF | FMTR3-212-75**** |
| | Select® SL | 350pc bucket | 350 screws, 3 bits | 100SF | FMTR3-212-350**** |
| | Transcend® TS | 1050pc bucket | 1050 screws, 6 bits | 300SF | FMTR3-212-1050**** |
| TrapEase 3 #20 TORX® tTap® Driver Bits (2 PK) | | | | | FMTTAPT20BIT-2PK |

**Selecting SKU/Board Color

When ordering, combine SKU column with board manufacturer color key found on page 54.

Example: Trex Transcend 2-1/2", 350pc Tiki Torch = FMTR3-212-350TSTT

| TrapEase Fascia Selection Guide | | | |
|---------------------------------|--|----------|-------------|
| Screw Length | Packaging Qty | Coverage | SKU |
| 1-3/4" | 200 Screws, 1 Counterbore Tool, 1 Driver Bit | 100 LF | FMTRF-1LF** |

**Selecting SKU/Board Color

When ordering, combine SKU column with board manufacturer color key found on page 54.

Example: Trex Transcend, Rope Swing = FMTRF-1LFRS



Deck and Trim *Product Numbers*

| Cortex Trim Selection Guide | | | | | | |
|--|----------------------------------|---|---|---|---|--|
| | | | 2" Fastener | | 2-3/4" Fastener | |
| Board | Color | Coverage | Loose Plugs | Collated Plugs | Loose Plugs | Collated Plugs |
| Versatex | SM = Smooth TR = Timber Ridge | 50 LF | FMCTXTVT50** | N/A | FMCTXT234-VT50** | N/A |
| | | 250 LF | FMCTXTVT250** | FMCTXTCL-VT250** | FMCTXT234-VT250** | FMCTXTCL234-VT2** |
| | | 750 LF | FMCTXTVT750** | FMCTXTCL-VT750** | FMCTXT234-VT750** | FMCTXTCL234-VT7** |
| Royal | SM = Smooth GN = Grain | 50 LF | FMCTXTRY50** | N/A | FMCTXT234-RY50** | N/A |
| | | 250 LF | FMCTXTRY250** | FMCTXTCL-RY250** | FMCTXT234-RY250** | FMCTXTCL234-RY250** |
| | | 750 LF | FMCTXTRY750** | FMCTXTCL-RY750** | FMCTXT234-RY750** | FMCTXTCL234-RY750** |
| Royal Select | | 250LF | N/A | N/A | N/A | FMCTXTCL234-C2** |
| | | FT = Frost LT = Latte WR = Wrought Iron | CN = Chestnut NA = Oceana PB = Pine Brook | GV = Grove WL = Willow SL = Shale | CL = Coastline CS = Castlestone RR = River Rock | MP = Imperial Red TL = Timberland DP = Deep Pewter |
| Koma® | SM = Smooth Celuka | 50 LF | FMCTXTKM50SM | N/A | N/A | N/A |
| | | 250 LF | FMCTXTKM250SM | N/A | N/A | N/A |
| | | 750 LF | FMCTXTKM750SM | N/A | N/A | N/A |
| Cortex #20 TORX® ttap® driver bits (2 Pack of Setting Tools) | | | | | | FMCTXSETTOOL3-2PK |

**Selecting SKU/Board Color

When ordering, please combine SKU column with board manufacturer color key.

Example: Cortex 250 LF fastener length 2-3/4" for Versatex Smooth = FMCTXT234-VT250SM

| Cortex Trim Replacement Plugs SKU Selection Guide | | | |
|---|-------------|---------------------------------|-------------------|
| Board | Type | Description | SKU |
| Versatex® | Smooth | 40pc collated replacement plugs | FMCTXTQUAD-VT40SM |
| | TimberRidge | | FMCTXTQUAD-VT40TR |
| Royal | Smooth | 40pc collated replacement plugs | FMCTXTQUAD-RY40SM |
| | Grain | | FMCTXTQUAD-RY40GN |



New board colors are always being added to the Cortex product line. If the board color you are looking for is not listed on this page, consult our website for recent updates or call FastenMaster customer service at 800-518-3569.



| Cortex Driller Product Offerings | | |
|----------------------------------|----------|----------------|
| Packaging Quantity | Coverage | SKU |
| 224 screws, 2 setting tools | 100 LF | FMCTXD-TX1LFNP |



Deck and Trim *Product Numbers*

TC-G Clips SKU Selection Guide

| Clip | Board Compatibility | | Packaging Qty | SKU |
|------|--|---|---|-------------|
| TC-G | Composite and PVC | Wood | 90pc bag (50 SF) 20 bags per tray pack | F-4058-TCGS |
| | Trex Select® Veranda® Fiberon® MoistureShield™ WOLF™ Clubhouse® | Fortress ModernView™ Deckorators® UltraDeck Solid™ Gossen® | 900pc gun bucket (500 SF) | F-5913-GNFS |
| | | Brazilian Redwood Ipe Ironwood Mangaris Teak Cambara Meranti Port Orford Cedar | | |

*Coverage based on 16" o.c. joist spacing and 5-1/2" wide decking

Tiger Claw Installation Tools and Accessories

| Description | Coverage | Length | SKU |
|---------------------------------------|----------|--------|-------------|
| Tiger Claw Scrail - Carbon Steel* | 500 SF | 1-1/2" | F-5906-GNSC |
| Tiger Claw Scrail - Stainless Steel* | 500 SF | 1-1/2" | F-6557-SSPS |
| Tiger Claw Butt Seam Clips | 30 SF | 1-5/8" | F-5969-TCBC |
| Tiger Claw Pneumatic Installation Gun | | | F-5899-IGUN |

*For use with Tiger Claw Pneumatic Installation Gun



GuardDog SKU Selection Guide

| Length | Packaging Qty | Coverage | SKU | Length | Packaging Qty | Coverage | SKU |
|--------|----------------|----------|--------------|--|----------------|----------|-----------------|
| 1-5/8" | 75pc box | 20 SF | FMGD158-75 | 3" | 75pc box | 20 SF | FMGD003-75 |
| | 350pc box | 100 SF | FMGD158-350 | | 350pc box | 100 SF | FMGD003-350 |
| | 1,750pc bucket | 500 SF | FMGD158-1750 | | 1,750pc bucket | 500 SF | FMGD003-1750 |
| 2" | 75pc box | 20 SF | FMGD002-75 | 3-1/2" | 75pc box | 20 SF | FMGD312-75 |
| | 350pc box | 100 SF | FMGD002-350 | | 350pc box | 100 SF | FMGD312-350 |
| | 1,750pc bucket | 500 SF | FMGD002-1750 | | 1,350pc bucket | 350 SF | FMGD312-1350 |
| 2-1/2" | 75pc box | 20 SF | FMGD212-75 | Driver bit for GuardDog w/ TORX ttap drive system (2 included) | | | FMGDTTAPT25-2PK |
| | 350pc box | 100 SF | FMGD212-350 | | | | |
| | 1,750pc bucket | 500 SF | FMGD212-1750 | | | | |

*Coverage based on 16" o.c. joist spacing and 5-1/2" wide decking



Structural Wood Fasteners *Product Numbers*

| FastenMaster MVP SKU Selection Guide | | |
|--------------------------------------|---------------|---------------|
| Length | Packaging Qty | SKU |
| 1-1/2" | 100 Pack | FMMVP112-100 |
| | 500 Pack | FMMVP112-500 |
| | 2000 Pack | FMMVP112-2000 |
| 2" | 100 Pack | FMMVP002-100 |
| | 500 Pack | FMMVP002-500 |
| | 2000 Pack | FMMVP002-2000 |
| 2-1/2" | 100 Pack | FMMVP212-100 |
| | 450 Pack | FMMVP212-450 |
| | 2000 Pack | FMMVP212-2000 |
| 3" | 100 Pack | FMMVP003-100 |
| | 350 Pack | FMMVP003-350 |
| | 1600 Pack | FMMVP003-1600 |
| 3-1/2" | 100 Pack | FMMVP312-100 |
| | 250 Pack | FMMVP312-250 |
| | 1250 Pack | FMMVP312-1250 |
| 4" | 100 Pack | FMMVP004-100 |
| | 250 Pack | FMMVP004-250 |
| | 1250 Pack | FMMVP004-1250 |

| TimberLOK SKU Selection Guide | | |
|-------------------------------|-----------------|----------------|
| Length | Packaging Qty | SKU |
| 2-1/2" | Single fastener | FMTLOK212-INDY |
| | 12pc clamshell | FMTLOK212-12 |
| | 50pc box | FMTLOK212-50 |
| | 500pc bucket | FMTLOK212-500 |
| 4" | Single fastener | FMTLOK04-INDY |
| | 12pc clamshell | FMTLOK04-12 |
| | 50pc box | FMTLOK04-50 |
| | 250pc bucket | FMTLOK04-250 |
| 6" | Single fastener | FMTLOK06-INDY |
| | 12pc clamshell | FMTLOK06-12 |
| | 50pc box | FMTLOK06-50 |
| | 250pc bucket | FMTLOK06-250 |
| 8" | Single fastener | FMTLOK08-INDY |
| | 12pc clamshell | FMTLOK08-12 |
| | 50pc box | FMTLOK08-50A |
| | 250pc bucket | FMTLOK08-250 |
| 10" | Single fastener | FMTLOK10-INDY |
| | 12pc clamshell | FMTLOK10-12 |
| | 50pc box | FMTLOK10-50A |
| | 250pc box | FMTLOK10-250 |



Structural Wood Fasteners *Product Numbers*

| HeadLOK Standard Selection Guide | | |
|----------------------------------|-----------------|----------------|
| Length | Packaging Qty | SKU |
| 2-7/8" | Single fastener | FMHLGM278-INDY |
| | 12pc clamshell | FMHLGM278-12 |
| | 50pc box | FMHLGM278-50 |
| | 500pc bucket | FMHLGM278-500 |
| 4-1/2" | Single fastener | FMHLGM412-INDY |
| | 12pc clamshell | FMHLGM412-12 |
| | 50pc box | FMHLGM412-50 |
| | 250pc bucket | FMHLGM412-250 |
| 6" | Single fastener | FMHLGM006-INDY |
| | 12pc clamshell | FMHLGM006-12 |
| | 50pc box | FMHLGM006-50 |
| | 250pc bucket | FMHLGM006-250 |
| 8" | Single fastener | FMHLGM008-INDY |
| | 12pc clamshell | FMHLGM008-12 |
| | 50pc box | FMHLGM008-50 |
| | 250pc bucket | FMHLGM008-250 |
| 10" | Single fastener | FMHLGM010-INDY |
| | 12pc clamshell | FMHLGM010-12 |
| | 50pc box | FMHLGM010-50 |
| | 250pc bucket | FMHLGM010-250 |

| Additional Length Selection Guide | | |
|-----------------------------------|---------------|---------------|
| Length | Packaging Qty | SKU |
| 3-3/4" | 50pc bucket | FMHLGM334-50 |
| | 250pc bucket | FMHLGM334-250 |
| 5" | 250pc bucket | FMHLGM005-250 |
| 7" | 250pc bucket | FMHLGM007-250 |
| 8" | 250pc bucket | FMHLGM008-250 |
| 9" | 250pc bucket | FMHLGM009-250 |
| 10" | 250pc bucket | FMHLGM010-250 |
| 11" | 250pc bucket | FMHLGM011-250 |
| 12" | 250pc bucket | FMHLGM012-250 |
| 13" | 250pc bucket | FMHLGM013-250 |
| 14" | 250pc bucket | FMHLGM014-250 |

| HeadLOK Bits | |
|------------------------|---------------|
| 2 Spider Bits per card | FMSPIDER3-2PK |



Structural Wood Fasteners *Product Numbers*

| LedgerLOK SKU Selection Guide | | | |
|-------------------------------|-----------------|---------------|-----------------|
| Length | Packaging Qty | Hex Style SKU | Flathead SKU |
| 3-5/8" | Single Fastener | FMLL358-INDY | FMLLF358-12INDY |
| | 12pc clamshell | FMLL358-12 | FMLLF358-12 |
| | 50pc box | FMLL358-50 | FMLLF358-50 |
| | 250pc bucket | FMLL358B-250 | FMLLF358B-250 |
| 5" | Single Fastener | FMLL005-INDY | FMLLF005-INDY |
| | 12pc clamshell | FMLL005-12 | FMLLF005-12 |
| | 50pc box | FMLL005-50 | FMLLF005-50 |
| | 250pc bucket | FMLL005B-250 | FMLLF005B-250 |



| ThruLOK SKU Selection Guide | | | |
|-----------------------------|------------------|-----------------|---------------|
| Length | Wood Dim Range | Pkg Qty | SKU |
| 6-1/4" | 4-1/2" to 5-1/4" | Single Fastener | FMTHR614-INDY |
| | | 24pc box | FMTHR614-24 |
| 7" | 5-1/4" to 6" | Single Fastener | FMTHR007-INDY |
| | | 24pc box | FMTHR007-24 |
| 8" | 6-1/4" to 7" | Single Fastener | FMTHR008-INDY |
| | | 24pc box | FMTHR008-24 |
| 9-1/2" | 7-3/4" to 8-1/2" | Single Fastener | FMTHR912-INDY |



| VersaLOK SKU Selection Guide | | |
|------------------------------|-----------------|--------------|
| Length | Pkg Qty | SKU |
| 6" | Single Fastener | FMVL006-INDY |
| | 50pc box | FMVL006-50 |
| 8" | Single Fastener | FMVL008-INDY |
| | 50pc box | FMVL008-50 |
| 10" | Single Fastener | FMVL010-INDY |
| | 50pc box | FMVL010-50 |

Structural Wood Fasteners *Product Numbers*

FlatLOK SKU Selection Guide

| Length | Typical Applications | Packaging Qty | SKU |
|--------|---------------------------|-----------------|--------------|
| 2-7/8" | 2-Ply Roof Girder Trusses | 50pc box | FMFL278-50 |
| | | 500pc bucket | FMFL278B-500 |
| 3-1/2" | 2-Ply LVL Beams | Single fastener | FMFL312-INDY |
| | | 50pc box | FMFL312-50 |
| | | 250pc bucket | FMFL312B-250 |
| 4" | Interior Corridor Ledgers | 50pc box | FMFL004-50 |
| | | 250pc bucket | FMFL004B-250 |
| 4-1/2" | 3-Ply Roof Girder Trusses | 50pc box | FMFL412-50 |
| | | 250pc bucket | FMFL412B-250 |
| 5" | 3-Ply LVL Beams | Single fastener | FMFL005-INDY |
| | | 50pc box | FMFL005-50 |
| | | 250pc bucket | FMFL005B-250 |
| 6" | 4-Ply Roof Girder Trusses | 50pc box | FMFL006-50 |
| | | 250pc bucket | FMFL006B-250 |
| 6-3/4" | 4-Ply LVL Beams | Single fastener | FMFL634-INDY |
| | | 50pc box | FMFL634-50 |
| | | 200pc bucket | FMFL634B-200 |



Lateral Tension System SKU Selection Guide

| Typical Applications | SKU |
|--|---------|
| 5 common installation conditions below | FMLTS-4 |

OlyLog SKU Selection Guide

| Length | Qty | SKU |
|--------|-----------|--------|
| 2-1/2" | 500pc box | LOG212 |
| 4" | 250pc box | LOG004 |
| 6" | 250pc box | LOG006 |
| 8" | 250pc box | LOG008 |
| 9" | 250pc box | LOG009 |
| 10" | 250pc box | LOG010 |
| 12" | 250pc box | LOG012 |
| 14" | 250pc box | LOG014 |
| 16" | 250pc box | LOG016 |

LogHog SKU Selection Guide

| Length | Qty | SKU |
|--------|-----------|---------|
| 7" | 250pc box | LHOG007 |
| 9" | 250pc box | LHOG009 |
| 10" | 250pc box | LHOG010 |
| 11" | 250pc box | LHOG011 |
| 12" | 250pc box | LHOG012 |
| 13" | 250pc box | LHOG013 |
| 15" | 150pc box | LHOG015 |



GutterScrew SKU Selection Guide

| Color | Qty | SKU |
|-------|----------------|---------------|
| Brown | 10pc clamshell | FMGUT007-10BR |
| Brown | 25pc box | FMGUT007-25BR |
| White | 10pc clamshell | FMGUT007-10WV |
| White | 25pc box | FMGUT007-25WV |



Wood Framing Systems *Product Numbers*

| FrameFAST Product Offerings | | | | | |
|--|----------------|-----------------------|--------------------|-------------------------|---------------|
| Fastener | | Tools | | Additional Heads | |
| Description | SKU | Tool Description | SKU | Head Description | SKU |
| NEW 50 pc. box w/TORX ttap 2" drive bit | FMFFTT006-50 | FF Corded Tool | FMFFTOOL-T2TP | Truss to Top Plate Head | FMFFHEAD-T2TP |
| | | FF Cordless Milwaukee | FMFFTOOL-T2TP-MILC | Stud to Plate Head | FMFFHEAD-S2P |
| 250 pc. Bucket w/TORX ttap 2" & 6" drive bit | FMFFTT006B-250 | FF Cordless DeWALT | FMFFTOOL-T2TP-DWC | Plate to Rim Head | FMFFHEAD-P2R |
| | | | | | |

All FrameFAST Tools include (2) replacement Torx Plus drive bits and the FrameFAST Truss-to-Top-Plate head. Cordless tools do not include battery or charger.



| PAMFast Product Offerings | | |
|---------------------------|------------------|------------|
| SKU | Compatible Motor | Power Type |
| SD-20-DWC13KUE* | DeWALT DCF622B | Cordless |
| SD-20-MAC13KUE* | Makita XSF04Z | Cordless |
| SD-20-DW13KUE | DeWALT DW268 | Corded |
| SD-20-DWC13KIT** | DeWALT DCF622B | Cordless |
| D-20-MAC13KIT** | Makita XSF04Z | Cordless |



*Batteries/charger sold separate **Kit only (no screw gun)

See PAMFast AutoFeed Screw listings on page 51-52



| NLB Connector SKU Selection Guide | |
|-----------------------------------|-------------|
| Description | SKU |
| NLB Connector (50 pack) | FMNLB006-50 |

| TrussBRACE SKU Selection Guide | | |
|--------------------------------|-------------------------|----------------|
| Quantity | Typical Applications | SKU |
| 30 per box | Roof Truss Installation | FM-TBRACE24-30 |



Delivering PRO Driven Service Nationwide



Hands-on Jobsite Support for PROs

By offering hands-on product training, on-site technical support, and tailored solutions, we aim to establish a strong partnership with PRO contractors. We understand the unique challenges faced by contractors and aim to provide the necessary support and resources to help them succeed on their jobsites.



Dealer Training and Merchandising

We strive to establish valuable partnerships with our retail partners by offering comprehensive support via our dedicated field sales team such as on-site product training and dynamic merchandising setups. Our strong relationships with PRO contractors helps our dealers to maximize their sales potential and deliver a positive customer experience.



New Construction Engineering Team

Our engineering team is committed to providing unparalleled support to building designers and engineers, offering direct assistance and technical expertise. Plus, our Building Connections field team collaborates closely throughout the entire design and construction process to facilitate successful project execution.



How to Connect with FastenMaster

Call us: 800-518-3569
Email us: info@fastenmaster.com
Follow us: @fastenmasterpro
Visit us: fastenmaster.com

Scan to contact your local representative here:

