

BASINS

Wash Basin Knee Operated - Type 2



Stoddart designed and introduced the Knee Operated Wash Basin with the full front knee operated panel to provide easy access to hygienic hand washing. A simple nudge with either your left or right knee or thigh activates the timed water flow.

The standard unit comes with a shroud, designed to allow disabled access as defined in AS 1428.1-2001.

With the optional Tempering valve, this basin meets AS 4674 for the design, construction & fit out of food premises.



Models:

SPPL.WB.KO2.xx

Code explanation:

SPPL = Standard Product Plumbing
WB = Wash basin
KO2 = Knee operated, with lower plumbing shroud
300 = 300mm splashback
xx = TV - tempering valve
eg.: for specification and ordering
SPPL.WB.KO2.300.TV

Mixing Valves:



TV
Tempering
Valve

Features and Benefits:

- Full front panel Easy Push button can easily be activated with either left or right knee for hygienic hands free use.
- Timed flow valve provides effective hand washing and saves water.
- Security bubbler has WELS 6 star rating and is preferred by councils for use in public areas due to its extra vandal resistance.
- Sturdy stainless steel construction ensures lifelong service.
- A 300mm splashback can be ordered with the unit for easy installation and to comply with plumbing requirements of most authorities and removes the need for tiling.
- Optional tempering valve can be supplied, loose
- Easy mount single piece stainless steel bracket has multiple fixing holes for a quick installation by plumber.
- Stainless steel shroud fully encloses plumbing for additional hygiene and security and prevents unauthorised tampering with plumbing fittings.
- Complies with AS 1428.1-2001 for disabled access.



Suitable for use where disabled access is required

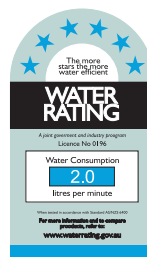

Proudly Manufactured in Australia

Manufactured by:

Tom Stoddart Pty Ltd. ABN 16 009690251
39 Forest Way, Karawatha 4117, Queensland Australia

Specifications:

Construction:	304 grade stainless steel construction, no.4 satin finish. Fully pre-plumbed. Knee operated timed flow valve.
Water Supply:	15mm (1/2" BSP). Additional water strainer/filter to protect valves from water-borne dirt and scale is fitted as standard.
Waste Connection:	40mm PVC waste supplied. (Trap by others).
Unit Fixing:	Unit is supplied with wall mounting bracket with 10mm fixing holes. Basin is fixed with 6mm fixings.
Disabled Fixing	
Height:	The unit can be mounted at 800 - 830mm above finished floor level for disabled use.

Models:
SPPL.WB.KO2.xx

Code explanation:

SPPL	= Standard Product Plumbing
WB	= Wash basin
KO2	= Knee operated, with lower plumbing shroud
300	= 300mm splashback
xx	= TV - tempering valve
eg.:	for specification and ordering
SPPL.WB.KO2.300.TV	

Mixing Valves:

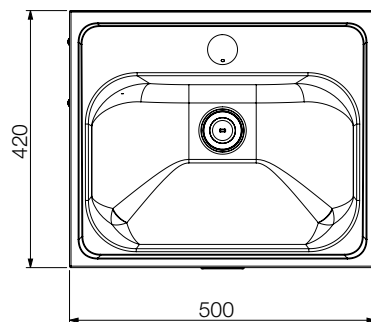

TV

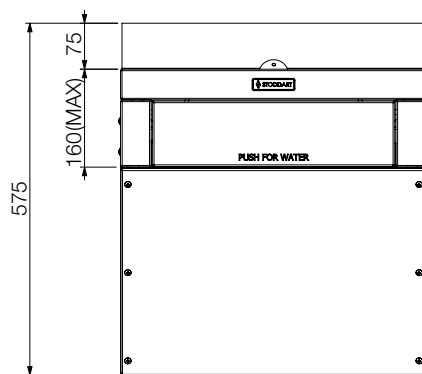
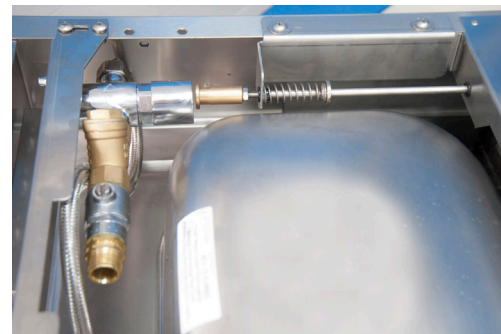

PLAN VIEW

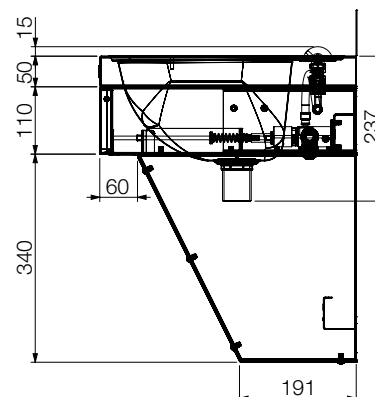

FRONT VIEW



END VIEW

Model No.	Width (mm)	Length (mm)	Height (mm)
SPPL.WB.KO2	420	500	575

Manufactured by:

Tom Stoddart Pty Ltd. ABN 16 009690251
39 Forest Way, Karawatha 4117, Queensland Australia