

## Product Information:

- 2mm thick stainless steel foot plates with locating pins (and drain holes on Electrolux models)
- 10 tray slides to suit gastronorm pans in 1.2mm stainless steel
- 38mm diameter stainless steel tube frame, 1.2mm thick
- Adjustable stainless steel flanged feet fitted to frames
- 1.2mm thick stainless steel under-shelf with top hat stiffening
- Oven located on feet plates (Rational model uses pins to secure feet)
- Supplied flat packed ready for assembly

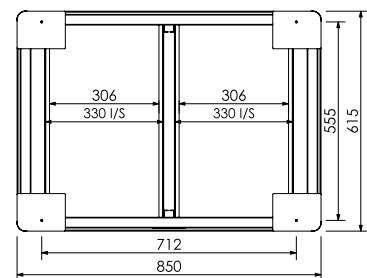

## General Drawing:

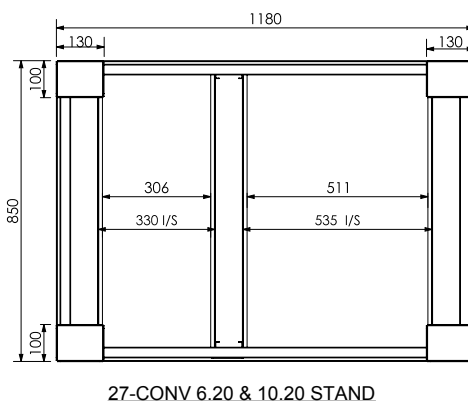
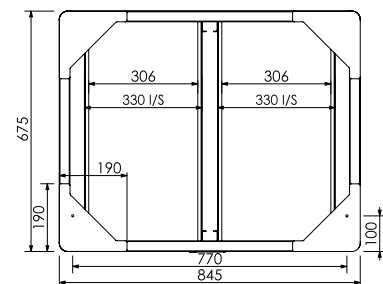
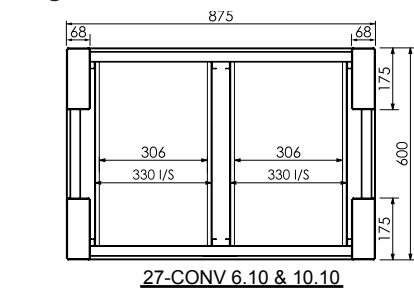

## Specifications:

<b>SS27.GIO</b>	870mm x 680mm x 697mm
<b>SS27.ELUX</b>	900mm x 750mm x 675mm
<b>SS27.ELUX.102</b>	1180mm x 850mm x 675mm
<b>SS27.RAT</b>	850mm x 615mm x 730mm
<b>SS27.IRAT</b>	845mm x 675mm x 660mm
<b>SS27.NEW.CONV4:6.10+10.10</b>	875mm x 600mm x 675mm
<b>SS27.CON.6/20+10/20</b>	1180mm x 850mm x 675mm

Due to continuous product research and development, the information contained herein is subject to change without notice.

Revision: A - 12/03/2021

[www.stoddart.com.au](http://www.stoddart.com.au)

[www.stoddart.co.nz](http://www.stoddart.co.nz)