

In-Wall Cistern with Mechanical Dual Flush

Model: SPPL.FD.CI.IW.MDF

SPPL = Stoddart Plumbing Product
 FD = Flushing Device
 CI = Cistern
 IW = In Wall
 MDF = Mechanical Dual Flush
 eg.: for specification and ordering quote
 Code: SPPL.FD.CI.IW.MDF

Features and Benefits:

- Dual flush cistern has Watermark License and WELS 4 Stars rating for efficient 4.5L/3L dual flush
- Cistern has Watermark License in accordance with AS1172.2
- Brushed Stainless Steel button plate with chrome plated actuators
- Choice of 4.5/3L and 6/3L flushing capacities
- Pairs with all WELS approved toilets



Actuator Location 1

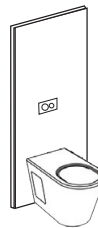

Wall Cavity Requirements

180mm to rear IF actuator in front of cistern

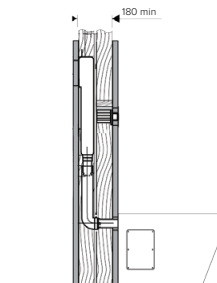

Side View
(actuator in front of tank)

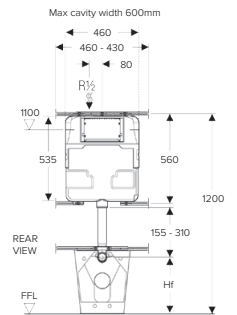

Rear Cavity Installation
(actuator in front of tank)

Specifications:

Construction: One piece moulded, high density polyethylene cistern tank. Stainless steel activation plate and chrome plated buttons.

Water Connection: 15mm threaded inlet at top of unit



Due to continuous product research and development, the information contained herein is subject to change without notice.

Revision: A - 19/04/2021

www.stoddart.com.au
 www.stoddart.co.nz