

Plaster & Clay Arrestor

Model: SPPL.PA.FM.AT

SPPL = Stoddart Plumbing Product
 PA = Plaster & Clay Arrestor
 FM = Floor Mounted
 AT = Angled Top
 eg.: for specification and ordering quote
 Code: SPPL.PA.FM.AT

Features and Benefits:

- Ideal plumbing protection for schools, hospitals, infirmaries, medical and veterinary practices where plaster & clay build up can be a costly and time consuming headache
- Fully welded, seamless, stainless steel unit with welded stainless steel inlet and outlet for strength and longevity
- Sealed rim to provide water tightness
- Quick release lid secured by clips
- Four layers of fine grade stainless steel mesh strainers ensure effective cleaning
- Strainers lift out for easy cleaning and maintenance

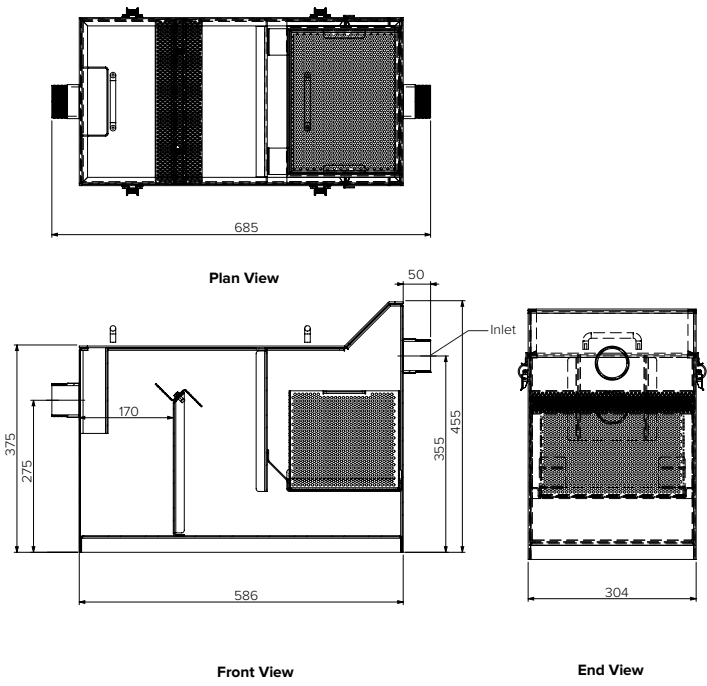

Specifications:

Construction: 1.5mm 304 grade stainless steel construction, no.4 satin finish.
 Inlet Connection: 50mm diameter BSP, stainless steel, supplied
 Outlet Connection: 50mm diameter BSP, stainless steel, supplied

Model No.	L x D x H (mm)
SPPL.PA.FM.AT	685 x 304 x 455



Due to continuous product research and development, the information contained herein is subject to change without notice.

Revision: A - 22/06/2021

www.stoddart.com.au
www.stoddart.co.nz