

Baby Bath - Drop In

Model: SPPL.BB.DI.yyy

SPPL = Stoddart Plumbing Product
 BB = Baby Bath
 DI = Drop In
 yyy = 1TH = 1 Tap Hole in extended hob
 = 3TH = 3 Tap Hole in extended hob

eg.: for specification and ordering quote

Code: SPPL.BB.DI.3TH

Features and Benefits:

- Ideal for use in hospitals, childcare centres, shopping centres, caravan parks and public facilities
- Specifically designed to assist in safely washing young infants
- All edges are rolled under to remove risk of injury
- Inclined base provides support for infants & helps to keep head out of the water while washing
- Variations can include extended rear hob for mounting, optional sink mixer tap or basin tap sets (contact your Stoddart representative for more information)
- Integrated into stainless steel bench top option available

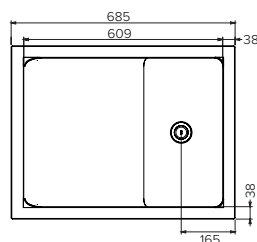

Plan View

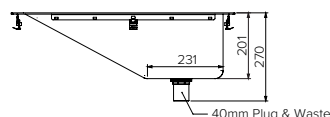

Front View

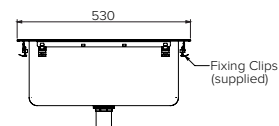

End View

SPPL.BB.DI

Specifications:

Construction: 1.2mm 304 grade, fully welded, seamless stainless steel construction, no.4 satin finish.

Waste Connection: 40mm PVC waste and plug supplied

Unit Fixing: Supplied with bench mounting fixing clips

Model No.	L x D x H (mm)
SPPL.BB.DI	685 x 530 x 201
SPPL.BB.DI.xTH	737 x 530 x 201

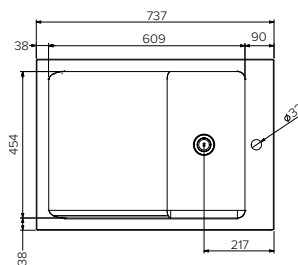

Plan View

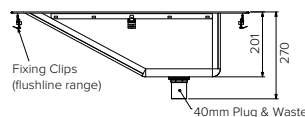

Front View

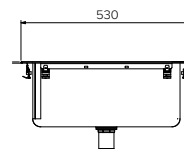

End View

SPPL.BB.DI.1TH



Proudly Manufactured in Australia

Due to continuous product research and development, the information contained herein is subject to change without notice.

Revision: A - 21/06/2021

www.stoddart.com.au

www.stoddart.co.nz