

## Metro - Freestanding

### Model: SPPL.DF.Mx.FS.yy

SPPL = Stoddart Plumbing Product  
 DF = Drinking Fountain  
 Mx = MS = Metro Single  
 = MD = Metro Dual  
 FS = Freestanding  
 yy = DB = Dog bowl (hinged, includes tap for filling)  
 = BF = Bottle filler

eg.: for specification and ordering quote

Code: SPPL.DF.MD.FS.SP

### Features and Benefits:

- Ideal for parks and outdoor areas
- Easy-Push buttons & valves supply a regulated flow of fresh clean drinking water while reducing water waste
- Large rounded collection bowl prevents excess water on the ground
- Optional dog bowl and filling tap can be added to the post
- Robust & vandal resistant for outdoor use with plumbing connections access via secure access panels
- Corrosion resistant to provide years of trouble free service in marine environments
- All optional tapware are WELS and Watermark approved

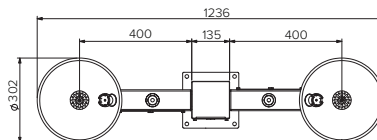

Plan View

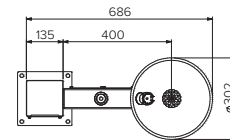

Plan View

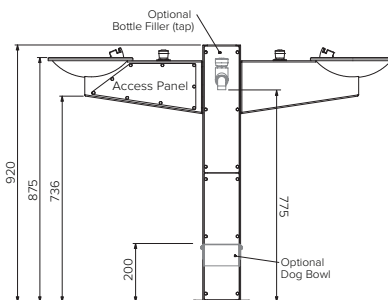

Front View

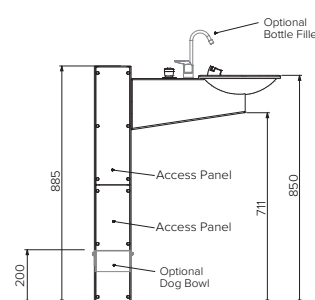

Front View

### Specifications:

**Construction:** 316 grade stainless steel construction, no.4 satin finish. Unit is pre-plumbed with button and bubbler.

**Water Connection:** Single 15mm (1/2" BSP)

**Waste Connection:** 40mm waste connection

**Unit Fixing:** The unit is welded to a 6mm thick stainless steel floor mounting plate with 13mm fixing holes. Drink fountain access plates are fitted to bowl arm and post with 6mm fixings.

Model No.	L x D x H (mm)
SPPL.DF.MD.FS.SP	1236 x 302 x 920
SPPL.DF.MS.FS.SP	686 x 302 x 885

### Optional Extras:

Tapware Options:



Due to continuous product research and development, the information contained herein is subject to change without notice.

Revision: A - 10/05/2024

www.stoddart.com.au  
 www.stoddart.co.nz



Suitable for use where disabled access is required



Proudly Manufactured in Australia



STODDART®