

Keyboard Tray Installation Instructions

1.

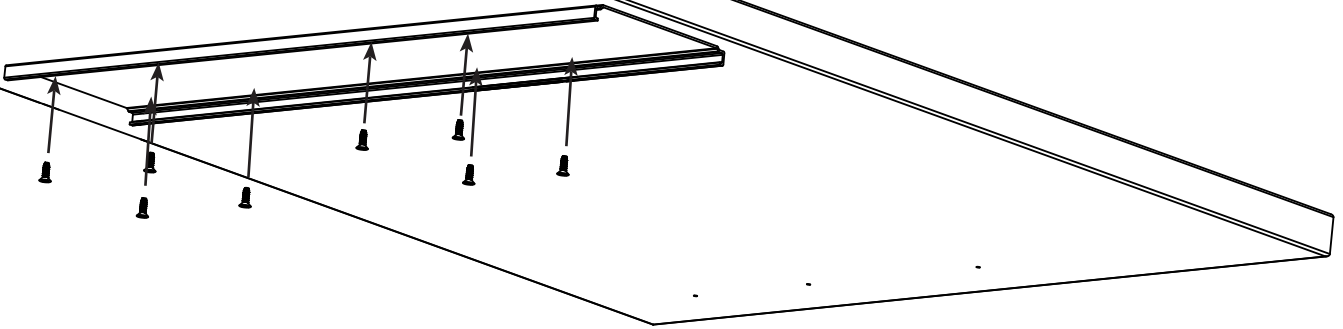

Using template provided, install keyboard track onto underside of worksurface.

2.

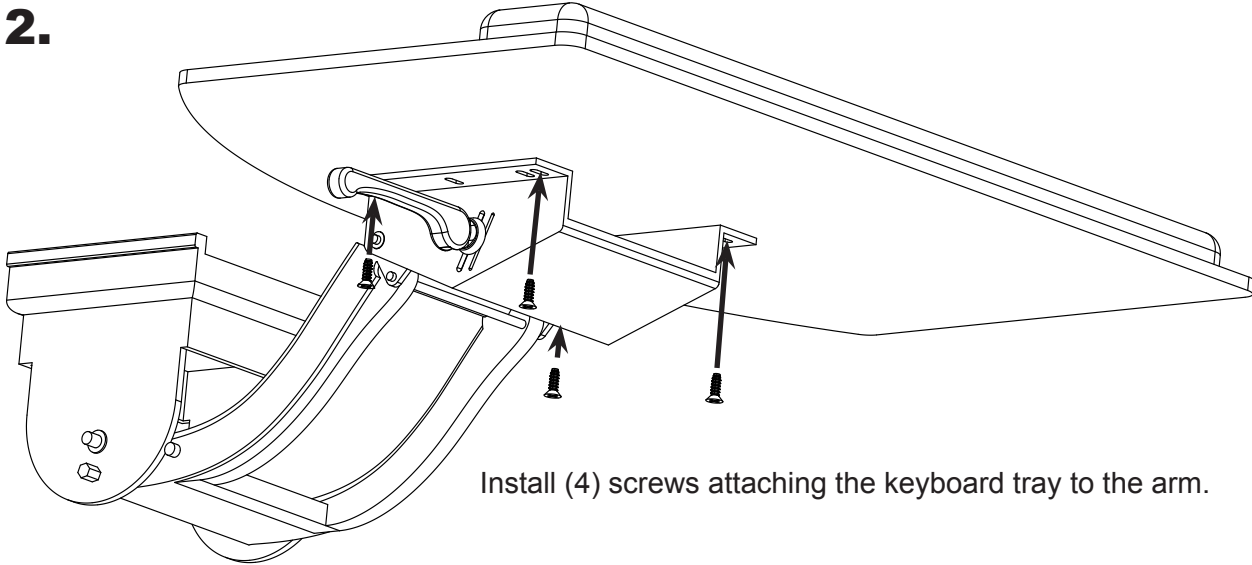

Install (4) screws attaching the keyboard tray to the arm.

3.

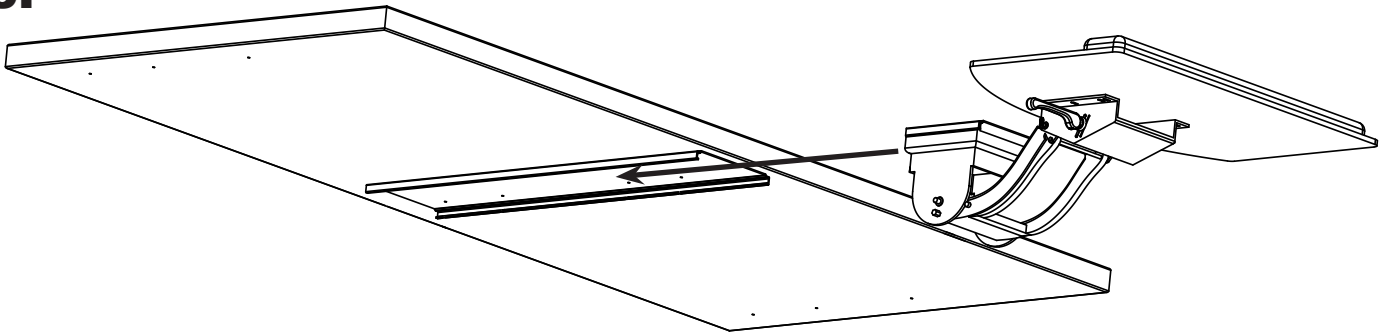

Install keyboard tray/arm into track on underside of worksurface.

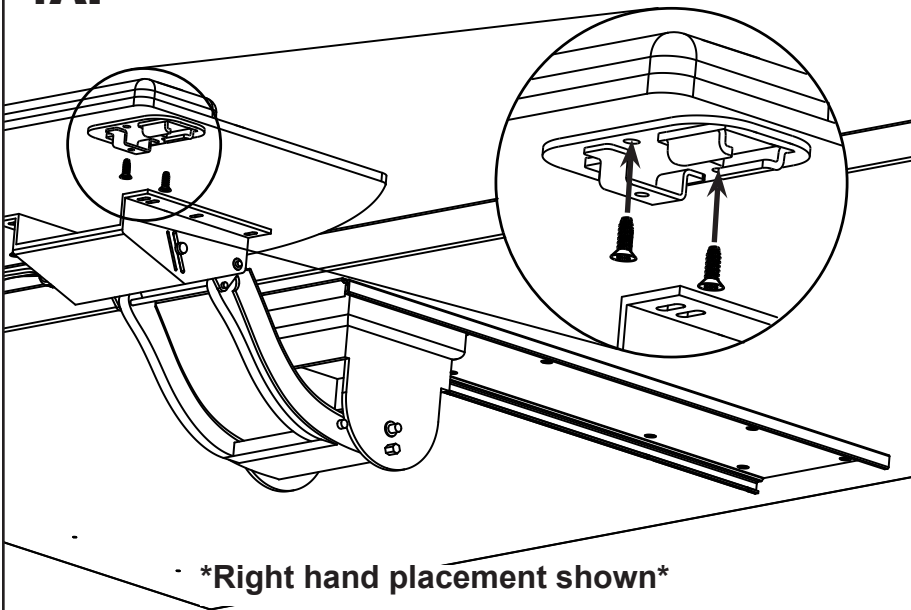
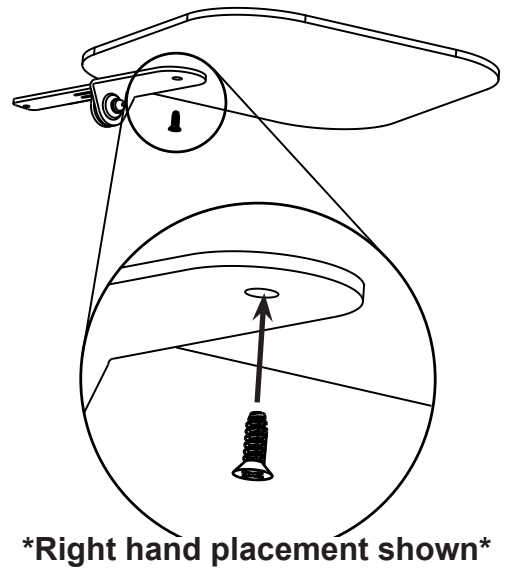
4A.**4B.**

Determine if you want a right or left handed placement. Install bracketry on side that you want to install the mouse tray using (1) screw. Install bracketry onto mouse tray using (1) screw.

5.