

Allsteel®

Aspect™

Specification Guide 2021

PDF updated October 11, 2022

GLASS TYPES

FRAMELESS GLASS PANELS

1/2" Tempered Clear - Grade 1.....	HA
1/2" Tempered Low Iron - Grade 4.....	HB
1/2" Laminated Clear - Grade 2.....	HC
1/2" Laminated Low Iron - Grade 5.....	HD
1/2" Laminated High Performance Clear - Grade 3.....	HG
1/2" Laminated High Performance Low Iron - Grade 6 ..	HH

FRAMELESS GLASS DOORS

1/2" Tempered Clear - Grade 1.....	HA
1/2" Tempered Low Iron - Grade 4.....	HB

FRAME FINISHES

PAINT COLOR SELECTION - GRADE 1

Textured Black Mica <i>Discontinued 6/30/2022</i>	P6P
Brownstone	P7D
Cinder	P7Q
Designer White	PJW
Flint	P02
Fossil	P28
Loft.....	P7B
Muslin.....	P4J
Pebble.....	P8R
Pewter.....	P8D
Salt	P8C
Textured Charblack.....	XCBK
Textured Designer White	PK7
Titanium.....	P8T

PAINT COLORS - GRADE 2

Designer White High Gloss 65	P8W
Matte Gold	P8G
Night Bronze	P8B
Pyrite.....	PJE
Silver	PR6
Solar Black	P8X

ANODIZED ALUMINUM

Satin Anodized Aluminum	SAL
-------------------------------	-----

VENEER FINISHES

STRATAWOOD VENEERS - GRADE 1

Beigewood	SE878
Belair	SE934
Burnished Cherry	SC777
Cinnamon/Biltmore Cherry	SC260
Clear Cherry	SC700
Clear Maple	SE800
Clear Rift Oak.....	SF300
Clear Silver Oak.....	SB100
Dark Rift Oak	SF331
Field Elm	SE599
Florence Walnut	ST579
Harvest Maple	SE856
Light Cherry.....	SC701
Light Walnut	ST601
Lowell Ash Cherry	SC394
Phantom Ecu.....	SE912
Pinnacle Walnut.....	ST679
Portico Teak.....	SB150
Shaker Cherry.....	SC774
Skyline Walnut.....	ST625
Sumatra Walnut.....	ST693

NATURAL VENEERS - GRADE 1

Burnished Cherry	NC777
Cinnamon/Biltmore Cherry	NC260
Clear Maple	NE800
Ebony Walnut	NT509
Florence Walnut	NT579
Harvest Maple	NE856
Light Cherry.....	NC701
Light Walnut	NT601
Lowell Ash	NC394
Medium Red Cherry.....	NC512
Nutmeg Walnut.....	NT629
Pinnacle Walnut.....	NT679
Shaker Cherry.....	NC774
Skyline Walnut.....	NT625
Sumatra Walnut.....	NT693

NATURAL VENEERS - GRADE 2

Dark Rift Cut Oak	RF331
Fawn Cypress Rift Cut Oak.....	RF108
Light Rift Cut Oak	RF301
Phantom Ecu Rift Cut Oak.....	RF912

LAMINATE FINISHES

SOLID LAMINATES - GRADE 1

Black.....	P
Brownstone	LM13
Bungalow	LM12
Designer White	LDW1
Flint.....	LM16
Fossil Shale	LEH1
Loft.....	LM11
Muslin.....	LM15
Titanium.....	LT11

WOODGRAIN LAMINATES - GRADE 1

Belair	LWBA
Bourbon Cherry.....	H
Field Elm	LWFE
Florence Walnut	LFW1
Kingswood Walnut.....	LK11
NeoWalnut.....	LNU1
Pinnacle.....	PINC
Shaker Cherry.....	LW7C

WOODGRAIN LAMINATES - GRADE 2

Beigewood	LWBE
Fawn Cypress	LFC1
Lowell Ash	LLA1
Mangalore Mango.....	LMM1
Natural Recon.....	LN1
Phantom Charcoal.....	LPC1
Phantom Ecu	LPE1
Portico Teak.....	LPT1
Skyline Walnut.....	LSW1
Veranda Teak.....	LVT1

WOODGRAIN LAMINATES - GRADE 3

Natural Walnut	LWNW
----------------------	------

PAINTED WOOD DOOR FINISHES

PAINT COLOR OPTION - GRADE 1

Black.....	P27
Brownstone	P7D
Designer White	PJW
Flint.....	P02
Fossil	P28
Loft.....	P7B
Muslin.....	P4J

POLYMERS

VERTICAL FILLERS

Clear Polycarbonate	CPC
---------------------------	-----

EXPOSED DOOR HARDWARE FINISHES

Silver.....	SIL
Black.....	BLK

Aspect™ supports how companies work. A refined frameless glass wall system creates space division through openness and visual transparency while facilitating acoustical privacy. A continuous reveal and low-profile trim seamlessly frames the exterior of each element, and a variety of glass, door, hardware and finish options provide choice in crafting a unique brand story.

Front Entry

Universal low-profile trim creates clean transitions between horizontal and vertical elements while also ensuring installation consistency and ease. Two- and three-way trim pieces arrive pre-mitered for optimal fit and finish.



Phone Booths

Beautiful, frameless glass installs quickly. Trim profiles have consistent dimensions at the ceiling, floor and wall start conditions. Base trim remains flush with the floor because glass is leveled inside the base channel. Minimal vertical fillers offer a clean aesthetic and eliminate the need for caulking.

Office & Conference Rooms

Half-inch thick laminated glass and minimally designed glazing connections ensure a tight sound seal for superior acoustical performance while creating spaces filled with natural light.



Table of Contents

Aspect™

Finishes	Inside Front Cover	Working with Aspect	38-78
General Overview	1	Sliding Doors	40-46
Table of Contents	2	Center Swing Pivot Doors	47-54
New, Revised, & Discontinued Products	3-5	Hinged Doors	55-63
Glass Types and Hardware Finishes	6-11	Working with Doors	64-66
Frame Finishes.....	6	Frameless Glass.....	67-70
Solid Doors Veneer Finishes	7	Trim, Wall Channels, & Drywall End Cap.....	71-78
Solid Doors Laminate Finishes.....	8	New, Revised, & Discontinued Products	79
Solid Wood Painted Doors.....	9	Appendix	80
Glass Information & Acoustical Performance.....	10		
Hardware Finishes.....	11		
Limited Lifetime Warranty	12		
Special Paint, Stain, and Laminate Policy	13		
Veneer Care	14		
Definitions and Acronyms	15-17		
Sustainability Information	18		
Overview of Aspect	19-20		
Frameless Glass Panels	19		
Doors	19		
Door Hardware.....	20		
Pre-Specification Guide	21-37		
Product Tolerance	22		
Field Measurements.....	23		
Field Measurements Example	24		
Addressing Tolerance Issues.....	25		
Ceiling / Floor Connection Rules.....	26-29		
Sliding Door Connection.....	30		
Door / Weight Support Requirement.....	31		
Product Testing	32		
Site Review.....	33		
Selling/Installing Aspect in a Seismic Zone.....	34-37		

OVERVIEW

TABLE OF CONTENTS

NEW, REVISED, & DISCONTINUED

MATERIALS AND FINISHES

WARRANTY

POLICIES AND PRODUCT CARE

DEFINITIONS AND ACRONYMS

Models Discontinued December 31, 2020

Base Model	Description	Replacement Model
BYLPG12	Door Pull - 12" Ladder Pull GL Door	AS-PULL12
BYRPG	Door Pull - 20"H Ladder Pull GL Door	AS-PULL20
BYLPG60	Door Pull - 60"H Ladder Pull GL Door	AS-PULL60
BYLPG72	Door Pull - 72"H Ladder Pull GL Door	49" and 60" Passage and Locking pulls available

MODEL REFERENCE GUIDE







OLD BASE MODEL	OLD DESCRIPTION	NEW BASE MODEL	NEW DESCRIPTION
BYLPG12	Door Pull - 12" Ladder Pull GL Door	AS-PULL12	12" Ladder Pull (Aspect)
BYLPG60	Door Pull - Ladder Pull GL Door	AS-PULL60	60" Ladder Pull (Aspect)
BYLPW12	Door Pull - Ladder Pull WD/AL Door	AS-PULL12	12" Ladder Pull (Aspect)
BYLPW60	Door Pull - 60H Ladder Pull WD/AL Door	AS-PULL60	60" Ladder Pull (Aspect)
BYRPG	Door Pull - 20H Ladder Pull GL Door	AS-PULL20	20" Ladder Pull (Aspect)
BYRPW	Door Pull - 20H Ladder Pull WD/AL Door	AS-PULL20	20" Ladder Pull (Aspect)
NFDWDA	Drywall Endcap Door Adapter	AS-DECAPADAPTER	Door to Drywall Endcap Adapter
NFDWT	Drywall Endcap Tee	AS-ENDCAP	Drywall Endcap
NFGPN	Half Inch Frameless Glass	AS-SGFRMLSTPANEL	Frameless Glass Panel, Tempered
NFGPN	Half Inch Frameless Glass	AS-SGFRMLSLPANEL	Frameless Glass Panel, Laminated
NFHDDSWS	Drop Seal - Hinged Wood Single	AS-SLDBTMSEAL	Solid Hinged Door Bottom Seal
NFHDFD	Hinged Wood Door Frame - Double	AS-HDFFRAME	Hinged Door Frame
NFHDFS	Hinged Wood Door Frame - Single	AS-HDFFRAME	Hinged Door Frame
NFHDFSG	Hinged Glass Door Frame - Single	AS-HDFFRAME	Hinged Door Frame
NFHDWD	Wood Door - Hinged Double	AS-SLDHLEAF	Solid Hinged Door Leaf
NFHDWS	Wood Door - Hinged Single	AS-SLDHLEAF	Solid Hinged Door Leaf
NFIK	Installation Kit	AS-INSTALLKIT	Installation Kit
NFPDFS	Pivot Glass Door Frame - Single	AS-PDFRAME	Pivot Door Frame
NFPDFSMC	Pivot Glass Dr Frame- Single for Magnetic Catch	AS-PDFRAME	Pivot Door Frame
NFPDGS	Frameless Glass Door - Pivot Single	AS-FGPDLEAF	Frameless Glass Pivot Door Leaf
NFPDGSMC	Frameless Gls Dr-Pivot Single for Magnetic Catch	AS-FGPDLEAF	Frameless Glass Pivot Door Leaf
NFSDFD	Sliding Glass Door Frame - Double	AS-SDFRAME	Sliding Door Frame
NFSDFS	Sliding Glass Door Frame - Single	AS-SDFRAME	Sliding Door Frame
NFSDGDT	Frameless GlsDr Sliding 3/8" ThickGls Double	AS-FGSDLEAF	Frameless Glass Sliding Door Leaf
NFSDGST	Frameless GlsDr Sliding 3/8" ThickGls Single	AS-FGSDLEAF	Frameless Glass Sliding Door Leaf
NFSK	Service Kit	AS-SERVICEKIT	Service Kit
NFTKL	1/2" Floor and Ceiling Trim Kit - 2-Way	AS-SGU2PCTRIM	Universal Two-Piece Floor and Ceiling Trim
NFTKS	1/2" Floor and Ceiling Trim Kit - Straight	AS-SGU2PCTRIM	Universal Two-Piece Floor and Ceiling Trim
NFTKT	1/2" Floor and Ceiling Trim Kit - 3-Way	AS-SGU2PCTRIM	Universal Two-Piece Floor and Ceiling Trim
NVFL	1/2" Vertical Filler - 2-Way	AS-FGFILLER	Vertical Filler
NVFT	1/2" Vertical Filler - 3-Way	AS-FGFILLER	Vertical Filler
NVGC	1/2" Glazing Connection - Straight	AS-FGFILLER	Vertical Filler
NFWCFD	Wall Channel - Door Frame to Drywall	AS-DWCHANNEL	Wall Channel - Door Frame to Drywall
NFWCGD	1/2" Wall Channel - Vertical Trim Kit	AS-SGWCHANNEL	Vertical Frameless Glass Wall Channel
NFSDFS / NFSDFD	Sliding Glass Door Frame - Single / Double	AS-SDTRACK	Sliding Door Track
NFPDGSMCR	Frameless Glass Door - Pivot, Single for Magnetic Catch	AS-FGPDLEAF	Frameless Glass Pivot Door Leaf
NFSDGDTR	Frameless Glass Door - Sliding, 3/8" Thick Glass, Double	AS-FGSDLEAF	Frameless Glass Sliding Door Leaf
NFSDGSTR	Frameless Glass Door - Sliding, 3/8" Thick Glass, Single	AS-FGSDLEAF	Frameless Glass Sliding Door Leaf
NFHDSG	Frameless Glass Door - Hinged, Single	AS-FGHDLEAF	Frameless Glass Hinged Door Leaf
NFHDSGR	Frameless Glass Door - Hinged, Single	AS-FGHDLEAF	Frameless Glass Hinged Door Leaf
NVFS	NOF VRT FILLER 3 WAY	AS-FGFILLER	Vertical Filler
APCHLPG12	12" Pull - Glass	AS-PULL12	12" Ladder Pull (Aspect)
APCHLP60	60" Pull	AS-PULL60	60" Ladder Pull (Aspect)
APCHLPW12	12" Pull - Wood	AS-PULL12	12" Ladder Pull (Aspect)
APCHLP60	60" Pull	AS-PULL60	60" Ladder Pull (Aspect)
APCHLP20	20" Pull	AS-PULL20	20" Ladder Pull (Aspect)
APCHLP20	20" Pull	AS-PULL20	20" Ladder Pull (Aspect)
APCHLP49	49" Pull	AS-PULL49	49" Ladder Pull (Aspect)

Paint Color Selection

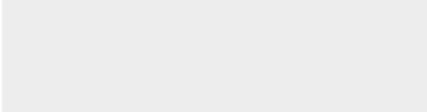
Paint Colors – Grade 1

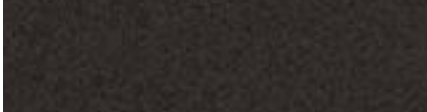
 Designer White P JW	 Textured Designer White PK7	 Loft P7B
 Salt P8C	 Muslin P4J	 Pebble P8R
 Fossil P28	 Titanium P8T	 Pewter P8D
 Flint P02	 Cinder P7Q	 Brownstone P7D
 Textured Black Mica <i>Discontinued 6/30/2022</i> P6P	 Textured Charblack XCBK	

Paint Colors – Grade 2

 Designer White High Gloss 65 P8W	 Matte Gold P8G	 Night Bronze P8B
 Pyrite PJE	 Silver PR6	 Solar Black P8X

Anodized Aluminum – Grade 1

 Satin Anodized Aluminum SAL
--

Stratawood Veneers – Grade 1

		
Clear Maple SE800	Clear Oak SF300	Silver Oak SB100
		
Light Cherry SC701	Light Walnut ST601	Burnished Cherry SC777
		
Dark Rift Oak SF331	Cinnamon/Biltmore Cherry SC260	Lowell Ash Cherry SC394
		
Clear Cherry SC700	Shaker Cherry SC774	Harvest Maple SE856
		
Phantom Ecu SE912	Field Elm SE599	Belair SE934
		
Beigewood SE878	Portico Teak SB150	Skyline Walnut ST625
		
Pinnacle Walnut ST679	Sumatra Walnut ST693	Florence Walnut ST579

Natural Veneers - Grade 1*



Natural Maple NE800



Light Cherry NC701



Burnished Cherry NC777



Light Walnut NT601



Lowell Ash NC394



Shaker Cherry NC774



Cinnamon/Biltmore Cherry NC260



Medium Red Cherry NC512



Harvest Maple NE856



Clear Maple NE800



Skyline Walnut NT625



Nutmeg Walnut NT629



Pinnacle Walnut NT679



Sumatra Walnut NT693



Ebony Walnut NT509

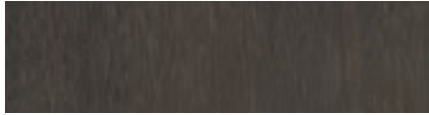

Florence Walnut NT579

Natural Veneers - Grade 2*

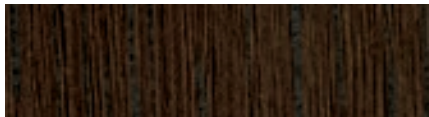

Dark Rift Cut Oak RF331



Light Rift Cut Oak RF301



Phantom Ecru Rift Cut Oak RF912



Fawn Cypress Rift Cut Oak RF108

Solid Door Laminate Finishes

Aspect™ — Materials and Finishes

Laminates – Grade 1

Solid

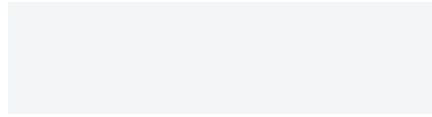

Designer White

LDW1



Muslin

LM15



Loft

LM11



Bungalow

LM12



Titanium

LT11



Fossil Shale

LEH1

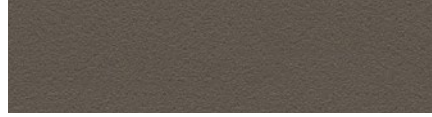

Brownstone

LM13



Flint

LM16



Black

P

Woodgrain



Kingswood Walnut

LK11



NeoWalnut

LNU1



Shaker Cherry

LW7C



Florence Walnut

LFW1



Belair

LWBA



Field Elm

LWFE



Bourbon Cherry

H



Pinnacle

PINC

Laminates – Grade 2

Woodgrain



Phantom Ecru

LPE1



Beigewood

LWBE



Fawn Cypress

LFC1



Natural Recon

LNR1



Portico Teak

LPT1



Phantom Charcoal

LPC1



Mangalore Mango

LMM1



Lowell Ash

LLA1



Skyline Walnut

LSW1



Veranda Teak

LVT1

Laminates – Grade 3

Woodgrain



Natural Walnut

LWNW

Painted Wood Doors

Paint Colors – Grade 1



Designer White PJW



Loft P7B

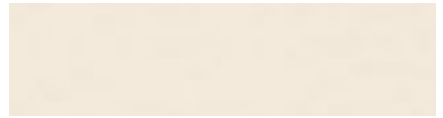

Muslin P4J

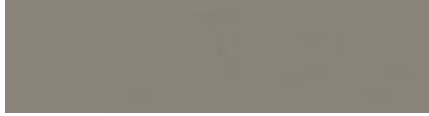

Fossil P28



Flint P02

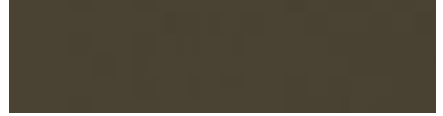

Brownstone P7D



Black P27

Aspect glass comes in a variety of thicknesses and opacities. All Aspect glass meets ANSI Z97.1 safety glass standard. Different types of glass can be specified to boost acoustic properties, add visual privacy, or create an artistic look.

Glass Thickness Options

- Frameless: ½"

Glass Types

- Tempered glass is one sheet of heat-treated safety glass.
- Laminated annealed glass is made of up two pieces of heat-treated safety glass that are secured together. Laminated glass boosts acoustic properties and typically carries a higher STC rating.
- Performance or high acoustic laminated glass further boosts acoustic properties. A thin, transparent film is placed between the sheets of laminated glass that reduces sound travel and gains additional STC points.

Glass Colors

- Clear glass has a slight greenish hue when glass is viewed from the edges or side profile.
- Low iron glass is ultra-clear and of higher transparency and clarity than clear float glass. Generally, the green hue of the glass is reduced. It is typically more expensive than clear float glass.
- Translucent white laminated has a medium light transmission level of 65%, meaning it's semi-transparent.
- White marker board laminated has a low light transmission level of 10%, meaning it's nearly opaque. The lower the light transmission level, the more difficult it is to see through the glass.

Glass Codes

- Glass codes are universal across the Allsteel Architectural Products offering. See specification pages for details on specific models:

Description	Code	Grade
½" Tempered Clear	HA	1
½" Tempered Low Iron	HB	4
½" Laminated Clear	HC	2
½" Laminated Low Iron	HD	5
½" Laminated, High Performance Clear	HG	3
½" Laminated, High Performance Low Iron	HH	6

Acoustical Performance

Glass Panels	STC Result
½" Laminated Glass	36
½" Laminated Glass, High Performance	39

STC test results represent testing of a fully assembled panel.

Exposed Door Hardware Finishes



Black

BLK



Silver

SIL

Our unwavering commitment to our customers compels us to care, and our dedication to quality is just one of the ways we show our customers how much they mean to us.

We recognize that keeping up with the pace of change requires having products that work as hard as the people who use them. That's why each of our products is rigorously tested and certified to meet the highest industry standards.

In the unlikely event that any Allsteel product or component covered by the Allsteel Warranty should fail under normal workplace use because of defective material or workmanship, Allsteel promises to fix it. Because taking care of *people* is how Allsteel takes care of business.

For information on Allsteel's warranty coverage, visit AllsteelOffice.com.

Special Paint and Stain Policy

Allsteel at its own discretion may modify its standard products with non-standard paint and stain colors to meet specific needs. Dealer is required to submit a special paint or stain request via the Tailored Solutions Application on Synergy. A sample of the non-standard paint or stain color desired will be required for matching. Pricing, lead time, and order information will be provided at the time of approval.

- For each new requested stain or paint, there will be a \$500 net fee to cover supplier costs to match the special item.
- For existing, previously-approved stains or paints, there is no \$500 matching fee, however, there is a sample chip fee of \$175 net for stains and \$100 net for paints.
- Samples, preferably at least 3" x 5" chips, of the exact color desired should be sent to the Allsteel Tailored Products Group. Paint matches require (3) sample chips, and stain matches require (3) sample chips. Please mail these sample chips to the address below and reference the Special Item Request Number from Tailored Solutions.

Allsteel Inc.

Attn: COM Department
Dock Doors 46-48
3000 North Hwy 61
Muscatine, IA 52761

- Allsteel will color match the sample and send control samples to the address provided in the request. Dealer will review Allsteel's color match and approve by signing the back of the sample chip. Send the signed sample back to the Allsteel Tailored Products Group.
- Product pricing for all special paints falls under the Select Paint price grade.
- Orders will not be accepted until Allsteel receives the Dealer's written approval on the color match.
- Extended lead times will apply on orders containing special paints or stains.
- Due to manufacturing techniques, materials, and quality issues, some exclusions will apply and some matches may be declined.

Important Notes

- Natural veneer is subject to nature's quality control. Differences in grain and color are naturally occurring variations and cannot be controlled by the manufacturer and cannot be considered as product defects. Natural veneer has the characteristics and beauty of a living organism; with its own variations of grain, growth, and color patterns. For these reasons, natural veneer is preferred by many for its warmth and personal characteristics.
- Color changes will occur over time when wood is exposed to light. For this reason, when new product is ordered as an addition to existing product, there will be color variances between the old and new product. Please remember when specifying new product that although the species of veneer will be the same, additional product is being manufactured from a different tree. It may take several months for the new furniture to mature to the color level of existing product. Even with this maturation process the additional product will not be an exact match.

Special Laminate Policy

The Company, at its own discretion, may modify its standard products with non-standard laminates to meet specific needs. Contact the Allsteel Tailored Products Group for pre-approved **Wilsonart, Formica, Nevamar, and Pionite** laminates and pricing for special laminates. When requesting a special laminate please supply manufacturer, along with name and pattern number of laminate.

- Extended lead times will apply on orders containing special laminates.
- Due to manufacturing techniques, materials, and quality issues, some product exclusions will apply and some requests may be declined.

Veneer Care Instructions

Veneer worksurfaces feature the Gunlocke® finishing system. The finishing system is a process that begins with the application of stains, which promote exceptional depth and clarity. Next the worksurface receives a specialized coating that provides exceptional durability and chemical resistance. The remaining surfaces receive a top coat. These finishing processes ensure depth, clarity, color consistency, and durability throughout the product.

Veneer worksurfaces have exceptional resistance to:

- Heat and moisture (hot beverages, pizza boxes)
- Chemicals (liquid paper, nail polish)
- Stains (permanent markers)
- Scratches and impact (everyday wear and tear)

Caring for your veneer finish:

- General maintenance procedures entail wiping clean the entire surface with a clean, water-dampened soft cloth once per week (be sure to wipe with the grain).
- Murphy's® Oil Soap may be used as a general purpose type cleaner with warm water to clean tops. Use with Guardsman® Furniture Polish (contains no waxes or silicones) to provide renewed luster.
- Be sure to wipe up all spills immediately. Do not allow spills to dry.

Wood owes its inherent beauty to variations in color, grain, and texture, and therefore, these variations are not considered defects. There may be minor variations from one piece of furniture to the next even though they are finished at the same time. Exposure to light and the aging process will cause a darkening of natural wood products. Light finishes on wood products do not mask the natural characteristics of wood. Allsteel does not guarantee the exact matching of grain, pattern, and color.

A

AFF: Above finished floor. Most commonly used when indicating the port-height locations on electrical posts in hardwired power applications. For example, 18" AFF indicates 18"H to the centerline of the receptacle above finished floor.

ADA: Americans with Disabilities Act.

Adapter: Painted or anodized aluminum post that is used to attach frameless glass panels to doors.

Adjustable Footer: Can be applied to certain doors to minimize the space between the door and the floor (undercut) to enhance acoustics. This allows for the ability to maintain one door height within a space, thus increasing overall flexibility.

Anodized Aluminum: Aluminum coated by an electrolytic process to produce an oxide film that is corrosion-resistant.

Architectural Wall: Vertical formal partition used to divide or enclose space, or support another structure.

Aspect: Allsteel's low profile, frameless glass demountable wall system.

B

Back-painted Glass: Any form of glass that is painted from the back side and viewed from the front side.

Ball-bearing Hinges: Used when hanging a door. Ball-bearing hinges differ from plain-bearing hinges in that they have a steel ball or buffer in between the knuckles.

Beaded Lite: Referring to wood doors with glass inserts. With this construction, most often there is a (standard quarter round) bead on both sides of the glass to hold it in place. This is the more cost-effective option as compared to the beadless lite construction.

Beadless Lite: Referring to wood doors with glass inserts in which the top rail is plowed out so the glass can slide in with the opening then plugged. There is a lumber liner on the core around the lite opening. Beadless lite is generally chosen with a cleaner aesthetic in mind, as opposed to the beaded lite construction. It is also generally more expensive.

Bevel: An angled or sloping surface, such as the edge of a door or glass panel.

Butt Joint: A joinery technique without a frame in which two members are joined by simply butting them together.

C

Card Reader: An electronic device used for access control that reads a magnetic strip on an access card to allow the opening of a door.

CET: Specification software used for designing, planning and configuring of Allsteel products.

Ceiling Attenuation Class (CAC): A measure for rating the performance of a ceiling system as a barrier to airborne sound transmission through a common plenum between adjacent closed spaces such as offices. A ceiling system with a CAC less than 25 is generally considered low performance, whereas a ceiling system with a CAC greater than 35 is generally considered high performance.

Ceiling Grid – Fine Line: A narrow profile slotted grid system with ¼" or ⅝" reveal.

Ceiling Grid – Service or Direct Mount (Flush): A narrow profile slotted grid system with no reveal.

Chamfer: A beveled edge connecting two surfaces.

Clerestory: A high section of wall that contains windows above eye level used to admit light.

Closer: Commonly refers to a door closer. A mechanical device that closes a door, in general, after someone opens it or after it was automatically opened.

Conduit: Tube to route electrical or data wiring within the wall or panel system.

Construction Specifications Institute (CSI): An organization that records and updates the standardization of construction language as it pertains to building specifications.

Crash Bar: See Panic Bar.

Cylindrical Lock: A lock where the keyhole and tumbler mechanisms are contained in the door handle.

Cylindrical Passage Set: A functioning door handle applied to two sides of the door leaf with no locking mechanism included.

D

Demising Wall: A common wall between two units. For demountable walls, this most commonly refers to replacing drywall with solid walls perpendicular to glass panels/storefronts.

Demountable Wall: A non-load-bearing wall made of prefabricated sections that can be readily disassembled and relocated. These walls may be full height or partial height.

Detent: On a swing (or hinged frameless glass) door, this commonly refers to the "hold open function" when specifying a closer.

Door Frame: Creates the structure for mounting the various door types. A door frame consists of one header and two jamb legs. Depending on the door type, the frame may also include a partial or full strike.

Door Hardware: Locks, handles, etc., designed for use on doors.

Door Head: The horizontal upper member of a door frame.

Door Hinges: Mounting hardware that is often handed when referring to hinged swing doors. Allsteel uses ball-bearing hinges for solid and aluminum framed swing doors and self-closing hydraulic hinges for frameless swing doors.

Door Jamb: The part of a door frame which surrounds and contacts the edges of the stiles and top rail of a door. Jamb may be classified as (1) "head" or "side" jamba and (2) "plain" or "rabbeted."

Door Skin: The front or face panel (usually two or more plies) of a flush door.

Door Stop: Any device or object used to halt the motion of a door, such as a large or heavy object, a wedge, or some piece of hardware fixed to the floor, door, or wall.

Door Strike: Metal plate affixed to a door jamb with a hole(s) to receive the door bolt. This keeps the door from swinging in two directions and assists in holding the door closed.

Door Track: A metal track or rail on which a sliding door moves.

Drop Seal: A door mechanism activated on closure that eliminates an undercut of up to ¾" with a rubberized seal. Used to provide improved acoustic performance.

Dropped Ceiling: A secondary ceiling, hung below the main (structural) ceiling. It may also be referred to as a drop ceiling, T-bar ceiling, false ceiling, or suspended ceiling, and is a staple of modern construction and architecture. The area above the dropped ceiling is called the plenum space, as it is sometimes used for HVAC air returns. The plenum space is also very commonly used to conceal piping, wiring, and/or ductwork.

Drywall End Cap: Painted or anodized aluminum post that conceals the demising wall in between two panels or doors to give the appearance of a continuous run.

E

Electric Strike: An access control device used for doors. It replaces the fixed strike faceplate often used with a latch bar (also known as a keeper).

End-of-Run Finished End: Painted or anodized aluminum cap to finish the end of a wall when it is not attached to construction.

Extrusion: Long profiles of aluminum or plastic used in construction of demountable walls. An example would be an aluminum post or trim.

F

Finished Floor: The floor, usually laid over a subfloor, which provides the completed floor surface.

Flexible Sweep: A rubber or vinyl strip that easily bends and is applied to the bottom of a door to create an effective seal against the sill (threshold).

Float: Amount of adjustment at the ceiling or base.

Float Glass: A process of making glass. A sheet of glass is made by floating molten glass on a bed of molten metal, typically tin. This method gives the sheet uniform thickness and very flat surfaces. This process is also known as the Pilkington Process. Float glass is further processed as tempered or laminated prior to being used in Allsteel products.

FSC® Veneer: The Forest Stewardship Council, FSC® is an independent, non-governmental, not-for-profit organization established to promote the responsible management of the world's forests. The certification system provides internationally recognized standard-setting, trademark assurance and accreditation services to companies, organizations, and communities interested in responsible forestry. Allsteel veneers, laminates, and painted wood materials are available FSC certified.

Full Strike: Door seal or stop found along the edge of the door frame to provide higher acoustics. For a sliding door, it is found only on one edge of the frame, but on aluminum and solid doors it would be found on three edges.

Furniture Integration: All solid frames include slotted standards in the verticals for furniture-mounting capability.

G

Gasket: A seal used inside aluminum trim to prevent the glass from touching the aluminum. The seal adds to the prevention of sound leakage.

Gypsum: A rigid board made of layers of fiberboard or paper bonded to a gypsum plaster core, used instead of plaster or wood panels in construction to form walls. This is not considered a strong environmental solution due to the inability to recycle.

H

Half Mortise Hinged: A door hinge with one plate surface-mounted on the jamb and the other plate mortised into the door stile.

Handed: Doors are typically right- or left-handed, referring to the position of the door and direction in which it opens.

Hard Lid Ceiling (Lid): Gypsum board applied to the underside of the structure above and taped and finished as opposed to an exposed structure with a suspended acoustical tile ceiling or other finish.

Hinged Door: An exterior or interior door hung by attaching butts to the stile so that the door swings on a vertical axis. These doors may be single (swinging through 90 degrees) or double-acting (swinging through 180 degrees). Double-acting doors do not require a door stop. Utilizes a 39"W door frame.

I

Interchangeable Core: A compact keying mechanism within a given format. This is most commonly used when referring to SFIC (small format) or LFIC (large format).

J

Junction Box (J-Box): Container for electrical connections, usually intended to conceal them from sight and deter tampering.

K

Knuckles: The cylindrical portion of a hinge through which the pin passes.

L

Ladder Pull: Door hardware with a tubular pull design that attaches to the door through perforations. Can be locking or non-locking.

Laminated Glass: A type of safety glass consisting of two sheets of glass bonded together with an interlayer. Laminated glass increases the STC rating and can add color and opacity.

Laminite Marker Board: A marker board made from coated steel. Similar in performance to porcelain.

Lites: Refers to the pieces of glass that are cut, prepared, and used to create the window or door (related terms: toplite, sidelite, backlite). Lites are also known as tiers.

Leveling Mechanism: A lift that allows the glass to accommodate height variations in the floor.

Low-iron Glass: Ultra-clear glass of higher transparency and clarity than clear float glass. Generally, the green hue of the glass is reduced and it is typically more expensive than clear float glass.

M

Maglock: Refers to an electromagnetic lock or magnetic lock. Consists of an electromagnet and an armature plate. Devices can be either "fail safe" meaning it is unlocked when power is lost or "fail secure" meaning it remains locked when power is lost.

Master Keying: Customizing a lock to be opened through the use of two keys rather than just one.

Miter Joint: The joining of two members at an angle that bisects the angle of junction.

Modular Power: Routes pre-wired electrical power systems in the base of a panel.

Modularity: Allows for ease of reconfiguration and movement of components. For example, if all panels and doors are 42" wide within a project, then they are considered "modular," and are interchangeable. This solution supports a small kit of parts strategy.

Monolithic Tile: A single tile that covers the full surface of a panel.

Mortised Lock: A lock that is in the edge of a door leaf so it cannot be seen or removed when the door is closed. The keyhole and tumbler are usually located above the door handle.

Mortise: A deep recess cut into wood for any of several other purposes, as for receiving a mortise lock.

Mounting Hardware: Any required hardware to install a door and frame. For a sliding door, this includes the sliding track.

Mullion: The upright or vertical member dividing glass panels or panels in a door.

Mutin: A horizontal bar or rigid supporting strip between adjacent panes of glass.

N

Natural Veneer: As opposed to stratawood veneer, natural veneer is subject to nature's quality control, exemplifying differences in grain and color patterns.

Nominal Height: Floor-to-ceiling height used to specify the overall size of a demountable wall product. For example, if a Beyond wall is 108"H nominal, it will fit into a space 107¼"H to 108¾"H as the actual product height will range ± ¼" depending on the flooring and ceiling conditions.

Non-defacing: Method of mounting a component that does not deface the mounting surface.

Non-progressive Panels: Allows a panel to be removed from the run without disturbing the remaining panels.

NRC: Noise Reduction Coefficient is a scalar representation of the amount of sound energy absorbed upon striking a particular surface.

O

Office Front: The face of an office or conference room. Typically consists of several glass panels and a door.

P

Panel Creep: When the connection between panels creates additional panel length/dimension to the run.

Panic Bar: A device for unlocking a door during emergency conditions. The mechanism is made up of a metal bar that is spring-loaded and fixed horizontally to the inside of an outward-opening door. Also called a crash bar, push bar, or panic device.

Partial Strike: Door stop found along part of the edge of the door frame to stop the door from swinging both ways. For center swing pivot doors only.

Particleboard: A formed panel consisting of particles of wood flakes and shavings, bonded together with a synthetic resin or other added binder. The particles are classified by sizes, dried to a uniform moisture content, mixed with binder, mat-formed, compressed to density, and then cured under controlled heat and pressure. Particleboard can be used to create a solid-core door.

Passage: Referring to doors that are non-locking.

(Center Swing) Pivot Door: A door that rotates on two metal pivots on the top and bottom of the door. Center swing pivot doors are made to be non-handed to increase flexibility and support a smaller kit of parts.

Plenum: Area above the ceiling, used for return air.

Plumb: Exactly perpendicular or vertical, or at right angles to the horizon or floor.

Polycarbonate: A type of plastic used in some of Allsteel's vertical fillers.

Ported: Tile or trim that has factory-cut holes for electrical or data components.

Powder Coat: A painting process where a powder material is applied and cured on a metal surface.

Push Bar: See Panic Bar.

PVB Interlayer: Polyvinyl butyral (or PVB) is a resin usually used for applications such as laminated glass that require strong binding, optical clarity, adhesion to many surfaces, toughness, and flexibility. This resin is used to bond two sheets of safety glass together to form laminated glass.

R

Raceway: A channel or cavity that's designed to hold wires and cables.

Rail: The cross or horizontal pieces of a door's framework. "Top rail," "mullion rail," "lock rail," and "bottom rail" are different types of rails based on their location in the structure of the door.

Reveal: The space, or margin, can be between any adjacent surfaces. Often refers to the space between tiles or trim.

S

Seismic Mounting: Special materials and installation method used to secure walls in project locations prone to earthquakes.

Set-back Panel: A glass panel perpendicular to an office front, attaching to a solid demising wall also called a glass return.

Sidelite: Narrow glass panel adjacent to a door.

Sliding Door: A door pulled across a mounted track, rather than turning on hinges. Typically utilizes a 42" wide nominal door frame for a single door. The benefit of this solution is the ability to gain more usable space within an office as opposed to a hinged door.

Slow Open/Close: A mechanism that protects a door from being slammed and automatically opens or closes the door to the fullest extent possible. Also commonly called "soft open/close."

Soffit: Finished construction, usually with drywall, that forms the join between the ceiling and the top of a non-building item.

Sound Transmission Class (STC): An integer rating of how well a building partition attenuates or blocks airborne sound. The higher the number, the better. Allsteel's demountable wall systems have STC ratings that are typically higher than permanent construction.

Stick Built: Wall panels that are constructed entirely or largely on-site rather than in a factory or similar facility.

Stile: The vertical members of a door frame.

Storefront: Typically refers to contractor-built solutions for the face of an office or conference room (several panels and a door).

Stratawood Veneer: A natural, FSC®-certified reconstituted veneer enhanced by technology for consistency in both color and grain pattern. It features a repeatable straight-grain pattern, absent of cathedrals seen in natural veneer or other significant grain and tone variations.

Subfloor: The rough floor which rests on the floor joists and onto which the finished floor is laid. Also known as blind floor or counter floor.

Substrate: Primary or underlying material on which other materials (such as ink, coating, paint, or treatment) are applied, or from which other materials are made.

T

T-Bar: A type of ceiling grid.

Tempered Glass: Tempered glass (or toughened glass) is a type of safety glass processed by controlled thermal or chemical treatments to increase its strength compared to normal glass. Tempered glass is used in passenger vehicle windows, shower doors, refrigerator trays, and much more.

Translucent Glass: Allows varying amounts of light to pass through, as opposed to transparent glass which lets 100% of light through, or opaque which lets 0% of light through.

Transom: A horizontal member separating a door from a window panel above the door, or separating one window above another. Also refers to a transom window which is set above the transom of a door or larger window.

U

Undercut: The space between the bottom of the door and the floor. Allsteel doors feature a ½" undercut.

Unitized: A product construction method where the majority of the assembly occurs in a factory.

V

Veneer: A thin sheet or layer of wood, usually rotary cut, sliced or sawn from a log, bolt, or flitch; thickness may vary from 1/100 to 1/4 of an inch. Also referred to as skin, ply, or veneer ply.

Aspect™ demountable walls play an important role in a workplace that is productive, healthy, and concerned with employee wellness and environmental impacts. Glass walls provide more natural light and better views to the outside, which improves productivity and enjoyment of the space. With more natural light entering the space, less artificial lighting is needed, requiring less energy to be used by the building and its tenant spaces. These factors have been shown to help with talent attraction and retention.

Being durable and demountable allows Aspect walls to be used and reused longer, decreasing the need to extract, refine, and transport natural resources (when compared to traditional drywall construction). The longer a product is used, the lower its environmental footprint. Aspect glass walls drastically minimize off-gassing, compared to drywall painted on-site, so the workplace air quality is better for future occupants from the start. Good indoor air quality can contribute to higher productivity and other wellness benefits. Aspect is Indoor Advantage™ Gold certified and meets ANSI/BIFMA e3 credits 7.6.1, 7.6.2. and 7.6.3.

Aspect demountable walls are level®2 certified to the ANSI/ BIFMA e3 Furniture Sustainability Standard. The product is evaluated by a third-party certifier on performance in the categories of materials, energy and atmosphere, human and ecosystem health, and social responsibility. Not only is the product audited against the standard, but also the manufacturing site and the organization. level®2 is the second-highest achievement.

LEED® Project Contributions

Aspect demountable walls can support LEED® projects by contributing to several credits within LEED V4.

Energy & Atmosphere

Aspect's glass walls allow more natural light into a space, which may reduce energy use by decreasing the use of artificial lighting.

Materials & Resources

Interiors Life-Cycle Impact Reduction, Options 1 and 3: Designing for reuse and flexibility – like using demountable and movable walls – helps lessen the environmental impacts of interior spaces over time. Aspect demountable walls may contribute to this credit.

BPDO Sourcing of Raw Materials, Option 2: Although glass must be virgin material to achieve its clarity and strength, other components in the Aspect system have recycled content. Environmental Data Sheets are available for Aspect's various setups and provide details about the material types and recycled content. Aspect's wood components are also available as FSC Certified.

Construction and Demolition Waste Management: Allsteel's product packaging for Aspect can be recycled with other on-site wastes or off-site, depending on project preference.

Indoor Environmental Quality

Low-Emitting Materials: Many of the materials used in Aspect are non-emitting, including glass, aluminum, steel, and other hardware. These components do not off-gas into the workplace and do not require repainting or refinishing that could release VOCs (Volatile Organic Compounds). Aspect's components have been tested for emissions and are certified for indoor air quality through the SCS Global Services Indoor Advantage™ Gold program. Aspect also meets the CDPH v1.1-2010 emissions criteria.

Indoor Air Quality Assessment: Aspect may indirectly support this credit. Aspect uses components that are non-emitting and do not require any on-site finishing or touch-ups, meaning that indoor air quality will not be impacted by the installation of Aspect.

Daylight: Aspect's glass walls allow more natural light into a space, which may support this credit.

Quality Views: Aspect's glass walls may provide occupants with access to views outside. Being able to access views to the outdoors has productivity benefits and may increase workplace satisfaction.

Acoustic Performance: Aspect has been tested for acoustic performance and may contribute to this credit, depending on the other materials selected for the interior spaces.

WELL Project Contributions

Aspect demountable walls can support WELL projects by contributing to several features within WELL V1.

Air 04: VOC Reduction: Good indoor air quality has been linked to improved productivity in office spaces. Allsteel's Aspect is SCS Indoor Advantage™ Gold certified and meets the referenced criteria in the WELL Building Standard (ANSI/BIFMA e3-2011 7.6.1 and 7.6.2).

Light 53: Visual Lighting Design: Balancing spatial brightness across a variety of spaces can contribute to sharper visual acuity and focus, while potentially reducing eye strain. Aspect's glass walls allow light to flow more deeply into the space than drywall and may help project teams with light balance from room to room.

Light 59: Surface Design: Exposure to light during the workday can promote alertness and activity. Choosing surfaces with high Light Reflectance Values (LRVs) can help increase the amount of light in a space without increasing unwanted glare. Allsteel's portfolio of paints, laminate, and veneer finishes include many options with an LRV of ½ or higher, contributing to this feature.

Light 61: Right to Light: Aspect's glass walls can increase access to views by employees if the building has sufficient vision glazing to allow views from the required areas. Offices and taller features placed in the interior of the space maximize view opportunities.

Comfort 78: Reverberation Time: Acoustic comfort in the office is crucial to productivity. Aspect demountable walls may contribute to the acoustic requirements of this feature. Additional considerations should be made with the other elements of the space, like flooring, ceiling materials, and furnishings, which may also impact this feature.

Comfort 80: Sound Reducing Surfaces: Reducing sound in an office can contribute to more comfortable levels throughout the space. While Aspect is primarily made of glass which may not have a high NRC, additional elements, like acoustic privacy tiles, can be added that may improve the acoustics within a space.

Comfort 81: Sound Barriers: Noise from adjacent spaces can be disruptive in a work environment. Sealing gaps between walls and adding thresholds for doors may help reduce noise between rooms.

Mind 87: Beauty and Design, Part 1: Occupants' moods and morale can be impacted by the design of their workspace. Integrating aesthetically pleasing elements into a space can provide a calming or joyful experience. Allsteel's Aspect can be customized to create room layouts that capture and enhance their organizational culture and contribute to this feature.

Glass and Trim

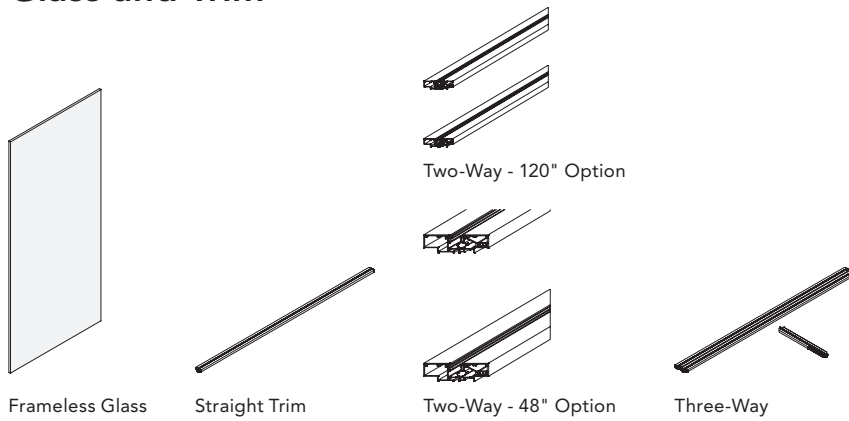

Frameless Glass

Straight Trim

Two-Way - 120" Option

Two-Way - 48" Option

Three-Way

Vertical Fillers

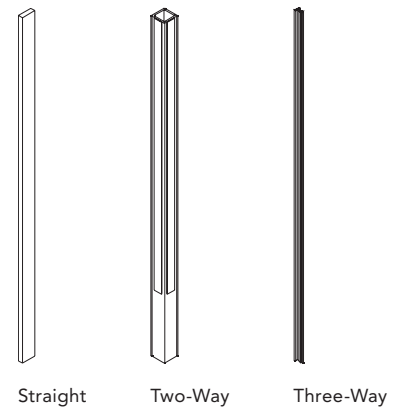

Straight

Two-Way

Three-Way

Doors

Sliding

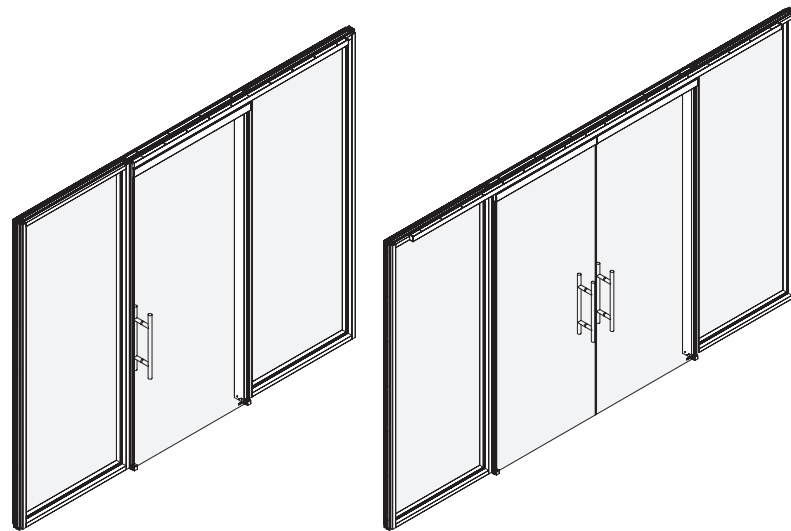

Sliding Frameless Glass, Single

Sliding Frameless Glass, Double

Swing

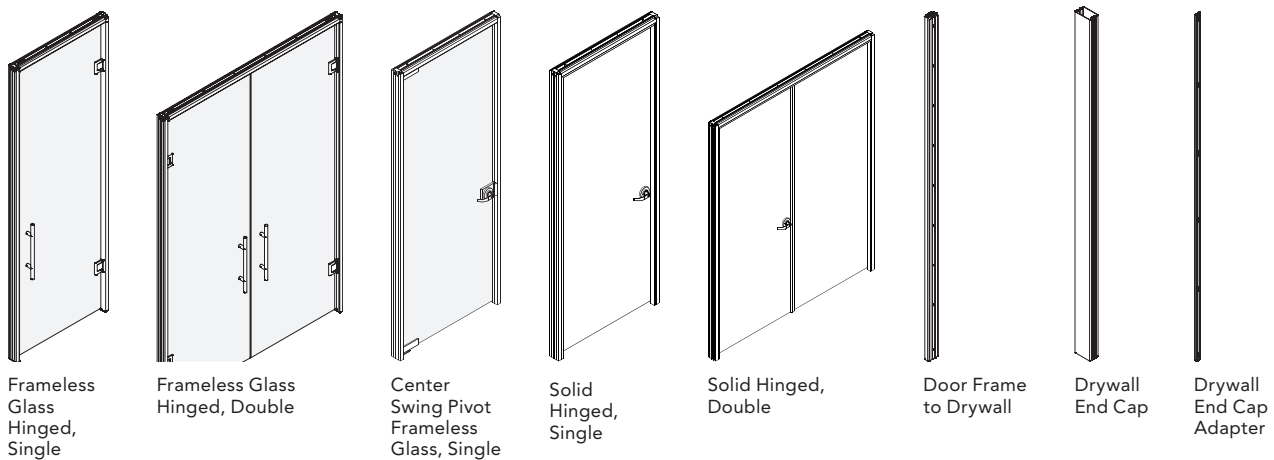

Frameless Glass Hinged, Single

Frameless Glass Hinged, Double

Center Swing Pivot Frameless Glass, Single

Solid Hinged, Single

Solid Hinged, Double

Door Frame to Drywall

Drywall End Cap

Drywall End Cap Adapter

Door Hardware

Ladder Pulls

For use with sliding doors and frameless swing doors.

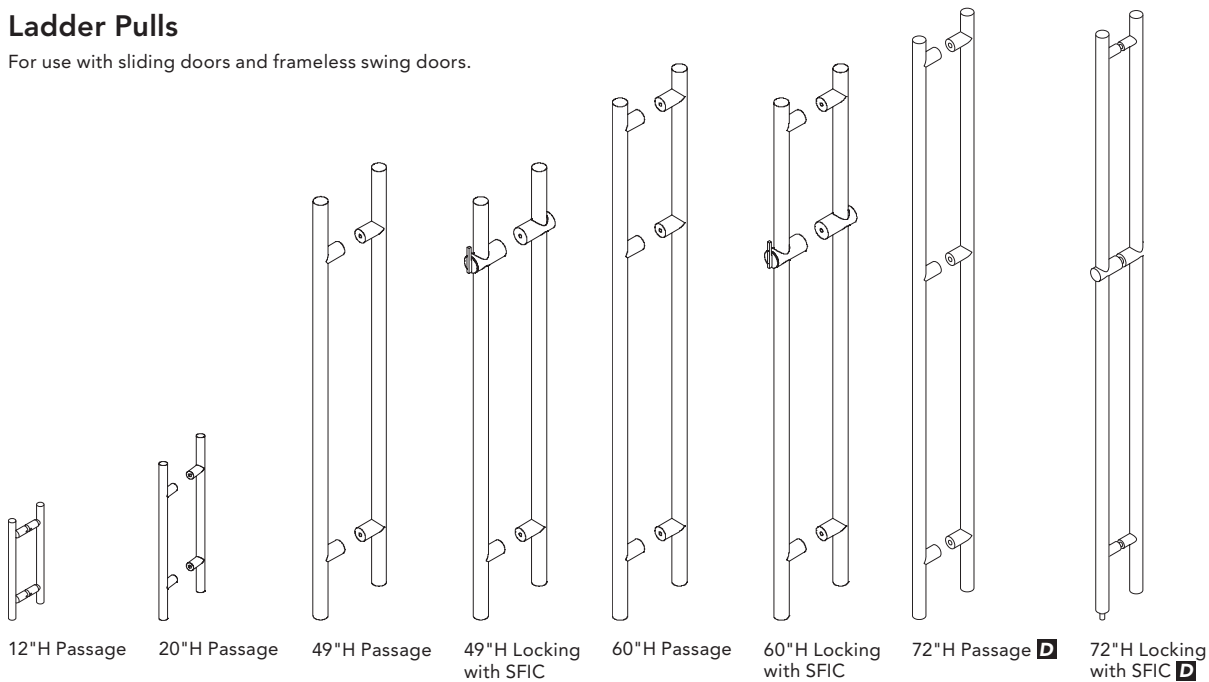

Levers

For use with center swing pivot frameless glass doors.

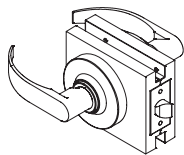

Passage

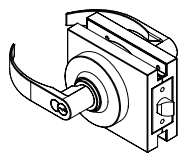

Locking with SFIC

For use with hinged doors.

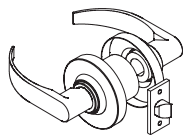

Passage

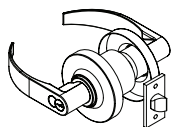

Locking with SFIC

D Discontinued 12/31/2020

Allsteel®

Aspect™

Pre-Specification Guide 2021

Product Tolerance

Aspect™

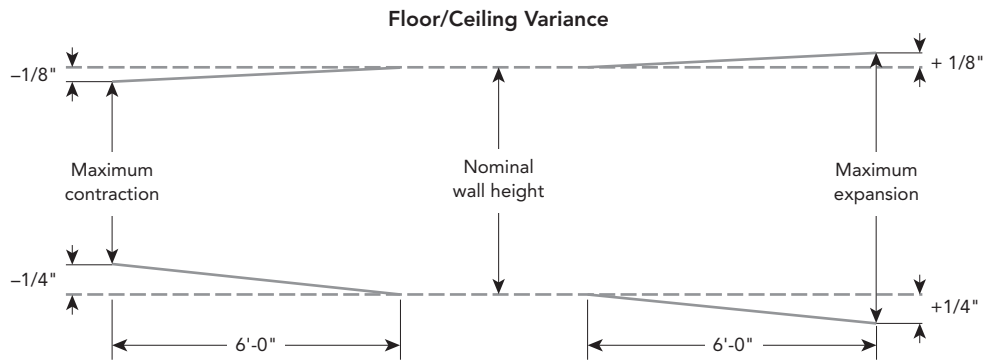

Floor

Aspect requires that the contractor adhere to a finished floor variation of $\pm 1/4"$ every 6'.

Note: Acceptable "flat" finished floor variation using straightedge method: $\pm 1/4"$ every 10'.

Ceiling

Aspect requires that the contractor adhere to a ceiling header variation of $\pm 1/8"$ every 6'.

Note: The Metal Lath/Steel Framing Association (ML/SFA) and the American Society of Testing Materials (ASTM) state under section C1007 that tolerances for steel framing horizontal alignment (levelness) of walls shall be within 1/960th ($1/8"$ in 10') of their respective lengths.

Profile View

Side View

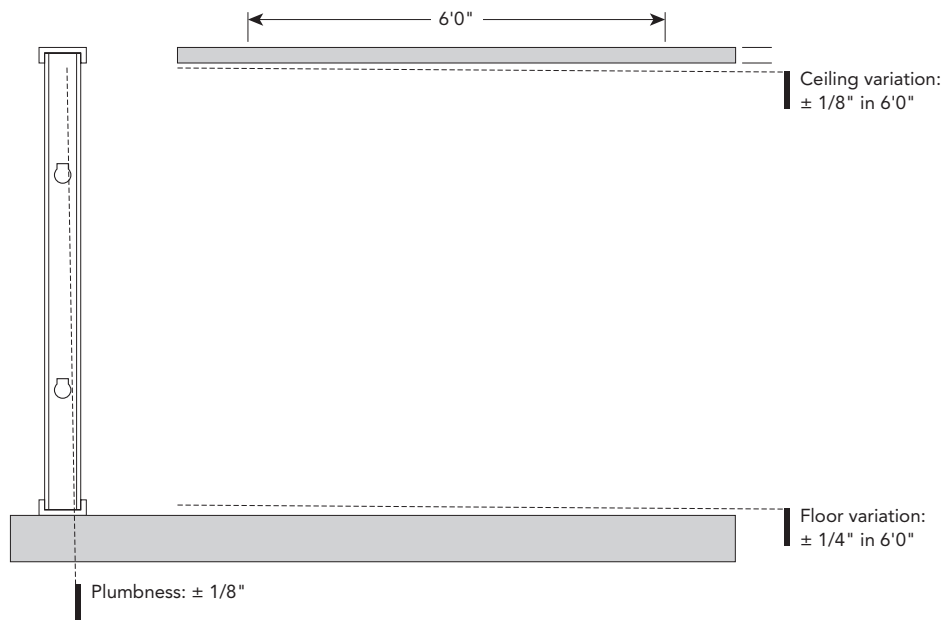

Wall Plumbness

Aspect requires the contractor adhere to vertical plumbness of $\pm 1/8"$ over 10'.

Note: Metal Lath/Steel Framing Association (ML/SFA) recommends acceptable gypsum wallboard plumbness of $1/8"$ in 10'.

It is recommended that measurements are taken from the benchmark to the floor and to the ceiling every 24" when using Aspect.

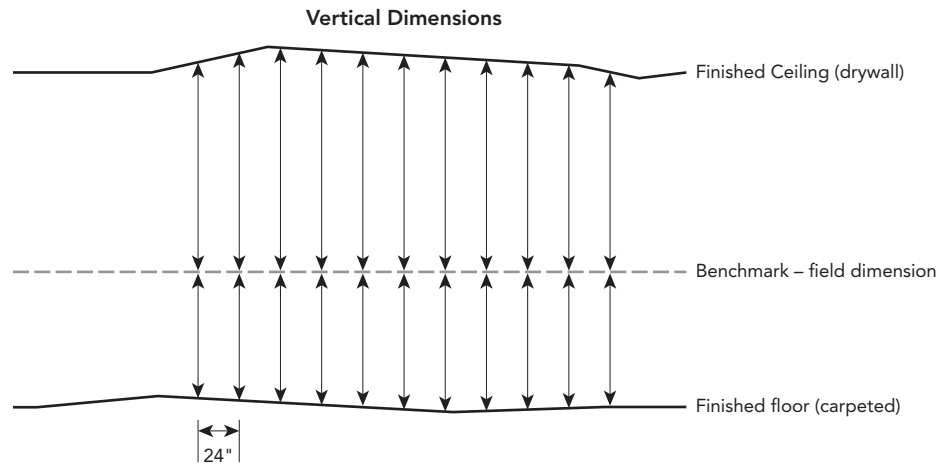

For horizontal dimensions, it is recommended that opening dimensions from finished drywall to finished drywall are taken when using Aspect.

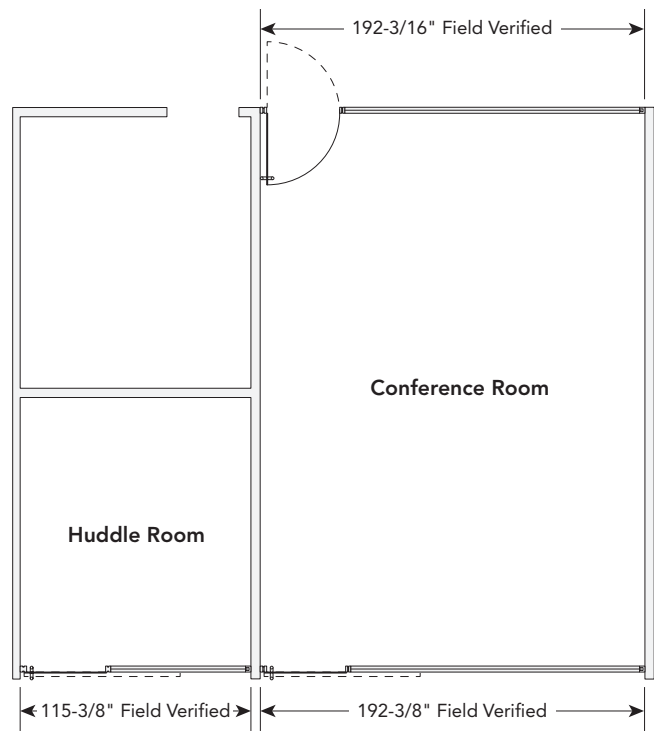

Field Measurements Example

Aspect™

Allsteel APG Pre-Install Measurements

Project: _____

Date: _____

Room #	Vertical (facing office)	Finished Above BM	Finished Below BM	Horizontal FD Location	Finshed Dim	Swing Door - Vert	Notes
A	Left	65.250	34.500	Top	114.75	34.375	Pivot Door
	Center Left	65.250	34.375	Center	114.625	34.5	
	Center	65.250	34.375	Base	114.75		
	Center Right	65.250	34.250				
	Right	65.000	34.000				
			0.250	0.500		0.125	0.125
B	Left	66.250	33.500	Top	74.34		No Door
	Center Left	66.250	33.750	Center	74.25		
	Center	66.000	34.000	Base			
	Center Right	66.000	34.000				
	Right	65.875	33.250				
			0.250	0.750		0.09	
C	Left	66.000	33.500	Top	194.4375	33.125	Pivot Door
	Center Left			Center	194.4375	33.875	
	Center	66.125	33.625	Base			
	Center Right						
	Right	66.250	34.000				
			0.250	0.500		0	0.65

BM = Default is Bench Mark is reset at each office

Finished = Examples include carpet at floor & painted drywall at header and side wall

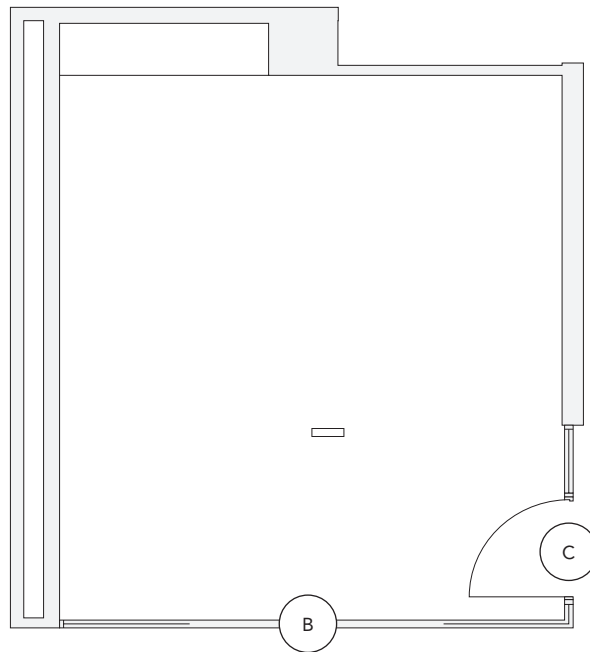
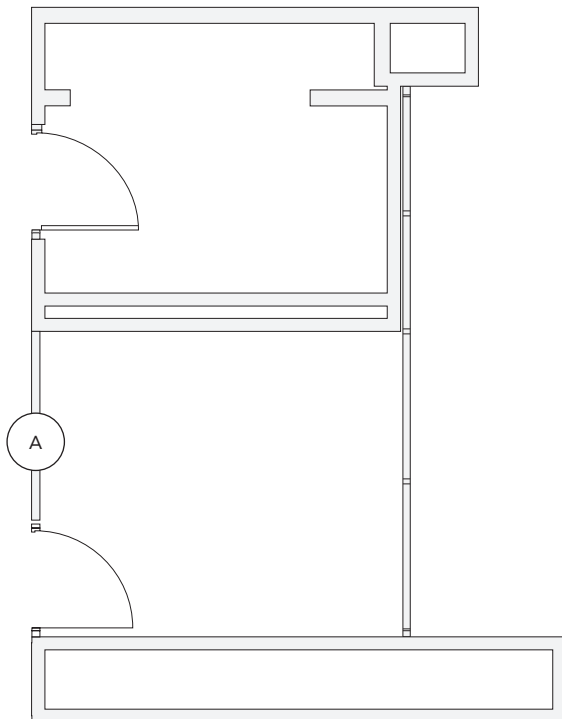
Green: Within **Aspect** tolerance**Red:** Not within **Aspect** tolerance

Ceiling and Floor Levelness

1. Review areas outside of **Aspect's** floor levelness tolerance with the general contractor following field dimensions.
2. Obtain time line for completion of corrective action from general contractor, factor potential delay into overall project schedule, and communicate to appropriate parties.
3. Confirm results of resolution on site to agreed-upon date.

Construction Vertical Partition Plumbness

1. Review areas outside of **Aspect's** vertical construction partition tolerance with the general contractor following field dimensions.
2. Obtain time line for completion of corrective action from general contractor, factor potential delay into overall project schedule, and communicate to appropriate parties.
3. Confirm results of resolution on site on agreed-upon date.

Ceiling Connection

Aspect™

Requirements for a Steel Bulkhead

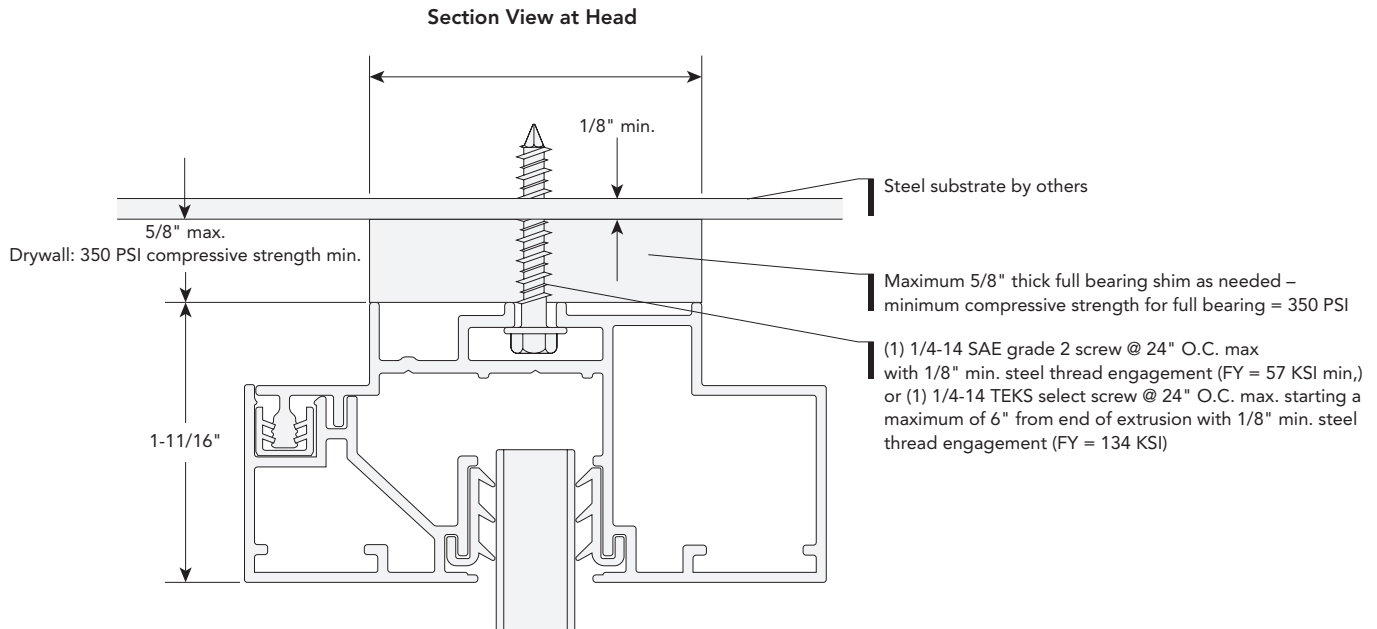

Note: Anchors supplied by installation partners.

Requirements for a Metal Stud Bulkhead

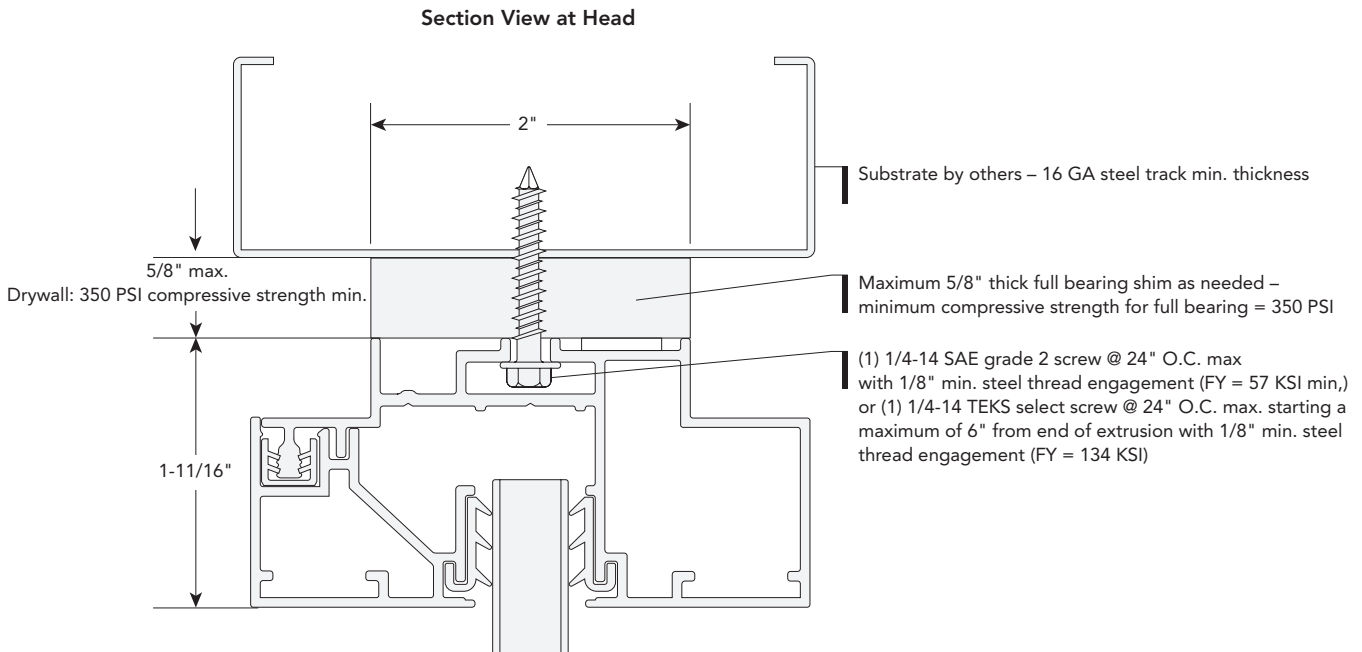

Note: Anchors supplied by installation partners.

Requirements for a Wood Bulkhead

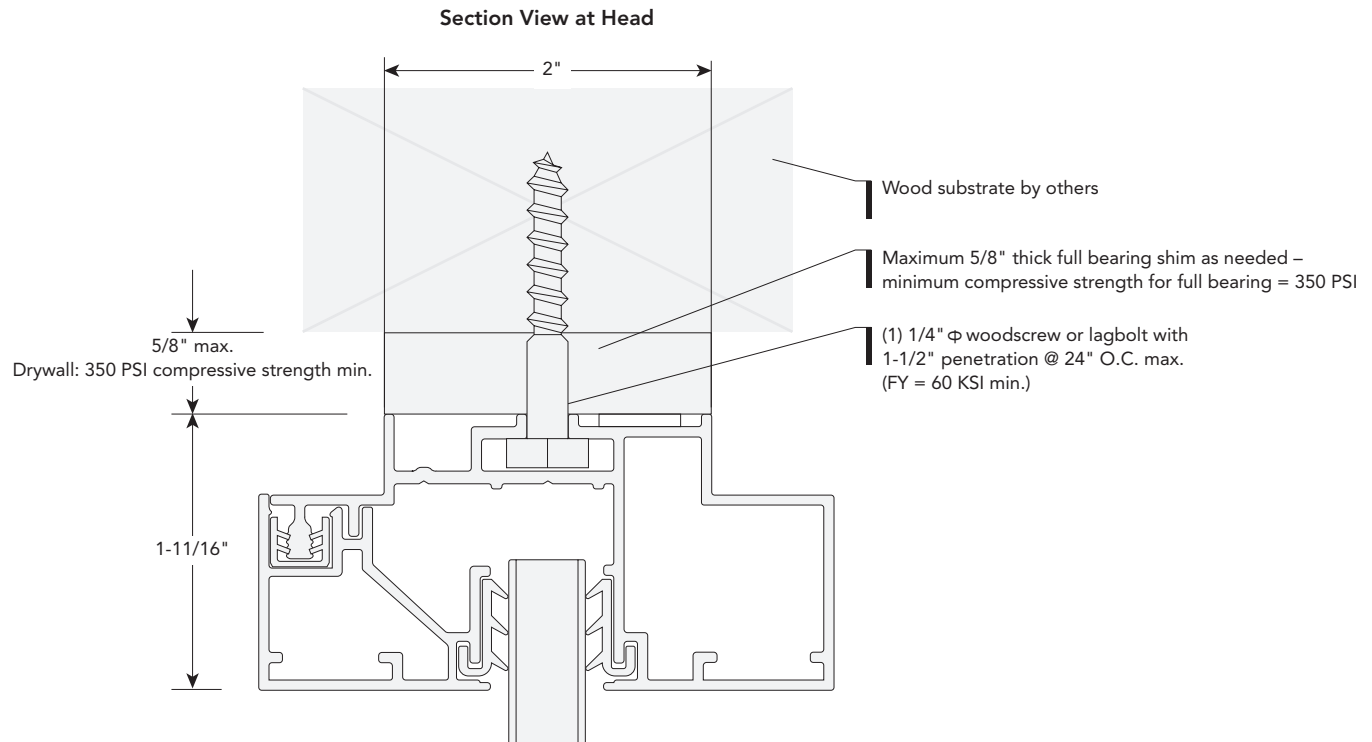

Requirements for a Wood Floor

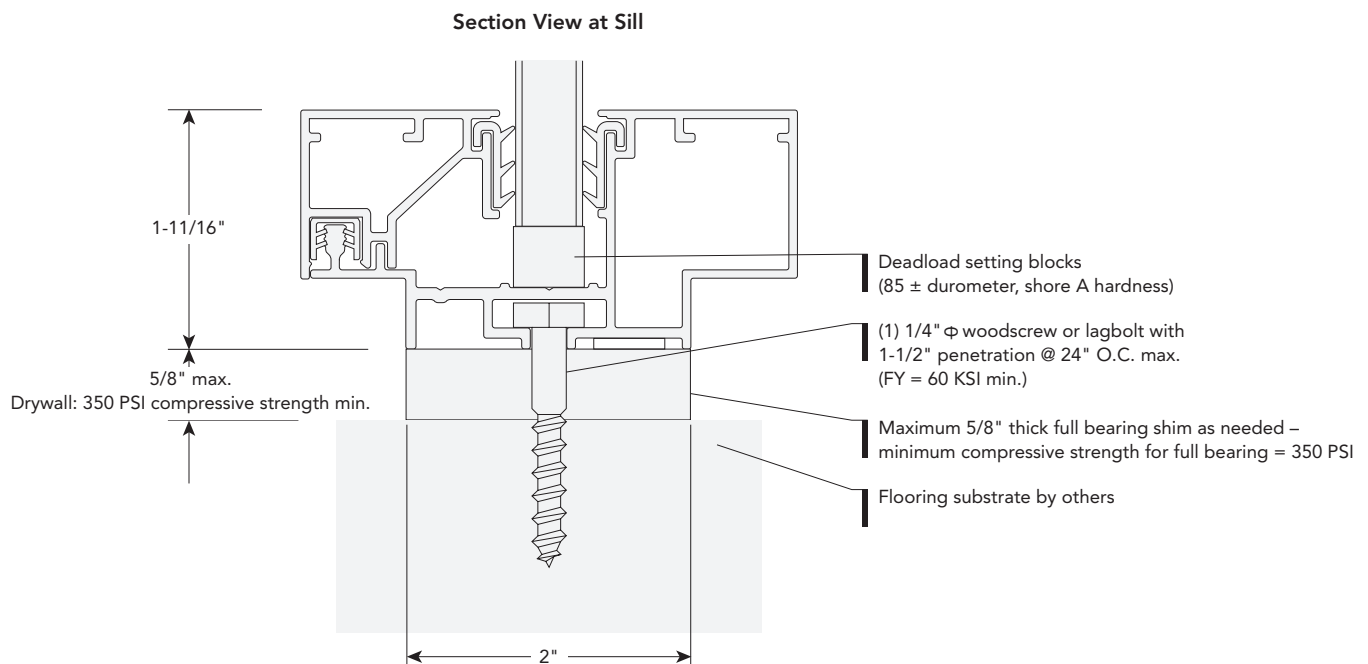

Note: Anchors supplied by installation partners.

Requirements for a Concrete Floor

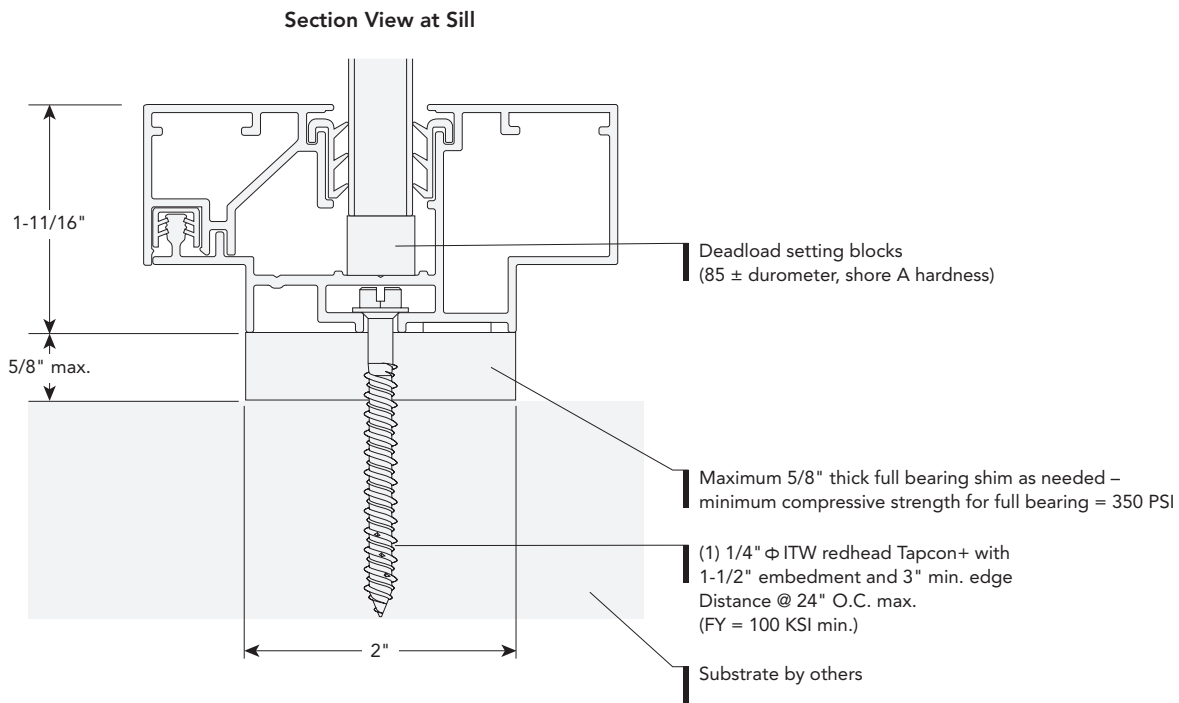

Note #1: Anchors supplied by installation partners.

Note #2: For post tension concrete applications, please consult with the architect prior to specifying.

Sliding Door Connection

Aspect™

For Aspect sliding doors, headers/soffits should be built with minimum requirements in mind. Reference dimensions are not required.

Minimum bulkhead structure requirements for Aspect sliding door.

Allsteel recommends the removable portion of trim be oriented to outside of room and sliding doors always be placed on inside of room.

The sliding door should be placed opposite the side of the removable trim.

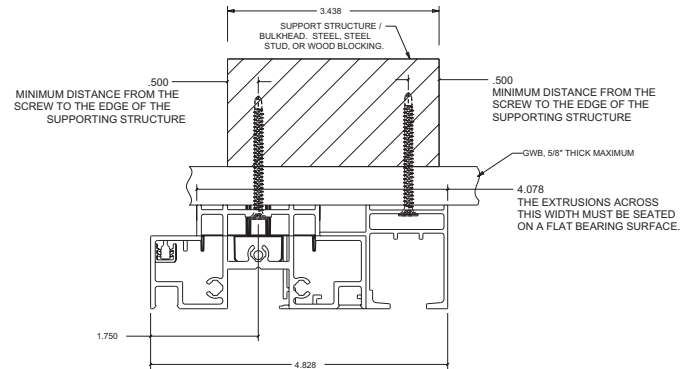

Application Example

Sliding door visualized in front edge to soffit condition with reference dimensions.

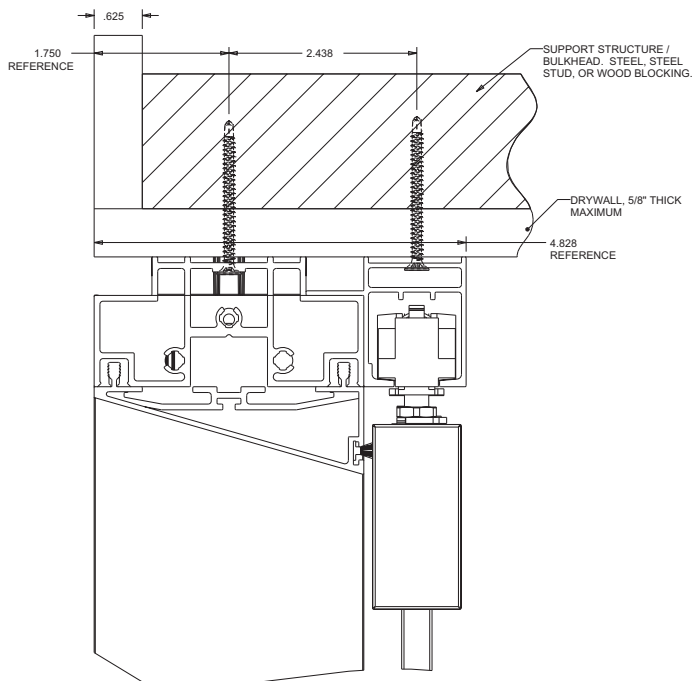

Door / Weight Support Requirement

Aspect™

Aspect requires the header/soffit/bulkhead to be designed to support the weight listed below.

Ceiling Height	Door Type	Single or Double	Door Unit Width (inch)	Approx. Aluminum weight supported by header per foot	Door Leaf Type	Door Leaf Glass Thickness (inch)	Approx. Weight of Door Leaf
120	Slider	Single	42	1 to 2 lbs/foot	Glass	0.375"	172 lbs.

Note: Stand-alone glass units and center swing pivot doors need to support the weight of the aluminum only at the header or approximately 1 to 2 lbs/foot. The center swing pivot door's weight is dispersed to the floor. Hinged doors are supported through the vertical which takes load to floor.

Aspect Design Loads are in accordance with codes shown on Sheet No: "0" of the standard calculations package: **5 PSF / 50 PLF @ 42" A.F.F.** (Standard calculations package is available on the Allsteel portal. Contact your local Allsteel dealer partner/sales person.)

Office Front Solutions Interior Partition Wall Calculations

Project Location:
Not Applicable
REI Project # R17-02-220

Prepared for:
Allsteel - Muscatine, IA
5/25/2017

Design Criteria:

1. Design Loads in accordance with codes shown on sheet 0- 5 PSF / 50 PLF @ 42" A.F.F.
2. Glass Panels shall as shown in the calculations. Use annealed minimum.
3. Aluminum mullions shall be alloy 6063-T5 or better. Members designed per the Aluminum Association, "Aluminum Design Manual".
4. Deflection to be L/75 or 1 1/2 max. for glass panels.
5. Steel anchor plates to be minimum ASTM A-36 steel.
6. Steel Studs are assumed to be a minimum of 16 GA, Fy = 33 ksi minimum.
7. Screws and bolts shall be stainless steel alloy groups 1,2 or 3 (300series only), condition CW Fy = 65 ksi, Fu = 110 ksi minimum with diameters and locations as shown in calculations.
8. Concrete anchors shall be a screw type anchor with the size, embedment depth and spacing as per the calculations. Anchors shall be installed per the manufacturer's specifications. Use Redhead or equal.
9. Concrete strength is assumed to be Fc = 3000 psi, cracked, and normal weight.
10. Design of material separation to prevent reaction between dissimilar materials not designed by Rice Engineering Inc.
11. Tape to be as shown and installed per manufacturer's recommendations.
12. Wood Screws shall conform to ANS/ASME Standard B18.6.1-1981, minimum bending yield strengths of Fby=70 ksi, Lag Screws shall conform to ANS/ASME Standard B18.6.1-1981, minimum bending yield strengths of Fby=60 ksi,
13. Wood is assumed to be Spruce-Pine-Fir, SG = 0.42.
14. Use Full Bearing Shims with dimensions as shown in the calculations.
Per IBC, glass has been designed using a safety factor of 4 in determining the allowable flexural stress (24,000/4 = 6,000 psi).
Per IBC, glass panels need to be manufactured from an approved safety glazing material conforming to CPSC 16 CFR 1201 (II).
The glass manufacturer is responsible for providing acceptable safety glass conforming to IBC and CPSC provisions.

Disclaimer:

This Certification is limited to the structural design of structural components of this Interior Partition Wall system. It does NOT include responsibility for:

- Structural design of hardware or support structure.
- Design of material separation to prevent reaction between dissimilar materials.
- Design of air and water infiltration prevention.
- The manufacture, assembly, or installation of the system.
- Quantities of materials or dimensional accuracy of drawings

Cover Page 1 of 2

Engineers Design Approval Stamp:

**PRELIMINARY DESIGN
NOT FOR CONSTRUCTION**

Code Compliance and Disclaimers	Detail Ref.	Sheet No:
		0

APPLICABLE CODES

- | | |
|---|--|
| International Building Code (IBC) - 2003-2015 | Missouri State - 2012 IBC |
| Alabama State - 2009 IBC | Montana State - 2012 IBC |
| Alaska State - 2009 IBC | Nebraska State - 2012 IBC |
| Arizona State - 2009 IBC | Nevada State - 2012 IBC |
| Arkansas State - 2006 IBC | New Hampshire State - 2009 IBC |
| California Building Code - 2016 | New Jersey Building Code - 2015 IBC with NJ Amendments |
| Municipal Code of Chicago | New Mexico State - 2009 IBC |
| Colorado State - 2015 IBC | New York State Building Code - 2015 IBC |
| Connecticut State Building Code - 2016 | New York City Building Code - 2014 |
| D.C. Construction Code - 2013 | North Carolina Building Code - 2012 |
| Delaware State - 2012 IBC | North Dakota State Building Code - 2015 |
| Florida Building Code - 2014 with 2016 Supplement | Ohio Building Code - 2013 |
| Georgia State - 2012 IBC | Oklahoma Uniform Building Code - 2015 IBC |
| Hawaii State Building Code | Oregon Structural Specialty Code - 2014 |
| Idaho State - 2012 IBC | Pennsylvania State - 2009 IBC |
| Indiana Building Code - 2014 | Rhode Island Building Code - 2013 |
| Iowa State - 2015 IBC | South Carolina State - 2012 IBC |
| Kansas State - 2003 IBC | South Dakota State - 2015 IBC |
| Kentucky Building Code - 2013 | Tennessee State - 2006 IBC |
| Louisiana State - 2012 IBC | Texas State - 2006 IBC |
| Maine Uniform Building and Energy Code - 2009 | Utah Uniform Building Code - 2015 |
| Maryland State - 2015 IBC | Vermont State - 2015 IBC |
| Massachusetts Building Code - 8th Edition | Virginia Building Code - 2012 |
| Michigan Building Code - 2015 | Washington State Building Code - 2015 |
| Minnesota Building Code - 2015 | West Virginia State - 2009 IBC |
| Mississippi State - 2015 IBC | Wisconsin Commercial Building Code - 2009 IBC |
| | Wyoming Building Code - 2015 IBC |

ALWAYS CHECK WITH THE LOCAL JURISDICTION AS EACH CITY, COUNTY, OR STATE MAY HAVE DIFFERENT REQUIREMENTS

	105 School Creek Trail Luxemburg, WI 54217 Phone: (820)817-1042 Fax: (820)817-1100 www.rice-inc.com	Project Description:	Job No:	R-17-02-220
		Allsteel New Office Front Seismic Category A and B	Engineer:	TLF
Template:		Date:	3/1/17	Rev:
		Chk By:		Date:

Review Delivery Requirements

Offload Requirements

Determine if there are any delivery requirements or special delivery methods to be included in project cost.

Examples of questions to ask include:

- “Delivery to site or warehouse?”
- “Does the city allow 53' trucks to deliver to the site?”
- “Can a 53' truck access the planned offload area?”
- “Is there a loading dock?”

Freight Elevator/Crane Requirement/Stair Carry

During the pre-order site visit, determine the most appropriate delivery path from offload location to product staging area. Make sure the paths are sized adequately to accommodate the component or skid size, according to the planned method. Fully dimension elevator to insure ability to transfer product and check for any elevator booking requirements or restricted hours of delivery.

Staging Install – Product Placement

Review the floorplate in the area of install and/or talk to building officials to determine the best staging areas and delivery routes for easy install. If security is an issue, the dealer partner or contracted installation company is responsible for providing a secure environment to house the Aspect product upon delivery until the project is complete; losses due to theft will be the responsibility of the dealer partner or contracted installation company.

Key Recommendations

- As shown in the illustration below, please be aware of any obstacles in the ceiling, floor or horizontal connections. Examples of potential obstacles to be aware of are lighting, HVAC and sprinkler heads.
- Since the product will produce noise to install, please understand from the client any activity restrictions.
- If available, review floor finish type and transitions. For example, VCT location in relationship to carpet.

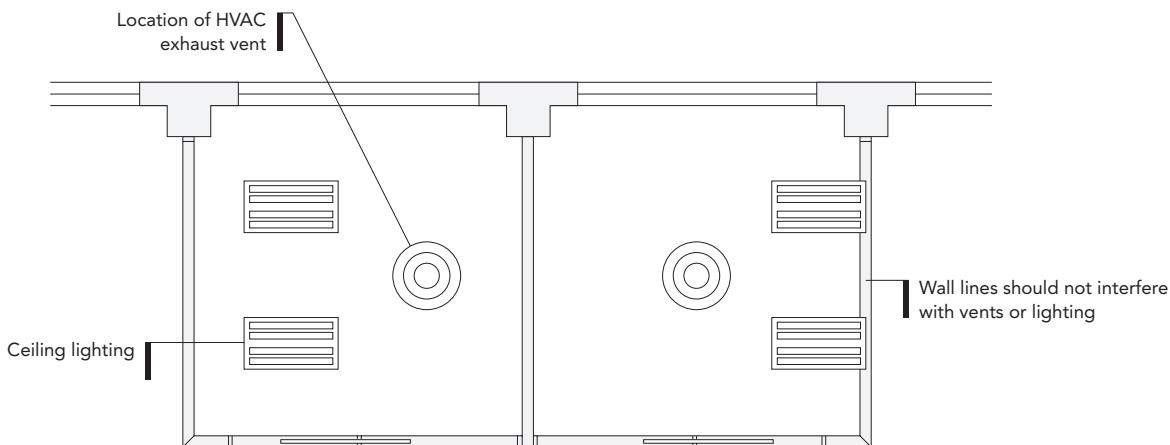

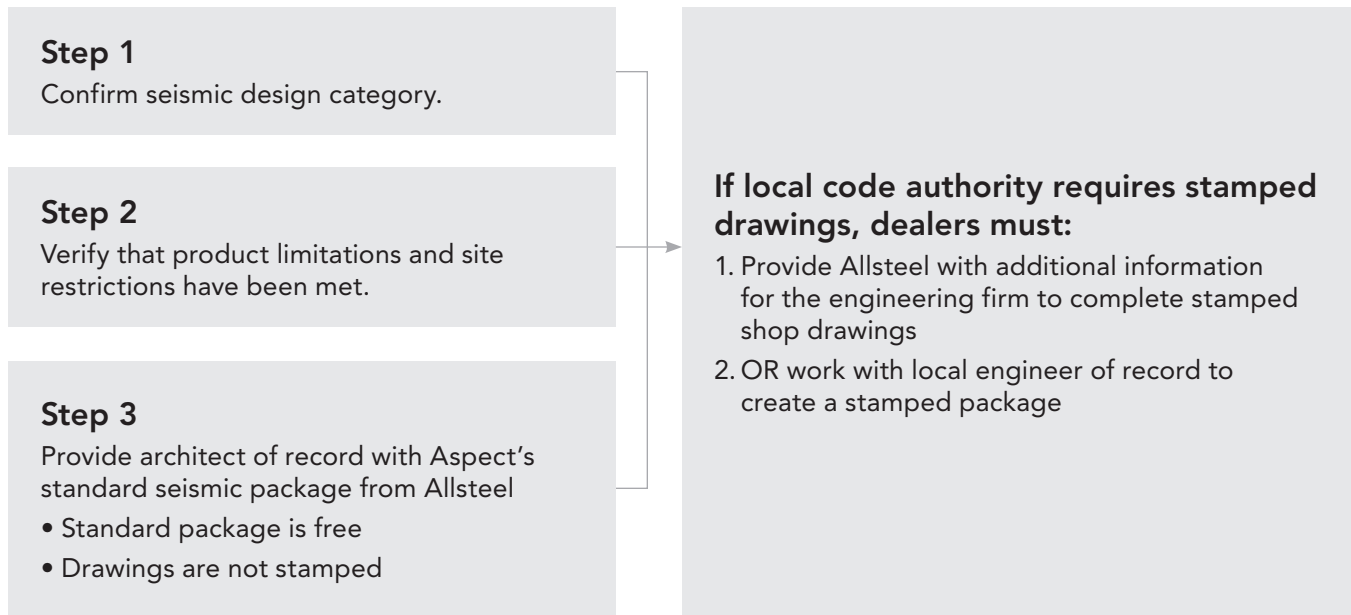

The project architect is ultimately responsible for code compliance including seismic requirements.

Allsteel has created guidelines regarding the sale and installation of Aspect in seismic zones. Before selling Aspect in a seismic zone, it's important to know which seismic zone the project is in as well as the building category. Aspect has been evaluated for seismic design categories C-F through a third-party engineering firm, where glass deflection was tested using computer analysis. Product installation is restricted to seismic risk categories I, II and III. Please consult the project architect for more details.

Please contact your Allsteel PM or Wall BDM with further questions.

Anchoring

There are no additional requirements for anchoring. See the Ceiling/Floor Connection Rules in the following pages for details.

Note: Aspect trim has centerlines at 15" centers, and a fastener needs to be placed in every pre-drilled hole.

Header Structure

Allsteel defers to the project architect and engineer of record for all building elements necessary to meet a project's seismic requirements. Structural soffits for Aspect should be designed with lateral loading and uplift vs. down load in mind in seismic zones.

Product Limitations

Aspect product limitations differ by glass type. There are no limitations regarding Aspect doors.

Tempered glass is the least restrictive. The only restrictions for tempered glass are on glass widths at 2-way and 3-way connections.

- At a 2-way connection, the sum of the width of two panels at the corner cannot be more than 64".
- At a 3-way connection, the sum of the width of the panel on either side of the return combined with the width of the return cannot be more than 64".

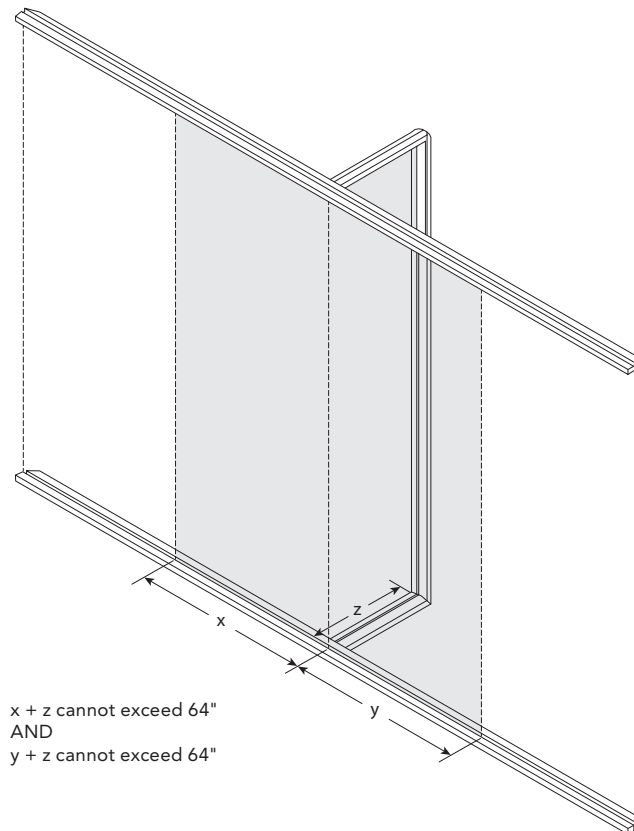
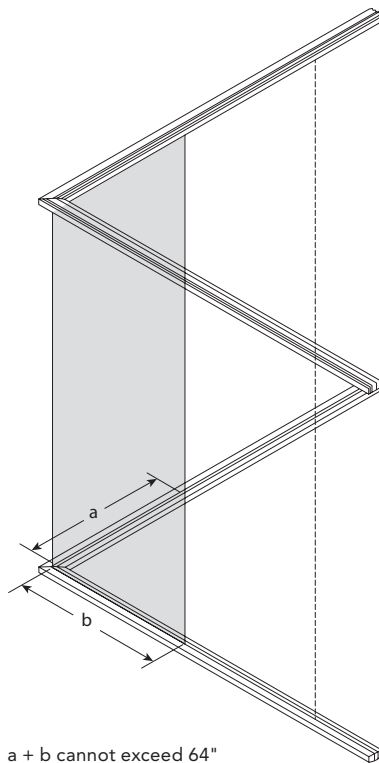

Selling/Installing Aspect in a Seismic Zone

Working with Aspect®

Laminated glass is more restrictive. Note that door placement can help mitigate restrictions as there are no limitations on Aspect doors.

Aspect cannot support corner applications (two-way or three-way connections) with laminated glass and is limited to straight runs only. These straight runs are limited in width to (2) pieces of 42" wide glass, or 84" in total width. Each laminated glass panel must be supported by ceiling track, floor track and at least one vertical trim component.

Additionally, laminated glass must be structurally adhered to all three trim components using silicone. This requirement is needed for the walls to withstand seismic clearance based on calculated seismic drift. Without being structurally adhered to trim components, Aspect runs are limited to a single glass panel that is no more than 30" in width.

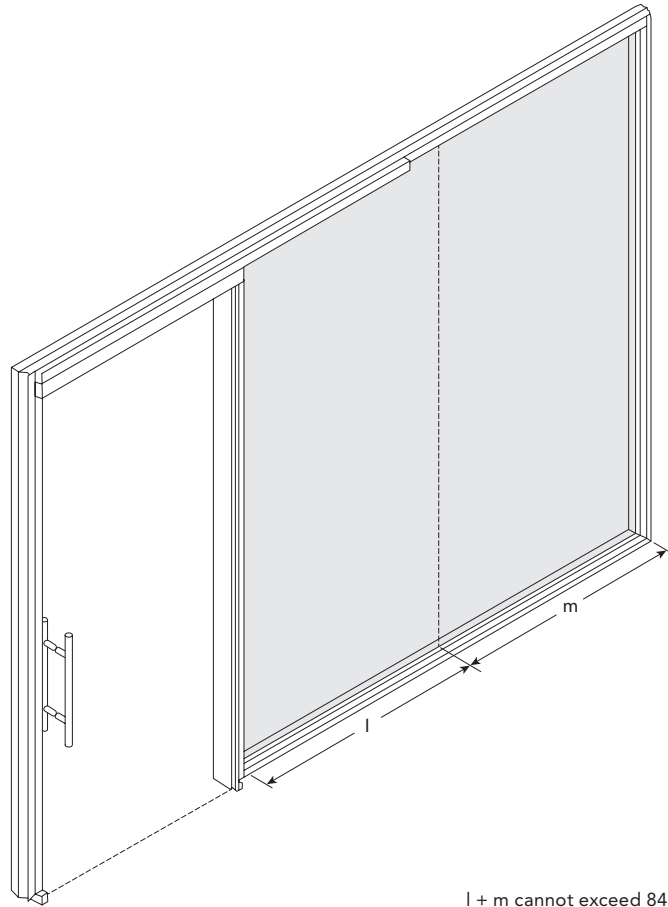

Documentation

Allsteel provides a standard seismic package for Aspect. This standard package is not stamped. There is no cost to obtaining this package and it is available on Synergy or through your Allsteel PM. This package should be provided to the Architect of Record.

Upfront Proposal Pricing

In some situations, local code authorities may require additional documentation including stamped drawings. Below are two options for obtaining stamped drawings that may carry additional costs. Allsteel is not responsible for covering these additional costs. It is recommended that dealer partners include verbiage in their proposal to the customer that notifies the customer of the potential of these additional costs.

Option 1) Provide Allsteel with additional information for the engineering firm to complete stamped shop drawings. For a small fee, Rice Engineering can create site-specific stamped drawings. To receive site-specific stamped drawings, the dealer will need to provide the following details to the Allsteel Project Manager:

1. Project Name
2. Location (City and State)
3. Structural Notes if available
4. Specifications if available
5. Building Type (Hospital, Store, Office, School, etc.)
6. Final Shop Drawings and Bill of Materials: Include plan/elevation view and wall height
7. Optional: Substrates at the Head and Sill

Option 2) The engineer of record for the project can take site-specific calculations and incorporate these calculations into the package they submit.

Doors are the first component installed when working with Aspect.

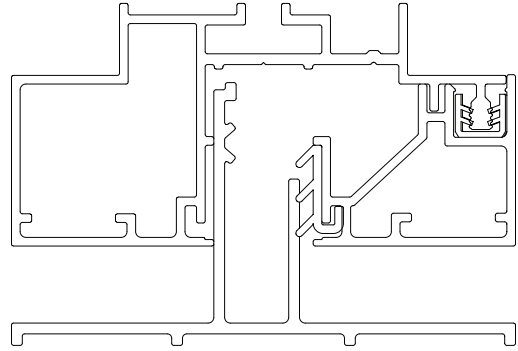

Door Frame to Drywall Wall Channel

- Aspect panels can be specified with a variety of door and hardware options.
- When connecting a door frame to drywall, utilize the door frame to drywall wall channel (specified as base model AS-DWCHANNEL).
- Aspect panels can be specified with a variety of door and hardware options.
 - Doors can reach a maximum height of 120" with a minimum height of 84".
 - All specification for door sizes is nominal. This differs from the glass panels which are specified in actual sizes.
 - Door height is specified in quarter inch ($\frac{1}{4}$ ") increments.
 - Doors specified at nominal height have a half inch ($\frac{1}{2}$ ") planned clearance between the bottom of the door and the floor.
 - Door clearances should be confirmed on the job site with field measurements for both the open and closed positions of the door.
 - All doors have a set width per module (nominal size of the door with frame).
- Utilize door frame to drywall wall channel (specified as base model AS-DWCHANNEL) when connecting a door directly to drywall.
- A door frame corner block is QTY (2) corner blocks are automatically included with each door frame



Base Model	Description	Specification
AS-DWCHANNEL	Wall Channel - Door Frame to Drywall	AS-DWCHANNEL

Configuration ID	Specification Description
Product	Aspect
Dimension	120"
Trim Type	Wall Channel
Trim Use	Adjacent Door
Finish Color	Painted or Anodized Finishes

Option	Specification Description	Specification
Paint Color Selection	3-digit painted or anodized finish	See Aspect Frame Finishes

Specification Example: AS-DWCHANNEL.#####.P8X

Sliding Doors

Working with Aspect™

Sliding Doors

Sliding doors (single and double) require a 6" header. Blocking is required above the header to support the weight of the door. Please see Pre-Specification Guide for more details.

General Information

- Sliding doors should be mounted on the interior of the office for a better aesthetic and for ease of installation.
- Sliding doors come in nominal 42" modules for single doors and nominal 78" modules for double doors.
- Door frames only come in 120" lengths vertically and are cut to size in the field.
- Sliding door mounting hardware is included with the sliding door frame for both single and double doors.
- For double sliding doors, specify double door models and frames.
- Adjacent glass panels of the following dimensions are required next to sliding doors to support the door track and to eliminate interference with another panel or door:
 - 42" door module requires a 36"W minimum adjacent panel.
 - Clearance is 33¹⁵/₁₆".
 - 78" door module requires a 33¹/₂"W (33.5") minimum adjacent panel on both sides of the door.
 - Clearance is 63¹/₂" (63.5").
- Sliding door tracks are available in two options.
 - Standard (Single Doors Only)
 - Slow Close/Slow Open (Single or Double Doors)
 - Incorporates a motion-dampening mechanism to support soft closures and openings for sliding doors.

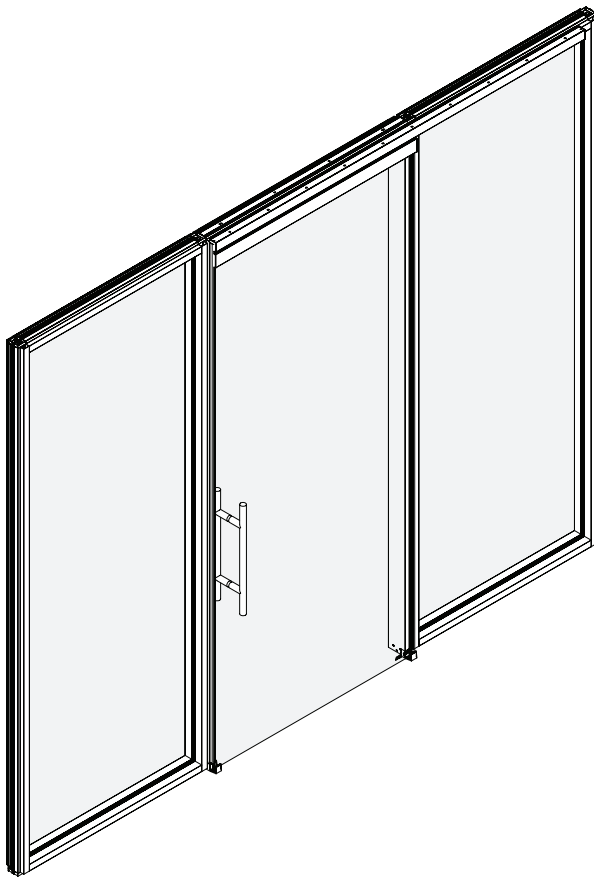

Single Sliding Door

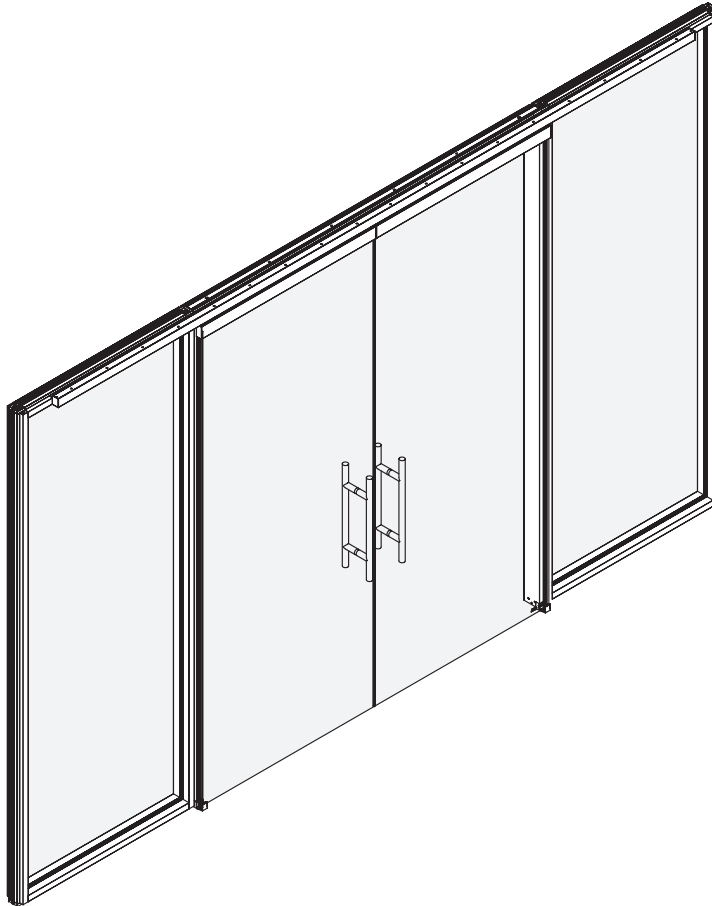

Double Sliding Door

- Sliding doors utilize door pulls. See the Sliding Door Hardware pages of the Doors section for available options.
- A rubberized leading edge seal is included with each door frame. The seal creates an acoustic barrier between the door and the door frame.
- Interlocking trailing edge seals are included with each frameless sliding glass door. Seals create added acoustic barriers.

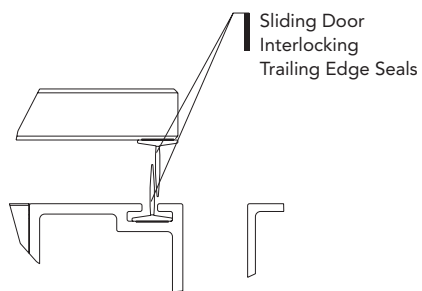

- Trailing edge seal is field-applied to the trailing edge of the frameless glass door. This seal interlocks with the trailing edge seal on the door frame.
- Sliding doors are non-handed.

Door Hardware

Working with Aspect™

Door Hardware

All door hardware may be specified in silver or in black.

Ladder Pulls

- Use with sliding and center swing pivot frameless glass doors. Pulls can be specified in silver or black stainless steel finish.

12"H Ladder Pull

- ¾" (.75") diameter pull
- Stainless steel finish
- Passage (non-locking) only

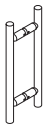

20"H Ladder Pull

- 1" diameter pull
- Anodized finish
- Passage (non-locking) only



49"H Ladder Pull

- 1⅝" diameter pull
- Anodized finish
- Passage option
- Locking option
 - Thumb-turn deadbolt lock is received into a floor socket.
 - Rim cylinder with SFIC format
 - SFIC core for field-keying to building requirements
 - Best E keyway
 - Random keying
 - Use SFIC for any custom keying requirements.
 - LFIC and other RIM cylinders are available as a custom option.
 - Master keying is available by others.

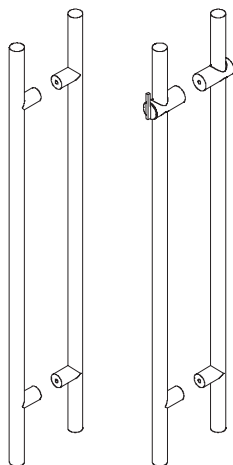

Passage

Locking

60"H Ladder Pull

- 1 3/8" (1.375") diameter pull.
- Anodized finish.
- Passage and locking options.
 - Thumb-turn deadbolt lock is received into a floor socket.
 - Rim cylinder with SFIC format.
 - SFIC core for field-keying to building requirements.
 - Best E keyway.
 - Random keying.
 - Use SFIC for any custom keying requirements.
 - Master keying, LFIC, and other RIM cylinders are available as a custom option.

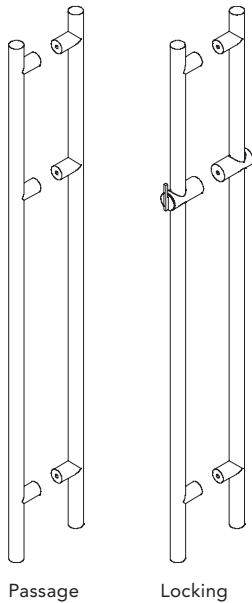

Passage

Locking

72"H Ladder Pull D

- 1 3/8" (1.375") diameter pull.
- Stainless steel finish.
- Passage and locking options.
 - Thumb-turn deadbolt lock is received into a floor socket.
 - Rim cylinder with SFIC format.
 - SFIC core for field-keying to building requirements.
 - Best E keyway.
 - Random keying.
 - Use SFIC for any custom keying requirements.
 - Master keying, LFIC, and other RIM cylinders are available as a custom option.

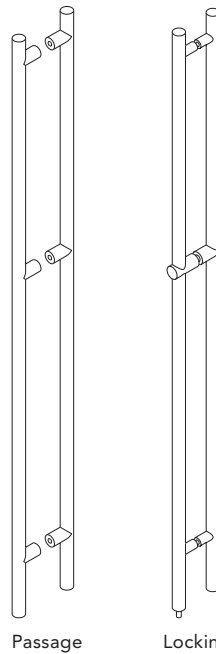

Passage

Locking



Frameless Sliding Glass, Single

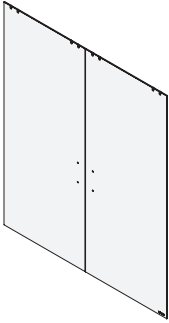

Frameless Sliding Glass, Double



Sliding Door Frame, Single

Base Model	Description	Specification
AS-FGSDLEAF	Frameless Glass Sliding Door Leaf	AS-FGSDLEAF

Configuration ID	Specification Description
Product	Aspect
Width	42" - Single Door 78" - Double Door
Height	86"-120" in ¼" increments
Door Type	Sliding
Door Style	Frameless Glass
Door Module	Single Double
Handle Type	Pull
Pull Height	12" 20" 49" 60"
Glass Code	TA: ⅜" Tempered Clear TB: ⅜" Tempered Low Iron

Option	Specification Description	Specification
Glass Selection	2-digit glass code	See above - Glass Finish options

Specification Example: AS-FGSDLEAF.#####.TA

Option	Specification Description	Specification
Glass Selection	2-digit glass code	See above - Glass Finish options

Specification Example: AS-FGSDLEAF.#####.TA

Option	Specification Description	Specification
Glass Selection	2-digit glass code	See above - Glass Finish options

Specification Example: AS-FGSDLEAF.#####.TA

Base Model	Description	Specification
AS-SDFRAME	Sliding Door Frame	AS-SDFRAME

Configuration ID	Specification Description
Product	Aspect
Width	42" - Single Door 78" - Double Door
Height	86"-120" in ¼" increments
Door Type	Sliding
Door Style	Frameless Glass
Door Module	Single Double
Frame Finish	Painted or Anodized Finishes

Option	Specification Description	Specification
Paint Color Selection	3-digit painted or anodized finish	See Aspect Frame Finishes

Specification Example: AS-SDFRAME.#####.P8X

Option	Specification Description	Specification
Paint Color Selection	3-digit painted or anodized finish	See Aspect Frame Finishes

Specification Example: AS-SDFRAME.#####.P8X

Option	Specification Description	Specification
Paint Color Selection	3-digit painted or anodized finish	See Aspect Frame Finishes

Specification Example: AS-SDFRAME.#####.P8X



Sliding Door Track,
Single

Base Model	Description	Specification
AS-SDTRACK	Sliding Door Track	AS-SDTRACK
Configuration ID	Specification Description	
Product	Aspect	
Width	42" - Single Door 78" - Double Door	
Height	86"-120" in ¼" increments	
Door Type	Sliding	
Door Style	Frameless Glass	
Door Module	Single Double	
Closer	Will populate if Slow Close is selected: Sliding Slow Close	
Frame Finish	Painted or Anodized Finishes	
Option	Specification Description	Specification
Paint Color Selection	3-digit painted or anodized finish	See Aspect Frame Finishes

Specification Example: AS-SDTRACK.#####.P8X



12"

Base Model	Description	Specification
AS-PULL12	12" Ladder Pull	AS-PULL12

Option	Specification Description	Specification
Door Material	Frameless Glass Aluminum-Framed/Wood	FG AL-WD
Trim Color	3-digit code	See Aspect hardware finishes

Specification Example: AS-PULL12.FG.SIL

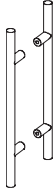

Base Model	Description	Specification
AS-PULL20	20" Ladder Pull	AS-PULL20

Option	Specification Description	Specification
Trim Color	3-digit code	See Aspect hardware finishes

Specification Example: AS-PULL20.SIL

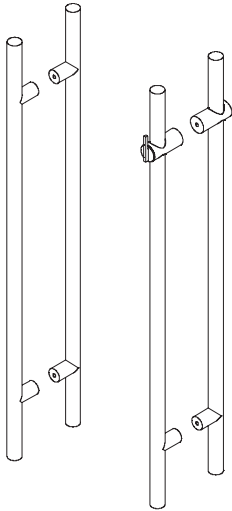

Base Model	Description	Specification
AS-PULL49	49" Ladder Pull	AS-PULL49

Option	Specification Description	Specification
Locking Option	Passage Locking with SFIC	P SFIC
Trim Color	3-digit code	See Aspect hardware finishes

Specification Example: AS-PULL49.P.SIL

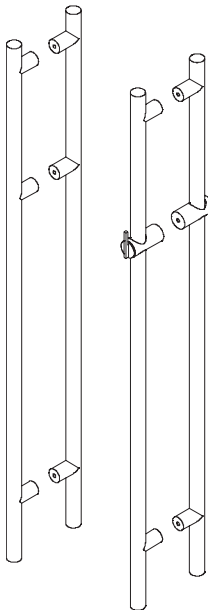

Base Model	Description	Specification
AS-PULL60	60" Ladder Pull	AS-PULL60

Option	Specification Description	Specification
Locking Option	Passage Locking with SFIC	P SFIC
Trim Color	3-digit code	See Aspect hardware finishes

Specification Example: AS-PULL60.P.SIL

Center Swing Pivot Frameless Glass Doors

- General Information:
 - All single center swing pivot doors utilize a nominal 39" door module.
 - Door frames are available in partial strike.
 - The strike plate for partial strike door frames can be reversed, allowing the door frame to be non-handed.
 - Allsteel's center swing pivot door housing can be specified with a passage (non-locking) lever, and a locking lever with a standard format interchangeable core (SFIC). SFIC locking is available for field-keying to building requirements and locks with a 7-pin SFIC push-button lock.
 - The pivot lever housing can accommodate other manufacturers' cylinder-style locks as a custom option.
 - Center swing pivot frameless doors can be specified with ladder pulls. The specification needs to include a magnetic catch and the corresponding door frame and door models.

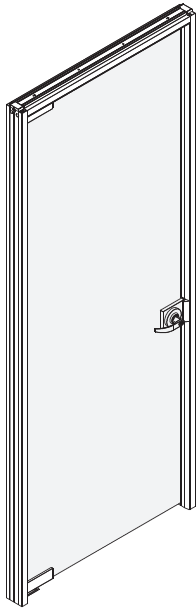

Center Swing Pivot Glass Lever

- Passage (non-locking) and locking with standard format interchangeable core (SFIC) lever options can be specified with Allsteel's glass pivot lever housing.
- Lever housing accommodates other manufacturers' cylinder-style locks as a custom option.

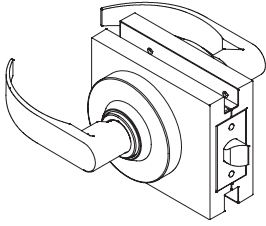

Passage

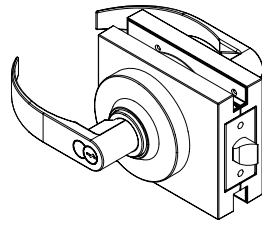

Locking with SFIC

Magnetic Catch

- Painted to match trim finish
- For use with center swing pivot frameless doors when specified with a pull.

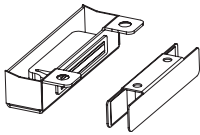

Magnetic Catch

Door Stops

Cylindrical Door Stop

- Floor-mounted.
- Height is 1½" (1.5").

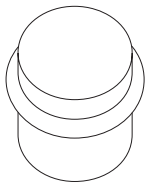

Dome Cylindrical Door Stop

- Floor-mounted.
- Height is 1⅛" (1.125") with optional spacer to increase height to 1½" (1.5").

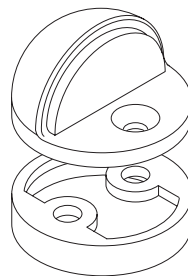

Door Hardware

All door hardware may be specified in silver or in black.

Ladder Pulls

- Use with sliding and center swing pivot frameless glass doors. Pulls can be specified in silver or black stainless steel finish.

12"H Ladder Pull

- ¾" (.75") diameter pull
- Stainless steel finish
- Passage (non-locking) only



20"H Ladder Pull

- 1" diameter pull
- Anodized finish
- Passage (non-locking) only

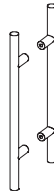

49"H Ladder Pull

- 1 ⅝" diameter pull
- Anodized finish
- Passage option
- Locking option
 - Thumb-turn deadbolt lock is received into a floor socket.
 - Rim cylinder with SFIC format
 - SFIC core for field-keying to building requirements
 - Best E keyway
 - Random keying
 - Use SFIC for any custom keying requirements.
 - LFIC and other RIM cylinders are available as a custom option.
 - Master keying is available by others.

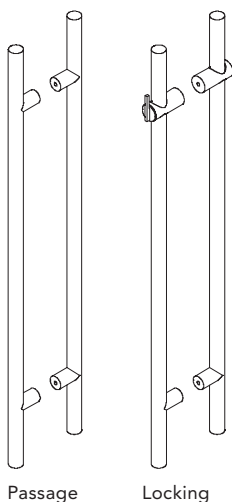

Passage

Locking

Door Hardware

Working with Aspect™

60"H Ladder Pull

- 1 $\frac{3}{8}$ " (1.375") diameter pull.
- Anodized finish.
- Passage and locking options.
 - Thumb-turn deadbolt lock is received into a floor socket.
 - Rim cylinder with SFIC format.
 - SFIC core for field-keying to building requirements.
 - Best E keyway.
 - Random keying.
 - Use SFIC for any custom keying requirements.
 - Master keying, LFIC, and other RIM cylinders are available as a custom option.

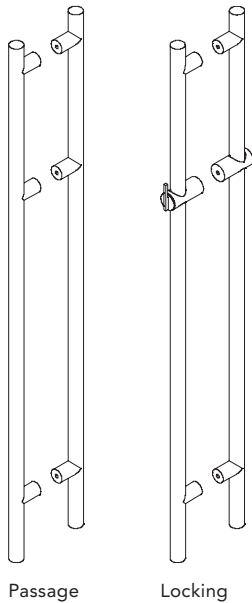

Passage

Locking

72"H Ladder Pull D

- 1 $\frac{3}{8}$ " (1.375") diameter pull.
- Stainless steel finish.
- Passage and locking options.
 - Thumb-turn deadbolt lock is received into a floor socket.
 - Rim cylinder with SFIC format.
 - SFIC core for field-keying to building requirements.
 - Best E keyway.
 - Random keying.
 - Use SFIC for any custom keying requirements.
 - Master keying, LFIC, and other RIM cylinders are available as a custom option.

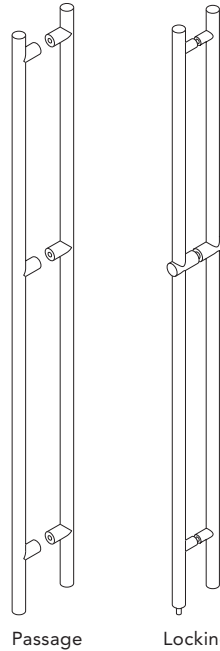

Passage

Locking

D Discontinued 12/31/2020

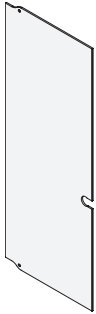

Center Swing Pivot Glass Door

Base Model	Description	Specification
AS-FGPDLEAF	Frameless Glass Pivot Door Leaf	AS-FGPDLEAF
Configuration ID	Specification Description	
Product	Aspect	
Width	39"	
Height	86"-120" in ¼" increments	
Strike Style	Will populate if specified with a ladder pull: Magnetic Catch	
Door Type	Pivot	
Door Style	Frameless Glass	
Handle Type	Pull Lever	
Pull Height	Will populate if specified with a pull: 12" 20" 49" 60"	
Glass Code	HA: ½" Tempered Clear HB: ½" Tempered Low Iron	

Option	Specification Description	Specification
Glass Selection	2-digit glass code	See above - Glass Finish options

Specification Example: AS-FGPDLEAF.####.HA

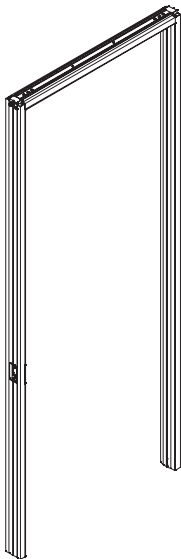

Base Model	Description	Specification
AS-PDFRAME	Pivot Door Frame	AS-PDFRAME
Configuration ID	Specification Description	
Product	Aspect	
Width	39"	
Height	86"-120" in ¼" increments	
Strike Style	Will populate if specified with a lever: Partial	
Door Type	Pivot	
Door Style	Frameless Glass	
Door Module	Single	
Frame Finish	Painted or Anodized Finishes	

Option	Specification Description	Specification
Paint Color Selection	3-digit painted or anodized finish	See Aspect Frame Finishes

Specification Example: AS-PDFRAME.####.P8X

Center Swing Pivot

Aspect™ — Hardware

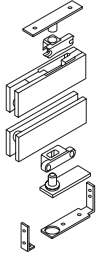

Center Swing Pivot
Glass Door

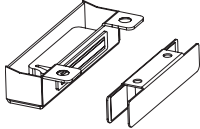

Magnetic Catch

Base Model	Description	Specification
AS-PIVOTMOUNT	Pivot Door Mounting Hardware	AS-PIVOTMOUNT

Option	Specification Description	Specification
Door Material	Frameless Glass	FG
	Aluminum-Framed/Wood	AL-WD
Finish Option	3-digit finish code	See Aspect hardware finishes

Specification Example: AS-PIVOTMOUNT.FG.SIL

Base Model	Description	Specification
AS-MAGCATCH	Magnetic Catch	AS-MAGCATCH

Option	Specification Description	Specification
Paint Color Selection	See Aspect painted metal finish options	3-digit finish code

Specification Example: AS-MAGCATCH.P8X

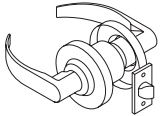

Passage

Base Model	Description	Specification
AS-LEVER	Cylindrical Lockset	AS-LEVER
Option	Specification Description	Specification
Locking Option	Passage Locking with SFIC	P SFIC
Trim Color	3-digit code	See Aspect hardware finishes
Door Material	Frameless Glass Aluminum-Framed/Wood	FG AL-WD

Specification Example: AS-LEVER.P.SIL.FG

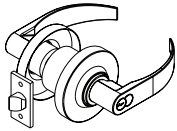

Locking with SFIC

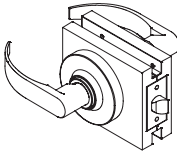

Passage

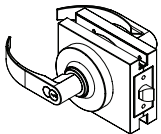

Locking with SFIC



Dome

Base Model	Description	Specification
AS-DOMESTOP	Dome Door Stop	AS-DOMESTOP
Option	Specification Description	Specification
Trim Color	3-digit code	See Aspect hardware finishes

Specification Example: AS-DOMESTOP.SIL



Cylindrical

Base Model	Description	Specification
AS-CYLSTOP	Cylindrical Door Stop	AS-CYLSTOP
Option	Specification Description	Specification
Trim Color	3-digit code	See Aspect hardware finishes

Specification Example: AS-CYLSTOP.SIL



12"

Base Model	Description	Specification
AS-PULL12	12" Ladder Pull	AS-PULL12

Option	Specification Description	Specification
Door Material	Frameless Glass Aluminum-Framed/Wood	FG AL-WD
Trim Color	3-digit code	See Aspect hardware finishes

Specification Example: AS-PULL12.FG.SIL

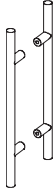

Base Model	Description	Specification
AS-PULL20	20" Ladder Pull	AS-PULL20

Option	Specification Description	Specification
Trim Color	3-digit code	See Aspect hardware finishes

Specification Example: AS-PULL20.SIL

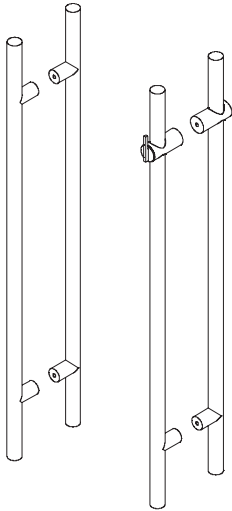

Base Model	Description	Specification
AS-PULL49	49" Ladder Pull	AS-PULL49

Option	Specification Description	Specification
Locking Option	Passage Locking with SFIC	P SFIC
Trim Color	3-digit code	See Aspect hardware finishes

Specification Example: AS-PULL49.P.SIL

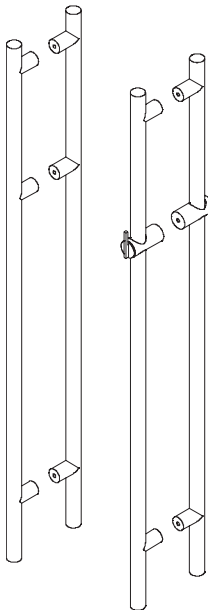

Base Model	Description	Specification
AS-PULL60	60" Ladder Pull	AS-PULL60

Option	Specification Description	Specification
Locking Option	Passage Locking with SFIC	P SFIC
Trim Color	3-digit code	See Aspect hardware finishes

Specification Example: AS-PULL60.P.SIL

Frameless Glass Hinged Doors

- General Information
 - Single option.
 - Single frameless glass hinged doors utilize a nominal 39" module including the frame.
 - Door frames are non-handed.
 - Doors swing 90 degrees both inward and outward. An optional strike bracket can be installed to prevent the outward or inward swing of the door.
- Hydraulic hinges provide self-closing mechanism.
 - Automatic closing from 0 to 80 degrees.
 - Adjustable closing speed.
 - Stops at +90- or -90-degree open position.
- Utilize ladder pull options for door hardware. See the [Hinged Door Hardware pages of the Doors section](#) for details.
- Frameless glass hinged doors can be locked by specifying the locking ladder pull options.
 - The frameless glass center swing pivot door levers may also be used as a custom hardware and custom door frame option to provide additional locking options for frameless glass hinged doors.

Hinged Doors

Working with Aspect™

Solid Hinged Doors

- Available in single and double door options.
- Single doors utilize a nominal 39" module including the frame. Double doors utilize a nominal 75" module including the frame.
- Available in veneer, laminate and painted wood.
- Door frames incorporate a full height strike for the door and are handed for both single and double doors.
- Double doors require specifying an active door.
 - The active door opens and closes with a lever.
 - The inactive door utilizes a flush bolt latch connecting into the door frame to lock out swing. Disengage latch to open the door.
 - The inactive door also incorporates an astragal for the active door to close against and provides a seal against light and sound between the doors.
- Door levers are available in the following options. See the Hardware pages of the Doors section for details.
 - Passage
 - Locking with SFIC

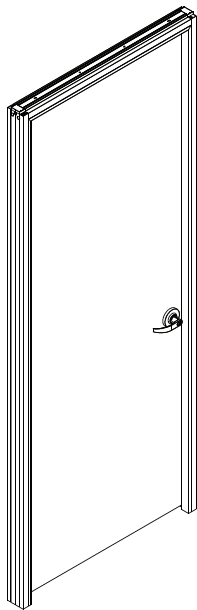

Single Solid Hinged Door

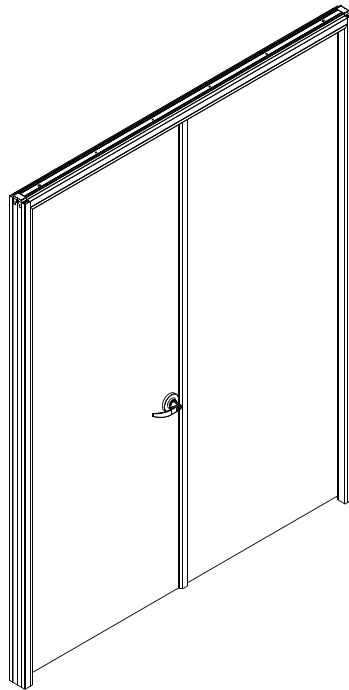

Double Solid Hinged Door

- Allsteel believes there are benefits in guaranteeing environmental and social responsibility. For this reason, all materials can be ordered with FSC (Forest Stewardship Council) Certification, ensuring that products have come from a forest and supply chain that is managed responsibly. Allsteel offers this benefit at no extra charge to consumers.

Door Hardware

All door hardware may be specified in silver or in black.

Ladder Pulls

- Use with frameless glass hinged doors. Pulls can be specified in silver or black stainless steel finish.

12"H Ladder Pull

- ¾" (.75") diameter pull
- Stainless steel finish
- Passage (non-locking) only



20"H Ladder Pull

- 1" diameter pull
- Anodized finish
- Passage (non-locking) only



49"H Ladder Pull

- 1 ⅝" diameter pull
- Anodized finish
- Passage option
- Locking option
 - Thumb-turn deadbolt lock is received into a floor socket.
 - Rim cylinder with SFIC format
 - SFIC core for field-keying to building requirements
 - Best E keyway
 - Random keying
 - Use SFIC for any custom keying requirements.
 - LFIC and other RIM cylinders are available as a custom option.
 - Master keying is available by others.

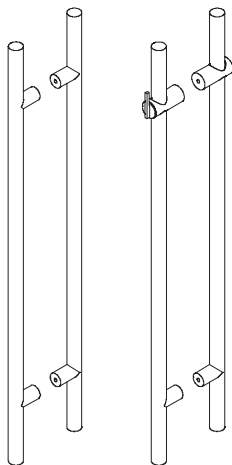

Passage

Locking

Door Hardware

Working with Aspect™

60"H Ladder Pull

- 1 $\frac{3}{8}$ " (1.375") diameter pull.
- Anodized finish.
- Passage and locking options.
 - Thumb-turn deadbolt lock is received into a floor socket.
 - Rim cylinder with SFIC format.
 - SFIC core for field-keying to building requirements.
 - Best E keyway.
 - Random keying.
 - Use SFIC for any custom keying requirements.
 - Master keying, LFIC, and other RIM cylinders are available as a custom option.

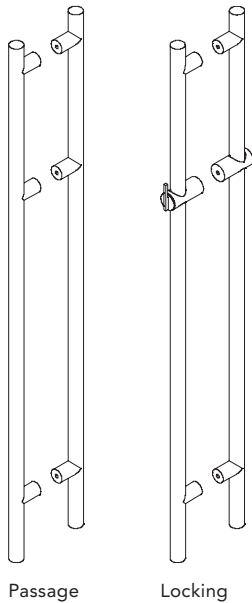

Passage

Locking

72"H Ladder Pull D

- 1 $\frac{3}{8}$ " (1.375") diameter pull.
- Stainless steel finish.
- Passage and locking options.
 - Thumb-turn deadbolt lock is received into a floor socket.
 - Rim cylinder with SFIC format.
 - SFIC core for field-keying to building requirements.
 - Best E keyway.
 - Random keying.
 - Use SFIC for any custom keying requirements.
 - Master keying, LFIC, and other RIM cylinders are available as a custom option.

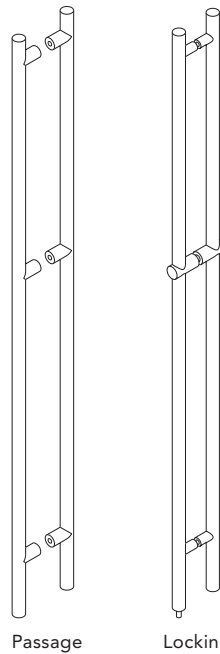

Passage

Locking

D Discontinued 12/31/2020

Hinged Solid Door Lever

- Passage (non-locking) and locking with standard format interchangeable core (SFIC) lever options can be specified with Allsteel's hinged solid door.
- Door lever is non-handed.

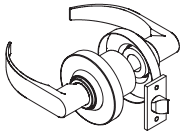

Passage

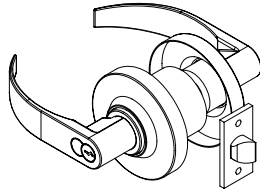

Locking with SFIC

Door Stops

Cylindrical Door Stop

- Floor-mounted.
- Height is 1½" (1.5").

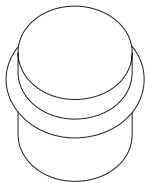

Dome Cylindrical Door Stop

- Floor-mounted.
- Height is 1⅛" (1.125") with optional spacer to increase height to 1½" (1.5").

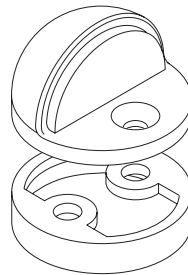

Hinged Doors



Frameless Hinged Glass, Single

Base Model	Description	Specification
AS-FGHDLEAF	Frameless Glass Hinged Door Leaf	AS-FGHDLEAF
Configuration ID	Specification Description	
Product	Aspect	
Width	39"	
Height	86"-120" in ¼" increments	
Door Type	Hinged	
Door Style	Frameless Glass	
Door Module	Single	
Handle Type	Pull	
Pull Height	12" 20" 49" 60"	
Glass Selection	HA: ½" Tempered Clear HB: ½" Tempered Low Iron	

Option	Specification Description	Specification
Glass Code	2-digit glass code	See above - Glass Finish options

Specification Example: AS-FGHDLEAF.#####.QA

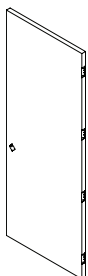

Left-hand

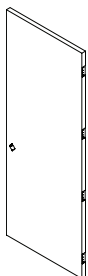

Right-hand

Base Model	Description	Specification
AS-SLDHDLEAF	Solid Hinged Door Leaf	AS-SLDHDLEAF
Configuration ID	Specification Description	
Product	Aspect	
Width	39" - Single Door 75" - Double Door	
Height	86"-120" in ¼" increments	
Door Type	Hinged	
Door Style	Wood	
Door Module	Single Double	
Hand	Left Right	
Leaf Type	Will populate if double door is selected Active Inactive	
Handle Type	Lever	
Floor Treatment	Will populate if drop seal is selected Drop Seal	
FSC	Not FSC-Certified FSC-Certified	
		X FSC
Finish	Veneer, Laminate or Painted Wood Finish	

Option	Specification Description	Specification
FSC Option	Not FSC-Certified FSC Certified	X FSC
Material Grade and Color Option	Veneer - See Aspect Veneer Finishes Laminate - See Aspect Laminate Finishes Painted Wood - See Aspect Painted Wood Finishes	See Aspect Materials & Finishes

Specification Example: AS-SLDHDLEAF.#####.FSC.LWC

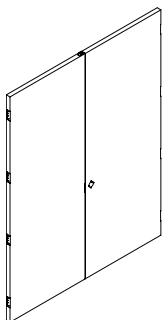

Left-hand

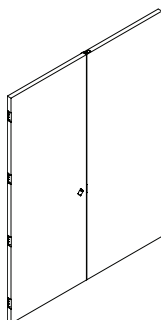

Right-hand

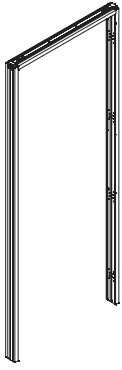

Solid Hinged Door, Single

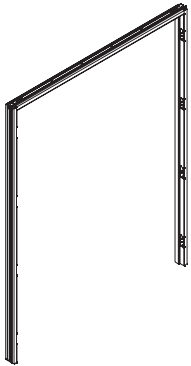

Solid Hinged Door, Double

Base Model	Description	Specification
AS-HDFRAME	Hinged Door Frame	AS-HDFRAME
Configuration ID	Specification Description	
Product	Aspect	
Width	39" - Single Door 75" - Double Door	
Height	86"-120" in ¼" increments	
Strike Style	Will populate if specified with a wood or aluminum framed door Full	
Door Type	Hinged	
Door Style	Frameless Glass Wood or Aluminum	
Door Module	Single Double	
Hand	Will populate if specified with wood or aluminum framed door Left Right	
Frame Finish	Painted or Anodized Finishes	

Option	Specification Description	Specification
Paint Color Selection	3-digit painted or anodized finish	See Aspect Frame Finishes

Specification Example: AS-HDFRAME.#####.P8X

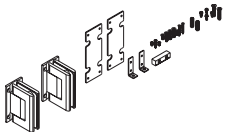

Frameless Hinged Door



Solid Single

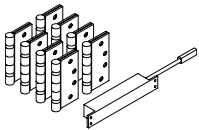

Solid Double

Base Model	Description	Specification
AS-HINGEDMOUNT	Hinged Door Mounting Hardware	AS-HINGEDMOUNT
Option	Specification Description	Specification
Hinge Configuration	Single Double	S D
Type/Functionality sub-option	Frameless Glass Aluminum Framed/Wood	FGCLSR AL-WDNCSR
Trim Color	3-digit code	See Aspect hardware finishes

Specification Example: AS-HINGEDMOUNT.SAL-WDNCSR.SIL

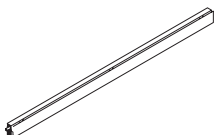

Base Model	Description	Specification
AS-SLDBTMSEAL	Aluminum/Solid Hinged Door Bottom Seal	AS-SLDBTMSEAL

Specification Example: AS-SLDBTMSEAL



12"

Base Model	Description	Specification
AS-PULL12	12" Ladder Pull	AS-PULL12

Option	Specification Description	Specification
Door Material	Frameless Glass Aluminum-Framed/Wood	FG AL-WD
Trim Color	3-digit code	See Aspect hardware finishes

Specification Example: AS-PULL12.FG.SIL

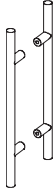

Base Model	Description	Specification
AS-PULL20	20" Ladder Pull	AS-PULL20

Option	Specification Description	Specification
Trim Color	3-digit code	See Aspect hardware finishes

Specification Example: AS-PULL20.SIL

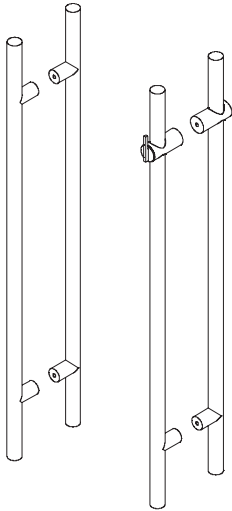

Base Model	Description	Specification
AS-PULL49	49" Ladder Pull	AS-PULL49

Option	Specification Description	Specification
Locking Option	Passage Locking with SFIC	P SFIC
Trim Color	3-digit code	See Aspect hardware finishes

Specification Example: AS-PULL49.P.SIL

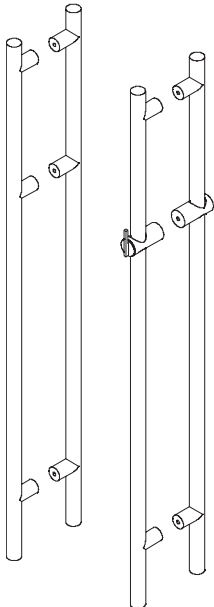

Base Model	Description	Specification
AS-PULL60	60" Ladder Pull	AS-PULL60

Option	Specification Description	Specification
Locking Option	Passage Locking with SFIC	P SFIC
Trim Color	3-digit code	See Aspect hardware finishes

Specification Example: AS-PULL60.P.SIL

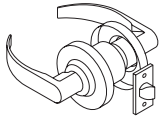

Passage

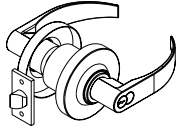

Locking with SFIC



Dome



Cylindrical

Base Model	Description	Specification
AS-LEVER	Cylindrical Lockset	AS-LEVER
Option	Specification Description	Specification
Locking Option	Passage Locking with SFIC	P SFIC
Trim Color	3-digit code	See Aspect hardware finishes
Door Material	Frameless Glass Aluminum-Framed/Wood	FG AL-WD

Specification Example: AS-LEVER.P.SIL.FG

Base Model	Description	Specification
AS-DOMESTOP	Dome Door Stop	AS-DOMESTOP
Option	Specification Description	Specification
Trim Color	3-digit code	See Aspect hardware finishes

Specification Example: AS-DOMESTOP.SIL

Base Model	Description	Specification
AS-CYLSTOP	Cylindrical Door Stop	AS-CYLSTOP
Option	Specification Description	Specification
Trim Color	3-digit code	See Aspect hardware finishes

Specification Example: AS-CYLSTOP.SIL

Custom Door Hardware

- Custom hardware can often be accommodated.
 - Provide as much detail as possible for Allsteel’s Tailored Products Group to review including exact hardware models and specifics of keying requirements if Allsteel is to supply hardware.
 - Exact hardware models.
 - For card readers, identify what the card reader is to control.
- Below are some examples of custom hardware that can be reviewed for compatibility. In some cases, if the requested model is not compatible, Allsteel will offer alternatives that can be accommodated.
 - Other manufacturers’ cylindrical locks.
 - Mortise-style locks.
 - Electric locks (cylindrical or mortise style).
 - Magnetic locks.
 - Electronic strikes.
 - Card reader mounting capabilities.
 - Mortise-style panic bars.
 - External overhead closers/floor closers.

Commonly used custom hardware for Allsteel doors include:

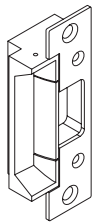

Electric Strike

- Suitable for solid doors.
- Requires a custom door frame and strike.
- Strike is non-handed.
- All wiring and interface to security system are provided by others.

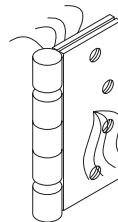

Electrified Hinges

- Suitable for solid doors.
- Use with electric locks.
- Requires custom mounting hardware, door, and door frame.
- 4-wire electrical system. 8-wire system optional.
- All wiring and interface to the security system to be provided by others.

LCN® 4011 Closer

- Suitable for solid doors.
- Requires custom door, door frame, and closer.
- Door, door frame, and closer are handed.
- 100-degree arm and no-hold open.
 - 140-degree arm and hold-open feature are additional options.
- Closer mounted to pull side.
- Manufactured by LCN®.

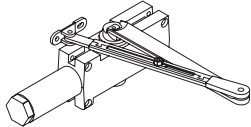

LCN® 4040XP Closer

- Suitable for solid doors.
- Requires custom door, door frame, and closer.
- Closer is non-handed.
- 100-degree arm and no-hold open.
 - 140-degree arm and hold-open feature are additional options.
- Closer mounted to push side.
- Manufactured by LCN®.

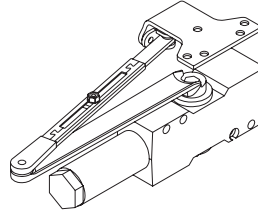

Magnetic Lock for Center Swing Pivot Frameless Glass Doors

- Requires custom door, door frame, and lock.
- Door frame is handed.
- Door and lock are non-handed.
- All wiring and interface to the security system are provided by others.

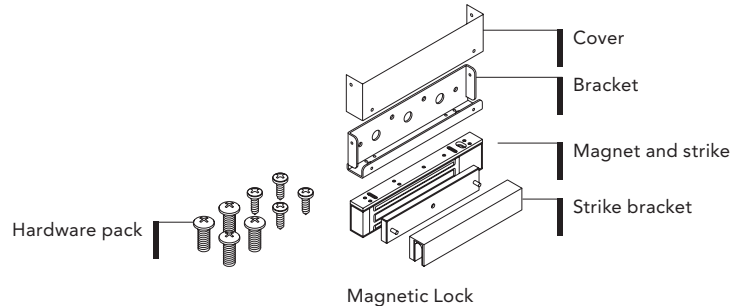

Door Hardware Reference Guide

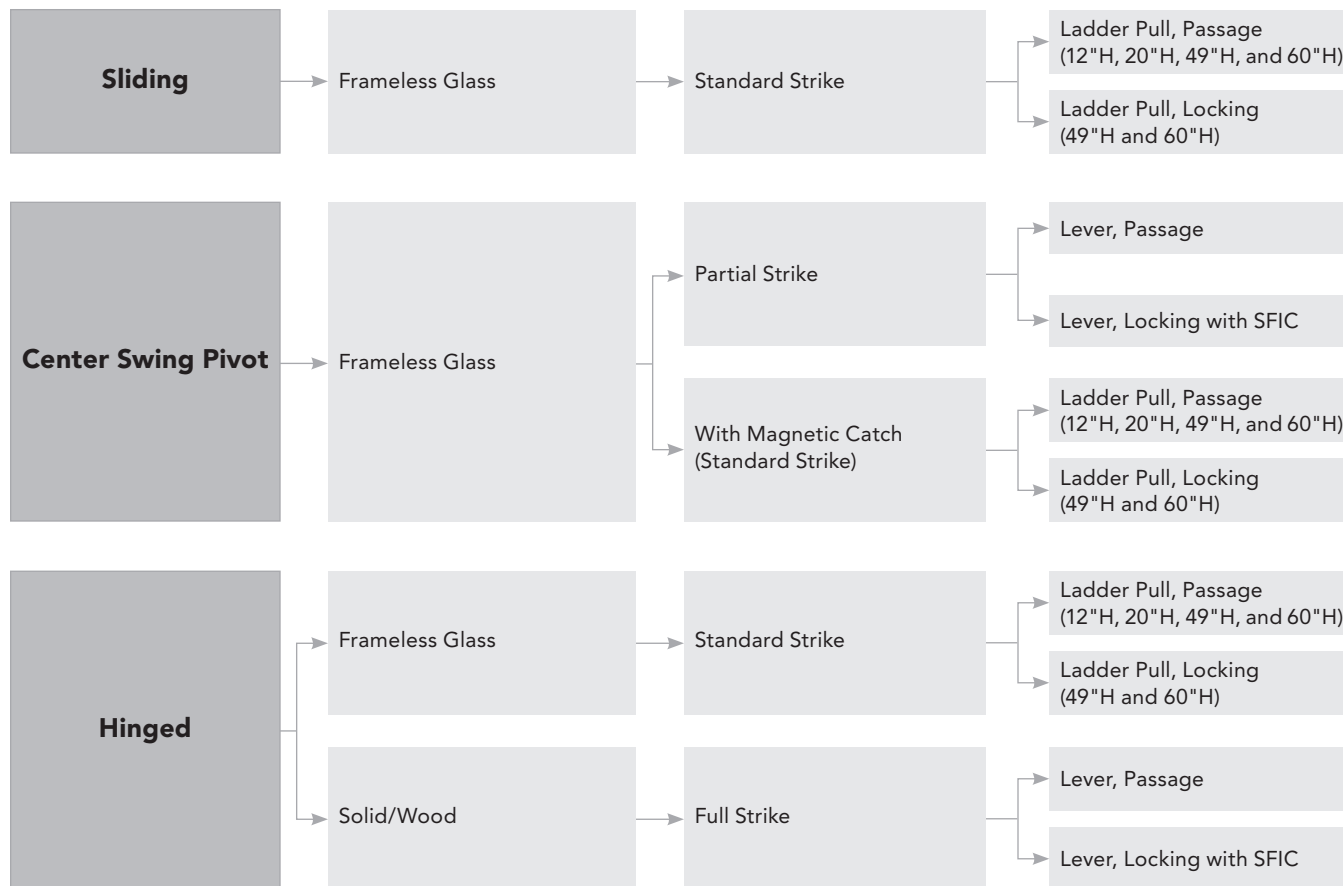

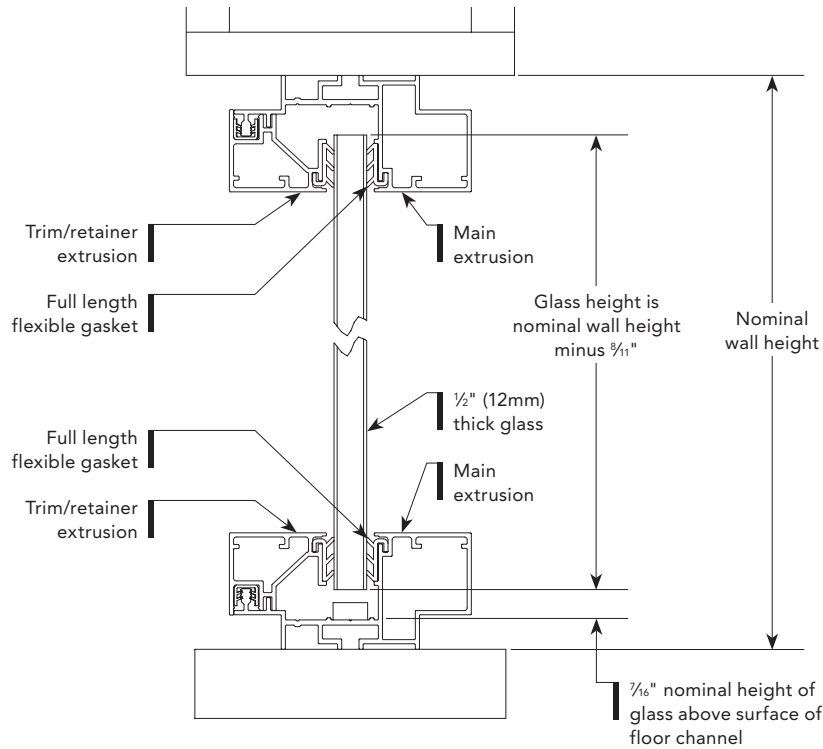

- Panel Dimensions
 - Height
 - 18"–120" in $\frac{1}{16}$ " increments
 - Width
 - 8"–42" up to 120"H in $\frac{1}{16}$ " increments
 - 42 $\frac{1}{16}$ "–48"W up to 108"H in $\frac{1}{16}$ " increments
 - Glass Thickness
 - $\frac{1}{2}$ "
- General overview
 - Universal two-piece trim at 1 $\frac{1}{16}$ " high captures the glass at the top, bottom and at wallstarts
 - Corner block pieces lock horizontal and vertical trim elements together, creating clean corner connections and maintaining a continuous reveal. The continuous reveal is a unique aesthetic element that creates a look of windows between spaces
 - Trim is removable to allow front loading of glass and ease of leveling
 - Panels are leveled through adjustment of setting blocks (shims)
 - Base trim remains flush with the floor for a clean aesthetic because glass is leveled inside base

- trim
- Aspect applications
 - 1, 2, 3, and 4-sided applications
 - Product designed for office front or conference room walls. Panels are anchored into the floor and ceiling and the weight of the doors is supported at the ceiling. Product designed to fit under a drywall soffit. Blocking required to support the weight of the doors.
 - Refer to the Pre-Specification guide for building requirement details.

Frameless Glass

- General Overview
 - Aspect laminated glass panels are available with no additional upcharge over tempered glass. Laminated glass panels have a 36 STC rating for a fully assembled panel. Option to upgrade to 39 STC rating for a fully assembled panel with a high performance interlayer.
 - Aspect is specified in exact dimensions
 - Thickness: $\frac{1}{2}$ " (0.5")
 - $\frac{1}{16}$ " for width and height



Base Model	Description	Specification
AS-SGFRMLSTPANEL	Frameless Glass Panel, Tempered	AS-SGFRMLSTPANEL
Configuration ID	Specification Description	
Product	Aspect	
Width	8"-42" in 1/16" increments up to 120"H 42 1/16"-48"W up to 108"H in 1/16" increments	
Height	18"-120" in 1/16" increments	
Glass code	HA: 1/2" Tempered Clear HB: 1/2" Tempered Low Iron	

Specification Example: AS-SGFRMLSTPANEL.#####



Base Model	Description	Specification
AS-SGFRMLSLPANEL	Frameless Glass Panel, Laminated	AS-SGFRMLSLPANEL
Configuration ID	Specification Description	
Product	Aspect	
Width	8"-42" in 1/16" increments up to 120"H 42 1/16"-48"W up to 108"H in 1/16" increments	
Height	18"-120" in 1/16" increments	
Glass code	HC: 1/2" Laminated Clear HD: 1/2" Laminated Low Iron HG: 1/2" Laminated, High Performance Clear HH: 1/2" Laminated, High Performance Low Iron	

Specification Example: AS-SGFRMLSLPANEL.#####

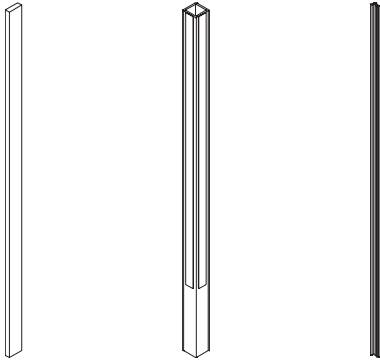

Vertical Fillers for Glass

- Description:
 - QTY 1 at each connection
 - Always comes in 120" lengths
 - Must be cut in field
 - Three types of connections
- Straight (Inline Application):
 - Clear VHB tape at inline connections
 - Use between glass panels in a straight run
- 2-Way (90-Degree Application):
 - Clear polycarbonate filler
 - Use between glass panels at 90-degree corner connections
- 3-Way (Three-Way Application):
 - Clear polycarbonate filler
 - Use for glass panels that intersect at a three-way intersection such as for set-back panels or glass demising walls



Base Model	Description	Specification
AS-FGFILLER	Vertical Filler	AS-FGFILLER

Configuration ID	Specification Description
------------------	---------------------------

Product	Aspect
---------	--------

Dimension	120"
-----------	------

Trim Type	Vertical Filler
-----------	-----------------

Trim Use	Straight – note: material is VHB tape at straight connection
----------	---

	Two Way
	Three Way

Finish Color	See below
--------------	-----------

Option	Specification Description	Specification
--------	---------------------------	---------------

Vertical Filler Selection	Clear Polycarbonate	CPC
---------------------------	---------------------	-----

Specification Example: AS-FGFILLER.#####.CPC

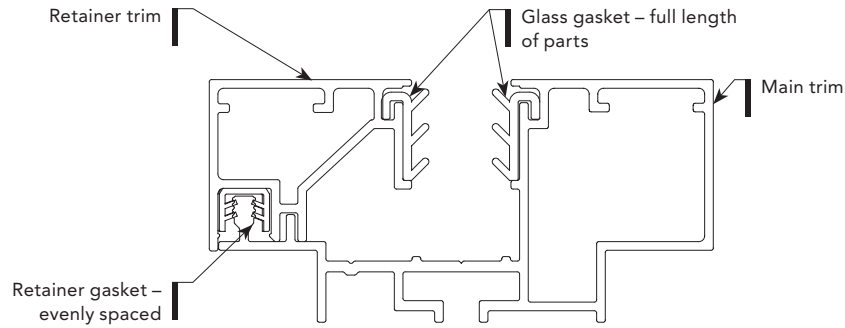

Universal Trim

- Universal two-piece trim
 - Comprised of a main trim piece and a retainer trim piece.
 - Two pieces are connected with a retainer gasket.
 - Trim captures the glass at the top, bottom and at wallstarts.
- Dimensions
 - 1¹/₁₆" tall
 - 3¹/₂" wide
 - 1/2" reveal
 - Straight trim comes in 120" lengths.
 - Two-way and three-way trim comes pre-mitered on both sides for ease of install.

Universal Trim

Working with Aspect™

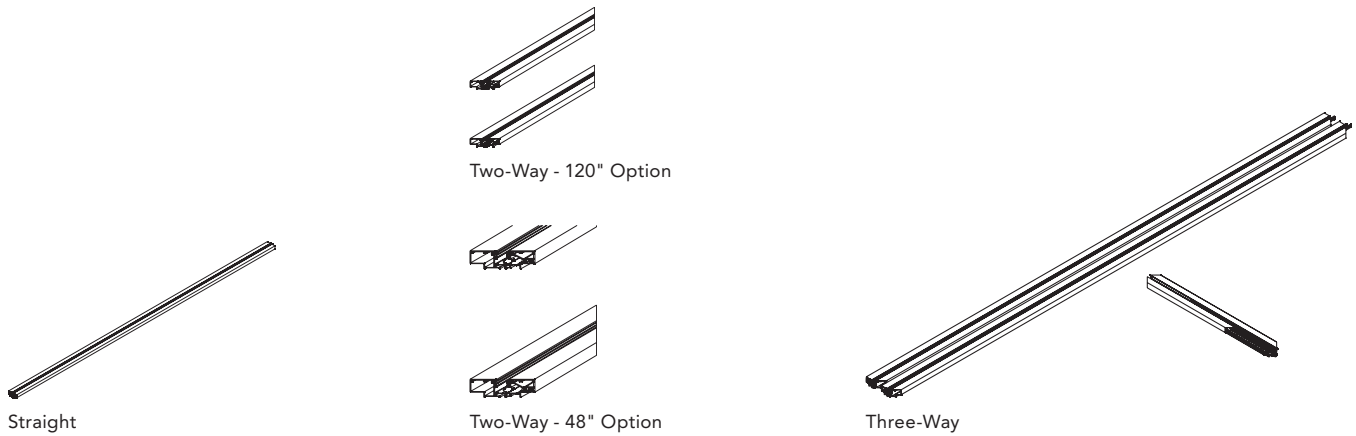

- Straight: 120" lengths only
 - Order QTY (1) for top
 - Order QTY (1) for bottom
- Two-Way: 48" and 120" options
 - Order QTY (1) for top and bottom, one side (contains 2 sets of trim)
 - Order QTY (1) for top and bottom, other side (contains 2 sets of trim)
- Three-Way:
 - Order QTY (1) for top which includes
 - 120" for main run, top (contains 2 sets of trim)
 - 36" for demising wall, top
 - Order QTY (1) for bottom which includes
 - 120" for main run, bottom (contains 2 sets of trim)
 - 36" for demising wall, bottom

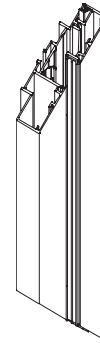

Two-Way

Leveling

- Panels have +/- 1/4" adjustment over 6 ft.
- To level panels, setting blocks are placed in the base channel.
- See Aspect Installation Guide for details.

Setting Blocks (Shims)

- Trim is removable to allow front loading of glass and ease of leveling. Panels are leveled through adjustment of setting blocks (shims).
- Base trim remains flush with the floor for a clean aesthetic because glass is leveled inside base trim.
- Need QTY (1) AS-INSTALLKIT per 100 LF
- Installation Kit
 - Contains setting blocks (shims) for leveling in the following sizes and quantities:
 - Glass Setting Block 1/16 – QTY 100
 - Glass Setting Block 1/8 – QTY 100
 - Glass Setting Block 1/4 – QTY 100
 - Glass Setting Block 3/8 – QTY 100

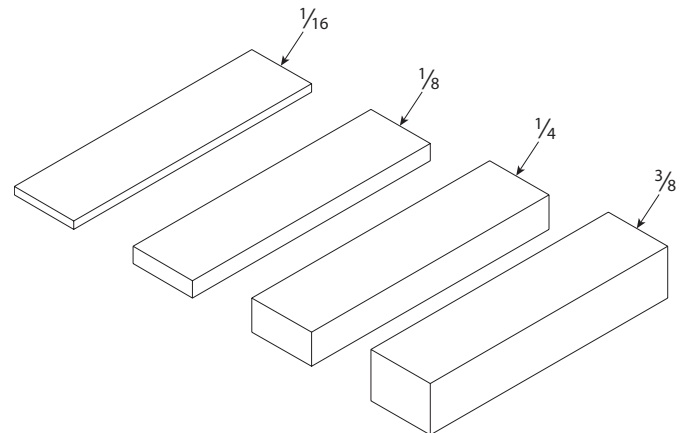

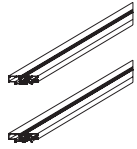
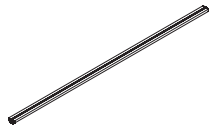

Two-Way - 120" Option

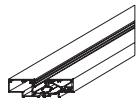

Two-Way - 48" Option

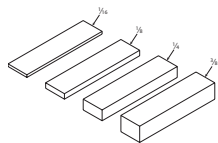
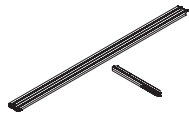

Base Model	Description	Specification
AS-SGU2PCTRIM	Universal Two-Piece Floor and Ceiling Trim	AS-SGU2PCTRIM

Configuration ID	Specification Description
------------------	---------------------------

Product	Aspect
Dimension	120" – Straight, Three Way 48", 120" – Two Way
Trim Type	Single Pane
Trim Use	Straight Two Way Three Way
Finish Color	Painted or Anodized Finishes

Option	Specification Description	Specification
--------	---------------------------	---------------

Paint Color Selection	3-digit painted or anodized finish	See Aspect Frame Finishes
-----------------------	------------------------------------	---

Specification Example: AS-SGU2PCTRIM.#####.P8X

Base Model	Description	Specification
AS-INSTALLKIT	Installation Kit	AS-INSTALLKIT

Specification Example: AS-INSTALLKIT



Wall Channel

- Wall channels are used when Aspect glass intersects with drywall or the building interior. Wall channel is comprised of the same 2-piece universal trim as the top and bottom trim; however, the wall channel contains a notch at the top. This notch is necessary for the trim component to clear the glass gasket during installation.
- Dimensions
 - 1¹/₁₆" tall
 - 3¹/₂" wide
 - 1/2" reveal
- Wall channels also come with QTY (2) corner blocks
 - Corner blocks help with the alignment of the vertical and horizontal elements and create a continuous reveal.
 - Corner blocks are automatically included and do not need to be specified.
- Wall channels have +/- 1/4" of adjustment.
- Wall channels are used to connect glass to drywall, glass to door frame, and when glass intersects a drywall end cap.
 - Specify QTY (1) from glass to drywall.
 - Specify QTY (1) from glass to door frame.
 - Specify QTY (1) from glass to end cap.

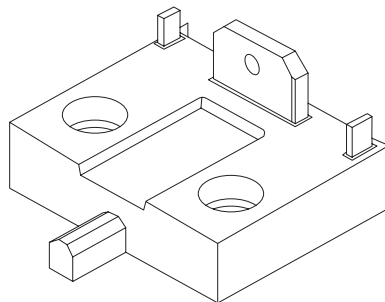

Wall Channel Corner Block

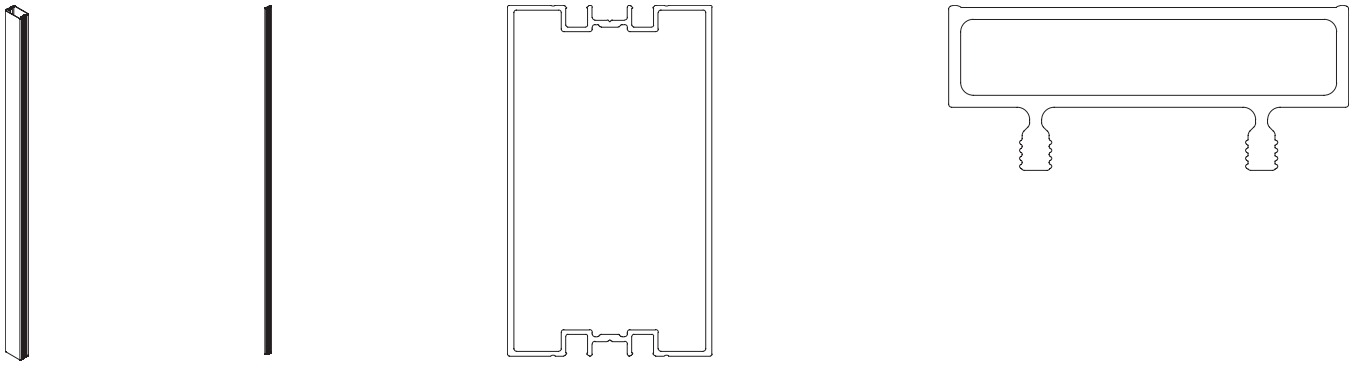

Drywall end caps are used to create a clean, continuous look across a wall run. Three-way drywall end caps are used at a three-way connection where drywall connects perpendicularly to Aspect (typically as a demising wall). The end of the Aspect wall terminates in a drywall end cap post that extends to cover the width of the drywall. Drywall endcap adapters are used to connect an Aspect door frame into the drywall end cap.

- Drywall end caps should be planned so the end of the drywall end cap post aligns with the face of the perpendicular drywall.
 - The 6" wide three-way post is engineered to accommodate drywall widths up to 5½". They should be planned so the centerline of the post aligns with the centerline of the perpendicular drywall. Contact Architectural Products Engineering prior to shop drawing completion if specifying a door adjacent to a drywall end cap with a ladder pull or non-standard lever set for the door hardware to ensure the door will open a full 90 degrees.
- One full height length strip of foam tape is installed to provide an acoustic seal at the demising drywall condition. Allsteel will also supply a piece of foam for the top gap between the ceiling channel and the drywall.
- Dimensions
 - Actual and planning dimensions of a three-way drywall end cap are 6" wide.

- Service Kit:
 - Specified as base model AS-SERVICEKIT
 - Need 1 kit per 100 LF
 - Finish type must be specified on Service Kit
 - Contains extra door mounting hardware, corner blocks, screws, and other miscellaneous items to assist with installation.

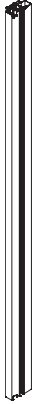

Base Model	Description	Specification
AS-SGWCHANNEL	Vertical Frameless Glass Wall Channel	AS-SGWCHANNEL

Configuration ID	Specification Description
Product	Aspect
Dimension	120"
Trim Type	Wall Channel
Trim Use	Universal
Finish Color	Painted or Anodized Finishes

Option	Specification Description	Specification
Paint Color Selection	3-digit painted or anodized finish	See Aspect Frame Finishes

Specification Example: AS-SGWCHANNEL.#####.P8X

Base Model	Description	Specification
AS-SERVICEKIT	Service Kit	AS-SERVICEKIT

Option	Specification Description	Specification
Paint Color Selection	3-digit painted or anodized finish	See Aspect Frame Finishes

Specification Example: AS-SERVICEKIT.P8X



Base Model	Description	Specification
AS-ENDCAP	Drywall Endcap	AS-ENDCAP
Configuration ID	Specification Description	
Product	Aspect	
Dimension	120"	
Trim Type	Drywall End Cap	
Trim Use	Universal	
Finish Color	Painted or Anodized Finishes	
Option	Specification Description	Specification
Paint Color Selection	3-digit painted or anodized finish	See Aspect Frame Finishes

Specification Example: AS-ENDCAP.#####.P8X



Base Model	Description	Specification
AS-DECAPADAPTER	Door to Drywall Endcap Adapter	AS-DECAPADAPTER
Configuration ID	Specification Description	
Product	Aspect	
Dimension	120"	
Trim Type	Drywall End Cap	
Trim Use	Adjacent Door	
Finish Color	Painted or Anodized Finishes	
Option	Specification Description	Specification
Paint Color Selection	3-digit painted or anodized finish	See Aspect Frame Finishes

Specification Example: AS-DECAPADAPTER.#####.P8X

MODEL REFERENCE GUIDE

Old Base Model	Old Description	New Base Model	New Description
BYLPG12	Door Pull - 12" Ladder Pull GL Door	AS-PULL12	12" Ladder Pull (Aspect)
BYLPG60	Door Pull - Ladder Pull GL Door	AS-PULL60	60" Ladder Pull (Aspect)
BYLPW12	Door Pull - Ladder Pull WD/AL Door	AS-PULL12	12" Ladder Pull (Aspect)
BYLPW60	Door Pull - 60H Ladder Pull WD/AL Door	AS-PULL60	60" Ladder Pull (Aspect)
BYRPG	Door Pull - 20H Ladder Pull GL Door	AS-PULL20	20" Ladder Pull (Aspect)
BYRPW	Door Pull - 20H Ladder Pull WD/AL Door	AS-PULL20	20" Ladder Pull (Aspect)
NFDWDA	Drywall Endcap Door Adapter	AS-DECAPADAPTER	Door to Drywall Endcap Adapter
NFDWT	Drywall Endcap Tee	AS-ENDCAP	Drywall Endcap
NFGPN	Half Inch Frameless Glass	AS-SGFRMLSTPANEL	Frameless Glass Panel, Tempered
NFGPN	Half Inch Frameless Glass	AS-SGFRMLSLPANEL	Frameless Glass Panel, Laminated
NFHDDSWS	Drop Seal - Hinged Wood Single	AS-SLDBTMSEAL	Solid Hinged Door Bottom Seal
NFHDFD	Hinged Wood Door Frame - Double	AS-HDFFRAME	Hinged Door Frame
NFHDFS	Hinged Wood Door Frame - Single	AS-HDFFRAME	Hinged Door Frame
NFHDFSG	Hinged Glass Door Frame - Single	AS-HDFFRAME	Hinged Door Frame
NFHDWD	Wood Door - Hinged Double	AS-SLDHLEAF	Solid Hinged Door Leaf
NFHDWS	Wood Door - Hinged Single	AS-SLDHLEAF	Solid Hinged Door Leaf
NFIK	Installation Kit	AS-INSTALLKIT	Installation Kit
NFPDFS	Pivot Glass Door Frame - Single	AS-PDFRAME	Pivot Door Frame
NFPDFSMC	Pivot Glass Dr Frame- Single for Magnetic Catch	AS-PDFRAME	Pivot Door Frame
NFPDGS	Frameless Glass Door - Pivot Single	AS-FGPDLEAF	Frameless Glass Pivot Door Leaf
NFPDGSMC	Frameless Gls Dr-Pivot Single for Magnetic Catch	AS-FGPDLEAF	Frameless Glass Pivot Door Leaf
NFSDFD	Sliding Glass Door Frame - Double	AS-SDFRAME	Sliding Door Frame
NFSDFS	Sliding Glass Door Frame - Single	AS-SDFRAME	Sliding Door Frame
NFSDGDT	Frameless GlsDr Sliding 3/8" ThickGls Double	AS-FGSDLEAF	Frameless Glass Sliding Door Leaf
NFSDGST	Frameless GlsDr Sliding 3/8" ThickGls Single	AS-FGSDLEAF	Frameless Glass Sliding Door Leaf
NFSK	Service Kit	AS-SERVICEKIT	Service Kit
NFTKL	1/2" Floor and Ceiling Trim Kit - 2-Way	AS-SGU2PCTRIM	Universal Two-Piece Floor and Ceiling Trim
NFTKS	1/2" Floor and Ceiling Trim Kit - Straight	AS-SGU2PCTRIM	Universal Two-Piece Floor and Ceiling Trim
NFTKT	1/2" Floor and Ceiling Trim Kit - 3-Way	AS-SGU2PCTRIM	Universal Two-Piece Floor and Ceiling Trim
NVFL	1/2" Vertical Filler - 2-Way	AS-FGFILLER	Vertical Filler
NVFT	1/2" Vertical Filler - 3-Way	AS-FGFILLER	Vertical Filler
NVGC	1/2" Glazing Connection - Straight	AS-FGFILLER	Vertical Filler
NFWCFD	Wall Channel - Door Frame to Drywall	AS-DWCHANNEL	Wall Channel - Door Frame to Drywall
NFWCGD	1/2" Wall Channel - Vertical Trim Kit	AS-SGWCHANNEL	Vertical Frameless Glass Wall Channel
NFSDFS / NFSDFD	Sliding Glass Door Frame - Single / Double	AS-SDTRACK	Sliding Door Track
NFPDGSMCR	Frameless Glass Door - Pivot, Single for Magnetic Catch	AS-FGPDLEAF	Frameless Glass Pivot Door Leaf
NFSDGDTR	Frameless Glass Door - Sliding, 3/8" Thick Glass, Double	AS-FGSDLEAF	Frameless Glass Sliding Door Leaf
NFSDGSTR	Frameless Glass Door - Sliding, 3/8" Thick Glass, Single	AS-FGSDLEAF	Frameless Glass Sliding Door Leaf
NFHDSG	Frameless Glass Door - Hinged, Single	AS-FGHDLEAF	Frameless Glass Hinged Door Leaf
NFHDSGR	Frameless Glass Door - Hinged, Single	AS-FGHDLEAF	Frameless Glass Hinged Door Leaf
NVFS	NOF VRT FILLER 3 WAY	AS-FGFILLER	Vertical Filler
APCHLPG12	12" Pull - Glass	AS-PULL12	12" Ladder Pull (Aspect)
APCHLP60	60" Pull	AS-PULL60	60" Ladder Pull (Aspect)
APCHLPW12	12" Pull - Wood	AS-PULL12	12" Ladder Pull (Aspect)
APCHLP60	60" Pull	AS-PULL60	60" Ladder Pull (Aspect)
APCHLP20	20" Pull	AS-PULL20	20" Ladder Pull (Aspect)
APCHLP20	20" Pull	AS-PULL20	20" Ladder Pull (Aspect)
APCHLP49	49" Pull	AS-PULL49	49" Ladder Pull (Aspect)

SPECIFICATION AND PRICING*

Aspect Budgeting Tool

Website: <https://www.allsteelsynergy.com/Pages/AspectBudgetingTool.aspx>

Create real time product and freight budgets with ease using this online tool – no need for the Design Intake Form! Designed to build storefront applications between drywall, the tool uses simple inputs to generate an estimated bill of materials behind the scenes for accurate and consistent budget pricing. Product specifications include standard finishes and hardware. Pricing is net to the dealer, excluding installation.

Special Pricing Application

Website: <https://www.allsteelsynergy.com/PricingProposals/BidPricing/SpecialPricingForm/Pages/SpecialPricingForm.aspx>

Utilize the Pricing Application to request project discounting. Send completed form with project drawings and bill of materials to AllsteelBids@allsteeloffice.com.

Allsteel Design Intake Form

Website: <https://www.allsteelsynergy.com/Pages/ASIIIntakeForm.aspx>

Request and schedule Allsteel design support, audit or consultation services using the Design Intake Form. Communicate project details, scope and specifications, as well as attach files for design review.

Literature and Samples

Website: www.allsteeladvantage.com

Order printed literature, materials, and finish samples for Aspect.

TRAINING

Website: www.allsteelsynergy.com

Allsteel University provides several Architectural Products online and instructor-led training opportunities. Please access Allsteel University on Synergy to sign up for online modules and instructor-led courses on product, design or project lifecycle processes. Additional instructional materials are available on Synergy.

Installation

Website: www.HNIPProductInstall.com

Access installation resources such as instructional videos, installation and punch guides, checklists, standard work, Installation Certification Program requirements, Installation Network Listing, and more!

Other Synergy Resources

Website: www.allsteelsynergy.com

- Case studies
- Environmental information
- Engineering specifications
- Hardware cut sheets
- Product imagery
- Product literature (sell sheets, product cards, brochures)
- Sales presentations
- Technical information

CONTACTS

Order Management: ArchProducts@allsteeloffice.com

Pricing: AllsteelBids@allsteeloffice.com

Design: ASIDesignAP@allsteeloffice.com

Synergy: SynergySupport@hnicorp.com

CET Designer: CETSupport@allsteeloffice.com

Tailored Products Group:

ARCHITECTURAL-PE@allsteeloffice.com

**Disclaimer: Many of the resources listed are available only to approved dealers who are participating in the Allsteel Architectural Projects Dealer Certification Program.*



Allsteel®

Allsteel Inc.
Muscatine, Iowa 52761

allsteeloffice.com

Form # A8660.A5 (10/22)