

Cityscape 2.0

Installation Instructions

HBF

TOOLS REQUIRED

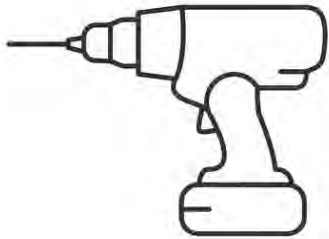

POWER DRIVER/DRILL



4MM ALLEN WRENCH
8MM ALLEN WRENCH

STANDARD MODEL LEG ATTACHMENT

PLACE UNIT ON ITS BACK AND ATTACH LEGS AS SHOWN BELOW.

- (16) ¼-20 x 23mm Ultra Low Profile Socket Head Bolt. (4) Bolts per leg assembly
- (4) Leg Assembly

This attachment process
Works for the following
Models:

HLD421-011

HLD421-041

HLD421-012

HLD421-042

HLD421-013

HLD421-043

HLD421-021

HLD421-044

HLD421-022

HLD421-023

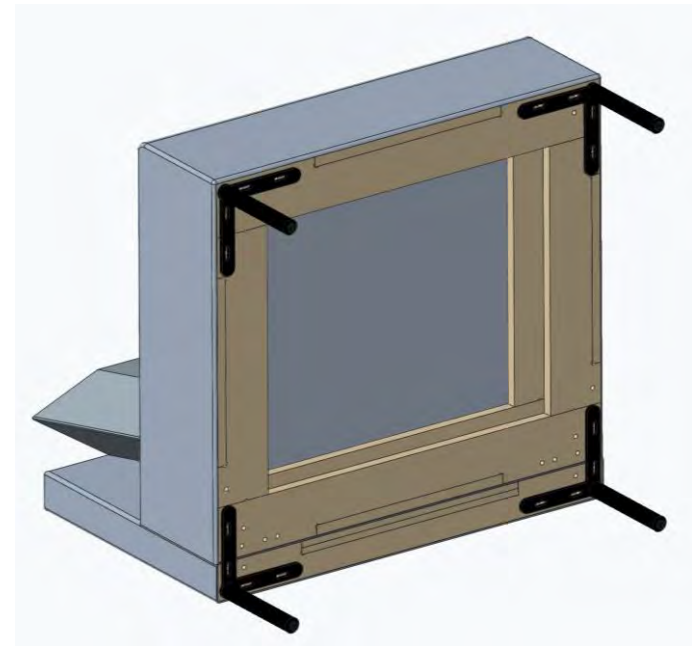
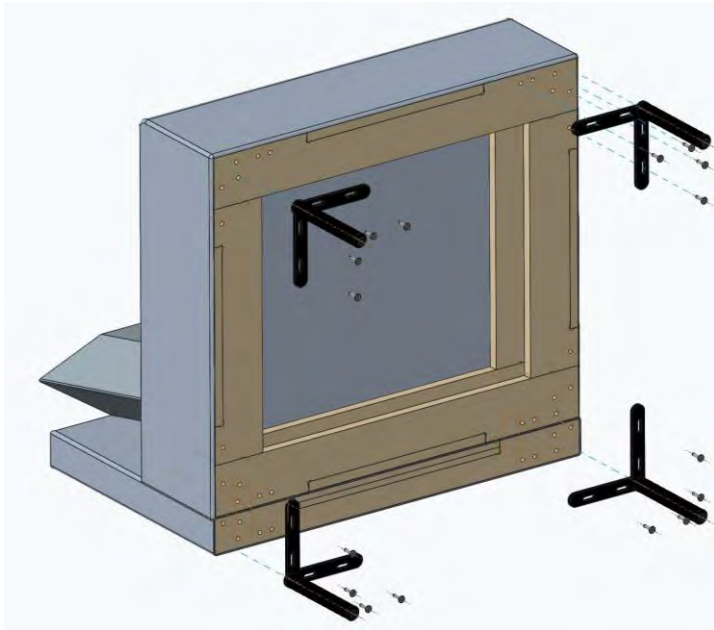

Legs Positioned in corners as shown

PENTAGON LEG ATTACHMENT

PLACE UNIT ON ITS BACK AND ATTACH LEGS
AS SHOWN BELOW.

- (20) ¼-20 x 23mm Ultra Low Profile Socket Head Bolt
- (3) 120 deg leg assembly
- (2) 90 deg leg assembly

This attachment process
works for the following
models:

HLD421-014

HLD421-024

HLD421-034

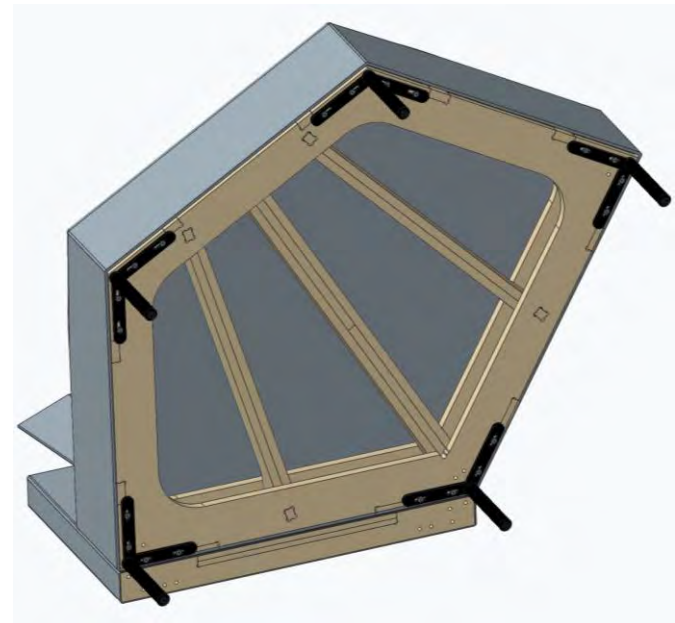
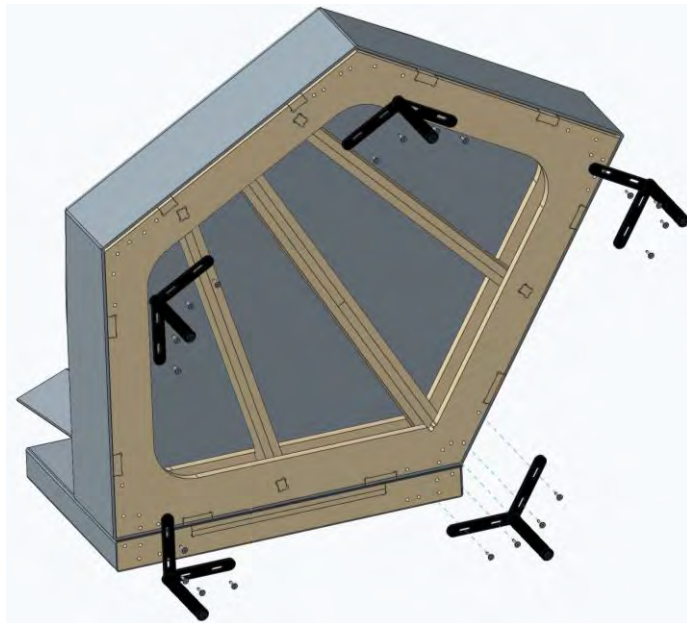

Legs Positioned in corners as shown

OPTIONAL LEG ATTACHMENT
ON PAGE "5"

PENTAGON OPTIONAL LEG ATTACHMENT

- (20) 1/4-20 x 23mm Ultra Low Profile Socket Head Bolt
- (2) 120 deg leg assembly
- (3) 90 deg leg assembly

This attachment process allows for all legs to be in alignment along all backs in the direction of the configuration being created.

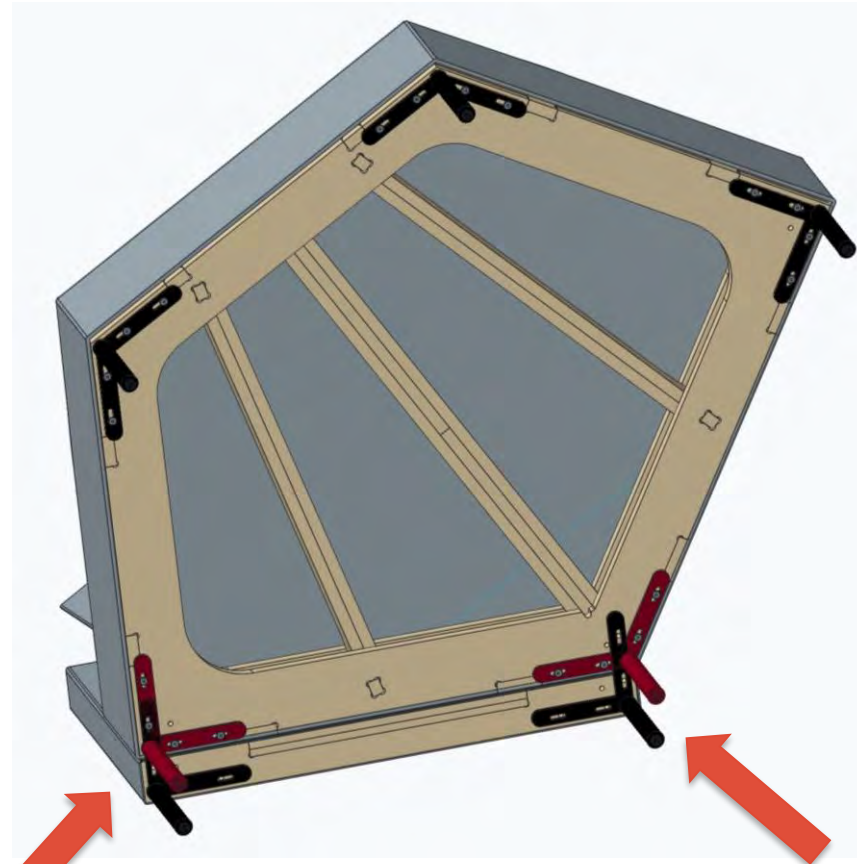

Assemble this 90 deg leg as shown (black)

OMIT this 120 deg leg (red) and assemble 90 deg (black) leg as shown

CITYSCAPE 2.0 TABLE ASSEMBLY AND LEG ATTACHMENT

- (8) ¼-20 x 15mm Ultra Low Profile Socket Head Bolt
- (2) Table Pedestals
- (2) Round Attachment Plates
- (2) ½-13 Steel Hex Head Bolts

Using (8) 15mm bolts, attach pedestal to the upper table top in the manner shown.

PLEASE DO NOT OVER-TORQUE BOLTS.

Carefully align both pedestals with the large holes in the lower table top, **insuring that the back edges of both tops are parallel.**

Attach round attachment plates to each pedestal with the ½-13 bolts and fully tighten.

THIS TABLE ASSEMBLY REQUIRES THE ATTACHMENT OF ADJACENT UNITS. ONE ON EACH SIDE. IT IS NOT A STAND ALONE UNIT

This assembly process works for the following models:

HTD42101-3231	HTD42101-5931
HTD42102-3231	HTD42102-5931
	HTD42103-5931

STEP 1

Table Top Assembly

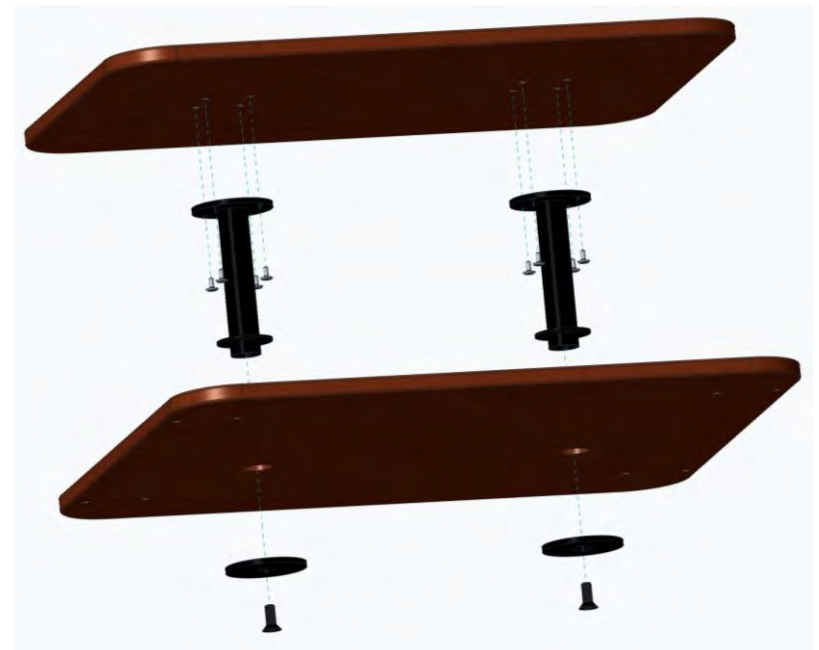

CITYSCAPE 2.0 TABLE ASSEMBLY AND LEG ATTACHMENT

- (8) ¼-20 x 15mm Ultra Low Profile Socket Head Bolt
- (2) Right Leg Assemblies
- (2) Left Leg Assemblies

Using (8) 15mm bolts, attach leg assemblies as shown. Snug bolts just enough to be able to adjust legs after adjacent units are attached (page 8).

Once adjacent units are attached and aligned, fully tighten bolts

PLEASE DO NOT OVER-TORQUE BOLTS.

This assembly process works
for the following models:
HTD42101-3231 HTD42101-5931
HTD42102-3231 HTD42102-5931
HTD42103-5931

STEP 2 Leg Assembly



TABLE AND ADJACENT UNIT ASSEMBLY

- Place assembled table on its back.
- Place adjacent units on their backs. If leg assemblies have not been installed, do not install the leg assemblies that will be replaced by the table leg assemblies. If leg assemblies have been installed, remove leg assemblies (**red leg assemblies**).
- Slide adjacent units into position and reuse the 23mm bolts to attach the units to the table.
- Carefully place the assembled unit in its upright position.

This assembly process works
for the following models:

HTD42101-3231	HTD42101-5931
HTD42102-3231	HTD42102-5931
	HTD42103-5931

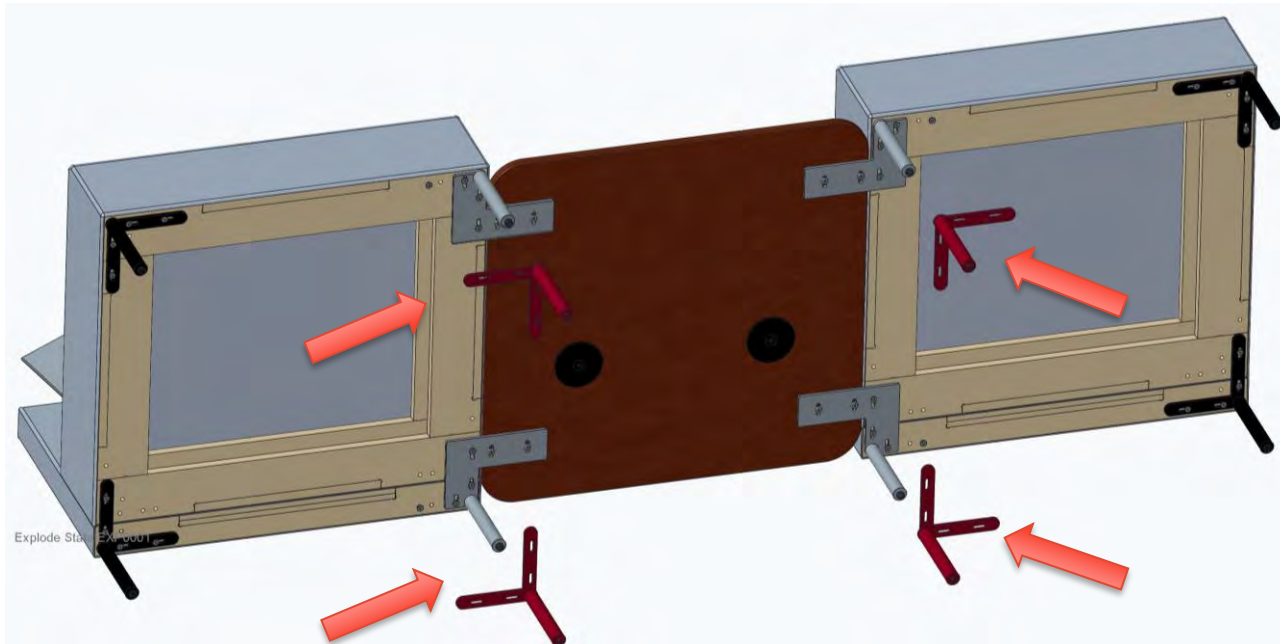
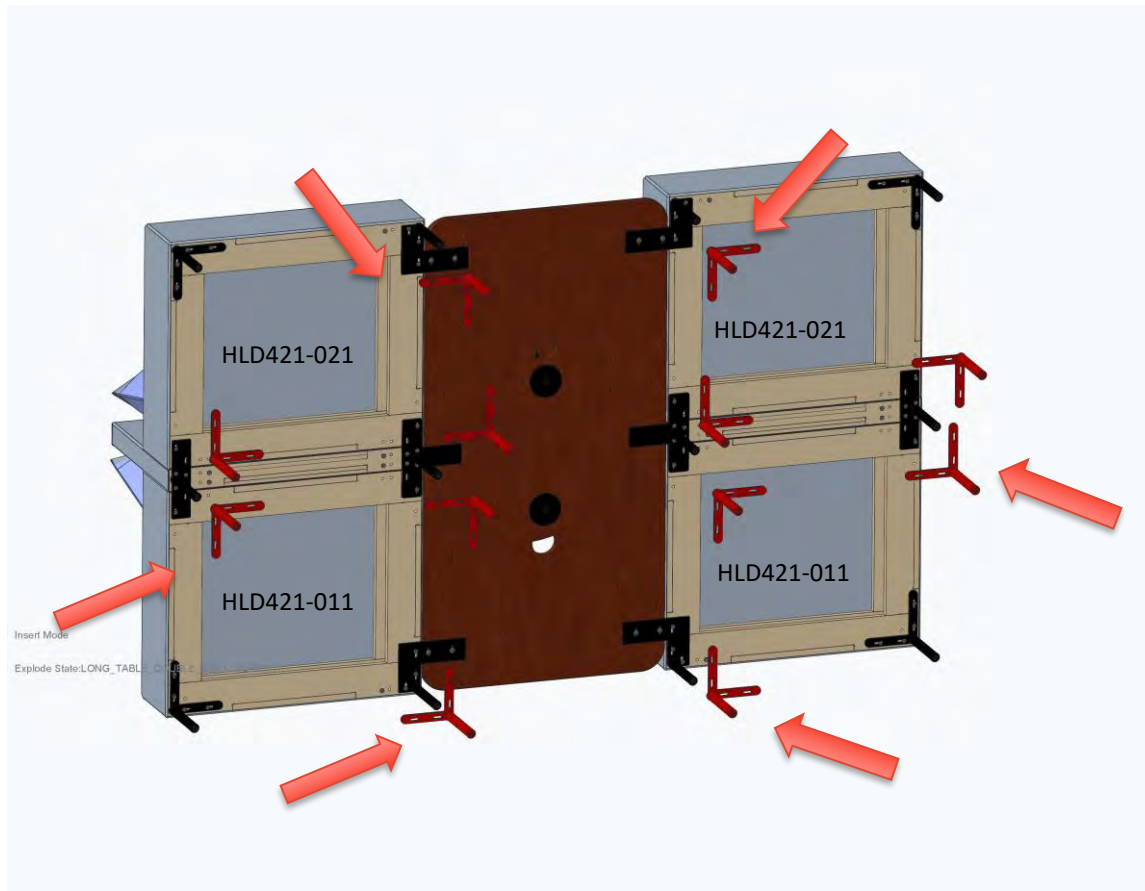

TABLE AND ADJACENT UNIT ASSEMBLY

POSSIBLE CONFIGURATION

- Assemble the 4 corner table legs (snug only).
- This assembly requires the purchase of a ganging kit (HAD421-010)(Sold separately). The leg with the angled bracket will not be used.
- If chair leg assemblies have not been installed, do not install the leg assemblies that will be replaced by the table leg assemblies. If leg assemblies have been installed, remove leg assemblies (**red leg assemblies**). Assemble each of the adjacent units using the ganging legs from the ganging kit as shown. Then attach the table center support legs to each of the adjacent units (leave loose). Carefully slide the adjacent units to the table and, re-using the 23mm bolts from the previous legs, assemble to the table and tighten all 23mm bolts. **When tightening the 15mm bolts use caution to not over-torque bolts.**

This assembly process works for the following table models:
HTD42101-5931
HTD42102-5931
HTD42103-5931



HBF